

**TRACK CONDITIONS**

Type :  Carpet  Asphalt      Size:  Open  Med.  Tight  
 Place :  Indoor  Outdoor      Traction:  High  Med.  Low  
 Surface:  Smooth  Med.  Bumpy      Track Temp/Air Temp: \_\_\_\_\_ / \_\_\_\_\_  
 Note: \_\_\_\_\_

**FRONT SUSPENSION**

Track Width: \_\_\_\_\_ mm       Gear Diff \_\_\_\_\_ wt  
 Toe Angle: 1.5 °       Spool  
 Caster: 4 °  
 Camber: 2 °  
 Ride Height: 5 mm      Anti-Roll Bar: Ø 1.3 mm  
 Down Stop: 5.6 mm

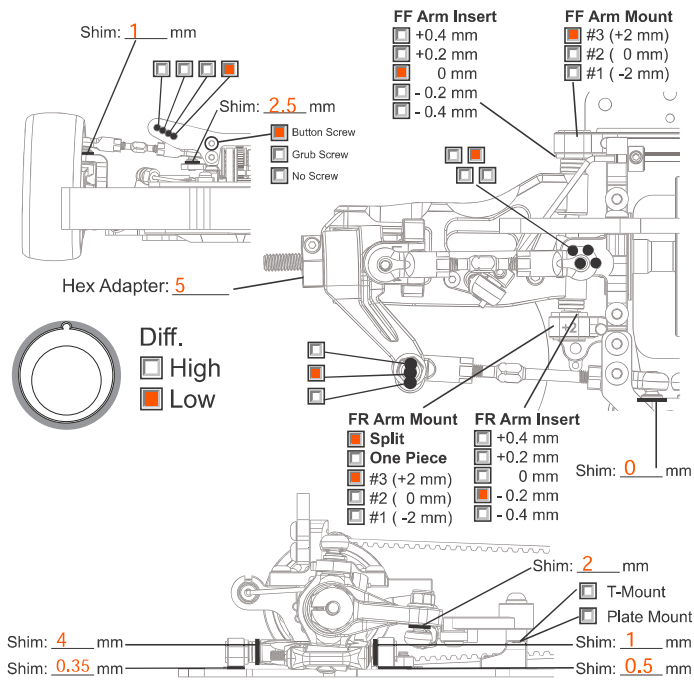

**REAR SUSPENSION**

Track Width: \_\_\_\_\_ mm      Gear Diff 7500 wt  
 Toe Angle: 2.7 °  
 Camber: 2 °  
 Ride Height: 5.2 mm  
 Down Stop: 4.2 mm      Anti-Roll Bar: Ø 1.2 mm

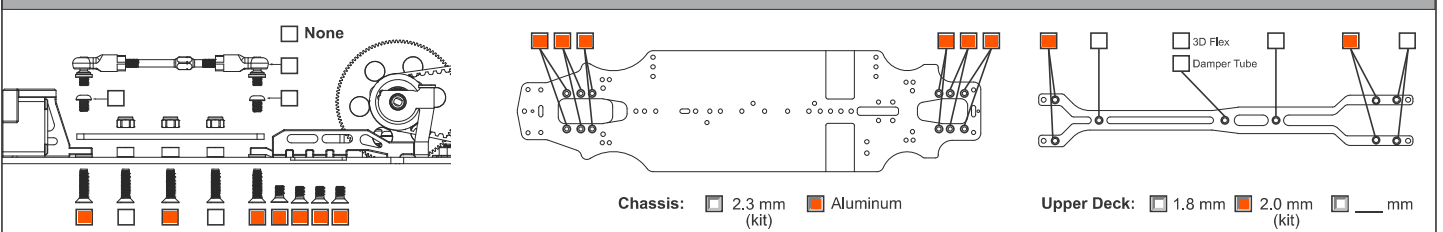
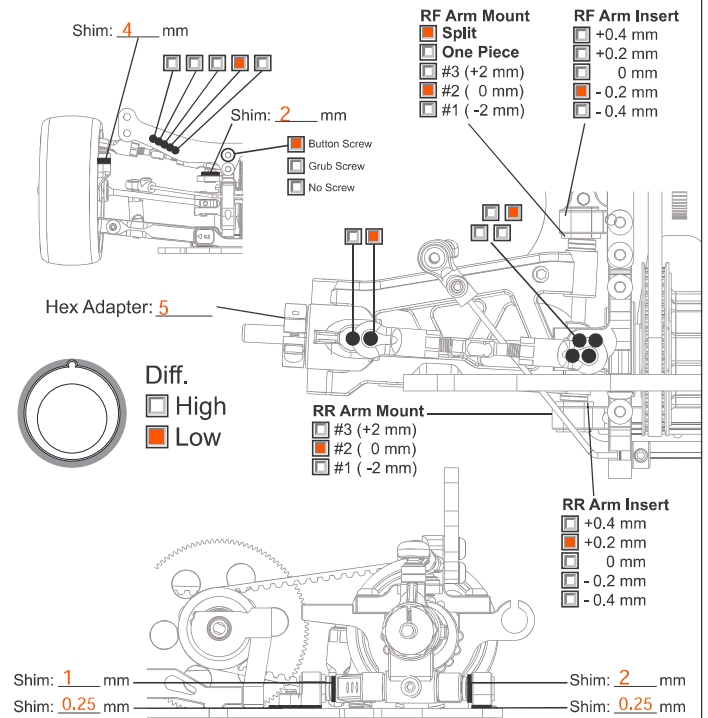

**ELECTRONICS**

Servo: \_\_\_\_\_  
 ESC: Nosram hd  
 Battery: Lrp 5500

**DRIVE RATIO**

Spur 110 T  
 Pinion 26 T X1.9 = 8.04

**MOTOR**

Brand: Lrp  
 Turns: 4.53  
 Timing: \_\_\_\_\_

**TIRES**

Insert: \_\_\_\_\_  
 Wheel: Team powerg  
 Shore/deg: \_\_\_\_\_  
 Compound: \_\_\_\_\_  
 Tire Temp: \_\_\_\_\_  
 Tire additive: Nosram carpet

**ESC**

Punch: \_\_\_\_\_  
 Initial Brake: \_\_\_\_\_  
 Drag Brake: \_\_\_\_\_  
 ESC Timing  Turbo Timing

**Treated Area**

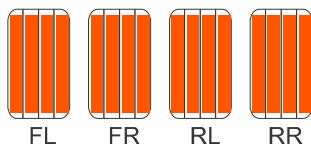

**SHOCKS**

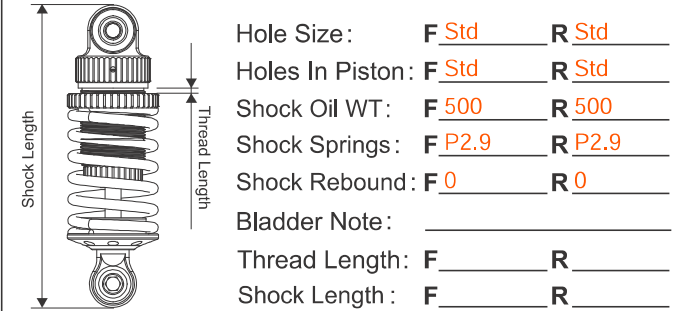

**BODY**

