

SETUP SHEET



TRACK CONDITIONS

Type :  Carpet  Asphalt      Size:  Open  Med.  Tight  
 Place :  Indoor  Outdoor      Traction:  High  Med.  Low  
 Surface:  Smooth  Med.  Bumpy      Track Temp/Air Temp: - / -

Note: Fast Lap 17.5

FRONT SUSPENSION

Track Width: \_\_\_\_\_ mm       Gear Diff \_\_\_\_\_ wt  
 Toe Angle: +0.75 °       Spool  
 Caster: 4 °  
 Camber: 1.8 °  
 Ride Height: 5.2 mm      Anti-Roll Bar: Ø 1.3 mm  
 Down Stop: 5.6 mm

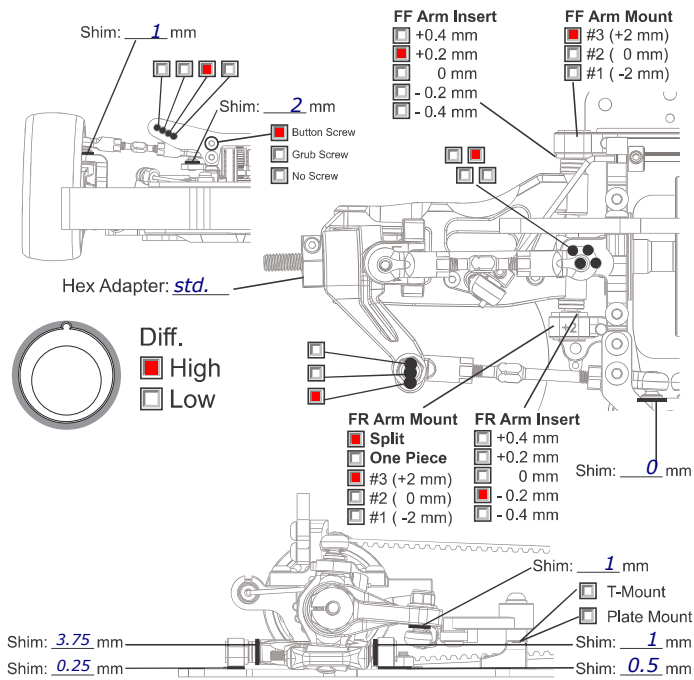

REAR SUSPENSION

Track Width: \_\_\_\_\_ mm      Gear Diff \_\_\_\_\_ 8000 wt  
 Toe Angle: \_\_\_\_\_ °  
 Camber: 2.0 °  
 Ride Height: 5.5 mm  
 Down Stop: 4.6 mm      Anti-Roll Bar: Ø 1.2 mm

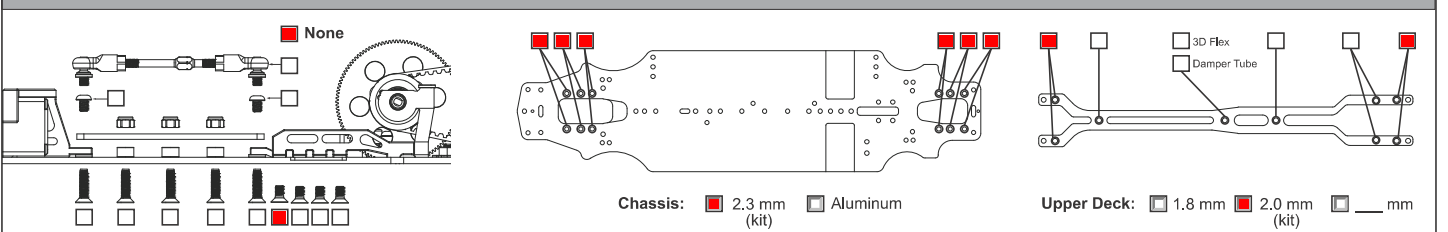
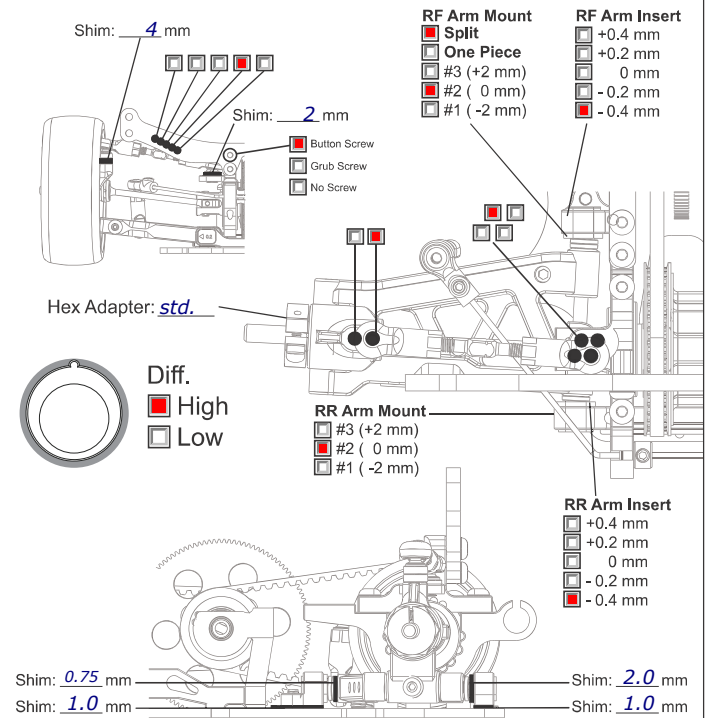

ELECTRONICS

Servo: HRC  
 ESC: MM  
 Battery: EZ HV 8200

MOTOR

Brand: MM  
 Turns: 13.5  
 Timing: Fixed

ESC

Punch: max.  
 Initial Brake: -  
 Drag Brake: -  
 ESC Timing  Turbo Timing

DRIVE RATIO

Spur 74 T  
 Pinion 31 T  $\times 1.9 =$  4.54

TIRES

Insert: Volante 36R  
 Wheel: \_\_\_\_\_  
 Shore/deg: \_\_\_\_\_  
 Compound: \_\_\_\_\_  
 Tire Temp: 55  
 Tire additive: HRC Green  
 Treated Area

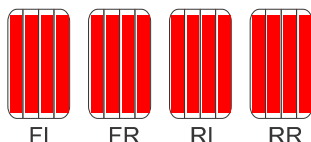

SHOCKS

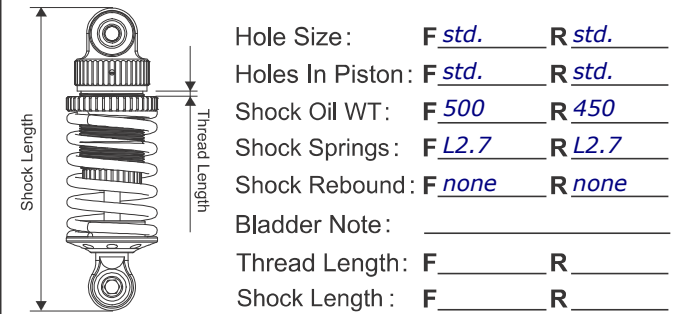

BODY

