

**TRACK CONDITIONS**

Type :  Carpet  Asphalt      Size:  Open  Med.  Tight  
 Place :  Indoor  Outdoor      Traction:  High  Med.  Low  
 Surface:  Smooth  Med.  Bumpy      Track Temp/Air Temp: 22 / 22  
 Note: Fast Lap 16.5

**FRONT SUSPENSION**

Track Width: \_\_\_\_\_ mm       Gear Diff \_\_\_\_\_ wt  
 Toe Angle: +0,75 °       Spool  
 Caster: 4 °  
 Camber: 1.2 °  
 Ride Height: 5.2 mm      Anti-Roll Bar: Ø 1.3 mm  
 Down Stop: 5.8 mm

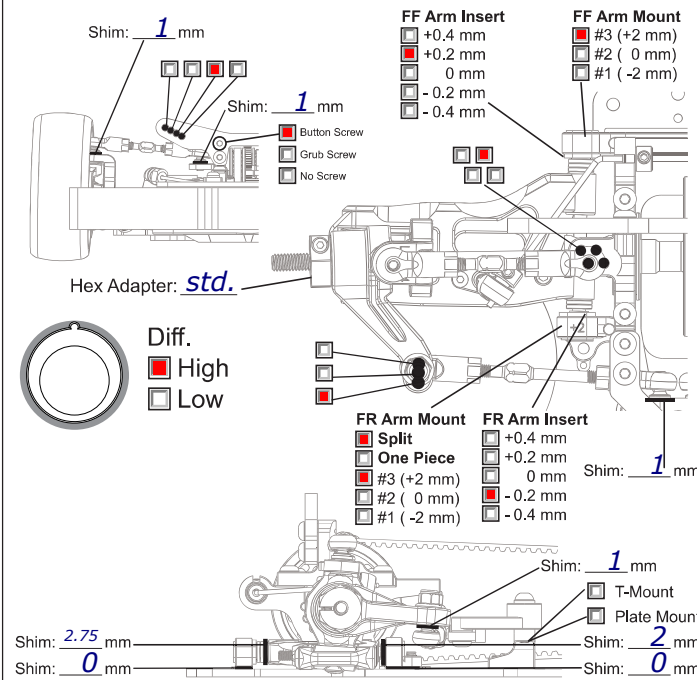

**REAR SUSPENSION**

Track Width: \_\_\_\_\_ mm      Gear Diff 3000 wt  
 Toe Angle: \_\_\_\_\_ °  
 Camber: 1.5 °  
 Ride Height: 5.4 mm  
 Down Stop: 5.0 mm      Anti-Roll Bar: Ø 1.2 mm

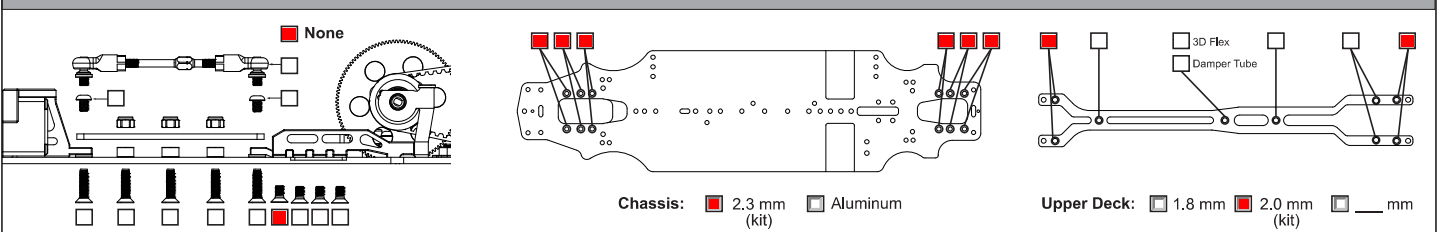
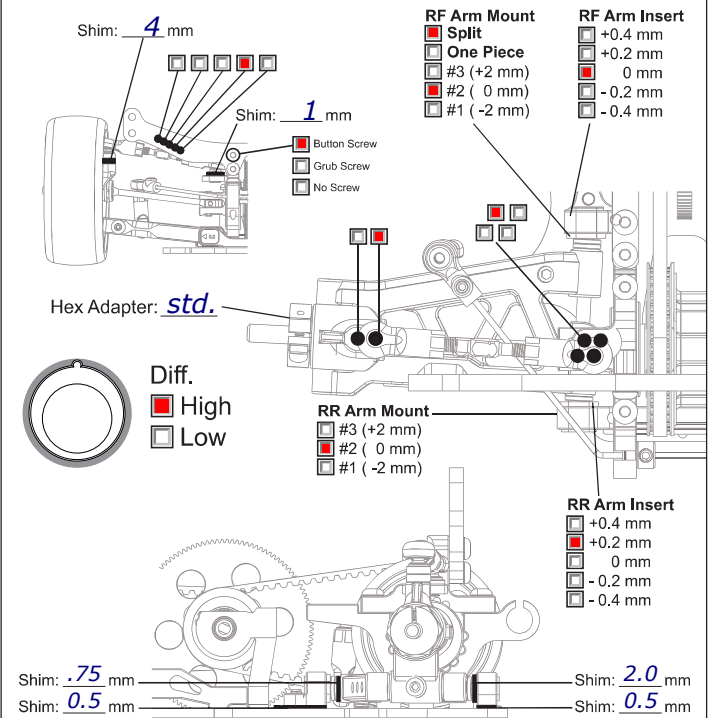

**ELECTRONICS**

Servo: HRC  
 ESC: MM  
 Battery: EZ HV 8200

**MOTOR**

Brand: MM  
 Turns: 13.5  
 Timing: Fixed

**ESC**

Punch: max.  
 Initial Brake: -  
 Drag Brake: -  
 ESC Timing  Turbo Timing

**DRIVE RATIO**

Spur 74 T  
 Pinion 31 T  $\times 1.9 =$  4.54

**TIRES**

Insert: Volante 36R  
 Wheel: \_\_\_\_\_  
 Shore/deg: \_\_\_\_\_  
 Compound: \_\_\_\_\_  
 Tire Temp: 65  
 Tire additive: Mr33 v3

**Treated Area**

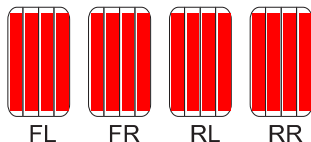

**SHOCKS**

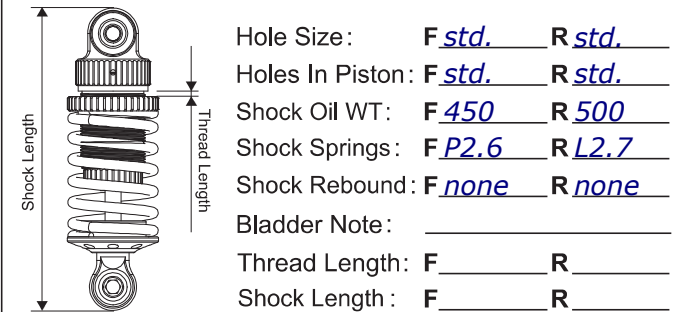

**BODY**

