

**TRACK CONDITIONS**

Type :  Carpet  Asphalt      Size:  Open  Med.  Tight  
 Place :  Indoor  Outdoor      Traction:  High  Med.  Low  
 Surface:  Smooth  Med.  Bumpy      Track Temp/Air Temp: 47 / 30  
 Note: \_\_\_\_\_

**FRONT SUSPENSION**

Track Width: \_\_\_\_\_ mm       Gear Diff \_\_\_\_\_ wt  
 Toe Angle: 0.5 °       Spool  
 Caster: 4 °  
 Camber: 2.0 °  
 Ride Height: 5.4 mm      Anti-Roll Bar: Ø 1.3 mm  
 Down Stop: 31.2 mm

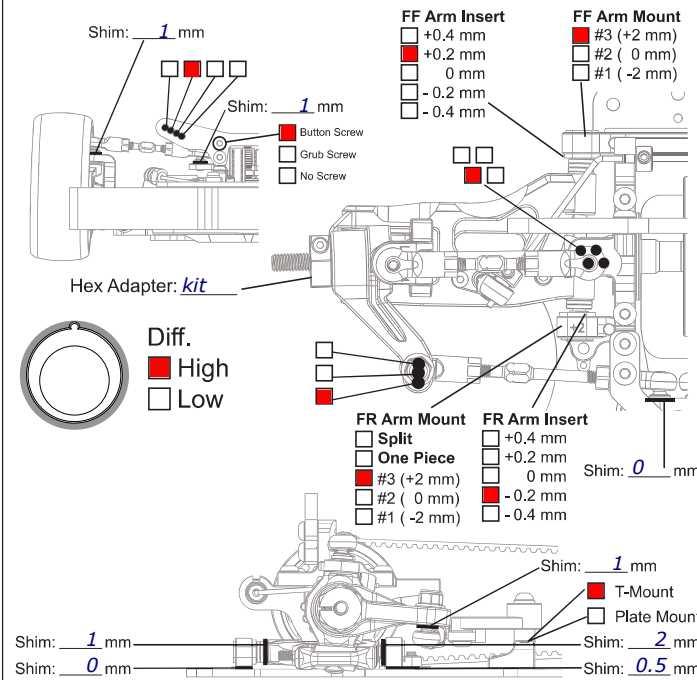

**REAR SUSPENSION**

Track Width: \_\_\_\_\_ mm      Gear Diff \_\_\_\_\_ 4000 wt  
 Toe Angle: \_\_\_\_\_ 3 °  
 Camber: \_\_\_\_\_ 2.5 °  
 Ride Height: \_\_\_\_\_ 5.6 mm  
 Down Stop: \_\_\_\_\_ 30.4 mm      Anti-Roll Bar: Ø 1.2 mm

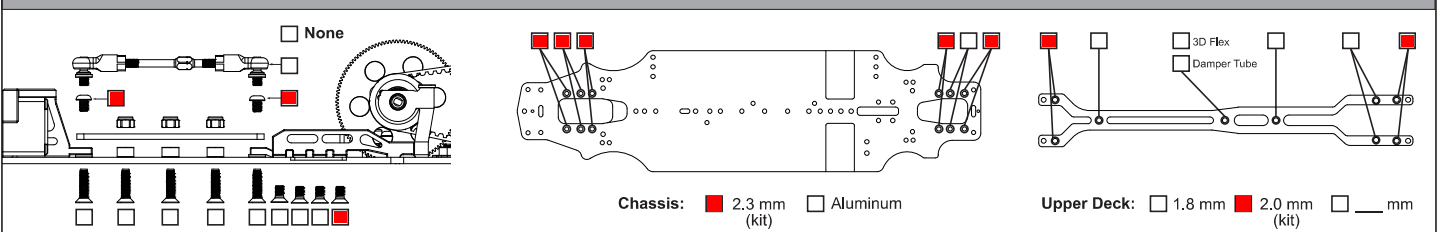
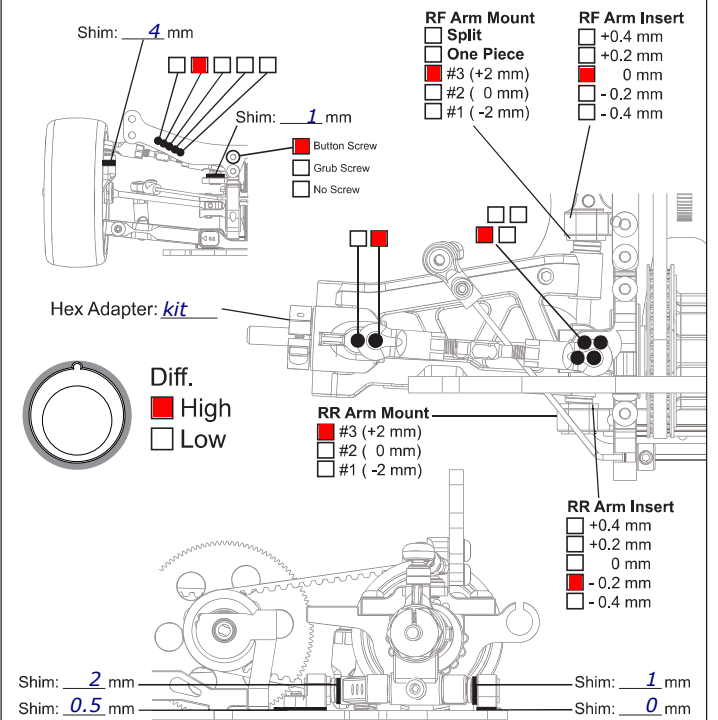

**ELECTRONICS**

Servo: HRC BL Low  
 ESC: Muchmore  
 Battery: Muchmore

**MOTOR**

Brand: Muchmore  
 Turns: 4.5  
 Timing: 20°

**ESC**

Punch: 0  
 Initial Brake: 75%  
 Drag Brake: 10%  
 ESC Timing  Turbo Timing  
30°

**DRIVE RATIO**

Spur 79 T  
 Pinion 22 T X1.9 = 6.82

**TIRES**

Insert: \_\_\_\_\_  
 Wheel: Sweep 30  
 Shore/deg: 30  
 Compound: \_\_\_\_\_  
 Tire Temp: \_\_\_\_\_  
 Tire additive: \_\_\_\_\_  
 Treated Area  
 FL  FR  RL  RR

**SHOCKS**

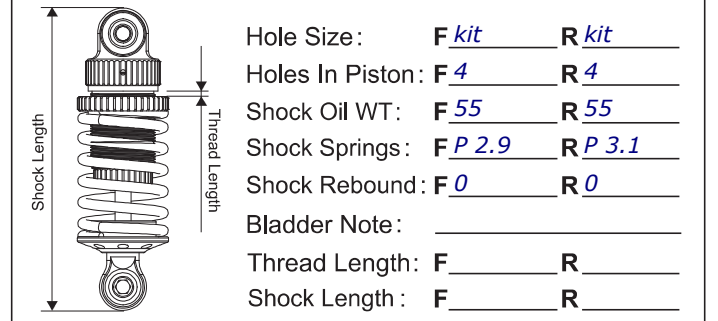

**BODY**

