

TRACK CONDITIONS

Type : Carpet Asphalt Size: Open Med. Tight
 Place : Indoor Outdoor Traction: High Med. Low
 Surface: Smooth Med. Bumpy Track Temp/Air Temp: 15° / _____
 Note: _____

FRONT SUSPENSION

Track Width: _____ mm Gear Diff _____ wt
 Toe Angle: 1° Spool
 Caster: 4°
 Camber: 2,0°
 Ride Height: 5 mm Anti-Roll Bar: Ø 1.3 mm
 Down Stop: 31.6 mm

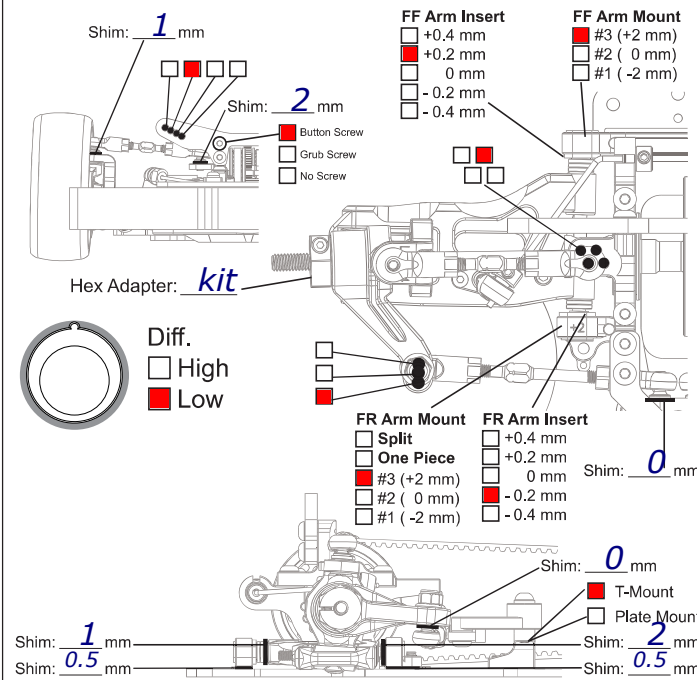

REAR SUSPENSION

Track Width: _____ mm Gear Diff 6000 wt
 Toe Angle: 3°
 Camber: 2.0°
 Ride Height: 5.2 mm
 Down Stop: 31.2 mm Anti-Roll Bar: Ø 1.2 mm

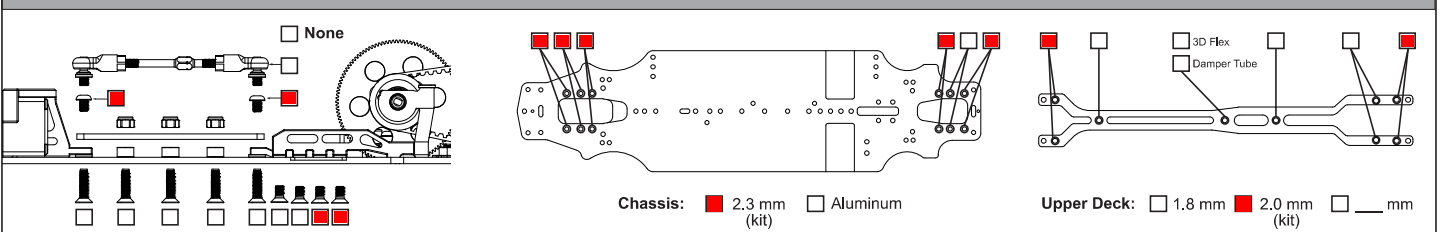
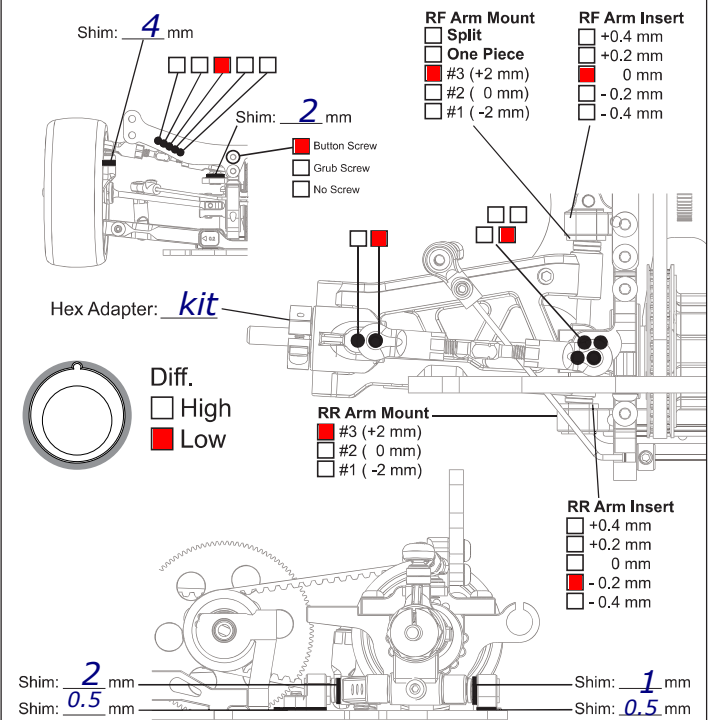

ELECTRONICS

Servo: HRC BL Low
 ESC: Muchmore
 Battery: Muchmore

MOTOR

Brand: _____
 Turns: 7.5
 Timing: 20

ESC

Punch: 2
 Initial Brake: 10 %
 Drag Brake: 10%
 ESC Timing Turbo Timing
2 38

DRIVE RATIO

Spur 79_T
 Pinion 21_T × 1.9 = 7.15

TIRES

Insert: _____
 Wheel: Volante
 Shore/deg: 28
 Compound: _____
 Tire Temp: _____
 Tire additive: CS High Grip

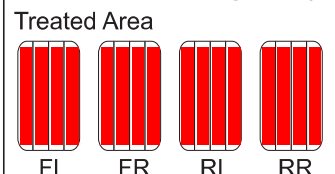

SHOCKS

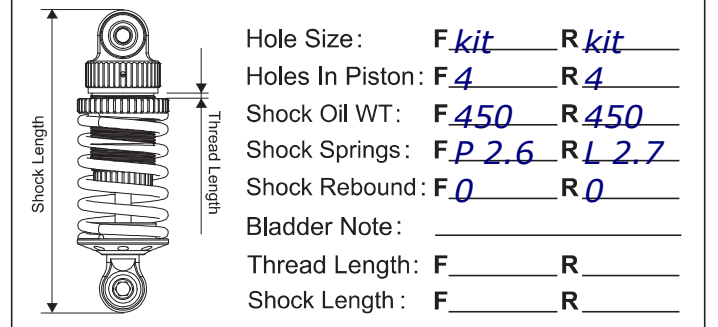

BODY

