

TRACK CONDITIONS

Type : Carpet Asphalt
 Place : Indoor Outdoor
 Surface : Smooth Med. Bumpy
 Size: Open Med. Tight
 Traction: High Med. Low
 Track Temp/Air Temp: _____ / _____
 Note: _____

FRONT SUSPENSION

Track Width: _____ mm Gear Diff _____ wt
 Toe Angle: +0.5 ° Spool
 Caster: 4 °
 Camber: 1.5 °
 Ride Height: 5.2 mm Anti-Roll Bar: Ø 1.3 mm
 Down Stop: 5.3 (31.2/axle) mm

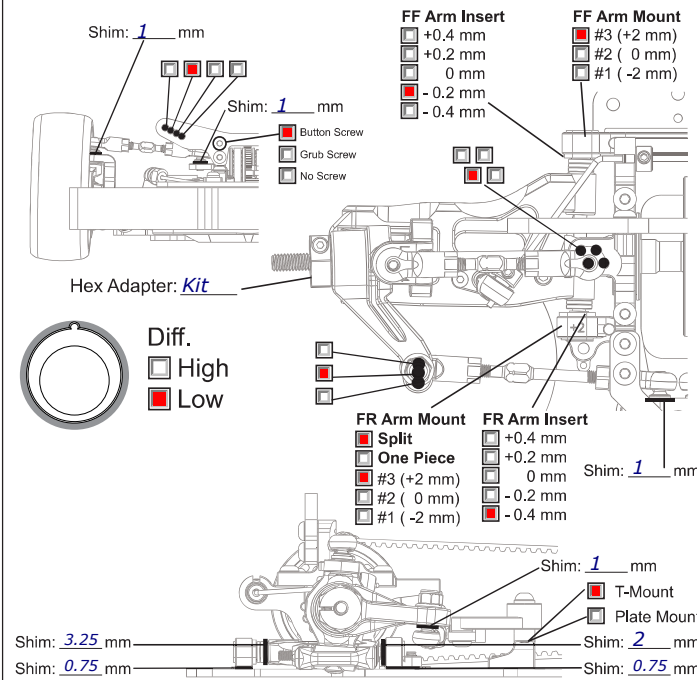

REAR SUSPENSION

Track Width: _____ mm Gear Diff 3'000 wt
 Toe Angle: 2.7 °
 Camber: 1.5 °
 Ride Height: 5.4 mm
 Down Stop: 4.9 (30.6/axle) mm Anti-Roll Bar: Ø 1.2 mm

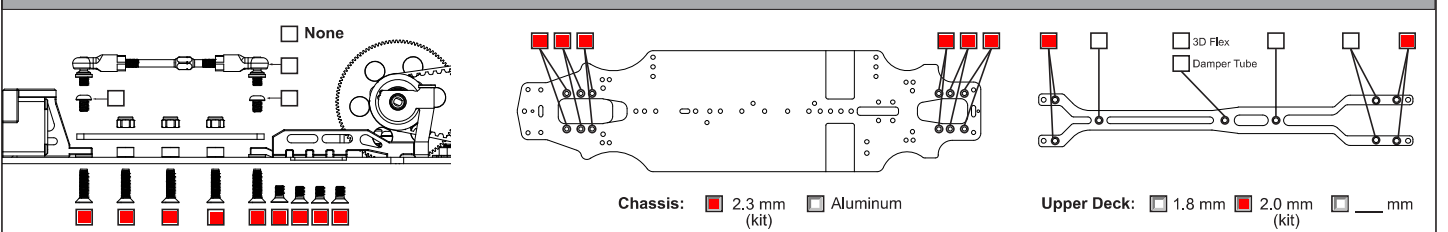
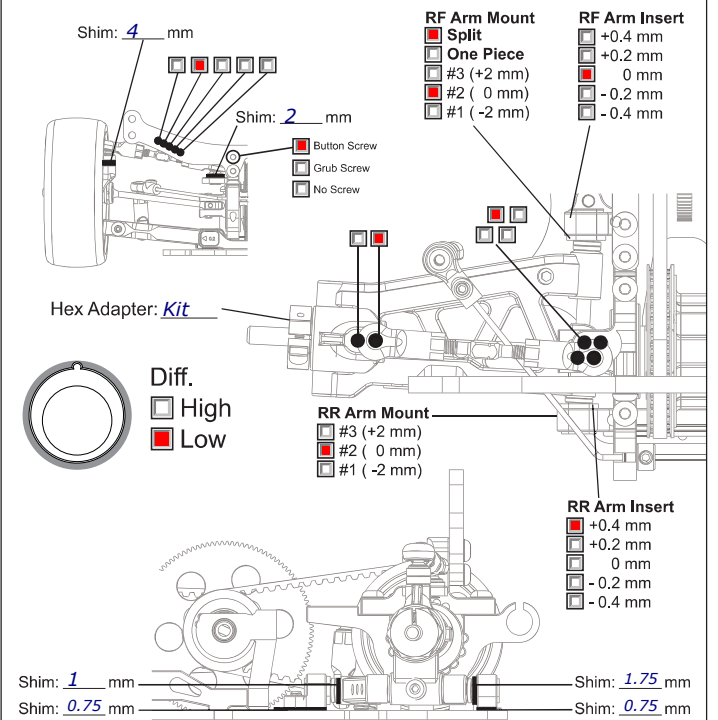

ELECTRONICS

Servo: _____
 ESC: _____
 Battery: _____

MOTOR

Brand: _____
 Turns: _____
 Timing: _____

ESC

Punch: _____
 Initial Brake: _____
 Drag Brake: _____
 ESC Timing Turbo Timing

DRIVE RATIO

Spur 100 T
 Pinion 30 T $\times 1.9 =$ 6.33

TIRES

Insert: _____
 Wheel: _____
 Shore/deg: _____
 Compound: _____
 Tire Temp: _____
 Tire additive: _____

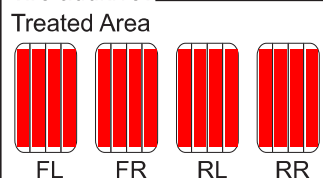

SHOCKS

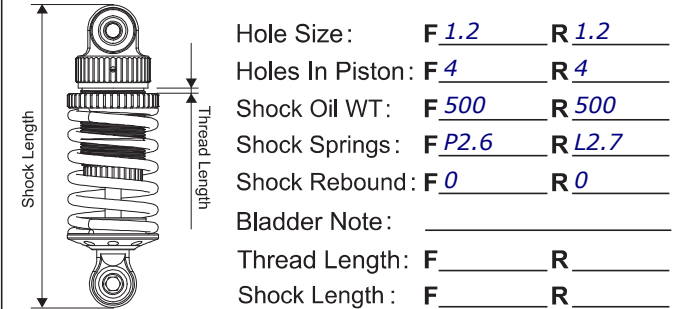

BODY

