

TRACK CONDITIONS

Type : Carpet Asphalt Size: Open Med. Tight
 Place : Indoor Outdoor Traction: High Med. Low
 Surface: Smooth Med. Bumpy Track Temp/Air Temp: 15 / 15
 Note: Best lap 9.089, easy car, slow is fast

FRONT SUSPENSION

Track Width: _____ mm Gear Diff _____ wt
 Toe Angle: +1.5 ° Spool
 Caster: 4 °
 Camber: -1.5 °
 Ride Height: 5 mm Anti-Roll Bar: Ø 1.2 mm
 Down Stop: 5.0 mm

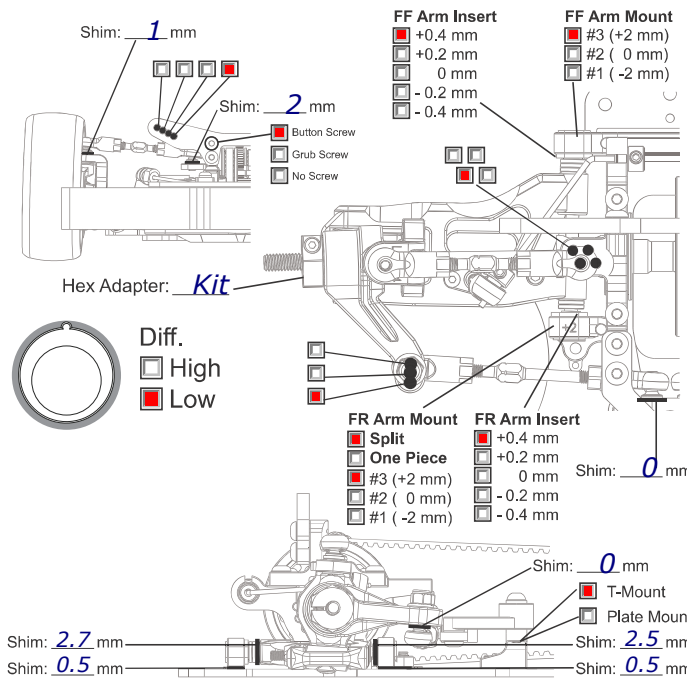

REAR SUSPENSION

Track Width: _____ mm Gear Diff 5'000 wt
 Toe Angle: -3.0 °
 Camber: -1.5 °
 Ride Height: 5.2 mm
 Down Stop: 4.8 mm Anti-Roll Bar: Ø 1.2 mm

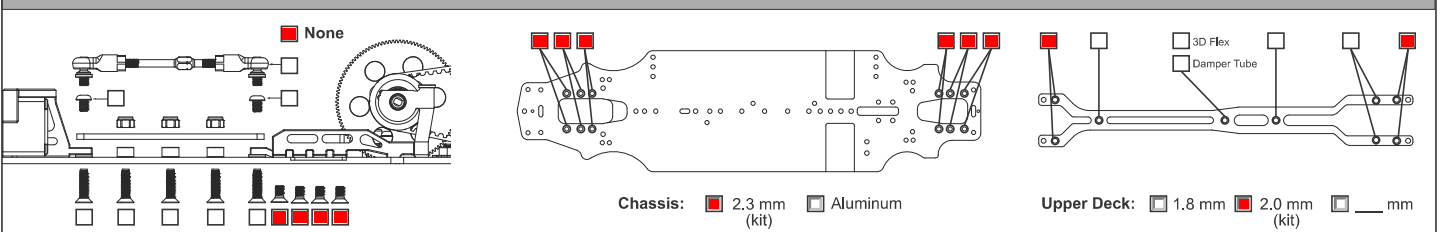
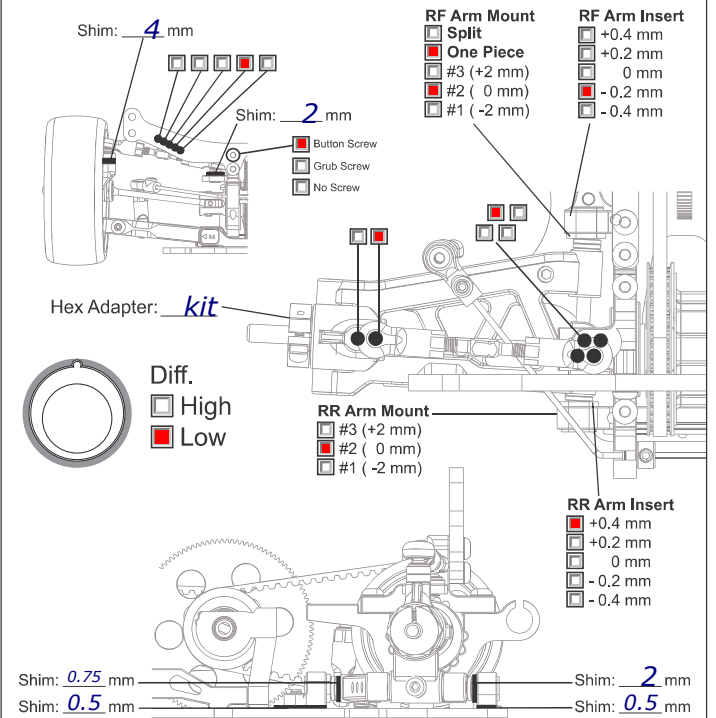

ELECTRONICS

Servo: HRC 68113CAR
 ESC: HW V3.1
 Battery: Nvision 6000

MOTOR

Brand: Orion
 Turns: 13.5
 Timing: 28°

ESC

Punch: 8-8
 Initial Brake: 8-6
 Drag Brake: 0% 87.5%
 ESC Timing Turbo Timing
40° 5'000-22'000

DRIVE RATIO

Spur 110 T
 Pinion 25 T X1.9 = 8.36

TIRES

Insert: _____
 Wheel: _____
 Shore/deg: Volante
 Compound: _____
 Tire Temp: 10mins
 Tire additive: CS High Grip
 Treated Area

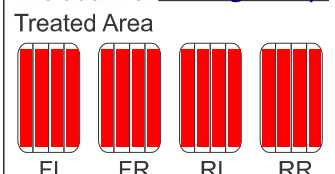

SHOCKS

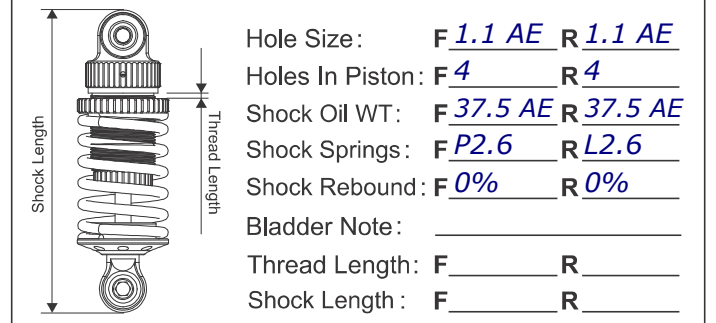

BODY

