

SP-1 185mm Track Width Setting (Option Parts Required)

1 | ATTACHING STEERING

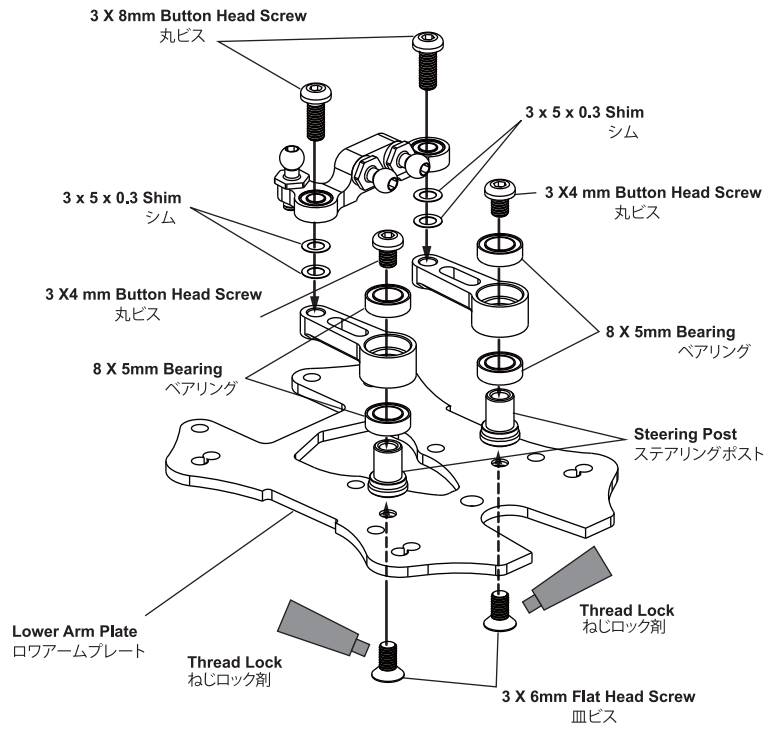

Optional

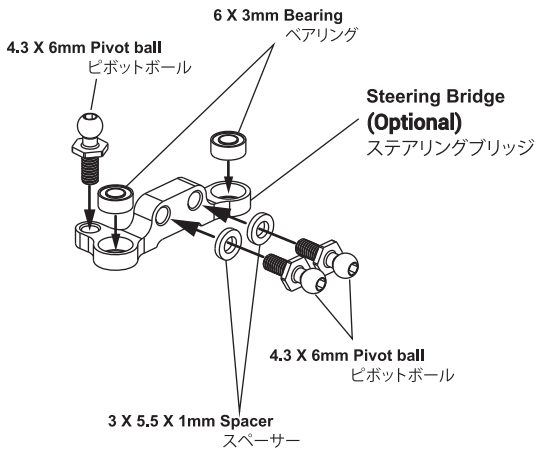
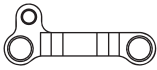

Steering Bridge
(Aluminium)
ステアリングブリッジ
(アルミ)

SP000741 (Gunmetal)
SP001016 (Red)

2 | SERVO

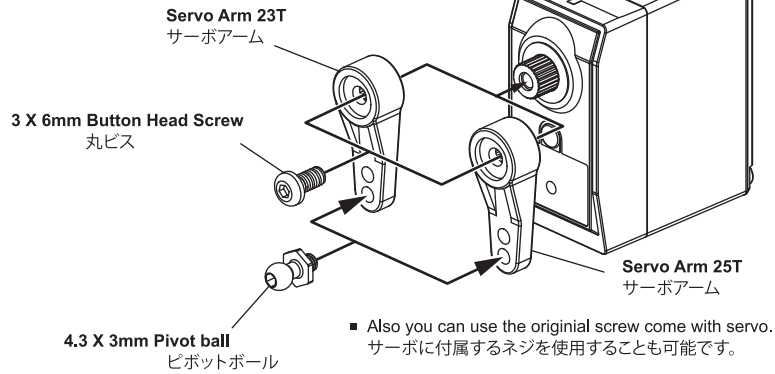
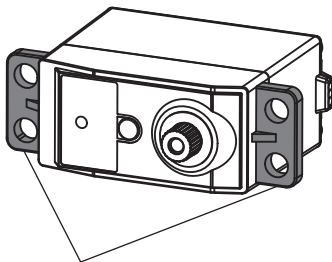

Optional



Servo Arm 23T (Aluminium)
サーボアーム 23T (アルミ)
SP000980

Optional



Servo Arm 25T (Aluminium)
サーボアーム 25T (アルミ)
SP000981

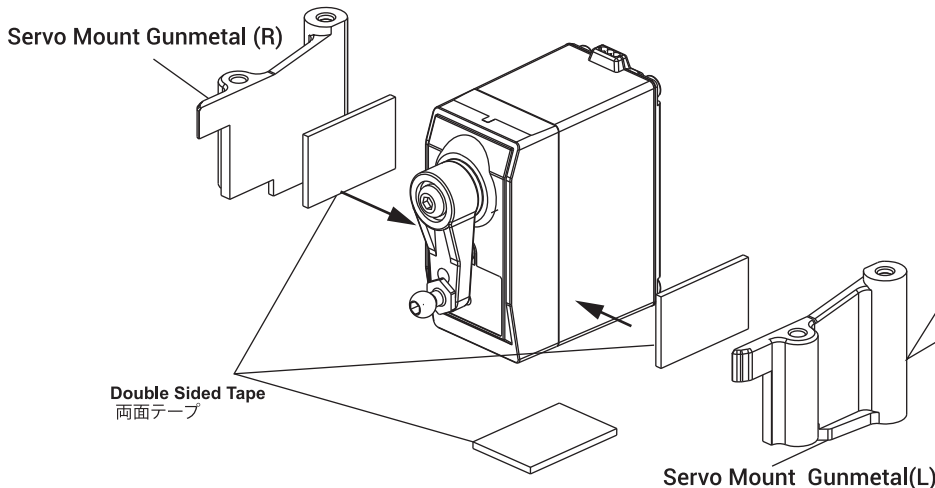

Optional

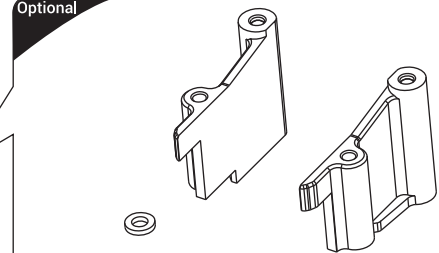

Servo Mount Set
(Aluminium)
サーボマウントセット
(アルミ)
SP000977 (Gunmetal)
SP001016 (Red)

3 | ATTACHING LOWER SUSPENSION ARM

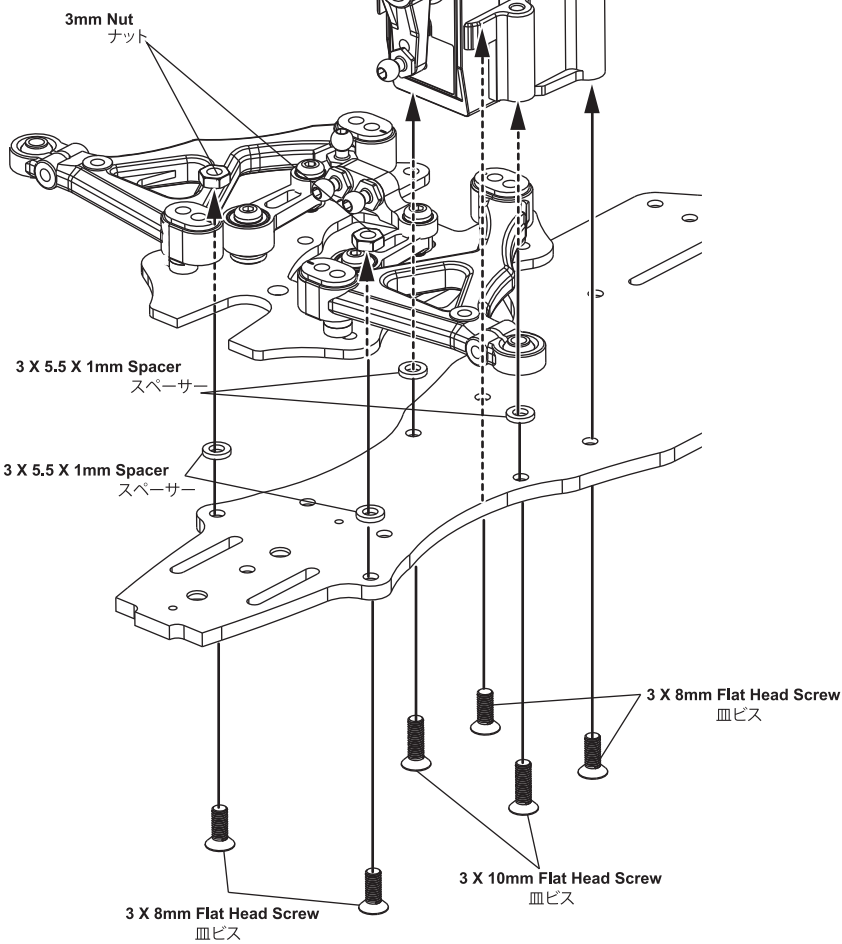
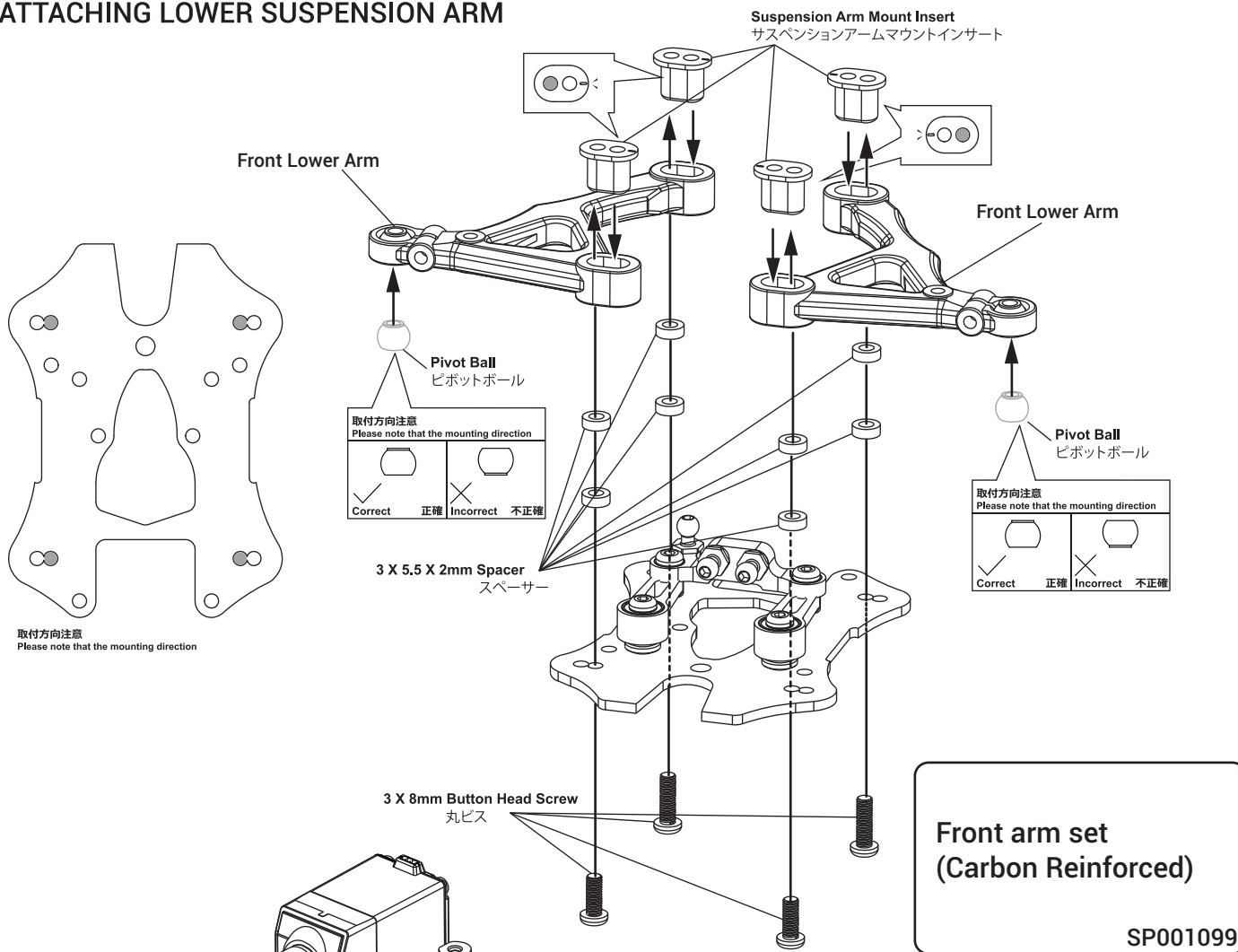

4 | ATTACHING CASTER BLOCK

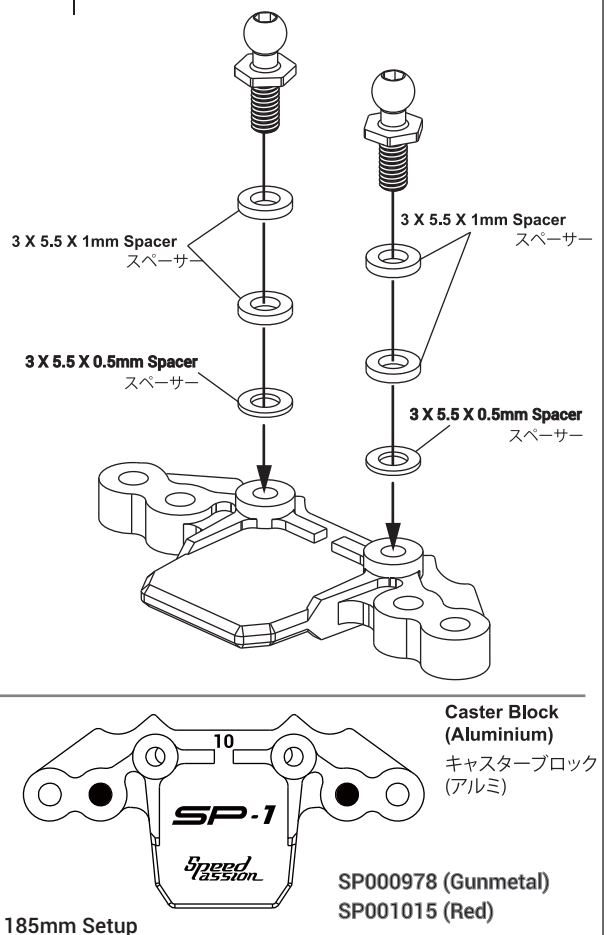

5 | SERVO LINK

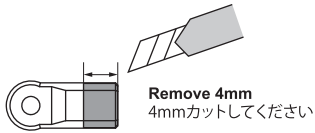

⚠ Be careful for the cutter blade.
十分に注意して作業してください。

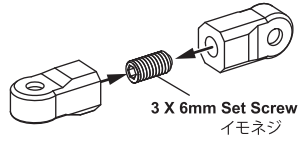

Overall length is 21.5mm
21.5mmに合わせてください

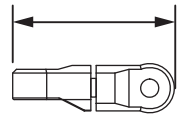

6 | TURNBUCKLE x2

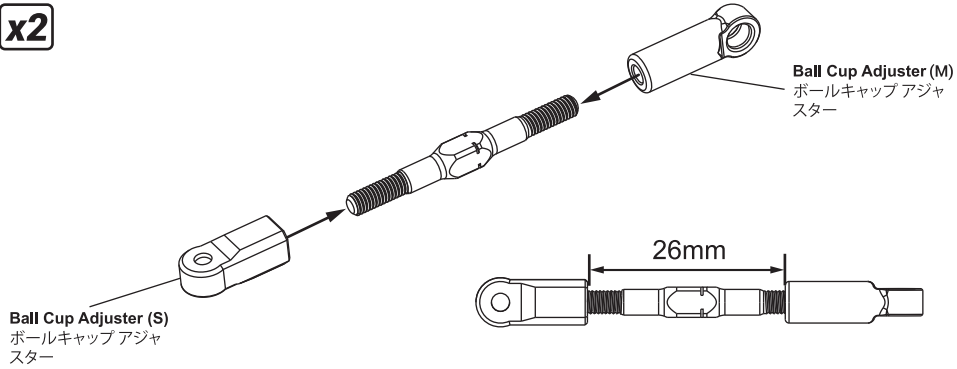

7 | ATTACHING CASTER BLOCK

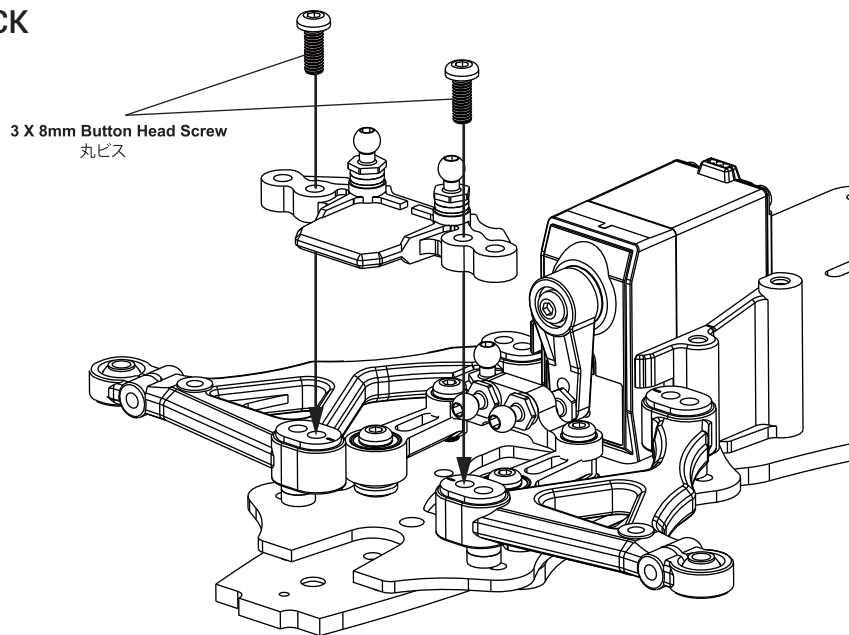

8 | ATTACHING TURNBUCKLE & SERVO LINK

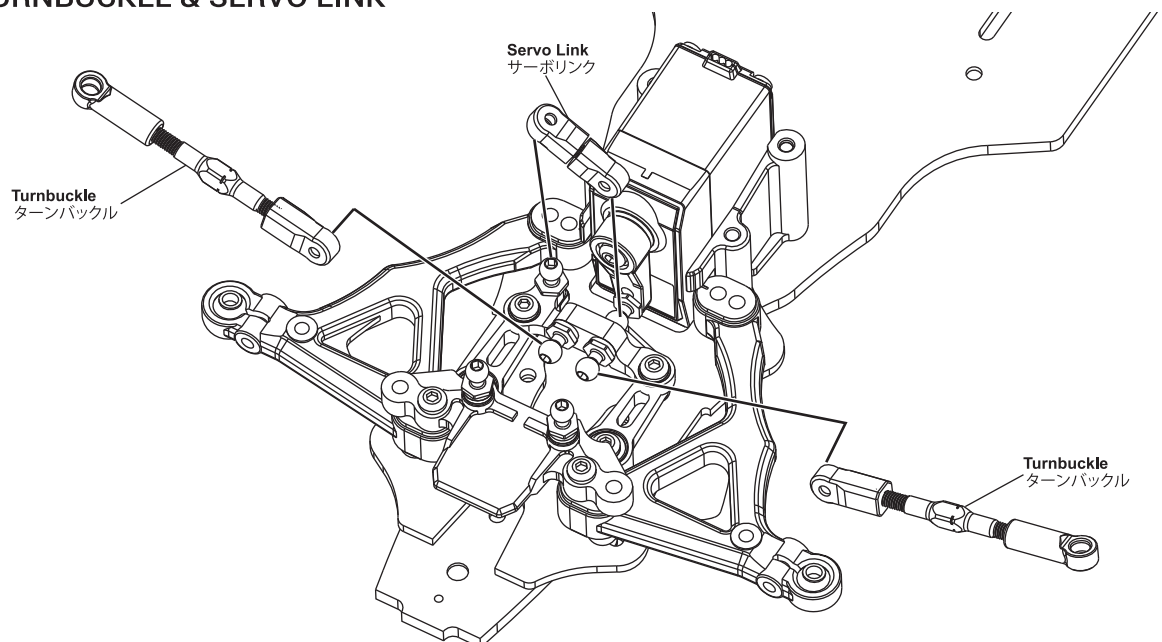

9 | ATTACHING UPPER SUSPENSION ARM

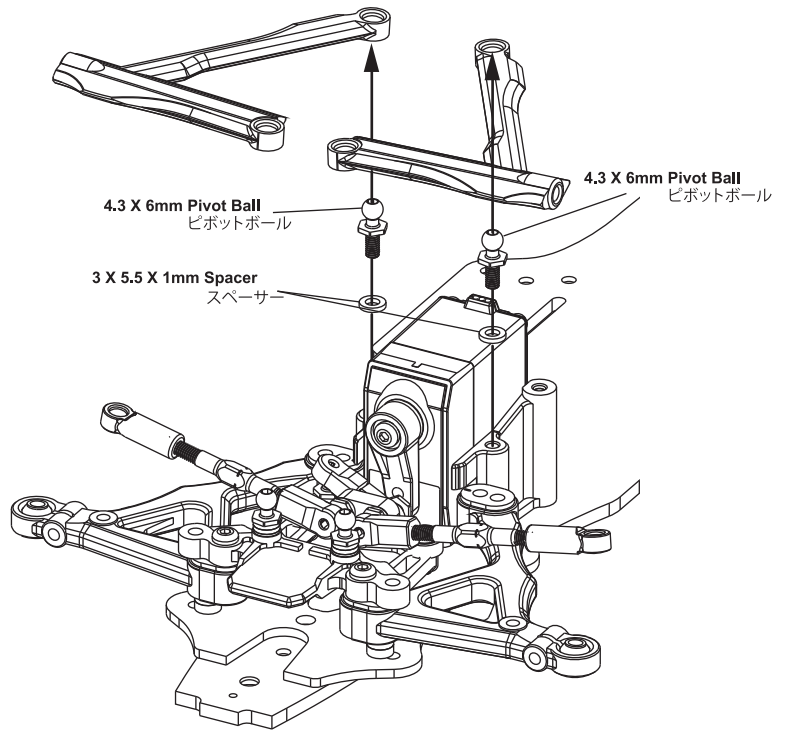
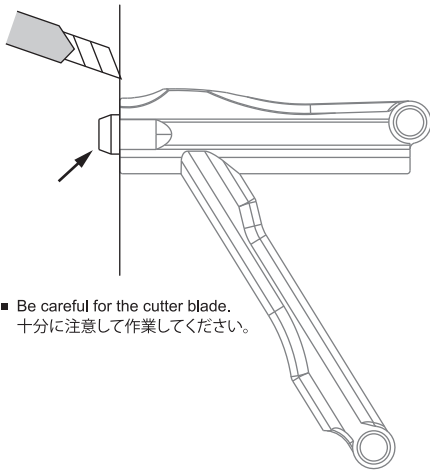

10 | STEERING UPRIGHT

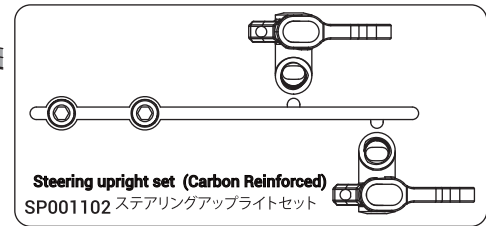
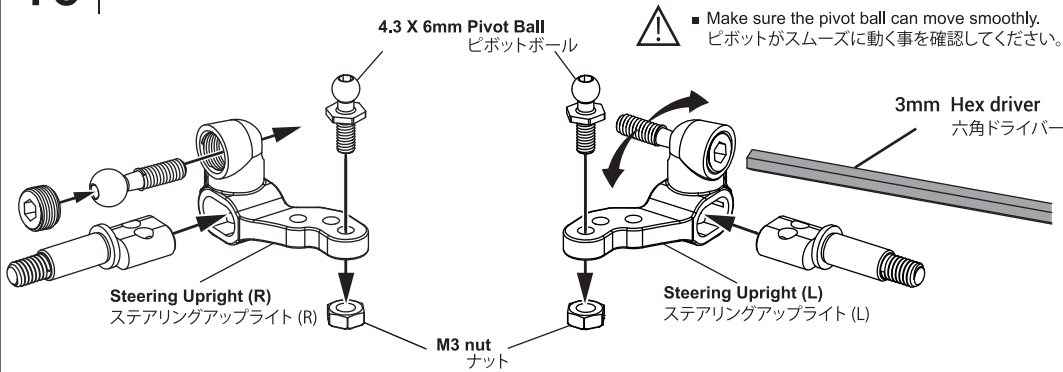

11 | ATTACHING STEERING UPRIGHT x2

