

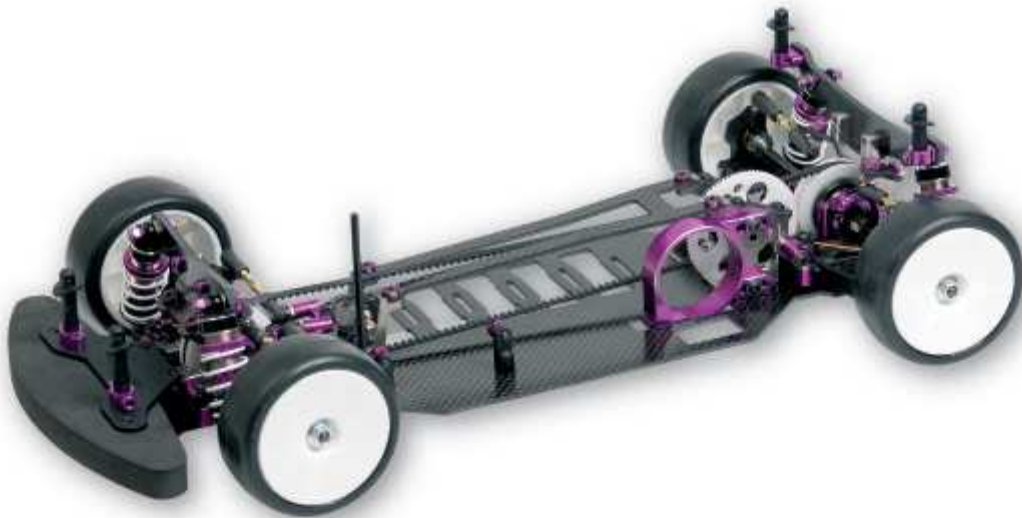

# Instruction Manual v.1.0



Schumacher Racing  
73 Tenter Road  
Moulton Park  
Northampton  
NN3 6AX  
ENGLAND



Schumacher USA Inc  
6302 Benjamin Road  
Suite 404  
Tampa  
Florida 33634  
U.S.A

S1179



## Transmitter, receiver and servo

(including AA bats for 3)



## Electronic Speed Control



SPK1000020 SP GT - PRD B/L ESC V3.0 Blue  
 SPK1000020 SP GT - PRD B/L ESC V3.0 Carbon  
 SPK1000020 SP GT - LFP B/L ESC V 3.0 Blue 5.5T  
 SPK1000020 SP GT - LFP B/L ESC V3.0 Carbon 5.5T

## Battery Pack



GL1T - Ener-G 4000 - XVS Team x 5  
 GL1B - Ener-G 4000 - XVS Team x 4



CR04 - CORE 5000mAh 1.4v LiPo 25C  
 CR04 - CORE 3250mAh 1.4v LiPo  
 SLR5709H Speed Power - 5900mAh 1.4v 30C

## Battery Charger



CR04 UDC30 Balance Charger - NiMH + Lipo  
 CR104 - UDC30 Universal Charger - NiMH, Lipo + LiFe

## Motor

SP19045 Speed Passion CV3.0 Core BL Motor: 4.5T  
 SP19045 Speed Passion CV3.0 Core BL Motor: 5.5T  
 SP19045 Speed Passion CV3.0 Core BL Motor: 6.0T  
 SP19045 Speed Passion CV3.0 Core BL Motor: 6.5T  
 SP19045 Speed Passion CV3.0 Core BL Motor: 7.0T  
 SP19045 Speed Passion CV3.0 Core BL Motor: 7.5T  
 SP19045 SP Ultra Stack BL Motor 10.5T  
 SP19045 SP Ultra Stack BL Motor 13.5T  
 SP19045 SP Ultra Stack BL Motor 15.5T



## Wheels & Tyres



See  
[www.racing-cars.com](http://www.racing-cars.com)  
 for full  
 listings.

## Bodyshell & Paint



## Pinion Gear

UP414 - 14T Pinion, Hard Alloy 48dp  
 UP415 - 15T Pinion, Hard Alloy 48dp  
 UP416 - 16T Pinion, Hard Alloy 48dp  
 UP417 - 17T Pinion, Hard Alloy 48dp  
 UP418 - 18T Pinion, Hard Alloy 48dp  
 UP419 - 19T Pinion, Hard Alloy 48dp  
 UP420 - 20T Pinion, Hard Alloy 48dp  
 UP421 - 21T Pinion, Hard Alloy 48dp  
 UP422 - 22T Pinion, Hard Alloy 48dp  
 UP423 - 23T Pinion, Hard Alloy 48dp  
 UP424 - 24T Pinion, Hard Alloy 48dp  
 UP425 - 25T Pinion, Hard Alloy 48dp  
 UP426 - 26T Pinion, Hard Alloy 48dp  
 UP427 - 27T Pinion, Hard Alloy 48dp  
 UP428 - 28T Pinion, Hard Alloy 48dp  
 UP429 - 29T Pinion, Hard Alloy 48dp  
 UP430 - 30T Pinion, Hard Alloy 48dp  
 UP431 - 31T Pinion, Hard Alloy 48dp  
 UP432 - 32T Pinion, Hard Alloy 48dp  
 64dp Hard Alloy Pinion's also available see  
[www.racing-cars.com](http://www.racing-cars.com)

## Tools



MW100 Wika Precision  
 Circclip Pliers

Curved Body Scissors  
 CR044  
 Designed for cutting out  
 polycarbonate bodies.

UP307 - Solder

CA450  
 20g LS Epoxy  
 (Super Glue)  
 Thin, ideal for tyres.

## IMPORTANT SAFETY NOTES

- This product is not suitable for children under the age of 14, without the direct supervision of an adult.
- Select an area for assembly that is away from the reach of small children. The parts in this kit are small and can be swallowed by children causing choking and possible internal injuries.
- Exercise care when using hand tools and sharp instruments during assembly.
- Carefully read all manufacturers warnings and cautions for any additional parts used in the construction.
- In line with our policy of continuous development the exact details of the kit may vary.

Before you begin building your Mi4  
 please refer to the set-up sheets at the back of the  
 manual. It may be necessary to build the car differently  
 according to the set-up required.

## Step 1

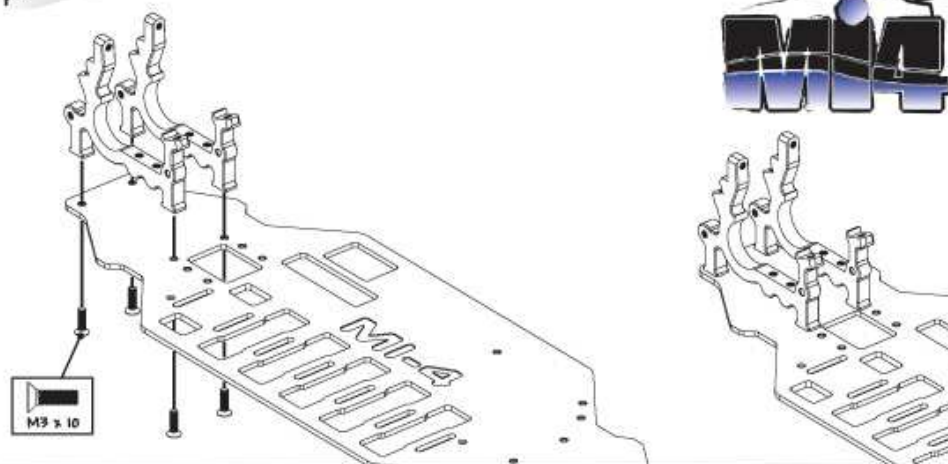

## Step 2

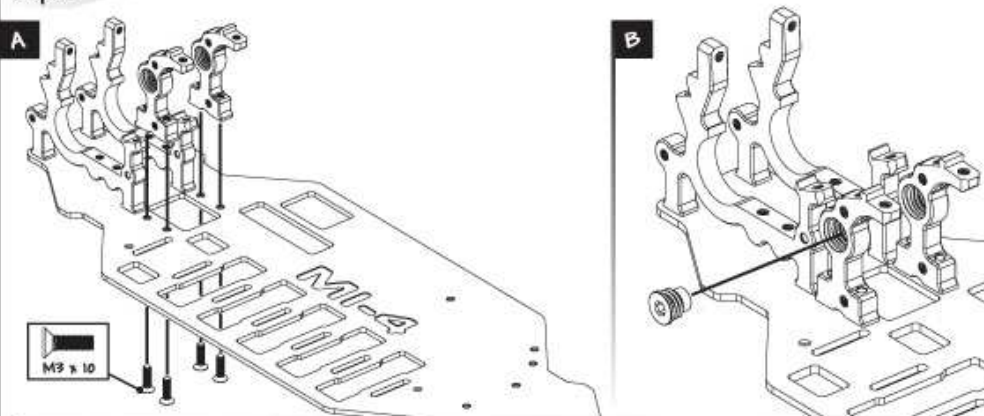

## Step 3

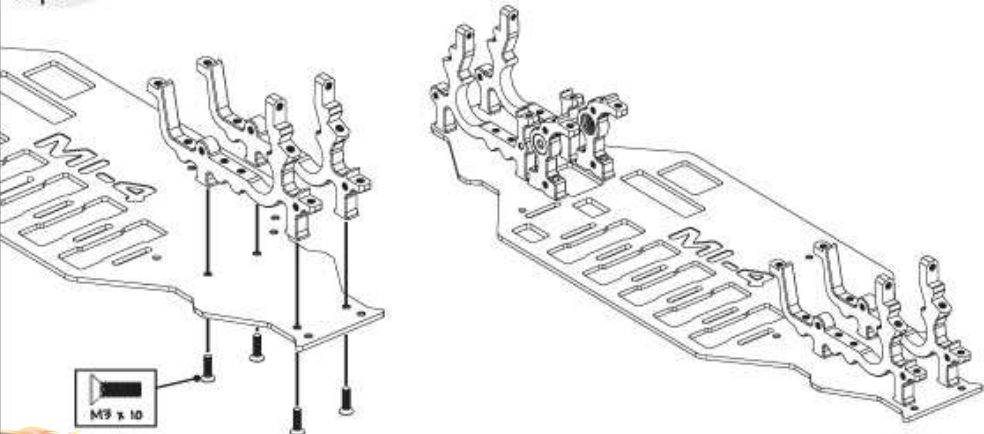



Step 4

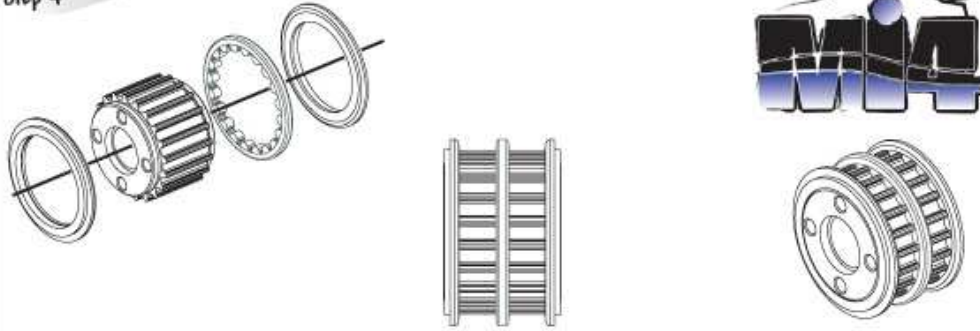

Step 5

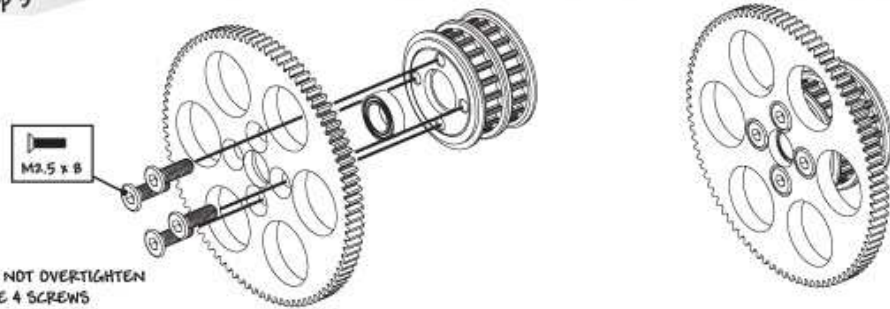

Step 6

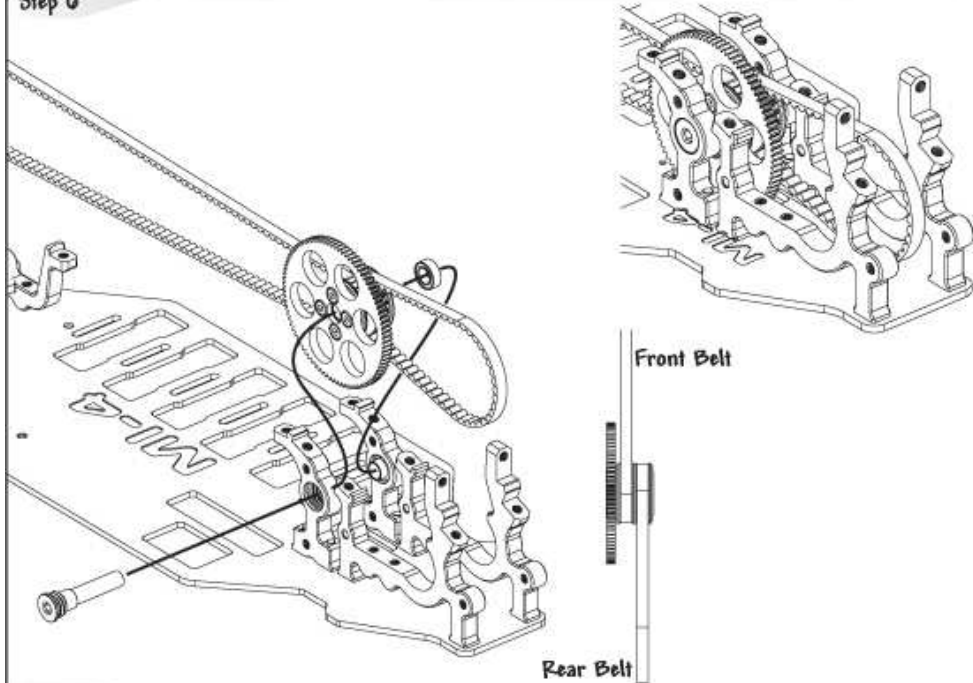

Step 7

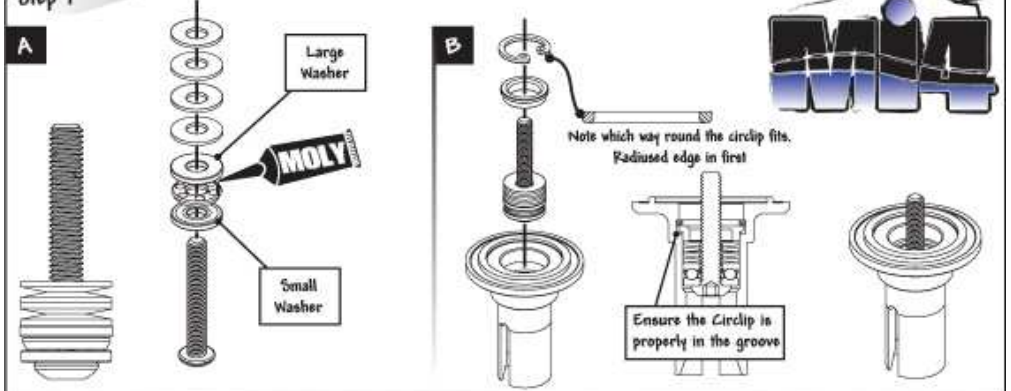

Step 8

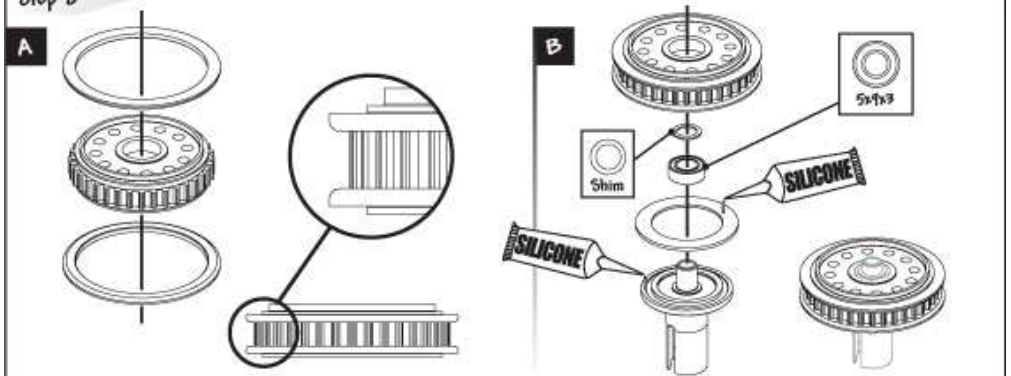

Step 9

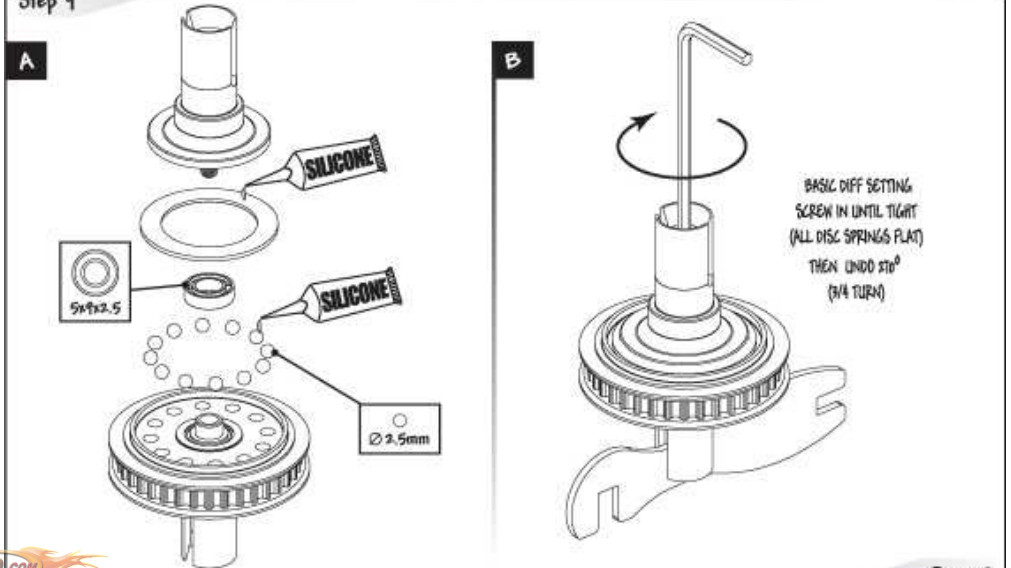

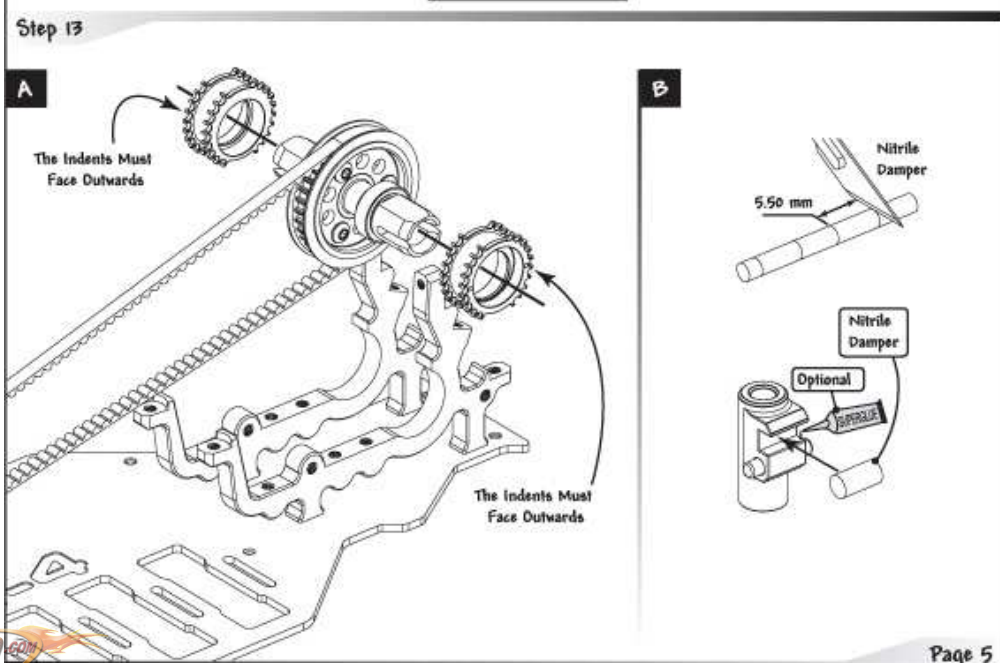
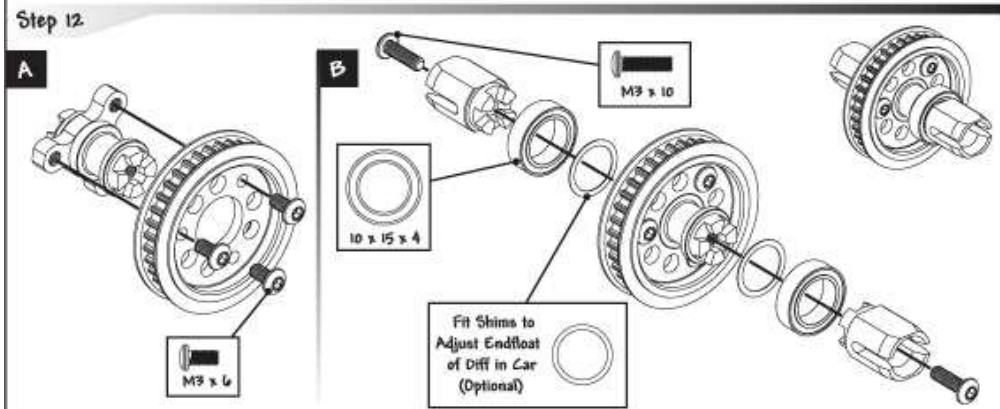
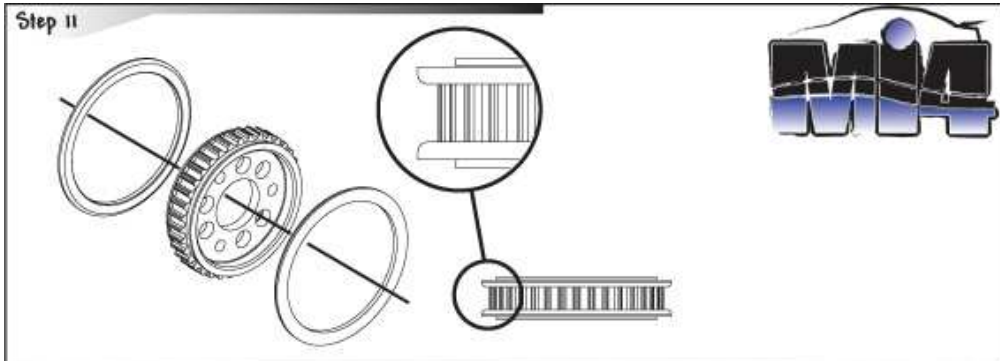
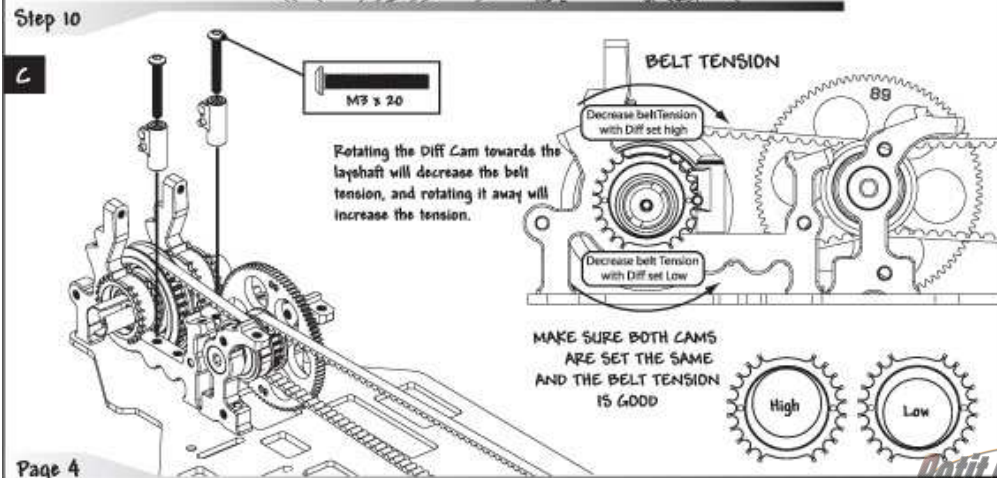
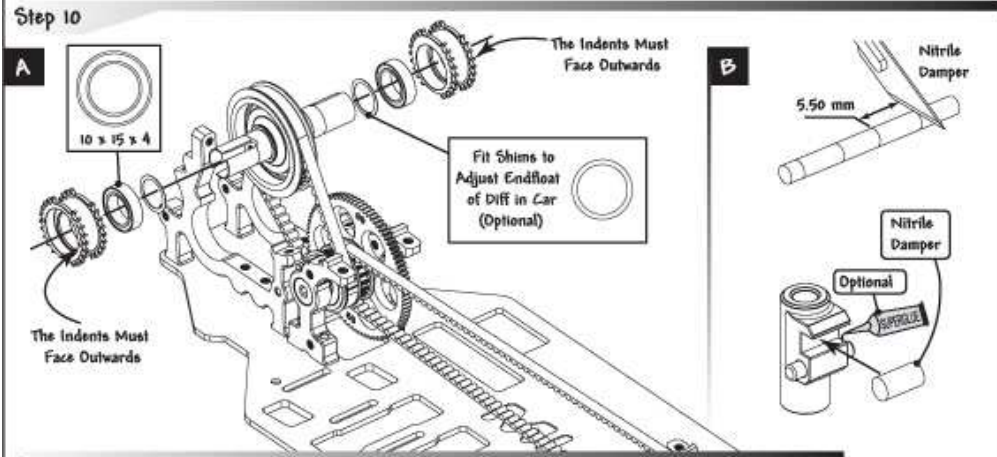
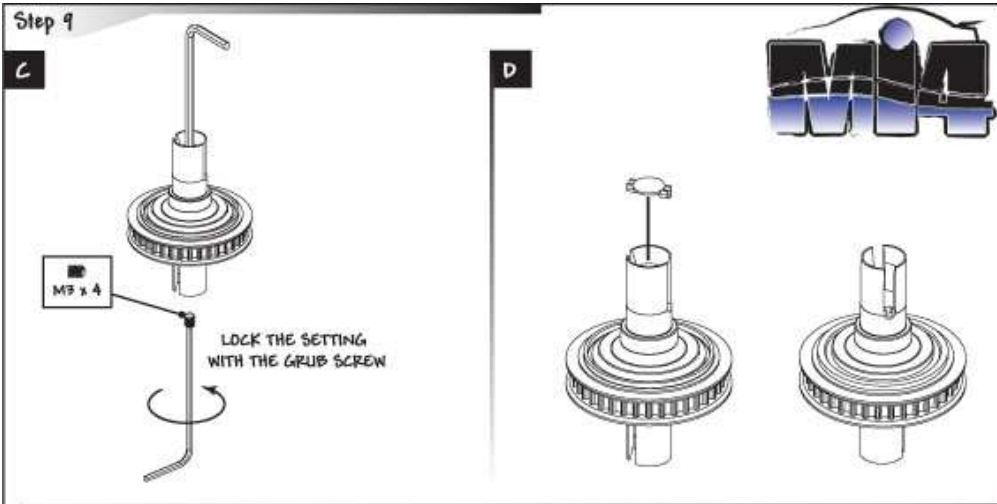



Step 13

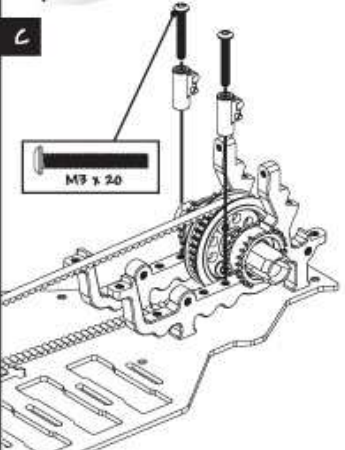

D

**BELT TENSION**

Rotating the Diff Cam towards the layshaft will decrease the belt tension, and rotating it away will increase the tension.

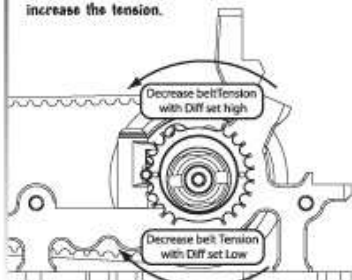

MAKE SURE BOTH CAMS ARE SET THE SAME AND THE BELT TENSION IS GOOD

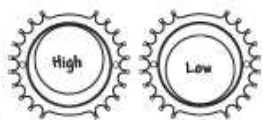

Step 14

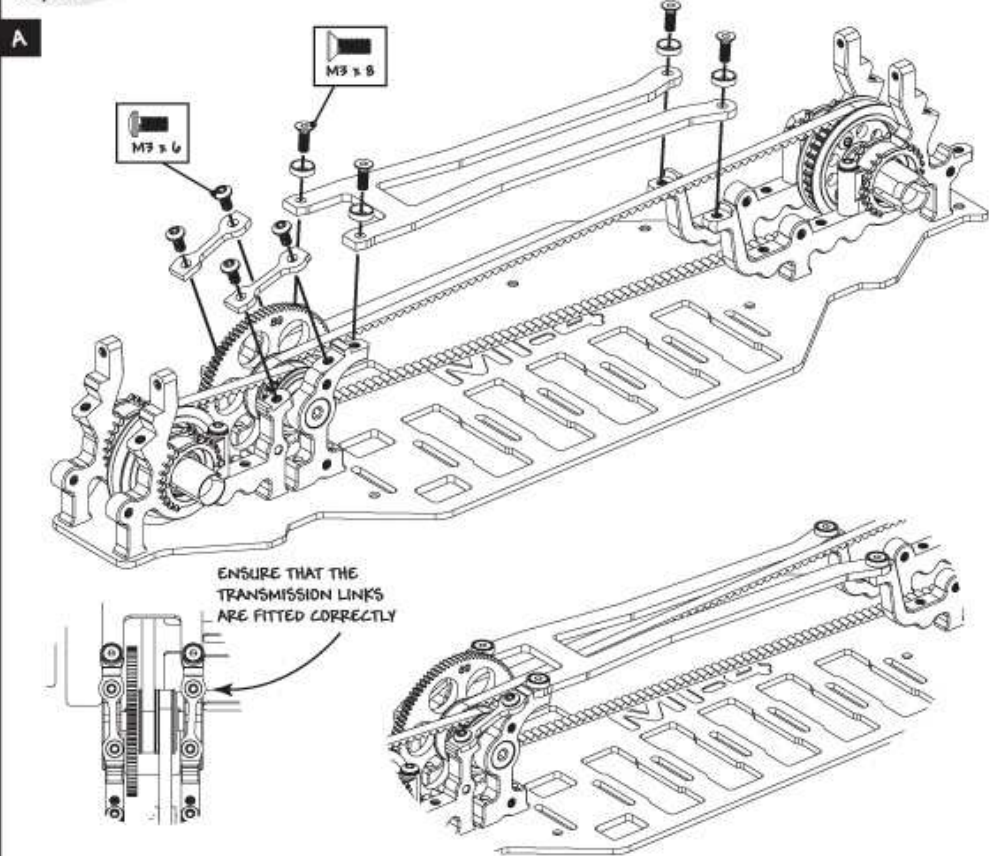

Step 15

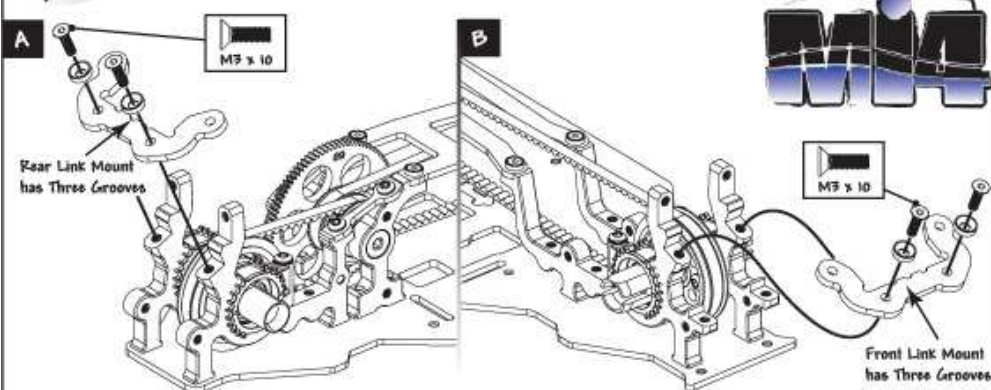

Step 16

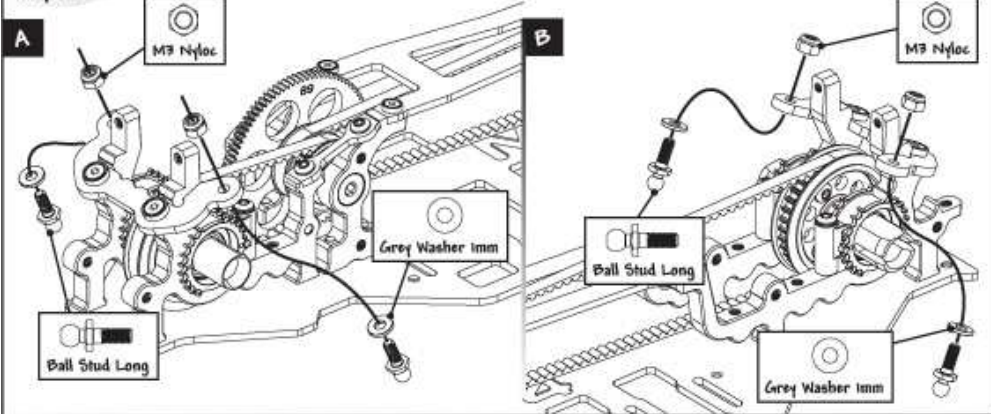

Step 17

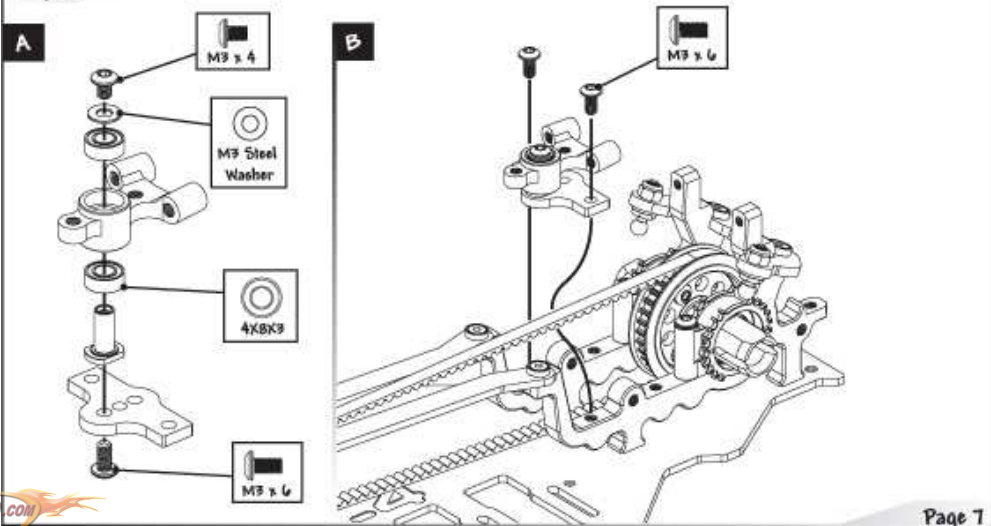



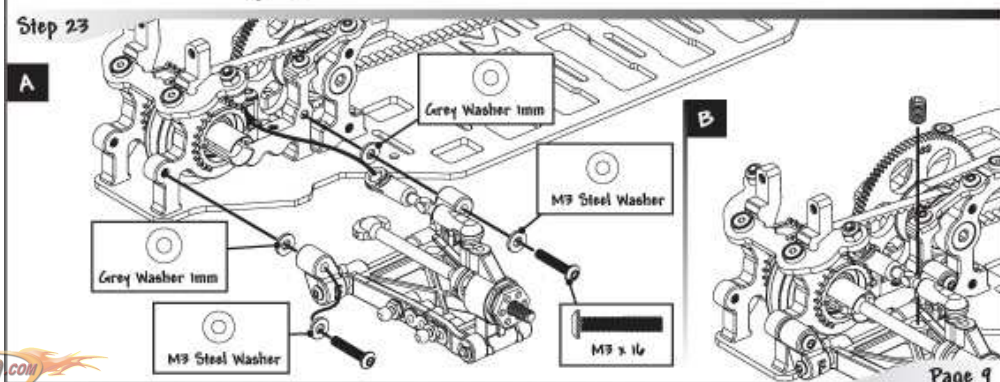
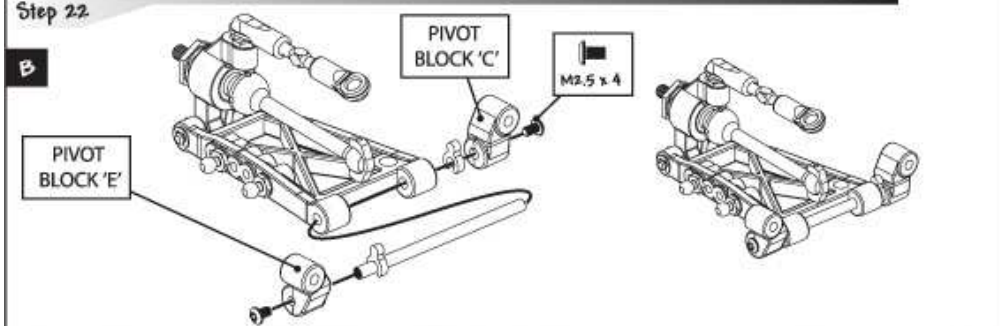
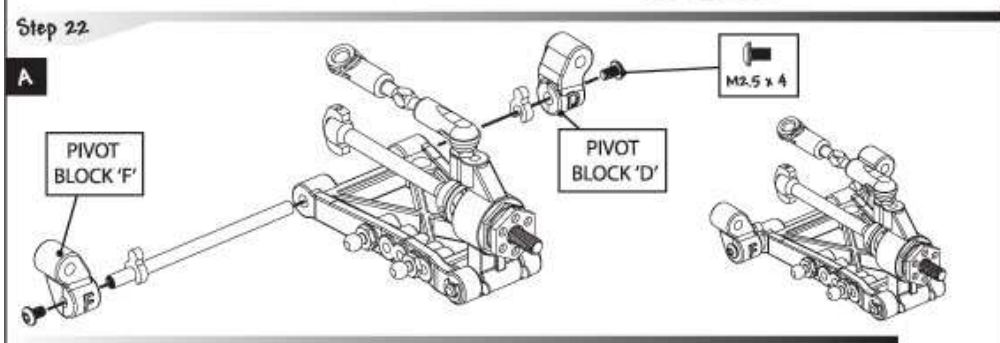
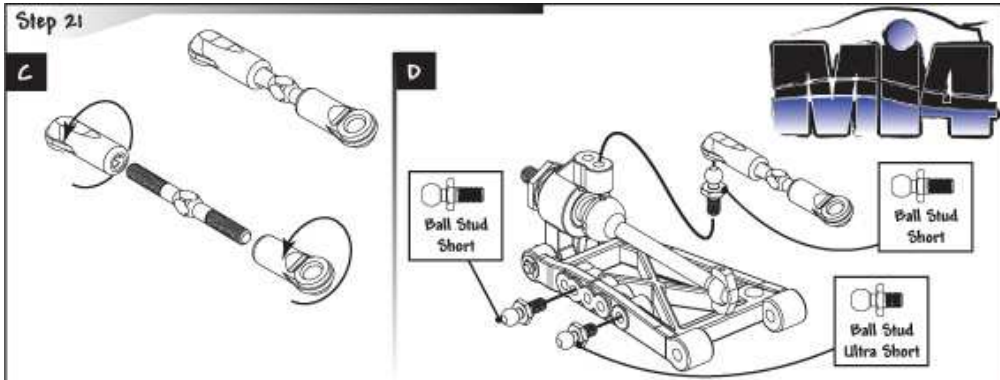
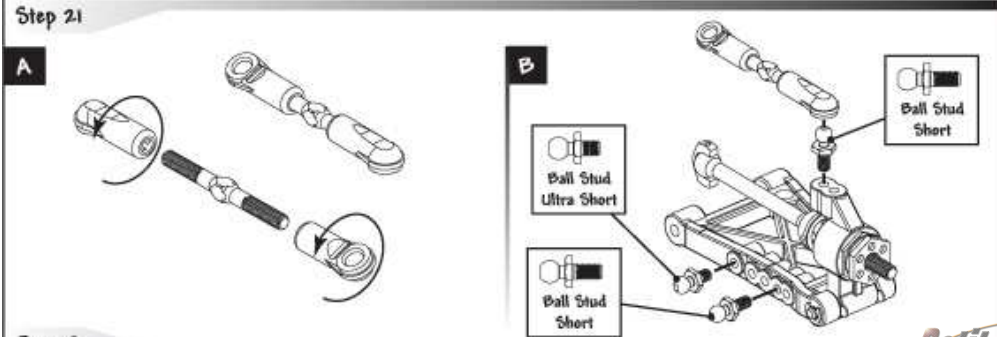
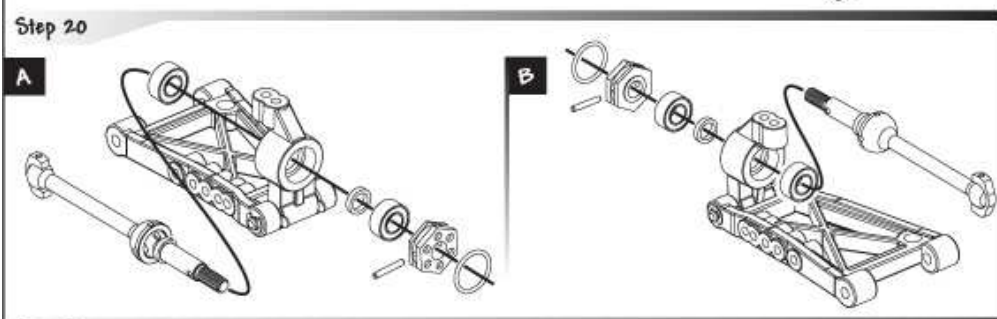
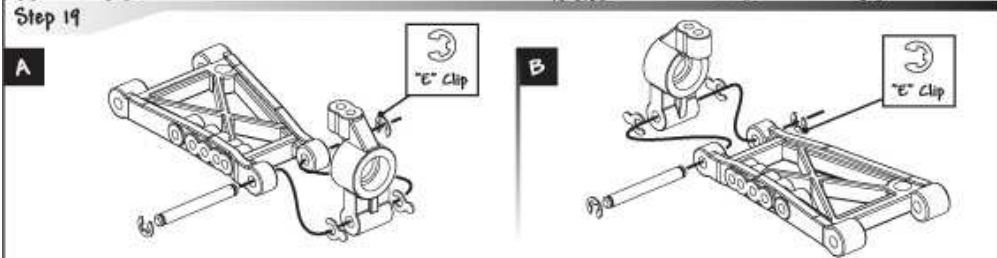
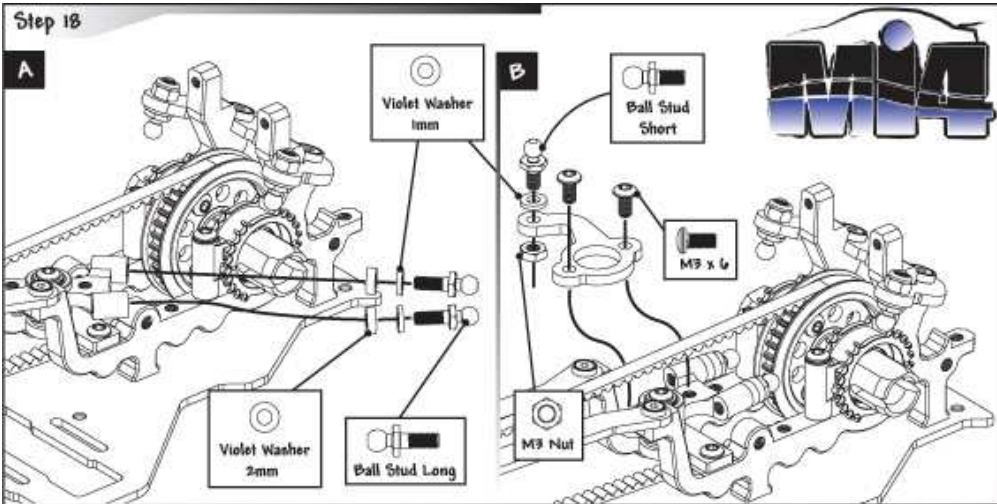

**Step 23**

**C**

Grey Washer 1mm

M3 Steel Washer

M3 x 16

M3 Steel Washer

**D**

Droop Stop Screw

**MIA**

Your suspension should rise and fall freely under its own weight. If it does not fall freely then the ball sockets may be a little tight on the ball studs, you should pinch the ball sockets with a pair of pliers, this will loosen the socket off slightly, and allow you to fine tune the fit.

**Step 24**

**A**

"E" Clip

**B**

**Step 24**

**C**

"E" Clip

**D**

**Step 25**

**A**

Use a washer to restrict steering lock and increase corner speed on outdoor tracks. very tight twisty tracks require more lock so the washer is not required.

Superglue

2mm Washer (Optional)

**Step 25**

**B**

Minimum Gap

Minimum Gap

**MIA**

**Step 26**

**A**

(Optional)

Superglue

2mm Washer

Use a washer to restrict steering lock and increase corner speed on outdoor tracks. very tight twisty tracks require more lock so the washer is not required.

**Step 26**

**B**

Minimum Gap

Minimum Gap

**Step 27**

**A**

Ball Stud Long

Ball Stud Long

Ball Stud Ultra Short

Ball Stud Short

Ball Stud Ultra Short

Ball Stud Short



Step 28

A

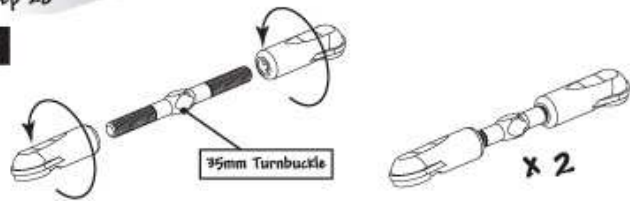

Step 28

B

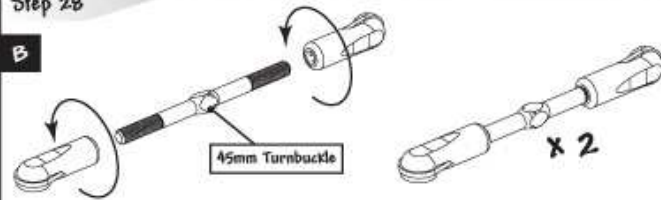

Step 28

C

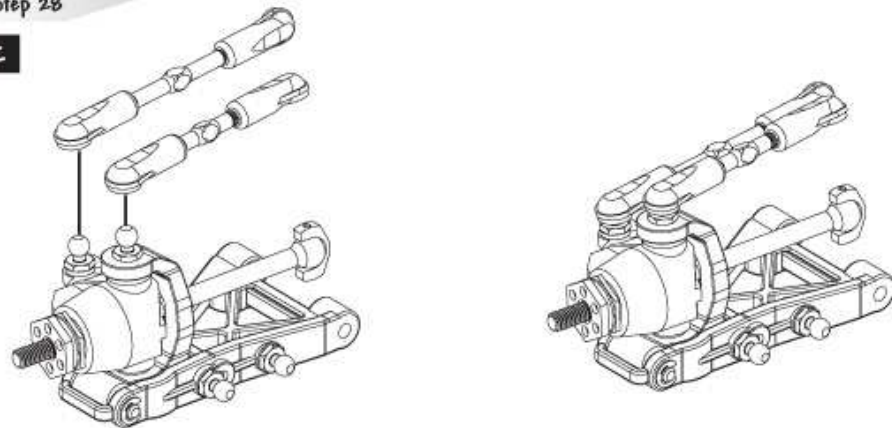

Step 28

d

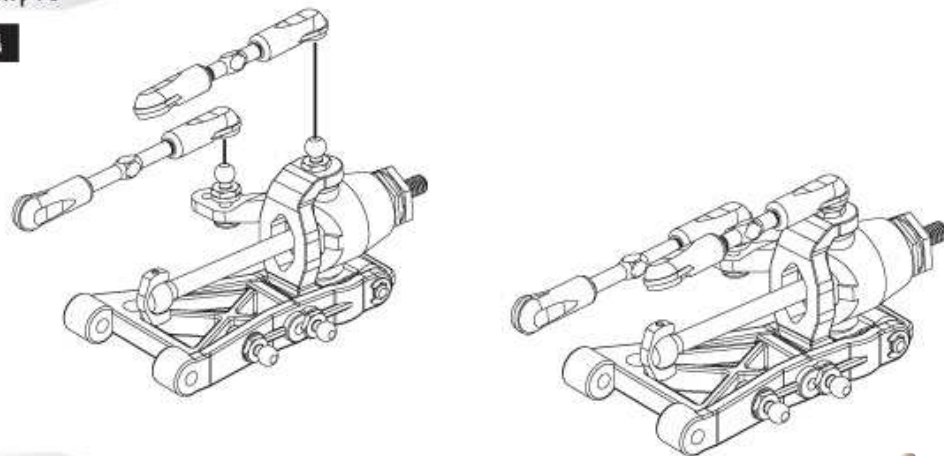

Step 29

A

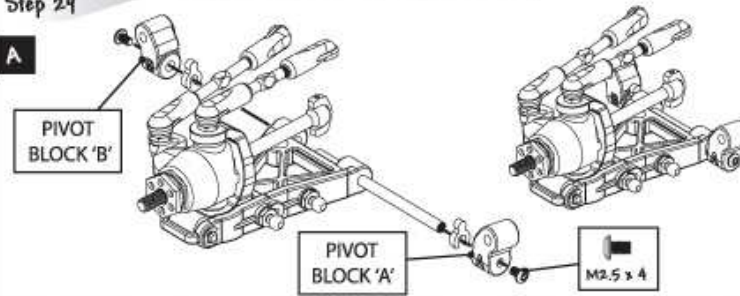

Step 29

B

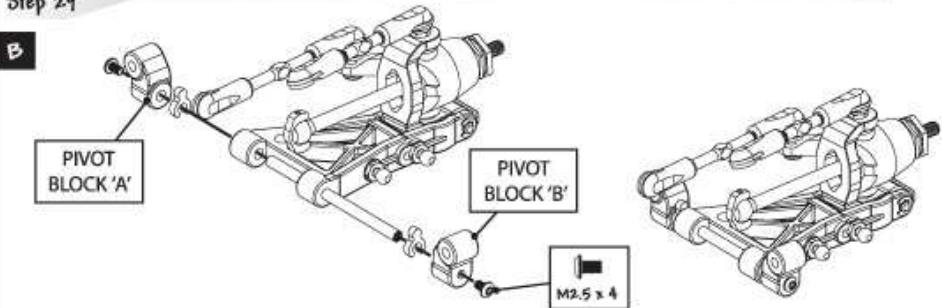

Step 30

A

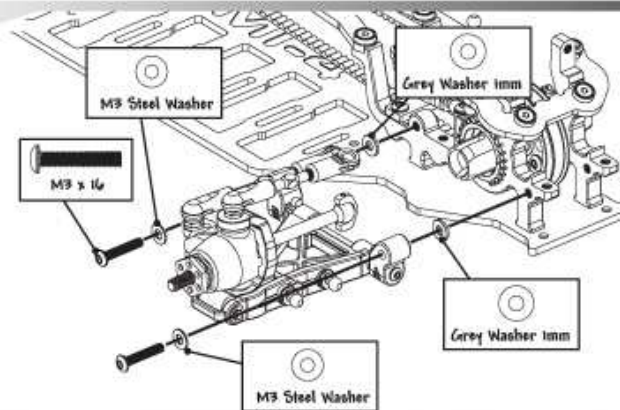

Step 30

B

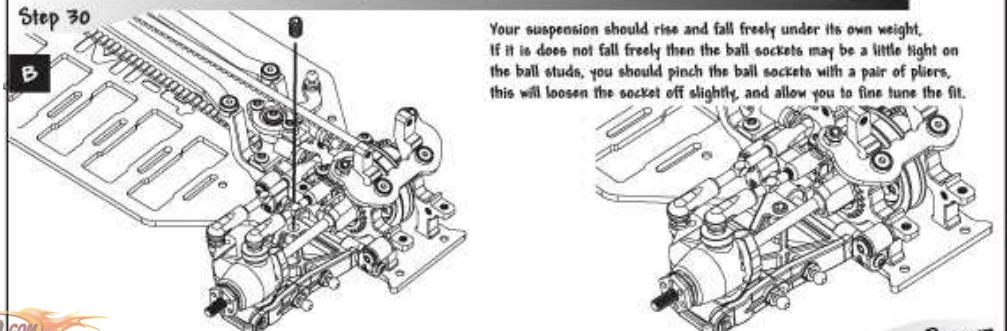

Your suspension should rise and fall freely under its own weight. If it does not fall freely then the ball sockets may be a little tight on the ball studs, you should pinch the ball sockets with a pair of pliers, this will loosen the socket off slightly, and allow you to fine tune the fit.



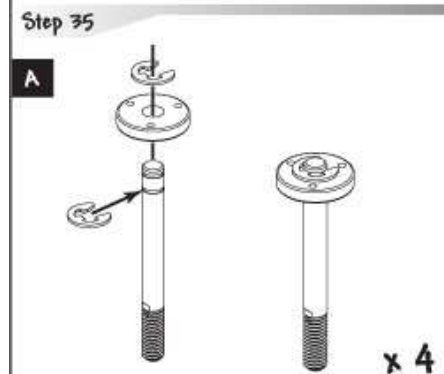
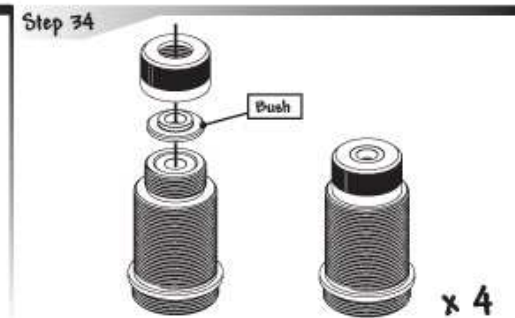
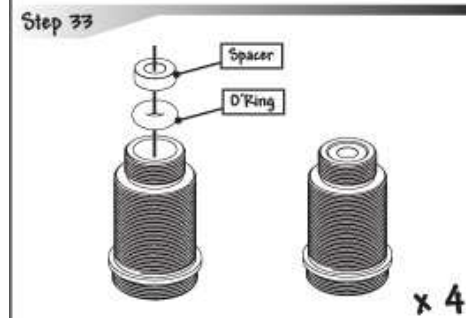
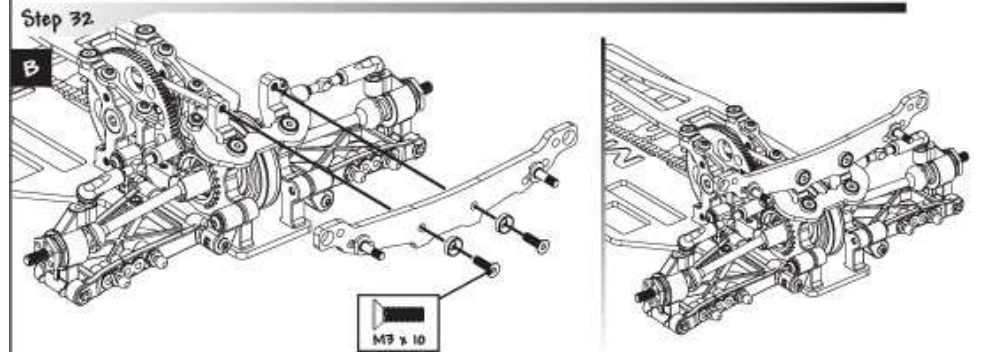
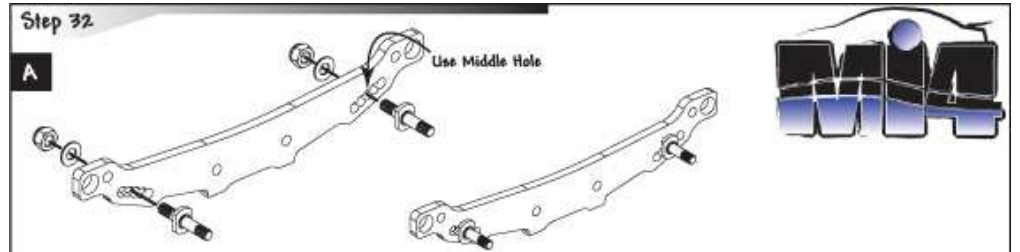
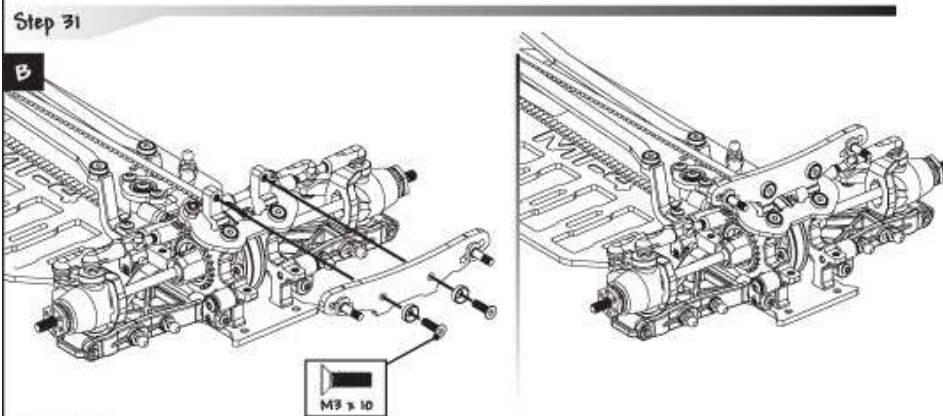
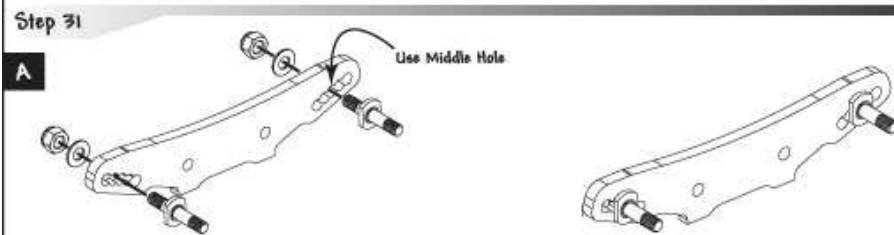
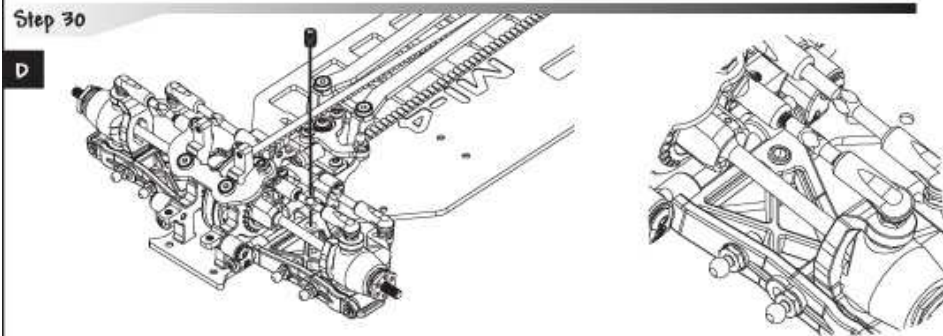
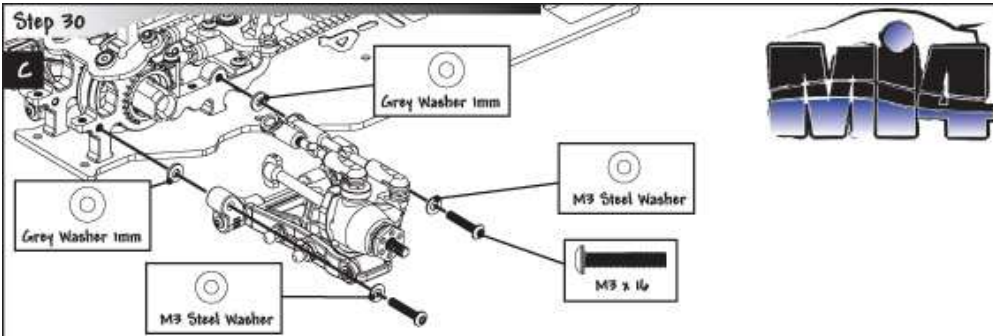

Step 36

A

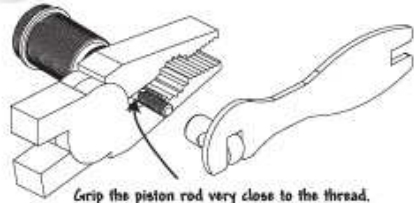

Grip the piston rod very close to the thread.  
BE CAREFUL NOT TO DAMAGE  
THE POLISHED SHOCK ROD.



x 4



Step 36

B



Fill Slowly with Shock Oil  
until Domed. Move Piston  
Up and Down Slowly  
and Allow all Air  
Bubbles to Rise  
and disappear.

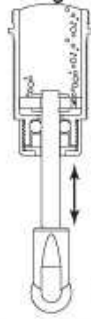

x 4

C



x 4

D

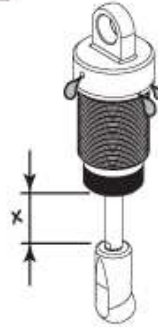

x 4

Adjust this distance (x) to suit the amount  
of rebound you want

Step 37

A

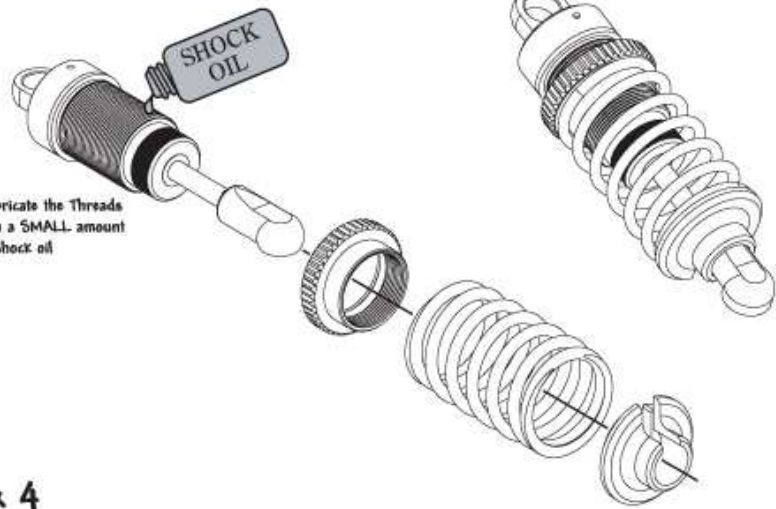

Lubricate the Threads  
with a SMALL amount  
of shock oil



x 4

Step 38

A

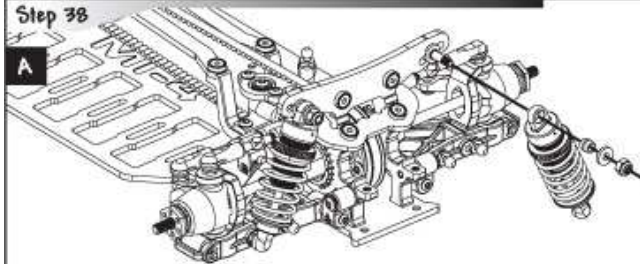

Step 38

B

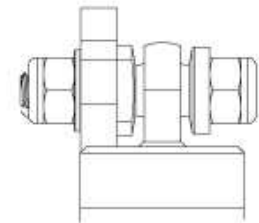
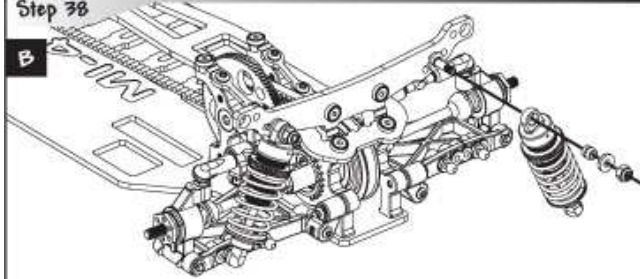

Step 39

A

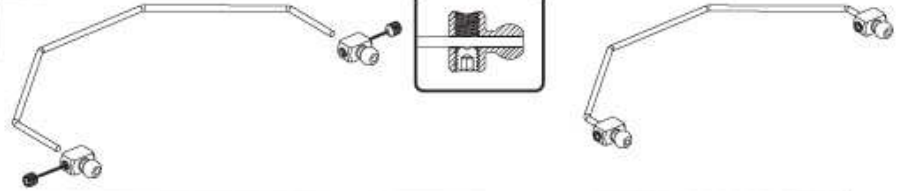

Step 39

B

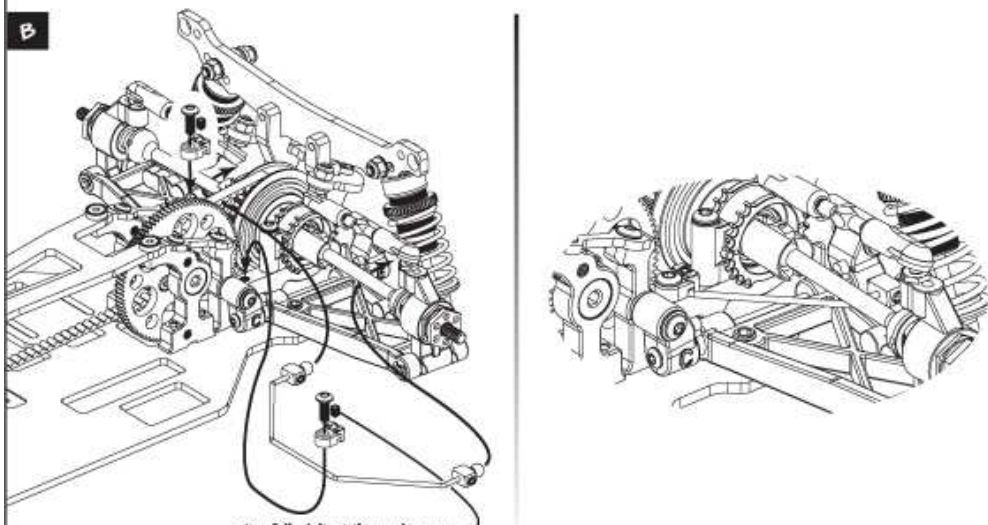

Carefully Adjust the grub screw  
to eliminate roll bar play



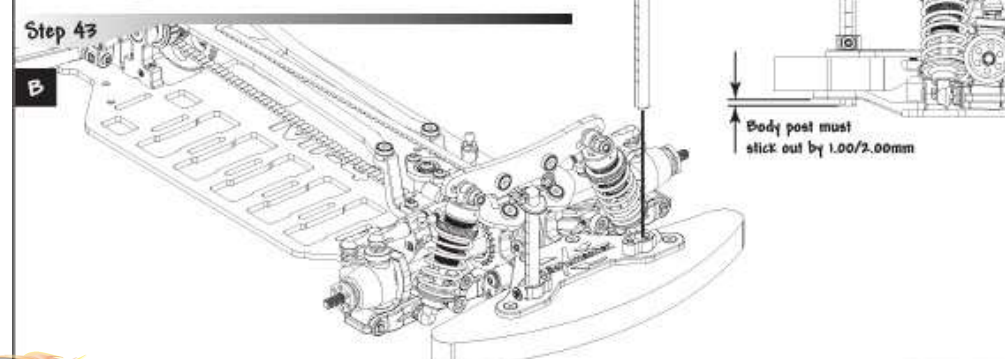
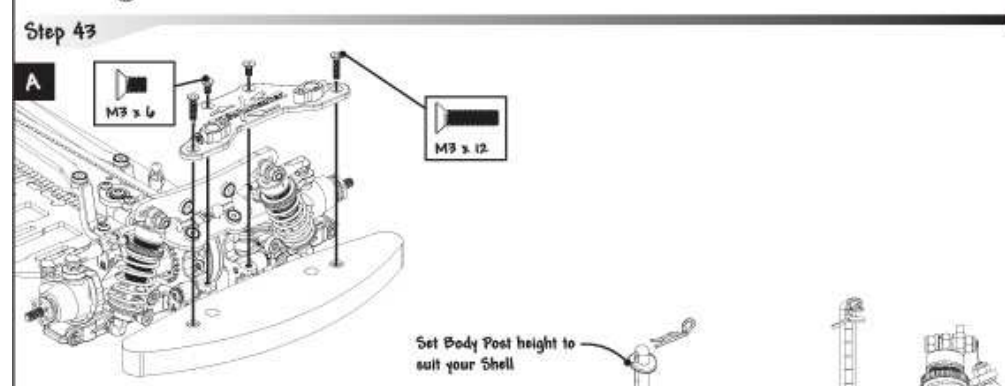
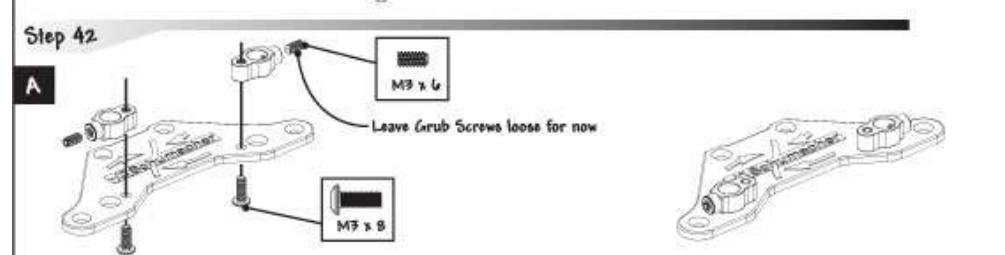
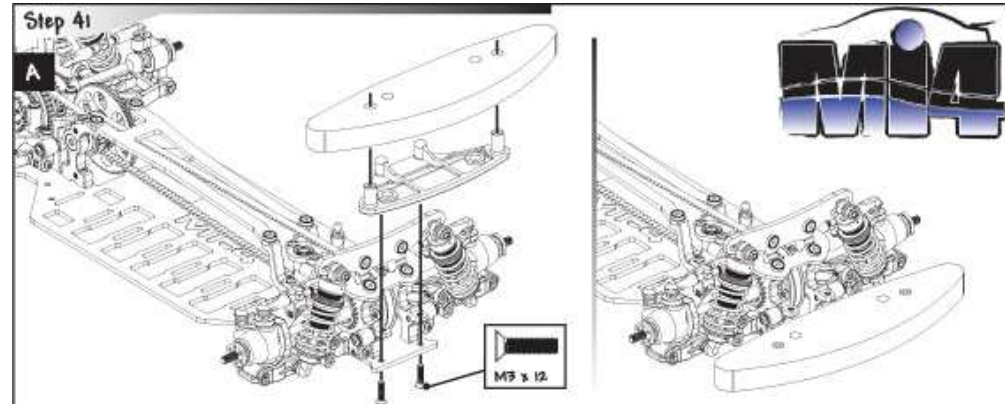
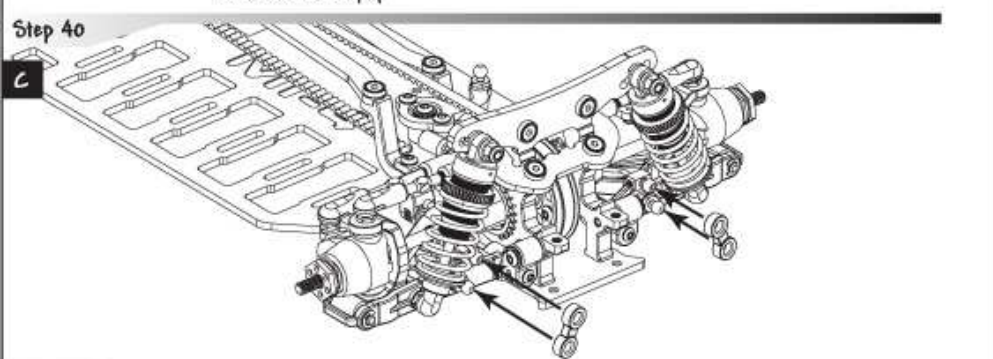
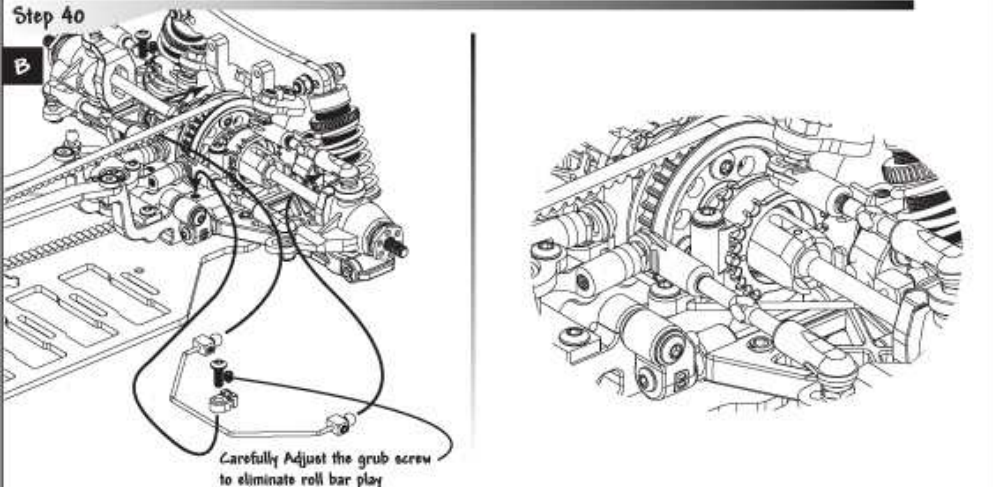
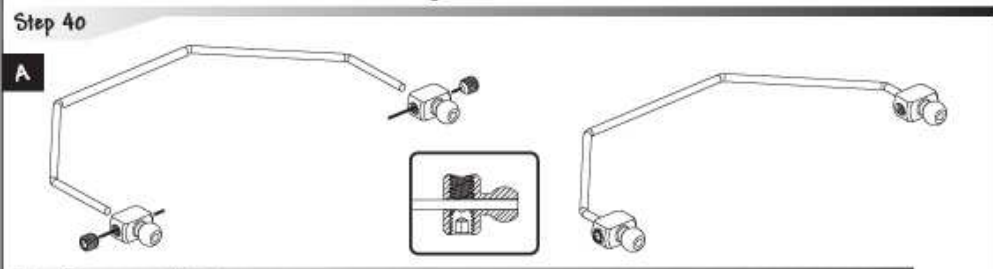
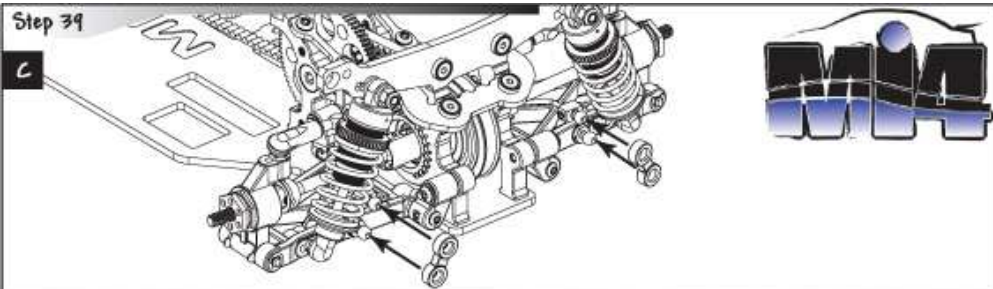

Step 44

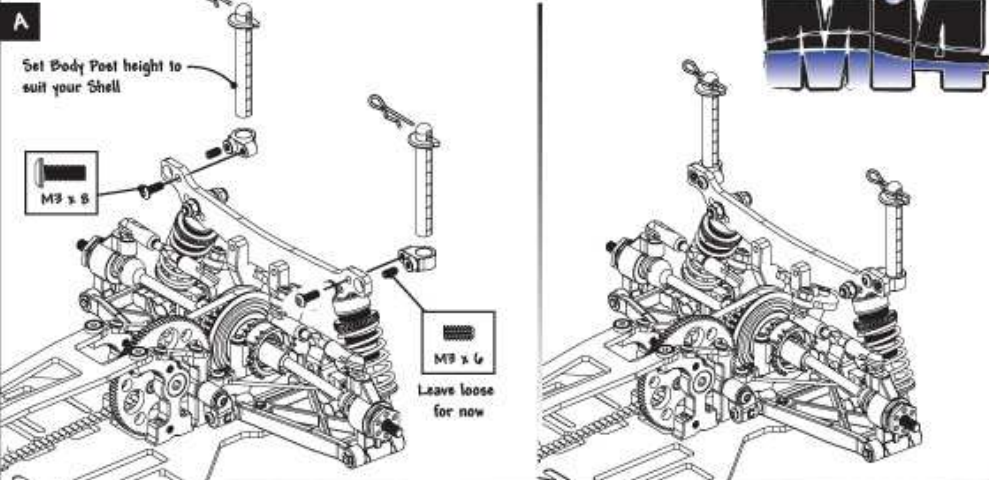

Step 45

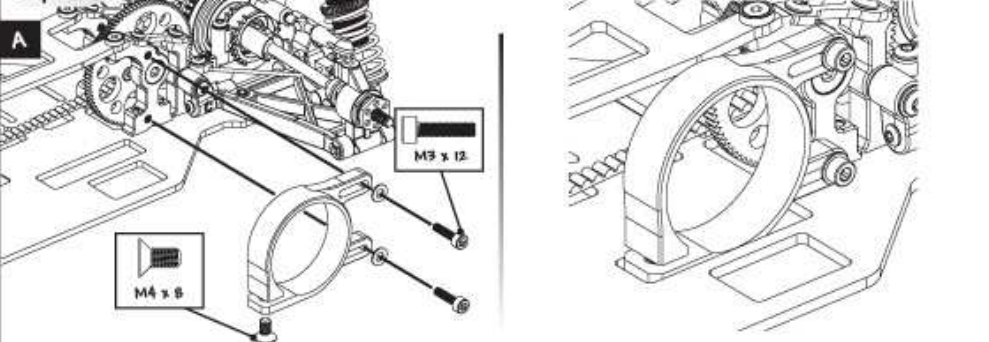

Step 46

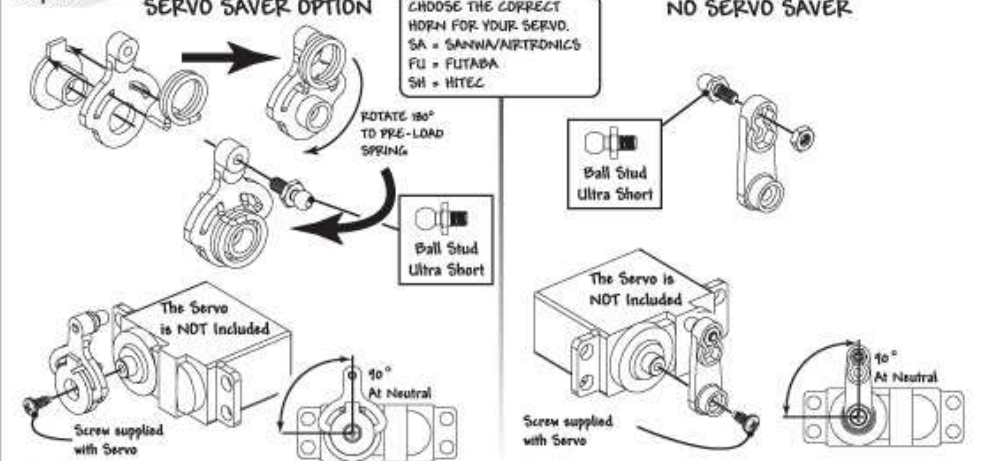

Step 47

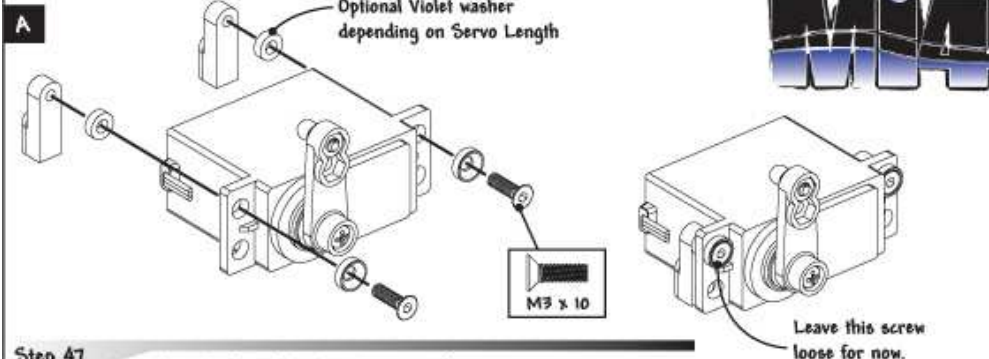

Step 47

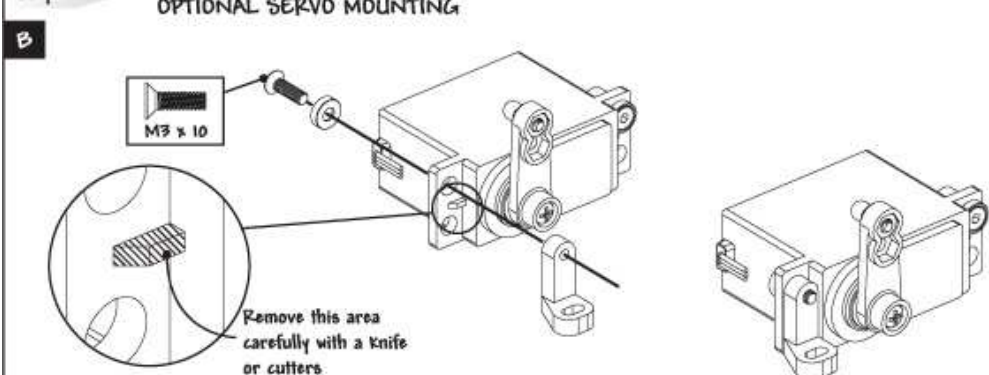

Step 48

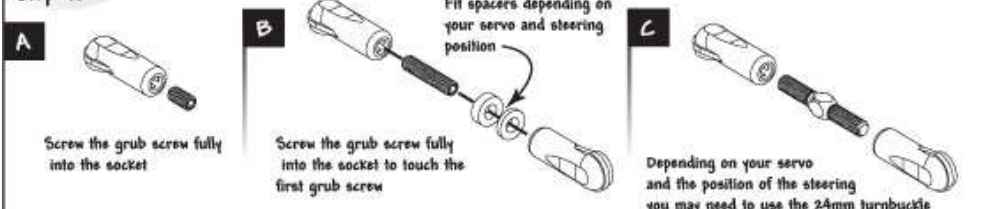

Step 48

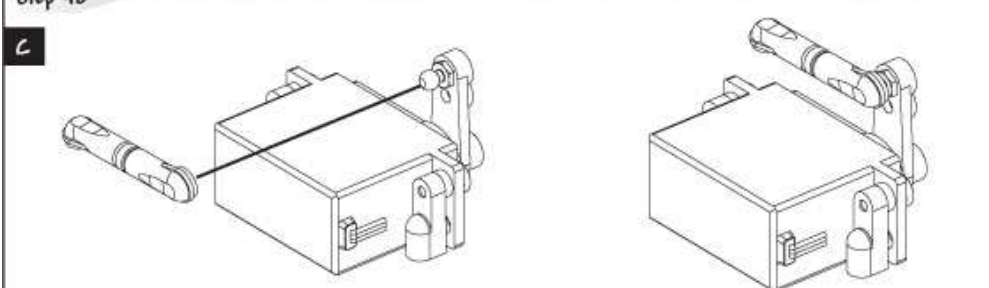



Step 49

A

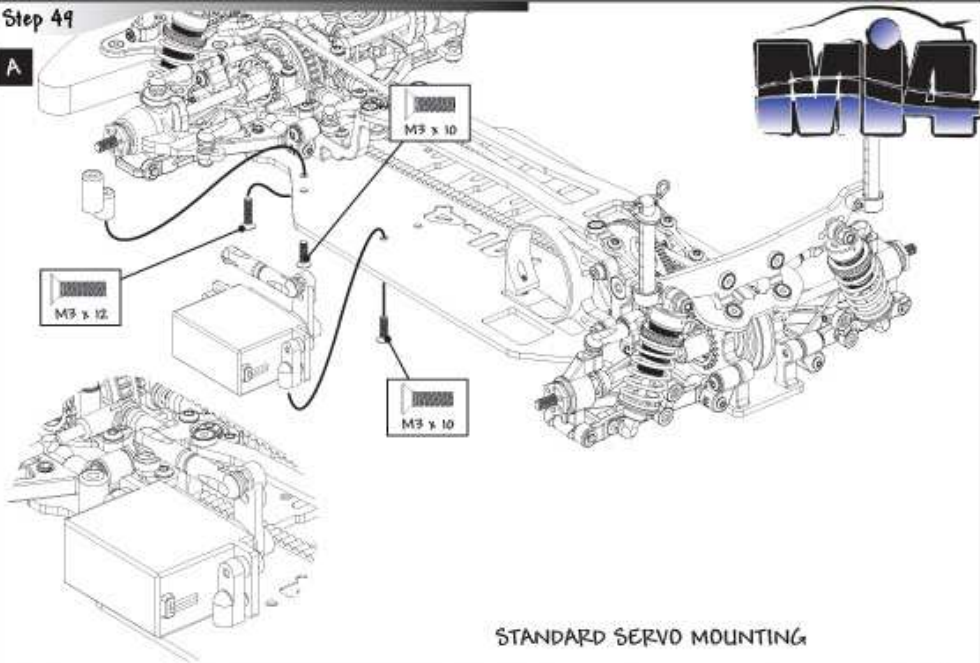

STANDARD SERVO MOUNTING

Step 49

B

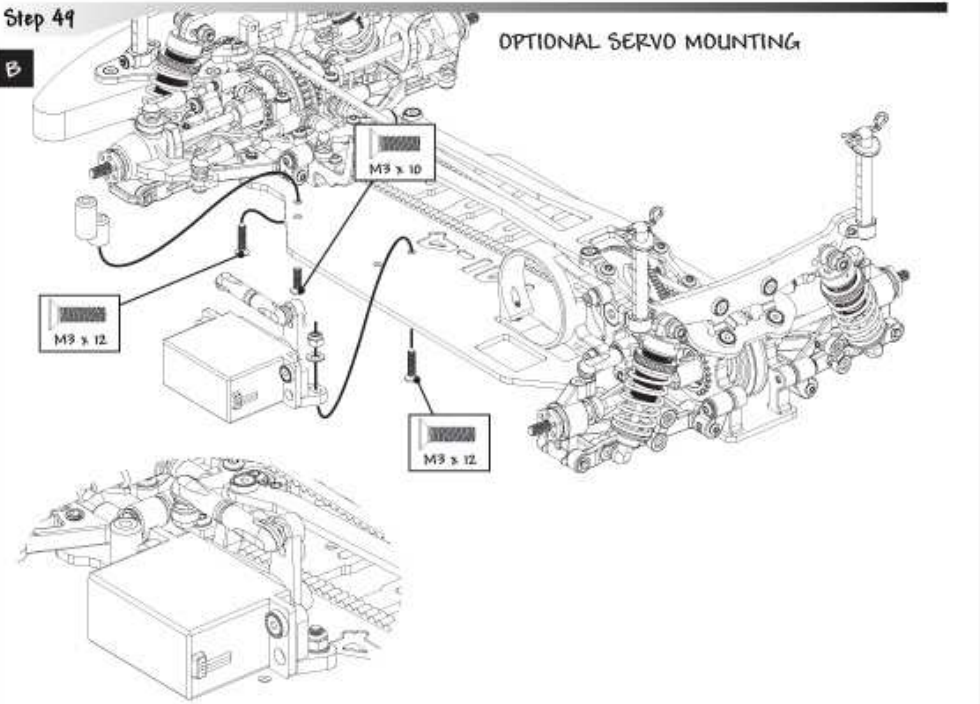

OPTIONAL SERVO MOUNTING

Step 49

C

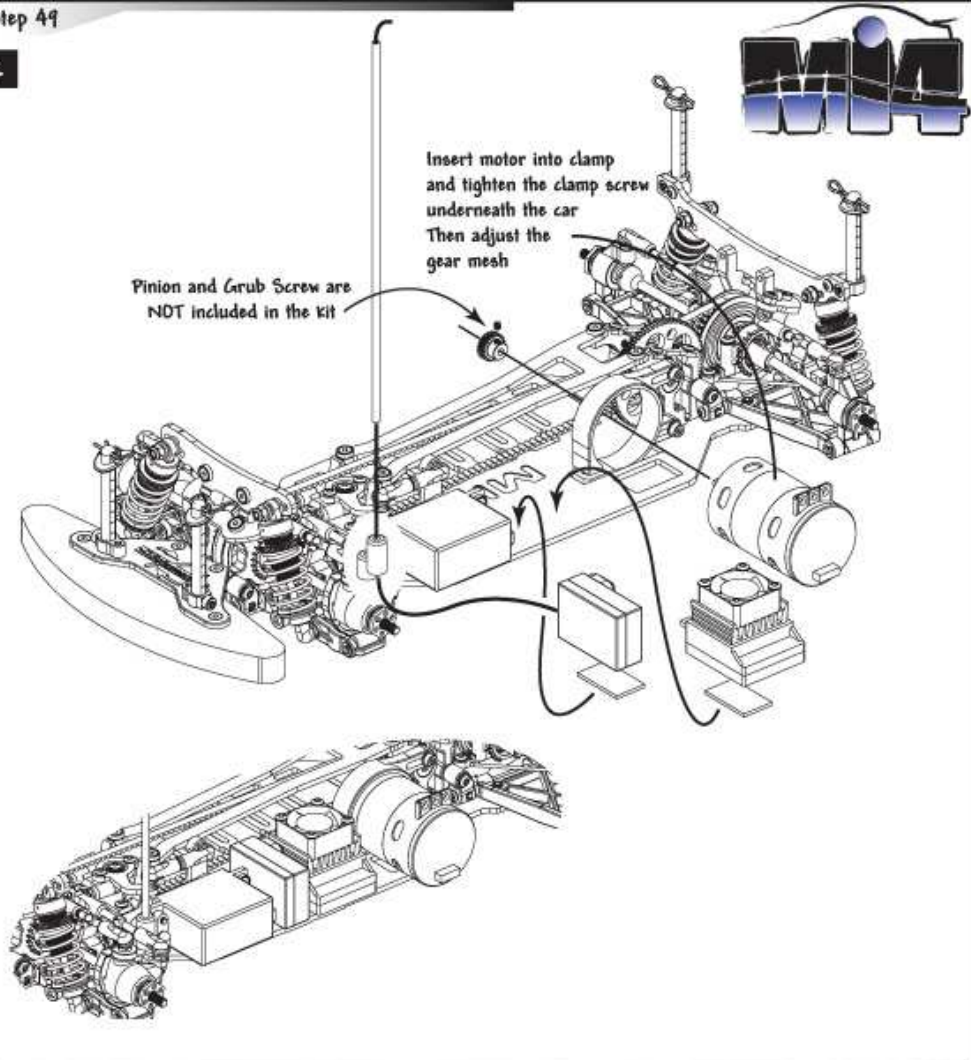

Step 50

A

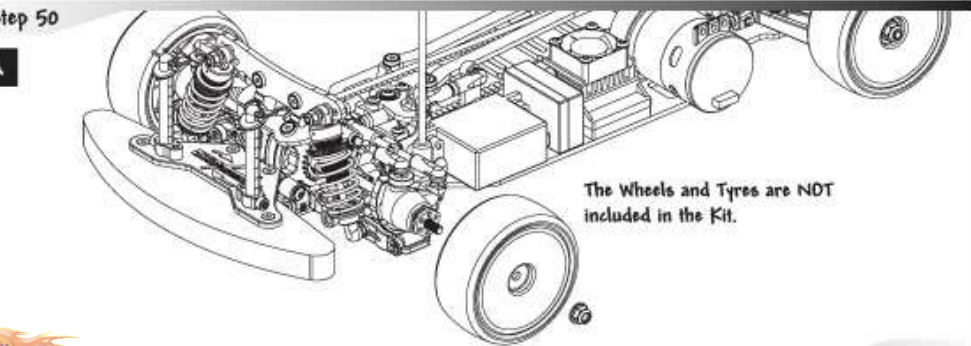

### Battery Installation 5 Cell NiMH

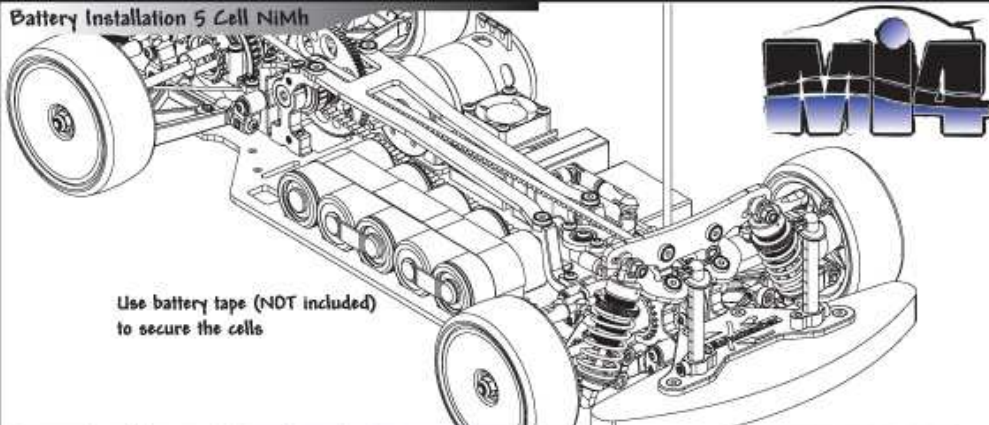

Use battery tape (NOT included) to secure the cells

### Battery Installation LiPo's with Nimh Humps

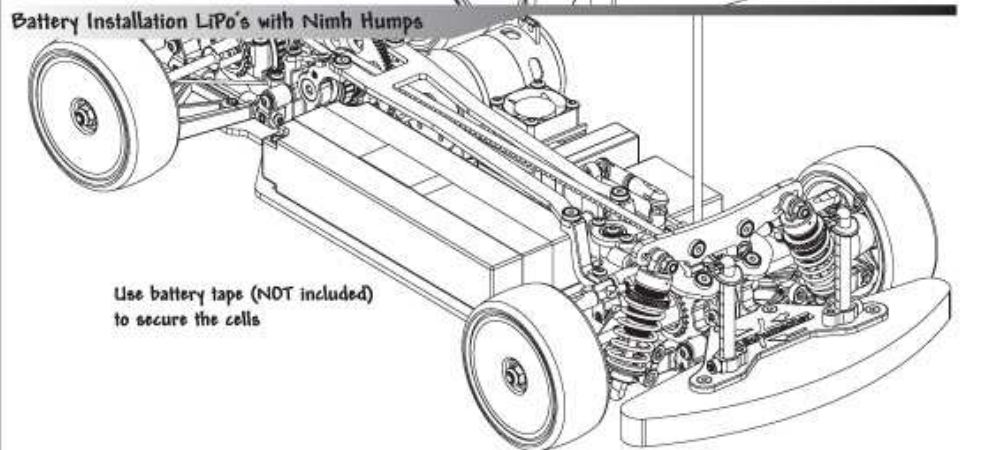

Use battery tape (NOT included) to secure the cells

### Battery Installation LiPo's without NiMH Humps

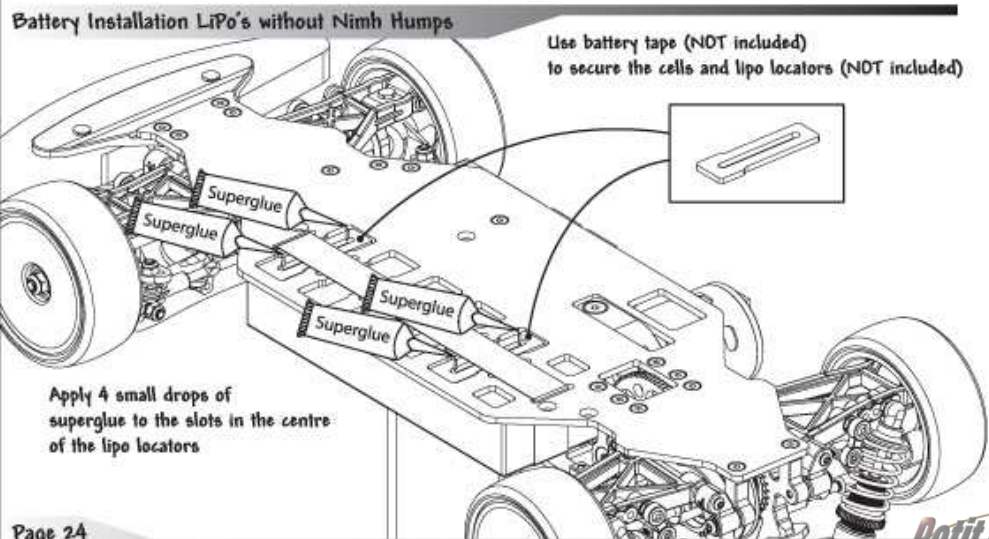

Use battery tape (NOT included) to secure the cells and lipo locators (NOT included)

Apply 4 small drops of superglue to the slots in the centre of the lipo locators

### Optional One Way U3518

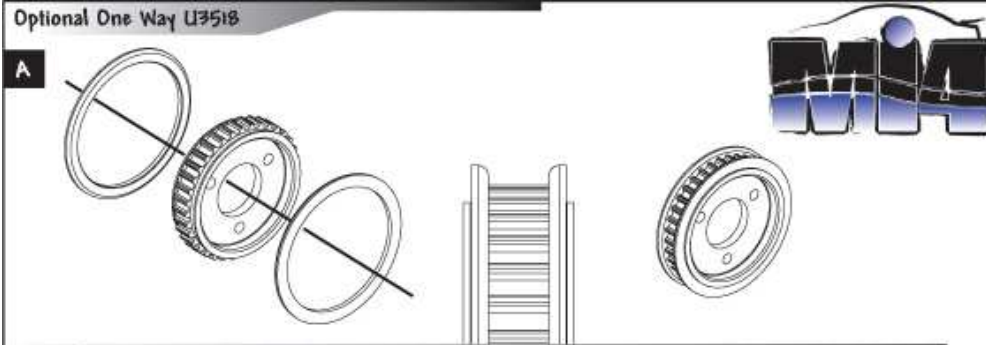

### Optional One Way U3518

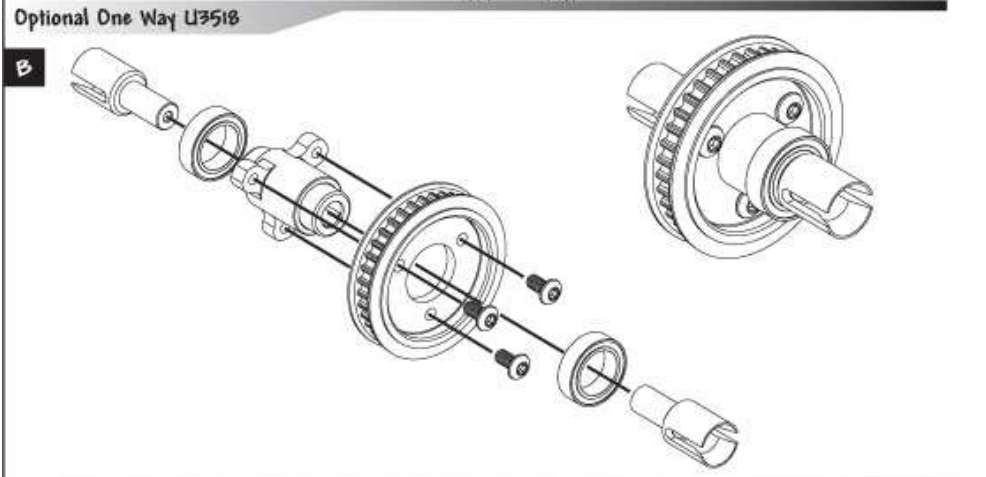

### Optional Alloy Suspension Blocks U3517

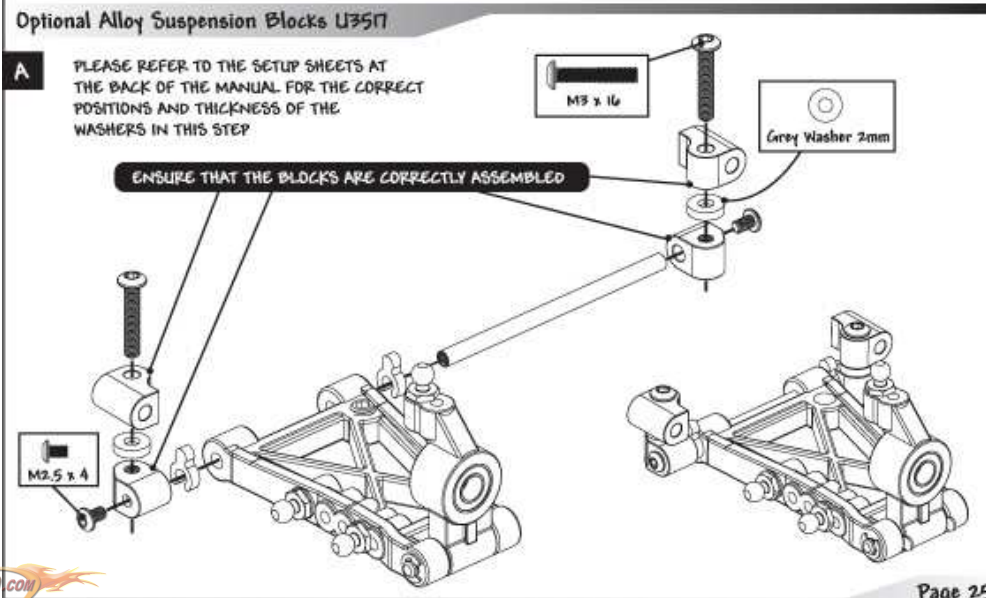



Optional Alloy Suspension Blocks U3517

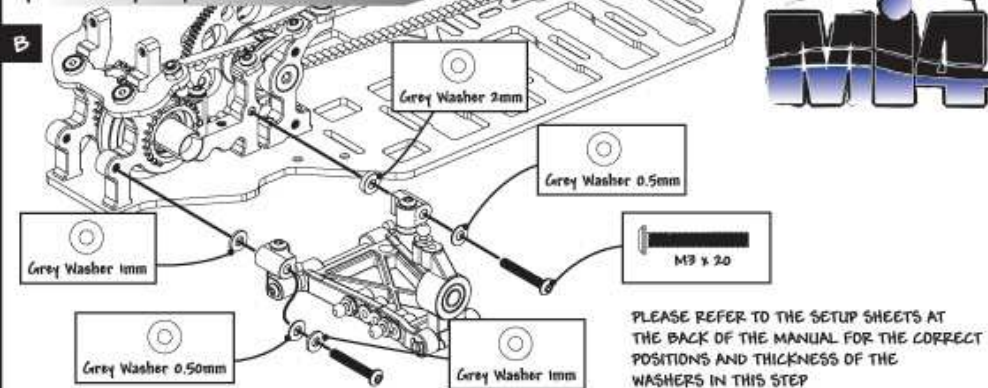

Optional Alloy Suspension Blocks U3517

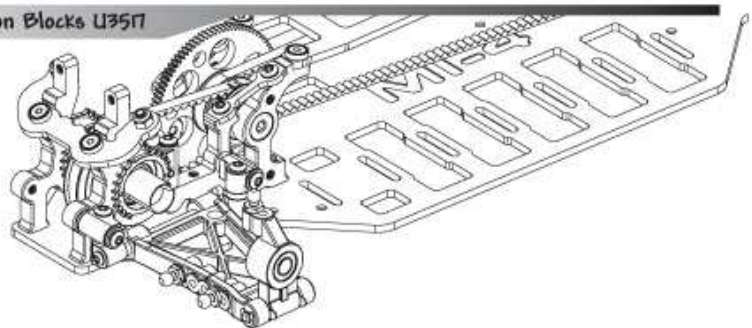

Optional Alloy Suspension Blocks U3517

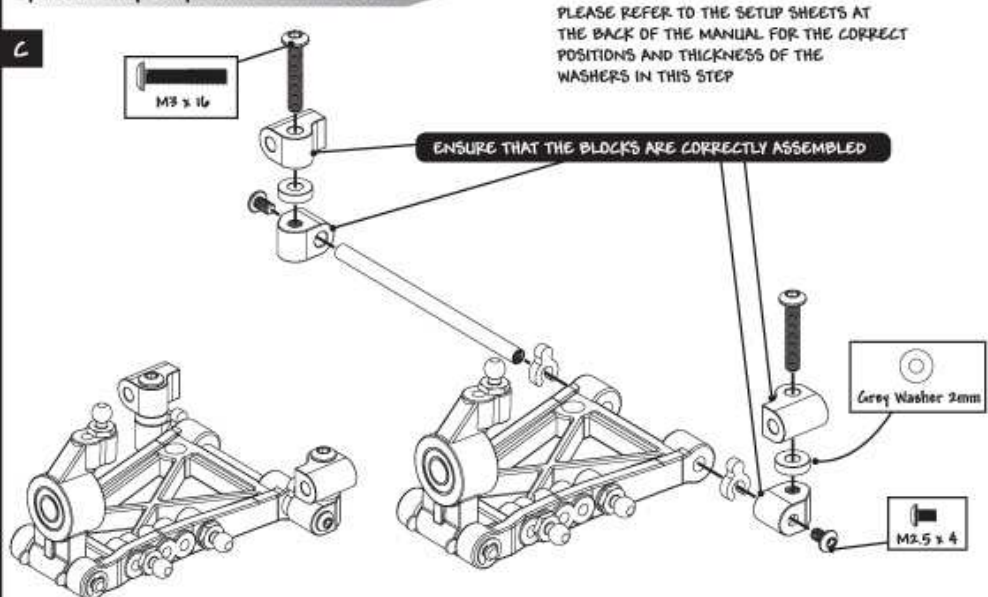

Optional Alloy Suspension Blocks U3517

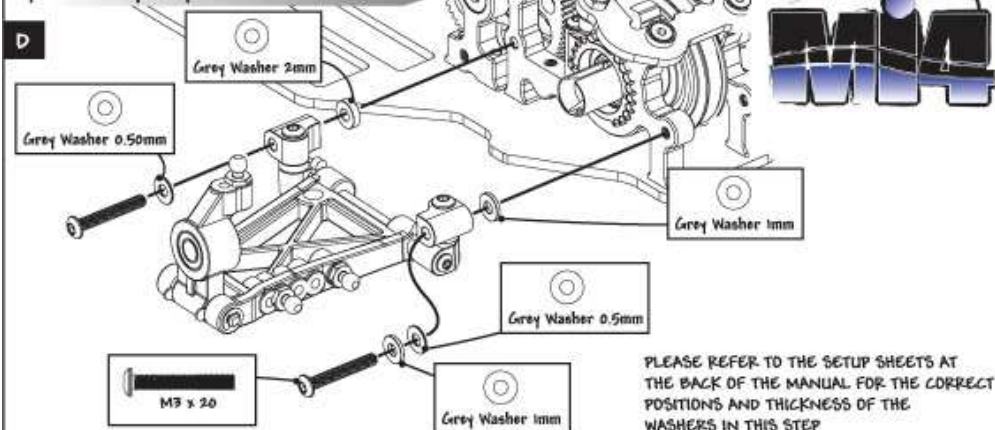

Optional Alloy Suspension Blocks U3517

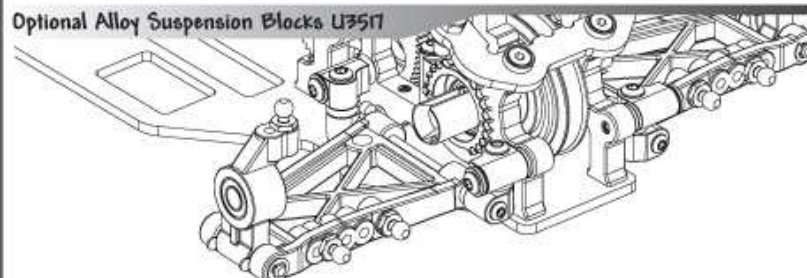

Optional Alloy Suspension Blocks U3517

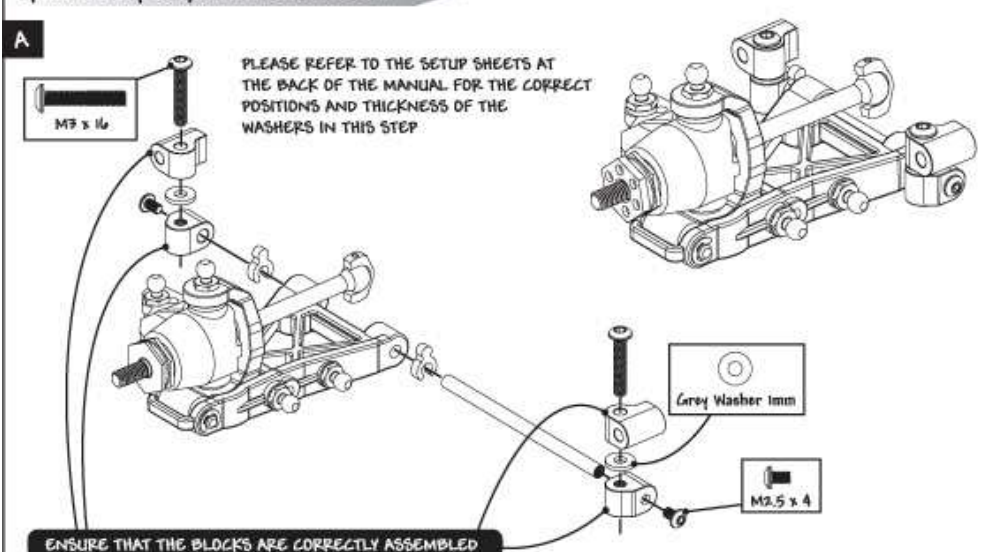



### Optional Alloy Suspension Blocks U3517

**B**

PLEASE REFER TO THE SETUP SHEETS AT THE BACK OF THE MANUAL FOR THE CORRECT POSITIONS AND THICKNESS OF THE WASHERS IN THIS STEP

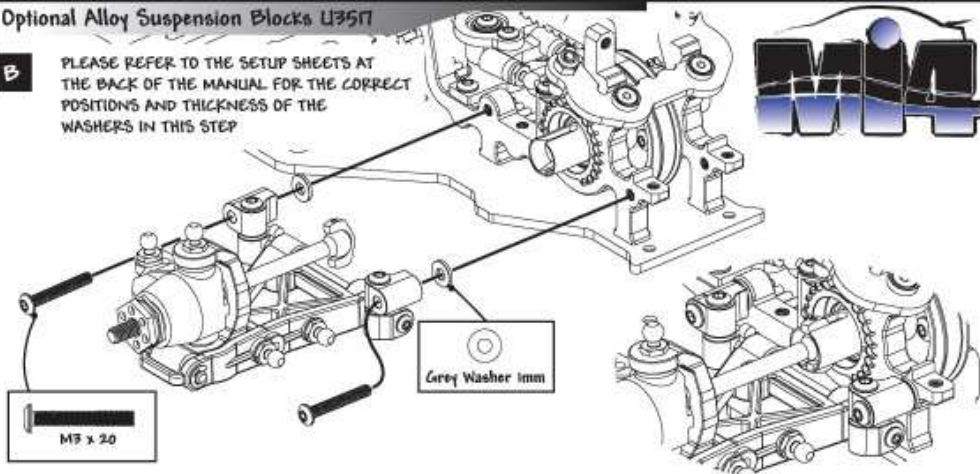

### Optional Alloy Suspension Blocks U3517

**C**

PLEASE REFER TO THE SETUP SHEETS AT THE BACK OF THE MANUAL FOR THE CORRECT POSITIONS AND THICKNESS OF THE WASHERS IN THIS STEP

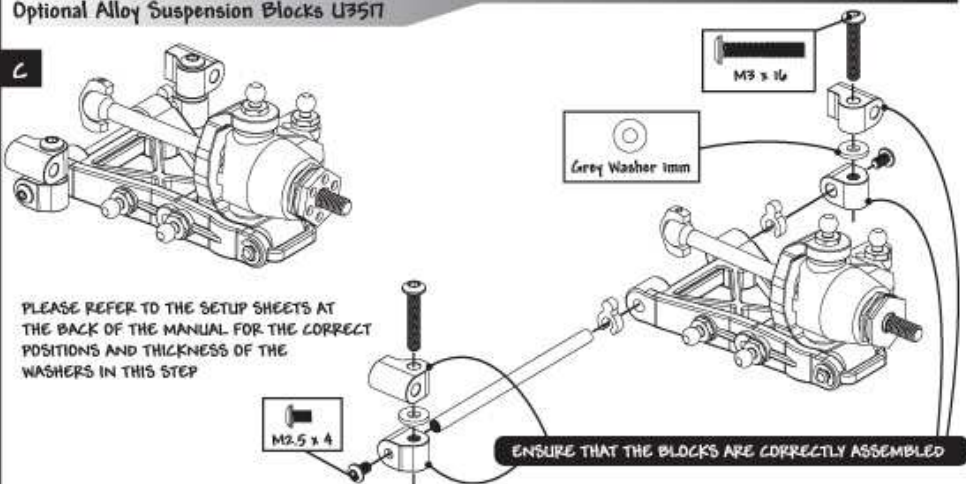

### Optional Alloy Suspension Blocks U3517

**D**

PLEASE REFER TO THE SETUP SHEETS AT THE BACK OF THE MANUAL FOR THE CORRECT POSITIONS AND THICKNESS OF THE WASHERS IN THIS STEP

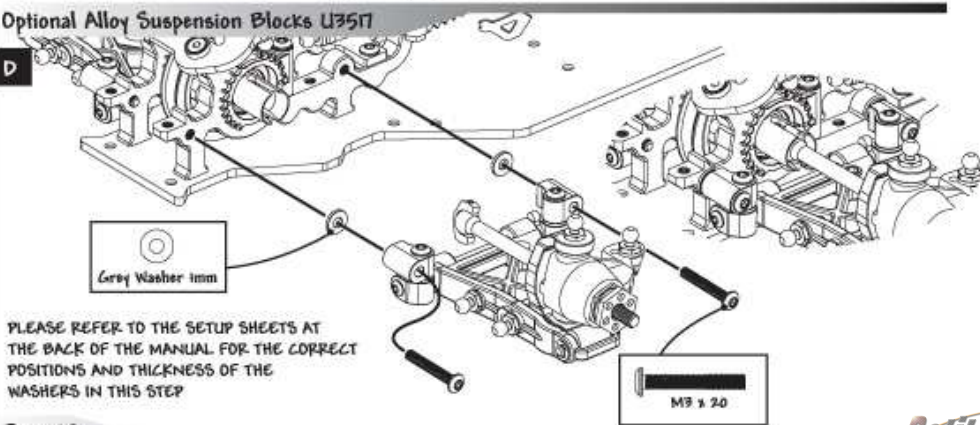

### Optional Battery Strap and Posts U3513

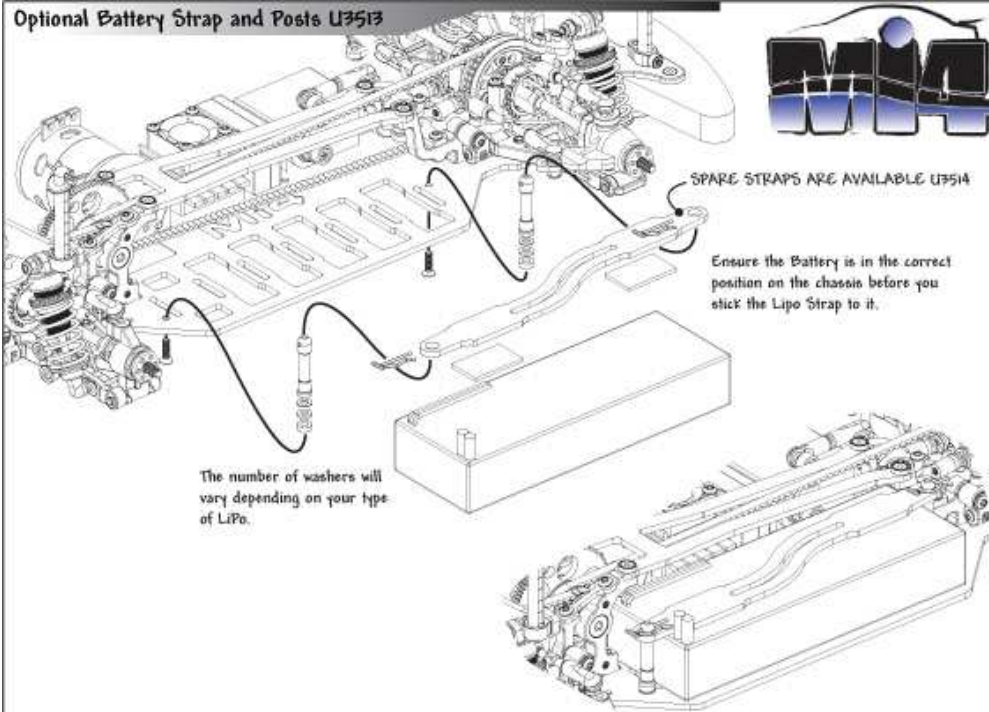

The number of washers will vary depending on your type of LiPo.

### Optional Battery Strap and Posts U3513 + LiPo Retainer U3516

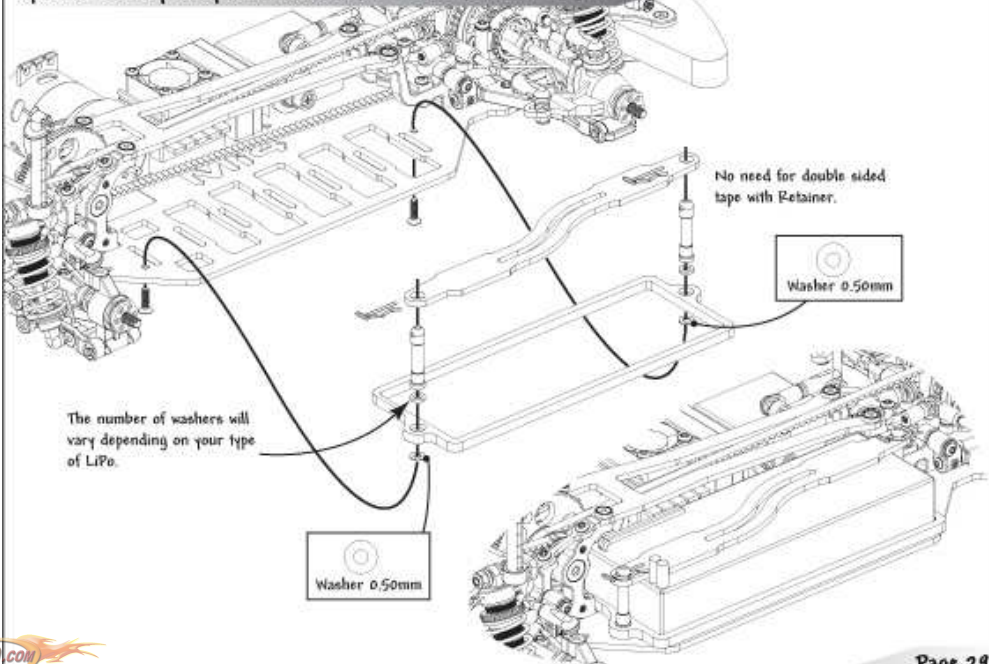

The number of washers will vary depending on your type of LiPo.







**CHASSIS PARTS**

- U1042 Aerial Mount - Universal
- U111 Aerial Tube - Pack 4
- U2231 Servo Horns
- U2480 Body Posts & R Clips (pk 4)
- U3154 Foam Bumper - Mi-4
- U3155 Front Bumper Mouldings - Mi-4
- U3156 Alloy Body Post Mounts; Horizontal (pr)
- U3157 Alloy Body Post Mounts; Vertical (pr)
- U3271 CF LiPo Battery Locator (pr)
- U3483 CF Chassis; 2.0 - Mi-4
- U3484 CF Chassis; 2.5 - Mi-4 Kit
- U3485 CF Chassis; 3.0 - Mi-4
- U3486 CF Top Deck; 2.0 - Mi-4 Kit
- U3487 CF Top Deck; 2.5 - Mi-4
- U3488 CF Top Deck; 3.0 - Mi-4
- U3489 Servo Mounts - Mi-4 (pr)
- U3490 Alloy Servo Mounts
- U3491 Instruction Manual - Mi-4
- U3521 Trans Link Tuning Set; 4prs - Mi-4

**BODYSHELLS & DECALS**

- EC16289121 East Coast - Body; 18250 190mm
- EC16289123 East Coast - Body; Euro-R 190mm
- EC16289123 East Coast - Body; 32081 190mm
- EC16289124 East Coast - Body; Speed 6 190mm
- EC16289124 East Coast - Body; Euro-R 190mm
- EC16289124 East Coast - Body; Euro-R 200mm
- EC16289124 East Coast - Body; 350Z 190mm
- EC16289128 East Coast - Body; RXT 190mm
- EC16289129 East Coast - Body; 505 190mm
- EC38824B East Coast - Half Paint; Blue; Speed 6 190mm
- EC38824R East Coast - Half Paint; Red; Speed 6 190mm
- U3478 Decal Sheet - Schumacher & Racing-Cars.Com (pk3)
- U3492 Decal Sheet - Mi-4 (pk3)

**SUSPENSION**

- U1440 Pro Pin; grooved V8x25mm (pr)
- U2464 Steering Yoke Pivot Set - 2 pairs
- U2718 Pro Pin; Grooved V8x18mm (pr)
- U2734 Steering Yoke; 2 degree - Mi-4 pr
- U2737 Steering Yoke; Kit Old 4 degree - Mi-4 pr
- U2738 Steering Yoke; 4 degree - Mi-4 pr
- U2750 Droop Screw; M5x8mm pk4
- U2910 Front Hub Carrier - Mi-4
- U2912 Rear Hub Carrier - Mi-4
- U3127 Washbones; Graphite Front - Mi-4
- U3128 Washbones; Graphite Rear - Mi-4
- U3137 Shock Mounting Post - Mi-4 (pr)
- U3142 Pro Pivot Pin - 55mm - Mi-4 (pr)
- U3154 Roll Bar Set; Front 1.2-1.4-1.6 - Mi-4
- U3157 Roll Bar Set; Rear 1.2-1.4-1.6 - Mi-4
- U3201 Turnbuckle Adjuster; Gold - 24mm (pr)
- U3210 Turnbuckle Adjuster; Gold - 35mm (pr)
- U3212 Turnbuckle Adjuster; Gold - 45mm (pr)
- U3241 Washbones; Med Flex Front - Mi-4
- U3250 Washbones; Medium Flex Rear - Mi-4
- U3251 Washbones; Extra Flex Front - Mi-4
- U3252 Washbones; Extra Flex Rear - Mi-4
- U3473 Alloy Steering Housing & Post - Mi-4
- U3494 Suspension Pivot Blocks; set B - Mi-4
- U3495 Ball Studs; Ultra Short - pk 4
- U3496 Ball Studs; Short - pk 4
- U3497 Ball Studs; Long - pk 4
- U3498 Ball Studs; X-Long - pk 4
- U3499 Roll Bar Blocks - Mi-4 pk4
- U3500 Pro-Ball Socket; Black - pk 8
- U3501 CF Steering Arm & Mount - Mi-4
- U3522 CF Shock Bracket; Front - Mi-4
- U3523 CF Shock Bracket; Rear - Mi-4
- U3524 CF Upper Link Mount; 45mm 1gr - Mi-4
- U3527 CF Upper Link Mount; 42mm 2gr - Mi-4
- U3528 CF Upper Link Mount; 39mm 3gr - Mi-4
- U3748 Steering Yoke; Med Flex 4 degree (pr)

**SPRINGS**

- U2822 Spring Tuning Set - Pro-Touring (4 prs)
- U2823 Pro-Touring Springs - White 14 lbs
- U2824 Pro-Touring Springs - Blue 16lbs
- U2825 Pro-Touring Springs - Green 18 lbs
- U2826 Pro-Touring Springs - Red 20 lbs
- U2827 Pro-Touring Springs - Yellow 23 lbs
- U2828 Pro-Touring Springs - Violet 27 lbs

K019  
K014

**ELECTRIC - TOURING CARS**  
Mi-4 Pro-CF - 1-10 Touring - KIT  
Mi-4 Pro-CF - 1-10 Touring - Assembled



**SHOCK ABSORBERS**

- U2973 Race Shock Body; Nickel Teflon (pr)
- U2974 Race Shock Collar; threaded adjuster (pr)
- U2975 Race Shock Piston - Trg 2 Hole (pr)
- U2976 Race Shock Piston - Trg 3 Hole (Kit old) pr
- U2977 Race Shock Rod; Ti-Nitride - 30mm (pr)
- U2978 Race Shock Seal Housing; On Road (pr)
- U2979 Race Shock Seal Rebuild Pack (pr)
- U3001 Race Shocks; fully assembled pair
- U3284 Race Shock Top Cap (pr) - Black Unvented
- U613 Spring Stop & Spacer Mouldings (pr)

**SHOCK OIL**

- G030 Pure Silicone Shock Oil - 30w
- G035 Pure Silicone Shock Oil - 35w
- G040 Pure Silicone Shock Oil - 40w
- G045 Pure Silicone Shock Oil - 45w
- G050 Pure Silicone Shock Oil - 50w
- G055 Pure Silicone Shock Oil - 55w
- G060 Pure Silicone Shock Oil - 60w
- G070 Pure Silicone Shock Oil - 70w
- G080 Pure Silicone Shock Oil - 80w
- G100 Pure Silicone Shock Oil - 100w

**TRANSMISSION**

- U1895 M3x8mm Button Screws & Washers pk4
- U2573 Pro-Diff Screw Set
- U2721 Rear Belt; Black Mod Lot x 3.6mm
- U2761 Diff Shims; 10 x 12
- U3011 Front Belt; 111 x 3.6mm
- U3012 Front Belt; Grey Stock 111 x 3.6mm
- U3013 Rear Belt; Grey Stock Lot x 3.6mm
- U3026 Pivot Pin & Screw; Alloy CV D/Shaft
- U3123 Alloy Eccentric - Mi-4 (pr)
- U3124 Diff Retaining Post - Mi-4 (pr)
- U3126 CNC Pulley & Fences; 20T - Mi-4
- U3138 Alloy Diff Output; Male - Mi-4
- U3139 Alloy Diff Output; Female - Mi-4
- U3140 Diff Washer; ProSpec - Mi-4 (pr)
- U3141 HD Spool Output - Mi-4
- U3146 85T 480P CNC Spur Gear - Mi-4
- U3147 81T 480P CNC Spur Gear - Mi-4
- U3148 84T 480P CNC Spur Gear - Mi-4
- U3149 114T 480P CNC Spur Gear - Mi-4
- U3154 114T 480P CNC Spur Gear - Mi-4
- U3155 118T 480P CNC Spur Gear - Mi-4
- U3170 Pins & Shims; Pole - Mi-4 4pc
- U3247 10T 480P CNC Spur Gear - Mi-4
- U3248 16T 480P CNC Spur Gear - Mi-4
- U3249 Ti Shock Post - Mi-4 pr
- U3249 10T 480P CNC Spur Gear - Mi-4
- U3270 106T 480P CNC Spur Gear - Mi-4
- U3275 Bone; 1075 Alloy Driveshaft - Mi-4 1pc
- U3400 16T 480P CNC Spur Gear - Mi-4
- U3502 Alloy Diff Mount; Rear - Mi-4
- U3503 Alloy Layshaft Mount - Mi-4
- U3504 Alloy Diff Mount; Front - Mi-4
- U3505 Alloy Motor Clamp - Mi-4
- U3506 Layshaft & Spacer - Mi-4
- U3507 Diff; Pro-Spec Assembly - Mi-4
- U3508 CNC Diff Pulley & Fences; 36T - Mi-4
- U3509 Spool; Complete Assembly - Mi-4
- U3510 CNC Spool Pulley only - Mi-4
- U3511 Driveshaft HD - Mi-4 pair
- U3512 Blades; Black pk 8

**BEARINGS & BALLS**

- G200 ZXI - Microlube
- H101 Bearing Blaster Aerosol 500ml
- U1901 Silicons Diff Lube - Pot
- U1411 Ball Bearing - 4 x 8 x 3 Non FL (pr)
- U1431 Ball Bearing - 5 x 9 x 3 Non FL (pr)
- U1954 Pro - Thrust Bearing
- U1957 Moly Pole Grease - Pot
- U2148 Ball Bearing - 5 x 10 x 4 Shielded (pr)
- U2181 Wheel Bearings 8pcs 10x5x4+Shim Set
- U2451 Diff Balls; T/C 2.5mm pk12
- U2574 Ball Bearing - 5 x 9 x 2.5 (pr)
- U2862 Ceramic Bearing - 510x4 Shielded (pr)
- U3016 Ball Bearing - 10x15x4 (pr)
- U3017 Ceramic Bearing - 10x15x4 (pr)
- U3018 Ceramic Nitride Diff Balls 2.5mm (pk12)
- U3136 Ball Bearing - 5 x 8 x 2.5 (pr)
- U3386 Ceramic Bearing - 4x8x3 (pr)
- U3520 Ceramic Bearing set - Mi-4

**SPEED PACKS**

- CR024 CORE RC - Serrated MA Steel Wheel Nut pk4
- CR035 CORE RC - Serrated Alloy M4 Nuts; Blue pk 4
- CR036 CORE RC - Serrated Alloy M4 Nuts; Purple pk 4
- CR061 Small Body Clip 1/10 - Silver (8)
- CR062 Small Body Clip 1/10 - Gold (8)
- CR063 Small Body Clip 1/10 - Fluorescent Yellow (8)
- CR064 Small Body Clip 1/10 - Fluorescent Green (8)
- CR065 Small Body Clip 1/10 - Fluorescent Red (8)
- CR066 Small Body Clip 1/10 - Metallic Green (8)
- CR067 Small Body Clip 1/10 - Metallic Red (8)
- CR069 Small Body Clip 1/10 - Metallic Purple (8)
- CR071 Big Body Clip 1/10 - Silver (8)
- CR072 Big Body Clip 1/10 - Gold (8)
- CR073 Big Body Clip 1/10 - Fluorescent Yellow (8)
- CR074 Big Body Clip 1/10 - Fluorescent Green (8)
- CR075 Big Body Clip 1/10 - Fluorescent Red (8)
- CR076 Big Body Clip 1/10 - Metallic Green (8)
- CR077 Big Body Clip 1/10 - Metallic Red (8)
- CR078 Big Body Clip 1/10 - Metallic Blue (8)
- CR079 Big Body Clip 1/10 - Metallic Purple (8)
- CR081 Extra Long Body Clip 1/10 - Silver (4)
- CR082 Extra Long Body Clip 1/10 - Gold (4)
- CR083 Extra Long Body Clip 1/10 - Fluorescent Yellow (4)
- CR084 Extra Long Body Clip 1/10 - Fluorescent Green (4)
- CR085 Extra Long Body Clip 1/10 - Fluorescent Red (4)
- CR086 Extra Long Body Clip 1/10 - Metallic Green (4)
- CR087 Extra Long Body Clip 1/10 - Metallic Red (4)
- CR088 Extra Long Body Clip 1/10 - Metallic Blue (4)
- CR089 Extra Long Body Clip 1/10 - Metallic Purple (4)
- U1541 SPEED PACK - M3 Nuts
- U1548 SPEED PACK - M3 Washers
- U1950 SPEED PACK - Socket Wrenches (pk3)
- U1951 SPEED PACK - E Clips 2x8pcs
- U1952 SPEED PACK - R Clips
- U1960 SPEED PACK - Servo Tape
- U1969 SPEED PACK - Small Pins (pk)
- U1960 SPEED PACK - D Rings; Various
- U2128 SPEED PACK - Grub-Set Screws M3 M4
- U2760 SPEED PACK - M3 Button Hd; 4 to 20
- U2858 Alloy M3x6 Spacer Set; 0.5; 1.3; 3mm - 16pcs
- U2988 M3 Cap Washers - Purple Alloy (pk10)
- U3002 Wheel Spacer Washers (pk10)
- U3021 SPEED PACK - M3x6 Cox Allen Hi-T
- U3022 SPEED PACK - M3x8 Cox Allen Hi-T
- U3023 SPEED PACK - M3x10 Cox Allen Hi-T
- U3024 SPEED PACK - M3x12 Cox Allen Hi-T
- U3131 Alloy Spacers M3x7mm 0.5; 1.3mm (pk18)
- U3148 SPEED PACK - M2.5 Screws pk 10
- U3524 SPEED PACK - M4x8 Cox Hi Tensile (4)

**ELECTRONICS**

- G031 Mini Temp Gun - 420F 230C
- G048 Tyre Warmers 1/10 Trg 1.2-12v
- G0495B Power Supply 5-15v 0-15Amp
- G0495F Power Supply 5-15v 0-20Amp
- G04460 Power Supply 12v 25 Amp
- G04753 Servo; Digital 804 MG-BB 0.08s 19.9Kg
- G04753 Servo; Digital 807 MG-BB 0.06s 15.3Kg
- G04754 Servo; Digital 808 MG-BB 0.04s 8.8Kg
- G04954M Power Cap 470uF 16v Anti Glitch
- G049000 XL-G1 2.4G Sport Wheel Radio Tx-Rx
- G049001 XL-G1 2.4G Race Wheel Radio Tx-Rx
- G049010 XL-G1 2.4G Micro Rx



**SPEED SECRET - OPTION PARTS**

- CR010 CORE Ti Screws - Mi-4 Set 17 pcs
- CR011 CORE Ti Screws - M3x8 Button Head pk4
- CR012 CORE Ti Screws - M3x10 Button Head pk4
- CR013 CORE Ti Screws - M3x16 Button Head pk4
- CR014 CORE Ti Screws - M3x20 Button Head pk4
- CR015 CORE Ti Screws - M3x8 Cox Head pk4
- CR016 CORE Ti Screws - M3x10 Cox Head pk4
- CR017 CORE Ti Screws - M3x12 Cox Head pk4
- CR018 CORE Ti Ball Studs - Ultra Short pk4
- CR019 CORE Ti Ball Studs - Short pk4
- CR020 CORE Ti Ball Studs - Long pk4
- CR043 CORE RC - Silver X-Weights 16pcs
- CR058 CORE RC - Black X-Weights 16pcs
- CR101 CORE Ti Ball Stud Set - M4 20pcs
- CR110 Alloy Servo Arm; Futaba Purple
- CR111 Alloy Servo Arm; ED/Sanwa Purple
- CR112 Alloy Servo Arm; Futaba Blue
- CR113 Alloy Servo Arm; ED/Sanwa Blue
- CR124 Ride Height Gauge; Purple Alloy; 0-10mm
- CR127 Droop Gauge Set; Purple Alloy - Touring
- 5900B Schumacher BANNER 6x30
- U1512 Titanium Turnbuckle; purple - 39mm (pr)
- U1516 Titanium Pivot Pin; purple - 25mm (pr)
- U1405 Titanium Turnbuckle; purple - 35mm (pr)
- U2059 Titanium Turnbuckle; purple - 25mm (pr)
- U2075 Camber & Ride Height Gauges - C/L
- U2096 Aerial Mount; Purple Chrome - Universal
- U2100 Set Up Wheels; Camber; Toe In - SST
- U2135 M4 Nylon Wheel Nut - Purple Alloy (pk4)
- U2187 M3 Nylon Nut - Purple Alloy (pk2)
- U2251 Kwik Klip; U/8x1.0 & 2.0mm
- U2288 Schumacher Pit Dude Car Stand
- U2566 Titanium Turnbuckle - 45mm (pr)
- U2719 Titanium Pivot Pin; purple - 18mm pr
- U2741 Alloy Rear Wheel Carriers; 1deg - Mi-4
- U2810 M4 Nylon Wheel Nut - Red Alloy (pk4)
- U2811 M4 Nylon Wheel Nut - Blue Alloy (pk4)
- U2812 M4 Nylon Wheel Nut - Black Alloy (pk4)
- U2813 M4 Nylon Wheel Nut - Gold Alloy (pk4)
- U2844 Hub & One Way; Heavy Duty - Mi-2
- U2845 Output; Heavy Duty One Way - Mi-2 1pc
- U1932 Kwik Clips 0.25 & 0.5mm (pk8)
- U3143 Titanium Pivot Pin Set - Mi-4 (8pcs)
- U3144 Titanium Pro Pivot Pin - 55mm (pr)
- U3221 Alloy Wheel Hex; Slim Solid - Mi-9 (pr)
- U3519 CF LiPo Strap & Posts - Mi-4
- U3514 CF LiPo Strap - Mi-4
- U3515 LiPo Retainer - Mi-4
- U3516 Ti Turnbuckle Set - Mi-4
- U3517 Alloy Block Susp Half Set - Mi-4
- U3518 One Way; Complete Assembly - Mi-4
- U3519 Cnc One Way Pulley - Mi-4
- U3525 Alloy Wheel Hex - Mi-4 (pr)





### CHARGERS

CR025 UDC10 Universal Charger - NiMH + LiPo  
 CR026 UDC20 Universal Balance Charger - NiMH+LiPo  
 CR027 Power Supply; UDC 20 - 6A UK Plug  
 CR028 Power Supply Cable; USA  
 CR029 Power Supply Cable; Europe  
 CR031 UDC Charger Connector Set  
 CR054 Balance Charge Lead; 3.5T to 3mm Male 7.4v  
 GM1464 Ultramat 14 Mains/12v Charger  
 SLC1005A SP Multi-Charge - Orange  
 SLC2015A SP Multi-Charge - Pink  
 SLC3025A SP Multi-Charge - Blue  
 SLC4035A SP Multi-Charge - Yellow

### SPEEDCONTROLS

GMT14 GM Genius 10 BL ESC 10 Amp  
 GMT16 GM Genius 120 BL-ESC 120 Amp  
 SPEXTE8802B Speed Passion GT V2.0 ESC - Blue  
 SPEXTE8802LPB Speed Passion LFP V2.0 ESC - Blue  
 SPEXTE8802LFP Speed Passion LFP V2.0 ESC - Carbon Look  
 SPEXTE8802PRD Speed Passion GT V2.0 ESC - Carbon Look

### BRUSHLESS MOTORS

GMT128 GM Pro 4T Delta Wind BL Motor  
 GMT128T GM Pro TT Delta Wind  
 GMT130 GM Pro Stock 10.5T - Star Wind  
 GMT134 GM Pro Stock 13.5T - Star Wind  
 GMT136 GM Pro 6.5T - Star Wind  
 SP1383 Speed Passion CV2.0 Comp BL Motor; 3.5T  
 SP1383S Speed Passion CV2.0 Comp BL Motor; 3.5T  
 SP13840 Speed Passion CV2.0 Comp BL Motor; 4.0T  
 SP13845 Speed Passion CV2.0 Comp BL Motor; 4.5T  
 SP13855 Speed Passion CV2.0 Comp BL Motor; 5.5T  
 SP13865 Speed Passion CV2.0 Comp BL Motor; 6.5T  
 SP13865 SP Ultra Stock BL Motor 10.5T BRCA RDAE  
 SP13865 SP Ultra Stock BL Motor 13.5T RDAE  
 SP13865 SP Ultra Stock BL Motor 11.5T RDAE  
 SP13865 Speed Passion CV2.0 Comp BL Motor; 7.5T  
 SP13865 Speed Passion CV2.0 Comp BL Motor; 8.5T

### BRUSHLESS ACCESSORIES

SP13835R1 SP Rotor 3.5T; Euro R Hi Power 12.5mm  
 SP13835R2 SP Rotor 3.5T; Euro S Hi Speed & Runtime 12mm  
 SP13845R1 SP Rotor 4.5T; Euro RS Power Band 13mm  
 SP142801 SP - Sensor Cable 180mm  
 SP142802 SP - Sensor Cable 10mm  
 SP142810 SP - HiPower Connector; 3pcs set  
 SPAM55CL5M SP - Super Capacitor 1.5 Farads 7.4 Volt rated  
 SPAM55CL3M SP - Super Capacitor 3 Farads 6 Volt rated  
 SPBA01 SP Brushless Analyser - ESC & Motors  
 SPCEB183236 SP - Ceramic Motor Bearing  
 SPLPDA501 SP - Connector; 7.4v Female - Golden Batteries  
 SPFA13835 SP Rotor 3.5T; Standard 13.5mm  
 SPFA13845 SP Rotor 4.5T; Standard 13.5mm  
 SPFB13835 SP Rotor 3.5T; Hi RPM 13mm  
 SPFB13845 SP Rotor 4.5T; Hi RPM 12mm  
 SPSPBA01 Brushless Analyser - ESC & Motors

### BRUSHLESS ESC & MOTOR COMBO

SPCOM105 SP Combo - Pro-Stock 10.5T + LFP ESC  
 SPCOM135 SP Combo - Stock 13.5T + LFP ESC  
 SPCOM165 SP Combo - Modified 6.5T + LFP ESC

### BATTERIES

CR004 CORE RC - 5000mAh 7.4v LiPo  
 CR034 CORE RC - 3250mAh 7.4v LiPo  
 GT07 Ener-G 4x00 - XXS Team 35 Selected  
 GM1888T LiPo V-MAXX 35C 5000/7.4V Stick 175 Amp Cont  
 GM18894 LiPo V-MAXX 30C 4200/7.4V Saddle  
 SLR38035 SP LiPo Hardcase - 3800mAh 7.4v 30C  
 SLR4025H SP LiPo Hardcase - 4000mAh 7.4v 25C  
 SLR423H5 SP LiPo Saddle Pack - 4200mAh 7.4v 30C  
 SLR5303H SP LiPo Hardcase - 5300mAh 7.4v 30C

### 1/10 TOURING WHEELS

U2500 Rev-Lite; 24mm - White (PK4)  
 U2501 Rev-Lite; 24mm InchUp - White (PK4)  
 U2771 Rev-Lite; Flex 24mm - White (PK4)  
 U2774 Rev-Lite Shift; 24mm - White (PK4)



### 1/10 TOURING TYRES & INSERTS

UG623 SST Mini Pins 24/25 - Blue (pr)  
 UG624 SST Mini Pins 24/25 - Yellow (pr)  
 UG626 SST Foam Tyre Insert - 24/25 Soft (pr)  
 UG627 SST Foam Tyre Insert - 24/25 Hard (pr)  
 UG628 SST Foam Tyre Insert - 24/25 Comp (pr)  
 UG629 SST Rally 24/25 - Yellow (pr)  
 UG630 SST Rally 24/25 - White (pr)  
 UG634 SST Foam Tyre Insert - 20 Soft (pr)  
 UG635 SST Foam Tyre Insert - 20 Hard (pr)  
 UG670 SST Mini Pins 20 - Blue (pr)  
 UG671 SST Mini Pins 20 - Yellow (pr)  
 UG672 SST Belted Stick 25 - White (pr)  
 UG670 SST Carpet Dragon 24/25mm (pr)  
 UG675 Moulded LP Insert Orange X-Soft (pr)  
 UG676 SST Moulded LP Insert Green Med. (pr)  
 UG677 SST LP24 Foam Insert; Med Blk (pr)  
 UG700 SST LP24 Foam Insert; Soft GY (pr)  
 UG714 Moulded CP Insert Aqua - Soft (pr)  
 UG716 SST Mini Pins 24/25 - Green (pr)  
 UG717 SST Mini Pins 20 - Green (pr)

### SOREX - TOURING CAR TYRES

XCD-20R Sores Competition Tyre - 20R  
 XCD-24R Sores Competition Tyre - 24R  
 XCD-28R Sores Competition Tyre - 28R  
 XCD-32R Sores Competition Tyre - 32R  
 XCD-36R Sores Competition Tyre - 36R  
 XCD-40R Sores Competition Tyre - 40R  
 XG-24BM Sores Glued 24R+Med B+Revlite24 pk4  
 XG-28BM Sores Glued 28R+Med B+Revlite24 pk4  
 XG-28TB Sores Glued 28R+TB+Revlite24 pk4  
 XG-32BM Sores Glued 32R+Med B+Revlite24 pk4  
 XG-32CM Sores Glued 32R+Med C+Revlite24 pk4 BRCA  
 XG-36BM Sores Glued 36R+Med B+Revlite24 pk4  
 XG-36CM Sores Glued 36R+Med C+Revlite24 pk4  
 XG-36EU Sores Glued 36R+Med EU; Euro 2008 pk4  
 XG-WET Shimizu Dot Wet Pre-Glued; Euro 2008 pk4  
 XMA-24F Sores Moulded Insert - A Firm pr  
 XMA-24M Sores Moulded Insert - A Med pr  
 XMB-24M Sores Moulded Insert - B Firm pr  
 XMB-24M Sores Moulded Insert - B Med pr  
 XMC-24F Sores Moulded Insert - C Firm pr  
 XMC-24M Sores Moulded Insert - C Med pr

### PINIONS 48dp

U3414 Pinion; Hard Alloy 48dp - 14T  
 U3415 Pinion; Hard Alloy 48dp - 15T  
 U3416 Pinion; Hard Alloy 48dp - 16T  
 U3417 Pinion; Hard Alloy 48dp - 17T  
 U3418 Pinion; Hard Alloy 48dp - 18T  
 U3419 Pinion; Hard Alloy 48dp - 19T  
 U3420 Pinion; Hard Alloy 48dp - 20T  
 U3421 Pinion; Hard Alloy 48dp - 21T  
 U3422 Pinion; Hard Alloy 48dp - 22T  
 U3423 Pinion; Hard Alloy 48dp - 23T  
 U3424 Pinion; Hard Alloy 48dp - 24T  
 U3425 Pinion; Hard Alloy 48dp - 25T  
 U3426 Pinion; Hard Alloy 48dp - 26T  
 U3427 Pinion; Hard Alloy 48dp - 27T  
 U3428 Pinion; Hard Alloy 48dp - 28T  
 U3429 Pinion; Hard Alloy 48dp - 29T  
 U3430 Pinion; Hard Alloy 48dp - 30T  
 U3431 Pinion; Hard Alloy 48dp - 31T  
 U3432 Pinion; Hard Alloy 48dp - 32T  
 U3433 Pinion; Hard Alloy 48dp - 33T  
 U3434 Pinion; Hard Alloy 48dp - 34T  
 U3435 Pinion; Hard Alloy 48dp - 35T  
 U3436 Pinion; Hard Alloy 48dp - 36T  
 U3437 Pinion; Hard Alloy 48dp - 37T  
 U3438 Pinion; Hard Alloy 48dp - 38T

### PINIONS 64dp

U3614 Pinion; Hard Alloy 64dp - 14T  
 U3620 Pinion; Hard Alloy 64dp - 20T  
 U3621 Pinion; Hard Alloy 64dp - 21T  
 U3622 Pinion; Hard Alloy 64dp - 22T  
 U3623 Pinion; Hard Alloy 64dp - 23T  
 U3624 Pinion; Hard Alloy 64dp - 24T  
 U3625 Pinion; Hard Alloy 64dp - 25T  
 U3626 Pinion; Hard Alloy 64dp - 26T  
 U3627 Pinion; Hard Alloy 64dp - 27T  
 U3628 Pinion; Hard Alloy 64dp - 28T  
 U3629 Pinion; Hard Alloy 64dp - 29T  
 U3630 Pinion; Hard Alloy 64dp - 30T  
 U3631 Pinion; Hard Alloy 64dp - 31T  
 U3632 Pinion; Hard Alloy 64dp - 32T  
 U3633 Pinion; Hard Alloy 64dp - 33T  
 U3634 Pinion; Hard Alloy 64dp - 34T  
 U3635 Pinion; Hard Alloy 64dp - 35T  
 U3636 Pinion; Hard Alloy 64dp - 36T  
 U3637 Pinion; Hard Alloy 64dp - 37T  
 U3638 Pinion; Hard Alloy 64dp - 38T  
 U3639 Pinion; Hard Alloy 64dp - 39T  
 U3640 Pinion; Hard Alloy 64dp - 40T  
 U3641 Pinion; Hard Alloy 64dp - 41T  
 U3642 Pinion; Hard Alloy 64dp - 42T  
 U3644 Pinion; Hard Alloy 64dp - 44T  
 U3646 Pinion; Hard Alloy 64dp - 46T  
 U3648 Pinion; Hard Alloy 64dp - 48T

### TOOLS

AT142 ATS Set Up Gauges - 1/10th Touring  
 CR044 CORE RC - Curved Body Scissors  
 CR045 CORE RC - Straight Body Scissors  
 CR200 Shock Shaft Pliers - Purple  
 CR201 Shock Shaft Pliers - Black  
 CR202 Magnetic Parts Tray - Purple  
 CR203 Magnetic Parts Tray - Black  
 ED10024 Arm Reamer 3.175 (US) x 12.0mm  
 H1032 Alloy Camber Gauge - 1/10th  
 H1055 GT95 Lube & Clean Aerosol 400ml  
 U2781 Schumacher Hex Driver - 1.5mm  
 U2780 Schumacher Hex Driver - 2.0mm  
 U2781 Schumacher Hex Driver - 2.5mm  
 U2782 Schumacher Hex Driver - 3.0mm  
 U2785 Schumacher M3 Nut Driver  
 U2786 Schumacher M4 Nut Driver  
 U2818 Schumacher Body Reamer

### TEAM CLOTHING

G331L T Blue - Large  
 G331M T Blue - Medium  
 G331S T Blue - Small Man  
 G331XL T Blue - X-Large  
 G331XXL T Blue - XX-Large  
 G333L Polo - Large  
 G333M Polo - Medium  
 G333S Polo - Small Man  
 G333XL Polo - X Large  
 G333XXL Polo - XX-Large  
 G334 Cap - Black; Medium 58cm  
 G335 Cap - Black; Large 62cm  
 G336L Sweat - Large  
 G336M Sweat - Medium  
 G336S Sweat - Small  
 G336XL Sweat - X-Large  
 G336XXL Sweat - XX-Large

### ACCESSORIES

CR001 CORE RC Motor & Battery Case  
 CR005 CORE RC Battery Tape - Black  
 CR006 CORE RC Battery Tape - Blue  
 CR007 CORE RC Silicone Wire 12g - Red/Black 2x50cm  
 CR008 CORE RC RED Connector with 2x4mm Tubes  
 CR009 CORE RC RED Connector with 2x4mm Tubes  
 CR022 CORE RC - Digital Pocket Scale 500gram  
 CR033 CORE RC - Safe Charge Pouch 18x22cm  
 CR037 CORE RC - Battery Tape - Purple  
 CR050 CORE RC Silicone Wire 12g - Red 1 Metre  
 CR051 CORE RC Silicone Wire 12g - Black 1 Metre  
 CR052 CORE RC Silicone Wire 12g - Blue 1 Metre  
 CR053 CORE RC Silicone Wire 12g - Red 50 Metre Reel  
 CR054 CORE RC Silicone Wire 12g - Black 50 Metre Reel  
 CR055 CORE RC Silicone Wire 12g - Blue 50 Metre Reel  
 CR059 CORE RC - Safe Charge Pouch 23x30cm  
 G173 Silicone Wire - 2x50cm Red/Black  
 G174 Battery Bars - p15  
 G175 Female Connector Tubes (pk 10)  
 G176 Male Connector Tubes (pk 2)  
 GM8375 Battery Warmer Pads 40degC 12v 3Amp  
 H1031 Battery Tape - Natural 50m x 17mm  
 H1040 T Connector; Red 2 Way - Male & Female  
 H1041 T Connector; Black 2 Way - Male & Female  
 H1048 T Connector; Red Sockets - pk4  
 H1049 T Connector; Black Sockets - pk4  
 H1054 Polarised Plug+Socket; 3.5mm - Pair  
 SEL3000B SP Lipo Extension Balancer

