

Congratulations on buying the Mi3.5



This car is factory assembled to save you time, and ensure that all the parts fit together correctly. However please refer to the setup sheets at the back of the manual, as small adjustments may be required to setup the car for your individual driving style, and the type of track you race on.

This manual covers the Pro spec and the Race spec versions of the Mi3.5. The box end label will tell you which version you have.

Because this car is assembled, most of the manual will only be required for maintenance, Page 28 onwards deals with finishing the car assembly.

Additional items required.

2 Channel radio Control. Transmitter, Receiver and Steering servo.

Electronic Speed Controller.

Battery Pack. 7.2v NiMH, 6.0v NiMH or 7.4v Lipo.

Battery charger.

Motor and pinion.

Bodyshell and paint.

Wheels and tyres.

AA Batteries for transmitter.

Tools.

See back page of manual for some available option parts.

Safety Notes

- This product is not suitable for children under 14 years of age unless supervised by an adult.
- Select an area for assembly that is away from the reach of small children. The parts are small and can be swallowed by children causing choking and possible internal injuries.
- Shock fluids, grease and adhesives should be kept out of childrens reach. They may be toxic and were not intended for human consumption.
- Exercise care when using hand tools, sharp instruments or power tools during assembly.
- Read the instructions fully and read all manufacturers warnings and cautions for any additional items that may be used for assembly purposes.
- Always drive your car safely and away from public roads, and be aware of any people or animals near you. MODEL CARS CAN BE DANGEROUS.
- Learn to use your power with respect, very few surfaces can cope with full power. If you use full power everywhere you WILL break things.
- Always ensure that the transmitter batteries are fully charged.
- Always ensure that all nuts and screws are tight and the gear mesh is correct.
- Superglue the tyres to the wheels as they may come off at high speeds.
- This product is not a toy, it is a hobby product capable of high performance, but it will require regular maintenance. Learn to drive the car slowly at first, away from solid objects.
- The carbon fibre chassis conducts electricity, beware of short circuiting the batteries.



IMPORTANT

Please read the entire manual before starting the assembly of your new MI-3.5
Before you start Building your car checkout the setup Sheets at the end of the manual or online at www.racing-cars.com to ensure the car is built to suit your driving style and track conditions



Rear Diff Assembly

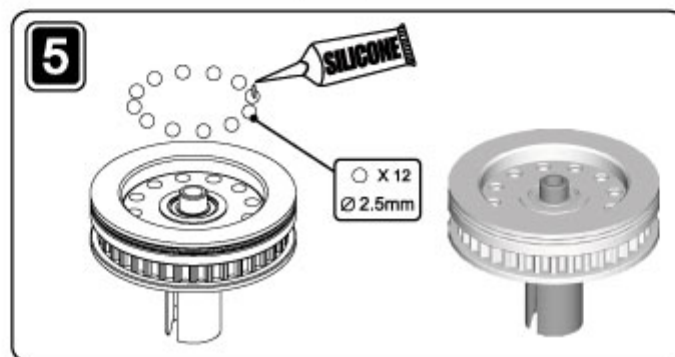
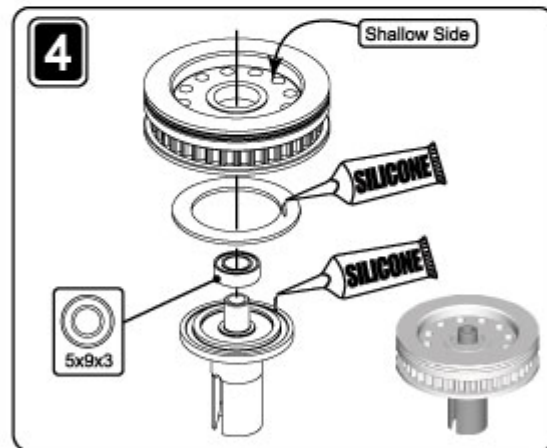
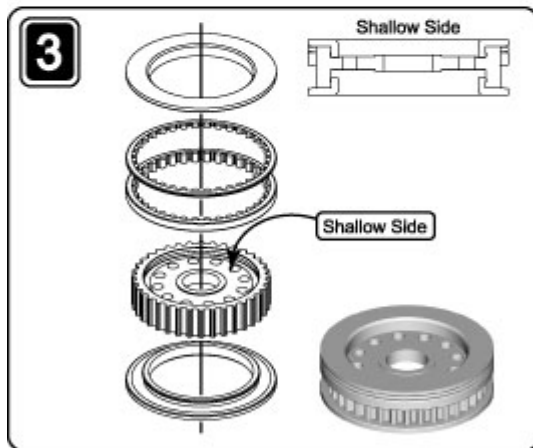
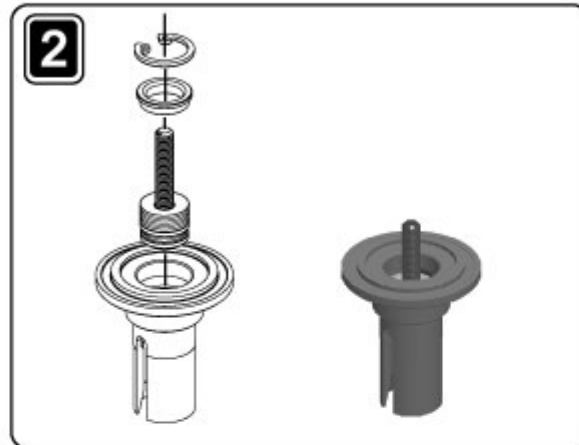
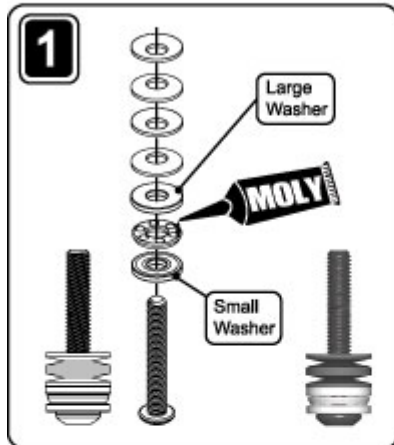

www.racing-cars.com

Page 1

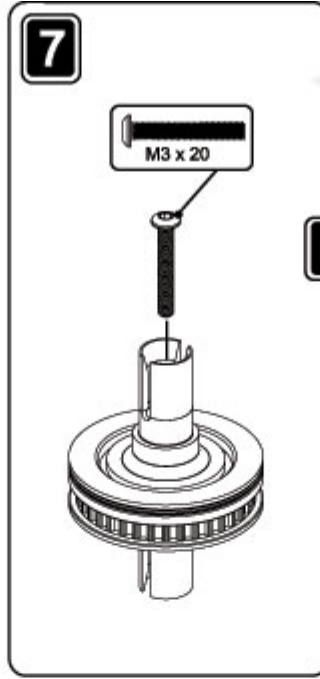
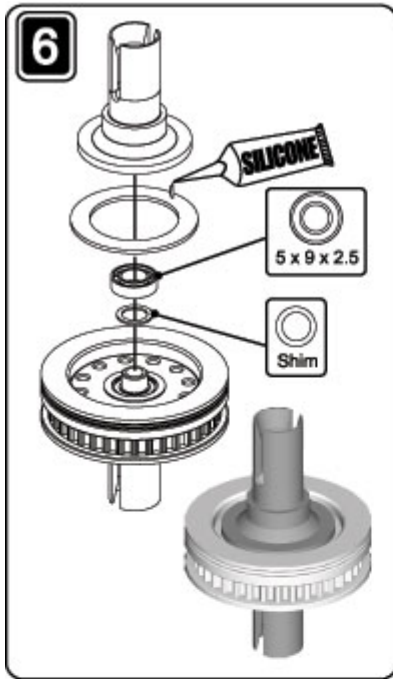

Diff Assembly cont..

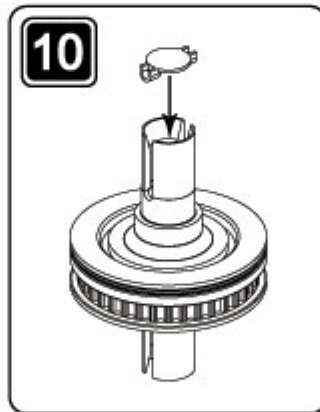
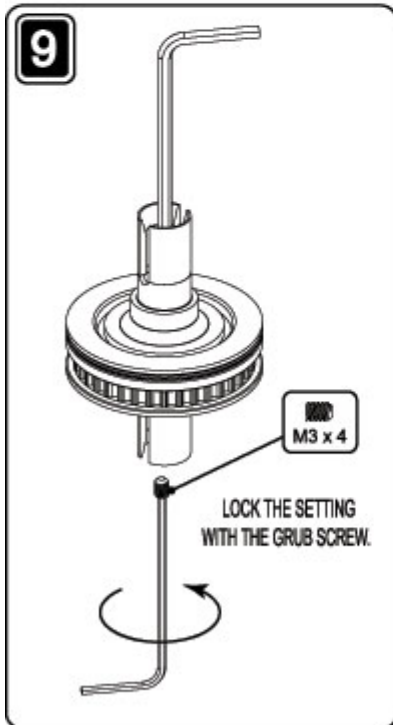
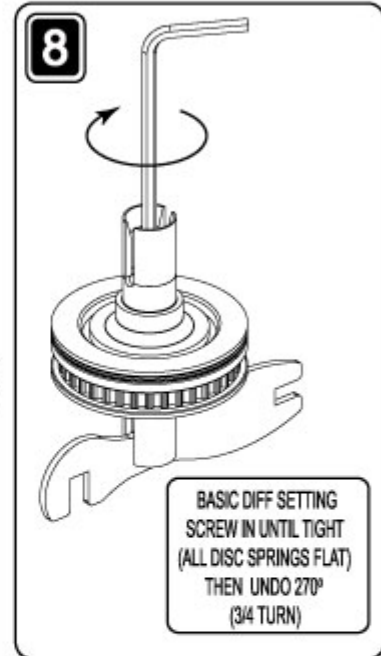

Final Assembly



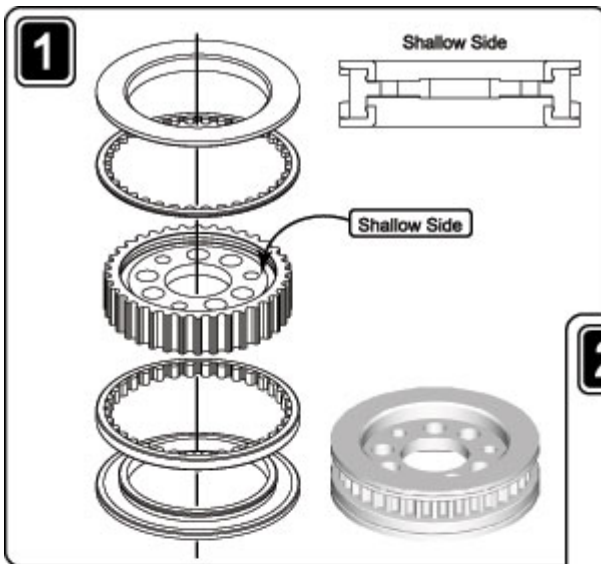

Spool Assembly

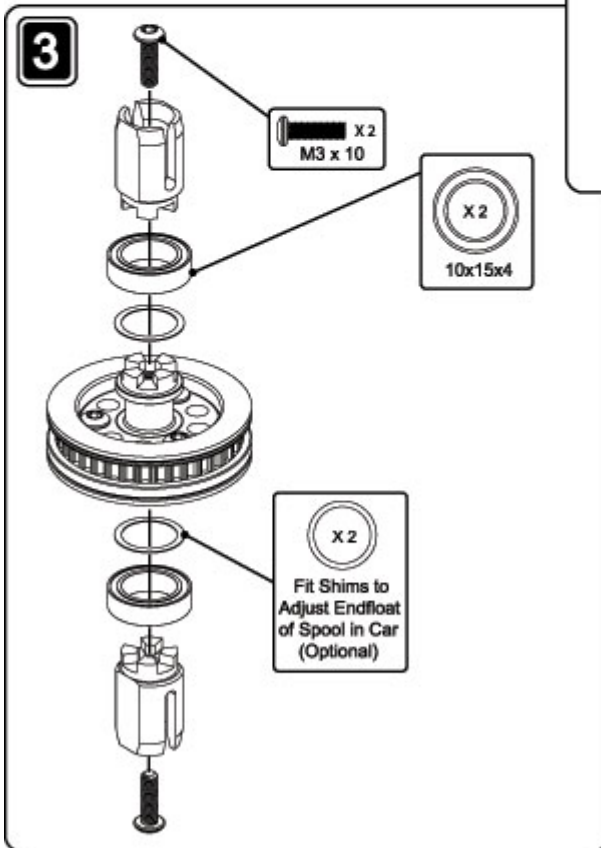
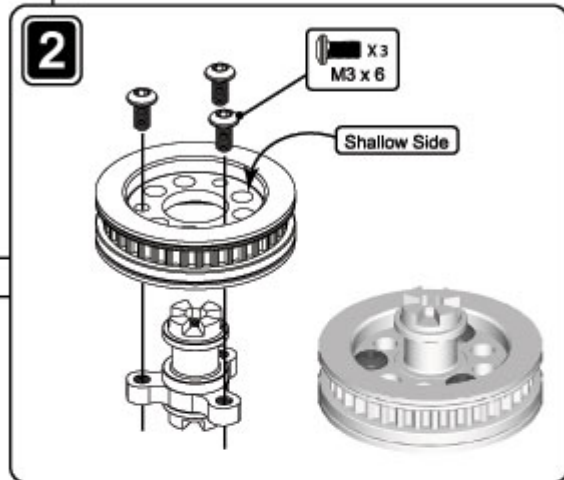

Final Assembly

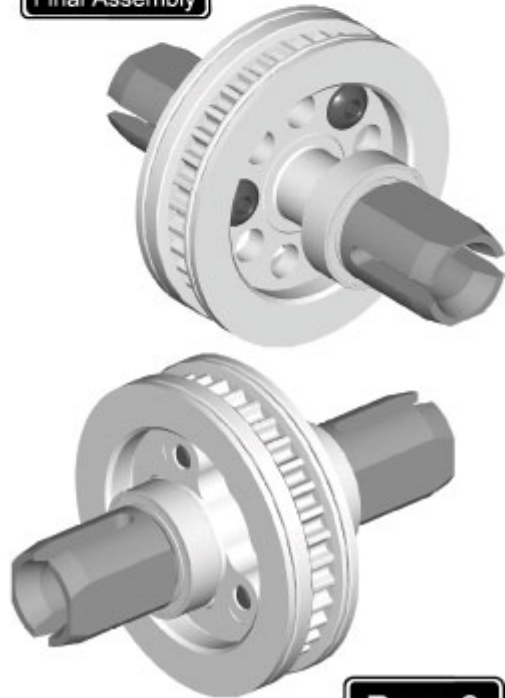

www.racing-cars.com

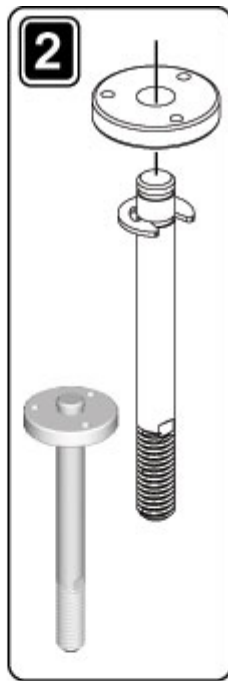
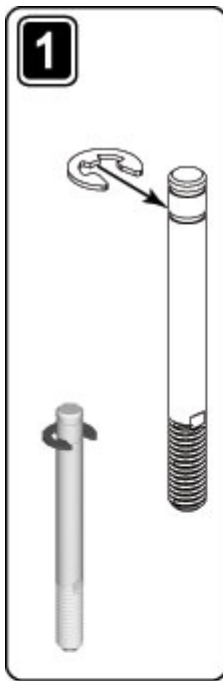

**Shock Assembly
Pro-Spec**

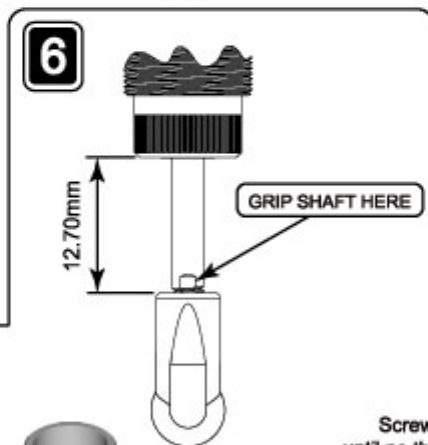
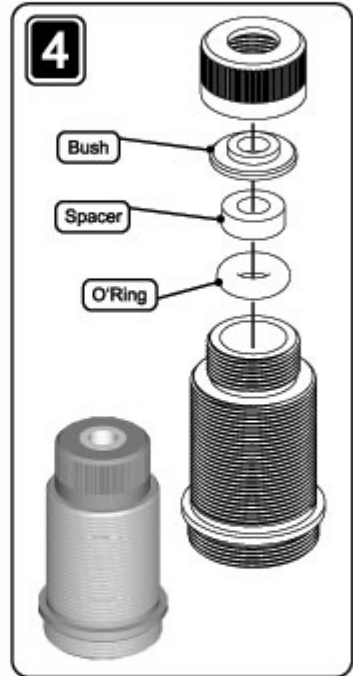

Screw on to shaft
until no thread is showing



Grip the piston rod very close to the thread.
**BE CAREFUL NOT TO DAMAGE
THE POLISHED SHOCK ROD.**



6 Fill Slowly With Shock Oil until Domed. Move Piston Up and Down Slowly and Allow all Air Bubbles to Rise and disappear.

7

iii 3.5 PRO

Shock Assembly cont.. Pro-Spec

9

Lubricate the Threads with a SMALL amount of shock oil

8 O'Ring

Final Assembly

61.30mm (All 4 Shocks the Same)

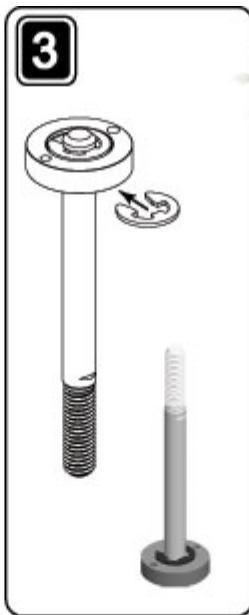
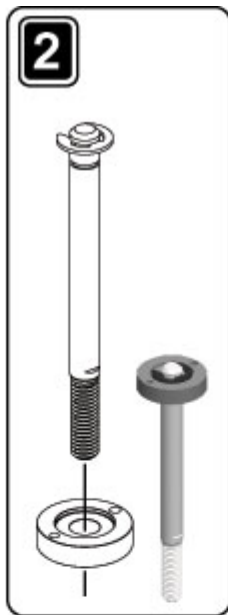

**Shock Assembly
Race-Spec**

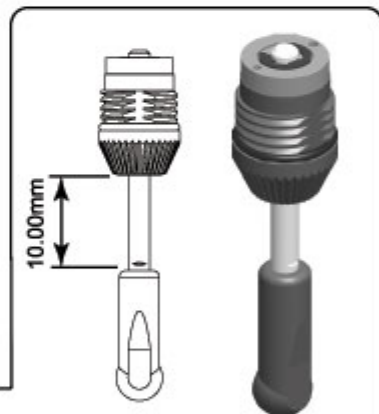
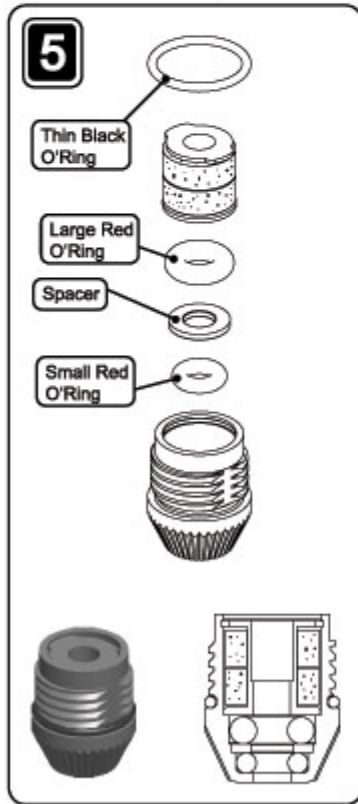
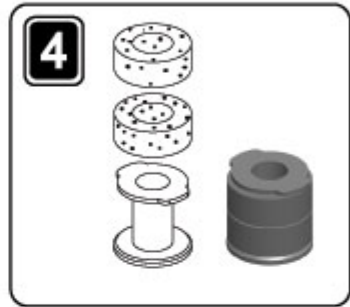

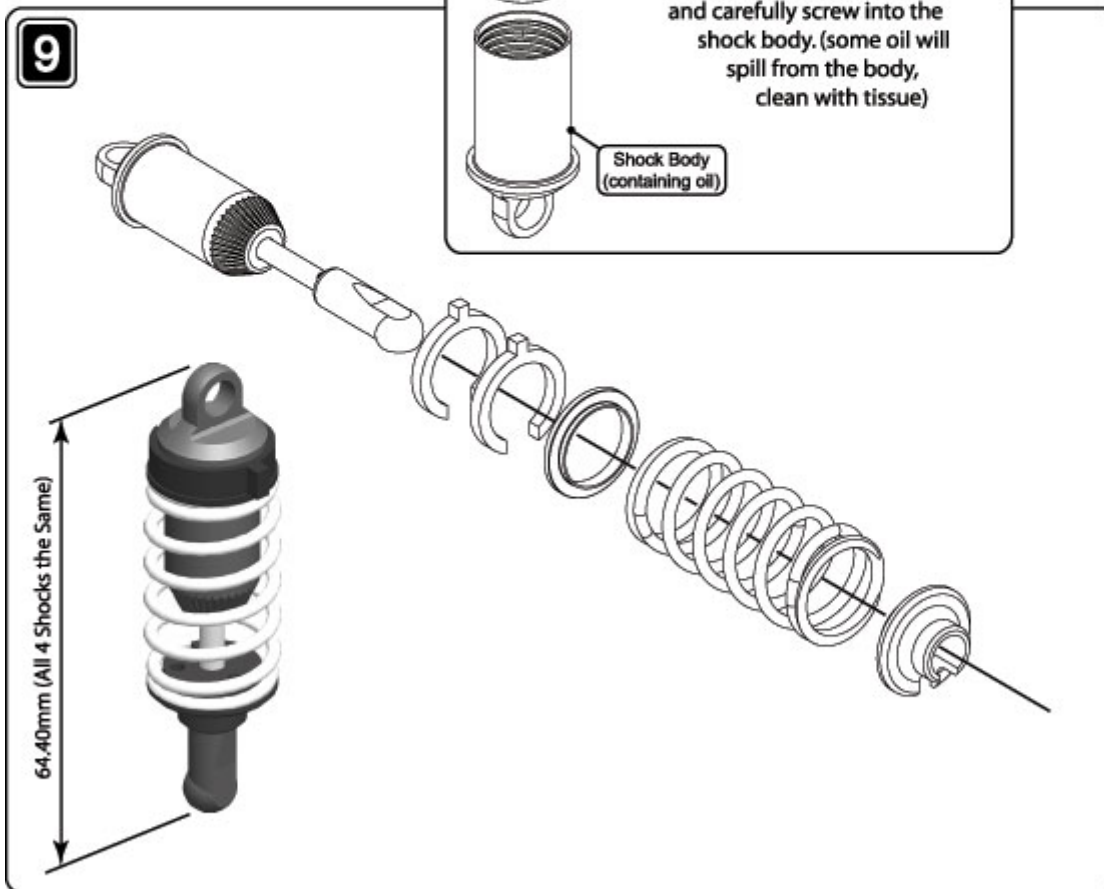
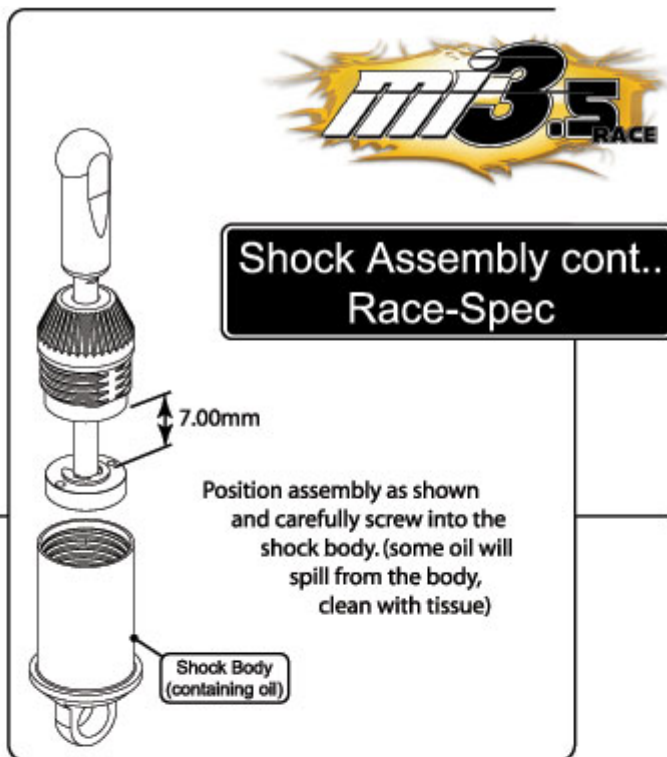
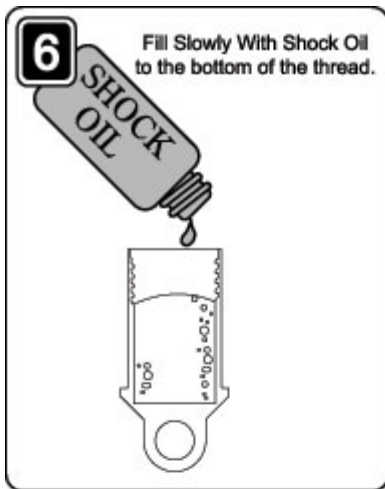

www.racing-cars.com

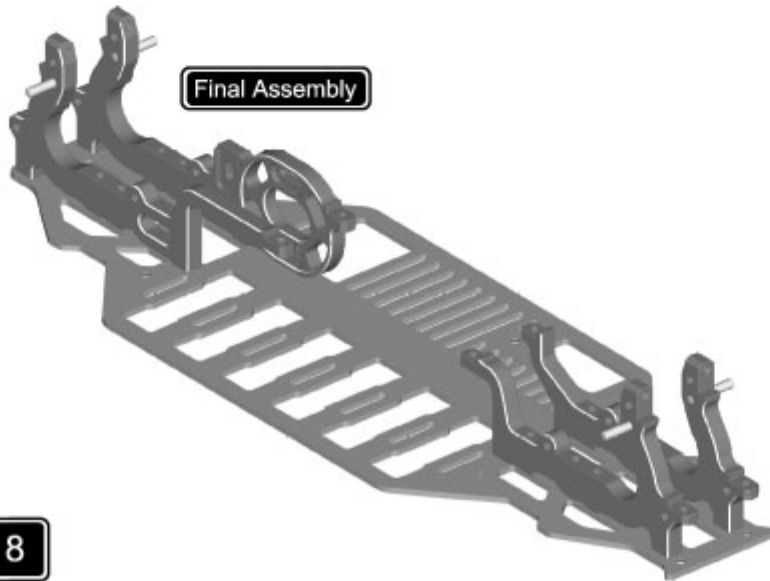
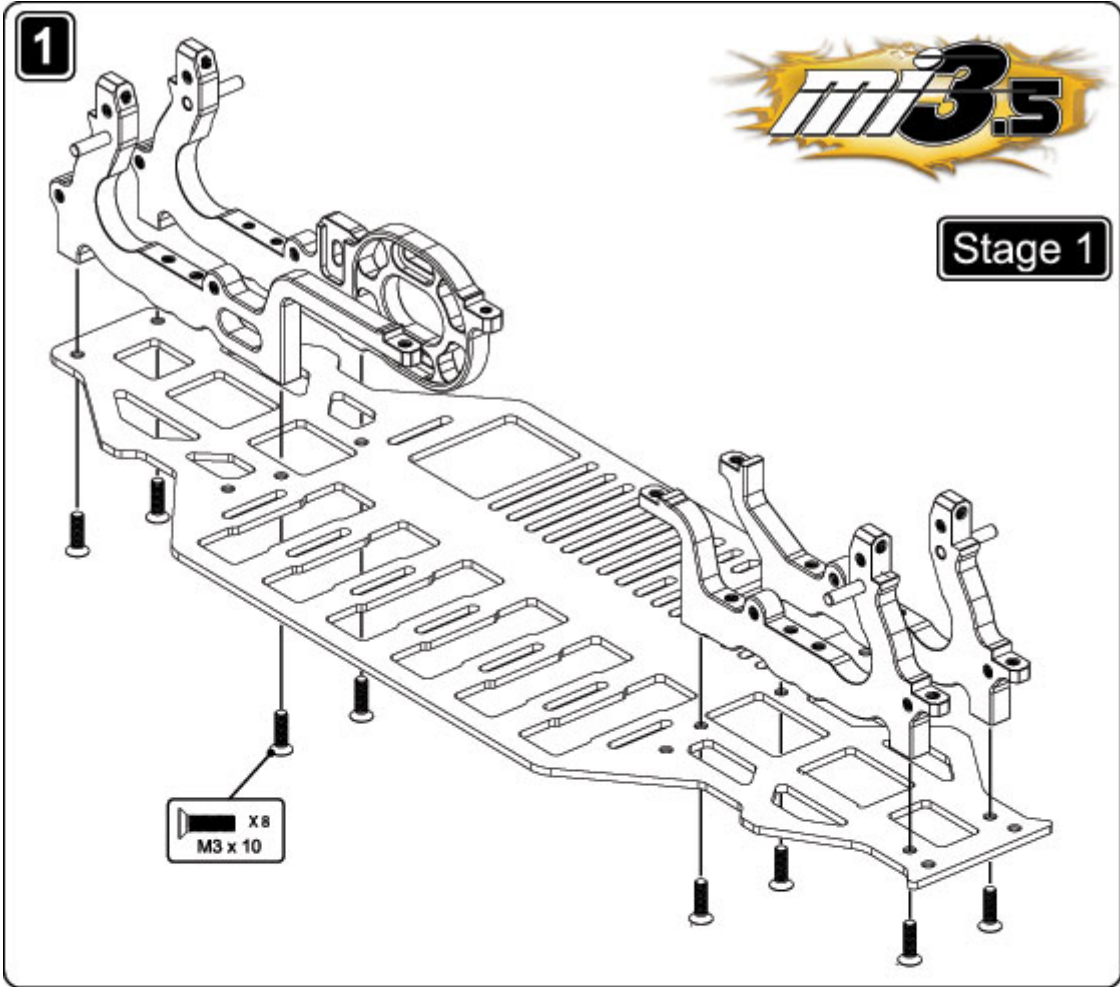

Page 8



www.racing-cars.com

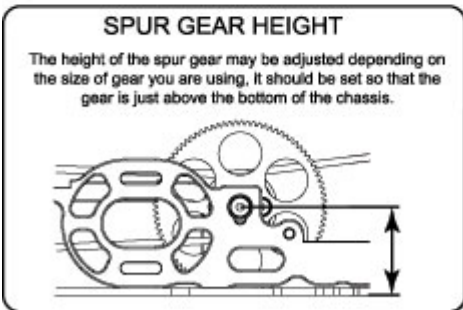
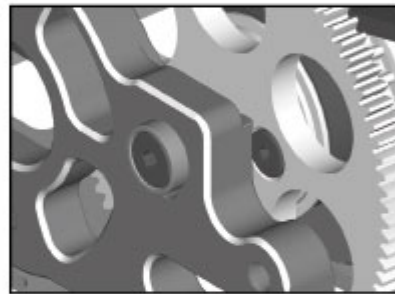
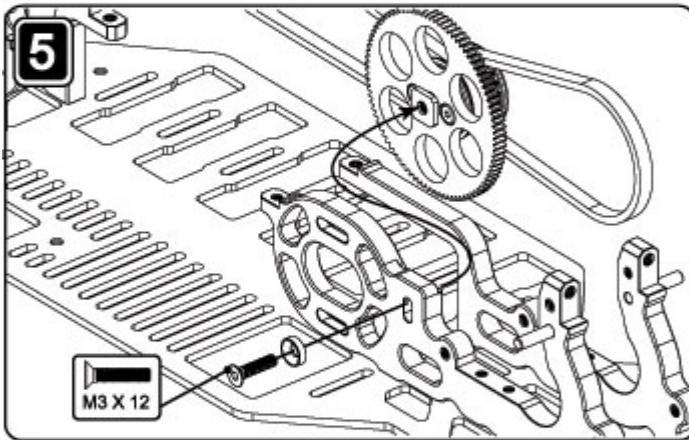
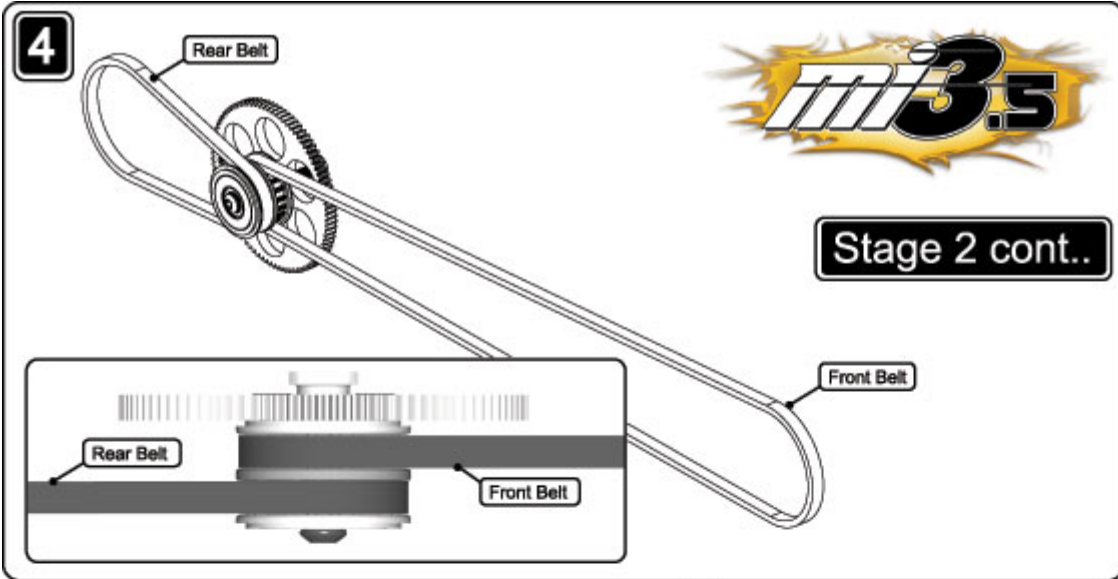

Final Assembly

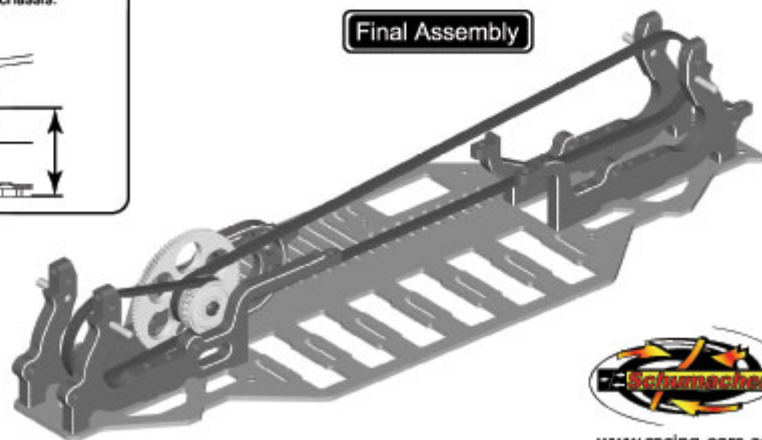

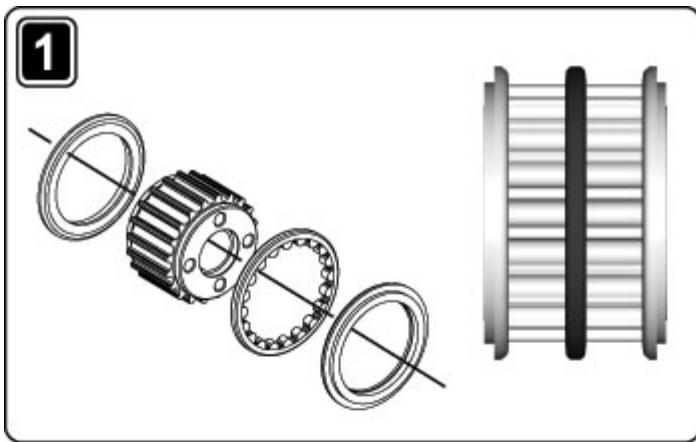

Stage 2

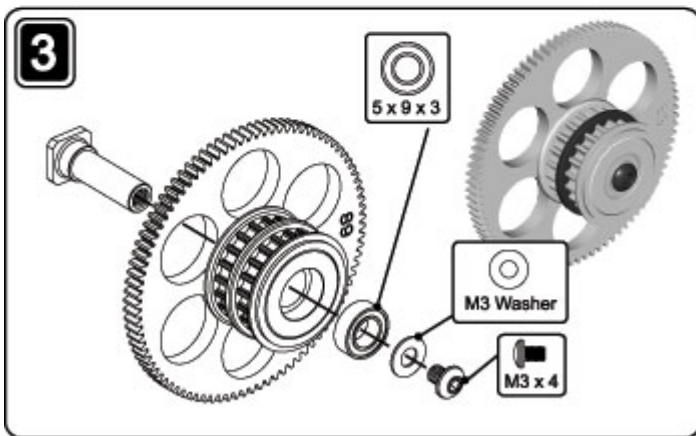
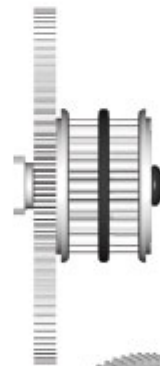
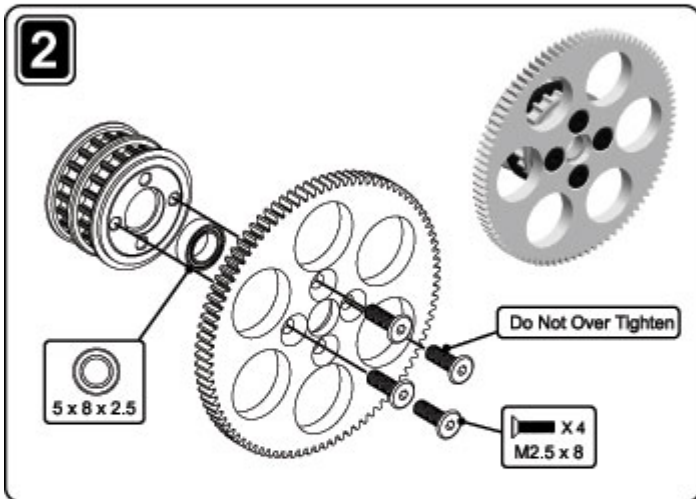

www.racing-cars.com

Page 9



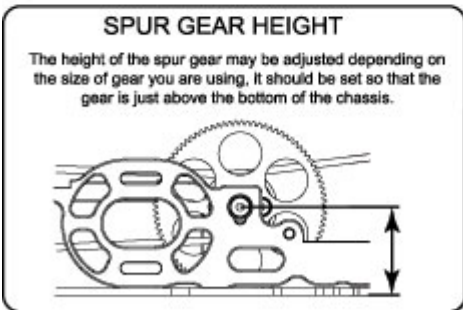
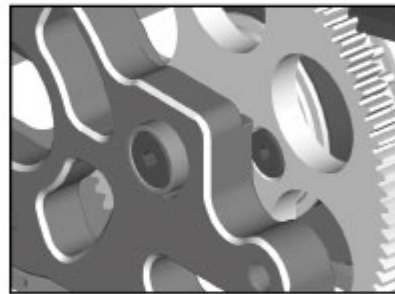
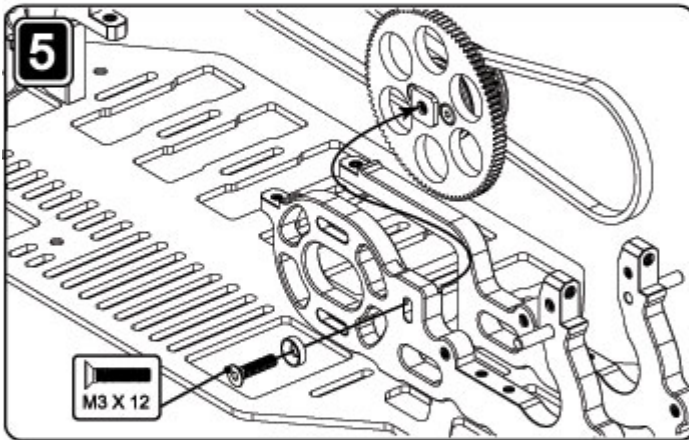
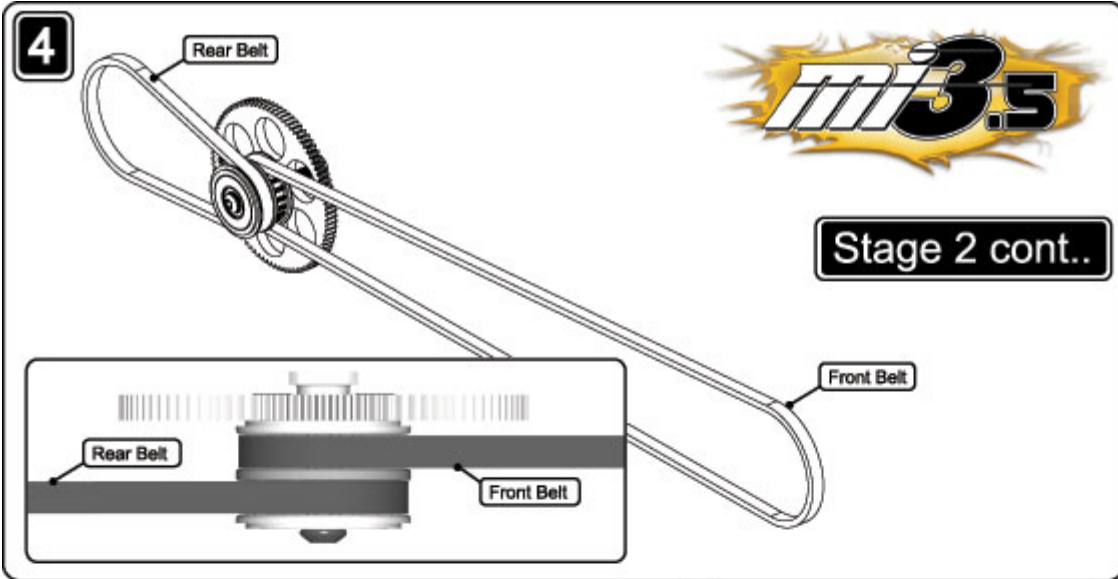

Final Assembly

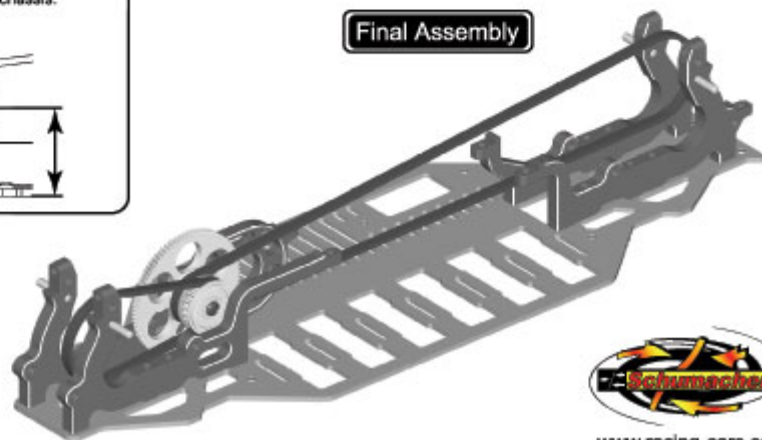

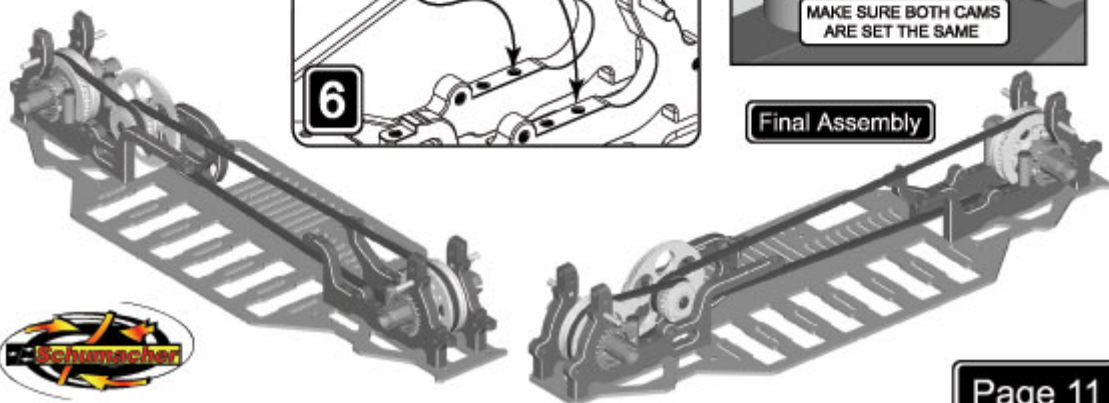
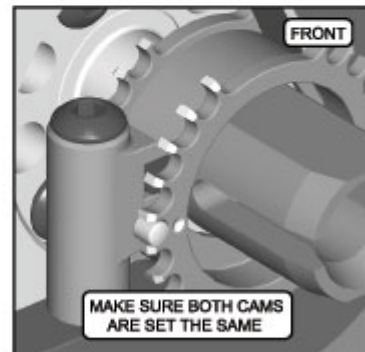
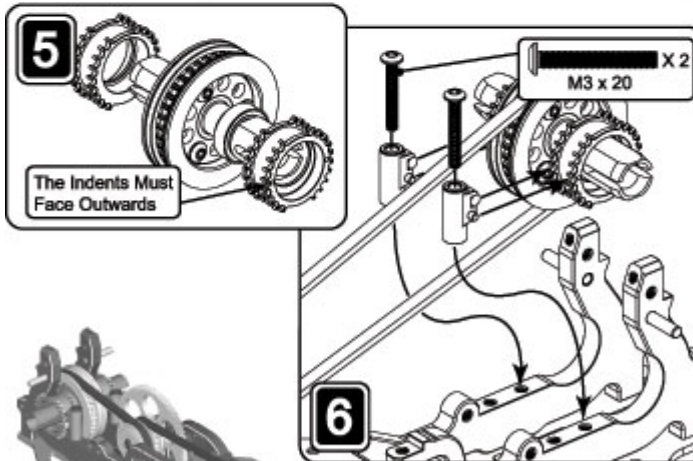
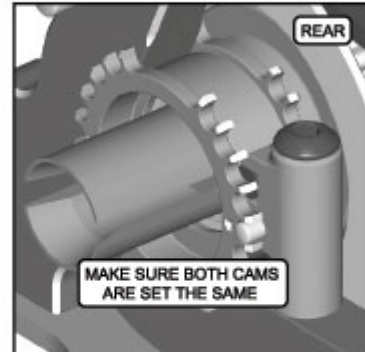
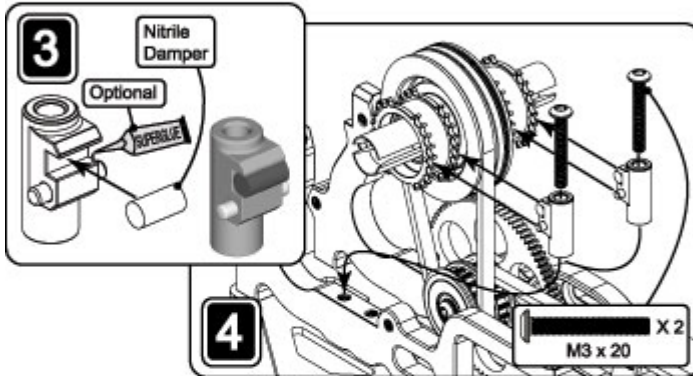
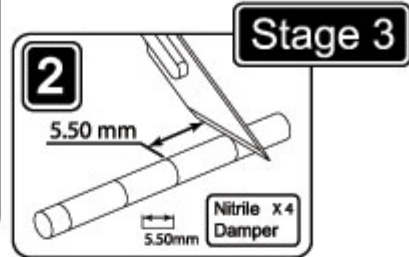
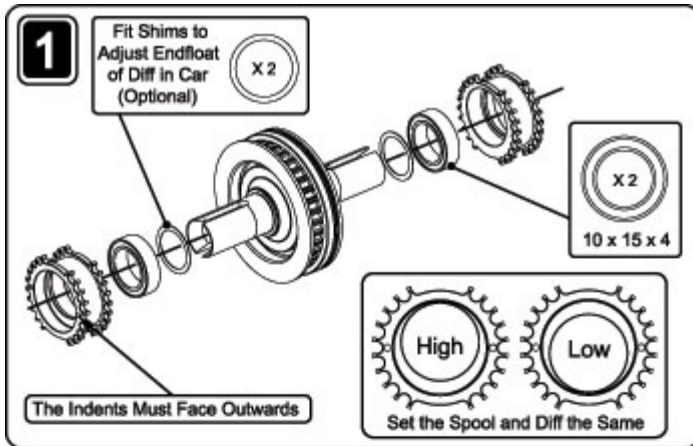



Rear Suspension
Right hand Side

Stage 5

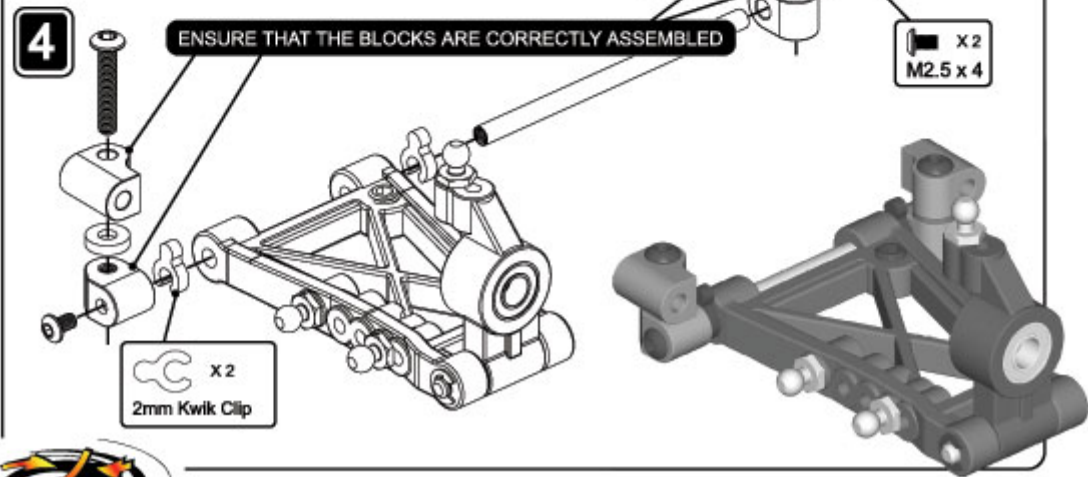
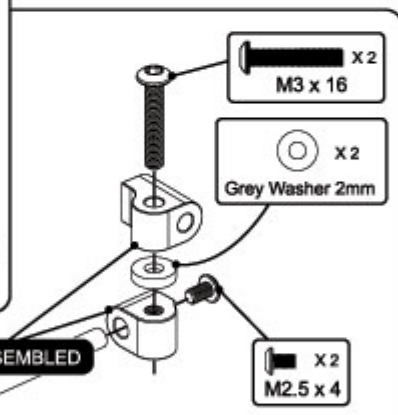
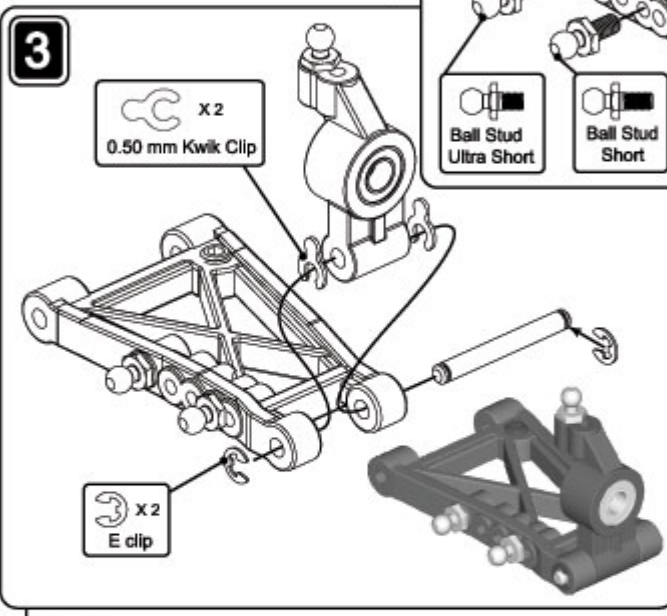
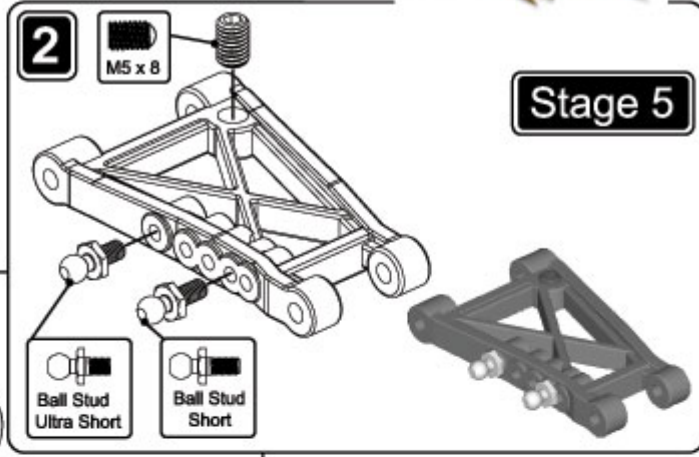
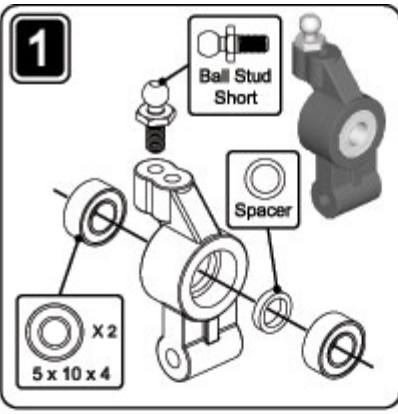



Stage 5 cont..

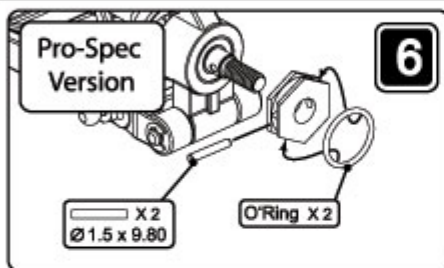
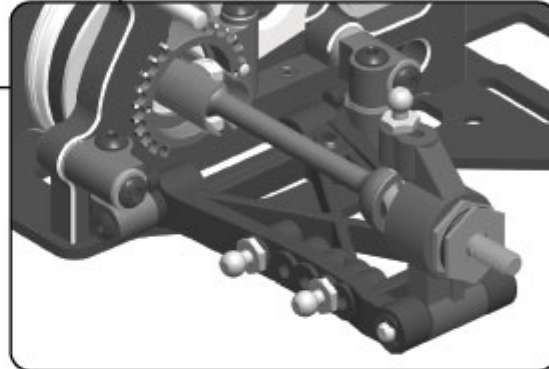
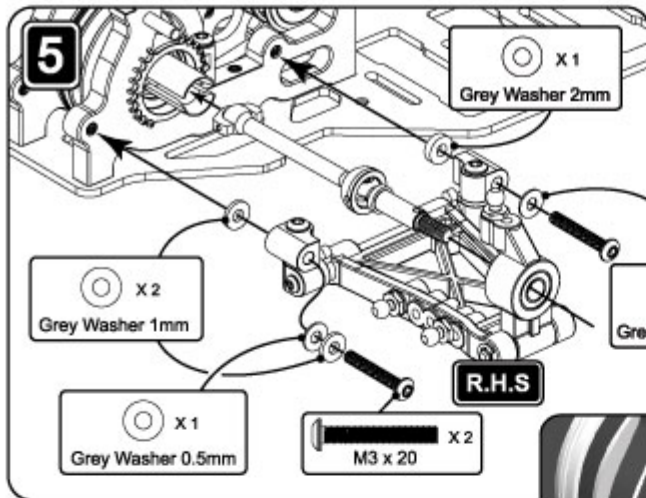

**Rear Suspension
Left hand Side**

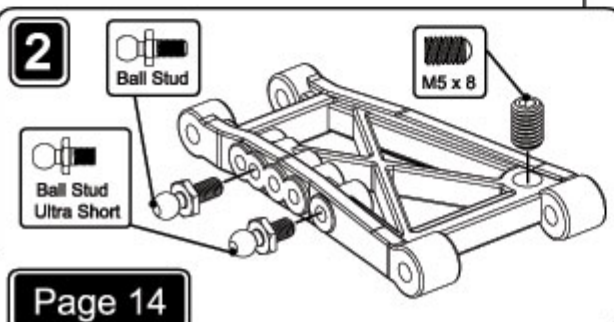
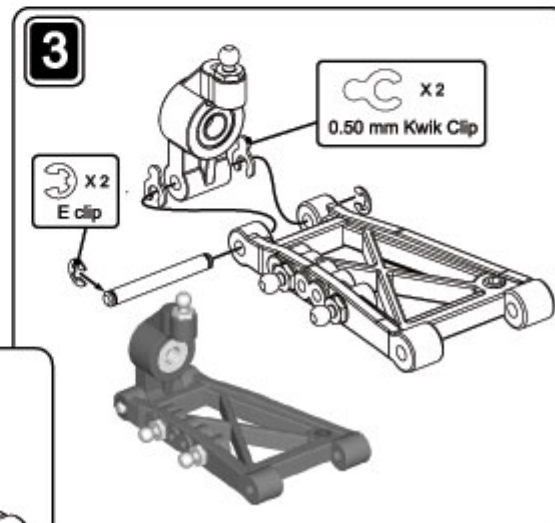
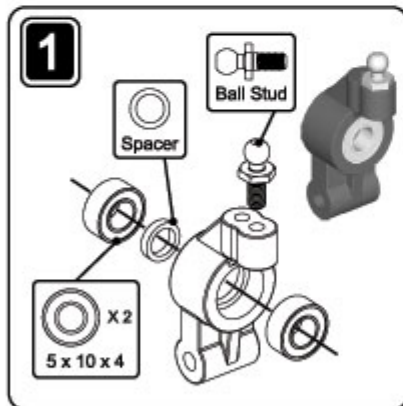

www.racing-cars.com

4

ENSURE THAT THE BLOCKS ARE CORRECTLY ASSEMBLED

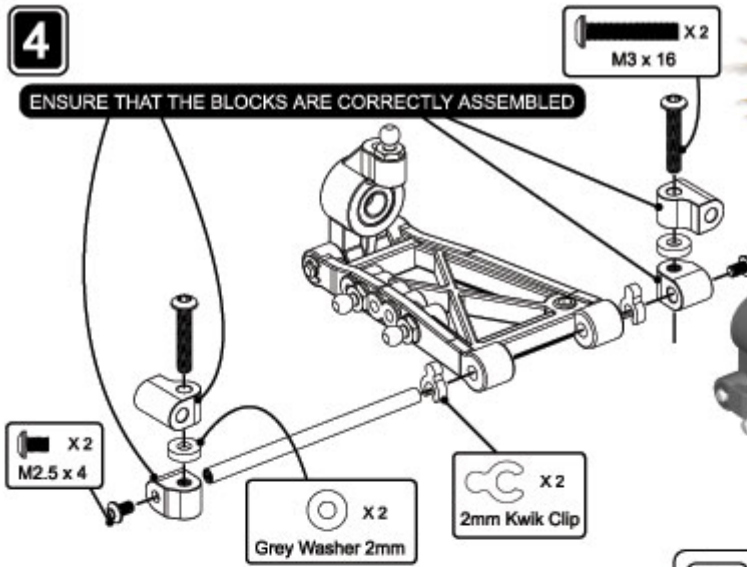

Stage 5 cont..

6

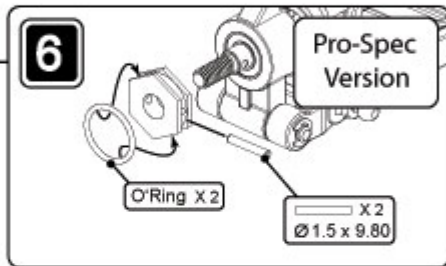

5

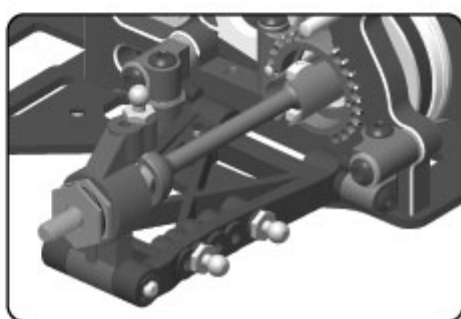
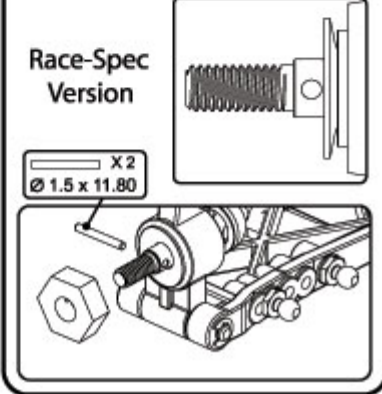
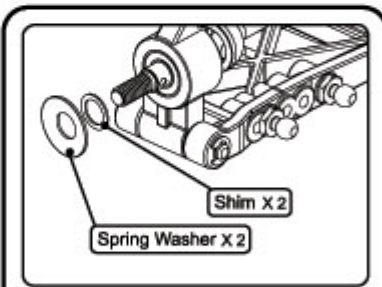
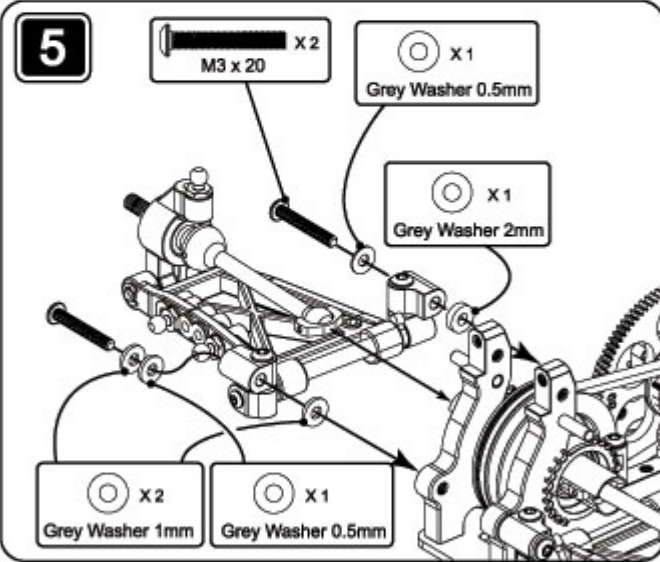

www.racing-cars.com

Page 15



1 Front Suspension Right hand Side

mi3.5

Stage 6

Carefully Pre-tap the Hub Carrier using a Nut Runner and the M4 Pivot, this will ensure easier assembly with the yoke with better alignment.

Ensure Free Movement of the Hub in the Yoke

Adjust the kingpins for minimum gap with free movement

M4 Pivot Ball

Ball Stud

Spacer

M3 Nyloc

5 x 10 x 4 X 2

M4 Pivot

Minimum Gap

Minimum Gap

Left Right

2

O'Ring

Ø 1.5 x 9.80

Pro-Spec Version

Spring Washer

Shim

Ø 1.5 x 11.80

Race-Spec Version

3

Hub Must Lean Backwards

M5 x 8

Ball Stud Ultra Short

Ball Stud

X 2 E clip

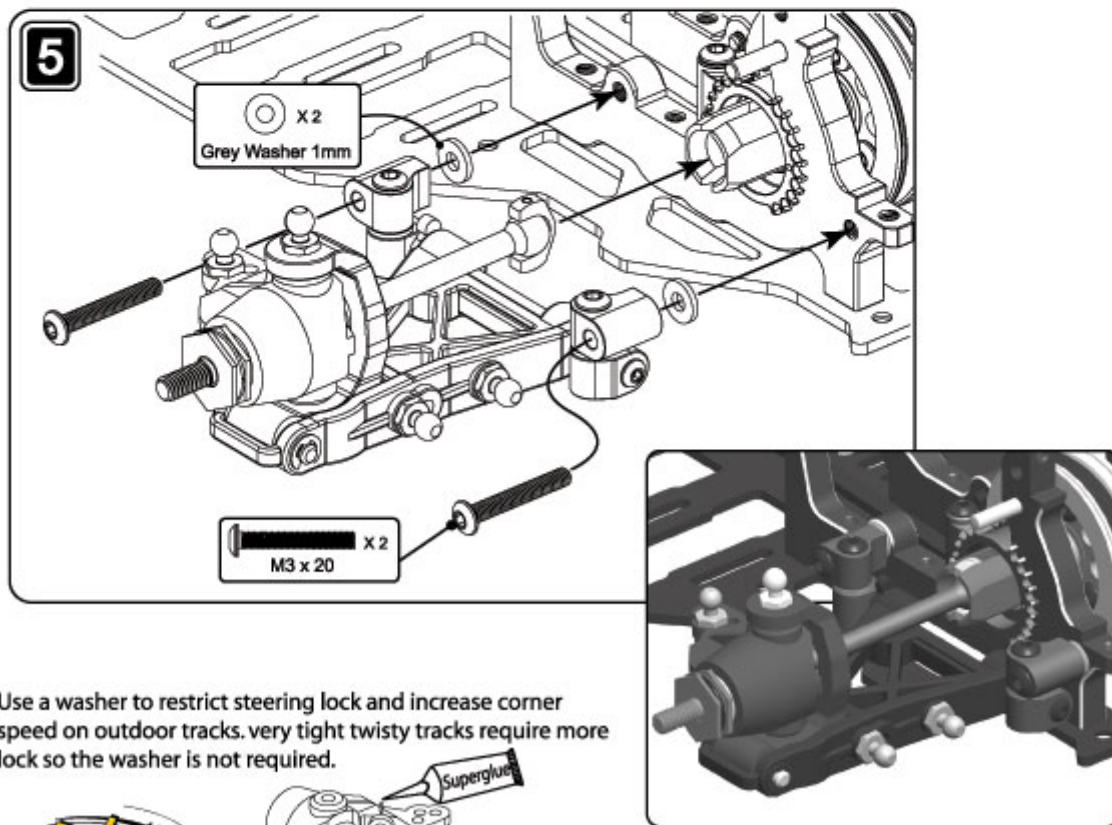
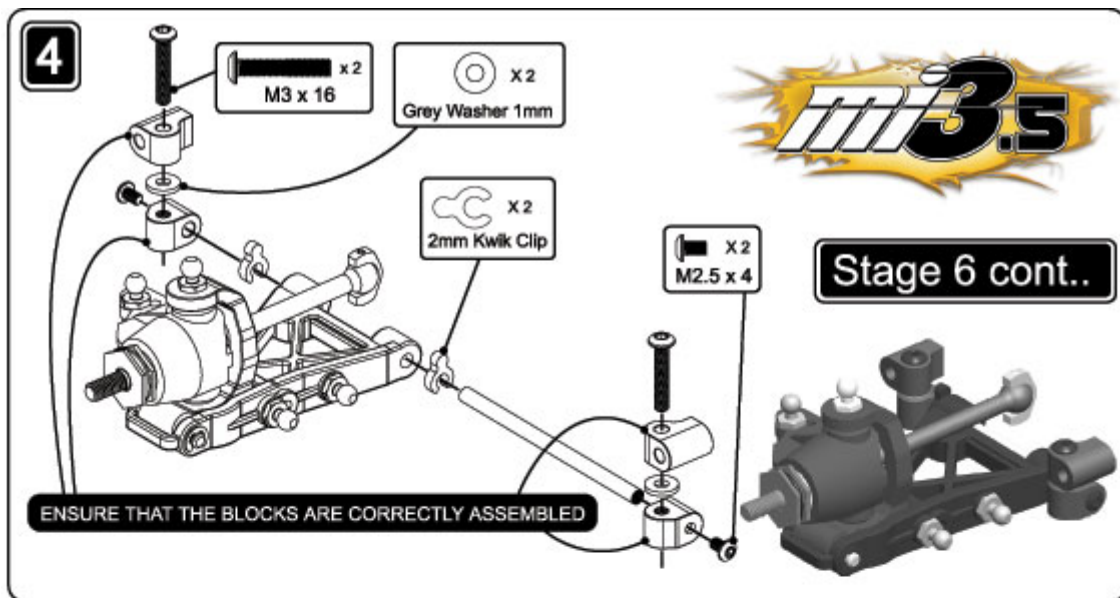

Use a washer to restrict steering lock and increase corner speed on outdoor tracks. very tight twisty tracks require more lock so the washer is not required.



www.racing-cars.com

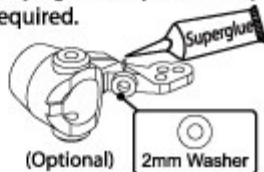

1 Front Suspension Left hand Side

Ensure Free Movement of the Hub in the Yoke

Carefully Pre-tap the Hub Carrier using a Nut Runner and the M4 Pivot, this will ensure easier assembly with the yoke with better alignment.

M4 Pivot Ball

Ball Stud

Left Right

Spacer

M3 Nyloc

M4 Pivot

X 2
5 x 10 x 4

Stage 6 cont...

Minimum Gap

Minimum Gap

Adjust the kingpins for minimum gap with free movement

2

Pro-Spec Version

Race-Spec Version

Shim

Spring Washer

Ø 1.5 x 9.80

O'Ring

3

M5 x 8

Ball Stud Ultra Short

Ball Stud

X 2
E clip

Hub Must Lean Backwards

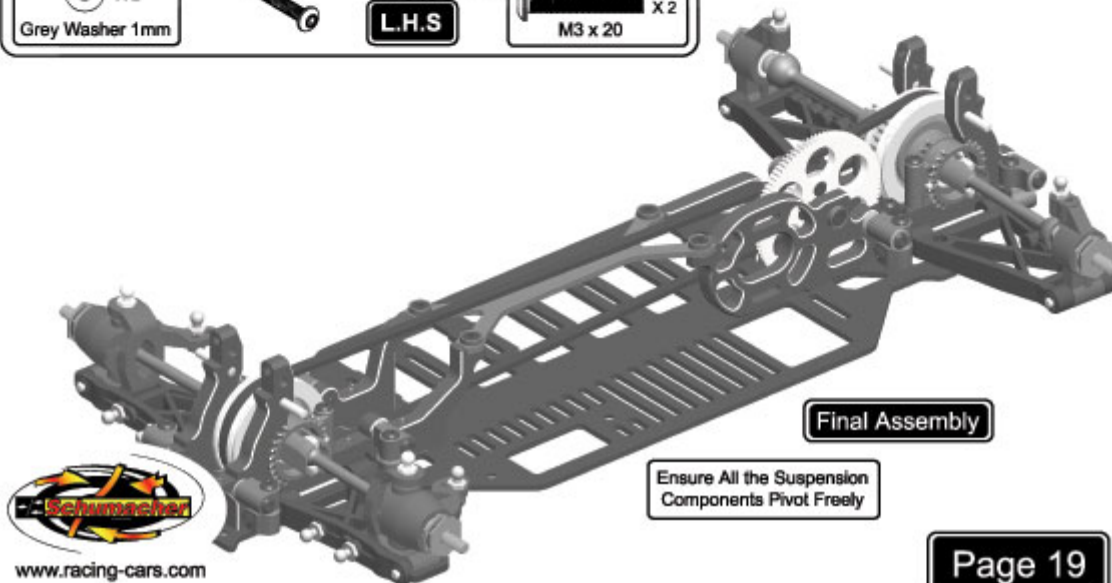
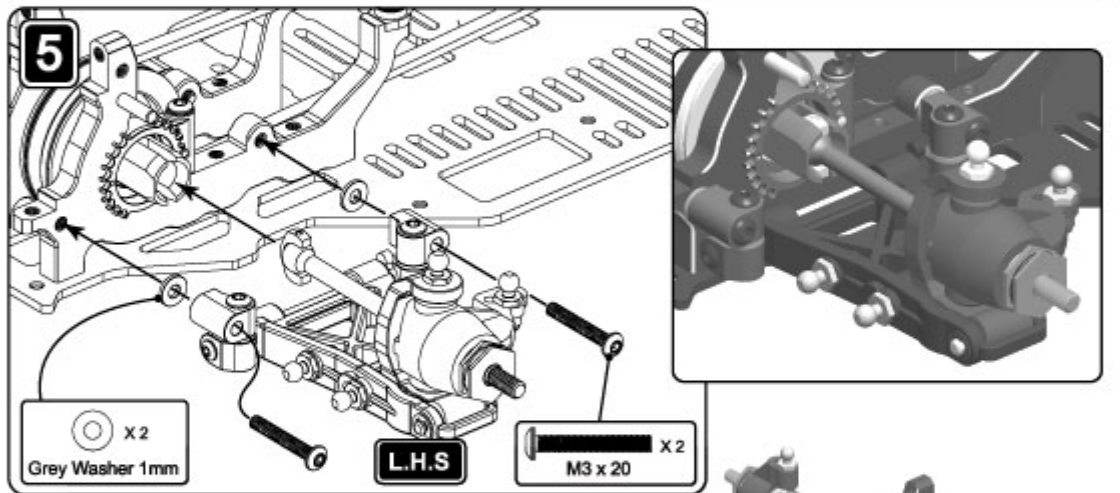
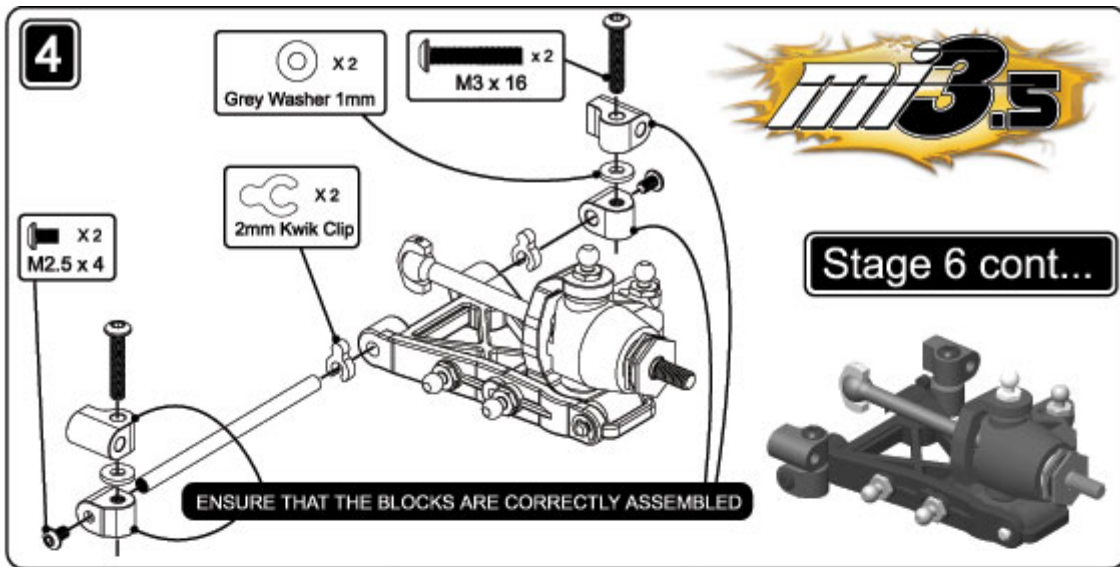

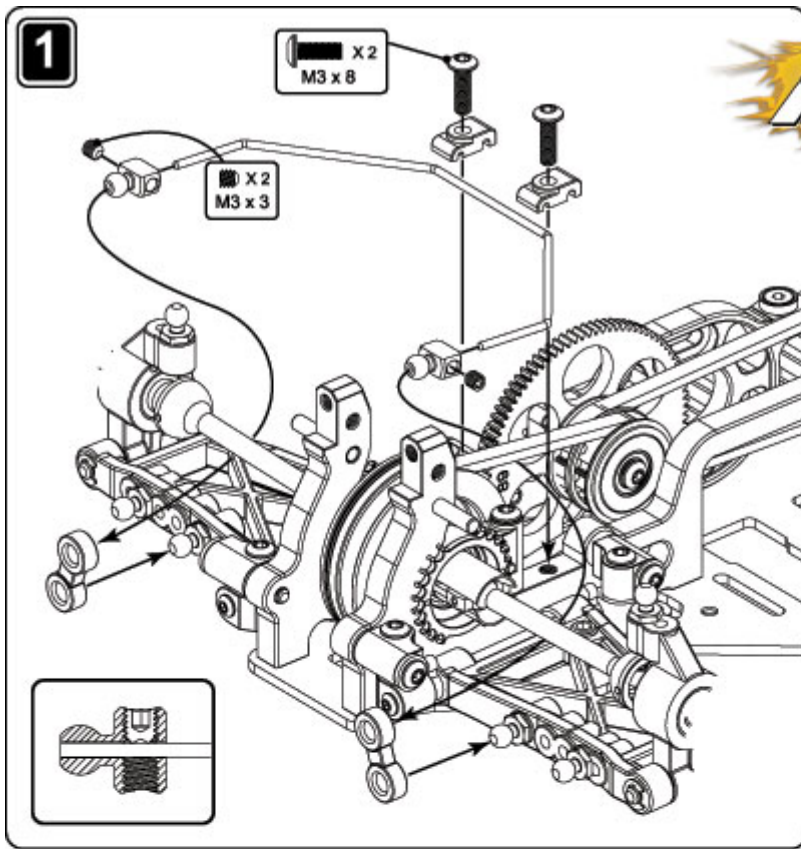

Stage 7
Pro-Spec



Rear Roll Bar
Full Size

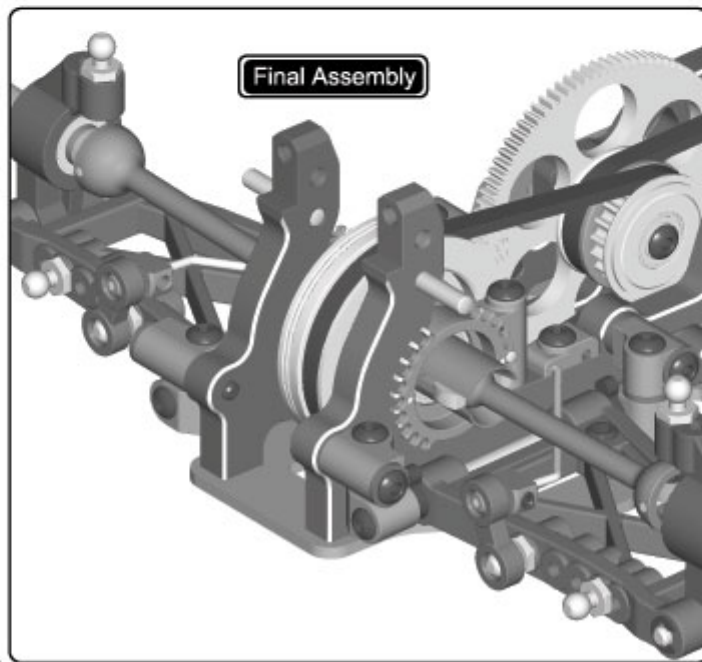

Final Assembly

Page 20



www.racing-cars.com



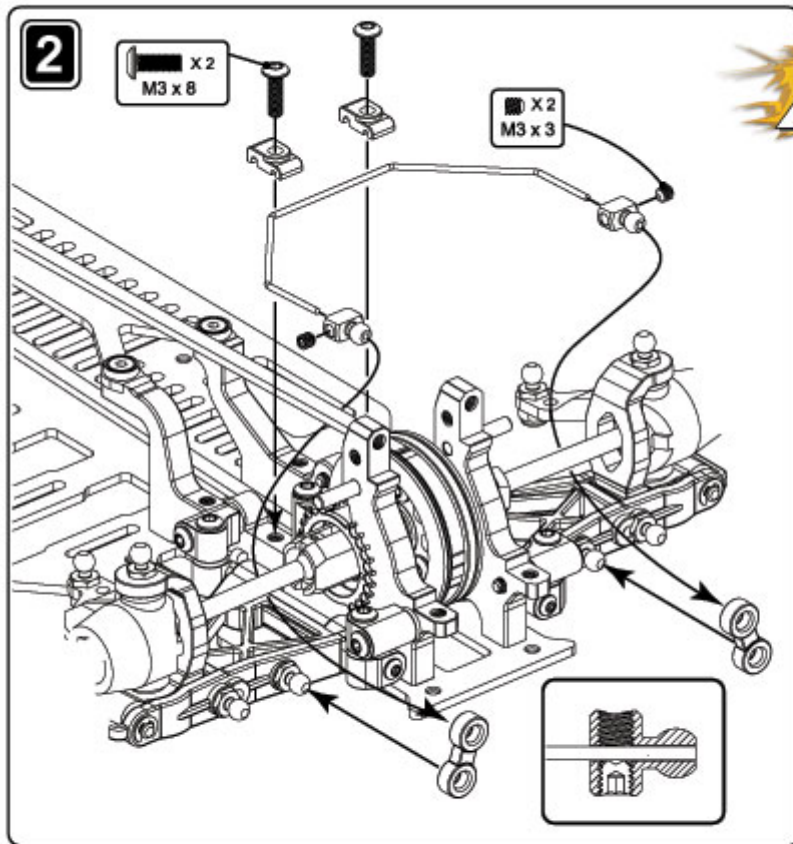

Stage 7 cont..
Pro-Spec

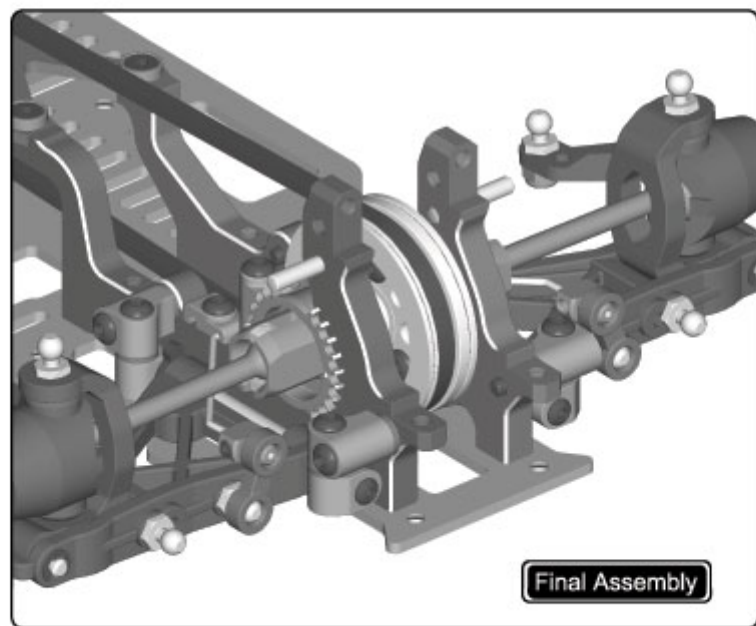
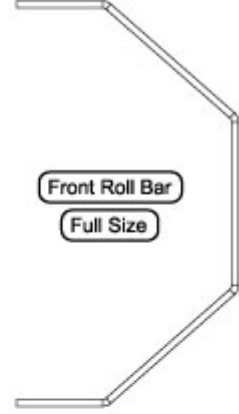

Final Assembly



www.racing-cars.com



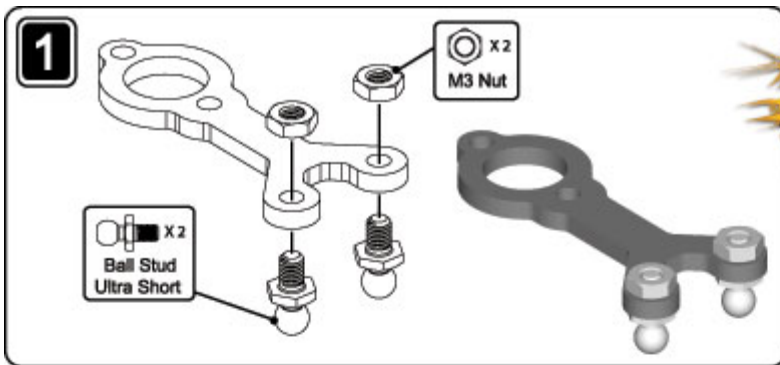

Stage 8

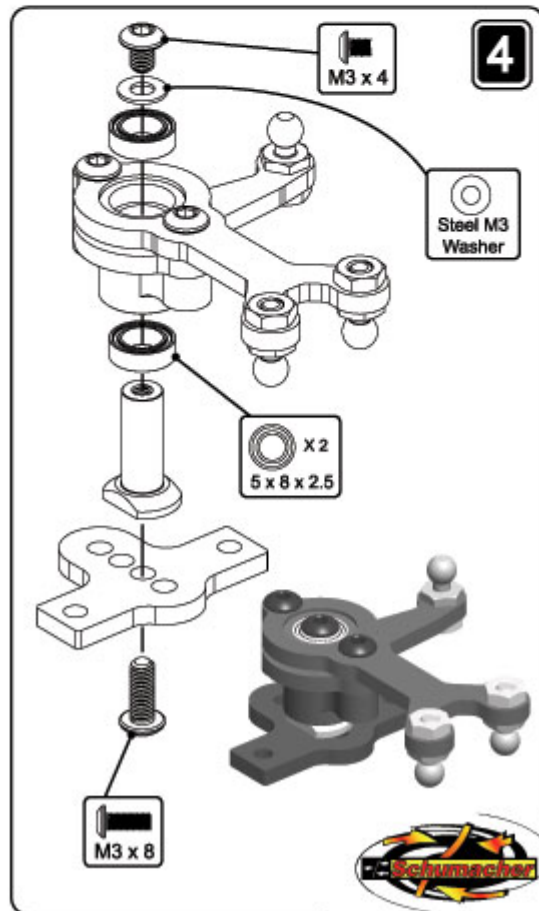
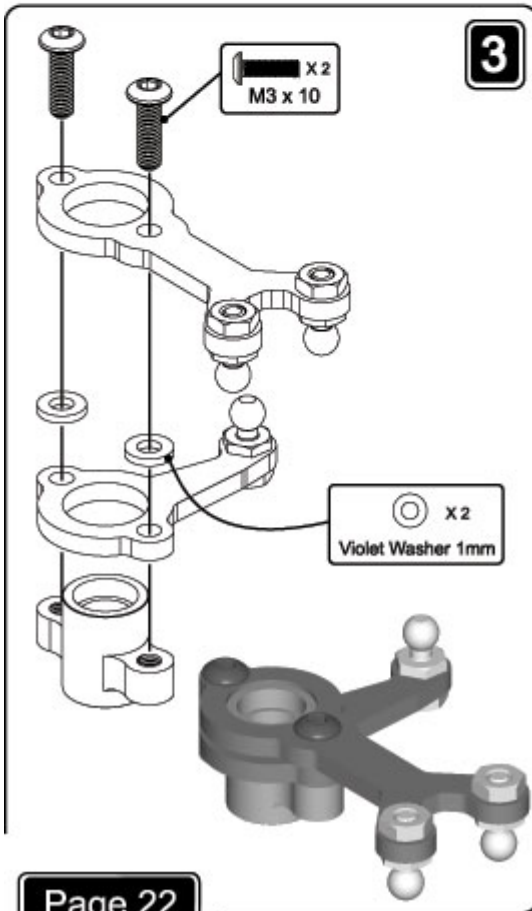
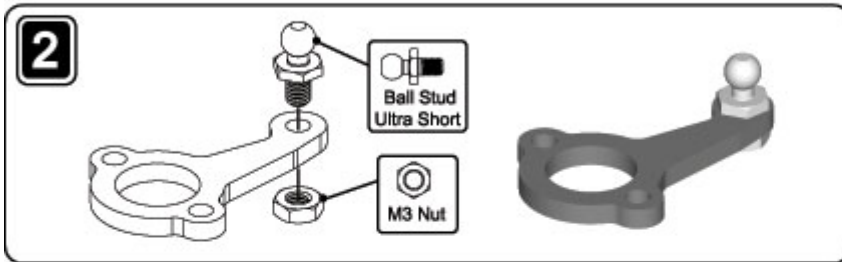

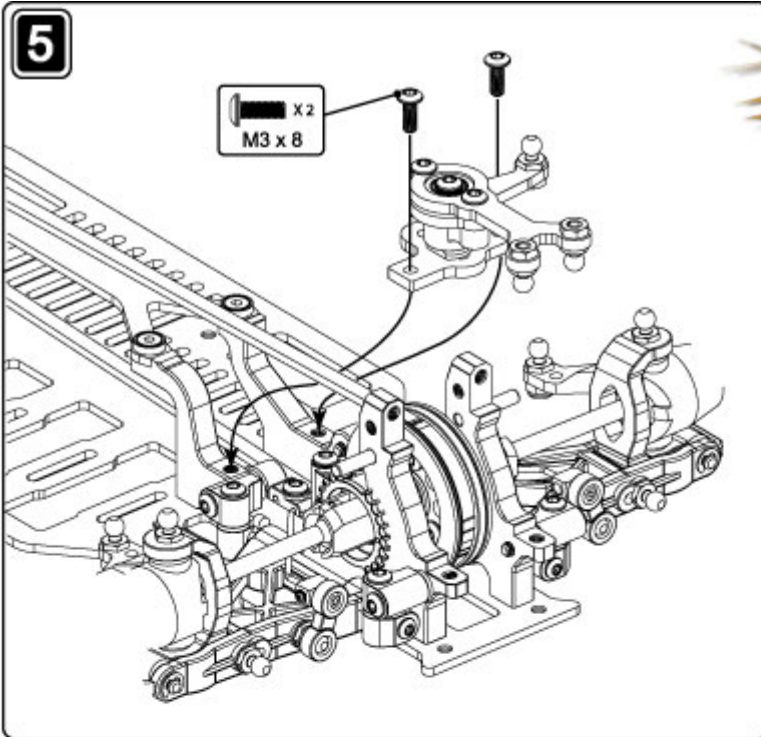

Stage 8 cont...

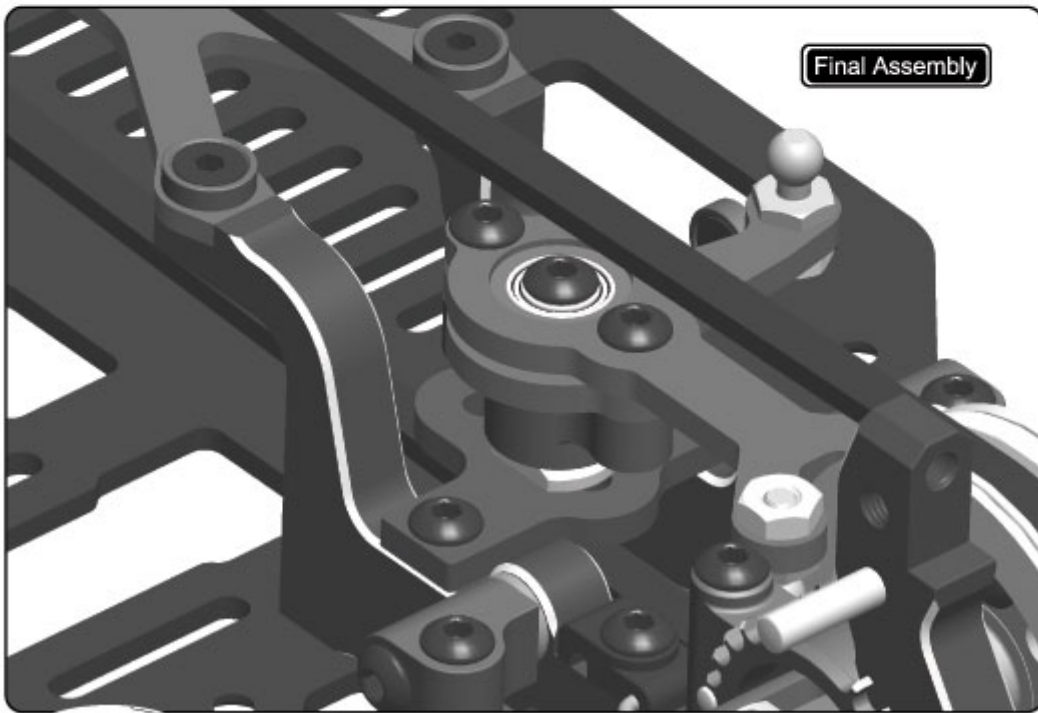

www.racing-cars.com

Page 23



1

Violet Washer 2mm

Violet Washer 0.50mm

Ball Stud

Use the Long Ball stud if using more washers

2

15.00mm (Rear Link)

35mm Tumbuckle

mi3.5

Stage 9

3

X 2 Grey Washer 1mm

X 4 Grey Washer 2mm

X 2 M3 x 16

X 2 Grey Washer 0.5mm

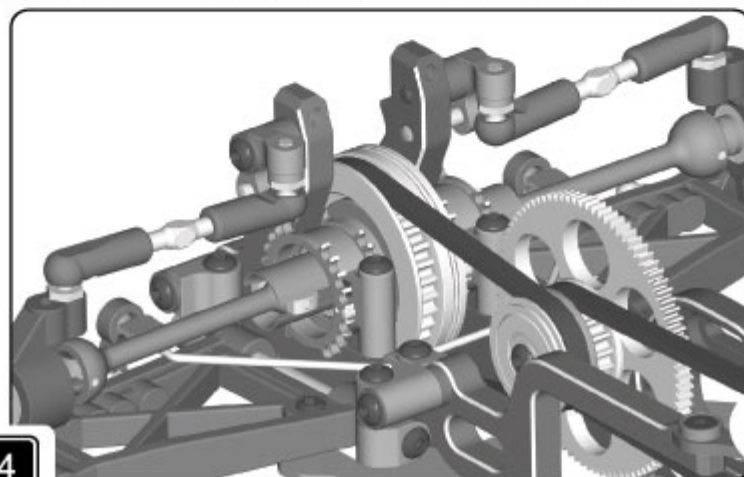

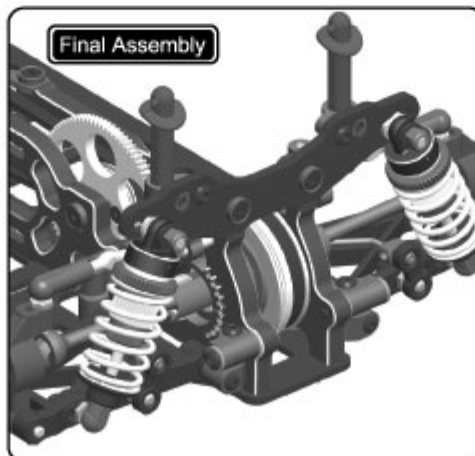
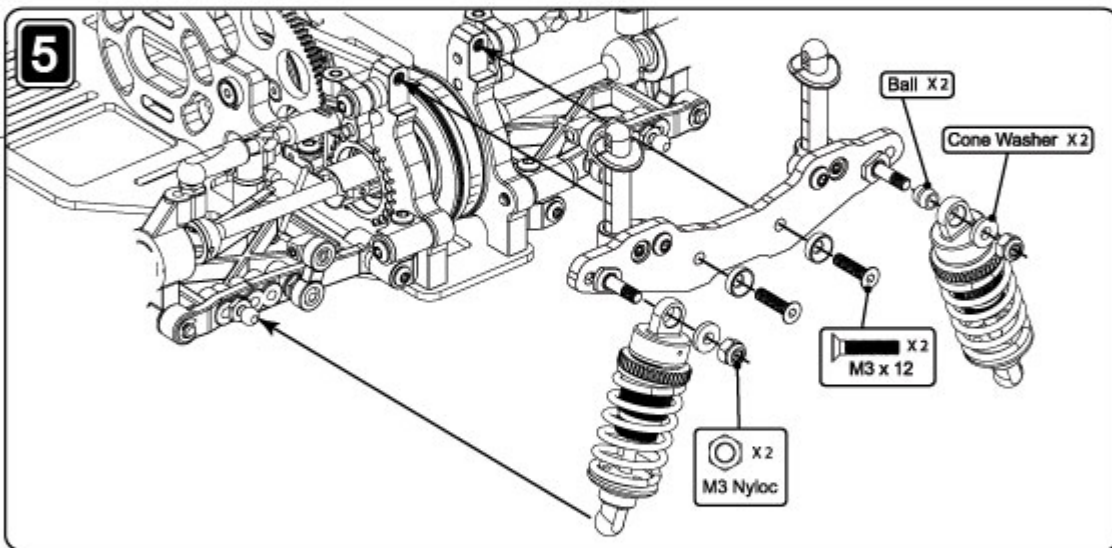
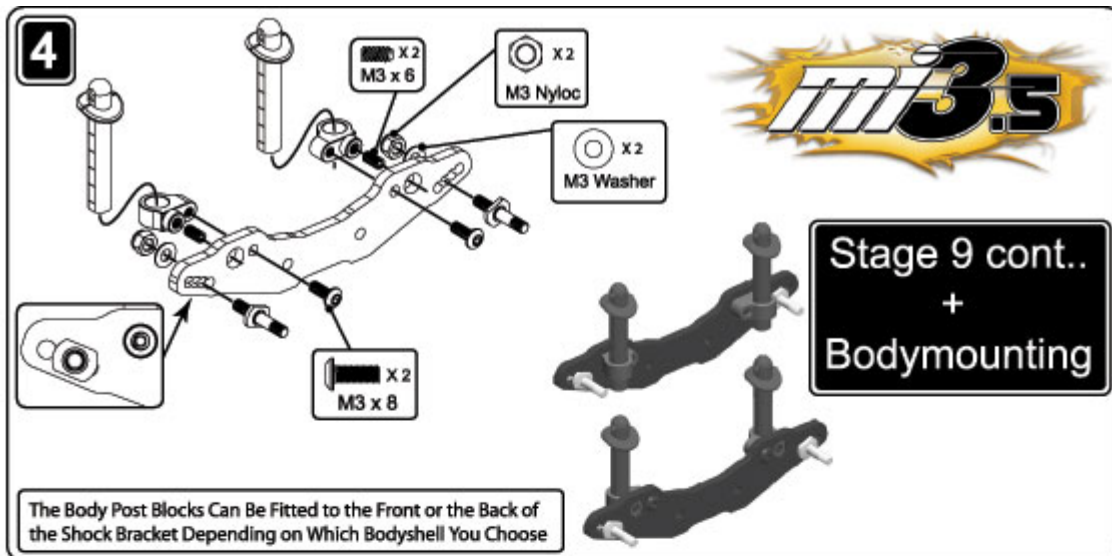

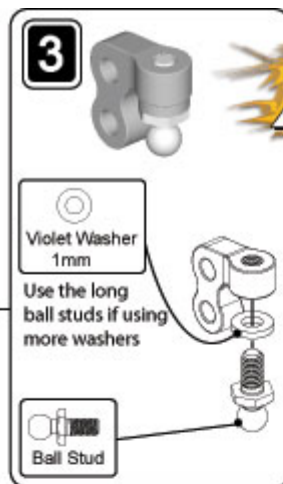
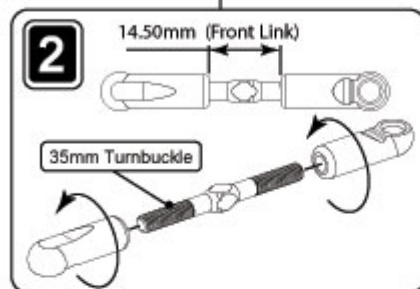
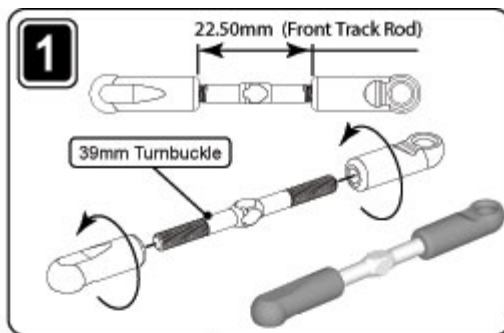

Stage 10

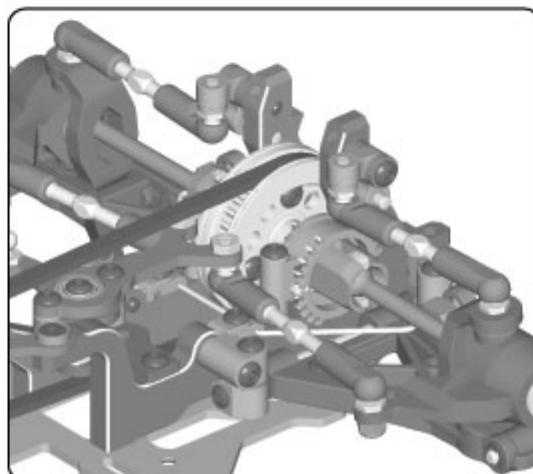
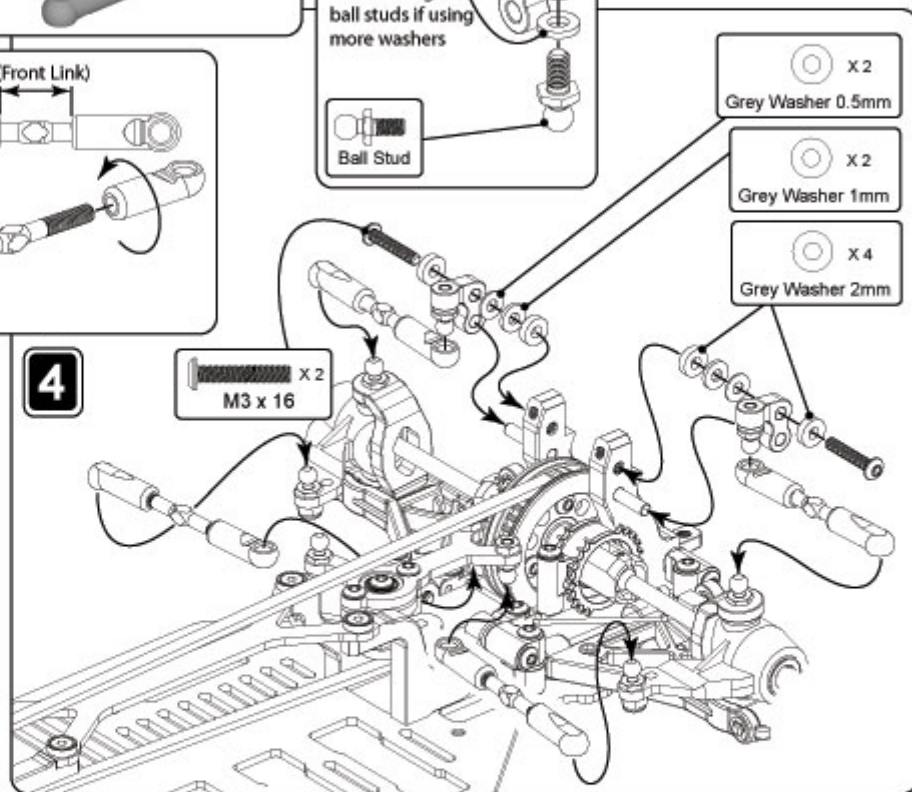

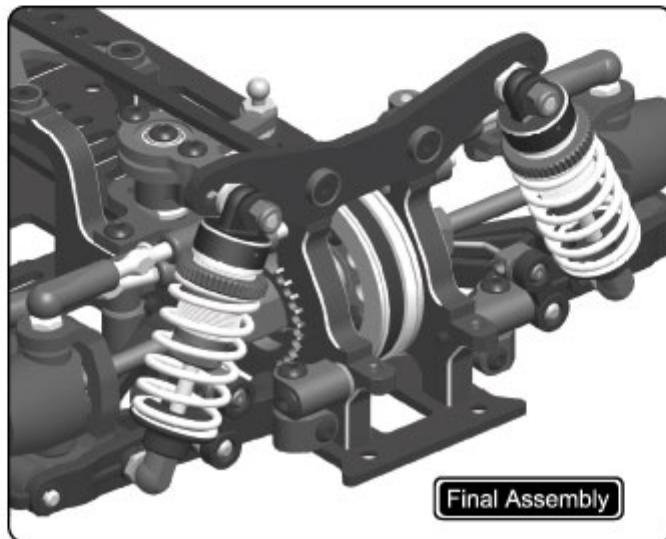
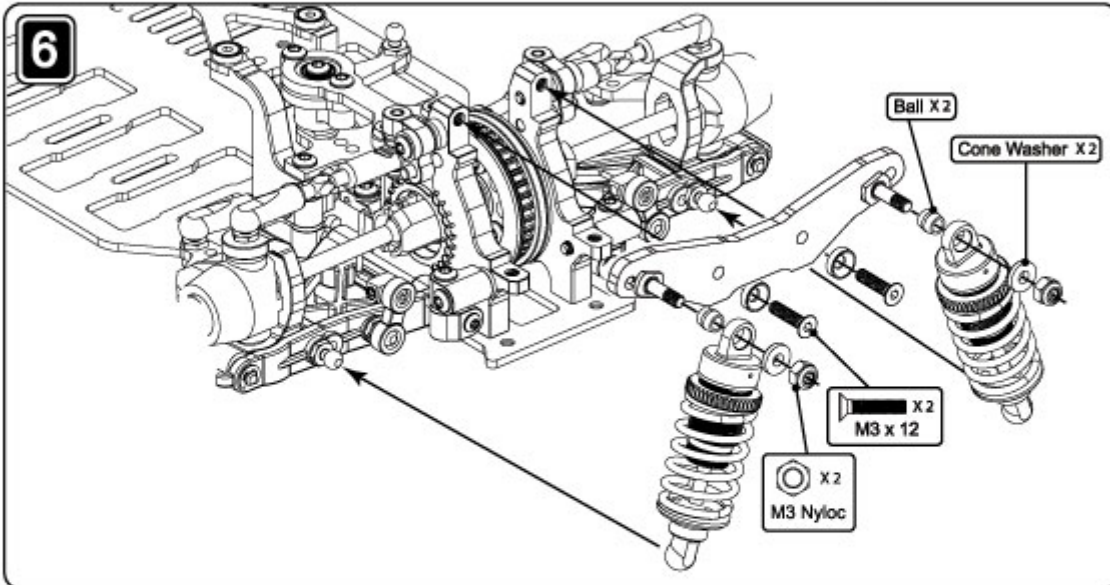
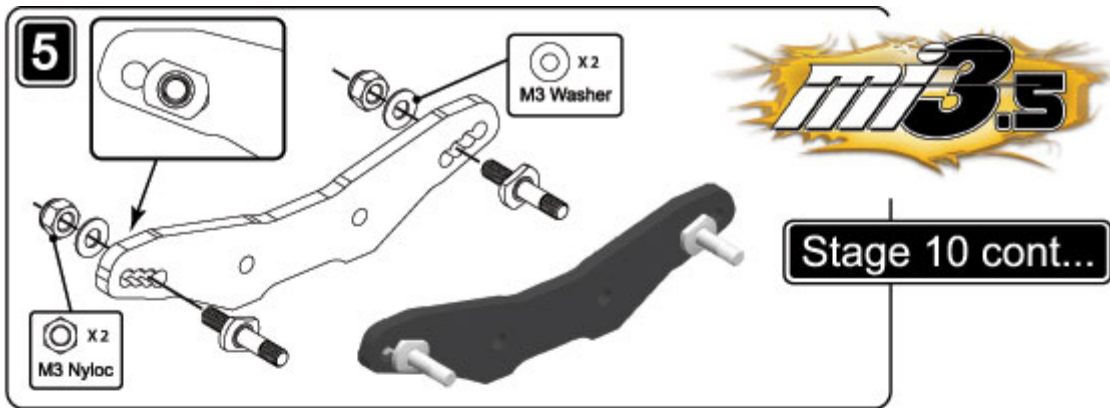

www.racing-cars.com

Page 27

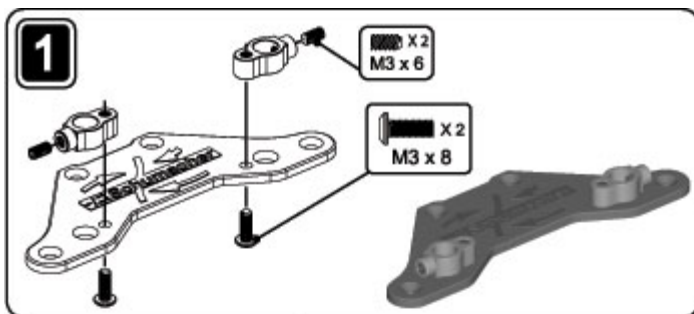

Front Body Mounts and Bumper

2

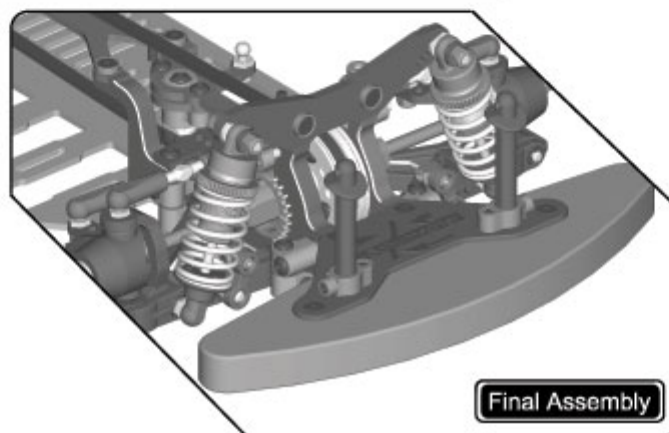
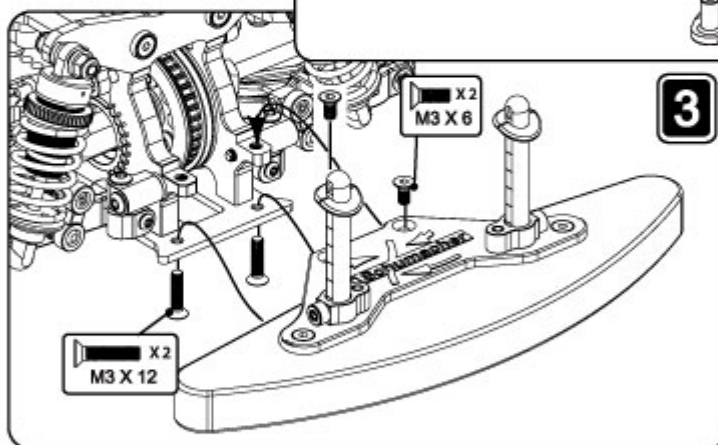
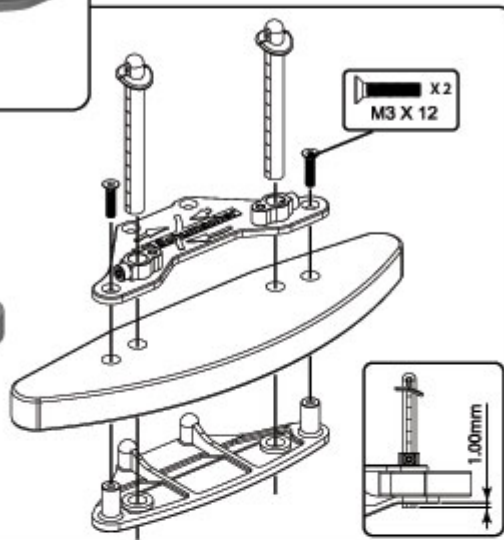

1

SERVO SAVER OPTION

CHOOSE THE CORRECT HORN FOR YOUR SERVO.
SA = SANWA/AIRTRONICS
FU = FUTABA
SH = SCHUMACHER/HITEC

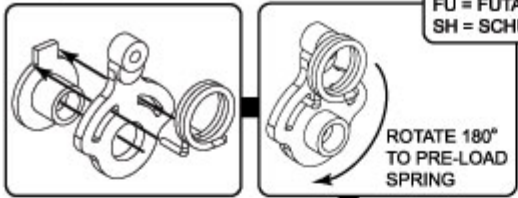

ROTATE 180° TO PRE-LOAD SPRING

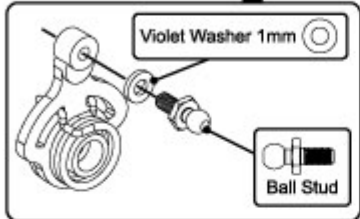

Violet Washer 1mm

Ball Stud



Radio Installation

1

NON SERVO SAVER OPTION



Ball Stud

X 2
M3 Nyloc

2

The Servo is NOT Included

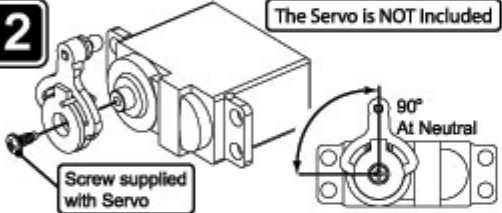

Screw supplied with Servo

90° At Neutral

2

The Servo is NOT Included

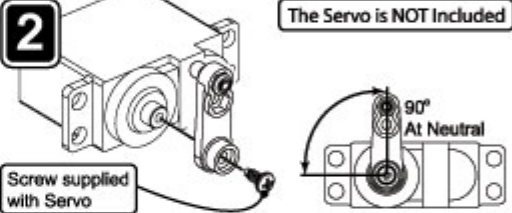

Screw supplied with Servo

90° At Neutral

3

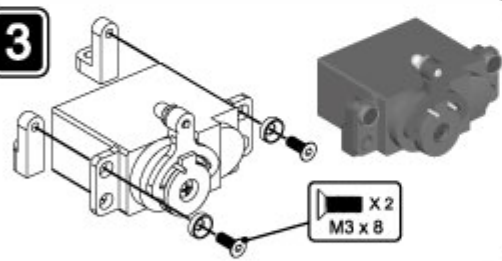

X 2
M3 x 8

3

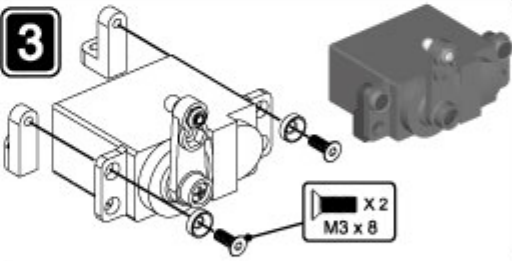

X 2
M3 x 8

4

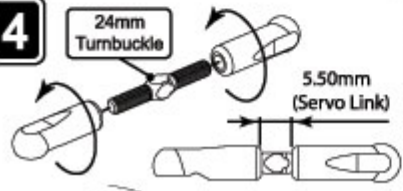

24mm Turnbuckle

5.50mm (Servo Link)



www.racing-cars.com

5

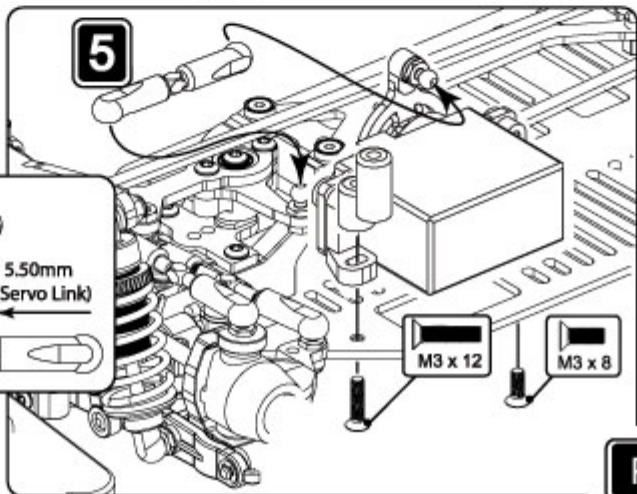

M3 x 12

M3 x 8

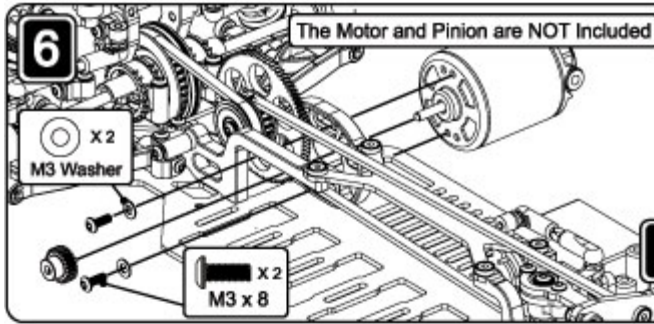

Radio Installation cont...

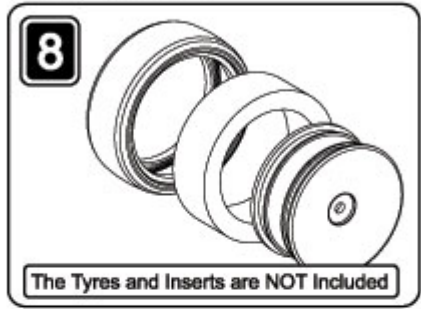
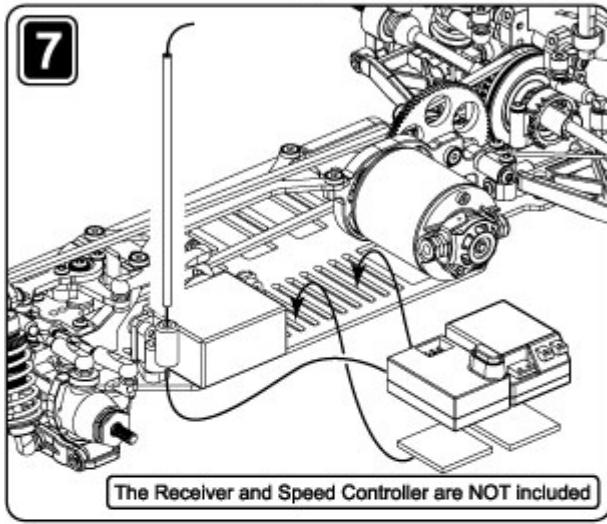

When using the 5 Cell Chassis fit the Receiver behind the Cells.

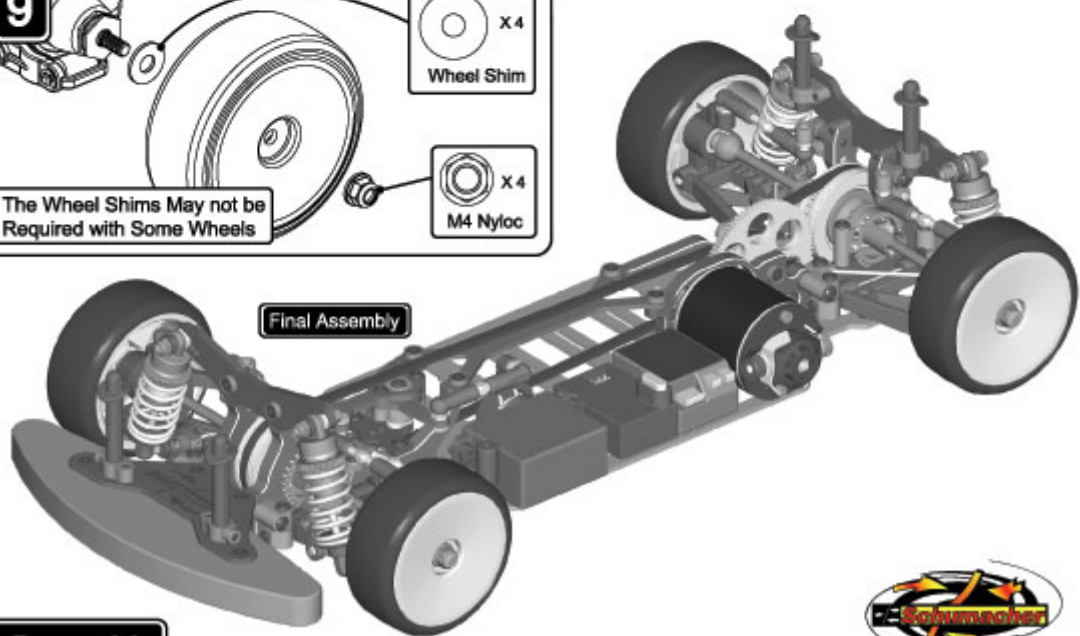

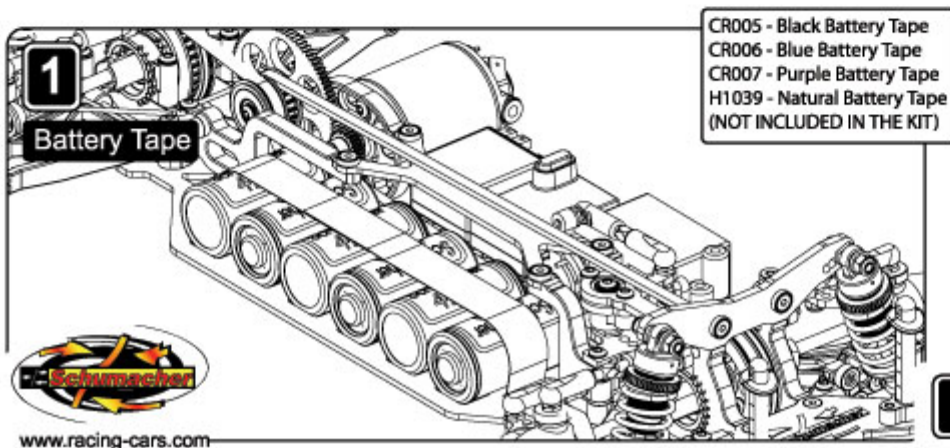
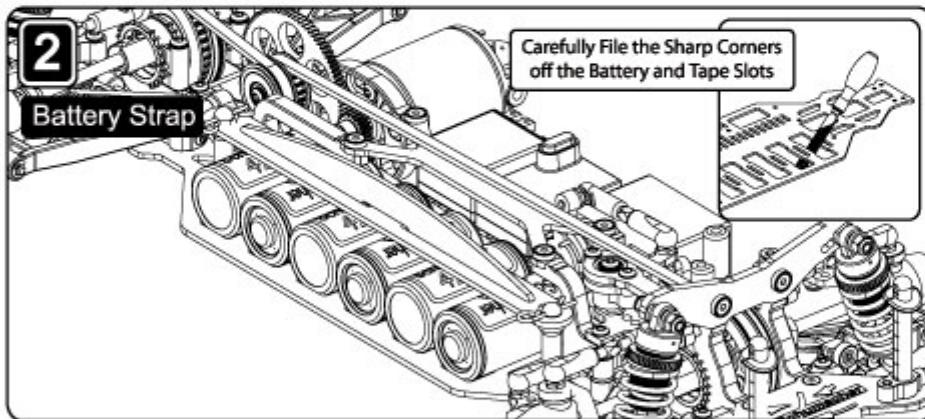
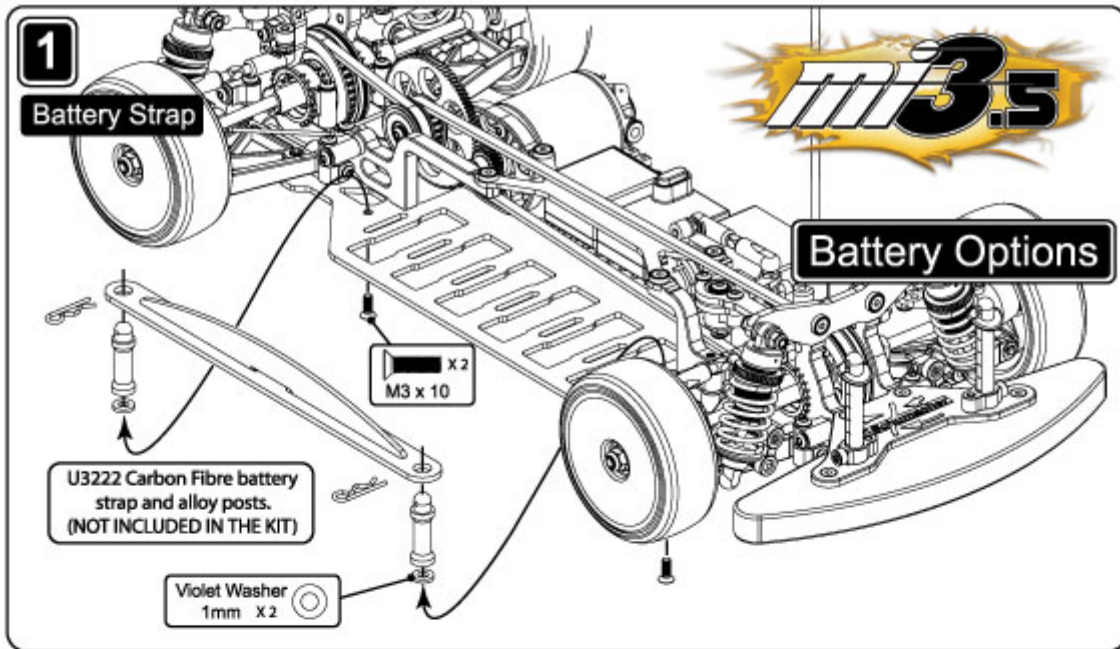

SPRINGS

The spring rate controls the suspension stiffness. Spring adjusters only change the ride height. They DO NOT alter the suspension stiffness. On slippery or bumpy tracks use soft to medium rate springs, on flat or high grip tracks run medium to hard rate springs.

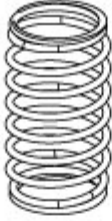

STEERING

With the Ball centres Closer together you will get a more aggressive steering response, and further apart will give a less aggressive steering response. The options are available when you purchase, U3135 Steering Set



Track Settings

FRONT CASTOR

The front castor can be altered by changing the yoke. The car comes with 4° castor as standard. Less castor will give a quicker steering response, but could lead to power on understeer. More castor will give the opposite, slightly slower turn in, but more power on steering.

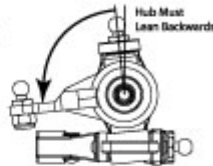

SHOCK BRACKETS (Shock Mounting)

Vertical shock absorbers make the car react sharply to driver inputs.

A laydown shock offers a softer feel to the driver.

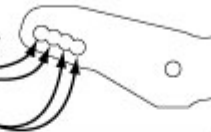

RIDE HEIGHT

In general always run the car as low as possible, without the chassis grounding out, as it rolls into corners.

A good starting point with rubber tyres is 5.5mm at the front and 6.0mm at the rear.

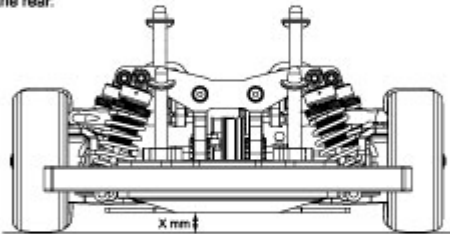

FRONT & REAR CAMBER

With maximum negative camber the car will have high levels of grip, but there may be the possibility of sudden breakaway in corners. Reducing the camber gives a more progressive slide, but may give less grip.

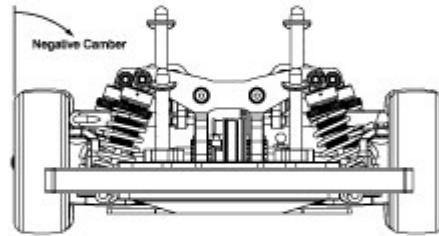

FRONT TOE-IN (Out-board)

The front toe-in is set by adjusting the steering trackrod tumbuckles.

Toe-In = A less than B
Toe-Out = A greater than B

Toe-in will give a more stable car, but will give less sharp turn in. Toe-out will give the opposite, less stability with sharper turn in to the corners. We recommend to start at about 0° or 1° toe-out.

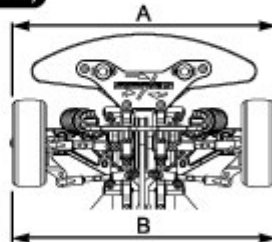

FRONT AND REAR TRACK WIDTH

TRACK WIDTH ADJUSTMENT (In-board)

The track width of the car may be altered by adding or removing equal thickness grey suspension washers between the Screw blocks and the transmission housings. When changing the track width ensure the driveshafts are fully engaged in the Diff outputs. And the width does not exceed 190mm

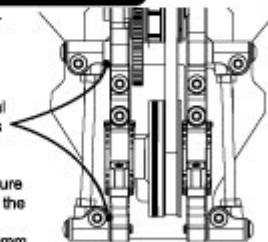

FRONT AND REAR WHEELBASE

WHEELBASE ADJUSTMENT (In-board)

The wheelbase may be adjusted by moving the Qwik clips to either the front or the back of the wishbones. This alters the front to rear weight Balance of the car.

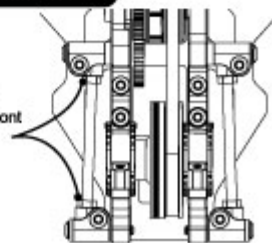

FRONT AND REAR INBOARD TOE-IN

TOE IN (In-board)

The toe-in is set by adding or removing the grey suspension washers between the Screw blocks and the transmission housings, at the front or rear of the wishbones. Each 0.50mm washer will change the Toe in by Approx 0.60°

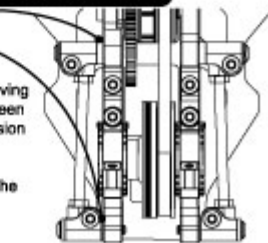

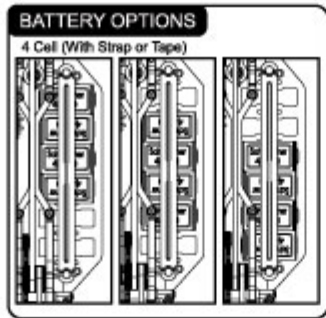
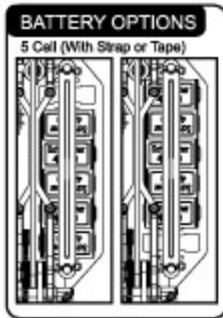

Track Settings

GEAR CHART 48Dp Maximum Tooth Sum = 121.....Minimum Tooth Sum = 91.....Internal Ratio = 1.8:1

	14	15	16	17	18	19	20	21	22	23	24	25	26	27	28	29	30	31	32	33	34	35	36	37	38	
89	11.44	10.68	10.01	9.42	8.90	8.43	8.01	7.63	7.28	6.97	6.68	6.41	6.16	5.93	5.72	5.52	5.34	5.17	5.01							
87	11.16	10.44	9.79	9.21	8.70	8.24	7.83	7.46	7.12	6.81	6.53	6.26	6.02	5.80	5.59	5.40	5.22	5.05	4.89	4.75	4.61					
85	10.92	10.20	9.56	9.00	8.50	8.05	7.65	7.29	6.95	6.65	6.38	6.12	5.88	5.67	5.46	5.28	5.10	4.94	4.78	4.64	4.50	4.37	4.25			
70								6.00	5.73	5.48	5.25	5.04	4.85	4.67	4.50	4.34	4.20	4.06	3.94	3.82	3.71	3.60	3.50	3.41	3.32	
66													4.75	4.57	4.40	4.24	4.10	3.96	3.83	3.71	3.60	3.49	3.39	3.30	3.21	3.13

GEAR CHART 64Dp Maximum Tooth Sum = 161.....Minimum Tooth Sum = 121.....Internal Ratio = 1.8:1

	19	20	21	22	23	24	25	26	27	28	29	30	31	32	33	34	35	36	37	38	39	40	41	42	43	44	45	46	47	48	49	50	
118	11.16	10.62	10.11	9.65	9.23	8.85	8.50	8.17	7.87	7.58	7.32	7.08	6.85	6.64	6.44	6.25	6.07	5.90	5.74	5.58	5.44	5.31	5.18	5.05	4.93								
116	10.99	10.44	9.94	9.49	9.08	8.70	8.35	8.03	7.73	7.46	7.20	6.96	6.74	6.53	6.33	6.14	5.97	5.80	5.64	5.49	5.35	5.22	5.09	4.97	4.85	4.75	4.64						
114	10.80	10.26	9.77	9.33	8.92	8.55	8.21	7.89	7.60	7.33	7.08	6.84	6.62	6.41	6.22	6.04	5.86	5.70	5.54	5.40	5.26	5.13	5.00	4.88	4.77	4.66	4.56	4.46	4.37				
106	10.04	9.54	9.08	8.67	8.30	7.96	7.63	7.34	7.07	6.81	6.56	6.36	6.15	5.96	5.78	5.61	5.45	5.30	5.16	5.02	4.89	4.77	4.65	4.54	4.44	4.34	4.24	4.15	4.06	3.96	3.89	3.82	
96						6.91	6.65	6.40	6.17	5.96	5.76	5.57	5.40	5.24	5.08	4.94	4.80	4.67	4.55	4.43	4.32	4.21	4.11	4.02	3.93	3.84	3.76	3.68	3.60	3.53	3.46		
90												5.23	5.06	4.91	4.76	4.63	4.50	4.38	4.26	4.15	4.05	3.95	3.85	3.77	3.68	3.60	3.52	3.45	3.38	3.31	3.24		

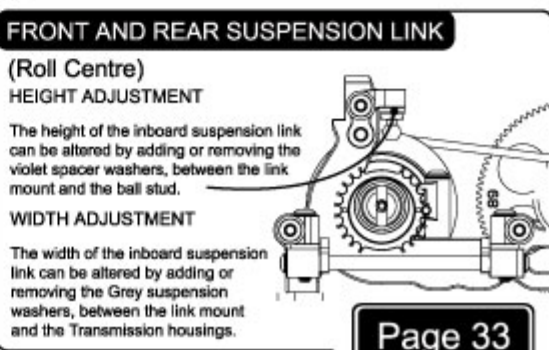
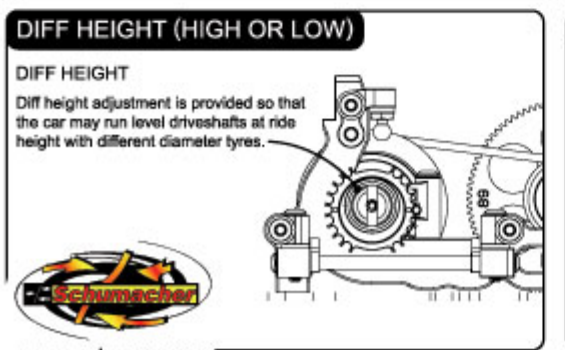
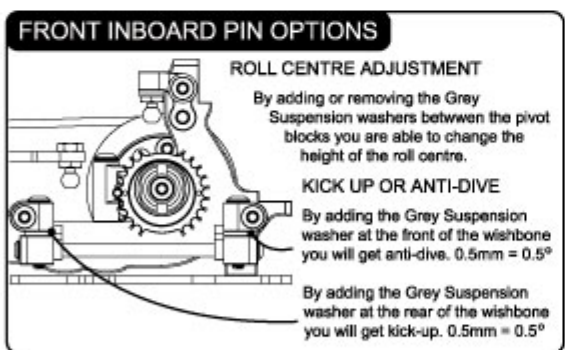

ELECTRIC - TOURING CARS

K080	Mi-3.5 Pro-CF - 1-10 4WD Trg 6 cell
K081	Mi-3.5 Pro-CF - 1-10 4WD Trg 5 Cell
K082	Mi-3.5 Race-S1 - 1-10 4WD Touring Car

CHASSIS PARTS

U1042	Aerial Mount - Universal
U1119	Aerial Tube - Pack 4
U2244	Servo Mounts (pr)
U2280	SpeedFlex Rr Belt5mm - C3K
U2980	Ball Grippa Sockets - (pk 8)
U3145	CF Chassis - 2.0mm Kit - Mi-3
U3150	CF Shock Bkt; Front - Mi-3 Kit
U3151	CF Shock Bkt; Rear - Mi-3 Kit
U3154	Foam Bumper - Mi-3
U3155	Front Bumper Mouldings - Mi-3
U3158	Alloy Body Post Block; Horizontal Mount - Mi-3 (pr)
U3159	Alloy Body Post Block; Vertical Mount - Mi-3 (pr)
U3271	CF Lipo Battery Locater (pr)
U3272	CF 2008 Euro Chassis - 5 cell - Mi-3
U3273	CF 2008 Euro Top Deck - Mi-3
U3274	CF 2008 Flex Top Deck - Mi-3
U3278	Chassis; S1 6 cell - Mi-3.5
U3279	Top deck; S1 - Mi-3.5
U3280	Shock Bracket; Front S1 - Mi-3.5
U3281	Shock Bracket; Rear S1 - Mi-3.5
U3282	Steering Post Set - Mi-3.5 S1
U3283	Instr Manual - Mi-3.5

BODYSHELLS & DECALS

EC16283121	East Coast - Body; k250 190mm
EC16283122	East Coast - Body; Euro-R 190mm
EC16283123	East Coast - Body; S20s 190mm
EC16283126	East Coast - Body; Speed 6 190mm
EC16283129	East Coast - Body; Evo0x 190mm
EC16283212	East Coast - Body; Euro-R 200mm
EC16283206	East Coast - Body; S502 190mm
EC16283208	East Coast - Body; RK7 190mm
EC16283209	East Coast - Body; S15 190mm
EC38826B	East Coast - Half Paint; Blue; Speed 6 190mm
EC38826R	East Coast - Half Paint; Red; Speed 6 190mm
U3167	Decal Sheet - Mi-3 (pk3)

SUSPENSION

U1430	Tumbuckle Adjuster - 30mm (pr)
U1440	Pro Pin; grooved 1/8x25mm (pr)
U2664	Steering Yoke Pivot Set - 2 pairs
U2718	Pro Pin; Grooved 1/8x18mm (pr)
U2722	Ball Grippa Joints - U/Sh Stud 4prs
U2736	Steering Yoke; 2 degree - Mi-2 pr
U2737	Steering Yoke; Kit Std 4 degree - Mi-2 pr
U2738	Steering Yoke; 6 degree - Mi-2 pr
U2750	Drop Screw; M3x8mm pk4
U2882	Servo Saver Set; Light & Heavy Springs
U2990	Front Hub Carrier - Mi2 E.C.
U2991	Purple Alloy Wheel Hex; Slim (pr)
U2992	Rear Hub Carrier - Mi2 E.C./Mi-3
U3127	Wishbones; Graphite Front - Mi-3
U3128	Wishbones; Graphite Rear - Mi-3
U3129	Alloy Block; Screw - Mi-3 (pr)
U3130	Alloy Block; Pivot - Mi-3 (pr)
U3133	Alloy Top Link Mount - Mi-3 (pr)
U3134	Steering Post Set - Mi-3 CF
U3135	Centre Track Rods; Set 7 - Mi3
U3137	Shock Mounting Post - Mi-3 (pr)
U3142	Pro Pivot Pin - 55mm - Mi-3 (pr)
U3249	Wishbones; Med Flex Front - Mi-3
U3250	Wishbones; Medium Flex Rear - Mi-3
U3251	Wishbones; Extra Flex Front - Mi-3
U3252	Wishbones; Extra Flex Rear - Mi-3
U750	Ball Grippa Joints - Short Stud 8prs
U796	Tumbuckle Adjuster - 24mm (pr)
U797	Tumbuckle Adjuster - 35mm (pr)
U851	Ball Grippa Joints - Long Stud 8prs

TRANSMISSION

U1805	M3x8mm Button Screws & Washers pk4
U1918	Spare Blades
U2573	Pro-Diff Screw Set
U2721	Rear Belt; Black Narrow - Mi-2
U2733	Diff Pulley Fences - Mi-2 & 3
U2746	CNC Diff Pulley - 4mm
U2761	Diff Shims; 10 x 12
U2797	CNC Spool Assy; Lightweight - Mi-2
U2798	CNC Spool Pulley - Mi-2
U3011	Front Belt; 17T x 3.6mm
U3012	Front Belt; Grey Stock 17T x 3.6mm
U3013	Rear Belt; Grey Stock - Mi-2 E.C.
U3026	Pivot; Pin & Screw; Alloy CV D/Shaft
U3123	Alloy Eccentric - Mi-3 (pr)
U3124	Diff Retaining Post - Mi-3 (pr)
U3125	Layshaft Post - Mi-3
U3126	CNC Pulley & Fence; 20T - Mi-3
U3138	Alloy Diff Output; Male - Mi-3
U3139	Alloy Diff Output; Female - Mi-3
U3140	Diff Washer; ProSpec - Mi-3 (pr)
U3141	HD Spool Output - Mi-3
U3160	85T 48DP CNC Spur Gear - Mi-3
U3161	87T 48DP CNC Spur Gear - Mi-3
U3162	89T 48DP CNC Spur Gear - Mi-3
U3163	114T 64DP CNC Spur Gear - Mi-3
U3164	116T 64dp CNC Spur Gear - Mi-3
U3165	118T 64dp CNC Spur Gear - Mi-3
U3170	Pins & Shims; Aisle - Mi-3 Apr
U3223	Diff; Fully Assembled Ceramic - Mi3
U3225	CNC Spool Assembly HD - Mi-3
U3234	Axle; Alloy CV Driveshaft 1pc
U3247	70T 48DP CNC Spur Gear - Mi-3
U3248	96T 64dp CNC Spur Gear - Mi-3
U3256	Alloy 7075 T6 Diff Mount; Front Left - Mi-3
U3257	Alloy 7075 T6 Diff Mount; Front Right - Mi-3
U3258	Alloy 7075 T6 Diff Mount; Rear Right - Mi-3
U3259	Alloy 7075 T6 Diff & Motor Mount - Mi-3
U3260	Ti Shock Post - Mi-3 pr
U3261	Ti Droop Screw - Mi-3 pk4
U3262	Ti Lay Post - Mi-3
U3267	Driveshafts; Heavy Duty - Mi3 (pr)
U3269	90T 64DP CNC Spur Gear - Mi-3
U3270	106T 64DP CNC Spur Gear - Mi-3
U3275	Bone; 7075 Alloy Driveshaft - Mi3 1pc
U3276	Axle; HD Steel - Mi3 1pc
U3400	66T 48DP CNC Spur Gear - Mi-3

SHOCK ABSORBERS

U2993	Race Shock Body; Nickel Teflon (pr)
U2994	Race Shock Collar; threaded adjuster (pr)
U2995	Race Shock Piston - Trg 3 Hole (pr)
U2996	Race Shock Piston - Trg 3 Hole (kit std) pr
U2997	Race Shock Rod; Ti/Nitride - 30mm (pr)
U2998	Race Shock Seal Housing; On Road (pr)
U2999	Race Shock Seal Rebuild Pack (pr)
U3001	Race Shocks; fully assembled pair
U3284	Race Shock Top Cap (pr) - Black Unvented
U613	Spring Stop & Spacer Mouldings (pr)

SHOCK OIL

G030	Pure Silicone Shock Oil - 30w
G035	Pure Silicone Shock Oil - 35w
G040	Pure Silicone Shock Oil - 40w
G045	Pure Silicone Shock Oil - 45w
G050	Pure Silicone Shock Oil - 50w
G055	Pure Silicone Shock Oil - 55w
G060	Pure Silicone Shock Oil - 60w
G070	Pure Silicone Shock Oil - 70w
G080	Pure Silicone Shock Oil - 80w
G100	Pure Silicone Shock Oil - 100w

SPRINGS

U2822	Spring Tuning Set - Pro-Touring (6 pr)
U2823	Pro-Touring Springs - White 14lbs
U2824	Pro-Touring Springs - Blue 16lbs
U2825	Pro-Touring Springs - Green 18lbs
U2826	Pro-Touring Springs - Red 20lbs
U2827	Pro-Touring Springs - Yellow 23 lbs
U2828	Pro-Touring Springs - Violet 27 lbs



BEARINGS & BALLS

G200	ZX1 - Microlube
H1031	Bearing Blaster Aerosol 500ml
U1301	Silicone Diff Lube - Pot
U1439	Ball Bearing - 5 x 9 x 3 Non Fl. (pr)
U1954	Pro - Thrust Bearing
U1957	Moly Ade Grease - Pot
U2148	Ball Bearing - 5 x 10 x 4 Shielded (pr)
U2189	Wheel Bearings 8pcs 10x5x4+Shim Set
U2459	Diff Balls; T/C 2.5mm pk12
U2574	Ball Bearing - 5 x 9 x 2.5 (pr)
U2862	Ceramic Bearing - 5x10x4 Shielded (pr)
U3016	Ball Bearing - 10x15x4 (pr)
U3017	Ceramic Bearing - 10x15x4 (pr)
U3019	Ceramic Nitride Diff Balls 2.5mm (pk12)
U3136	Ball Bearing - 5 x 8 x 2.5 (pr)
U3171	Ceramic Bearing set - Mi-3

SPEED PACKS

CR035	CORE RC - Serrated Alloy M4 Nuts; Blue pk 4
CR036	CORE RC - Serrated Alloy M4 Nuts; Purple pk 4
H1010	Body Clips - Fluorescent Yellow (pk10)
H1011	Body Clips - Fluorescent Green (pk10)
H1012	Body Clips - Fluorescent Red (pk10)
H1013	Body Clips - Metallic Red (pk10)
H1014	Body Clips - Metallic Blue (pk10)
H1015	Body Clips - Metallic Purple (pk10)
U1547	SPEED PACK - M3 Nuts
U1548	SPEED PACK - M3 Washers
U1549	SPEED PACK - M4 Nuts & Washers
U1550	SPEED PACK - Socket Wrenches (pk3)
U1551	SPEED PACK - E Clips 2x8pcs
U1552	SPEED PACK - R Clips
U1606	SPEED PACK - Servo Tape
U1633	SPEED PACK - Small Pins (pk)
U1960	SPEED PACK - O Rings; Various
U2128	SPEED PACK - Grub-Set Screws M3 M4
U2631	SPEED PACK - Circlips Various 12 pcs
U2760	SPEED PACK - M3 Button Hd; 4 to 20
U2858	Alloy M3x6 Spacer Set 0.5; 1; 2; 3mm - 16pcs
U2988	M3 Ck Washers - Purple Alloy (pk10)
U3002	Wheel Spacer Washers (pk10)
U3021	SPEED PACK - M3x6 Csk Allen Hi-T
U3022	SPEED PACK - M3x8 Csk Allen Hi-T
U3023	SPEED PACK - M3x10 Csk Allen Hi-T
U3024	SPEED PACK - M3x12 Csk Allen Hi-T
U3131	Alloy Spacers M3x7mm 0.5; 1; 2mm (pk18)
U3168	SPEED PACK - M2.5 Screws pk 10

TOOLS

AT1142	ATS Set Up Gauges - 1/10th Touring
H1009	Lean Scissors; curved
H1032	Alloy Camber Gauge - 1/10th
SPCF-MP001	Carbon Fibre Pit Mat; Black 58x76cm
SPCF-SB001	C/F Set Up Board; Silver 33x43cm
U2789	Schumacher Hex Driver - 1.5mm
U2790	Schumacher Hex Driver - 2.0mm
U2791	Schumacher Hex Driver - 2.5mm
U2792	Schumacher Hex Driver - 3.0mm
U2795	Schumacher M3 Nut Driver
U2796	Schumacher M4 Nut Driver
U2818	Schumacher Body Reamer

ELECTRONICS

G837	Mini Temp Gun - 420F 230C
G848	Tyre Warmers 1/10 Trg 7.2-12v

SPEEDCONTROLS

SPEXT98801	Speed Passion - BL ESC; GT 2.5T
SPEXT98801LPF	Speed Passion - BL ESC; LPF 5.5T



www.racing-cars.com



SPEED SECRET - OPTION PARTS

CRO10	CORE Ti Screws - M3 Set 67 pcs
CRO11	CORE Ti Screws - M3x8 Button Head pk4
CRO12	CORE Ti Screws - M3x10 Button Head pk4
CRO13	CORE Ti Screws - M3x16 Button Head pk4
CRO14	CORE Ti Screws - M3x20 Button Head pk4
CRO15	CORE Ti Screws - M3x8 Csk Head pk4
CRO16	CORE Ti Screws - M3x10 Csk Head pk4
CRO17	CORE Ti Screws - M3x12 Csk Head pk4
CRO18	CORE Ti Ball Studs - Ultra Short pk4
CRO19	CORE Ti Ball Studs - Short pk4
CRO20	CORE Ti Ball Studs - Long pk4
CRO21	CORE Ti Ball Stud Set - Mi3 24pcs
CRO43	CORE RC; X-Weights 8x10 & 8x5gms
H1024	Alloy 6 Fin Motor Heatsink; purple
H1026	Ride Height Gauge; Purple Alloy; 0-10mm
H1027	Droop Gauge Set; Purple Alloy - Touring
U1572	Titanium Turnbuckle; purple - 39mm (pr)
U1576	Titanium Pivot Pin; purple - 25mm (pr)
U1905	Titanium Turnbuckle; purple - 35mm (pr)
U2053	Titanium Turnbuckle; purple - 25mm (pr)
U2075	Camber & Ride Height Gauges - C/C
U2096	Aerial Mount; Purple Chrome - Universal
U2100	Set Up Wheels; Camber & Toe In-SST
U2135	M4 Nylon Wheel Nut - Purple Alloy (pk4)
U2187	M3 Nylon Nut - Purple Alloy (pk8)
U2251	Kwik Klip; 1/8x1.0 & 2.0mm
U2296	Schumacher Pit Dude Car Stand
U2719	Titanium Pivot Pin; purple - 18mm pr
U2741	Alloy Rear Hub Carriers; purple - Mi-2 EC & Mi-3
U2753	Heavy Duty Front One Way Assy - Mi-2
U2756	One Way Pulley Assembly - Mi-2
U2810	M4 Nylon Wheel Nut - Red Alloy (pk4)
U2811	M4 Nylon Wheel Nut - Blue Alloy (pk4)
U2812	M4 Nylon Wheel Nut - Black Alloy (pk4)
U2813	M4 Nylon Wheel Nut - Gold Alloy (pk4)
U2844	Hub & One Ways; Heavy Duty - Mi-2
U2845	Output; Heavy Duty One Way - Mi-2 1pc
U3132	Kwik Clips 0.25 & 0.5mm (pk8)
U3143	Titanium Pivot Pin Set - Mi-3 (8pcs)
U3144	Titanium Turnbuckle Set - Mi-3 (7pcs)
U3146	CF Chassis - 2.5mm Stiff - Mi-3
U3148	CF Top Deck - Stiff - Mi-3
U3149	CF Top Deck - Flex - Mi-3
U3152	CF Shock Bkt; Front - Low - Mi-3
U3153	CF Shock Bkt; Rear - Low - Mi-3
U3156	Roll Bar Set; Front 1.2-1.4-1.6 - Mi-3
U3157	Roll Bar Set; Rear 1.2-1.4-1.6 - Mi-3
U3221	Purple Alloy Wheel Hex; Grooveless (pr)
U3222	CF Battery Strap & Alloy Posts - Mi3
U3224	CF Chassis - 5 cell 2.0mm - Mi-3
U3246	CF Top Deck - 2.5mm - Mi-3

TEAM CLOTHING

G331L	T Blue - Large
G331M	T Blue - Medium
G331S	T Blue - Small Man
G331XL	T Blue - X-Large
G331XXL	T Blue - XX-Large
G332L	T White - Large
G332M	T White - Medium
G332S	T White - Small Man
G332XL	T White - X-Large
G332XXL	T White - XX-Large
G333L	Polo - Large
G333M	Polo - Medium
G333S	Polo - Small Man
G333XL	Polo X Large
G333XXL	Polo - XX-Large
G334	Cap - Black; Medium 58cm
G335	Cap - Black; Large 62cm
G336L	Sweat - Large
G336M	Sweat - Medium
G336S	Sweat - Small
G336XL	Sweat - X-Large
G336XXL	Sweat - XX-Large

CHARGERS

CRO25	UDC10 Universal Charger - NiMH + LiPo
CRO26	UDC20 Universal Balance Charger - NiMH+LiPo
CRO27	Power Supply; 6A UK Plug
CRO28	Power Supply Cable; USA
CRO29	Power Supply Cable; Europe
CRO31	UDC Charger Connector Set

ELECTRIC MOTORS

SP13825	Speed Passion CV2.0 Comp BL Motor; 2.5T
SP13835	Speed Passion CV2.0 Comp BL Motor; 3.5T
SP13835R1	Rotor 3.5T; Euro R Hi Power 12.5mm
SP13835R2	Rotor 3.5T; Euro S Hi Speed & Runtime 12mm
SP13840	Speed Passion CV2.0 Comp BL Motor; 4.0T
SP13845	Speed Passion CV2.0 Comp BL Motor; 4.5T
SP13845R1	Rotor 4.5T; Euro RS Power Band 13mm
SP162801	SP - Sensor Cable 180mm
SP162802	SP - Sensor Cable 90mm
SP162810	SP - H-Power Connector; 3pcs set
SPWSSC1.5M SP	Super Capacitor 1.5 Farads 7.4 Volt rated
SPCB138328 SP	Ceramic Motor Bearing
SPF105	SP Ultra Stock BL Motor 10.5T BRCA ROAR
SPF135	SP Ultra Stock BL Motor 13.5T BRCA ROAR
SPF175	SP Ultra Stock BL Motor 17.5T ROAR
SPRA13835	Rotor 3.5T; Standard 13.5mm
SPRA13845	Rotor 4.5T; Standard 12.5mm
SPRB13835	Rotor 3.5T; H RPM 13mm
SPRB13845	Rotor 4.5T; H RPM 12mm

BATTERIES

CRO04	CORE RC - 5000mAh 7.4v LiPo
CRO05	CORE RC Battery Tape - Black
CRO06	CORE RC Battery Tape - Blue
CRO07	CORE RC Silicone Wire 12g - Red/Black 2x50cm
CRO08	CORE RC RED Connector with 2x4mm Tubes
CRO09	CORE RC RED Connector with 2x4mm Males
CRO33	CORE RC - Safe Charge Pouch
CRO34	CORE RC - 3250mAh 7.4v LiPo
CRO37	CORE RC Battery Tape - Purple
G756	East Power 4200W2 - XVS Sport x6
G757	Orion SHO 4200 - XVS Team x6
G758	Orion SHO 4200 - XVS Team x5
G759	Orion SHO 4200 - XVS Team x4
G760	Orion SHO 4200 - XVS Sport x6
G761	East Power 4600 - 2008 XVS Team x6
G762	East Power 4600 - 2008 XVS Team x5
G763	East Power 4600 - 2008 XVS Team x4
G764	East Power 4600 - 2008 XVS Sport x6
G793	Silicone Wire - 2x50cm Red/Black
G794	Battery Bars - pk5
G795	Female Connector Tubes (pk 10)
G796	Male Connector Plugs (pk 2)
H1039	Battery Tape - Natural 50m x 17mm
H1046	T Connector; Red 2 Way - Male & Female
H1047	T Connector; Black 2 Way - Male & Female
H1048	T Connector; Red Sockets - pk4
H1049	T Connector; Black Sockets - pk4
H1054	Polarised Plug+Socket; 3.5mm - Pair

ACCESSORIES

CRO01	CORE RC Motor & Battery Case
CRO22	CORE RC - Digital Pocket Scale 500gram
CRO23	CORE RC - Digital Caliper 0-100mm
CRO24	CORE RC - Serrated M4 Steel Wheel Nut pk4
MC3	Mega Cargo Carrier; 1/10 Touring

1/10 TOURING WHEELS

U1932	Wheel; 5 spoke 25mm - White (Pk4)
U1933	Wheel; 5 spoke 25mm - Black (Pk4)
U1934	Wheel; 5 spoke 25mm - Satin (Pk4)
U1935	Wheel; 5 spoke 25mm - Chrome (Pk4)
U2170	Wheel; 12 spoke 25mm - White (Pk4)
U2171	Wheel; 12 spoke 20mm - White (Pk4)
U2172	Wheel; 12 spoke 25mm - Purple Chrome (Pk4)
U2173	Wheel; 5 spoke 25mm - Purple Chrome (Pk4)
U2296	Wheel; Dish 25mm - White (Pk4)
U2300	Wheel; 5 sp 25mm - Gold (pr) (Pk4)
U2366	Wheel; 12 spoke 24mm - White (Pk4)
U2393	Wheel; 12 spoke 24mm - Black (Pk4)
U2500	Rev-Lite; 24mm - White (Pk4)
U2501	Rev-Lite; 24mm Inch-Up - White (Pk4)
U2777	Rev-Lite; Flex 24mm - White (Pk4)
U2799	Rev-Lite Stiff; 24mm - White (Pk4)



1/10 TOURING TYRES & INSERTS

U6623	SST Mini Pins 24/25 - Blue (pr)
U6624	SST Mini Pins 24/25 - Yellow (pr)
U6626	SST Foam Tyre Insert - 24/25 Soft (pr)
U6627	SST Foam Tyre Insert - 24/25 Hard (pr)
U6628	SST Foam Tyre Insert - 24/25 Comp (pr)
U6629	SST Rally 24/25 - Yellow (pr)
U6630	SST Rally 24/25 - White (pr)
U6634	SST Foam Tyre Insert - 20 Soft (pr)
U6635	SST Foam Tyre Insert - 20 Hard (pr)
U6670	SST Mini Pins 20 - Blue (pr)
U6671	SST Mini Pins 20 - Yellow (pr)
U6672	SST Behed Slick 25 - White (pr)
U6690	SST Carpet Dragon 24/25mm (pr)
U6695	Moulded LP Insert Orange X-Soft (pr)
U6696	SST Moulded LP Insert Green Med (pr)
U6699	SST LP14 Foam Insert Med Blk (pr)
U6700	SST LP24 Foam Insert Soft Gy (pr)
U6714	Moulded CP Insert Aqua - Soft (pr)
U6716	SST Mini Pins 24/25 - Green (pr)
U6717	SST Mini Pins 20 - Green (pr)

PINIONS

U3414	Pinion; Hard Alloy 48dp - 14T
U3415	Pinion; Hard Alloy 48dp - 15T
U3416	Pinion; Hard Alloy 48dp - 16T
U3417	Pinion; Hard Alloy 48dp - 17T
U3418	Pinion; Hard Alloy 48dp - 18T
U3419	Pinion; Hard Alloy 48dp - 19T
U3420	Pinion; Hard Alloy 48dp - 20T
U3421	Pinion; Hard Alloy 48dp - 21T
U3422	Pinion; Hard Alloy 48dp - 22T
U3423	Pinion; Hard Alloy 48dp - 23T
U3424	Pinion; Hard Alloy 48dp - 24T
U3425	Pinion; Hard Alloy 48dp - 25T
U3426	Pinion; Hard Alloy 48dp - 26T
U3427	Pinion; Hard Alloy 48dp - 27T
U3428	Pinion; Hard Alloy 48dp - 28T
U3429	Pinion; Hard Alloy 48dp - 29T
U3430	Pinion; Hard Alloy 48dp - 30T
U3431	Pinion; Hard Alloy 48dp - 31T
U3432	Pinion; Hard Alloy 48dp - 32T
U3433	Pinion; Hard Alloy 48dp - 33T
U3434	Pinion; Hard Alloy 48dp - 34T
U3435	Pinion; Hard Alloy 48dp - 35T
U3436	Pinion; Hard Alloy 48dp - 36T
U3437	Pinion; Hard Alloy 48dp - 37T
U3438	Pinion; Hard Alloy 48dp - 38T
U3619	Pinion; Hard Alloy 64dp - 19T
U3620	Pinion; Hard Alloy 64dp - 20T
U3621	Pinion; Hard Alloy 64dp - 21T
U3622	Pinion; Hard Alloy 64dp - 22T
U3623	Pinion; Hard Alloy 64dp - 23T
U3624	Pinion; Hard Alloy 64dp - 24T
U3625	Pinion; Hard Alloy 64dp - 25T
U3626	Pinion; Hard Alloy 64dp - 26T
U3627	Pinion; Hard Alloy 64dp - 27T
U3628	Pinion; Hard Alloy 64dp - 28T
U3629	Pinion; Hard Alloy 64dp - 29T
U3630	Pinion; Hard Alloy 64dp - 30T
U3631	Pinion; Hard Alloy 64dp - 31T
U3632	Pinion; Hard Alloy 64dp - 32T
U3633	Pinion; Hard Alloy 64dp - 33T
U3634	Pinion; Hard Alloy 64dp - 34T
U3635	Pinion; Hard Alloy 64dp - 35T
U3636	Pinion; Hard Alloy 64dp - 36T
U3637	Pinion; Hard Alloy 64dp - 37T
U3638	Pinion; Hard Alloy 64dp - 38T
U3639	Pinion; Hard Alloy 64dp - 39T
U3640	Pinion; Hard Alloy 64dp - 40T
U3641	Pinion; Hard Alloy 64dp - 41T
U3642	Pinion; Hard Alloy 64dp - 42T
U3644	Pinion; Hard Alloy 64dp - 44T
U3646	Pinion; Hard Alloy 64dp - 46T
U3648	Pinion; Hard Alloy 64dp - 48T
U3650	Pinion; Hard Alloy 64dp - 50T

