

Driver:
Date:
Meeting:
Best Time:

ESchumacher



FRONT SETTINGS

Ride Height *mm*
Anti-Roll Bar.....
Castor..... 2° 4° 6°
Kick Up..... *mm* Anti-Dive..... *mm*
Toe-In/Out..... *degrees*
Roll Centre *mm*
Camber..... *degrees*
Wishbone..... Short Mid/Short Mid/Long Long

Notes:

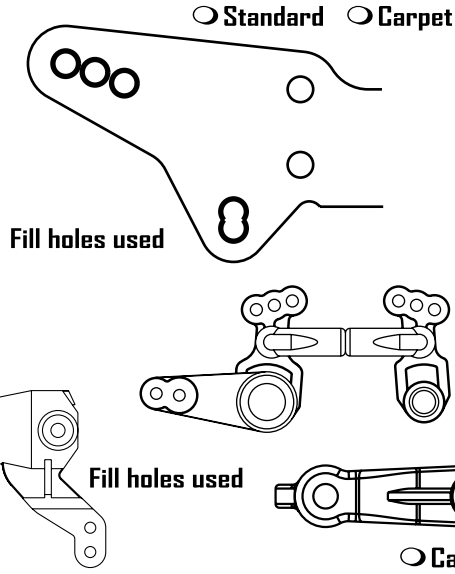

FRONT SHOCKS

Oil.....
Spring.....
Piston.....2...3...
Length.....*mm*..
Droop.....*mm*..

Centre Track Rod Length *mm*

REAR SETTINGS

Ride Height *mm*
Anti-Roll Bar.....
Anti/Pro Squat.....
Toe-In (In)..... *degrees*
Roll Centre *mm*
Camber..... *degrees*
Wishbone..... Short Mid/Short Mid/Long Long

Notes:

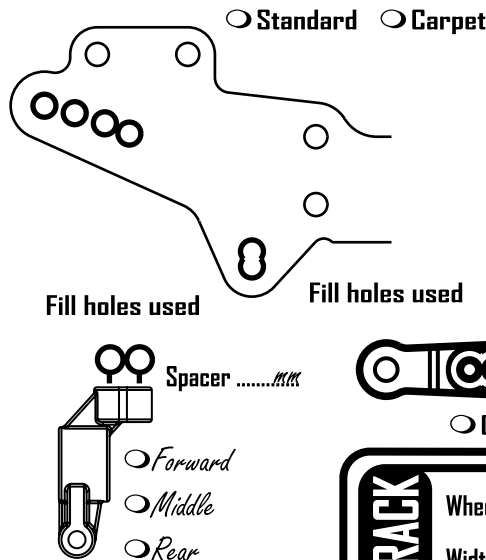

REAR SHOCKS

Oil.....
Spring.....
Piston.....2...3...
Length.....*mm*..
Droop.....*mm*..

OTHER SETTINGS

Bodyshell.....
Differential..... Standard Locked One-Way
Chassis
Top Deck
E.S.C.
Cells
Servo.....
Receiver

MOTOR & GEARING

Motor.....
Brush.....
Spring.....
Timing..... *degrees*
Pinion Size..... *tooth*
Spur Size..... *tooth*

TRACK CONDITIONS

VENUE Indoor Outdoor

SURFACE Carpet Concrete Tarmac

TYPE Tight Open

GRIP High Medium Low

CONDITION Smooth Bumpy

TYRES & WHEELS

Front Tyres.....
Rear Tyres.....
Front Inserts.....
Rear Inserts.....
Wheel.....
Tyre Additive..... Yes No *Type*

DRIVERS NOTES