

DRIVER DETAILS

NAME	<i>Robert Krens</i>
DATE	<i>09-12-2016</i>
EVENT	<i>Practice</i>
LOCATION	<i>RC Paradise Uithoorn</i>
RACE RESULT	
QUALIFYING POSITION	
FASTEST LAP TIME	<i>8.395</i>

TRACK CONDITIONS

GRIP LEVEL	High <input checked="" type="checkbox"/>	Medium <input checked="" type="checkbox"/>	Low <input type="checkbox"/>
TYPE	Tight <input checked="" type="checkbox"/>	Mixed <input checked="" type="checkbox"/>	Open <input type="checkbox"/>
SURFACE	Asphalt <input type="checkbox"/>	Carpet <input checked="" type="checkbox"/>	
CONDITION	Smooth <input type="checkbox"/>	Bumpy <input checked="" type="checkbox"/>	
TRACK DIMENSIONS	<i>8*3meter</i>		
TEMPERATURE	<i>20 °C</i>		°F

MOTOR & GEARING

MOTOR	<i>Trinity D4 10,5T</i>
MOTOR OPTIONS	-
ROTOR DIAMETER	<i>12.3mm</i>
TIMING	<i>53deg</i>
SPUR GEAR SIZE	<i>80</i>
PINION SIZE	<i>40</i>
ROLLOUT	<i>65 mm / rev</i>

TYRES & ADDITIVE

	Front	Rear
COMPOUND	<i>Ulti J-Hard</i>	<i>Ulti X-Med</i>
FOAM DIAMETER	<i>41.6 mm</i>	<i>40.3 mm</i>
TYRE ADDITIVE	<i>CS-High Grip</i>	<i>CS-High Grip</i>
ADDITIVE TIME	<i>2 min</i>	<i>10 min</i>
ADDITIVE COVERAGE	<i>15mm.65 %</i>	<i>100 %</i>
SIDEWALL GLUE	-	-

ELECTRONICS & BODYSHELL

BODYSHELL	<i>BlackArt BA006</i>	HEIGHT	<i>5 mm</i>
E.S.C	<i>Team Orion R10 pro</i>		
SERVO	<i>Sanwa 141 HR</i>		
RECEIVER	<i>Sanwa 481</i>		
BATTERY	<i>IP8000 SHV</i>		

FRONT

CAMBER	<i>1.5°</i>
RIDE HEIGHT	<i>3.2 mm</i>
RIDE HEIGHT SPACER	1.0mm <input type="checkbox"/> 1.5mm <input type="checkbox"/> 2mm <input checked="" type="checkbox"/>
TOE	<i>0.5°/side</i>
DAMPING	<i>9.000 cSt</i>
DROOP	<i>1.5 mm</i>
FRONT END BRACE	O-ring <input checked="" type="checkbox"/> Solid <input type="checkbox"/> Removed <input type="checkbox"/>

STATIC CASTER

FRONT	REAR	STATIC CASTER
1.5mm	0mm	2.5°
1mm	0.5mm	4.5° (Kit)
0.5mm	1mm	6.0°
0mm	1.5mm	<i>7.5°</i>

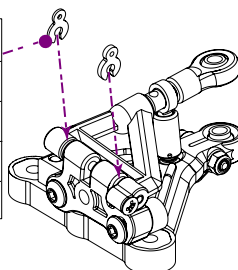

UPPER ARM LENGTH

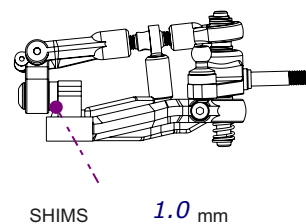

REACTIVE CASTER

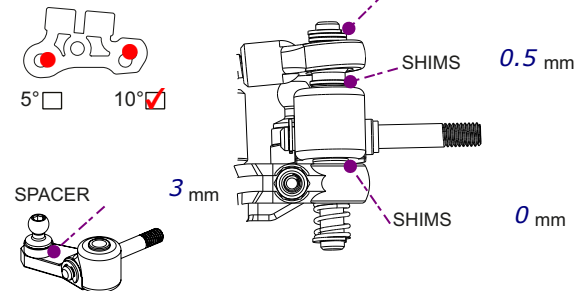

FRONT TRACK WIDTH

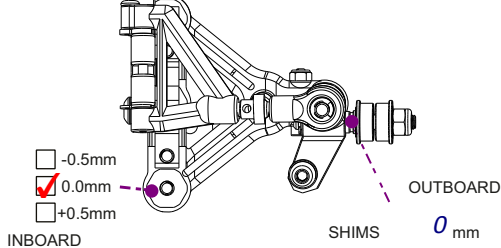

FRONT SPRINGS

- SUPER SOFT - U7013
- RED - U7015
- YELLOW - U7016
- BLUE - U7014
- SOFT - U7012
- MEDIUM SOFT - U7011
- MEDIUM - U7009
- HARD - U7010
- IRS 0.18*

REAR

RIDE HEIGHT	<i>3.4 mm</i>
ROLL DAMPING	<i>7000 cSt</i>
BUMP DAMPING	<i>40.000 cSt</i>
DROOP	<i>1.6 mm</i>
ROLL CENTRE SHIFT	KIT <input checked="" type="checkbox"/> +2.5mm <input type="checkbox"/> mm <input type="checkbox"/>
ANTI SQUAT	KIT <input checked="" type="checkbox"/> ANTI SQUAT <input type="checkbox"/>
DIFF PRELOAD	360° KIT <input checked="" type="checkbox"/>

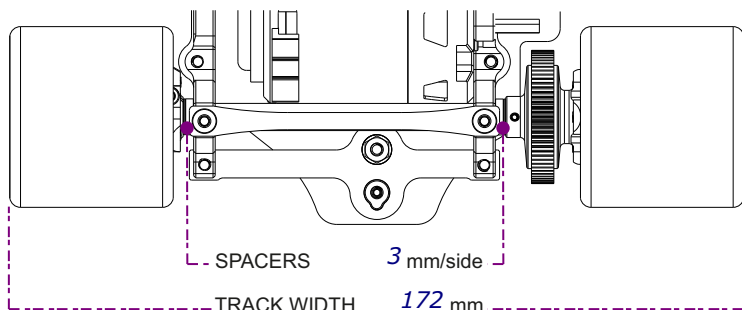
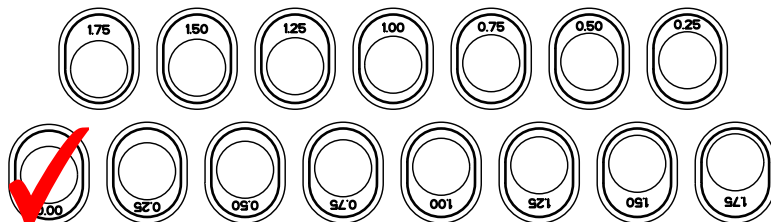

ROLL SPRINGS (SIDE): *Associated green*

BUMP SPRING (CENTRE): *Associated silver*

← SOFTER → HARDER →
U4838 BLACK - U4839 SILVER - U4840 GOLD - U4841 NICKEL