

DRIVER DETAILS

NAME
DATE
EVENT
LOCATION
RACE RESULT
QUALIFYING POSITION
FASTEST LAP TIME

TRACK CONDITIONS

GRIP LEVEL	High <input type="checkbox"/>	Medium <input type="checkbox"/>	Low <input type="checkbox"/>
TYPE	Tight <input type="checkbox"/>	Mixed <input type="checkbox"/>	Open <input type="checkbox"/>
SURFACE	Asphalt <input type="checkbox"/>	Carpet <input type="checkbox"/>	
CONDITION	Smooth <input type="checkbox"/>	Bumpy <input type="checkbox"/>	
TRACK DIMENSIONS			
TEMPERATURE		°C	°F

MOTOR & GEARING

MOTOR
MOTOR OPTIONS
ROTOR DIAMETER
TIMING
SPUR GEAR SIZE
PINION SIZE
ROLLOUT

mm / rev

TYRES & ADDITIVE

	Front	Rear
COMPOUND		
FOAM DIAMETER	mm	mm
TYRE ADDITIVE		
ADDITIVE TIME	min	min
ADDITIVE COVERAGE	%	%
SIDEWALL GLUE		

ELECTRONICS & BODYSHELL

BODYSHELL	HEIGHT	mm
E.S.C		
SERVO		
RECEIVER		
BATTERY		

FRONT

CAMBER	°
RIDE HEIGHT	mm
RIDE HEIGHT SPACER	1.0mm <input type="checkbox"/> 1.5mm <input type="checkbox"/> 2mm <input type="checkbox"/>
TOE	°/side
DAMPING	cSt
DROOP	mm
FRONT END BRACE	O-ring <input type="checkbox"/> Solid <input type="checkbox"/> Removed <input type="checkbox"/>

STATIC CASTER

FRONT	REAR	STATIC CASTER
1.5mm	0mm	2.5°
1mm	0.5mm	4.5° (Kit)
0.5mm	1mm	6.0°
0mm	1.5mm	7.5°

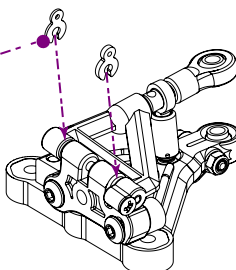

UPPER ARM LENGTH

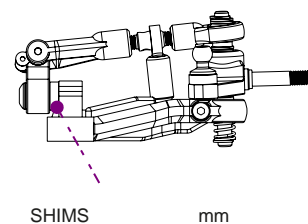

REACTIVE CASTER

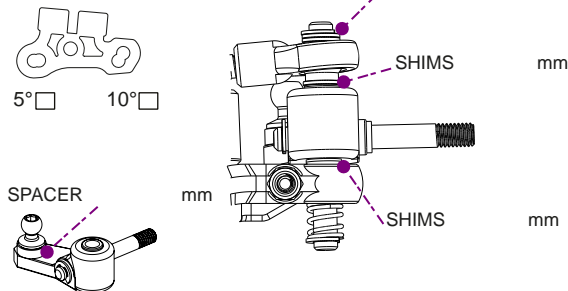

FRONT TRACK WIDTH

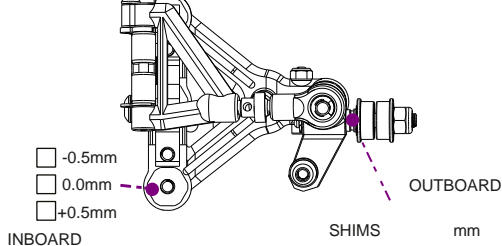

FRONT SPRINGS

- SUPER SOFT - U7013
- RED - U7015
- YELLOW - U7016
- BLUE - U7014
- SOFT - U7012
- MEDIUM SOFT - U7011
- MEDIUM - U7009
- HARD - U7010

REAR

RIDE HEIGHT	mm
ROLL DAMPING	cSt
BUMP DAMPING	cSt
DROOP	mm
ROLL CENTRE SHIFT	KIT <input type="checkbox"/> +2.5mm <input type="checkbox"/> mm <input type="checkbox"/>
ANTI SQUAT	KIT <input type="checkbox"/> ANTI SQUAT <input type="checkbox"/>
DIFF PRELOAD	360° KIT <input type="checkbox"/> ° <input type="checkbox"/>

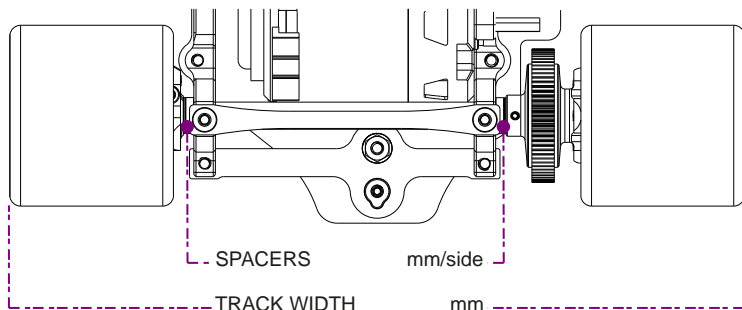
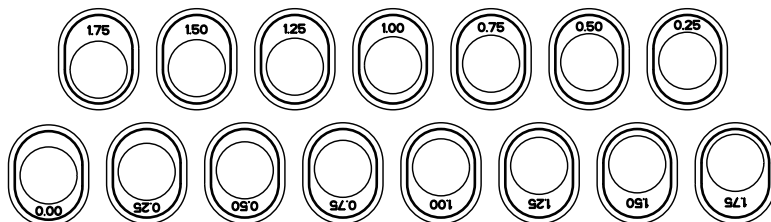

ROLL SPRINGS (SIDE): _____

BUMP SPRING (CENTRE): _____

← SOFTER → HARDER →

U4838 BLACK - U4839 SILVER - U4840 GOLD - U4841 NICKEL