

# Setup Sheet



## DRIVER DETAILS

NAME	Andy Murray
DATE	8/12/2018
EVENT	BRCA National R3 - 2018
LOCATION	Tamworth
RACE RESULT	2nd
QUALIFYING POSITION	1st
FASTEST LAP TIME	

## TRACK CONDITIONS

GRIP LEVEL	High <input type="checkbox"/>	Medium <input checked="" type="checkbox"/>	Low <input type="checkbox"/>
TYPE	Tight <input checked="" type="checkbox"/>	Mixed <input type="checkbox"/>	Open <input type="checkbox"/>
SURFACE	Primafelt		
CONDITION	Smooth <input checked="" type="checkbox"/>	Bumpy <input type="checkbox"/>	
TRACK DIMENSIONS			
TEMPERATURE	°C		°F

## MOTOR AND GEARING

MOTOR	
MOTOR OPTIONS	
ROTOR DIAMETER	
TIMING	
SPUR GEAR SIZE	
PINION SIZE	
ROLLOUT	mm / rev

## NOTES

- Kit Chassis
- Kit Low Roll Centre
- Lipo position fully rearward.
- 1mm motor spacer
- Rear hole in front hub carrier
- Kit type, small servo saver
- Body mounted 2mm forwards of central front arches
- Qualified 2nd Finished 2nd in Mod with same setup, only tighter diff.

TOPDECK STIFFNESS ADJUSTMENT

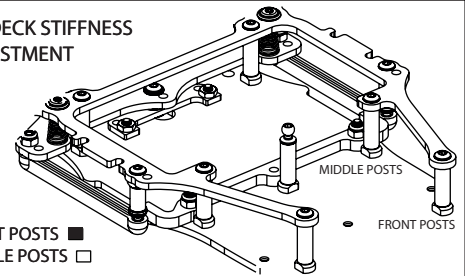

FRONT POSTS   
MIDDLE POSTS

## TYRES AND ADDITIVE

	Front	Rear
COMPOUND	CONTACT JT2-35FT	CONTACT JT2-35RT
FOAM DIAMETER	39.75 mm	40.75 mm
TYRE ADDITIVE		
ADDITIVE TIME	3 minutes	45 minutes
ADDITIVE COVERAGE	16MM %	Full %
SIDEWALL GLUE	<input type="checkbox"/>	<input type="checkbox"/>

## ELECTRICS AND BODYSHELL

BODYSHELL	Team Bomber Ketter Ultra	HEIGHT	6mm
FRONT PIN HEIGHT	BOTTOM 0 <input checked="" type="checkbox"/> 1 <input type="checkbox"/> 2 <input type="checkbox"/> 3 <input type="checkbox"/> 5 <input type="checkbox"/> TOP		
FRONT HANGERS	1 DOT <input checked="" type="checkbox"/> 2 DOT <input type="checkbox"/> 3 DOT <input type="checkbox"/>		
REAR PIN HEIGHT	BOTTOM 1 <input type="checkbox"/> 2 <input type="checkbox"/> 3 <input type="checkbox"/> 4 <input checked="" type="checkbox"/> 5 <input type="checkbox"/> TOP		
REAR HANGERS	1 DOT <input type="checkbox"/> 2 DOT <input checked="" type="checkbox"/> 3 DOT <input type="checkbox"/>		
E.S.C	XR10 PRO 1S		
SERVO	Sanwa HR		
RECEIVER	Sanwa RX-482		
LiPo	LRP 8000		

## FRONT

CAMBER	0.75° <input type="checkbox"/>	1.5° <input checked="" type="checkbox"/>
RIDE HEIGHT	3.0	mm
TOE OUT	0.8	degrees/side
KINGPIN DAMPING	15k	cSt
DROOP	0.5	mm
CASTER	WASHER A (REAR)	0.0 mm
	WASHER B (FRONT)	2.5 mm
	CASTER ANGLE	4.0 degrees

SILVER SHIMS x...2.....  
BLACK SHIMS x...1.....

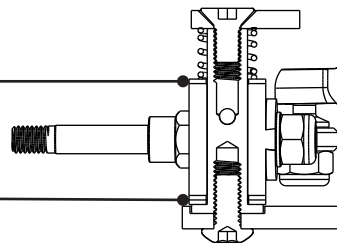

SILVER SHIMS x...0.....  
BLACK SHIMS x...0.....

## FRONT SPRINGS

- BLACK - SOFT
- SILVER - MEDIUM
- GOLD - HARD
- WHITE - ULTRA

## Rear

RIDE HEIGHT	3.3	mm
ROLL DAMPING	15k	cSt
BUMP DAMPING	30k	cSt
DROOP	1.0	mm
ANTI SQUAT	KIT <input checked="" type="checkbox"/> ANTI SQUAT <input type="checkbox"/>	
DIFF PRELOAD	360° KIT <input type="checkbox"/> MEDIUM <input checked="" type="checkbox"/>	
PIVOT LENGTH	LONG <input checked="" type="checkbox"/> SHORT <input type="checkbox"/>	

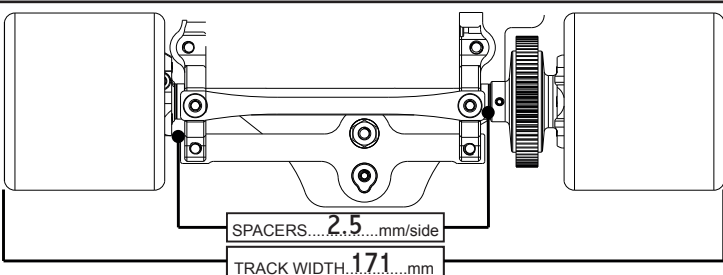
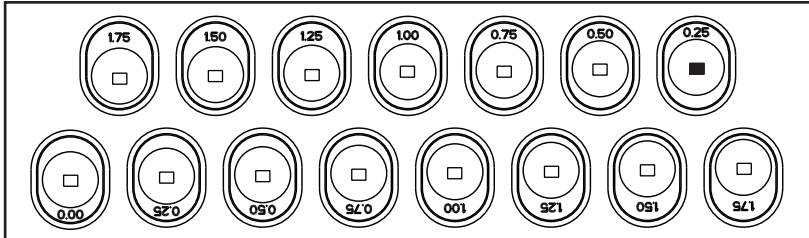

← SOFTER	ROLL SPRINGS (SIDE)						HARDER →
U4838 BLACK <input checked="" type="checkbox"/>	U4839 SILVER <input type="checkbox"/>	U4840 GOLD <input type="checkbox"/>	U4841 NICKEL <input type="checkbox"/>	U7322 RED DOT <input type="checkbox"/>	U7323 BLACK ULTRA <input type="checkbox"/>		

← SOFTER	BUMP SPRING (CENTRE)						HARDER →
U4838 BLACK <input type="checkbox"/>	U4839 SILVER <input type="checkbox"/>	U4840 GOLD <input type="checkbox"/>	U4841 NICKEL <input checked="" type="checkbox"/>	U7322 RED DOT <input type="checkbox"/>	U7323 BLACK ULTRA <input type="checkbox"/>		