

Setup Sheet



DRIVER DETAILS

NAME	Andy Murray
DATE	18/10/2018
EVENT	International Indoor Championship - IIC
LOCATION	Las Vegas
RACE RESULT	6th
QUALIFYING POSITION	6th
FASTEST LAP TIME	11.10

TRACK CONDITIONS

GRIP LEVEL	High <input checked="" type="checkbox"/> Medium <input type="checkbox"/> Low <input type="checkbox"/>
TYPE	Tight <input type="checkbox"/> Mixed <input checked="" type="checkbox"/> Open <input type="checkbox"/>
SURFACE	
CONDITION	Smooth <input checked="" type="checkbox"/> Bumpy <input type="checkbox"/>
TRACK DIMENSIONS	
TEMPERATURE	25 °C °F

MOTOR AND GEARING

MOTOR	LRP 3.5T
MOTOR OPTIONS	
ROTOR DIAMETER	std
TIMING	-10
SPUR GEAR SIZE	88
PINION SIZE	27
ROLLOUT	39 mm / rev

NOTES

- Alloy Chassis
- Using eclipse1 pod base and rear link mount with +2mm Roll Centre
- Lipo position fully rearward.
- 1mm motor spacer
- Rear hole in front hub carrier
- Kit type, small servo saver

TOPDECK STIFFNESS ADJUSTMENT

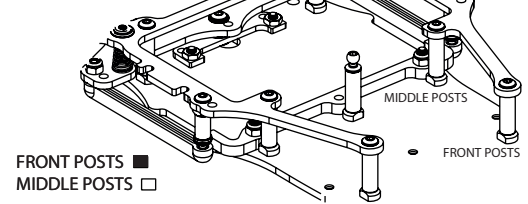

TYRES AND ADDITIVE

	Front	Rear
COMPOUND	CONTACT JT2-35FT	CONTACT JT2-35RT
FOAM DIAMETER	39.75 mm	40.25 mm
TYRE ADDITIVE	SXT 3.0	SXT 3.0
ADDITIVE TIME	3 minutes	15 minutes
ADDITIVE COVERAGE	<9mm %	Full %
SIDEWALL GLUE	<input checked="" type="checkbox"/>	<input type="checkbox"/>

ELECTRICS AND BODYSHELL

BODYSHELL	Team Bomber Ketter Ultra	HEIGHT	6mm
FRONT PIN HEIGHT	BOTTOM 0 <input checked="" type="checkbox"/> 1 <input type="checkbox"/> 2 <input type="checkbox"/> 3 <input type="checkbox"/> 5 <input type="checkbox"/> TOP		
FRONT HANGERS	1 DOT <input checked="" type="checkbox"/> 2 DOT <input type="checkbox"/> 3 DOT <input type="checkbox"/>		
REAR PIN HEIGHT	BOTTOM 1 <input type="checkbox"/> 2 <input type="checkbox"/> 3 <input type="checkbox"/> 4 <input checked="" type="checkbox"/> 5 <input type="checkbox"/> TOP		
REAR HANGERS	1 DOT <input type="checkbox"/> 2 DOT <input checked="" type="checkbox"/> 3 DOT <input type="checkbox"/>		
E.S.C	XR10 PRO 1S		
SERVO	Sanwa HR		
RECEIVER	Sanwa RX-482		
LiPo	LRP 8000		

FRONT

CAMBER	0.75° <input checked="" type="checkbox"/> 0.8° <input type="checkbox"/> 1.5° <input type="checkbox"/>	
RIDE HEIGHT	3.2 mm	
TOE OUT	0.8 degrees/side	
KINGPIN DAMPING	15k cSt	
DROOP	0.5 mm	
CASTER	WASHER A (REAR)	0.0 mm
	WASHER B (FRONT)	2.0 mm
	CASTER ANGLE	3.0 degrees

SILVER SHIMS x...0
BLACK SHIMS x...1

SILVER SHIMS x...2
BLACK SHIMS x...0

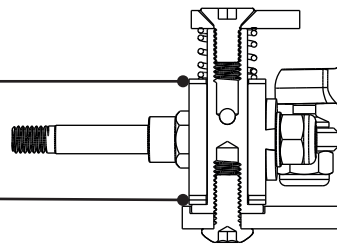

FRONT SPRINGS

- BLACK - SOFT
- SILVER - MEDIUM
- GOLD - HARD
- WHITE - ULTRA

Rear

RIDE HEIGHT	3.4 mm
ROLL DAMPING	15k cSt
BUMP DAMPING	30k cSt
DROOP	0.8 mm
ANTI SQUAT	KIT <input checked="" type="checkbox"/> ANTI SQUAT <input type="checkbox"/>
DIFF PRELOAD	360° KIT <input type="checkbox"/> SPOOL - SOLID AXLE <input type="checkbox"/>
PIVOT LENGTH	LONG <input checked="" type="checkbox"/> SHORT <input type="checkbox"/>

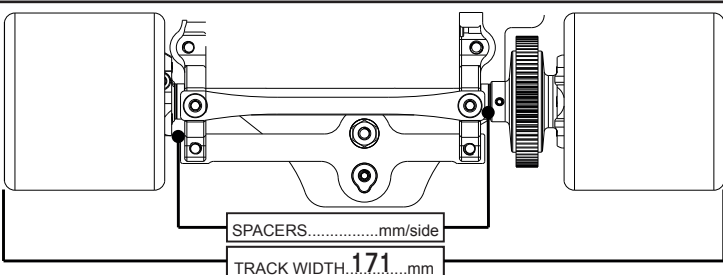
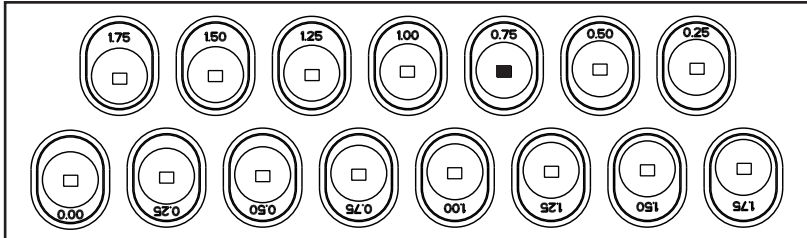

← SOFTER	ROLL SPRINGS (SIDE)						HARDER →
U4838 BLACK <input type="checkbox"/>	U4839 SILVER <input checked="" type="checkbox"/>	U4840 GOLD <input type="checkbox"/>	U4841 NICKEL <input type="checkbox"/>	U7322 RED DOT <input type="checkbox"/>	U7323 BLACK ULTRA <input type="checkbox"/>		

← SOFTER	BUMP SPRING (CENTRE)						HARDER →
U4838 BLACK <input type="checkbox"/>	U4839 SILVER <input type="checkbox"/>	U4840 GOLD <input type="checkbox"/>	U4841 NICKEL <input type="checkbox"/>	U7322 RED DOT <input checked="" type="checkbox"/>	U7323 BLACK ULTRA <input type="checkbox"/>		