

**A**  
BAG

①~②  
Kit Bag A

- TS0201003 .....2
- SJG\_M3X6 .....2

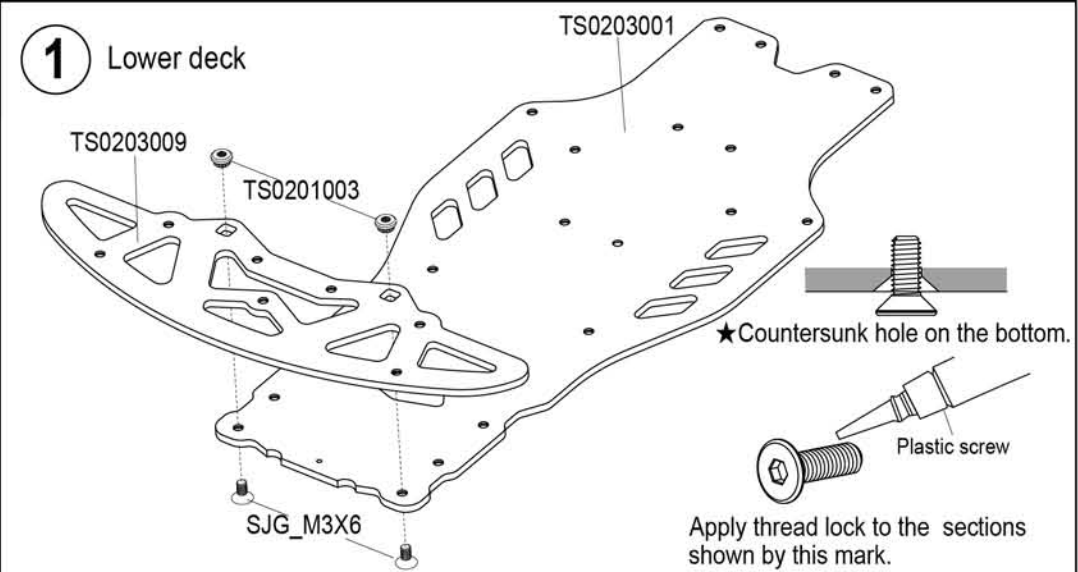

- SJG\_M3X10 .....4
- SN\_M3\_F .....4

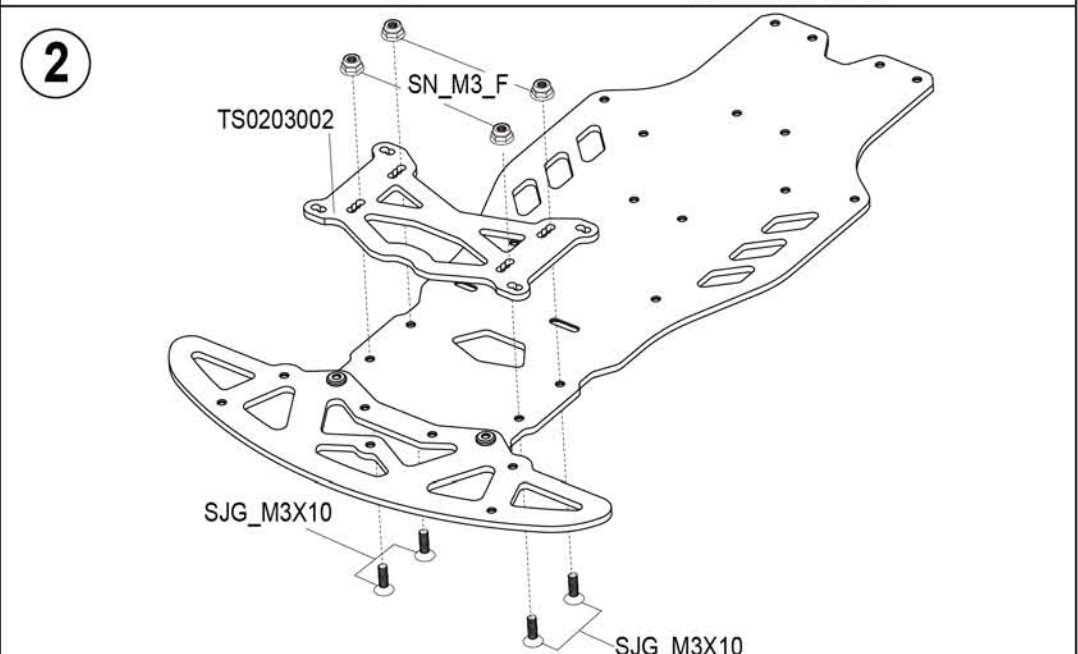

**B**  
BAG

③~④  
Kit Bag B

- TS0201006 .....2
- TS0201005 .....2
- TS0201004 .....6
- SJG\_M3X10 .....4
- SJG\_M3X8 .....2
- TS0201003 .....2

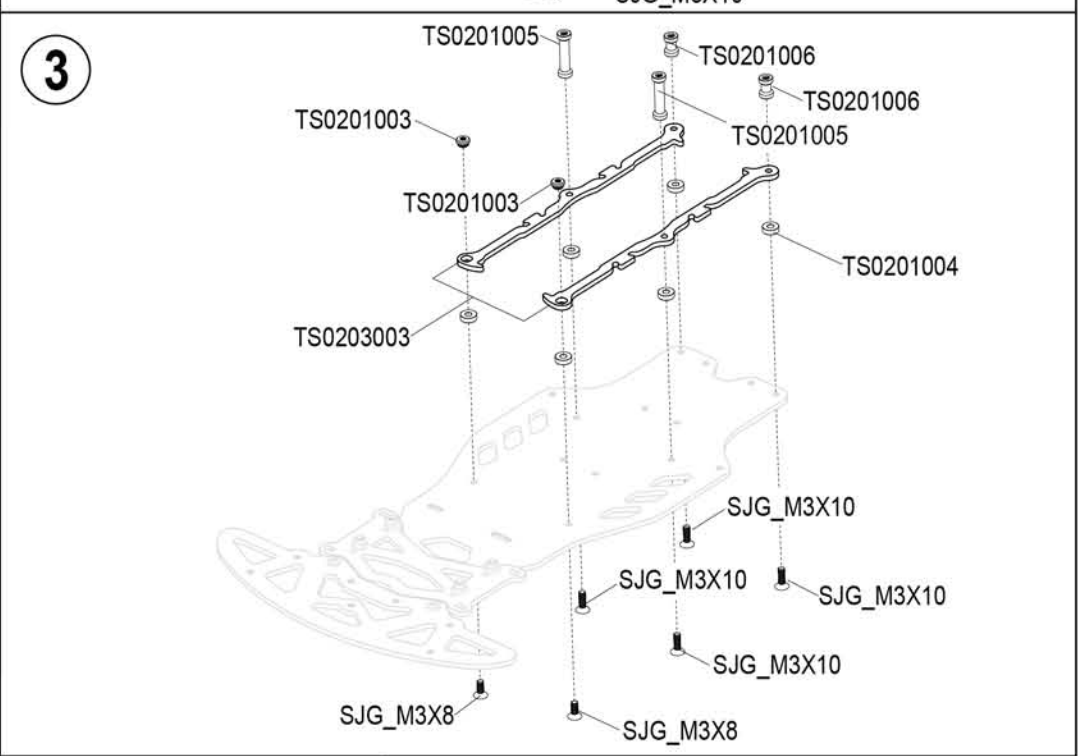

- TS0102010 .....2
- SJG\_M3X4 .....2

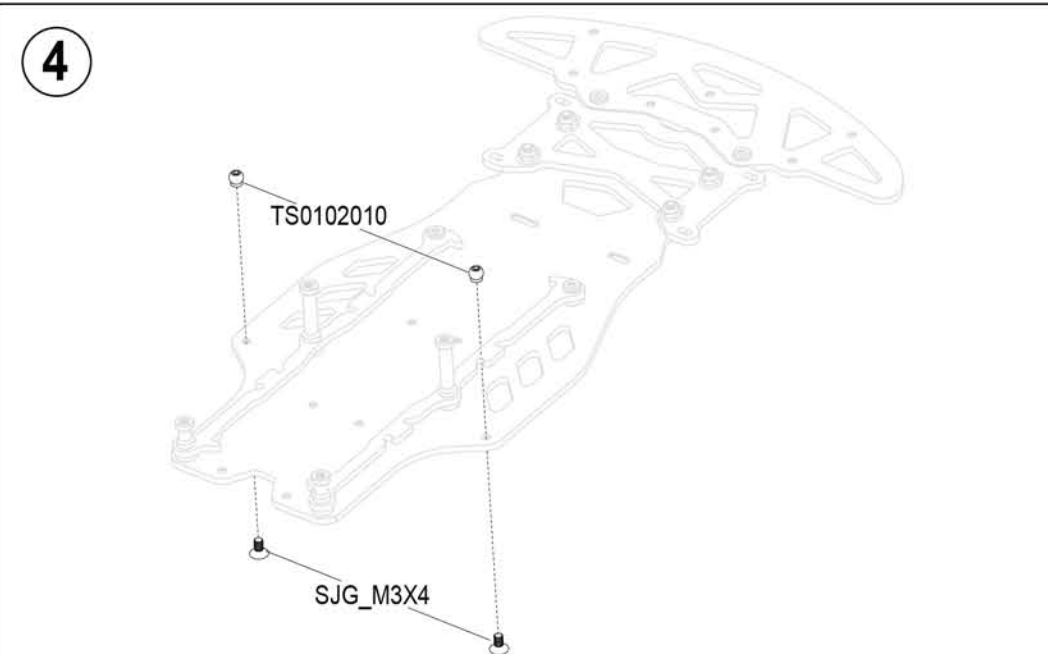

**C**  
BAG

⑤~⑦  
Kit Bag C

- SJG\_M3X6 .....1
- SG\_M2X6 .....2
- TS0102010 .....3
- SJG\_M3X4 .....2

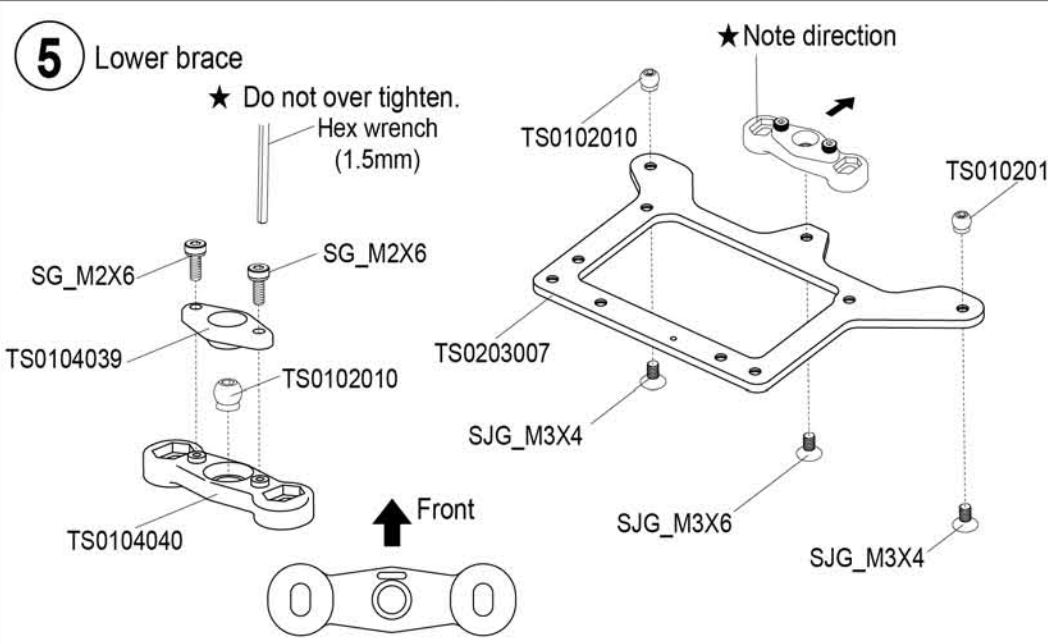

- SN\_M3 .....2
- SJG\_M3X10 .....2

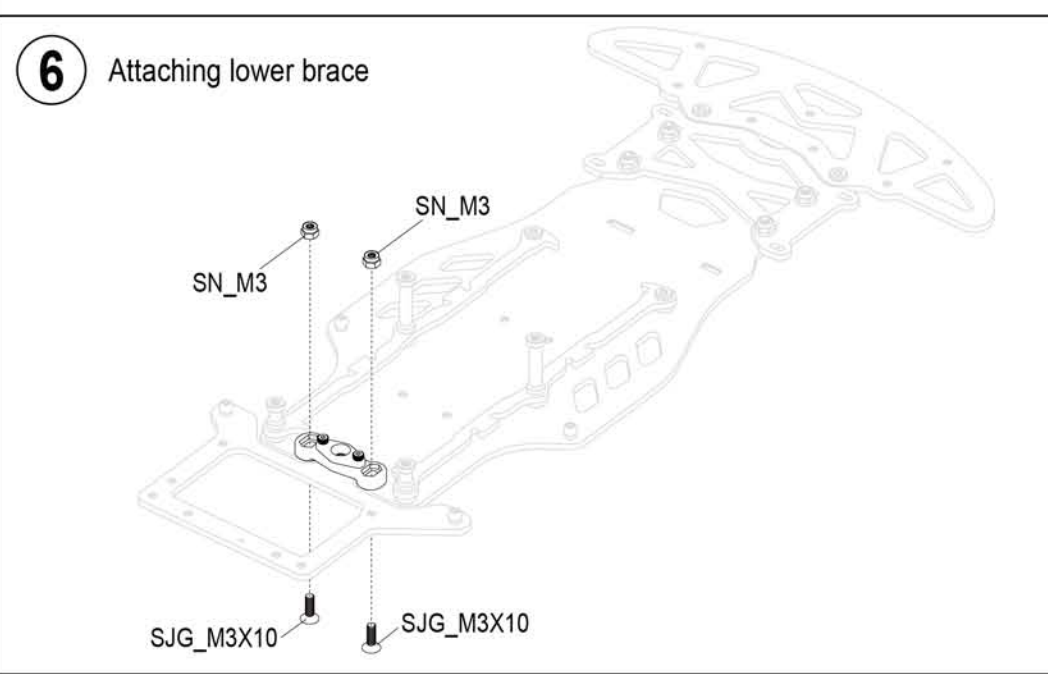



- SG\_M2X6 .....4
- TS0104038 .....2

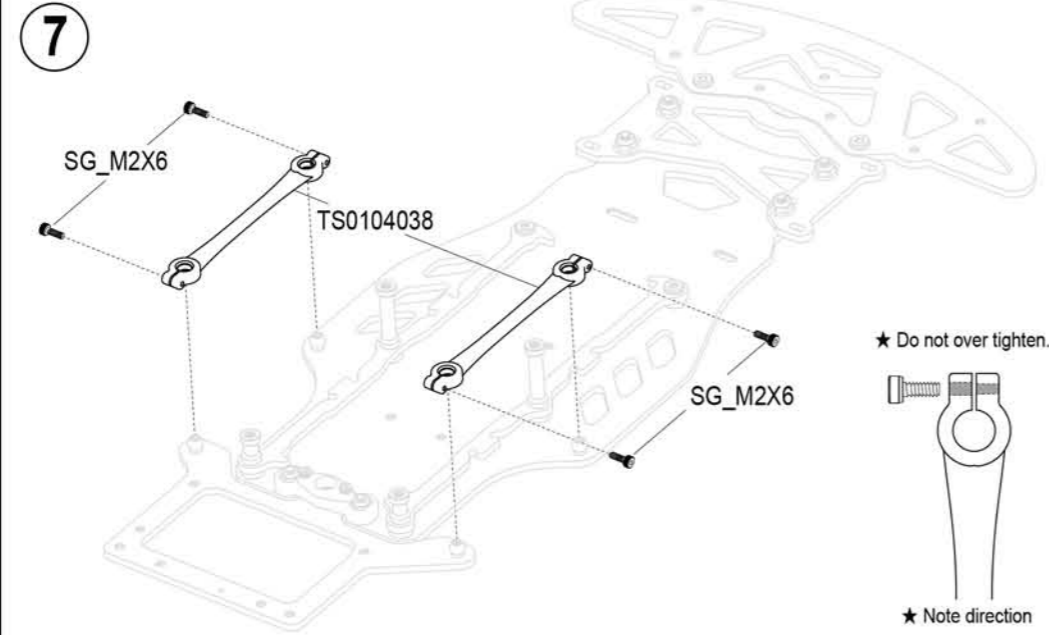

- TS0102004 .....2
- TS0102006 .....12
- MR128-2RS .....1  
8×12×3.5
- MR115-2RS .....1  
5×11×4
- TS0102011 .....2
- TS0101006 .....1
- SN\_M4\_F .....1

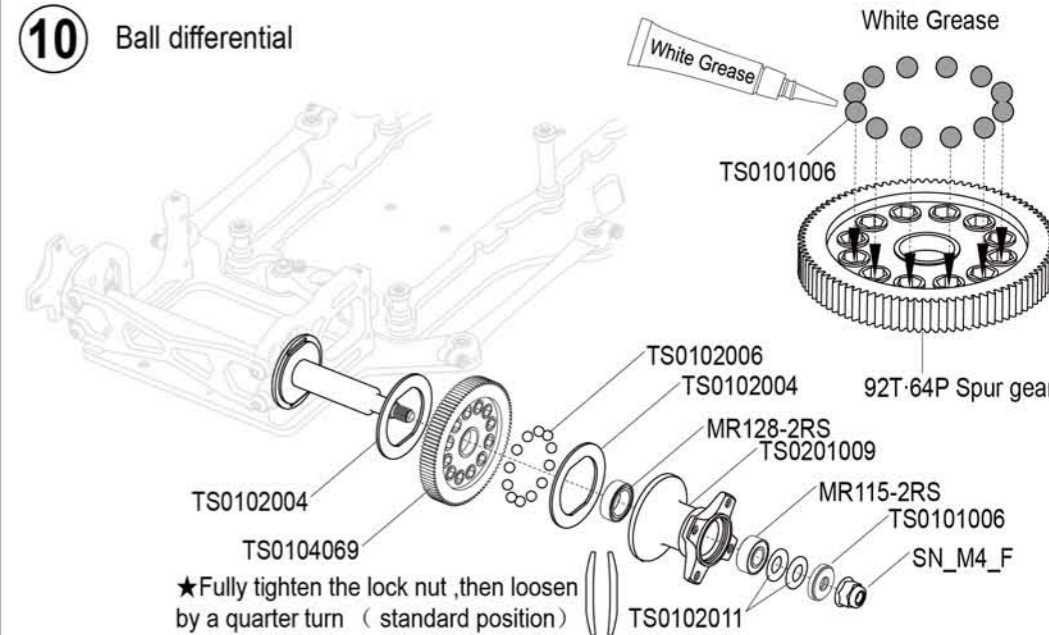

**D** Kit Bag D

- SJG\_M3X8 .....5
- SIG\_M3X6 .....4
- TS0101021 .....1
- TS0101020 .....1

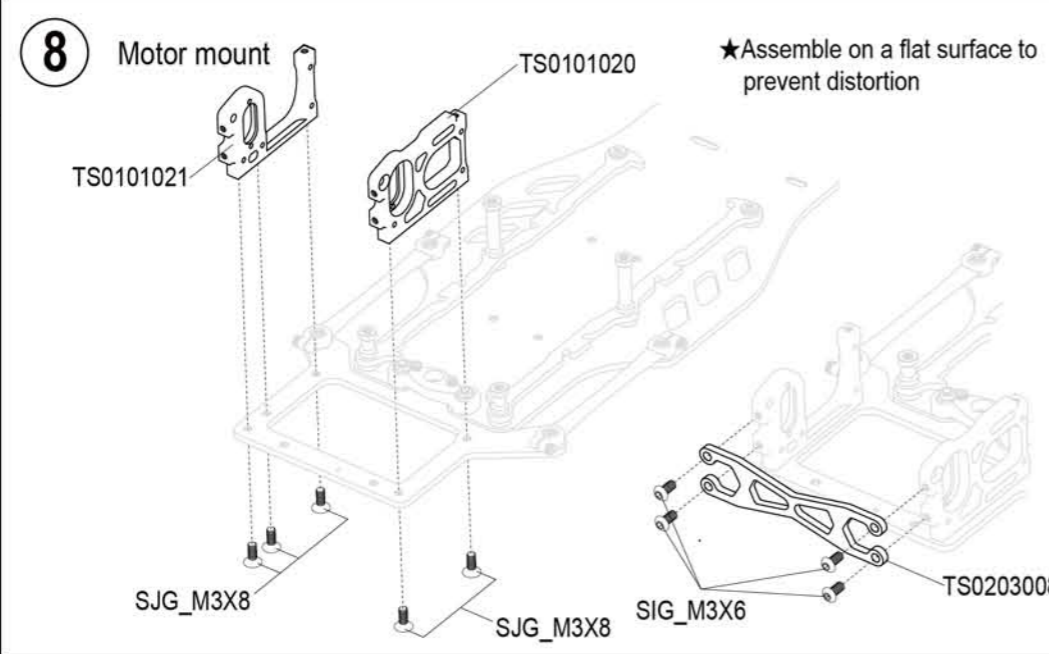

**F** Kit Bag F

- TS0104042 .....2
- TS0102001 .....2
- SK\_M3X8 .....2
- TS0101007 .....2
- SIG\_M3X6 .....2

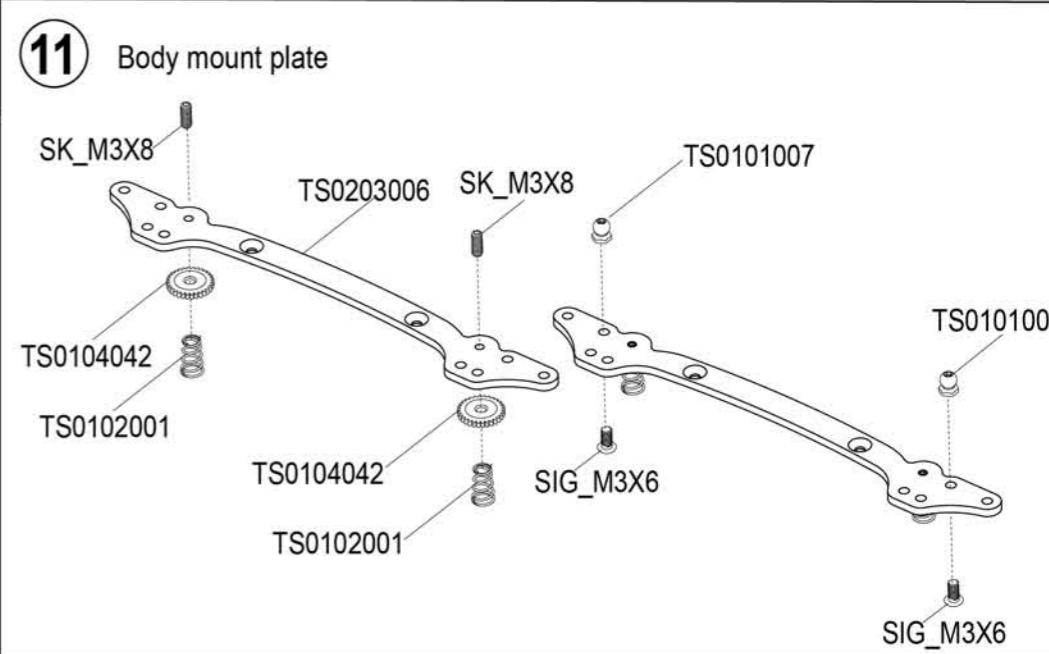



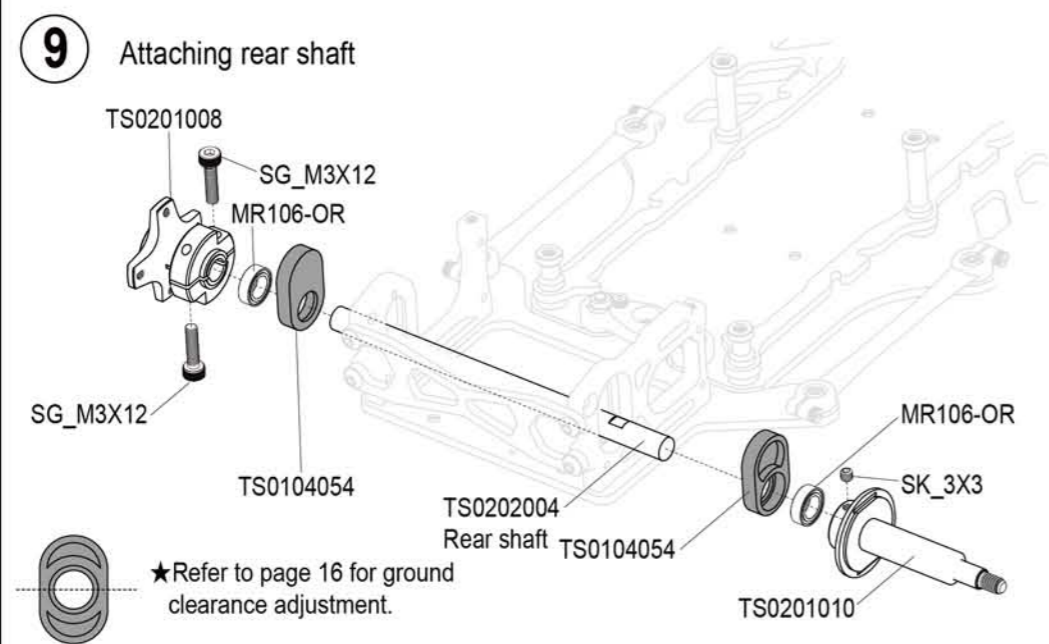

**E** Kit Bag E

- SG\_M3X12 .....2
- SK\_3X3 .....1
- MR106-OR .....2  
6X10X3
- TS0201008 .....1

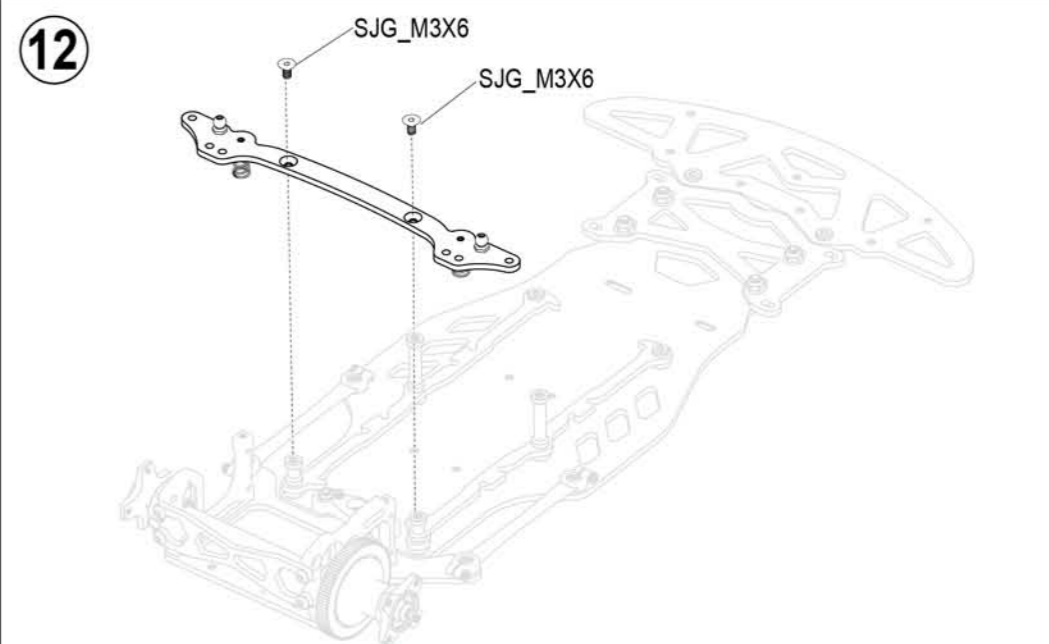





- SJG\_M3X6 .....2

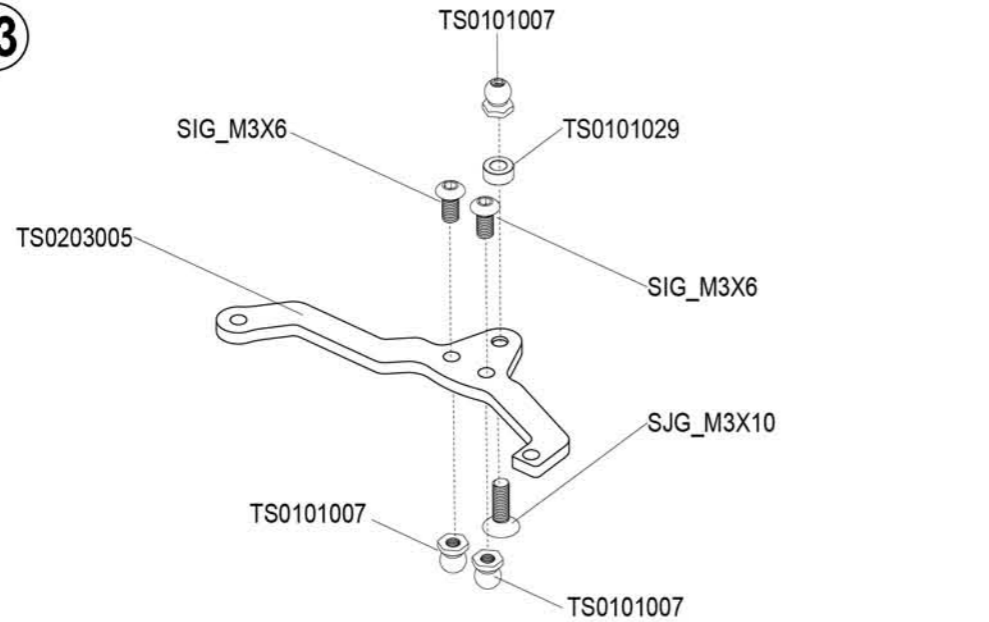

-  TS0101007 .....3
-  TS0101029 .....1
-  SIG\_M3X6 .....2
-  SJG\_M3X10 .....1

**13**



-  TS0104026 .....4
-  TS0101018 .....2
-  TS0104080 .....2
-  SK\_M3X10 .....2



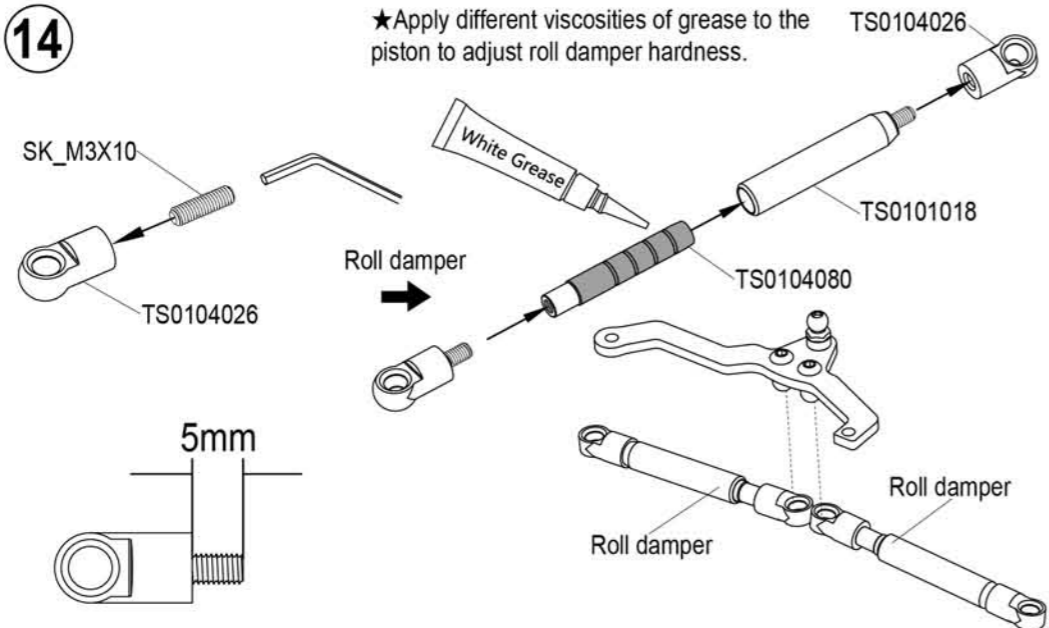

**14**

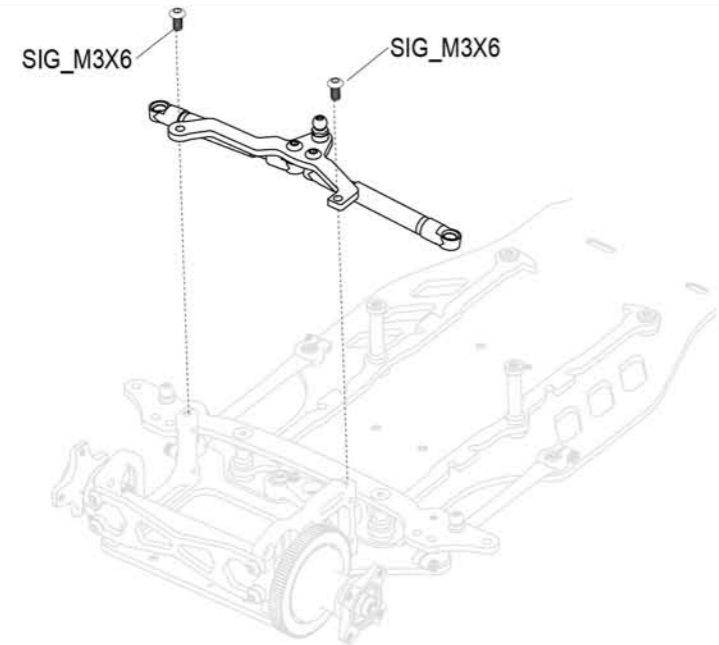

-  SIG\_M3X6 .....2

**15**





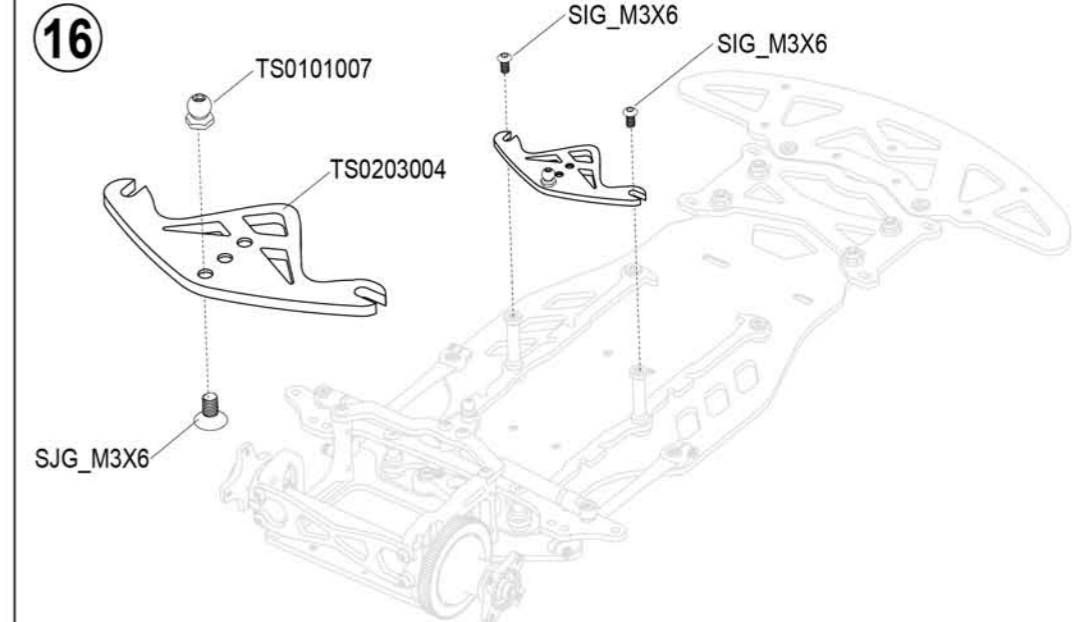

-  TS0101007 .....1
-  TS0203004 .....1
-  SJG\_M3X6 .....1
-  SIG\_M3X6 .....2

**16**



**G**  
BAG Kit Bag G



17~25

-  TS0101007 .....2
-  TS0101029 .....2
-  TS0104023 .....2
-  SIG\_M3X10 .....2

**17**

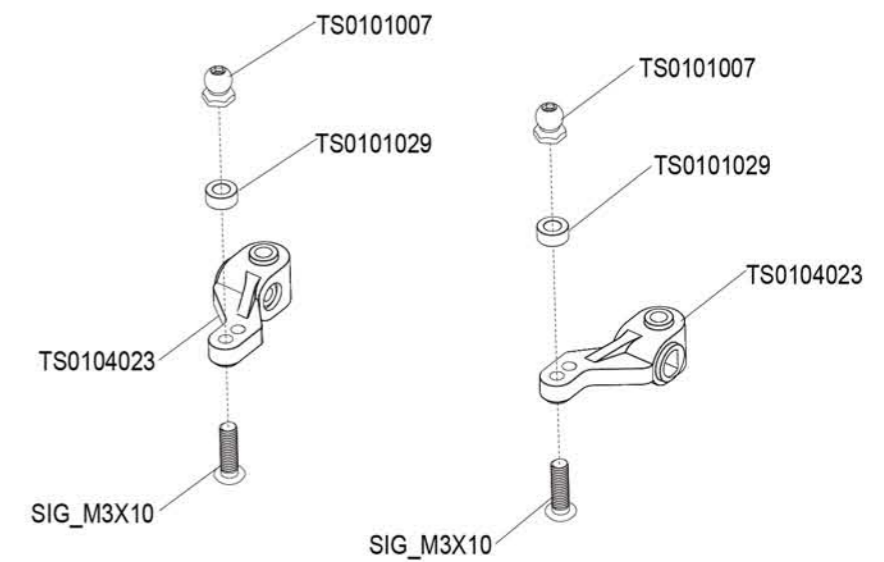
Attaching front uprights





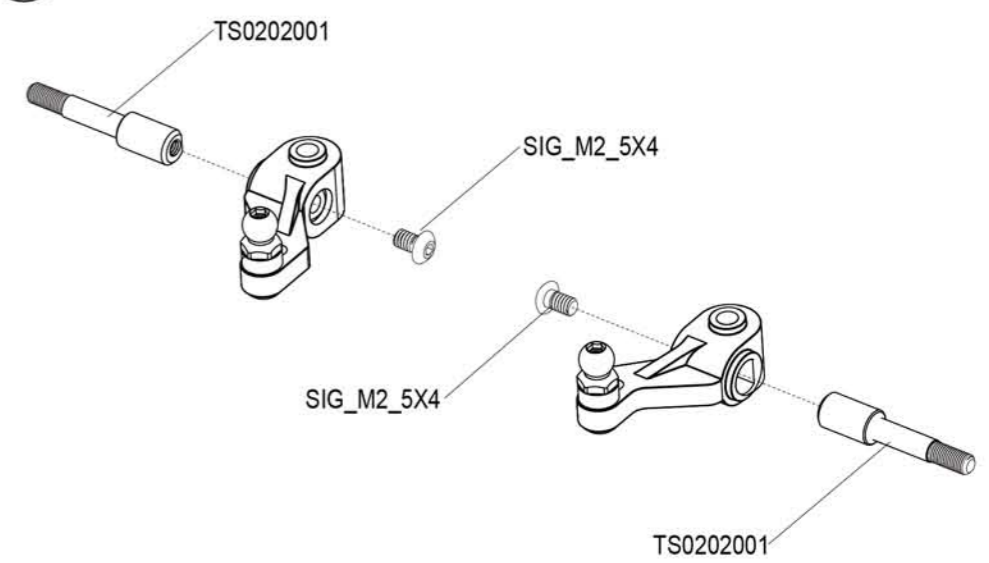

-  TS0202001 .....2
-  SIG\_M2\_5X4 .....2

**18**





GT500W offset upright assembly



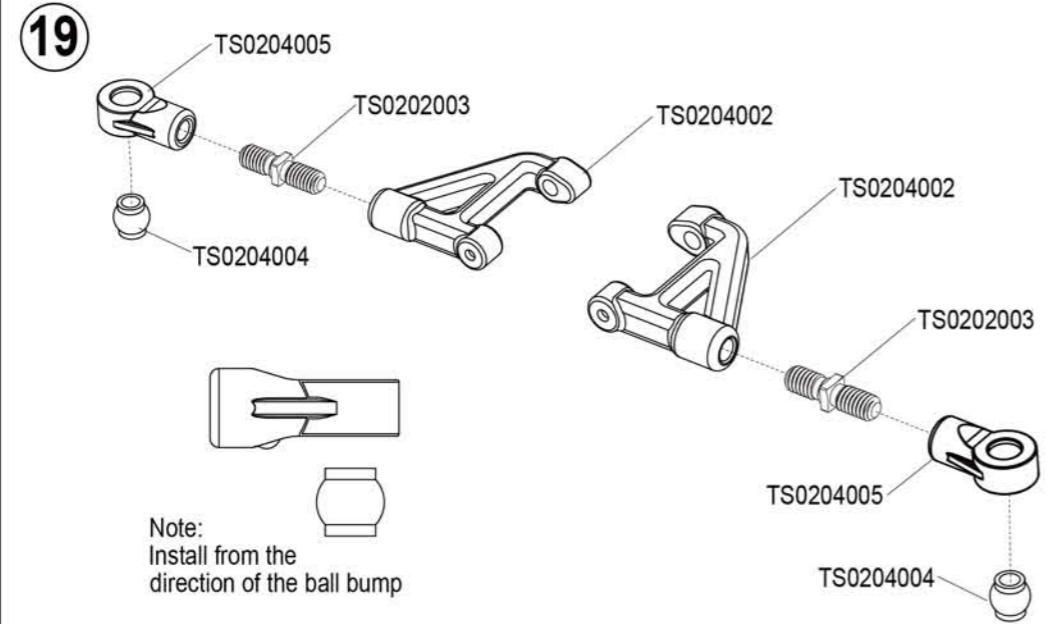





-  TS0204004 .....2
-  TS0204002 .....2
-  TS0202003 .....2
-  TS0204005 .....2

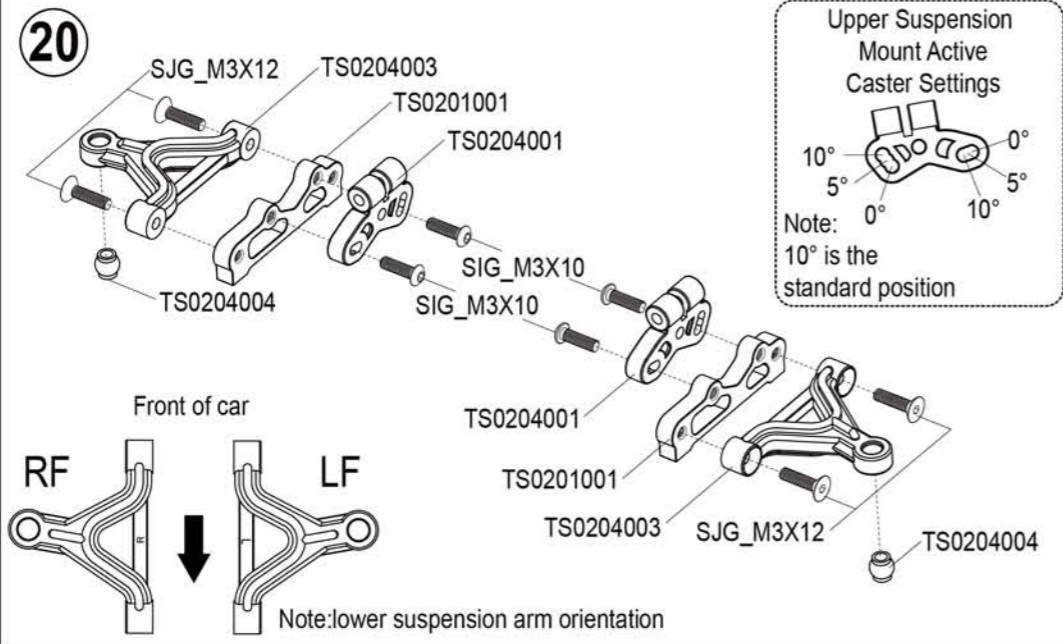





-  TS0204004 .....2
-  TS0201001 .....2
-  TS0204001 .....2
-  SJG\_M3X12 .....4
-  SIG\_M3X10 .....4

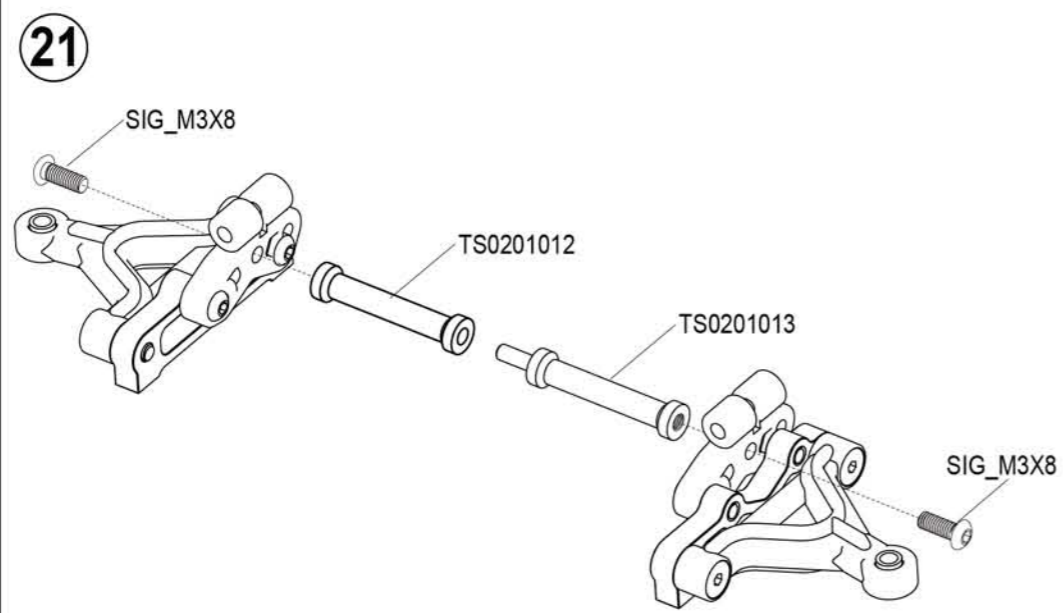

-  TS0201012 .....1
-  TS0201013 .....1
-  SIG\_M3X8 .....2





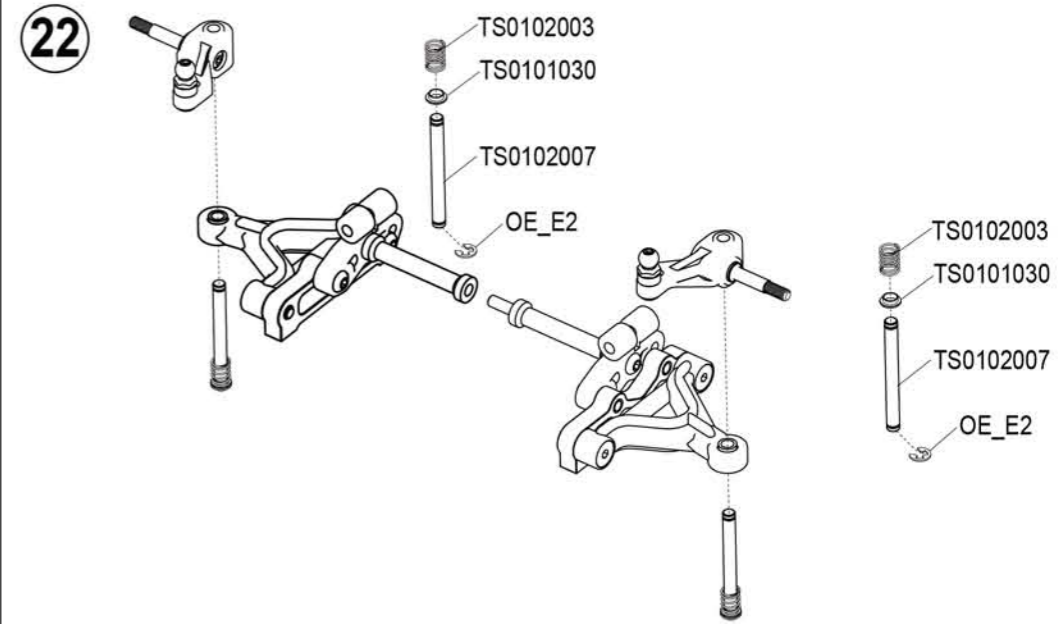

-  OE\_E2 .....2
-  TS0101030 .....2
-  TS0102003 .....2
-  TS0102007 .....2

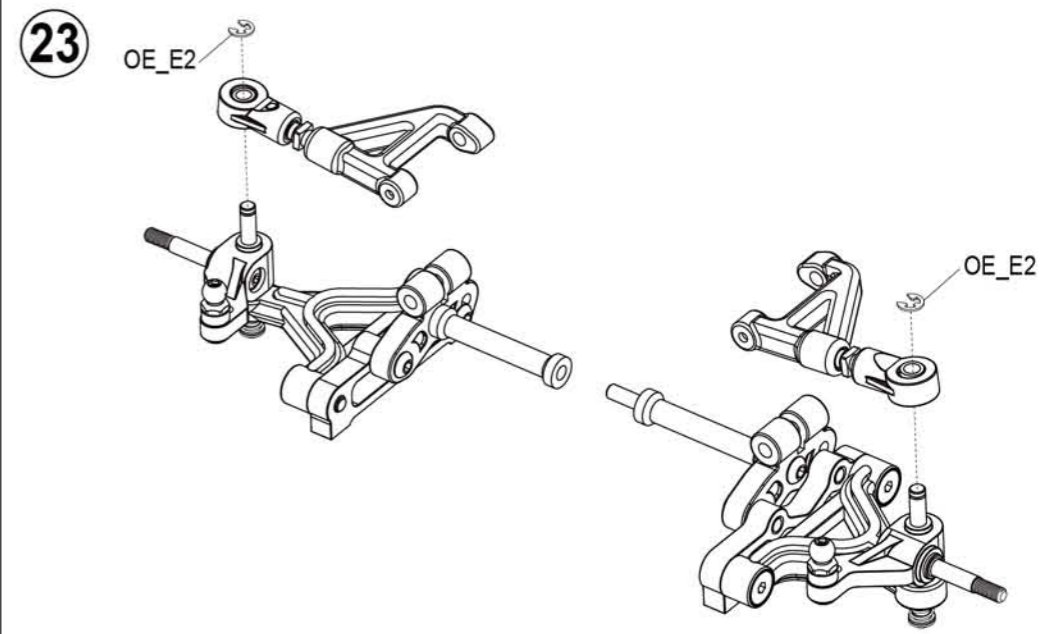





-  OE\_E2 .....2

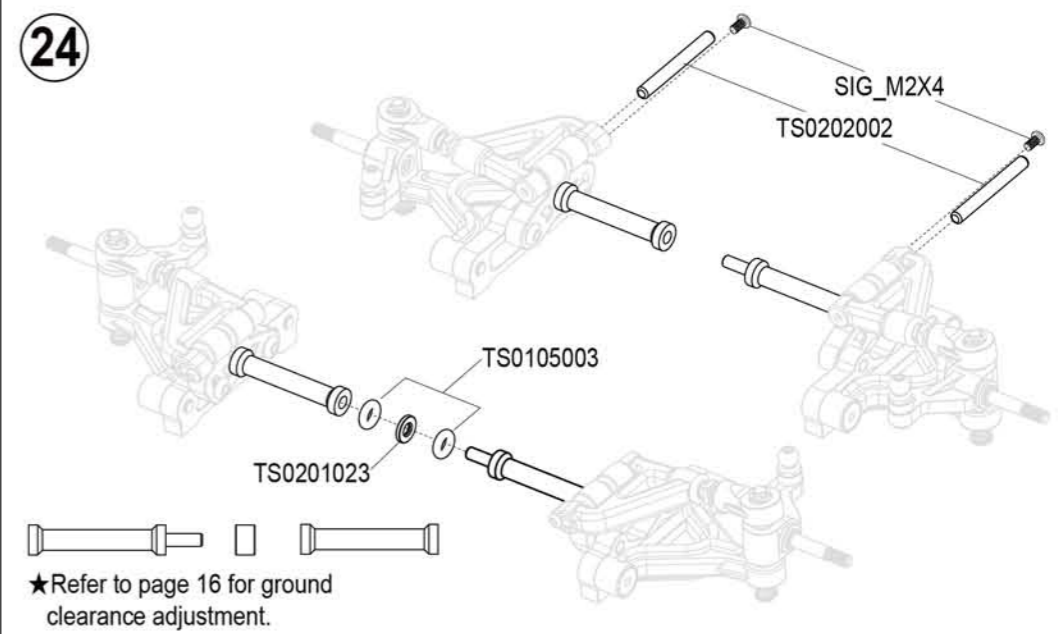

-  SIG\_M2X4 .....2
-  TS0202002 .....2
-  TS0201024 .....1
-  TS0201023 .....1
-  TS0105003 .....2







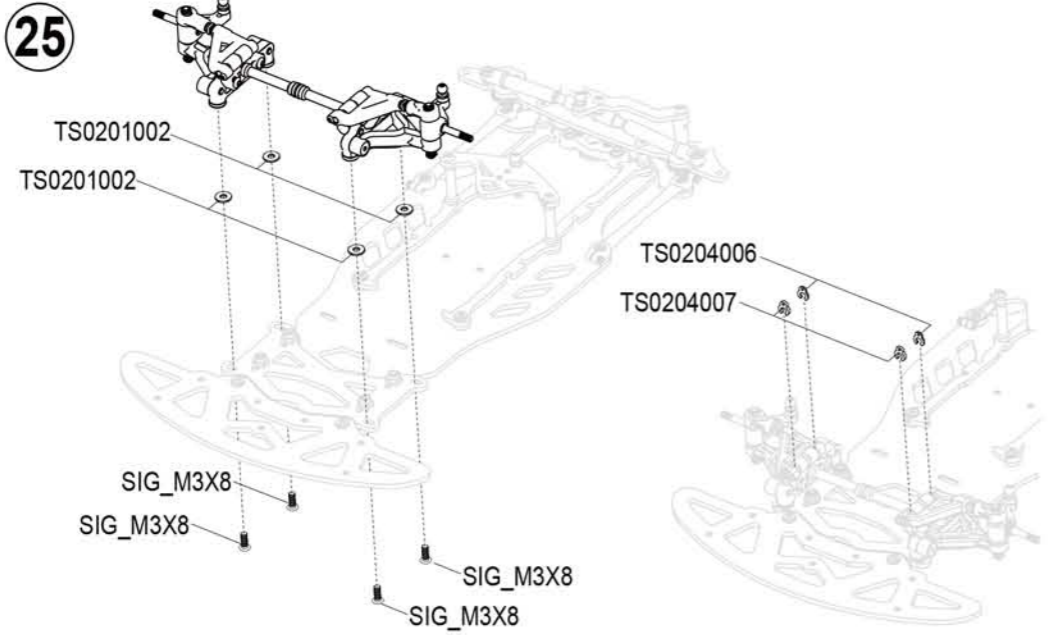

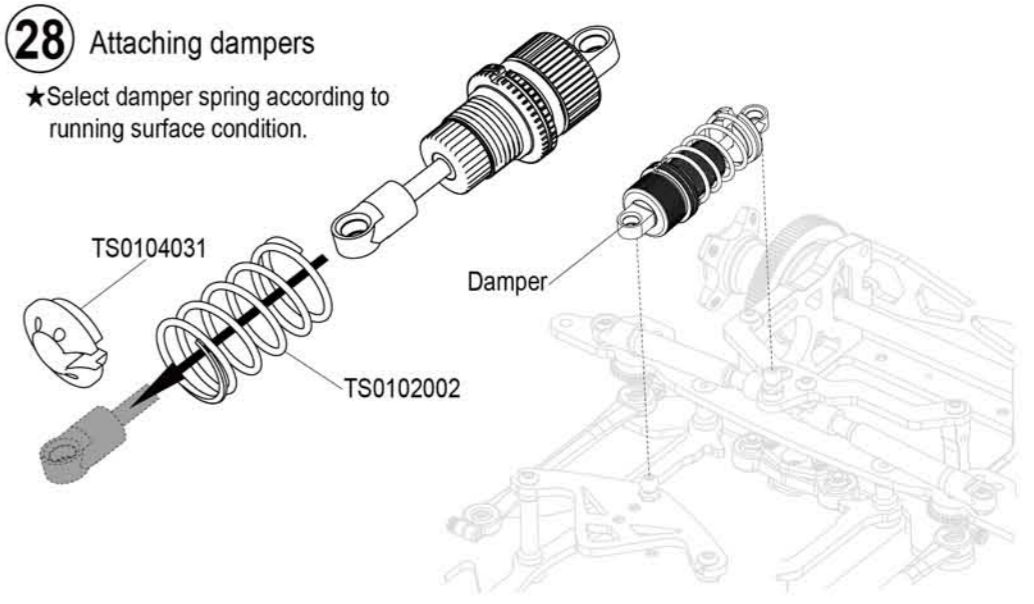

-  TS0201002 .....4
-  SIG\_M3X8 .....4
-  TS0204006 .....2
-  TS0204007 .....2







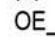

-  TS0102002 .....1

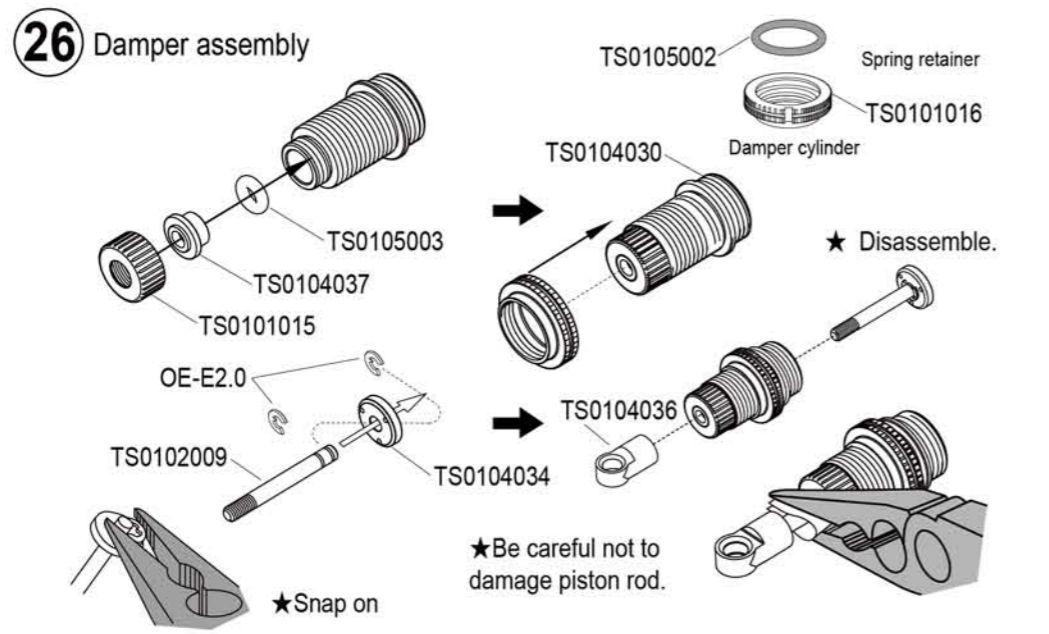



**H BAG** (26~32) Kit Bag H

-  TS0105003 .....1
-  TS0104034 .....1
-  TS0104037 .....1
-  TS0102009 .....1
-  OE\_E2 .....2
-  TS0105002 .....1

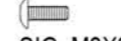

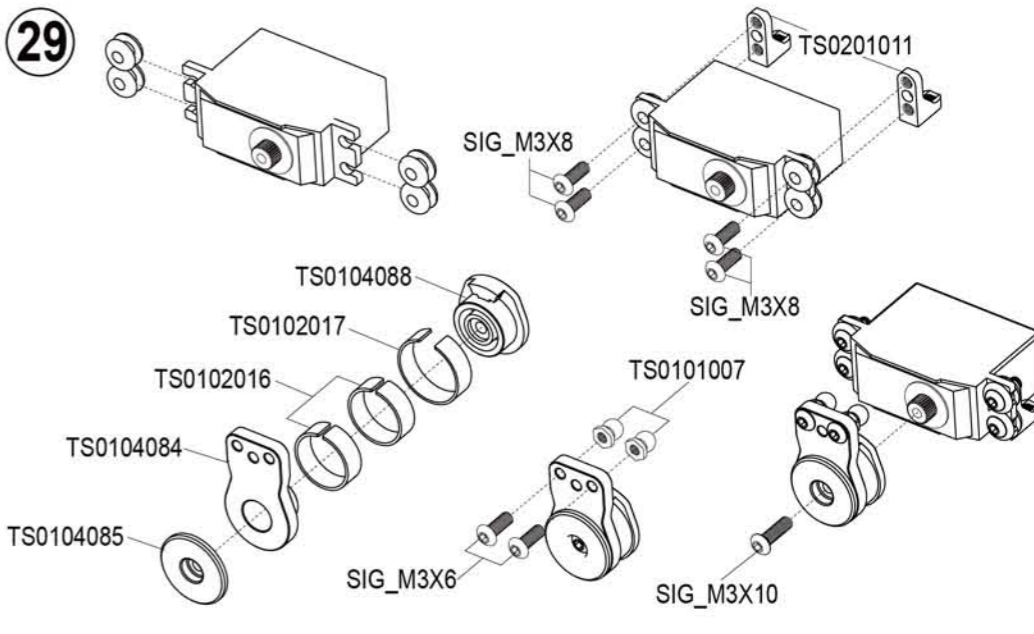
-  TS0201011 .....2
-  TS0102017 .....1
-  TS0102016 .....2
-  TS0104084 .....2
-  SIG\_M3X10 .....1
-  SIG\_M3X8 .....4



-  TS0105001 .....1

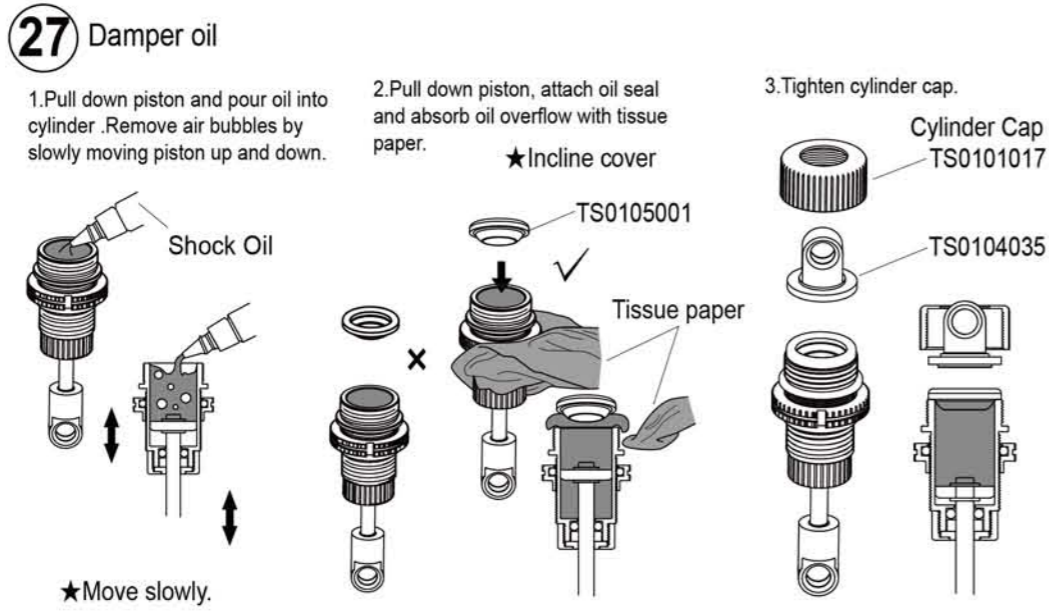

-  SJG\_M3X6 .....2

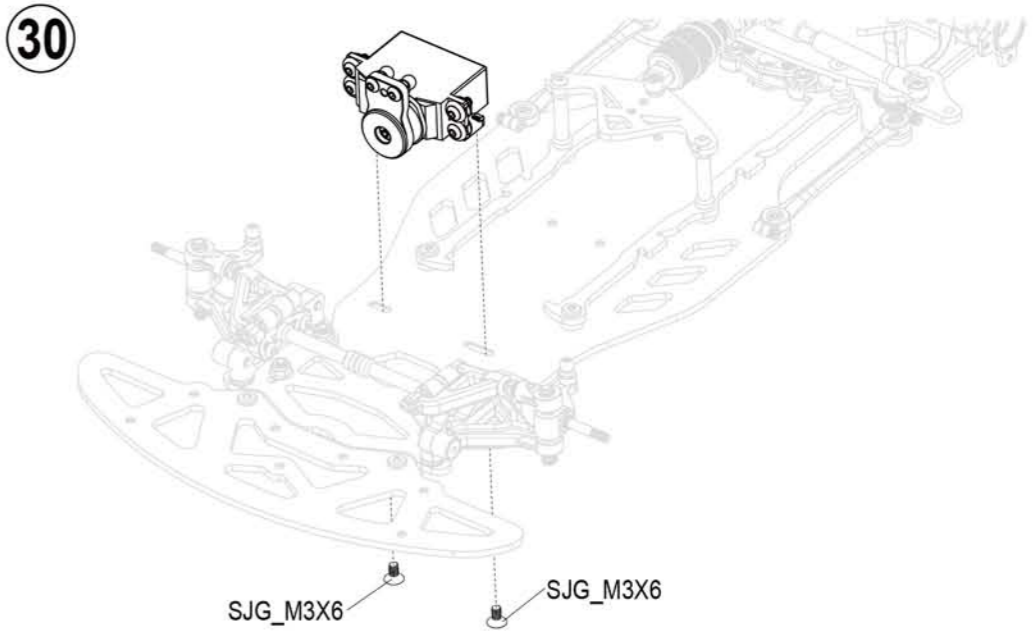

- TS0102008 .....2
- TS0104027 .....4

**31** Servo saver

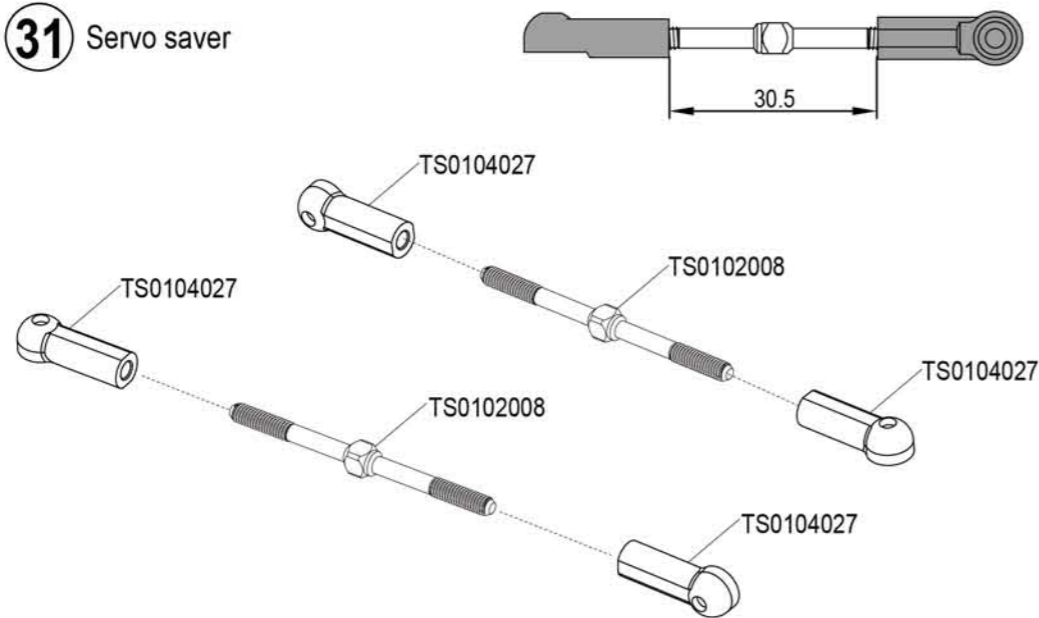

**32**

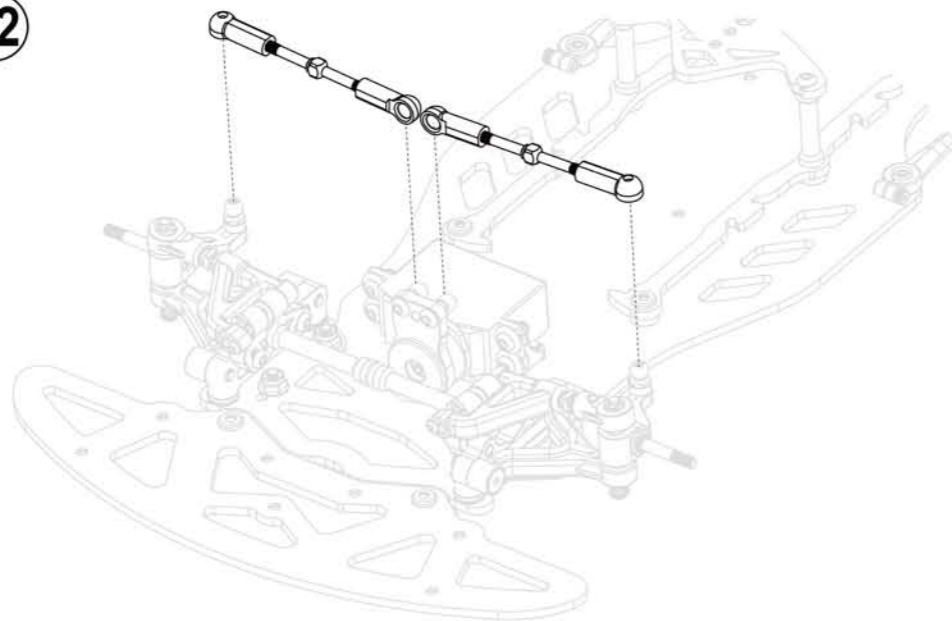

**33**

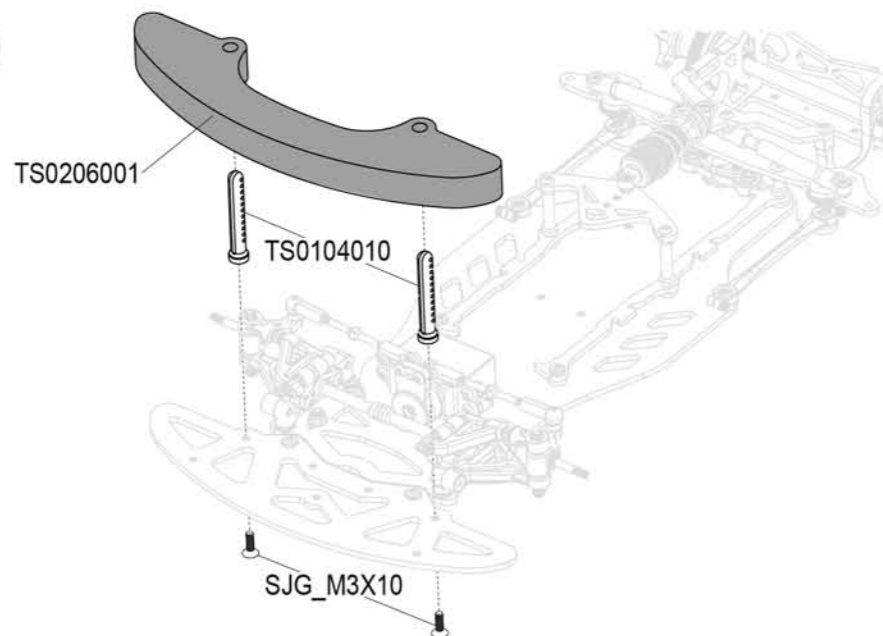

**I**  
BAG  
33~42  
Kit Bag I

- TS0104010 .....2
- SJG\_M3X10 .....2

- TS-P034\_R6 .....2
- TS0104003 .....2

**34**

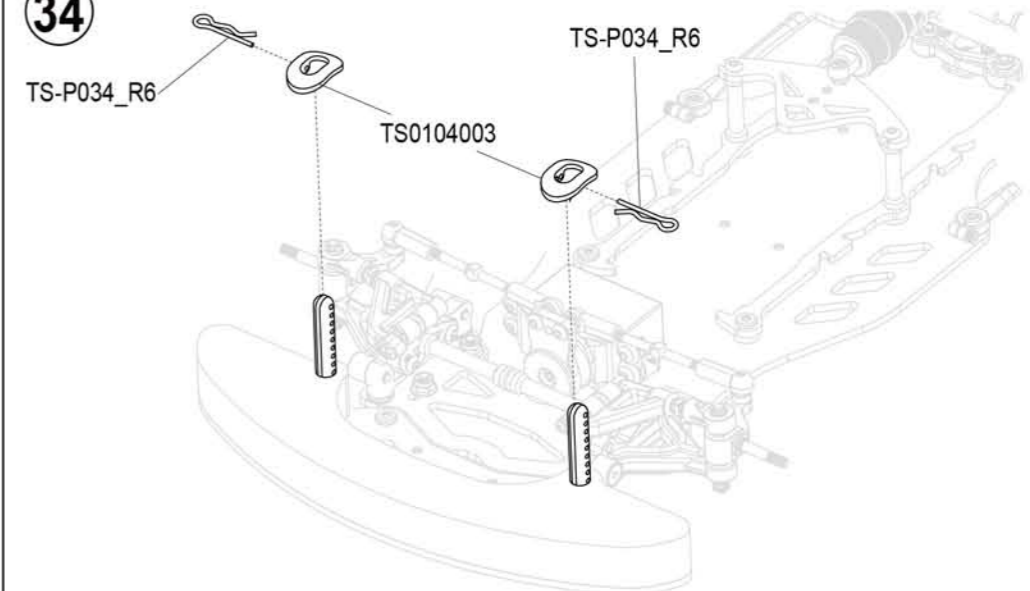

- TS-P034\_R6 .....2
- TS0104003 .....2
- TS0104010 .....2
- SIG\_M3X8 .....2

**35**

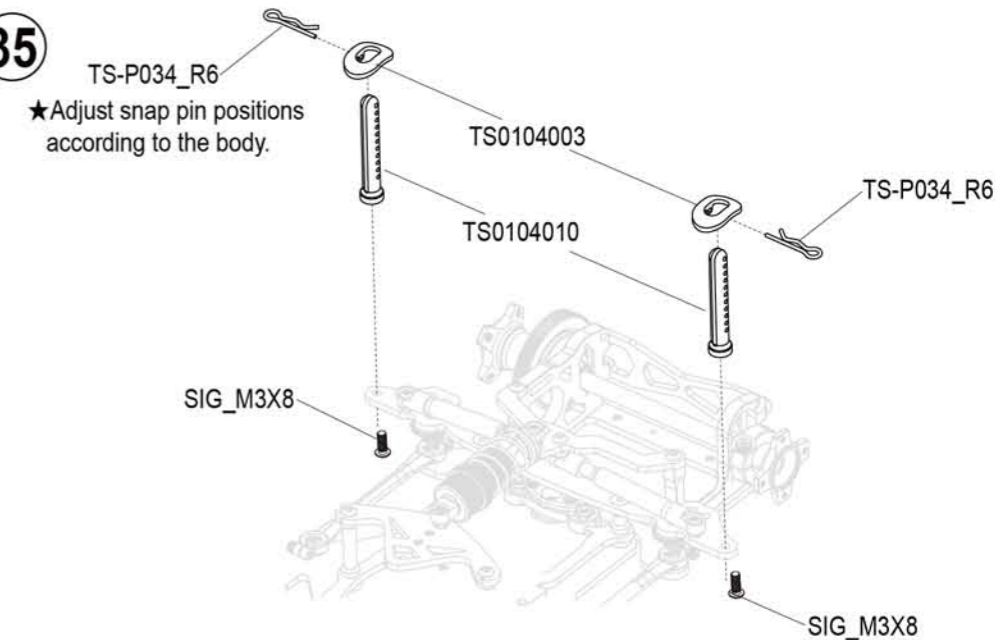

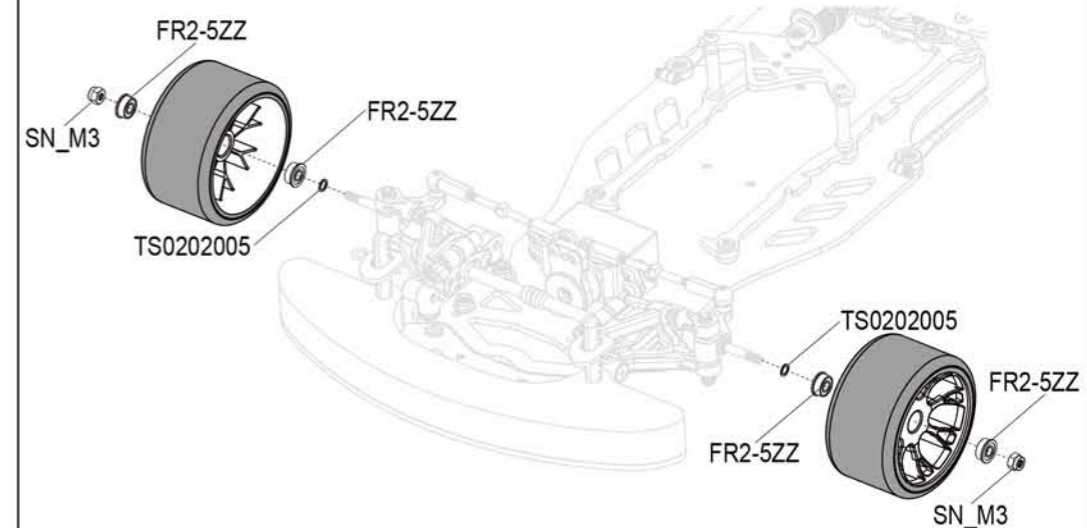

- FR2-5ZZ .....4
- SN\_M3 .....2
- TS0202005 .....2

**36**





-  SG\_M3X8 .....8
-  SK\_3X3 .....1
-  SIG\_M3X8 .....2

**37**

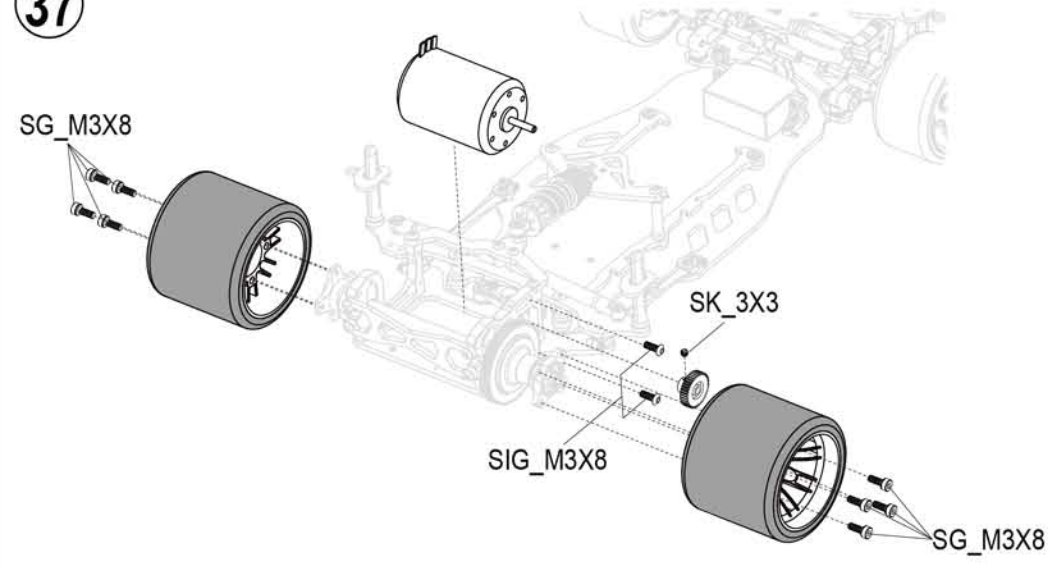

**38** 2S Standard battery assemble as below

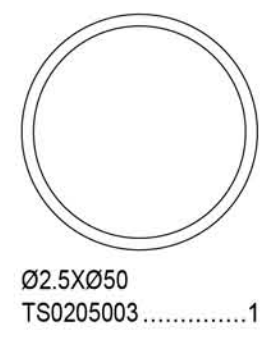
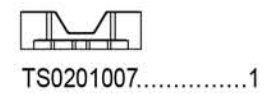
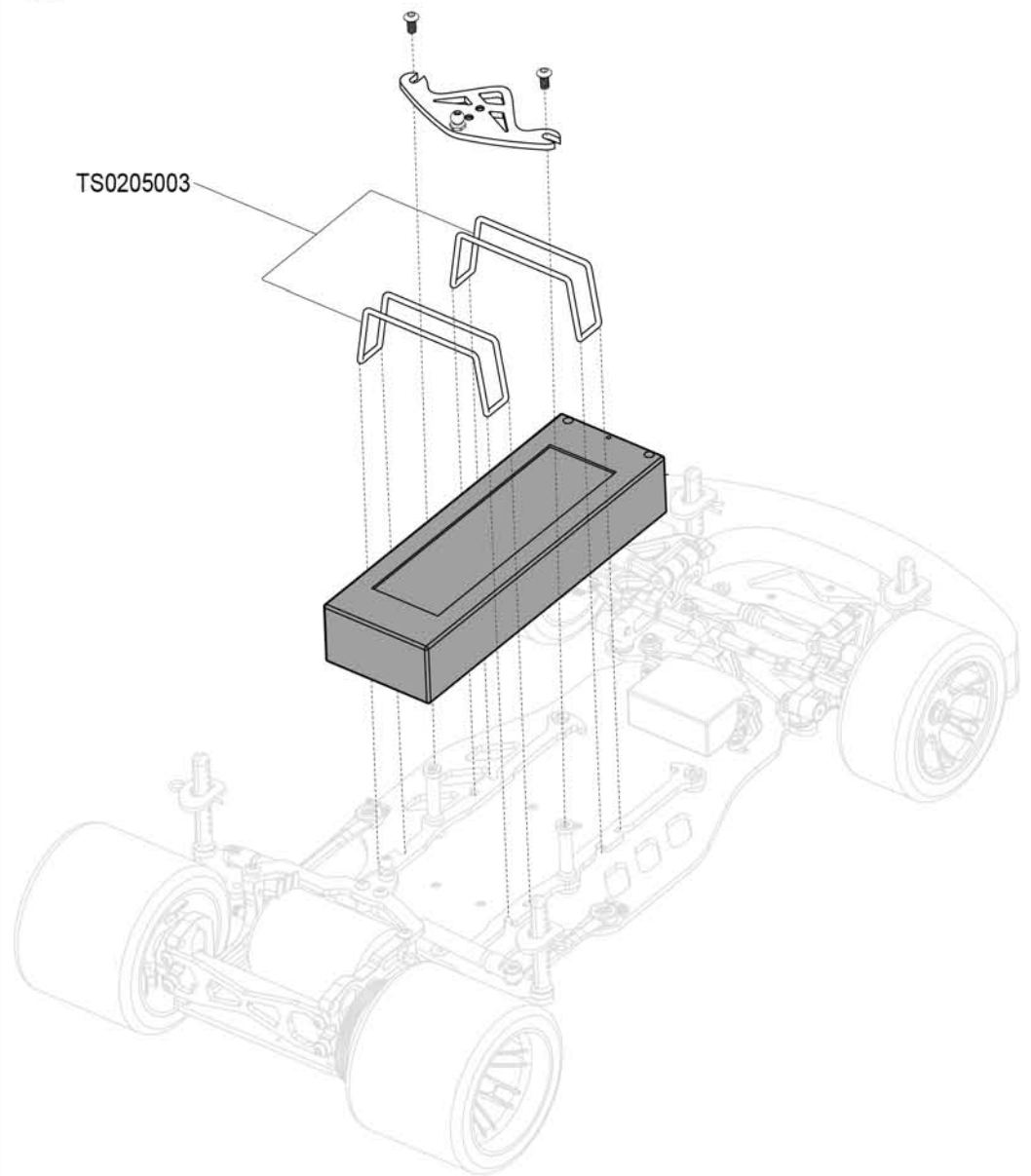
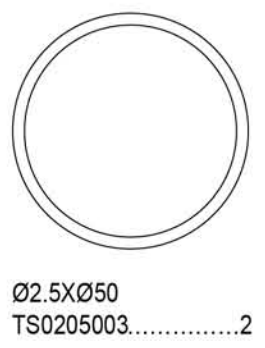

**39** 2S Short battery assemble in front position

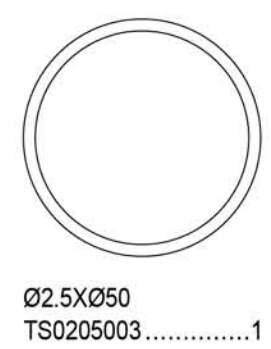
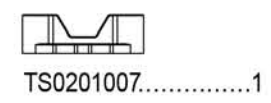
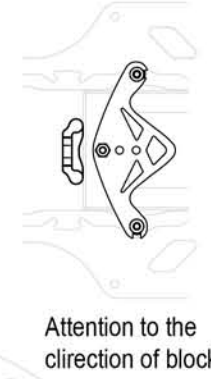
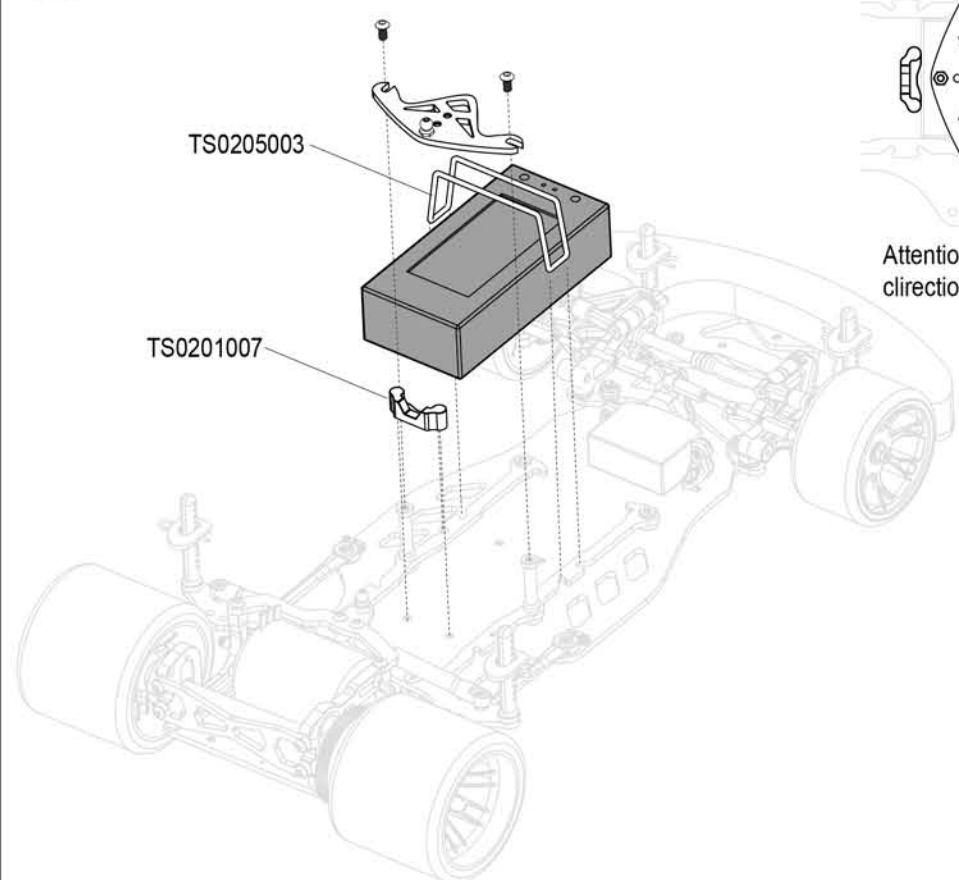

**40** 2S Short battery assemble in rear position

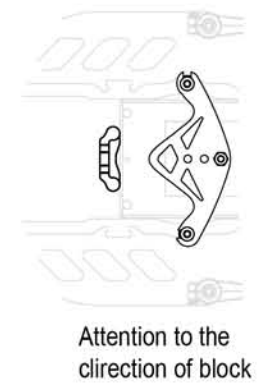
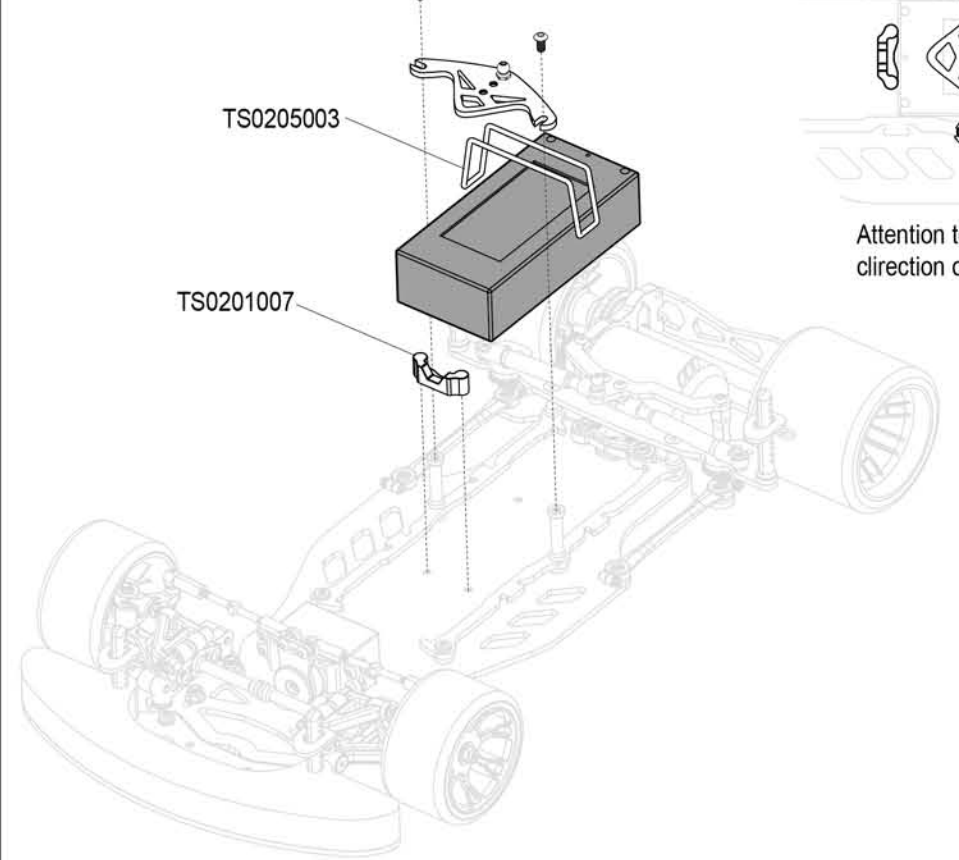



TS0201007.....1

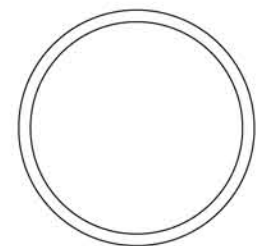

Ø2.5XØ44  
TS0205002.....1

### 41 1S Battery assemble in front position

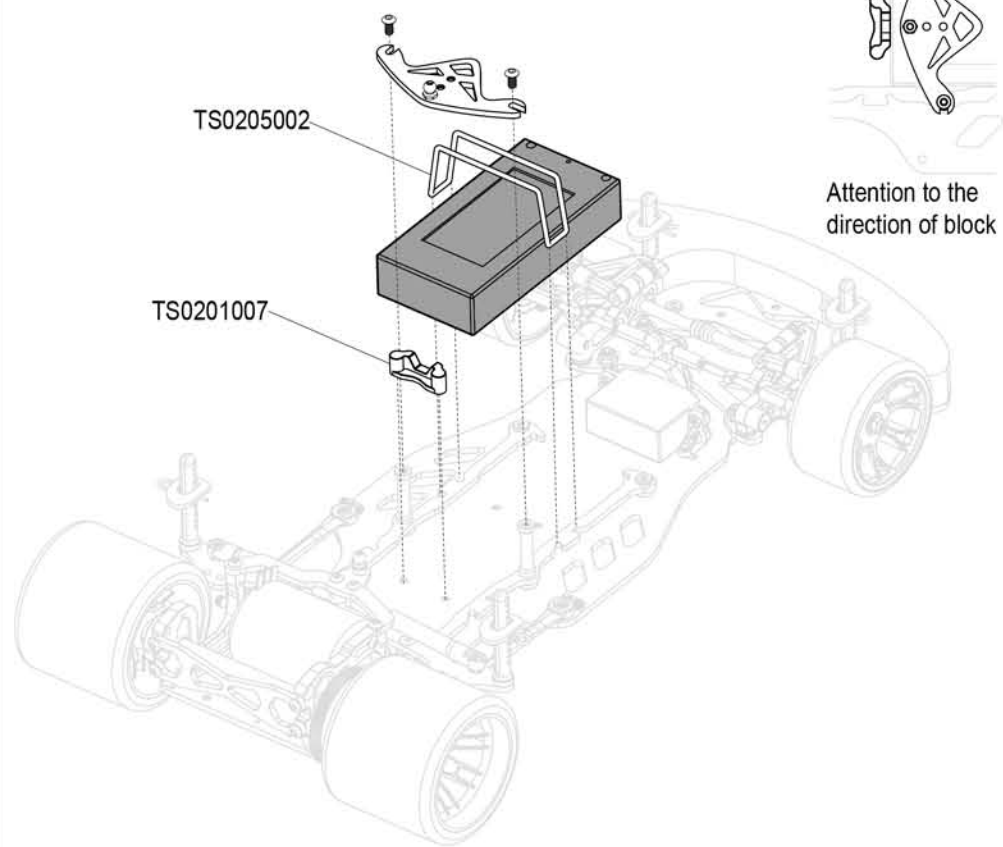

TS0201007.....1

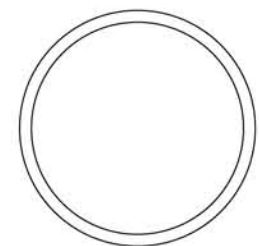

Ø2.5XØ44  
TS0205002.....1

### 42 1S Battery assemble in rear position

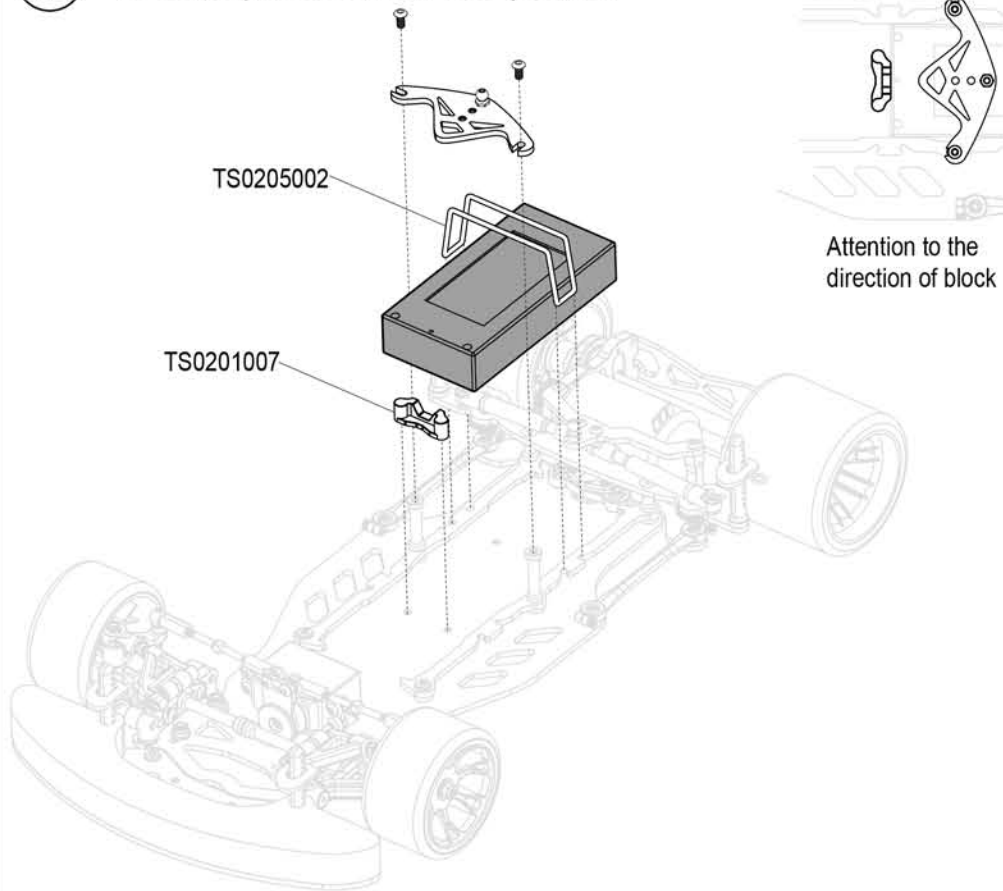

## SETTING - UP

- Record various running conditions and settings on the setting sheet on page 16.

### TOE-IN AND TOE-OUT

Toe-in and toe-out

- Adjust rod length by rotating adjuster.

- Make sure the servo is in neutral.

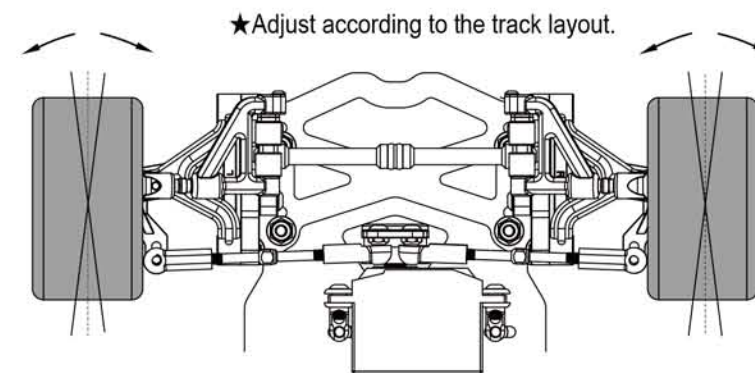
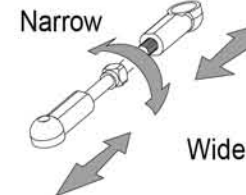

### CAMBER ANGLE

Camber angle

- Adapt for the draw bar to adjust camber angle.

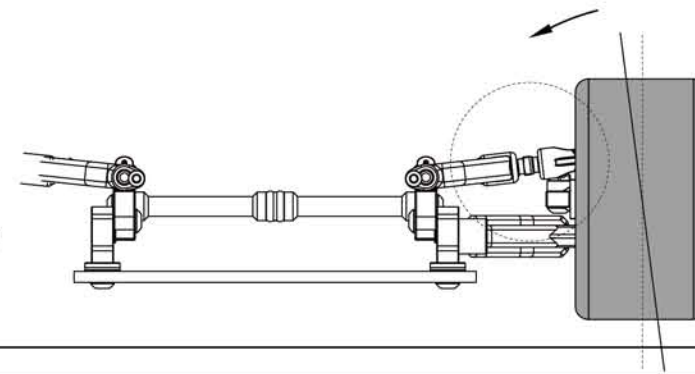
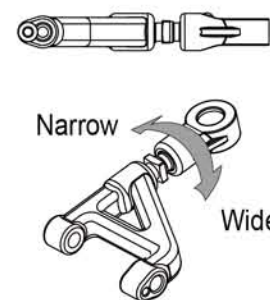

### GROUND CLEARANCE

Front

- Ways for adjusting the turnbuckle to fit the hardness of the front suspension

