

Name: Shin Adachi Date: 28/Feb/2010 Truck / City: R/C Addict Event: TITC2010

Front Suspension

Upper Spacer: 2.5 mm (1 2 3 4 5 6 7 8)

King Pin: Standard UM128

Upper Spacer: 0 mm

Knuckle Spacer: Upper Lower

Wheel Spacer: 0.5 mm

Drive Hub: LAW30R (4.5) TFW031 (5.2)

Drop: 8.5 mm

Upper Rod Position:

Diff. Position:

Sus. Arm Spacer: Front 2 mm Rear 1 mm

Knuckle Spacer: 1 mm

Ride Height: 3.8 mm

Sway Bar: None

Toe Angle: 0.5 °

Front Diff.: Spool Oneway Diff.

Notes: _____

Sus. Holder Bush: Front A In / Out E

Sus. Holder Spacer: 2 mm

Rear A In / Out E

Sus. Holder Spacer: 2 mm

Camber Angle: 2.0 °

Rear Suspension

Upper Spacer: 1.75 mm (1 2 3 4 5 6 7)

Upper Rod Position:

Upper Spacer: 0 mm

Wheel Spacer: 1.75 mm

Drive Hub: LAW30R (4.5) TFW031 (5.2)

Drop: 8 mm

Sus. Arm Spacer: Front 3 mm Rear 0 mm

Diff. Position:

Ride Height: 4.0 mm

Sway Bar: None

Hub Carrier Spacer: Front 1 mm Rear 1 mm

Camber Angle: 2 °

Sus. Holder Bush: Front A IN / OUT D

Sus. Holder Spacer: 2.0 mm

Rear A IN / OUT D

Sus. Holder Spacer: 2.0 mm

Shock

	Front	Rear
Shock Oil:	# 80 (LRP)	# 80 (LRP)
Shock Spring:	Pink (#28)	Pink (#28)
Diaphragm:	Std	Std
Pressure Form:	None	None
Shock Length:	_____ mm	_____ mm

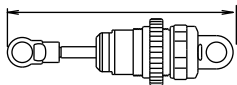

Steering Wiper

Steering Spacer: 1.5 mm

Chassis

Battery Position: IN OUT

Weight: 28 g

Weight: 10 g

Weight: 40 g

Weight: _____ g

Weight: _____ g

Front Belt Position: Right Left

Tire

Tire	Comments
Much More AT-32	Controlled tire
Much More	-----
Much More	-----
1st: Mighty	2nd: _____

Others

Motor	ORION 2009	4.0T	2nd Gear Ratio: 1.83
Pinion/Spur	<u>25</u>	/ <u>116</u>	Gear Ratio <u>8.43</u>
Battery	ORION Lipo 5400 45C	ESC	SXX TC Speck (1-4-2-2)
Body	Speed6 Light Weight	Wing	Std

Track Condition

<input checked="" type="checkbox"/> Smooth	<input checked="" type="checkbox"/> Asphalt
<input checked="" type="checkbox"/> Bumpy	<input type="checkbox"/> Concrete
<input type="checkbox"/> Low Truction	<input type="checkbox"/> Carpet
<input type="checkbox"/> Med. Truction	<input type="checkbox"/> Indoor
<input checked="" type="checkbox"/> High Truction	<input checked="" type="checkbox"/> Outdoor

Comment: Weight 1410g