

Name: Shin Adachi Date: 13/Dec/2009 Truck / City: Kyosho Circuit Event: Futa-san Cup

### Front Suspension

Upper Spacer: 2.5 mm (1 2 3 4 5 6 7 8)

King Pin:  Standard  UM128

Upper Spacer: 0.5 mm

Knuckle Spacer:  Upper  Lower

Wheel Spacer: 0.5 mm

Drive Hub:  LAW30R (4.5)  TFW031 (5.2)

Droop: 8.5 mm

Upper Rod Position:

Diff. Position:

Sus. Arm Spacer: Front 2 mm Rear 1 mm

Knuckle Spacer: 1 mm

Ride Height: 4.2 mm

Sway Bar: None

Toe Angle: 0.5 °

Front Diff.:  S pool  Oneway  Diff.

Notes: \_\_\_\_\_

Sus. Holder Bush: Front A In / Out E

Sus. Holder Spacer: 2.0 mm

Rear A In / Out E

Camber Angle: 2.0 °

### Rear Suspension

Upper Spacer: 1.75 mm (1 2 3 4 5 6 7)

Upper Rod Position:

Upper Spacer: 0 mm

Wheel Spacer: 1.5 mm

Drive Hub:  LAW30R (4.5)  TFW031 (5.2)

Droop: 8 mm

Sus. Arm Spacer: Front 3 mm Rear 0 mm

Diff. Position:

Ride Height: 4.6 mm

Sway Bar: None

Hub Carrier Spacer: Front 1 mm Rear 1 mm

Camber Angle: 2 °

Sus. Holder Bush: Front A IN / OUT D

Sus. Holder Spacer: 2.0 mm

Rear A IN / OUT D

### Shock

	Front	Rear
Shock Oil:	<u>1.2 - 2</u> # 30 (X-Gear Blue)	<u>1.2 - 2</u> # 27.5 (X-Gear Blue)
Shock Spring:	<u>Gold</u> (X-Gear)	<u>Gold</u> (X-Gear)
Diaphragm:	<u>Std</u>	<u>Std</u>
Pressure Form:	<u>None</u>	<u>None</u>
Shock Length:	<u>    </u> mm	<u>    </u> mm

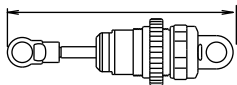

### Steering Wiper

Steering Spacer: 1.5 mm

### Chassis

Battery Position:  IN  OUT

Weight:      g

Weight:      g

Weight:      g

Weight:      g

Front Belt Position:  Right  Left

### Tire

Tire	Comments
<u>Kyosho (KC-M)</u>	<u>Controlled tire</u>
<u>Kyosho</u>	-----
<u>Kyosho</u>	-----
Traction Compound 1st: <u>Mighty</u> 2nd: <u>    </u>	-----

### Others

Motor	<u>ORION 2009 4.5T</u>	2nd Gear Ratio: <u>1.83</u>
Pinion/Spur	<u>23 / 116</u>	Gear Ratio <u>9.22</u>
Battery	<u>ORION Lipo 5400 45C</u>	ESC <u>SXX TC Speck (1-2-2-2)</u>
Body	<u>Speed6 Light Weight</u>	Wing <u>Std</u>

### Track Condition

<input checked="" type="checkbox"/> Smooth	<input checked="" type="checkbox"/> Asphalt
<input type="checkbox"/> Bumpy	<input type="checkbox"/> Concrete
<input checked="" type="checkbox"/> Low Truaction	<input type="checkbox"/> Carpet
<input type="checkbox"/> Med. Truaction	<input type="checkbox"/> Indoor
<input type="checkbox"/> High Truaction	<input checked="" type="checkbox"/> Outdoor

Comment: Weight 1335g