

Name: Chrissi Krapp Date: January 2011 Truck / City: Odense, DK Event: DHI Cup 2011

Front Suspension

Upper Spacer: 3 mm

King Pin: Standard UM128

Upper Spacer: 0 mm

Knuckle Spacer: Upper Lower

Wheel Spacer: 0 mm

Drive Hub: LAW30R (4.5) TFW031 (5.2)

Droop: 6 mm

Upper Rod Position:

Diff. Position:

Sus. Arm Spacer: Front 2 mm Rear 1 mm

Knuckle Spacer: 1 mm

Ride Height: 5,0 mm

Sway Bar: 1,4mm

Toe Angle: -0,5 °

Sus. Holder Bush: Front In / Out D Rear In / Out D

Sus. Holder Spacer: Front 1 mm Rear 1 mm

Front Diff.: S pool Oneway Diff.

Camber Angle: 1,5 °

Notes: -----

Rear Suspension

Upper Spacer: 1.75 mm

Upper Rod Position:

Upper Spacer: 0 mm

Wheel Spacer: 0,5 mm

Drive Hub: LAW30R (4.5) TFW031 (5.2)

Droop: 5 mm

Sus. Arm Spacer: Front 2 mm Rear 1 mm

Diff. Position:

Ride Height: 5,2 mm

Sway Bar: 1,2mm

Hub Carrier Spacer: Front 1 mm Rear 1 mm

Sus. Holder Bush: Front IN / OUT D Rear IN / OUT D

Sus. Holder Spacer: Front 1 mm Rear 1 mm

Camber Angle: 2 °

Shock

	Front	Rear
Shock Oil:	<u>3-hole</u>	<u>3-hole</u>
Shock Spring:	<u>Tam. white</u>	<u>Tam. blue</u>
Diaphragm:	<u>stock</u>	<u>stock</u>
Pressure Form:	<u>none</u>	<u>none</u>
Shock Length:	<u>65</u> mm	<u>65</u> mm

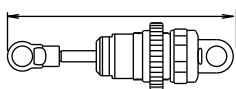

10% rebound

Steering Wiper

Steering Spacer: 1,5 mm

Chassis

Weight: 10 g

Battery Position: IN OUT

Weight: 25 g

Weight: 10 g

Weight: ___ g

Front Belt Position: Right Left

Weight: ___ g

Tire

Tire	Comments
<u>LRP CPX</u>	-----
<u>LRP</u>	-----
<u>LRP</u>	-----
Traction Compound	1st: <u>CS high</u> 2nd: <u>Orion red</u>

Others

Motor: Orion 4,5T

Pinion/Spur: 24 / 116 Gear Ratio: 8,8

Battery: Orion 5400 ESC: LRP

Body: PF LTC Wing: PF LTC

2nd Gear Ratio: 1.83

Track Condition

<input type="checkbox"/> Smooth	<input type="checkbox"/> Asphalt
<input checked="" type="checkbox"/> Bumpy	<input type="checkbox"/> Concrete
<input type="checkbox"/> Low Truction	<input checked="" type="checkbox"/> Carpet
<input type="checkbox"/> Med. Truction	<input checked="" type="checkbox"/> Indoor
<input checked="" type="checkbox"/> High Truction	<input type="checkbox"/> Outdoor

Comment: tire additive 30 minutes (front and rear)