

Track Condition

Composition: Asphalt Carpet
Environment: Indoor Outdoor
Surface: Smooth Medium Bumpy
Traction: Low Medium High
Size: Tight Medium Open
Track Temp.: 24 **Air Temp.:** 16

Electronics

Motor: R1 13.5 V7 **Timing:** 28 timing mark
ESC: LRP Flow **Battery:** SMC 4400
Spur: 34 **Pinion:** 69 **Ratio:** 3.95

Aerodynamics

Body: BD Narda **Wing:** BD Charge

Front	Shocks	Rear
<u>Yellow</u>	- Spring -	<u>Red</u>
<u>450</u>	- Oil -	<u>450</u>
<u>4 x 1.1</u>	- Piston -	<u>4 x 1.1</u>
<u>25</u>	- Rebound (%) -	<u>25</u>
<u>no</u>	- Foam Inserts -	<u>no</u>

Anti-Roll Bar

1.4 1.2

Tires

GRP 32A - Inserts - GRP32A
 - Rims -
LG2 - Additive - LG2
10 min - Additive Time - 10 min

Fr Left	Fr Right	Surface	Rr Left	Rr Right
Heat 5 min			Heat 5 min	

Transmission

Gear Ball - Diff - Gear Ball
 - Oil - 1500
 - Oil Weight (Grs) -
 - Settings -
 Spool

4 Deg -ve Caster front
 0 Deg Caster rear
 10 Grams weight in front servo

Front

Toe: +0.75
Camber: -1.5
Droop: 5mm
Rideheight: 6
Wheel Hex: 0

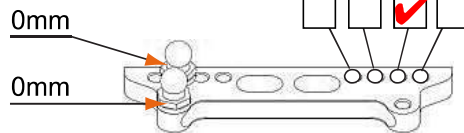
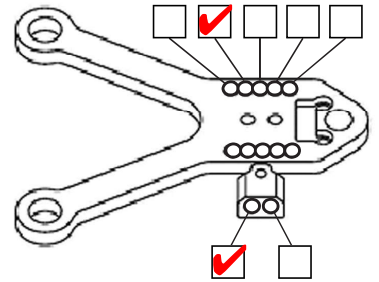
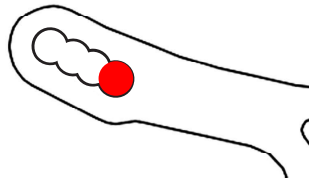
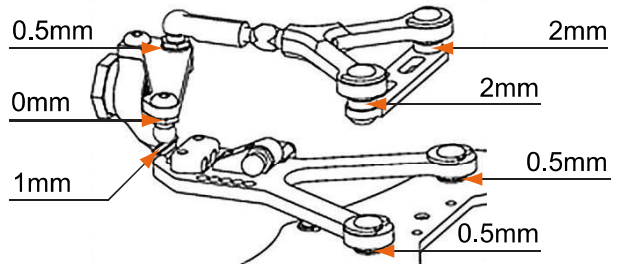

Rear

Toe: -2.5
Camber: -2
Droop: 4mm
Rideheight: 6.2
Wheel Hex: 0

