



## Part# 74900 SP12M VCS Micro Shock

Team Corally's VCS Micro Shock is developed as a higher volume, lightweight, constant travel shock to fit on the SP12M, and provides consistently smooth, superior dampening without the needs for frequent rebuilds. The VCS Micro Shock body is precision-machined from aircraft-quality aluminium, and is externally threaded for convenient spring pre-load adjustment. Internally, the shock utilizes exclusive VCS, 7075 aluminium shock piston, molded Teflon components and a precision-ground, case-hardened steel shock shaft which is extremely resistant to bending.

### Step 1

**1x black VC foam**  
**1x VC housing**

1. Remove the plastic **VC housing** from the parts tree.
2. Soak the **VC foam** with your shock oil. Use our Corally silicone oil.
3. Push the foam into the housing.

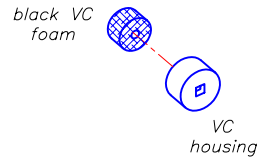

### Step 2

**1x shock shaft and piston**  
**1x body**

1. Keep shock **body** straight up and fill with oil up to the upper groove.
2. Insert **shaft/piston** all the way to the bottom.

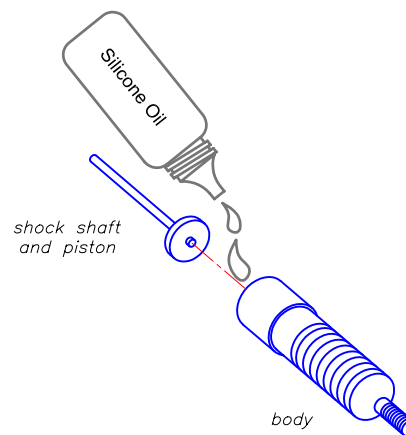

### Step 3

**1x clip**  
**1x large washer**  
**1x red O-ring**  
**1x small washer**

1. Remove the **small** and **large** washer from the parts tree. Remove any flash from the washers.
2. Slide the **VC housing** with the foam onto the shaft, housing first (so the foam is still seen though the body opening).
3. Slide on the following in this order: smaller washer, **red O-ring**, **larger washer**, then the star-shaped **clip**.

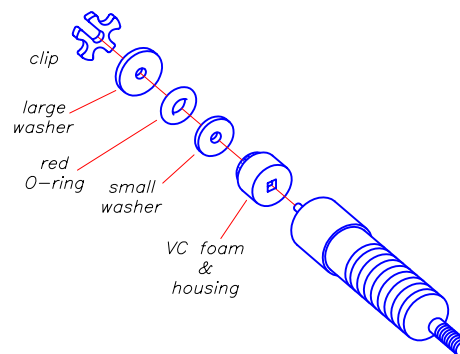

### Step 4

1. Use the **assembly tool** to push all the parts down into the **body** until the **clip** snaps into the groove. When you remove the tool, the shaft will push out somewhat if everything snapped into place correctly. Make sure the **clip** snaps into the groove completely.

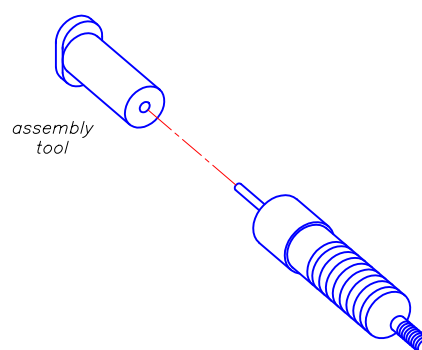

## Step 5

1. Remove the **assembly tool** and screw on the **ball cup** where shown.
2. Screw the **spring adjusting nut** onto the shock body threads, flange first, as shown.

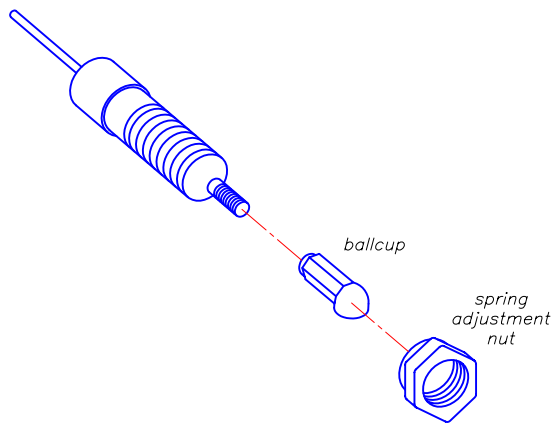

## Step 6

- 1x green spring (soft)
- 1x silver spring (hard)
- 1x shock shaft end
- 1x ball cup
- 1x setscrew

1. Slide the **spring** over the body and up against the **adjusting nut**.
2. Screw the **ball cup** onto the **shock shaft end**.
3. Tighten the shock rod and to the shaft with the **set screw**.

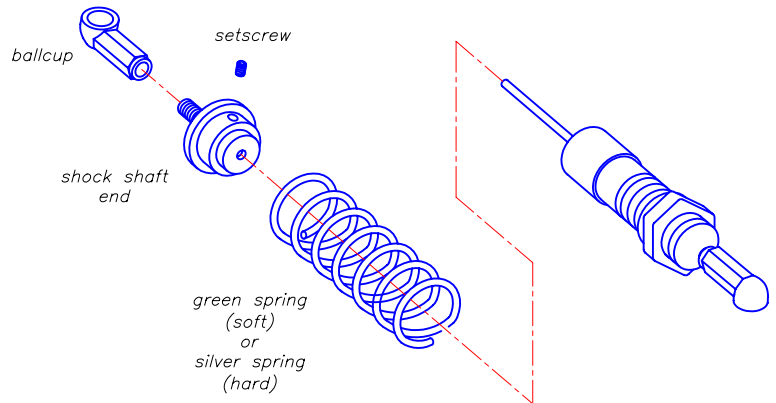

## Step 7

1. Pop the ball cups on the ball ends of your kit.
2. Turn the spring adjusting nut to adjust spring tension.

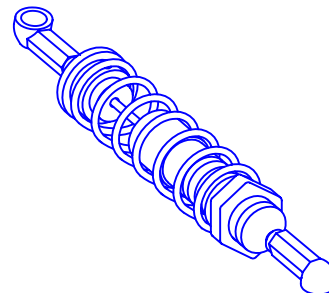

## Step 8

1. To remove the parts from the inside of the shock, first loosen the set screw of the shock shaft end and spring.
2. Now carefully insert your **disassembly rod** into one of the rounded grooves of the star clip and pop it out.

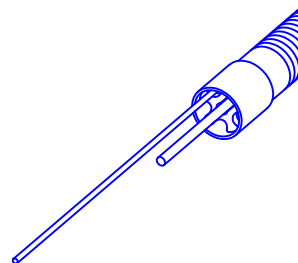

## Contact



**Corally R/C BV**  
**Ploegstraat 49**  
**3319 LG Dordrecht**  
**Holland**

**<http://www.corally.com>**  
**e-mail: [team@corally.com](mailto:team@corally.com)**  
**Fax: (+31) 78 621 26 89**