

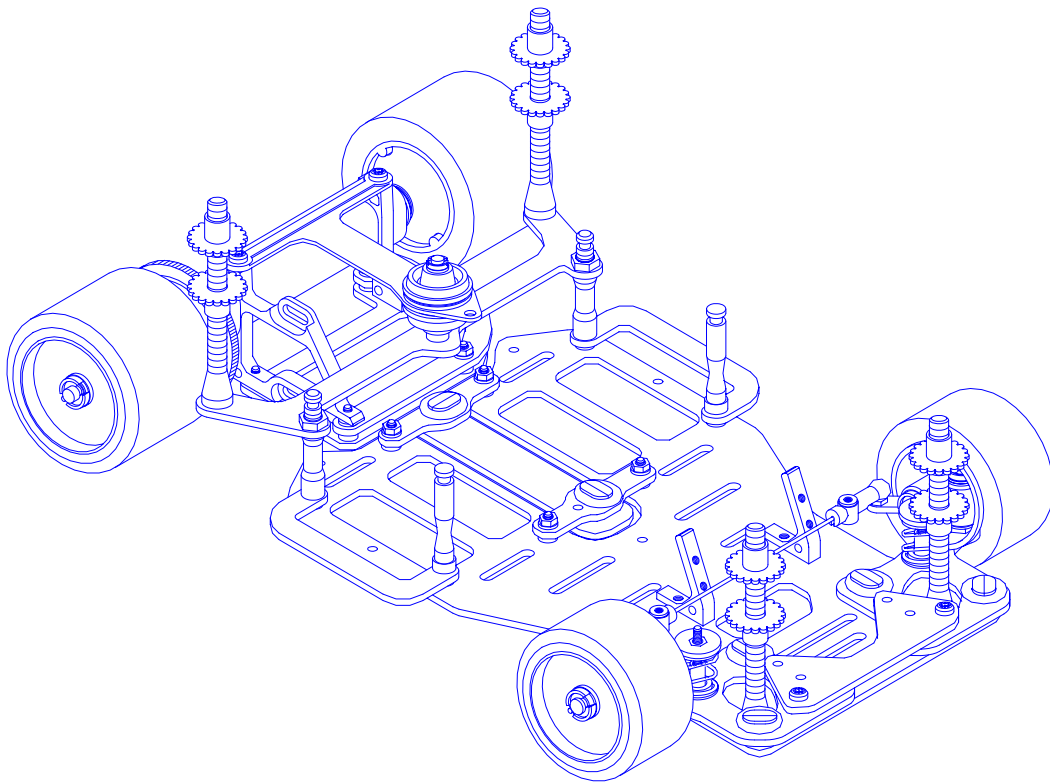

# SP12M

## Instruction Manual



*- Best of luck with your racing and have some fun!!!-*

# T-bar Assembly

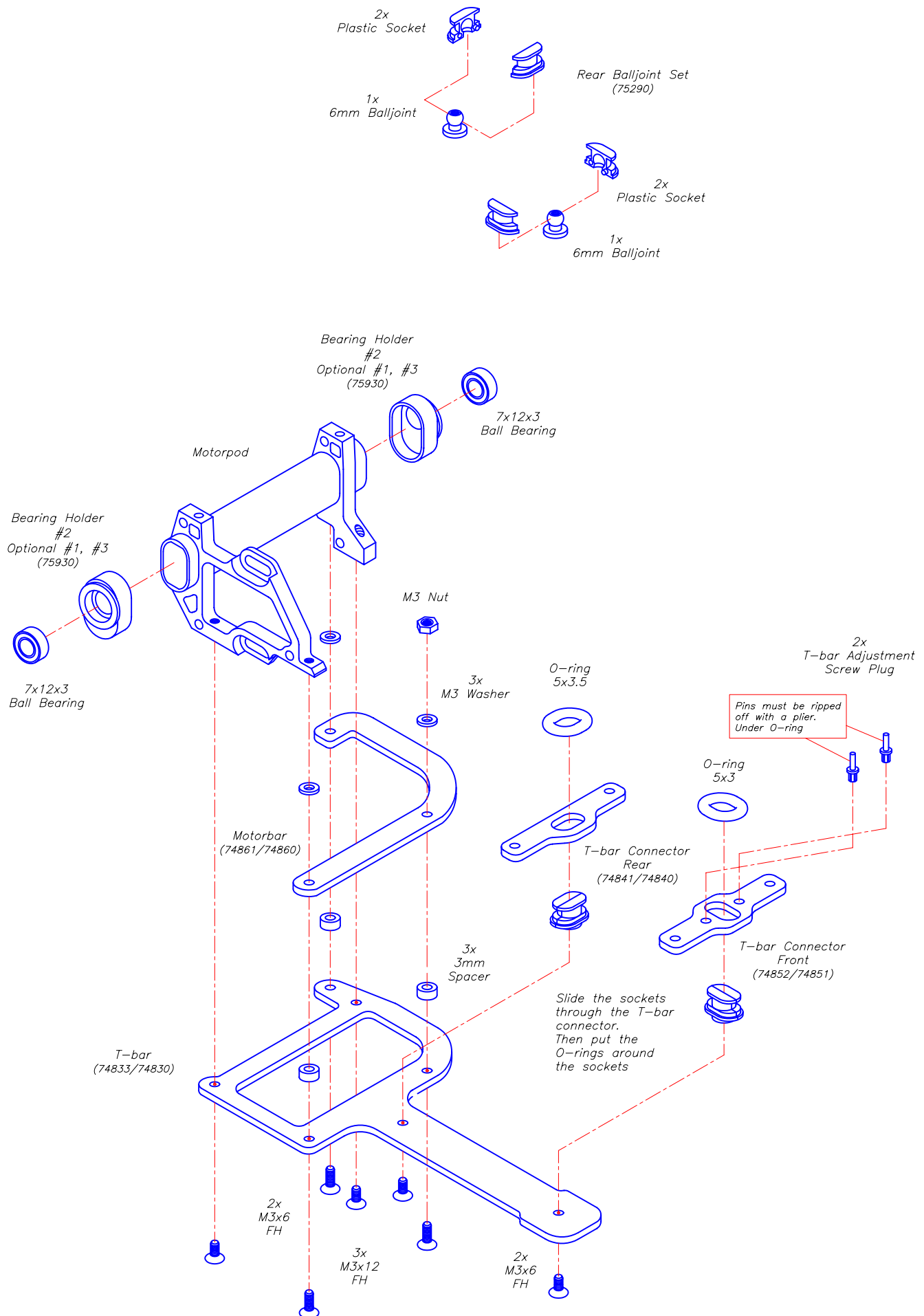

# Rear Axle Assembly

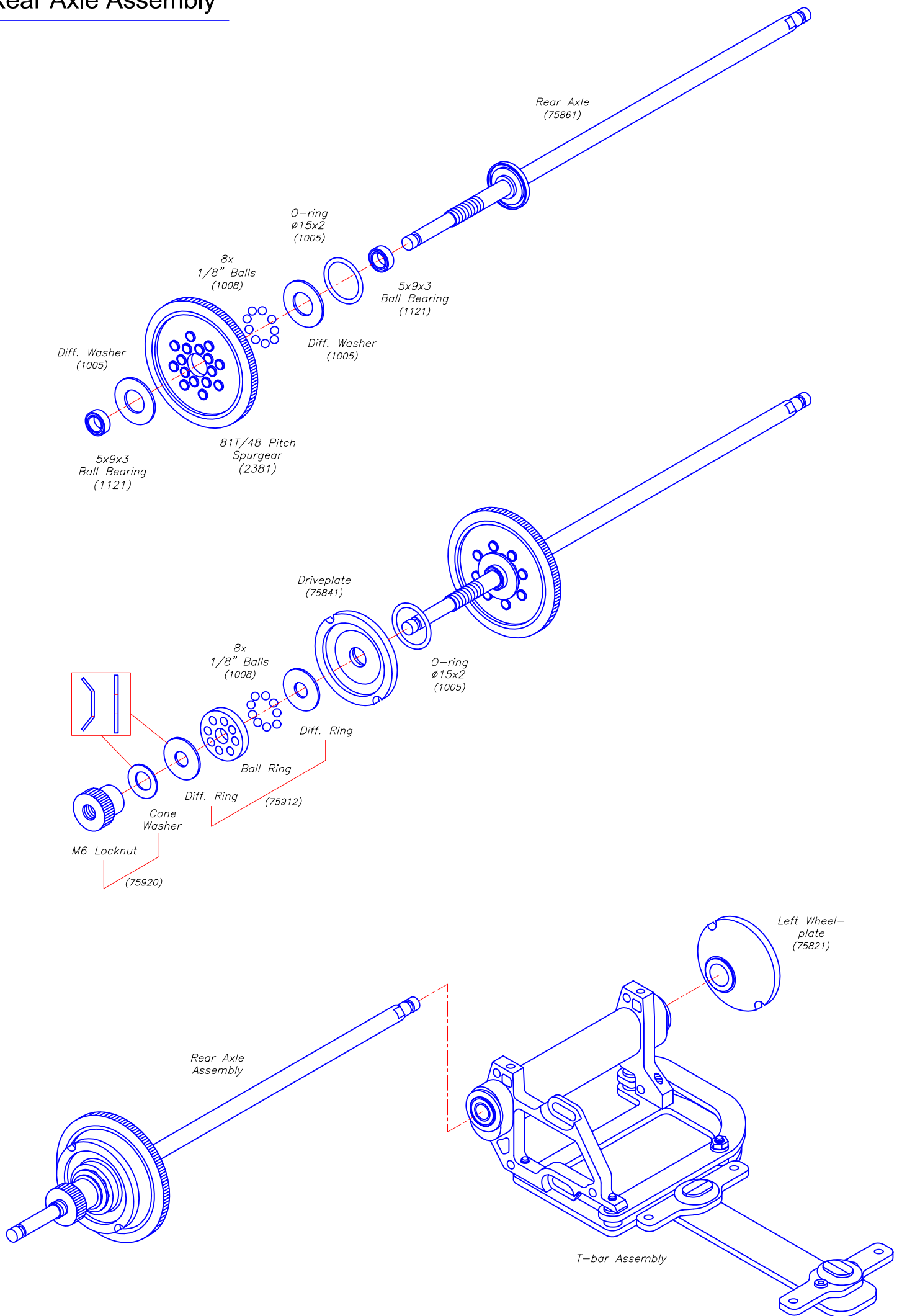

# Drivetrain Mounting

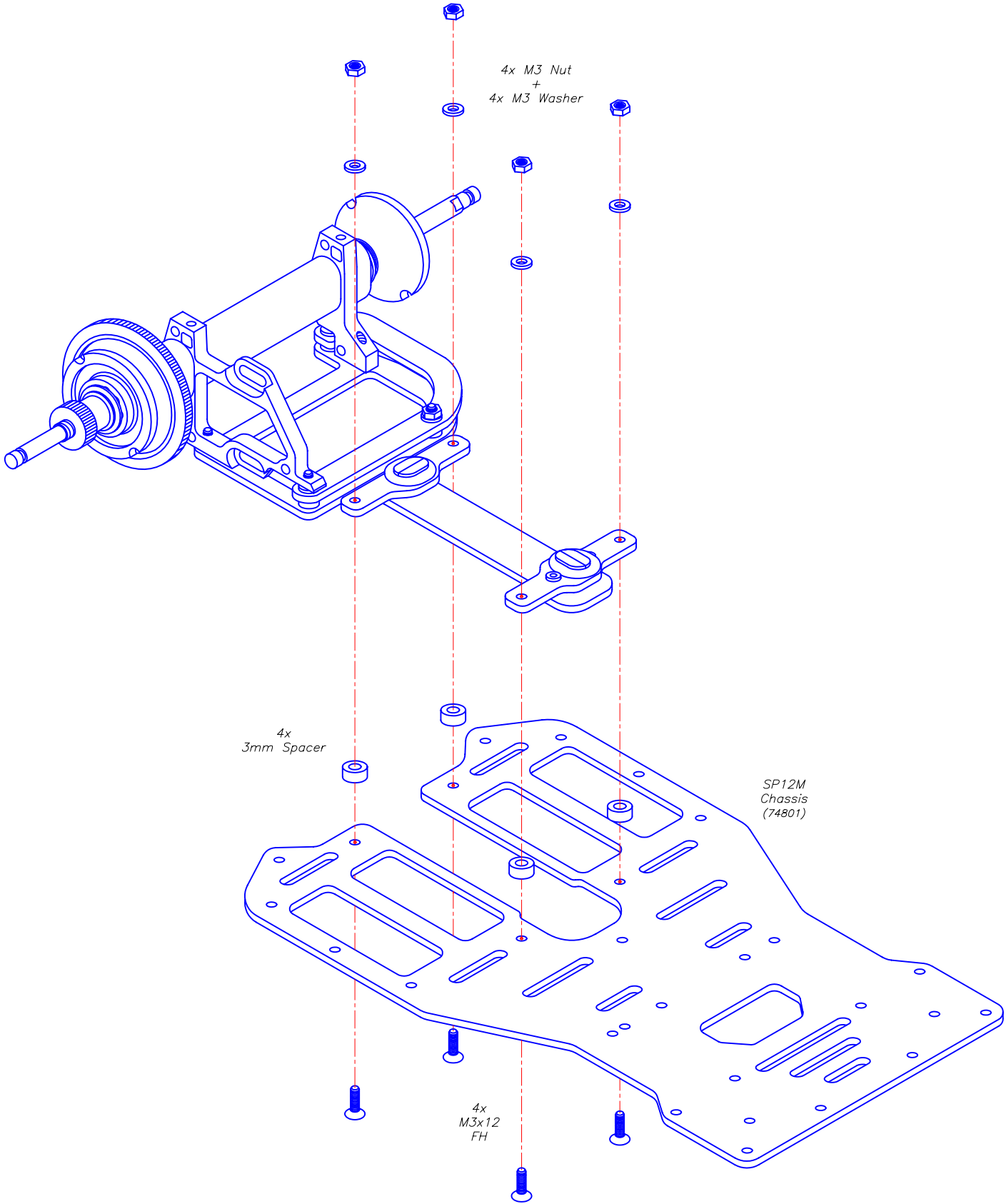

# Rear Damper Assembly

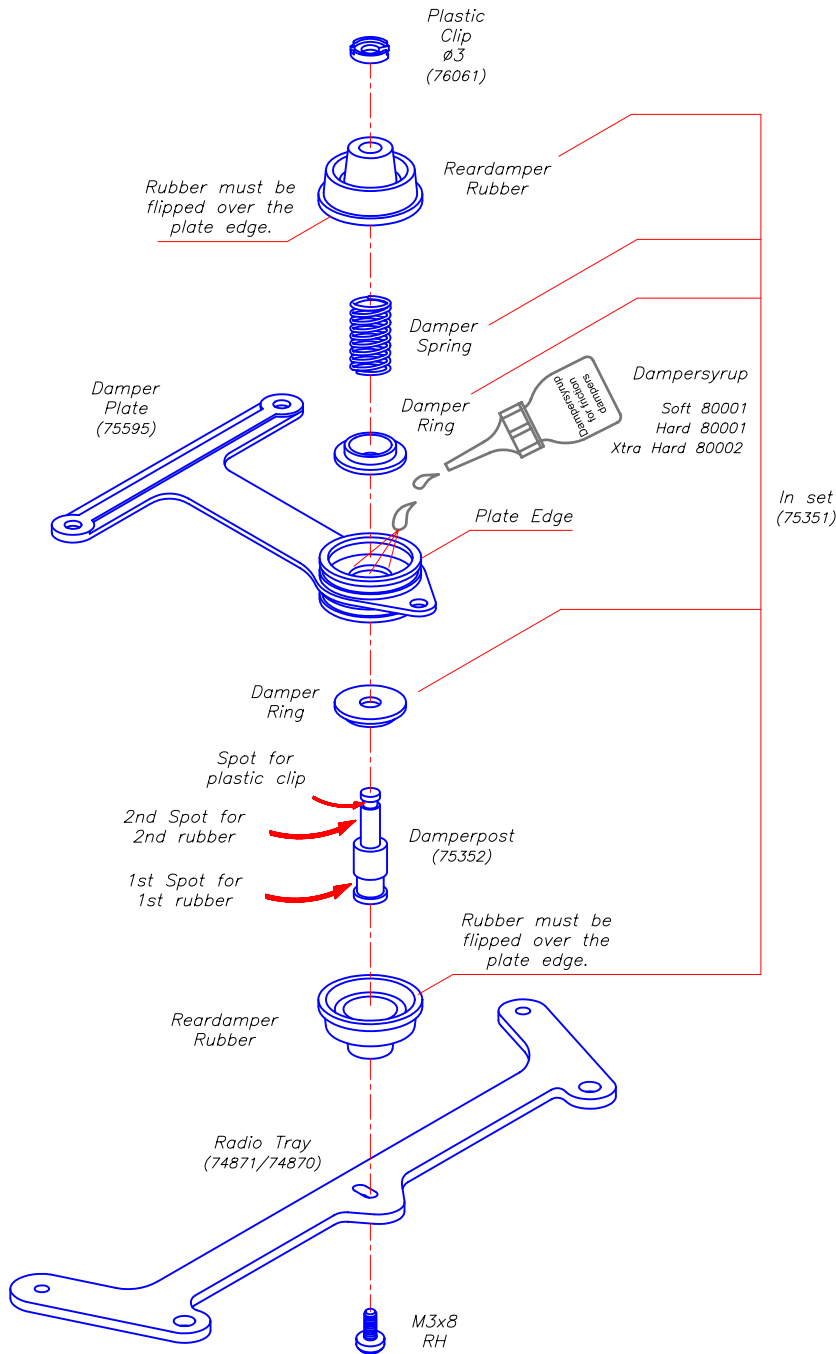

- Place the lowest Rubber on the Damperpost.
- Slide a Damper Ring over the Damperpost.
- Then mount the Damperplate, and fill the inner surface with Dampersyrup.
- Mount another Damper Ring and Spring over the Damperpost.
- Fit the 2nd Rubber over the Damperpost, and lock it with a Plastic Clip.
- Flip both Rubbers over the edges of the Damperplate.
- Mount the assembly to the radio plate.

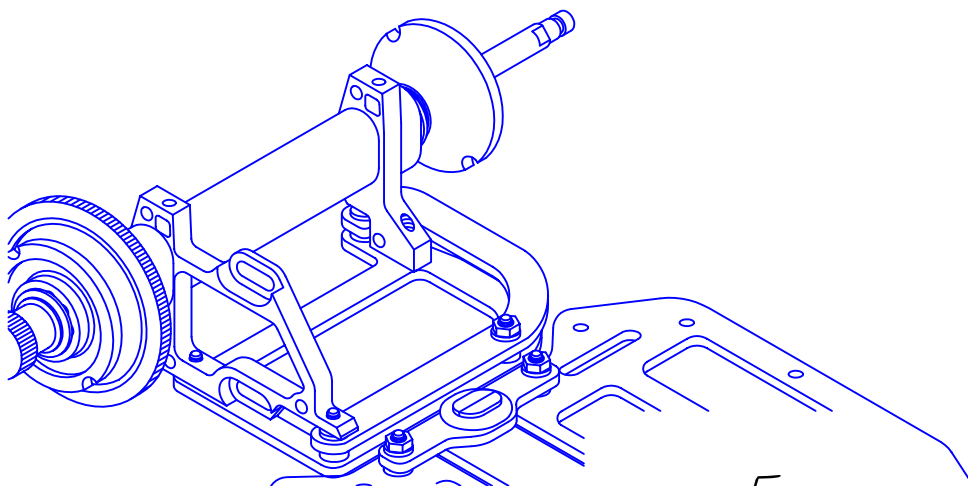

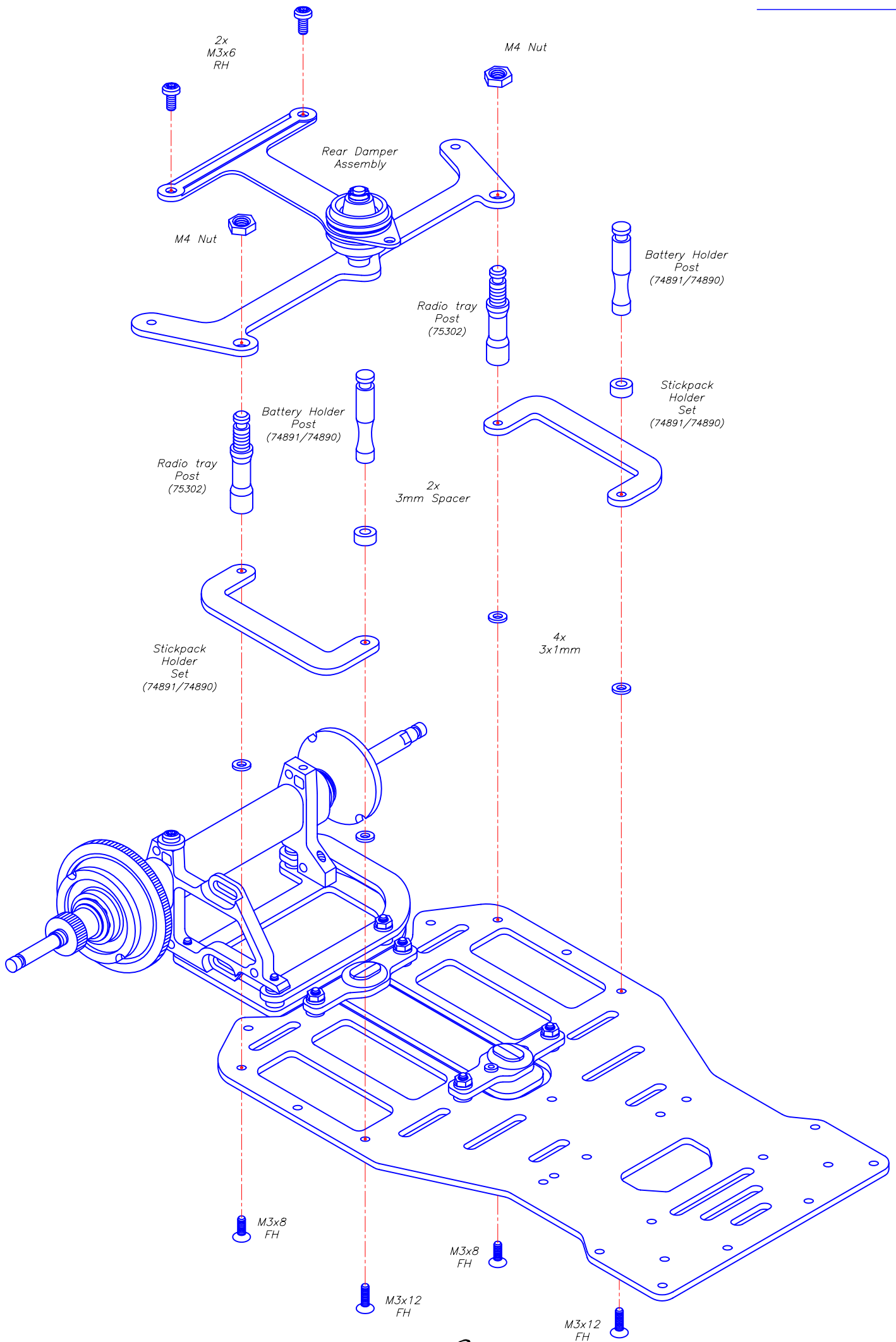

# Front Suspension Mounting

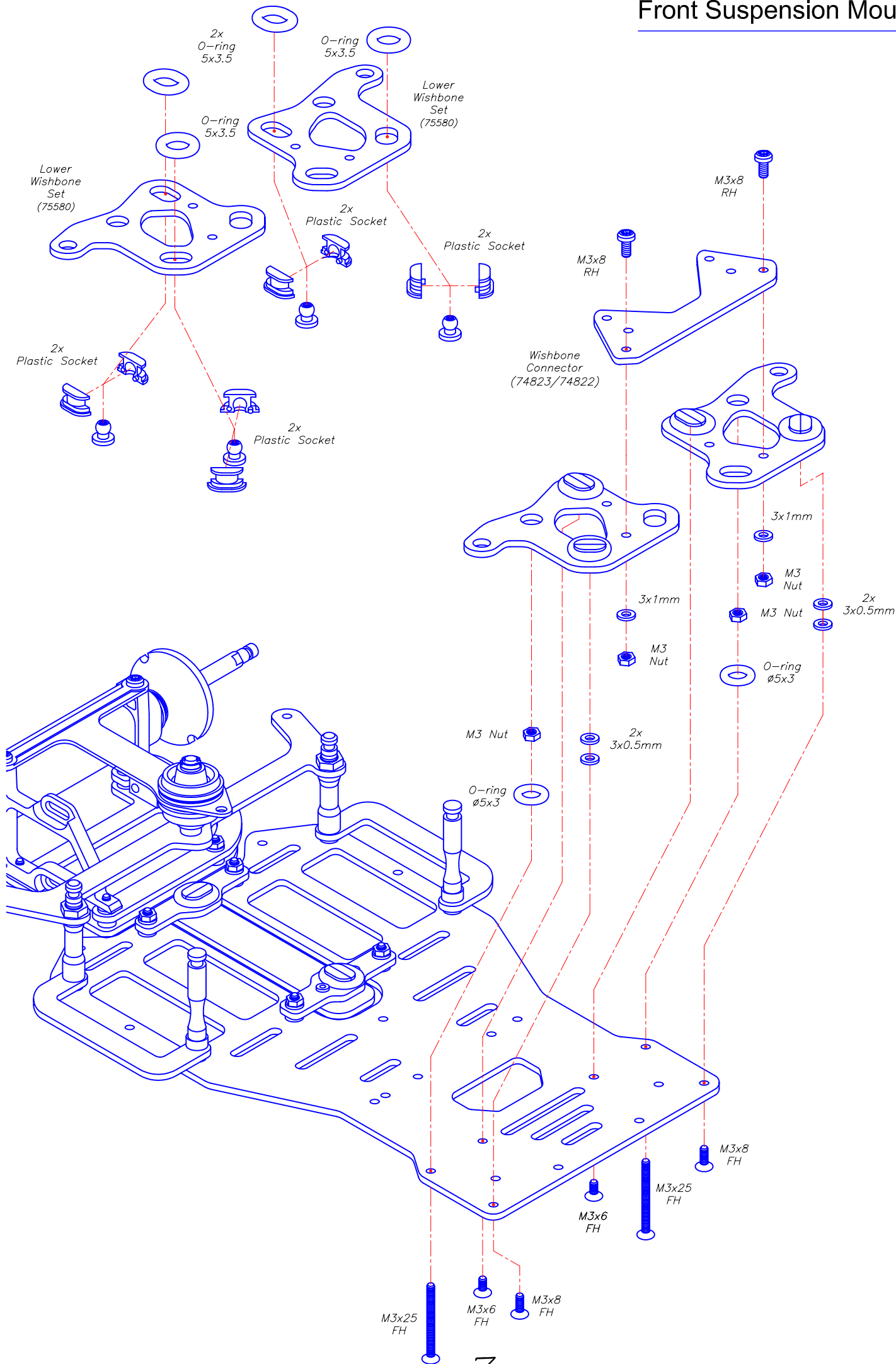

# Front Suspension Mounting

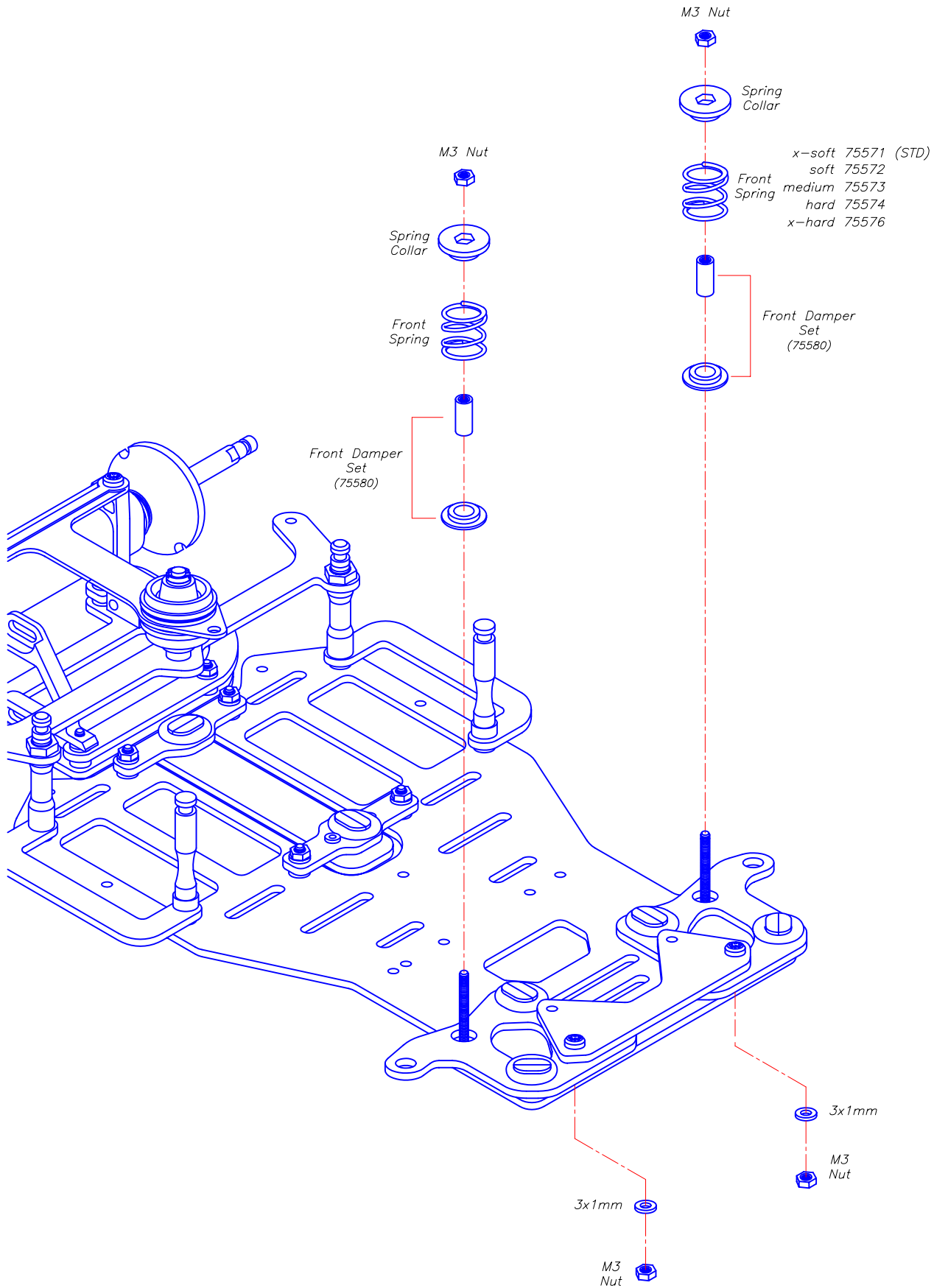



# Steerings (step1)

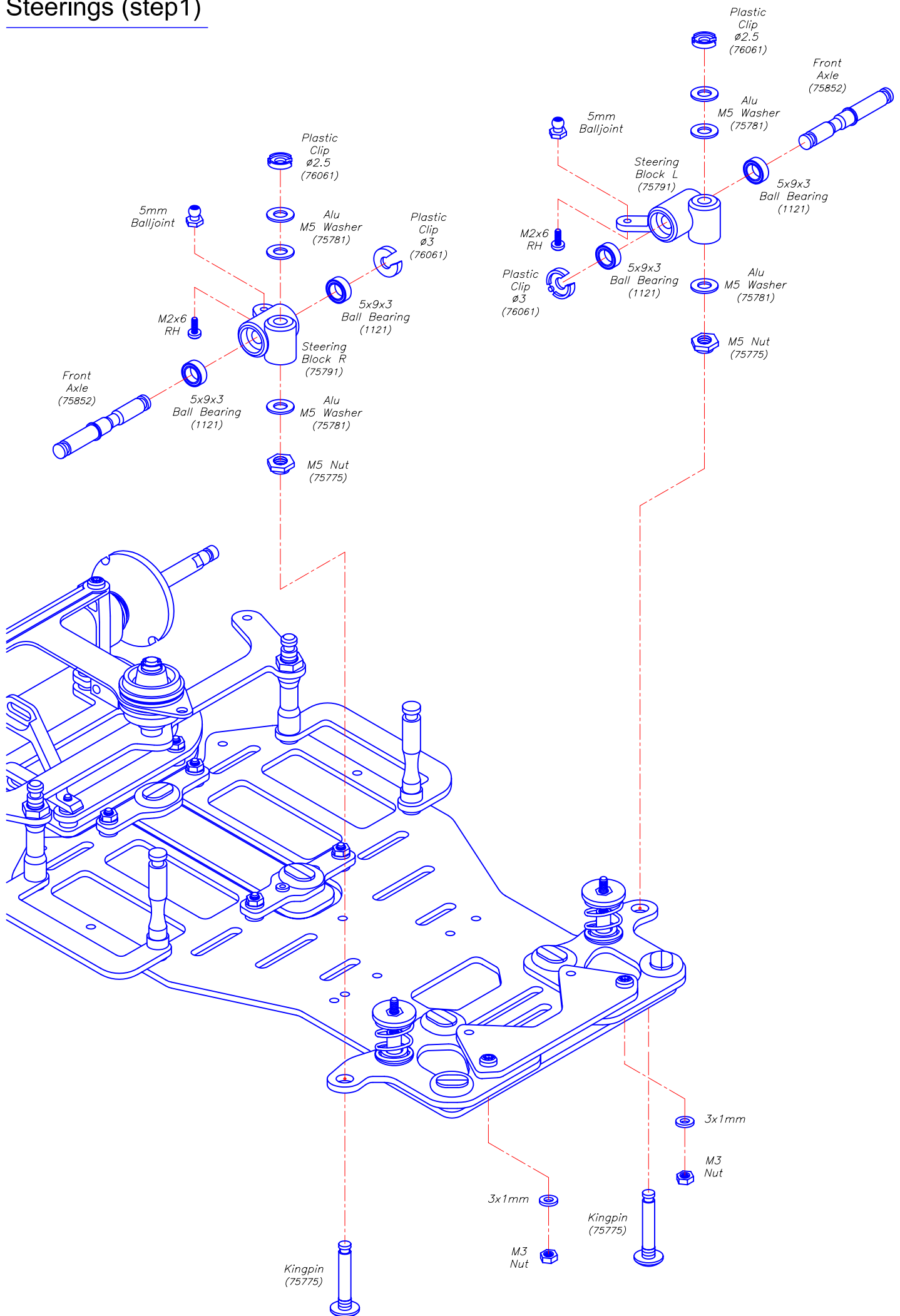

## Steerings (step 2)

- Fit the Servopost on the Chassis, but tighten them when mounting the Servo.
- Remove temporary Steering link, and apply the Trackrods.

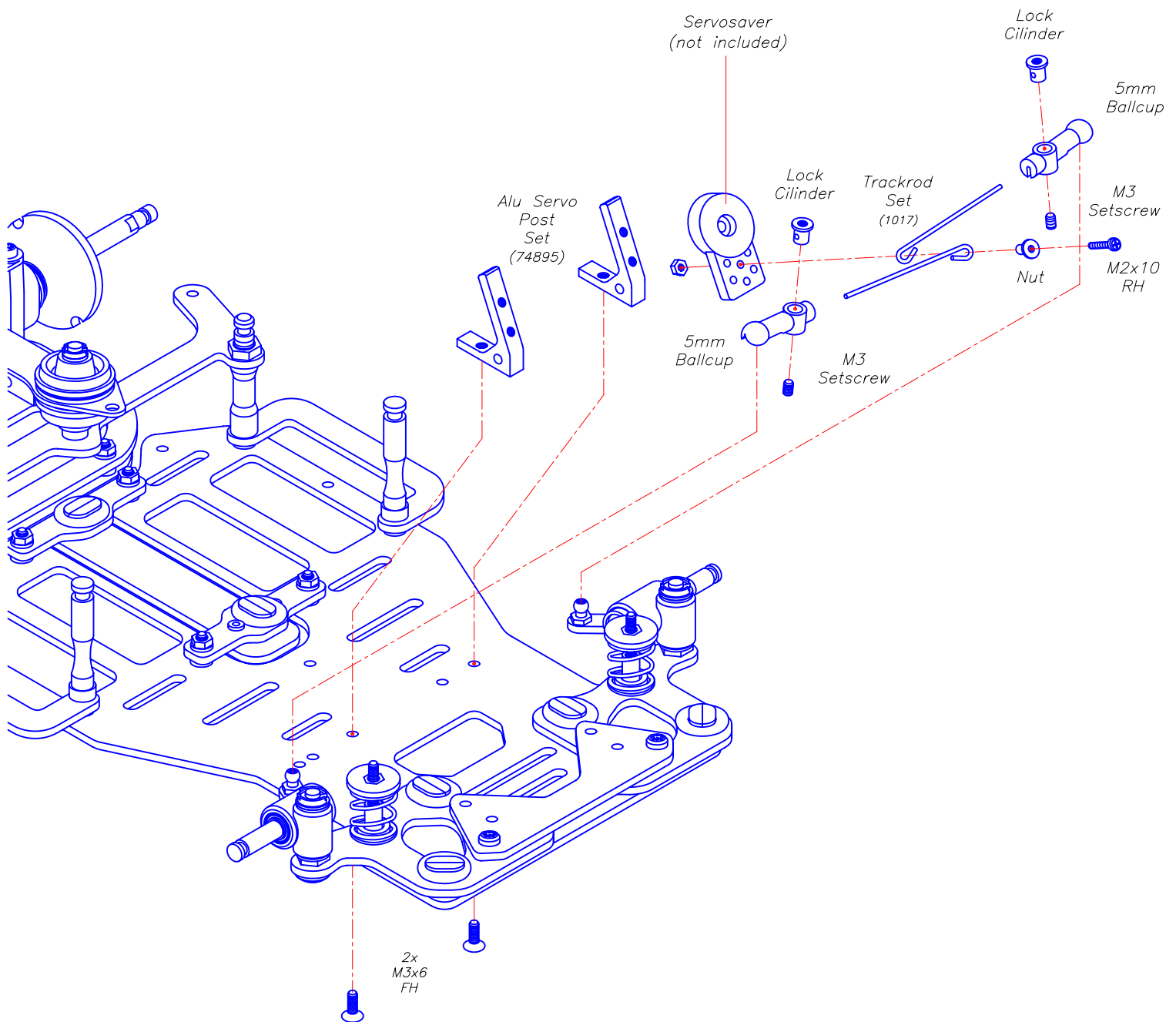

## Wheel Mounting

- Fit the wheels on the axles.
- Take note to add a fake bearing in the left rear wheel.
- Lock the wheels with a plastic clip

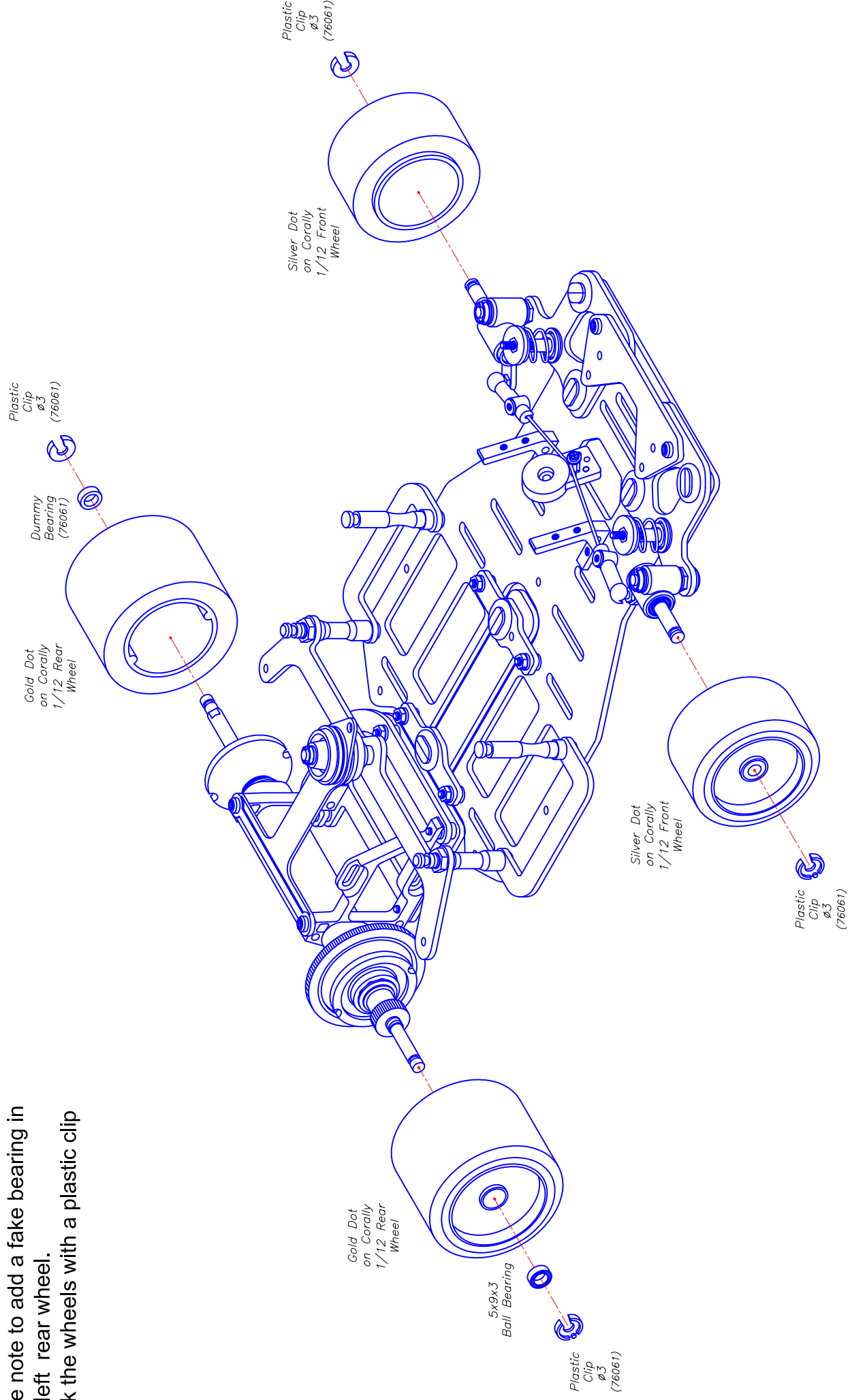

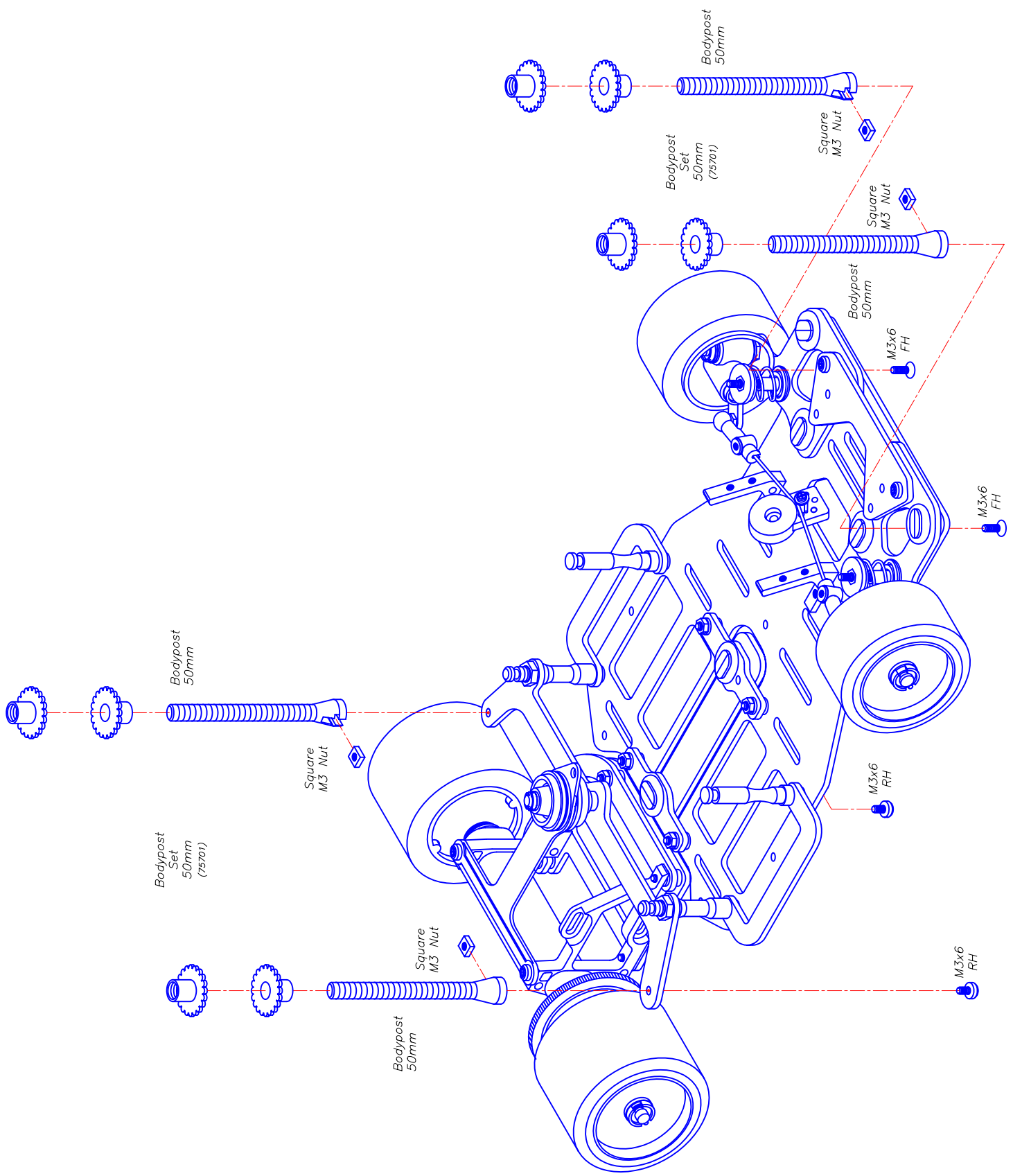

## Adding Electronics (Not included)

- Not included in kit are:
  - Motor
  - Batteries
  - Electronic Speed Controller
  - Receiver
  - Servo with Servosaver
- Check the manual of your electronics for proper installation.

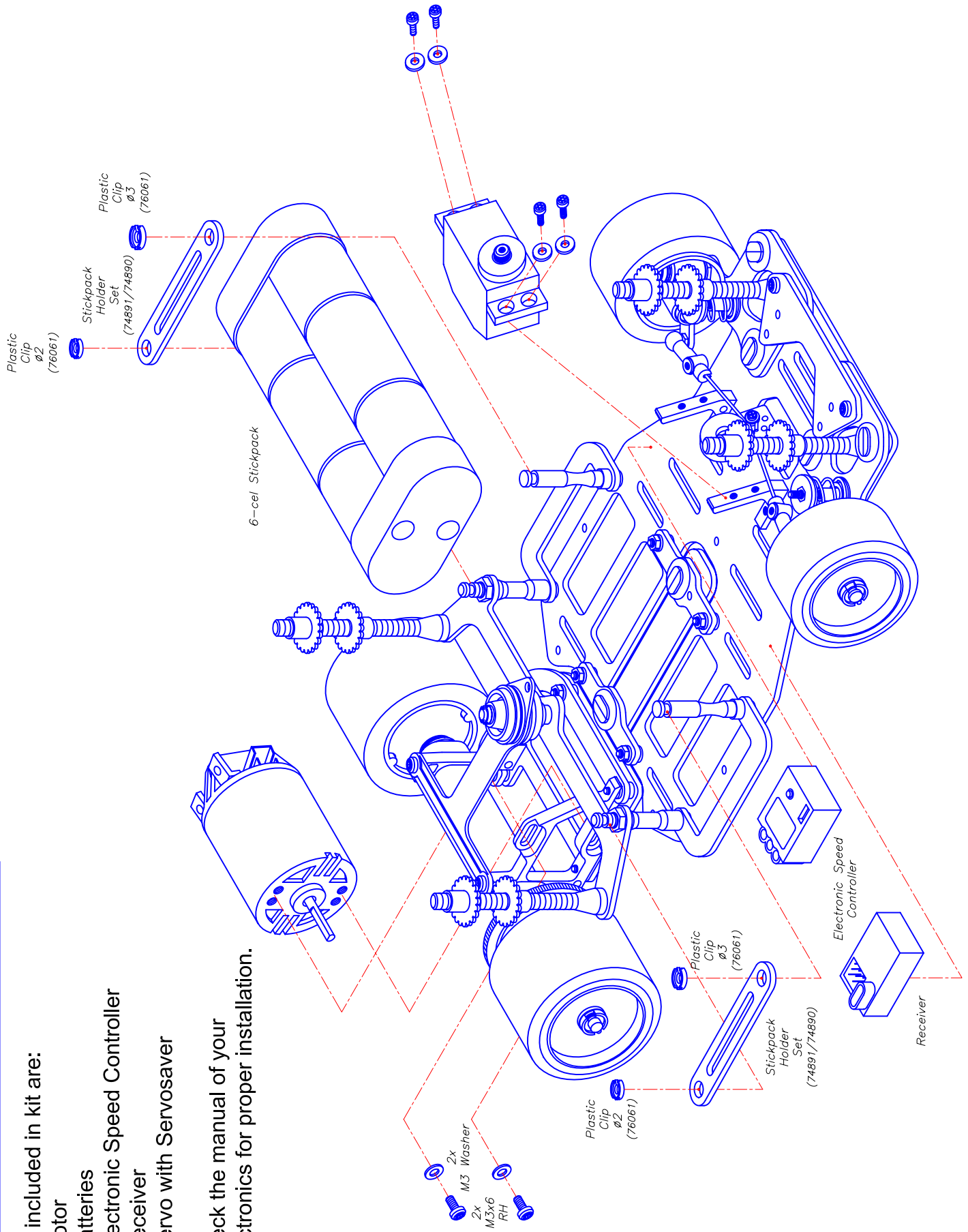

## Almost Ready Run!

- After checked all your electronics don't forget to put on a pinion!
- Your standard spur gear is 81T/48Pitch. Do not overgear it, check the gear ratio chart!
- Now you can put on your body and hit the track.

