

NAME Wen
 COUNTRY Taiwan
 RACE Practice
 TRACK Titan track

DATE 2016/3/27 TEMP.°C AIR / TRACK 18°C / 28°C
 TRACK CONDITION TECHNICAL MIXED FAST
 TRACTION LOW MEDIUM HIGH

FRONT

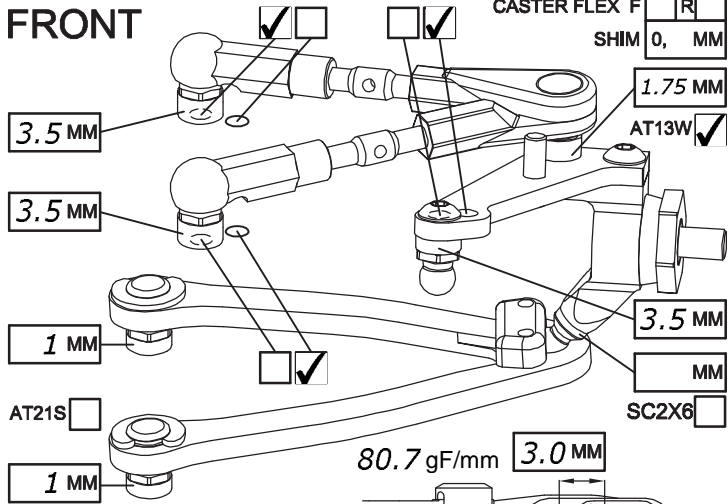

CAMBER ANGLE / °	-2.5
CASTER ANGLE / °	4
TOE ANGLE / °	+1
RIDE HEIGHT / MM	5.2
DOWNSTOP / MM	6
UPSTOP / MM	
STABILIZER Ø / MM	1.2
LOW ARM C04AL	<input type="checkbox"/>
STEERING ARM STD	<input type="checkbox"/>
WHEEL SPACER / MM	
FRONT DRIVE	<input type="checkbox"/> GD3 <input type="checkbox"/> SPOOL <input checked="" type="checkbox"/> GD2B

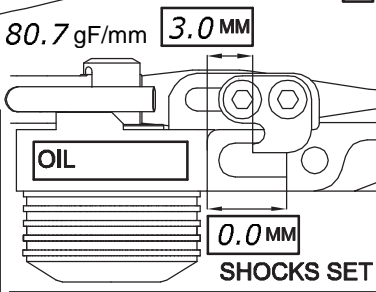

ROTOR	STD <input checked="" type="checkbox"/>	AE45-575 <input type="checkbox"/>
SPRING	STD <input checked="" type="checkbox"/>	S <input type="checkbox"/>
DAMPER	D2.1 <input type="checkbox"/>	
ACTION	SYM. <input type="checkbox"/>	ASYM. <input type="checkbox"/>
SRS/RHS ARR.	I <input checked="" type="checkbox"/>	II <input type="checkbox"/>

DIFF OIL DIFF WASHERS
 DOGBONE DRIVE ST17-1 ST11 ST12 BB ST02

REAR

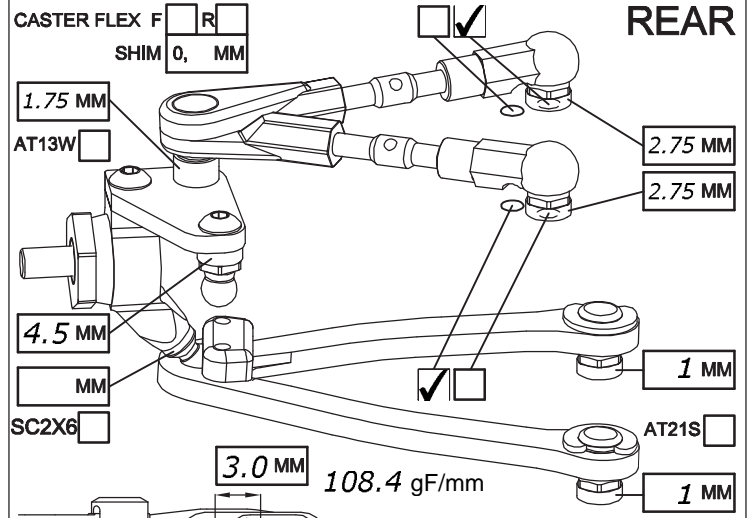

CAMBER ANGLE / °	-2.5
CASTER ANGLE / °	0
TOE ANGLE / °	-3
RIDE HEIGHT / MM	5.8
DOWNSTOP / MM	5
UPSTOP / MM	
STABILIZER Ø / MM	1.1
LOW ARM C04AL	<input checked="" type="checkbox"/>
STEERING ARM STD	<input type="checkbox"/>
WHEEL SPACER / MM	
REAR DRIVE	<input type="checkbox"/> GD3R <input checked="" type="checkbox"/> GD2B

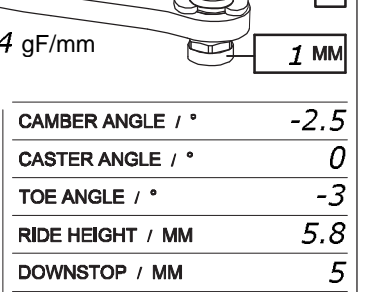

ROTOR	STD <input checked="" type="checkbox"/>	AE45-575 <input type="checkbox"/>
SPRING	STD <input checked="" type="checkbox"/>	S <input type="checkbox"/>
DAMPER	D2.1 <input type="checkbox"/>	
ACTION	SYM. <input type="checkbox"/>	ASYM. <input type="checkbox"/>
SRS/RHS ARR.	I <input checked="" type="checkbox"/>	II <input type="checkbox"/>

DIFF OIL 10K 90% fill DIFF WASHERS
 DOGBONE DRIVE ST11 ST12 BB ST17-1 EVD

FRAME FLEX SETTING

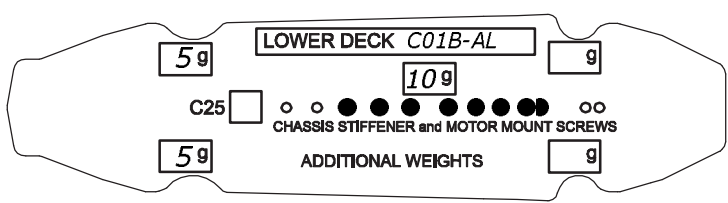

CHASSIS STIFFENER AM110 AM115 ST130

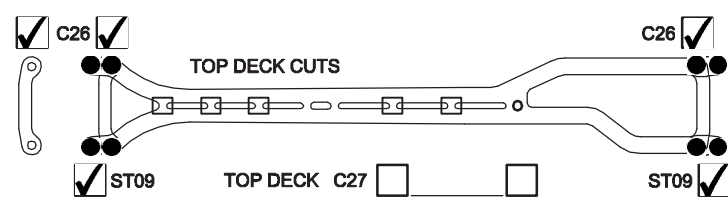

COMMENTS
 ST130 and 15G weight
 ABS
 C04M
 Oring replace C07
 Spr02H
 Dt10-3

TIRES		FRONT	REAR
FL	FR	Volante 36	Volante 36
RL	RR	Volante	Volante
WHEELS		Volante	Volante
ADDITIVE		Trinity White Dot	Trinity White Dot

MOTOR LATERAL SHIFT / MM		MOTOR <u>Scorpion 4.5</u>
ACKERMANN SHIMS / MM	2.75	SERVO <u>Awesomatix</u>
DRIVE RATIO	7.6	ESC <u>Scorpion</u>
SPUR 84	PINION 21	BATTERY <u>Scorpion</u>
BODY <u>Ltr light</u>		RECEIVER <u>Futaba</u>
WING <u>Blitz</u>		

BEST LAP TIME _____ QUALIF. / FINAL POSITION _____ /

ESC SETTING _____

COMMENTS / IMPRESSIONS
Tire warmer at 60 degree all the time, as the traction increase more screw on stiffener,

CONTACT _____