

NAME **Kyle Bergstrom**  
 COUNTRY **USA**  
 RACE **STGP**  
 TRACK **Tamiya**

DATE **4/26/2014** TEMP.°C AIR / TRACK **70°F / 90°F**  
 TRACK CONDITION TECHNICAL  MIXED  FAST   
 TRACTION LOW  MEDIUM  HIGH

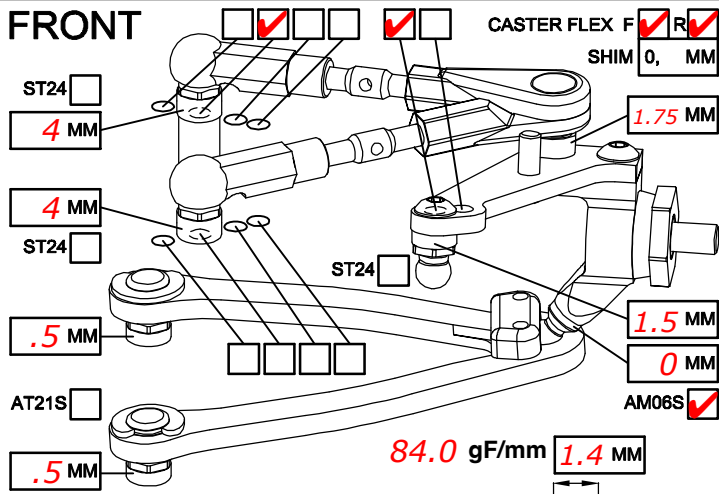

CAMBER ANGLE / ° **2**  
 CASTER ANGLE / ° **4**  
 TOE ANGLE / ° **1**  
 RIDE HEIGHT / MM **5.6**  
 DOWNSTOP / MM

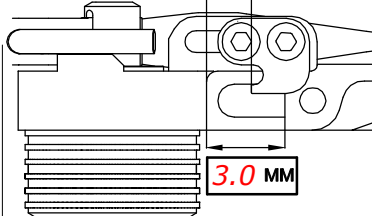

UPSTOP / MM

STABILIZER Ø / MM **black**

LOW ARM STD

STEERING ARM STD

WHEEL SPACER / MM **1**

FRONT DRIVE BALL DIFF  GEAR DIFF  SPOOL  ONE-WAY

DIFF SET LOOSE  MEDIUM  TIGHT  OIL  #

DOG BONE DRIVE BUSHING  C-DRIVE  BB  EVD

SPRING STD  S

DAMPER #6  #3

ACTION SYM.  ASYM.

SRS/RHS ARR. I  II

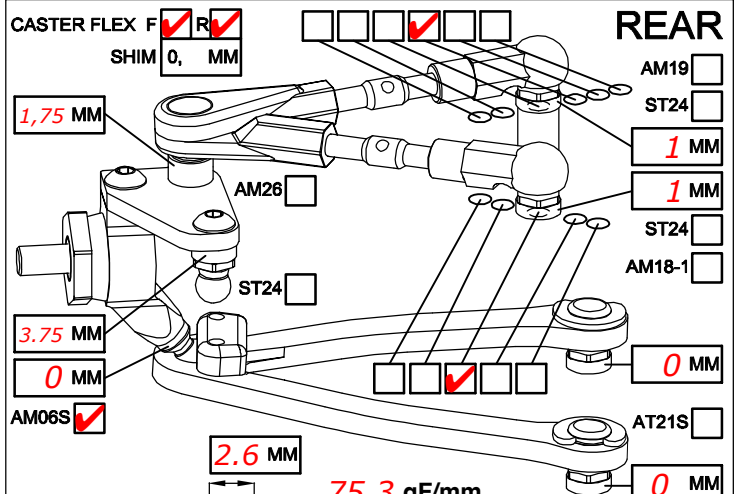

CAMBER ANGLE / ° **2**  
 CASTER ANGLE / ° **2**  
 TOE ANGLE / ° **3**  
 RIDE HEIGHT / MM **5.6**  
 DOWNSTOP / MM

UPSTOP / MM

STABILIZER Ø / MM **black**

LOW ARM STD

STEERING ARM STD

WHEEL SPACER / MM **1**

REAR DRIVE BALL DIFF  GEAR DIFF

DIFF SET LOOSE  MEDIUM  TIGHT  OIL  # **1000**

DOG BONE DRIVE BUSHING  C-DRIVE  BB  EVD

SPRING STD  S

DAMPER #6  #3

ACTION SYM.  ASYM.

SRS/RHS ARR. I  II

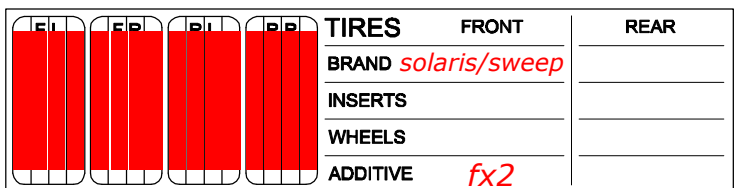
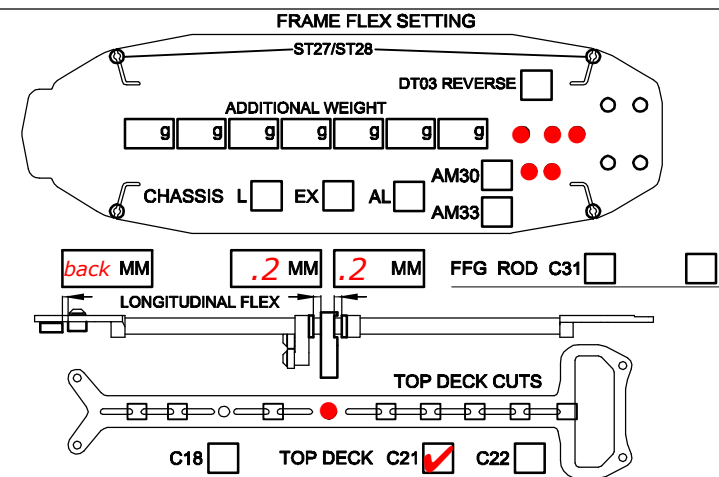

MOTOR LAYOUT LONG.  TRANS.  MOTOR **Hacker 13.5/7.5**

SERVO LAYOUT LEFT  RIGHT  SERVO **Hitec 8775**

ESC LAYOUT LEFT  RIGHT  ESC **Hacker**

BAT. LAYOUT R1  R2  F1  F2  BATTERY **Aero-Model 7600**

SPUR **88** PINION **42/35** SD1  RECEIVER **471**

FINAL DRIVE RATIO

MOTOR OFFSET / MM

WING **Stock**

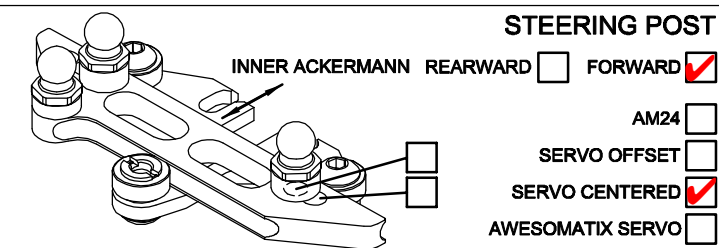

BEST LAP TIME **13.1/12.6** QUALIF. / FINAL POSITION **1 / 1**

ESC SETTING

COMMENTS / IMPRESSIONS **soft springs**

*Tires just off board on 10mm block for droop, Raceberry Chassis, Top deck with center screw, tq and win in 13.5, back luck in mod, car was very fast in mod as well*

CONTACT