

AWESONIX® A700

NAME **Ethan Erchinger**
 COUNTRY **USA**
 RACE **Club Race**
 TRACK **NorCal Hobbies**

SETUP SHEET

DATE **April 21, 2012** TEMP.°C **AIR / TRACK 85 F** / 130 F
 TRACK CONDITION TECHNICAL CARPET ASPHALT
 MIXED FAST
 TRACTION LOW MEDIUM HIGH

FRONT

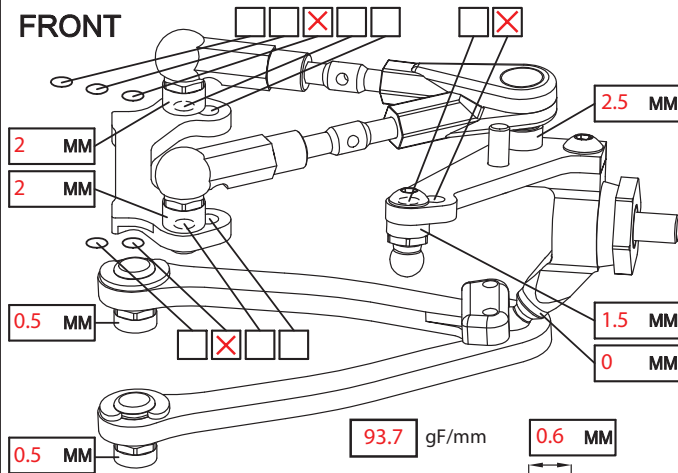

CAMBER ANGLE / ° **2**
 CASTER ANGLE / ° **4**
 TOE ANGLE / ° **-1**
 RIDE HEIGHT / MM **5.1**
 DOWNSTOP / MM **5.8**
 UPSTOP / MM **0**

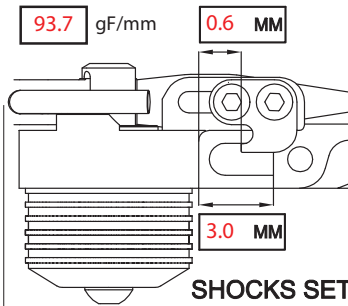

SHOCKS SET

STABILIZER Ø / MM **1**
 LOW ARM STD
 STEERING ARM STD
 WHEEL SPACER / MM

SPRING STD
 DAMPER STD
 ACTION SYM. ASYM.
 SRS/RHS ARR. I II

FRONT DRIVE BALL DIFF GEAR DIFF SPOOL ONE-WAY

DIFF SET LOOSE MEDIUM TIGHT OIL #

DOGBONE DRIVE BUSHING C-DRIVE BB EVD

REAR

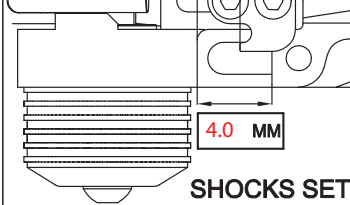
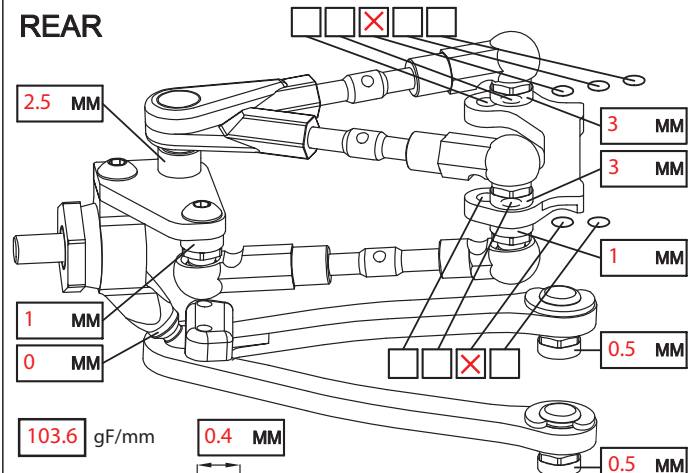

SHOCKS SET

SPRING STD
 DAMPER STD
 ACTION SYM. ASYM.
 SRS/RHS ARR. I II

CAMBER ANGLE / ° **1.5**
 CASTER ANGLE / ° **6**
 TOE ANGLE / ° **2.5**
 RIDE HEIGHT / MM **5.3**
 DOWNSTOP / MM **4.6**
 UPSTOP / MM **0**

STABILIZER Ø / MM **1**
 LOW ARM STD
 STEERING ARM STD
 WHEEL SPACER / MM

REAR DRIVE BALL DIFF GEAR DIFF

DIFF SET LOOSE MEDIUM TIGHT OIL # **1500**

DOGBONE DRIVE BUSHING C-DRIVE BB EVD

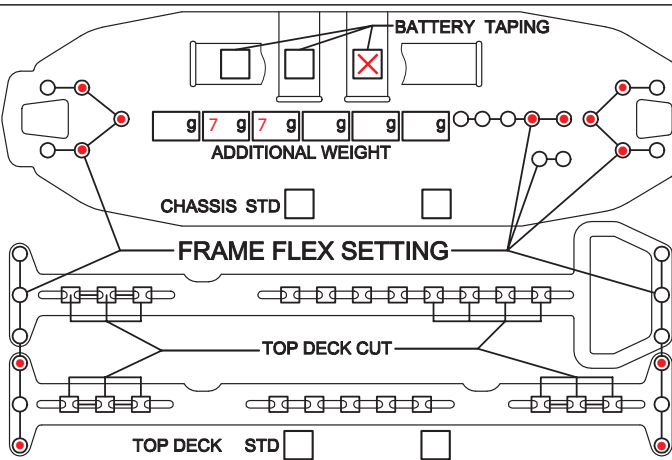

FL	FR	RL	RR	TIRES	FRONT	REAR
				BRAND	Powers Hard	Powers Hard
				INSERTS		
				WHEELS		
				ADDITIVE	Tweak	Tweak

MOTOR LAYOUT LONG TRANS. MOTOR **Team Powers 4.0**
 SERVO LAYOUT LEFT RIGHT SERVO **Futaba bls551**
 ESC LAYOUT LEFT RIGHT ESC **Team Powers XLS**
 BAT. LAYOUT R1 R2 F1 F2 BATTERY **Protek**
 SPUR **78** PINION **22** RECEIVER **Futaba R614FF**
 FINAL DRIVE RATIO **9.00** MOTOR OFFSET / MM **0**
 BODY **PF Speed 6 Regular** WING **<---**

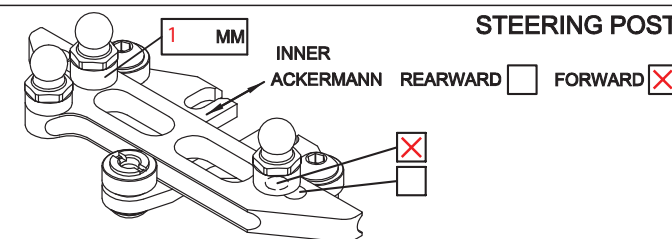

STEERING POST

INNER ACKERMANN REARWARD FORWARD

BEST LAP TIME **14.49** QUALIF. / FINAL POSITION **4** / **2**
 ESC SETTING **2 timing and 5 turbo boost. Motor very hot (215F).**
 COMMENTS / IMPRESSIONS **IAS used, not full forward.**
Initial push on power, solved with more rear caster. Stiffened front just a little, increased reactiveness. Need to try stiffer up front with bigger stabilizer.
14g in front of battery for left/right balance. 48%F/52%R balance.
 CONTACT