

AWESOMETIX® A700

NAME **Ethan Erchinger**
 COUNTRY **NorCal Hobbies**
 RACE **Club race**
 TRACK **Outdoor asphalt**

SETUP SHEET

DATE **Feb., 25 2012** TEMP. °C **AIR / TRACK 66 F** / 84 F
 TRACK CONDITION TECHNICAL CARPET ASPHALT
 MIXED FAST
 TRACTION LOW MEDIUM HIGH

FRONT

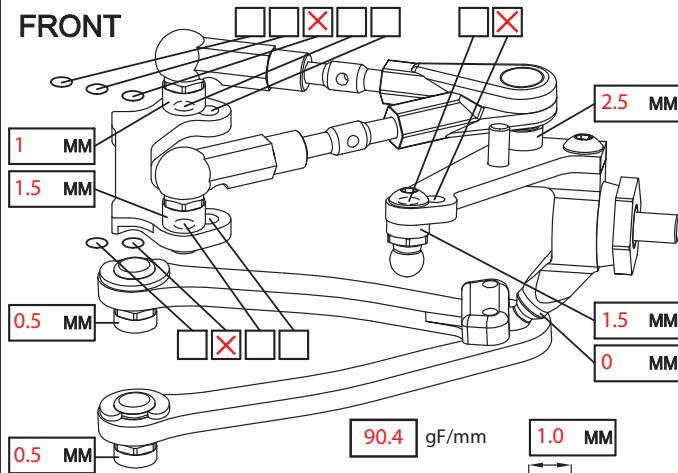

CAMBER ANGLE / ° **2**
 CASTER ANGLE / ° **4**
 TOE ANGLE / ° **-1**
 RIDE HEIGHT / MM **5.2**
 DOWNSTOP / MM **6**
 UPSTOP / MM **0**
 STABILIZER Ø / MM **1**
 LOW ARM STD
 STEERING ARM STD
 WHEEL SPACER / MM
 FRONT DRIVE BALL DIFF GEAR DIFF SPOOL ONE-WAY
 DIFF SET LOOSE MEDIUM TIGHT OIL #
 DOGBONE DRIVE BUSHING C-DRIVE BB EVD

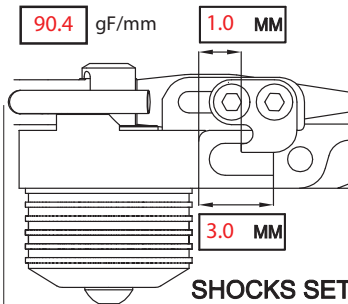

SHOCKS SET

SPRING STD
 DAMPER STD
 ACTION SYM. ASYM.
 SRS/RHS ARR. I II

REAR

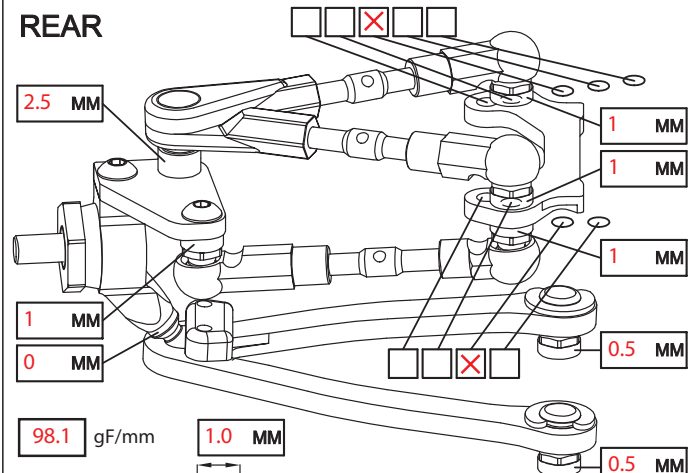

CAMBER ANGLE / ° **1.5**
 CASTER ANGLE / ° **4**
 TOE ANGLE / ° **3**
 RIDE HEIGHT / MM **5.5**
 DOWNSTOP / MM **5.5**
 UPSTOP / MM **0**
 STABILIZER Ø / MM **0**
 LOW ARM STD
 STEERING ARM STD
 WHEEL SPACER / MM **0.5**
 REAR DRIVE BALL DIFF GEAR DIFF
 DIFF SET LOOSE MEDIUM TIGHT OIL # **1500**
 DOGBONE DRIVE BUSHING C-DRIVE BB EVD

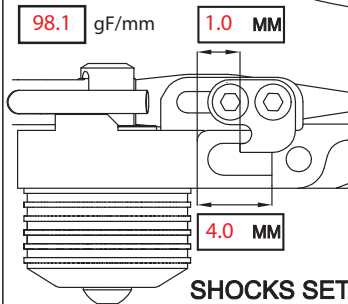

SHOCKS SET

SPRING STD
 DAMPER STD
 ACTION SYM. ASYM.
 SRS/RHS ARR. I II

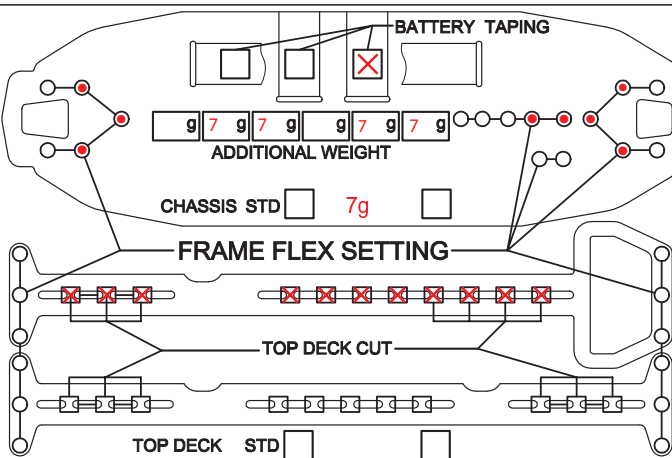

STEERING POST

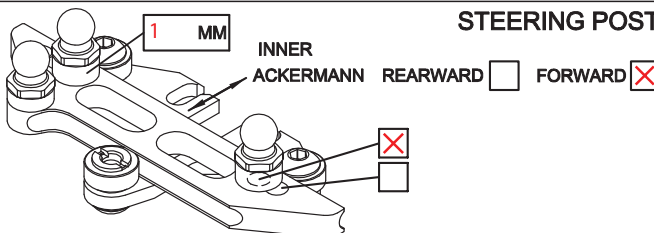

FL	FR	RL	RR	TIRES	FRONT	REAR
				BRAND	Team Powers 36R	Team Powers 36R
				INSERTS		
				WHEELS		
				ADDITIVE	Paragon 2	Paragon 2

MOTOR LAYOUT LONG. TRANS. MOTOR **Team Powers 4.5**
 SERVO LAYOUT LEFT RIGHT SERVO **Futaba bls551**
 ESC LAYOUT LEFT RIGHT ESC **Team Powers XLS**
 BAT. LAYOUT R1 R2 F1 F2 BATTERY **Protek**
 SPUR **71** PINION **17** RECEIVER **Futaba R614FF**
 FINAL DRIVE RATIO **8.7** MOTOR OFFSET / MM **0**
 BODY **PF Speed 6 Regular** WING **<---**

BEST LAPTIME QUALIF. / FINAL POSITION /
 ESC SETTING **Some boost**
 COMMENTS / IMPRESSIONS **Regular body raised the center of gravity a bit, and helped the car generate more roll, in turn generate more steering. The car is still a little lazy going in, need to try more ackerman, and possibly a slightly stiffer spring rate up front. Also the setup had too much on power push.**
 CONTACT