

AWESOMIX® A700

NAME **Ed Clark**
 COUNTRY **China**
 RACE **TITC Practise**
 TRACK **RCI - Addict layout**

SETUP SHEET

DATE **05/02/12** TEMP.°C AIR / TRACK **15** / 10
 CARPET ASPHALT
 TRACK CONDITION TECHNICAL MIXED FAST
 TRACTION LOW MEDIUM HIGH

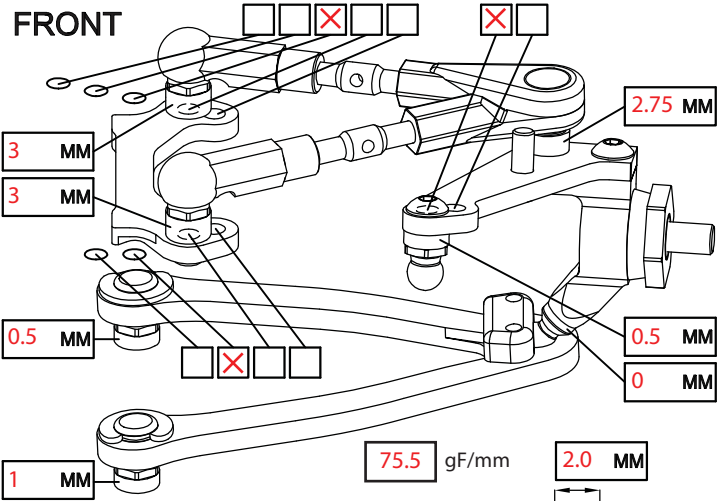

CAMBER ANGLE / ° **2**
 CASTER ANGLE / ° **4**
 TOE ANGLE / ° **-1**
 RIDE HEIGHT / MM **5**
 DOWNSTOP / MM **6**
 UPSTOP / MM **-**

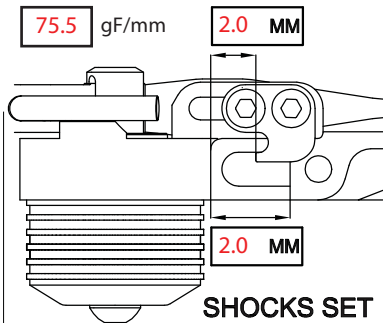

STABILIZER Ø / MM **1.0**
 LOW ARM STD
 STEERING ARM STD
 WHEEL SPACER / MM **0**
 FRONT DRIVE BALL DIFF GEAR DIFF SPOOL ONE-WAY
 DIFF SET LOOSE MEDIUM TIGHT OIL #
 DOGBONE DRIVE BUSHING C-DRIVE BB EVD

SHOCKS SET
 SPRING STD
 DAMPER STD
 ACTION SYM. ASYM.
 SRS/RHS ARR. I II

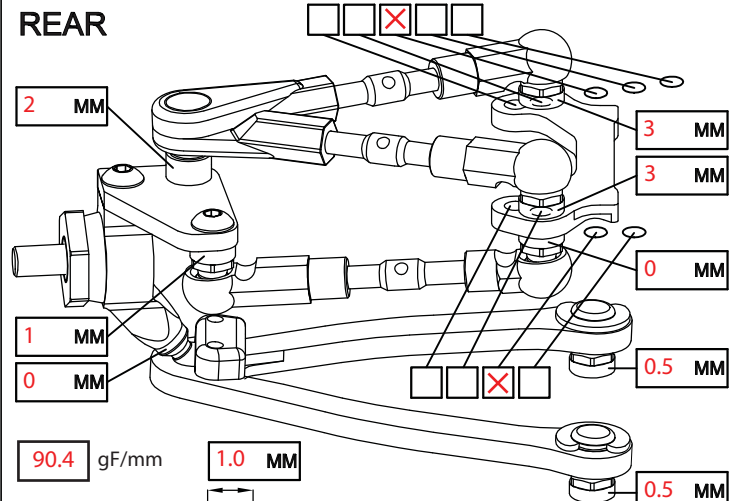

CAMBER ANGLE / ° **2**
 CASTER ANGLE / ° **2**
 TOE ANGLE / ° **3**
 RIDE HEIGHT / MM **5.5**
 DOWNSTOP / MM **5.5**
 UPSTOP / MM **-**

SHOCKS SET
 SPRING STD
 DAMPER STD
 ACTION SYM. ASYM.
 SRS/RHS ARR. I II

STABILIZER Ø / MM **1.0**
 LOW ARM STD
 STEERING ARM STD
 WHEEL SPACER / MM **0**
 REAR DRIVE BALL DIFF GEAR DIFF
 DIFF SET LOOSE MEDIUM TIGHT OIL # **Losi90**
 DOGBONE DRIVE BUSHING C-DRIVE BB EVD

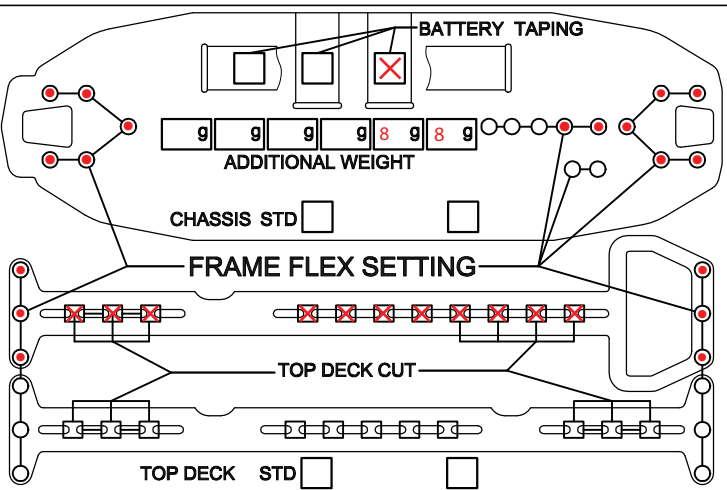

FL	FR	RL	RR	TIRES	FRONT	REAR
				BRAND	Sorex28R	Sorex28R
				INSERTS	Ride C30	Ride C30
				WHEELS	RP	RP
				ADDITIVE	FX2 + 55°C/15mins	FX2 + 55°C/15mins

MOTOR LAYOUT LONG. TRANS.
 SERVO LAYOUT LEFT RIGHT
 ESC LAYOUT LEFT RIGHT
 BAT. LAYOUT R1 R2 F1 F2
 SPUR **90** PINION **28**
 FINAL DRIVE RATIO
 BODY **Speed6 LWT**
 MOTOR **LRP X12 10.5t**
 SERVO **Savox 1251MG**
 ESC **HW 120A v2.1**
 BATTERY **ProAmps 6000**
 RECEIVER **Sanwa RX451R**
 MOTOR OFFSET / MM **-**
 WING **Standard**

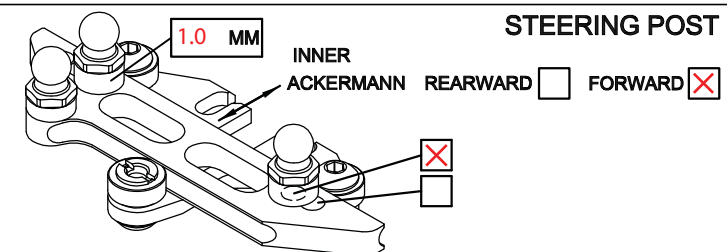

BEST LAPTIME **12.5** QUALIF. / FINAL POSITION /
 ESC SETTING **Boost 30, Turbo 10, DDRS 9, Boost Accl 400, start 4000, Turbo delay 0.2**
 COMMENTS / IMPRESSIONS **Track not as quick as previous week (~0.4s)**
Good balance, and consistent to drive. Will use as base for TITC.
Re-try reactive castor again, and work through spring/damper settings.
For more steering LTC-R, lower front roll-centre. IAS for tight and twisty track.
 CONTACT **thard@thard.co.uk**