

# AWESONIX® A700

NAME **Ed Clark**  
 COUNTRY **Thailand**  
 RACE **TITC 2012**  
 TRACK **RC Addict**

## SETUP SHEET

DATE **23-26 / 02 / 2012** TEMP.°C AIR / TRACK **38** / **32**  
 CARPET  ASPHALT   
 TRACK CONDITION TECHNICAL  MIXED  FAST   
 TRACTION LOW  MEDIUM  HIGH

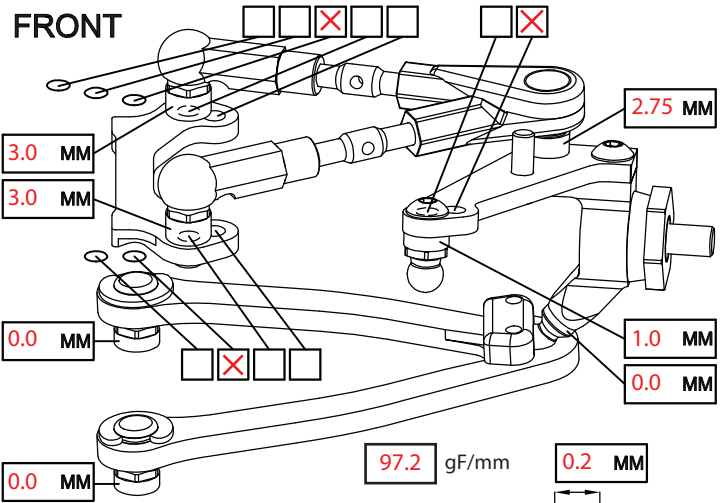

CAMBER ANGLE / ° **1.0**  
 CASTER ANGLE / ° **4.0**  
 TOE ANGLE / ° **-1.0**  
 RIDE HEIGHT / MM **4.8**  
 DOWNSTOP / MM **6**  
 UPSTOP / MM **-**

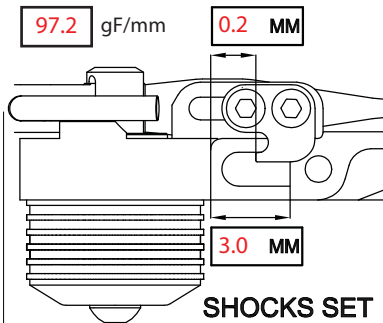

SHOCKS SET  
 SPRING STD    
 DAMPER STD    
 ACTION SYM.  ASYM.   
 SRS/RHS ARR. I  II   
 STABILIZER Ø / MM **1.3 (Black)**  
 LOW ARM STD    
 STEERING ARM STD    
 WHEEL SPACER / MM **0.0**  
 FRONT DRIVE BALL DIFF  GEAR DIFF  SPOOL  ONE-WAY   
 DIFF SET LOOSE  MEDIUM  TIGHT  OIL  #  
 DOGBONE DRIVE BUSHING  C-DRIVE  BB  EVD

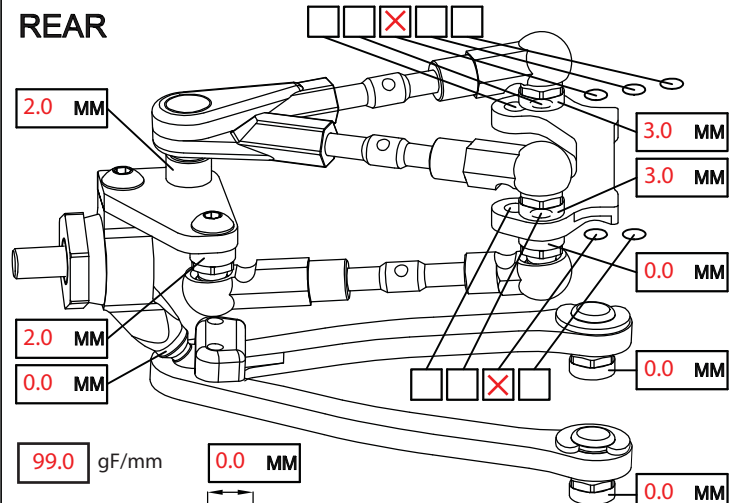

CAMBER ANGLE / ° **1.0**  
 CASTER ANGLE / ° **0.0**  
 TOE ANGLE / ° **3.0**  
 RIDE HEIGHT / MM **5.0**  
 DOWNSTOP / MM **5.5**  
 UPSTOP / MM **-**

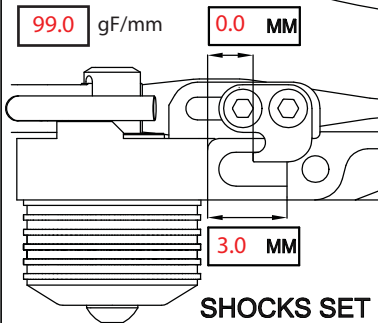

SHOCKS SET  
 SPRING STD    
 DAMPER STD    
 ACTION SYM.  ASYM.   
 SRS/RHS ARR. I  II   
 STABILIZER Ø / MM **-**  
 LOW ARM STD    
 STEERING ARM STD    
 WHEEL SPACER / MM **0.0**  
 REAR DRIVE BALL DIFF  GEAR DIFF   
 DIFF SET LOOSE  MEDIUM  TIGHT  OIL  # **Losi90**  
 DOGBONE DRIVE BUSHING  C-DRIVE  BB  EVD

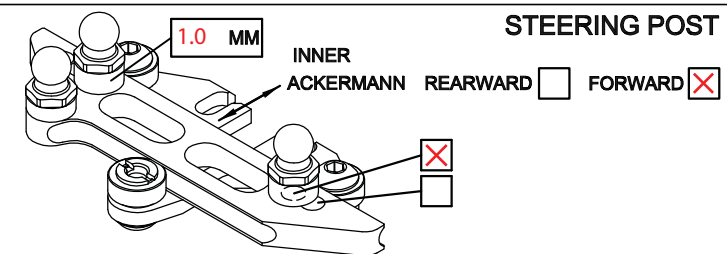
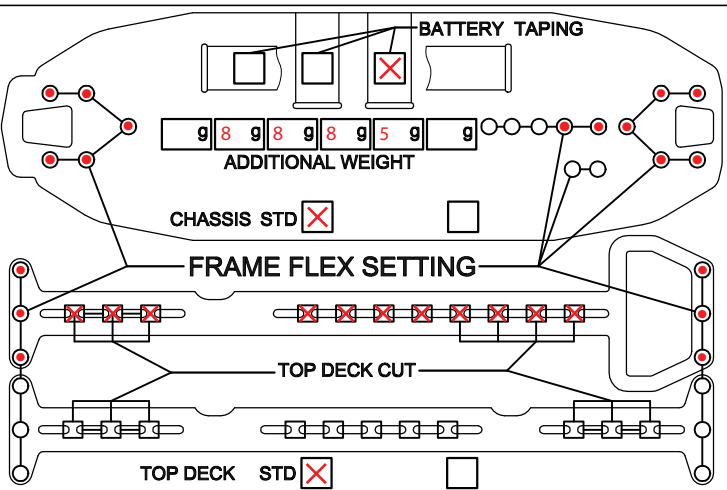

| FL | FR | RL | RR | TIRES    | FRONT        | REAR         |
|----|----|----|----|----------|--------------|--------------|
|    |    |    |    | BRAND    | Ride 36      | Ride 36      |
|    |    |    |    | INSERTS  | Ride C30     | Ride C30     |
|    |    |    |    | WHEELS   | MuchMore     | MuchMore     |
|    |    |    |    | ADDITIVE | LRP Carpet 2 | LRP Carpet 2 |

MOTOR LAYOUT LONG.  TRANS.  MOTOR **DS Z5 4.5t (12.8 rotor)**  
 SERVO LAYOUT LEFT  RIGHT  SERVO **Savox 1251 MG**  
 ESC LAYOUT LEFT  RIGHT  ESC **HW V3**  
 BAT. LAYOUT R1  R2  F1  F2  BATTERY **TP 6000 45C**  
 SPUR **96** PINION **28** RECEIVER **Sanwa RX451**  
 FINAL DRIVE RATIO **7.1** MOTOR OFFSET / MM **-**  
 BODY **LTC-R Lightweight** WING **Ride HD**

BEST LAPTIME **16.1** QUALIF. / FINAL POSITION **D9** / **D5**  
 ESC SETTING **30 turbo,**  
 COMMENTS / IMPRESSIONS **Car was good and stable, no hint of traction roll.**  
**Needed a little more steering (softer front spring?), should also have tested thicker rear oil.**  
**High speed damping needs some work, softer damper, stiffer spring...**  
**should have tried SRS ARR I, forgot about this!**  
 CONTACT **thard@thard.co.uk**