

AWESOMIX® A700

NAME **Ed Clark**
 COUNTRY **China**
 RACE **Practise**
 TRACK **RCI**

SETUP SHEET

DATE **11/03/2012** TEMP.°C AIR / TRACK **8** / 10
 CARPET ASPHALT
 TRACK CONDITION TECHNICAL MIXED FAST
 TRACTION LOW MEDIUM HIGH

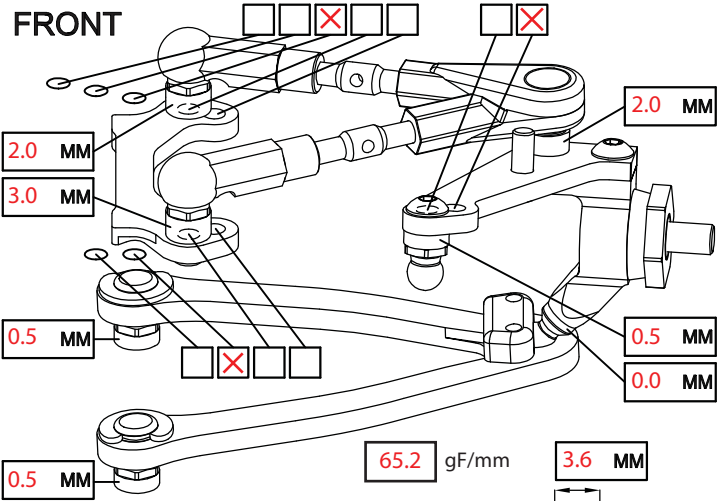

CAMBER ANGLE / ° **1.5**
 CASTER ANGLE / ° **4.0**
 TOE ANGLE / ° **-1.0**
 RIDE HEIGHT / MM **4.8**
 DOWNSTOP / MM **5.5**
 UPSTOP / MM

STABILIZER Ø / MM **1.3 (Black)**
 LOW ARM STD
 STEERING ARM STD
 WHEEL SPACER / MM **0.0**
 FRONT DRIVE BALL DIFF GEAR DIFF SPOOL ONE-WAY
 DIFF SET LOOSE MEDIUM TIGHT OIL #
 DOGBONE DRIVE BUSHING C-DRIVE BB EVD

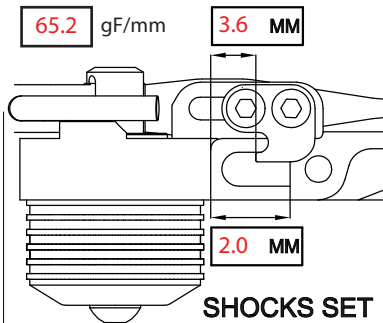

SHOCKS SET
 SPRING STD
 DAMPER STD
 ACTION SYM. ASYM.
 SRS/RHS ARR. I II

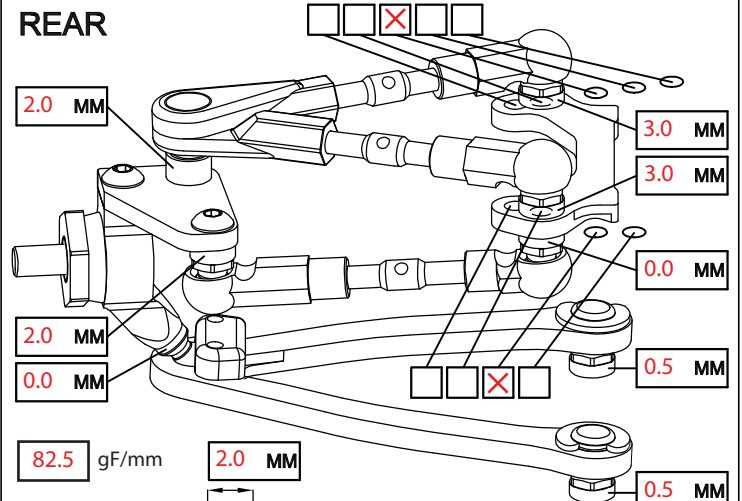

CAMBER ANGLE / ° **1.5**
 CASTER ANGLE / ° **0.0**
 TOE ANGLE / ° **3.0**
 RIDE HEIGHT / MM **5.0**
 DOWNSTOP / MM **5.0**
 UPSTOP / MM

STABILIZER Ø / MM **1.2 (Brown)**
 LOW ARM STD
 STEERING ARM STD
 WHEEL SPACER / MM **0.0**
 REAR DRIVE BALL DIFF GEAR DIFF
 DIFF SET LOOSE MEDIUM TIGHT OIL # **Losi70**
 DOGBONE DRIVE BUSHING C-DRIVE BB EVD

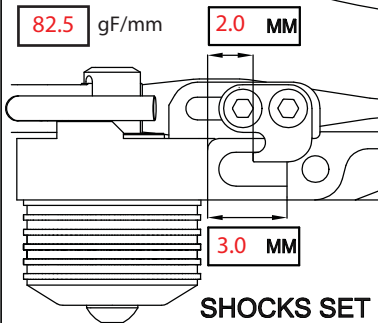

SHOCKS SET
 SPRING STD
 DAMPER STD
 ACTION SYM. ASYM.
 SRS/RHS ARR. I II

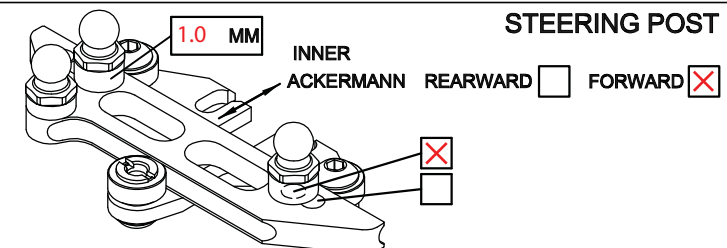
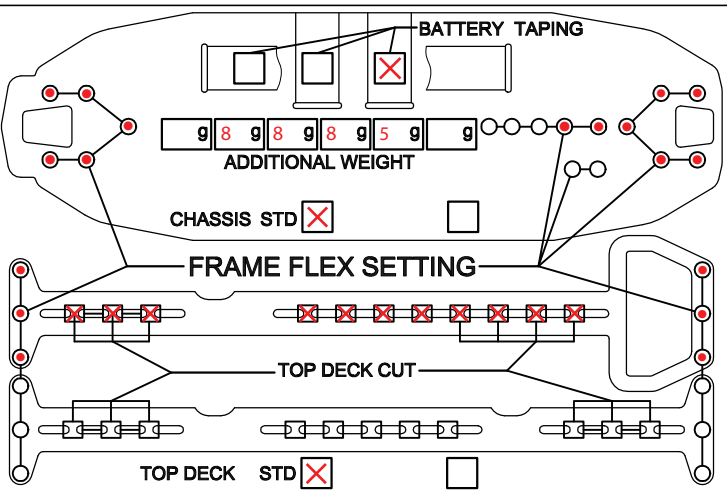

FL	FR	RL	RR	TIRES	FRONT	REAR
				BRAND	Sorex 32R	Sorex 32R
				INSERTS	Hara Black V2	Hara Black V2
				WHEELS	Sweep EXP	Sweep EXP
				ADDITIVE	FX2	FX2

MOTOR LAYOUT LONG. TRANS. MOTOR **LRP X12 10.5t**
 SERVO LAYOUT LEFT RIGHT SERVO **Savox 1251MG**
 ESC LAYOUT LEFT RIGHT ESC **HW V3**
 BAT. LAYOUT R1 R2 F1 F2 BATTERY **TP 6000 45C**
 SPUR **96** PINION **28** RECEIVER **Sanwa RX451R**
 FINAL DRIVE RATIO MOTOR OFFSET / MM **0.0**
 BODY **Speed 6 LWT** WING **RIDE HD**

BEST LAPTIME **11.9** QUALIF. / FINAL POSITION /
 ESC SETTING **Boost 30, Turbo 10, Punch 30/30**
 COMMENTS / IMPRESSIONS **Very +ve, good over bumps, no traction roll!**
Used Steen ETS as base. Softer damper = no corner speed
Will over-rotate mid-corner if too aggressive, try softer rear.
Also need to try softer in general (make car roll more as long, not tran motor)
 CONTACT **thard@thard.co.uk**