

AWESONIX® A700

NAME **Ed Clark**
 COUNTRY **China**
 RACE **First Practise**
 TRACK **RCI**

SETUP SHEET

DATE **02/01/2012** TEMP.°C AIR / TRACK **10** / **15**
 CARPET ASPHALT
 TRACK CONDITION TECHNICAL MIXED FAST
 TRACTION LOW MEDIUM HIGH

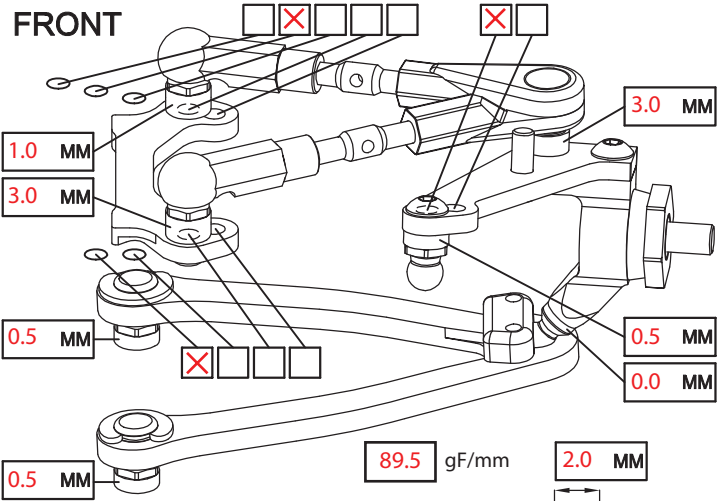

CAMBER ANGLE / ° **1.5**
 CASTER ANGLE / ° **4.3**
 TOE ANGLE / ° **1.0**
 RIDE HEIGHT / MM **5.0**
 DOWNSTOP / MM **5.5**
 UPSTOP / MM **Not Used**

STABILIZER Ø / MM **1.15**
 LOW ARM STD
 STEERING ARM STD
 WHEEL SPACER / MM **0.5**
 FRONT DRIVE BALL DIFF GEAR DIFF SPOOL ONE-WAY
 DIFF SET LOOSE MEDIUM TIGHT OIL #
 DOGBONE DRIVE BUSHING C-DRIVE BB EVD

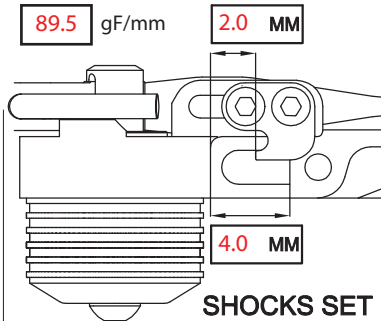

SHOCKS SET

SPRING STD
 DAMPER STD
 ACTION SYM. ASYM.
 SRS/RHS ARR. I II

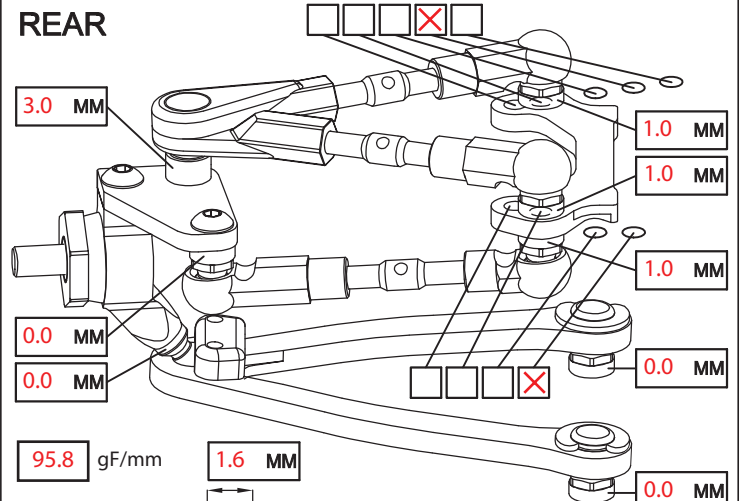

CAMBER ANGLE / ° **1.5**
 CASTER ANGLE / ° **3mm diff**
 TOE ANGLE / ° **3.0**
 RIDE HEIGHT / MM **5.0**
 DOWNSTOP / MM **4.5**
 UPSTOP / MM **Not Used**

STABILIZER Ø / MM **1.0**
 LOW ARM STD
 STEERING ARM STD
 WHEEL SPACER / MM **0.5**
 REAR DRIVE BALL DIFF GEAR DIFF
 DIFF SET LOOSE MEDIUM TIGHT OIL # **Losi80**
 DOGBONE DRIVE BUSHING C-DRIVE BB EVD

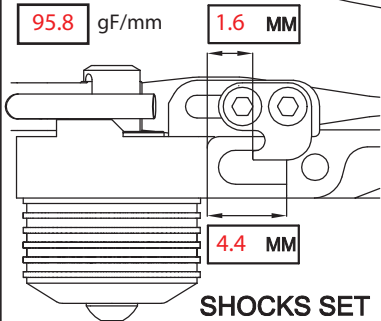

SHOCKS SET

SPRING STD
 DAMPER STD
 ACTION SYM. ASYM.
 SRS/RHS ARR. I II

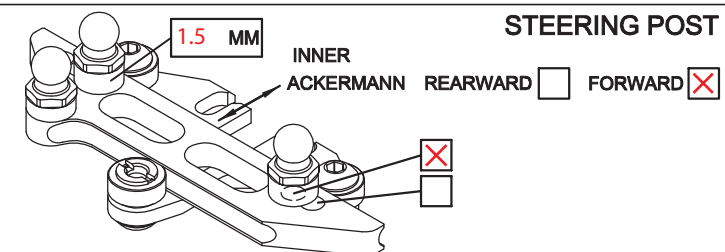
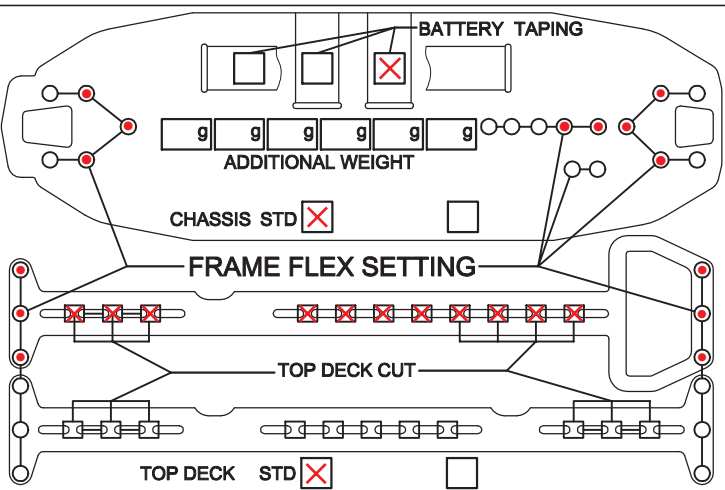

STEERING POST

INNER ACKERMANN REARWARD FORWARD

FL	FR	RL	RR	TIRES	FRONT	REAR
				BRAND	TP32 Spec	TP32 Spec
				INSERTS		
				WHEELS		
				ADDITIVE	FX2 / 45°C	FX2 / 45°C

MOTOR LAYOUT LONG. TRANS.
 SERVO LAYOUT LEFT RIGHT
 ESC LAYOUT LEFT RIGHT
 BAT. LAYOUT R1 R2 F1 F2
 SPUR **88** PINION **39**
 FINAL DRIVE RATIO
 BODY **Speed 6 LWT**
 MOTOR **MMH 13.5**
 SERVO **Savox 1251MG**
 ESC **HW 120A v2.1**
 BATTERY **HW 6000mah**
 RECEIVER **Sanwa RX451R**
 MOTOR OFFSET / MM **0**
 WING **Standard**

BEST LAPTIME **No amb** QUALIF. / FINAL POSITION /
 ESC SETTING **508_V3 - DDRS 9, 10% Drag, 6% Neutral range.**
 COMMENTS / IMPRESSIONS **Reactive castor helped to avoid push mid-corner.**
Used softer spring/damper rates + Roll bars to help with track bumps.
A little too reactive on initial steering input, difficult to get into sweeper consistently.
To try - Roll centre, Asym dampers, Battery position
 CONTACT **thard@thard.co.uk**