

NAME **Karl Hoffmeister**  
 COUNTRY **USA**  
 RACE **Halloween Classic**  
 TRACK **The Gate**

DATE **10/27/2013** TEMP. °C AIR / TRACK °C / °C  
 TRACK CONDITION TECHNICAL  MIXED  FAST   
 TRACTION LOW  MEDIUM  HIGH

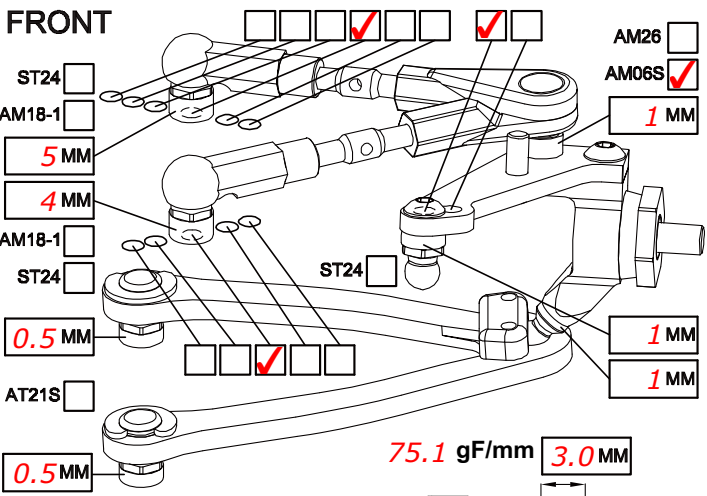

CAMBER ANGLE / ° **1.25**  
 CASTER ANGLE / ° **4**  
 TOE ANGLE / ° **0.5**  
 RIDE HEIGHT / MM **5**  
 DOWNSTOP / MM **notes**  
 UPSTOP / MM

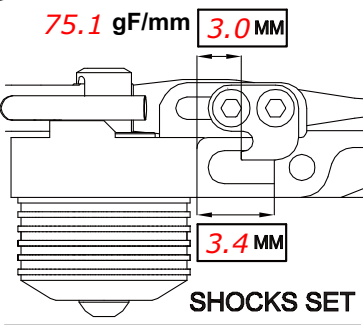

STABILIZER Ø / MM **1.2** SPRING STD  S   
 LOW ARM STD  DAMPER #6  #3   
 STEERING ARM STD  ACTION SYM.  ASYM.   
 WHEEL SPACER / MM **0.5** SRS/RHS ARR. I  II   
 FRONT DRIVE BALL DIFF  GEAR DIFF  SPOOL  ONE-WAY   
 DIFF SET LOOSE  MEDIUM  TIGHT  OIL #   
 DOGBONE DRIVE BUSHING  C-DRIVE  BB  EVD

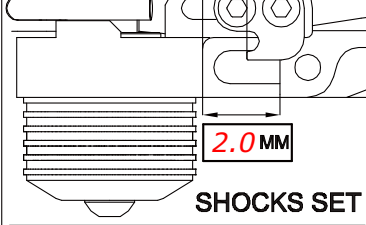
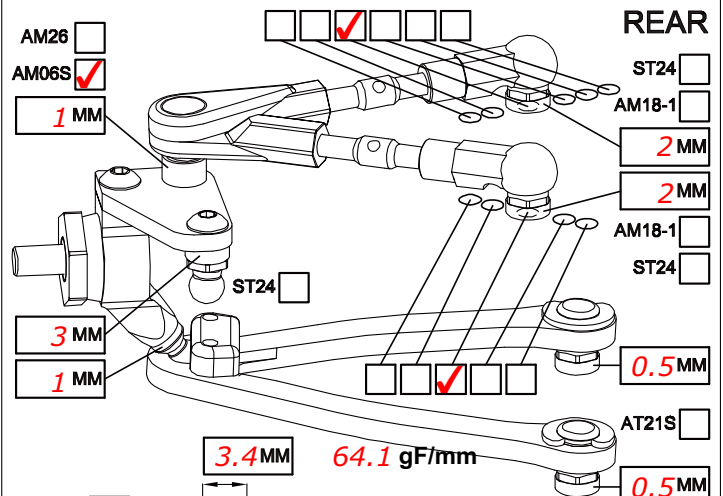

CAMBER ANGLE / ° **2**  
 CASTER ANGLE / ° **0**  
 TOE ANGLE / ° **3**  
 RIDE HEIGHT / MM **5**  
 DOWNSTOP / MM **notes**  
 UPSTOP / MM

SPRING STD  S   
 DAMPER #6  #3   
 ACTION SYM.  ASYM.   
 SRS/RHS ARR. I  II   
 REAR DRIVE BALL DIFF  GEAR DIFF   
 DIFF SET LOOSE  MEDIUM  TIGHT  OIL #  **1K**  
 DOGBONE DRIVE BUSHING  C-DRIVE  BB  EVD

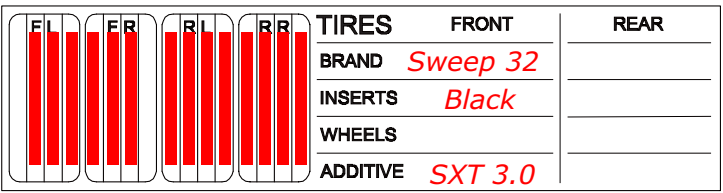
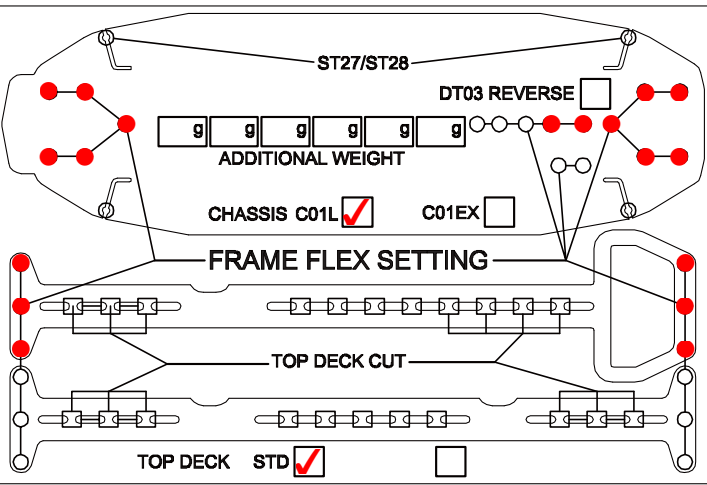

MOTOR LAYOUT LONG  TRANS.  MOTOR **Express D3.5 17.5**  
 SERVO LAYOUT LEFT  RIGHT  SERVO  
 ESC LAYOUT LEFT  RIGHT  ESC  
 BAT. LAYOUT R1  R2  F1  F2  BATTERY  
 SPUR **80** PINION RECEIVER  
 FINAL DRIVE RATIO **3.78** MOTOR OFFSET / MM  
 BODY **LTC LtWt** WING

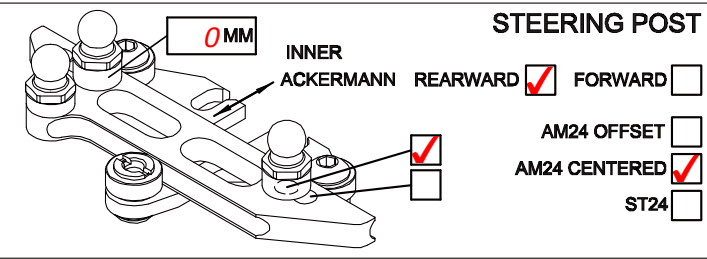

BEST LAPTIME **9.3** QUALIF. / FINAL POSITION **1 / 1**  
 ESC SETTING  
 COMMENTS / IMPRESSIONS  
**4.6mm Droop Measured at Arm - Front**  
**5.2mm Droop Measured at Arm - Rear**  
 CONTACT