

NAME **Aaron Young**
 COUNTRY **USA**
 RACE **Club Race**
 TRACK **NorCal Hobbies (Home of the Reedy Race)**

DATE **April 2013** TEMP. °C AIR / TRACK **60°F** / °C
 TRACK CONDITION TECHNICAL MIXED FAST
 TRACTION LOW MEDIUM HIGH

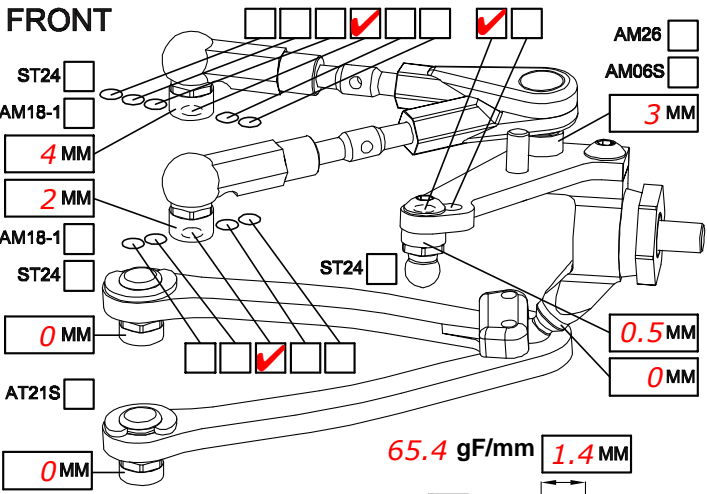

CAMBER ANGLE / ° **2**
 CASTER ANGLE / ° **5**
 TOE ANGLE / ° **-1.0**
 RIDE HEIGHT / MM **5.0**
 DOWNSTOP / MM **1.5**
 UPSTOP / MM **NA**
 STABILIZER Ø / MM **Copper**
 LOW ARM STD
 STEERING ARM STD
 WHEEL SPACER / MM
 FRONT DRIVE BALL DIFF GEAR DIFF SPOOL ONE-WAY
 DIFF SET LOOSE MEDIUM TIGHT OIL #
 DOGBONE DRIVE BUSHING C-DRIVE BB EVD

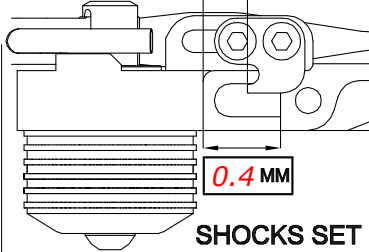

SPRING STD S
 DAMPER #6 #3
 ACTION SYM. ASYM.
 SRS/RHS ARR. I II

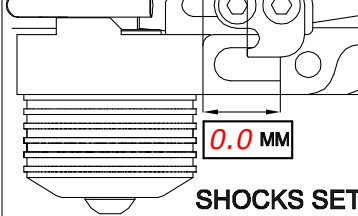
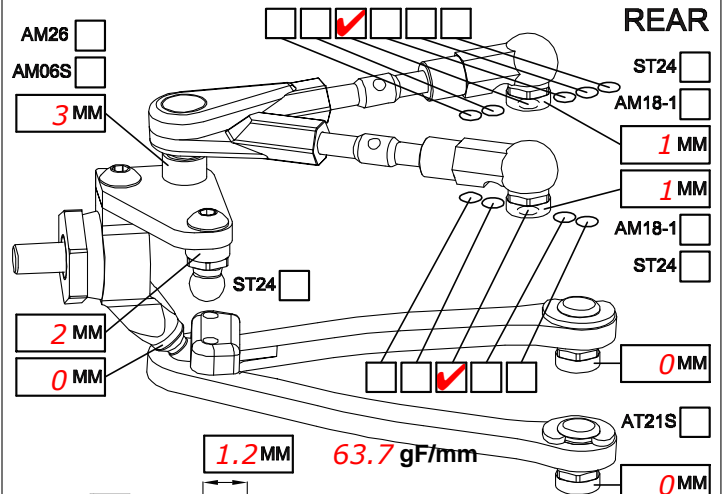

SPRING STD S
 DAMPER #6 #3
 ACTION SYM. ASYM.
 SRS/RHS ARR. I II

CAMBER ANGLE / ° **2**
 CASTER ANGLE / ° **6**
 TOE ANGLE / ° **2.25**
 RIDE HEIGHT / MM **5.2**
 DOWNSTOP / MM **2.5**
 UPSTOP / MM **NA**
 STABILIZER Ø / MM **Copper**
 LOW ARM STD
 STEERING ARM STD
 WHEEL SPACER / MM
 REAR DRIVE BALL DIFF GEAR DIFF
 DIFF SET LOOSE MEDIUM TIGHT OIL # **1000**
 DOGBONE DRIVE BUSHING C-DRIVE BB EVD

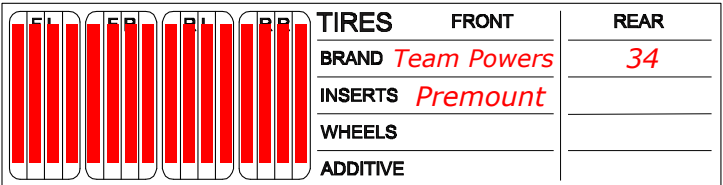
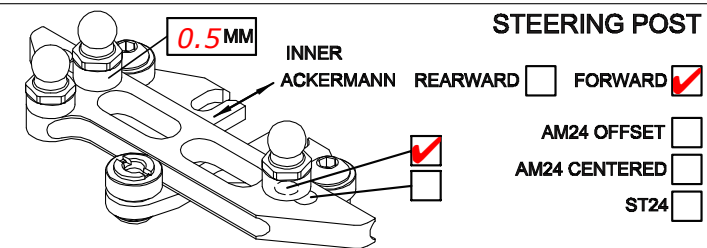
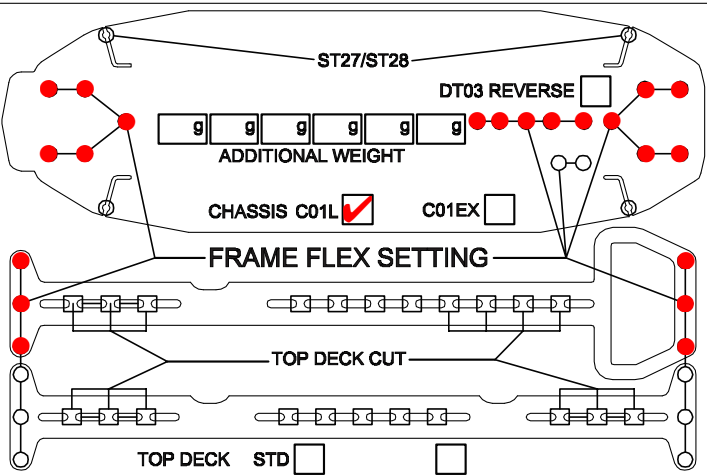

MOTOR LAYOUT LONG TRANS. MOTOR **17.5**
 SERVO LAYOUT LEFT RIGHT SERVO
 ESC LAYOUT LEFT RIGHT ESC
 BAT. LAYOUT R1 R2 F1 F2 BATTERY
 SPUR PINION RECEIVER
 FINAL DRIVE RATIO MOTOR OFFSET / MM
 BODY WING

BEST LAPTIME QUALIF. / FINAL POSITION **1 / 1**
 ESC SETTING
 COMMENTS / IMPRESSIONS
ST09 under top deck and inner camber links
 CONTACT