

NAME **Viljami Kutvonen**
 COUNTRY _____
 RACE **ETS Round 3 2012-2013 Modified**
 TRACK **Telde, Gran Canaria**

DATE **03.03.2013** TEMP. °C AIR / TRACK °C / °C
 CARPET ASPHALT
 TRACK CONDITION TECHNICAL MIXED FAST
 TRACTION LOW MEDIUM HIGH

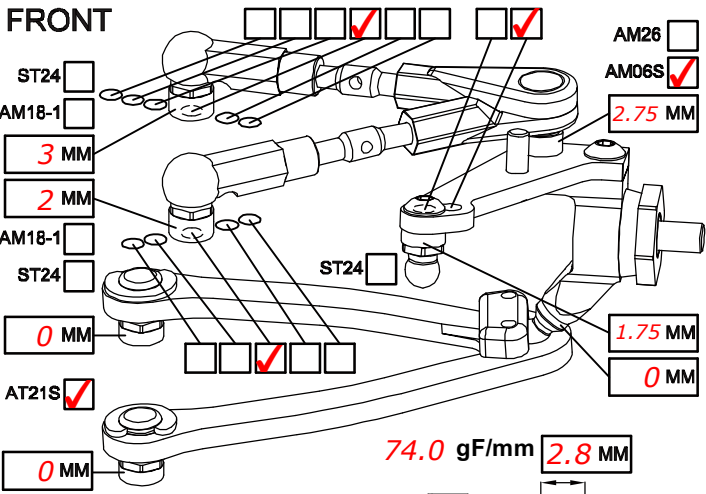

CAMBER ANGLE / ° **1.5**
 CASTER ANGLE / ° **4**
 TOE ANGLE / ° **0.5 out**
 RIDE HEIGHT / MM **5.1**
 DOWNSTOP / MM **6**
 UPSTOP / MM **max**
 STABILIZER Ø / MM **1.0**
 LOW ARM STD
 STEERING ARM STD
 WHEEL SPACER / MM **0**
 FRONT DRIVE BALL DIFF GEAR DIFF SPOOL ONE-WAY
 DIFF SET LOOSE MEDIUM TIGHT OIL #
 DOGBONE DRIVE BUSHING C-DRIVE BB EVD

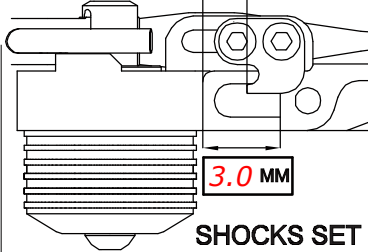

SPRING STD S
 DAMPER #6 #3
 ACTION SYM. ASYM.
 SRS/RHS ARR. I II

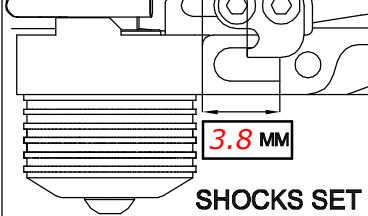
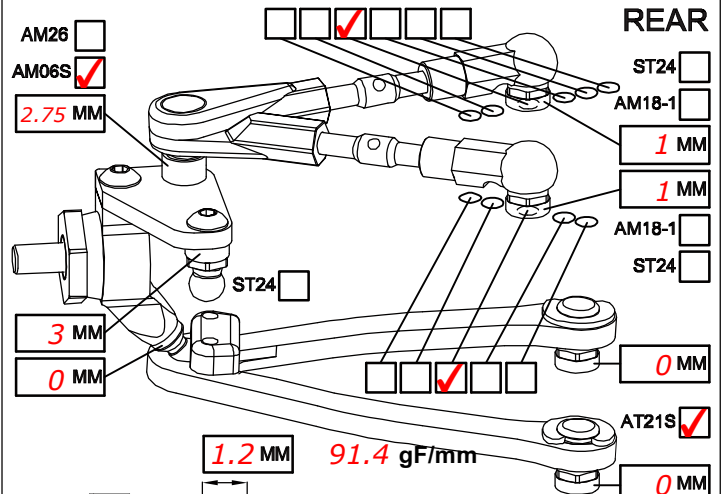

SPRING STD S
 DAMPER #6 #3
 ACTION SYM. ASYM.
 SRS/RHS ARR. I II

CAMBER ANGLE / ° **1.5**
 CASTER ANGLE / ° **1.5**
 TOE ANGLE / ° **3**
 RIDE HEIGHT / MM **5.3**
 DOWNSTOP / MM **5**
 UPSTOP / MM **max**
 STABILIZER Ø / MM **1.0**
 LOW ARM STD
 STEERING ARM STD
 WHEEL SPACER / MM **0**
 REAR DRIVE BALL DIFF GEAR DIFF
 DIFF SET LOOSE MEDIUM TIGHT OIL # **~1500**
 DOGBONE DRIVE BUSHING C-DRIVE BB EVD

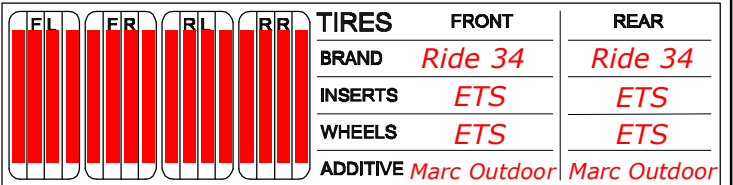
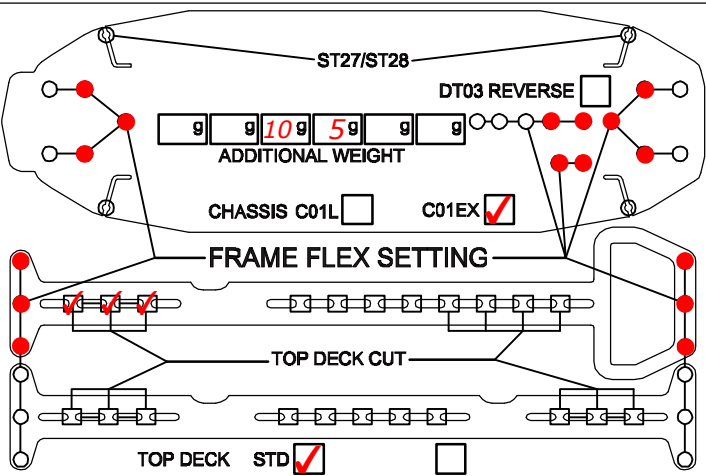

MOTOR LAYOUT LONG. TRANS. MOTOR **LRP X20 4.5T**
 SERVO LAYOUT LEFT RIGHT SERVO **Sanwa SRG-BLS**
 ESC LAYOUT LEFT RIGHT ESC **LRP Flow WorksTeam**
 BAT. LAYOUT R1 R2 F1 F2 BATTERY **LRP 6900 LiPo**
 SPUR PINION RECEIVER **Sanwa 451R**
 FINAL DRIVE RATIO **8.49** MOTOR OFFSET / MM
 BODY **Protoform LTC-R** WING **MR33**

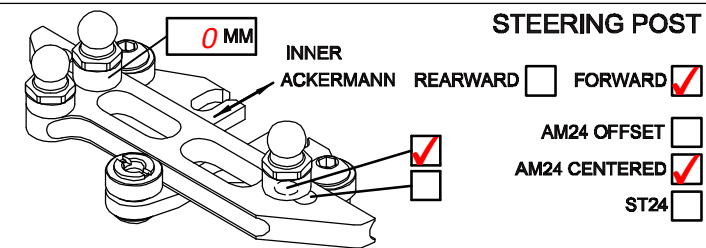

BEST LAPTIME QUALIF. / FINAL POSITION /
 ESC SETTING
 COMMENTS / IMPRESSIONS
 CONTACT