

NAME **Dionys Stadler**
 COUNTRY **Roll centers F/R: -10,39mm / -11,33mm**
 RACE
 TRACK **Türkheim**

DATE **5.05.2013** TEMP. °C AIR / TRACK °C / °C
 CARPET ASPHALT
 TRACK CONDITION TECHNICAL MIXED FAST
 TRACTION LOW MEDIUM HIGH

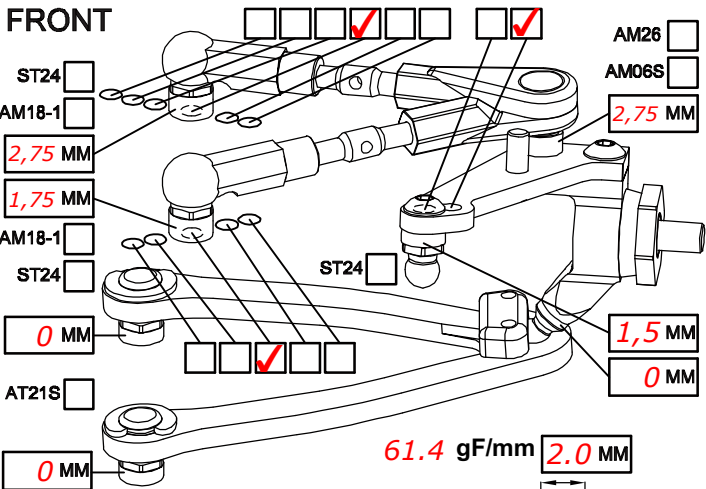

CAMBER ANGLE / ° **1,5**
 CASTER ANGLE / ° **3,5**
 TOE ANGLE / ° **0,5**
 RIDE HEIGHT / MM **6,0**
 DOWNSTOP / MM **5,8**

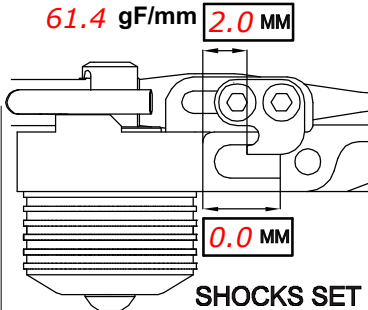

UPSTOP / MM
 STABILIZER Ø / MM **1,2** SPRING STD S
 LOW ARM STD DAMPER #6 #3
 STEERING ARM STD ACTION SYM. ASYM.
 WHEEL SPACER / MM **0** SRS/RHS ARR. I II
 FRONT DRIVE BALL DIFF GEAR DIFF SPOOL ONE-WAY
 DIFF SET LOOSE MEDIUM TIGHT OIL #
 DOGBONE DRIVE BUSHING C-DRIVE BB EVD

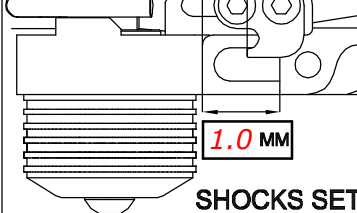
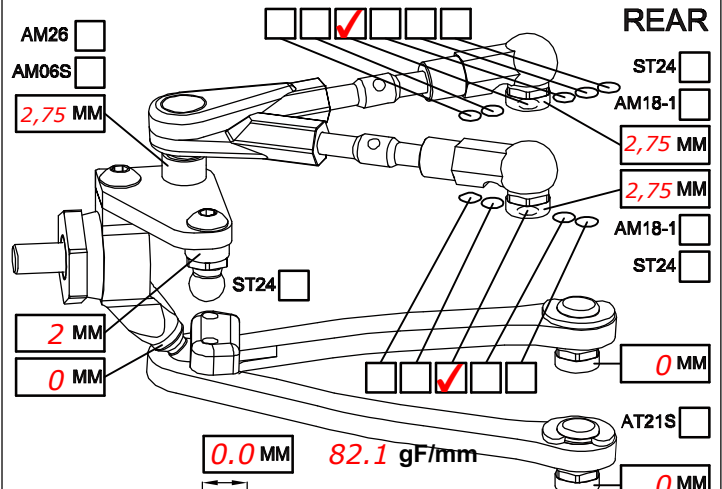

CAMBER ANGLE / ° **2,0**
 CASTER ANGLE / ° **0**
 TOE ANGLE / ° **2,5**
 RIDE HEIGHT / MM **6,2**
 DOWNSTOP / MM **5,0**

UPSTOP / MM
 STABILIZER Ø / MM **1,0** SPRING STD S
 LOW ARM STD DAMPER #6 #3
 STEERING ARM STD ACTION SYM. ASYM.
 WHEEL SPACER / MM **0** SRS/RHS ARR. I II
 REAR DRIVE BALL DIFF GEAR DIFF
 DIFF SET LOOSE MEDIUM TIGHT OIL # **3000**
 DOGBONE DRIVE BUSHING C-DRIVE BB EVD

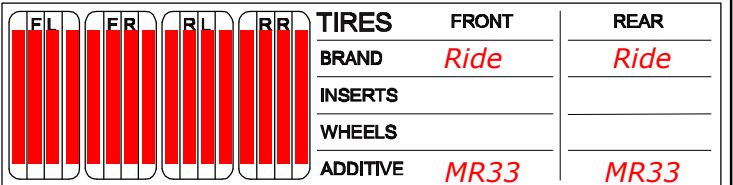
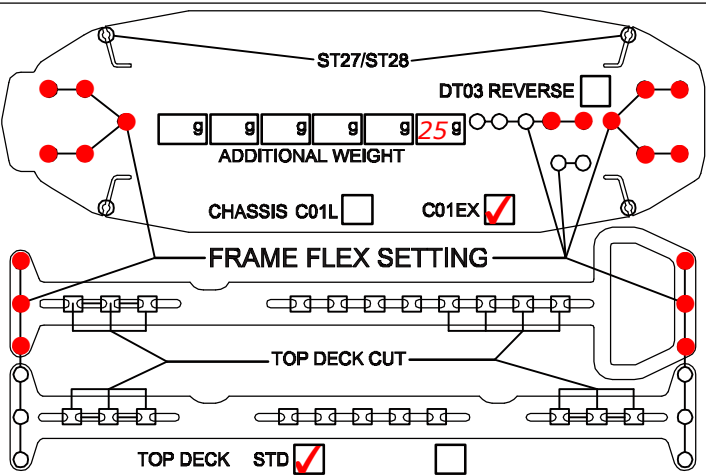

MOTOR LAYOUT LONG. TRANS. MOTOR **ORCA 4,5**
 SERVO LAYOUT LEFT RIGHT SERVO **Sanwa**
 ESC LAYOUT LEFT RIGHT ESC **ORCA**
 BAT. LAYOUT R1 R2 F1 F2 BATTERY **ORCA**
 SPUR **26** PINION **96** RECEIVER
 FINAL DRIVE RATIO **7,68** MOTOR OFFSET / MM
 BODY **PF Mazda Speed6 LW** WING **STD**

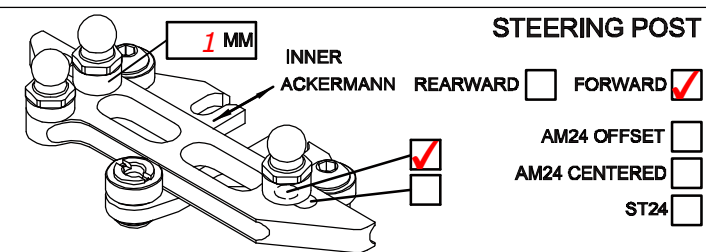

BEST LAPTIME **13,36** QUALIF. / FINAL POSITION /
 ESC SETTING
 COMMENTS / IMPRESSIONS
2x Stahlrad in Diff
 CONTACT