

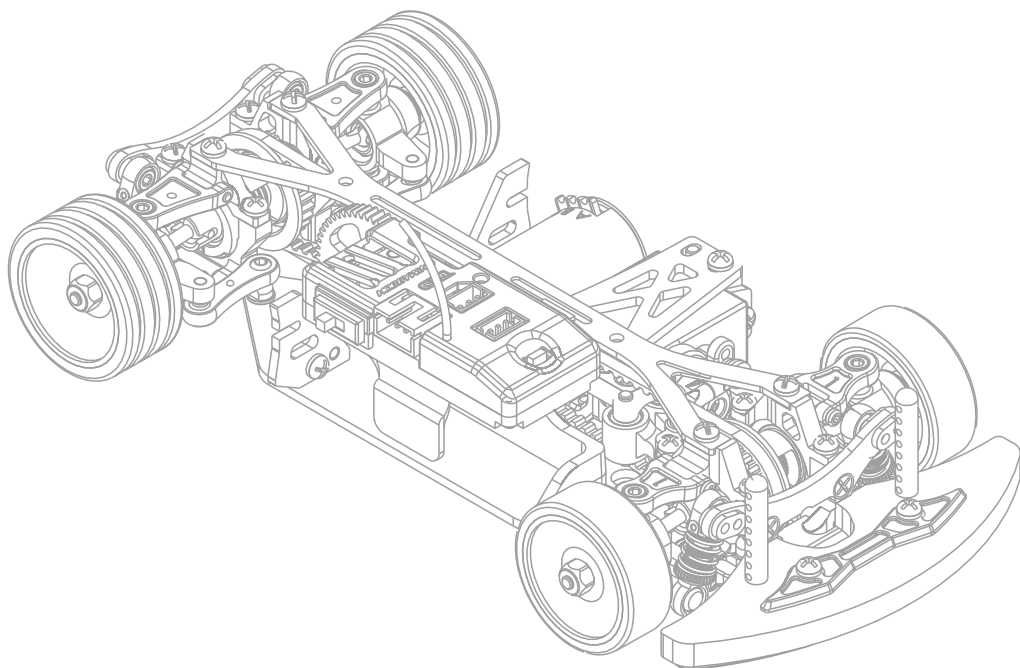

## Instruction and Assembly Manual



Thank you for purchasing this Atomic product. BZ is a high performance competition machine for 1:28 scale. Please read this manual in detail in order to have proper assembly of this product and wish you have fun with it.

### Tools Included :

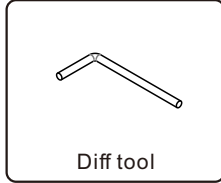
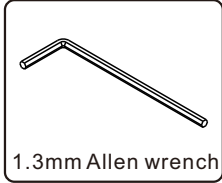

### Tools Needed (Not Included) :

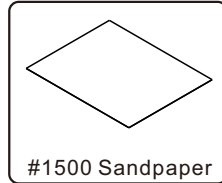
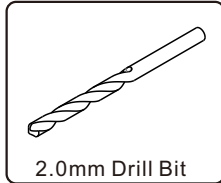
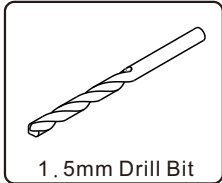
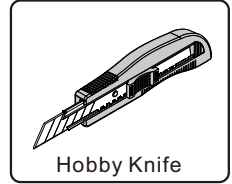
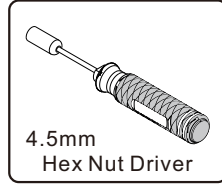
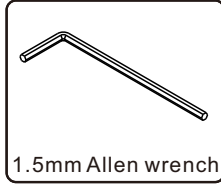

### Equipment required :

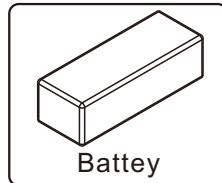
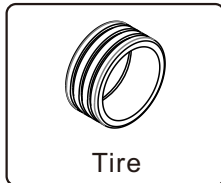
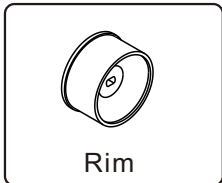
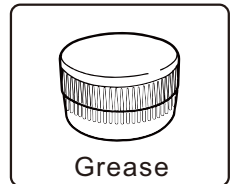
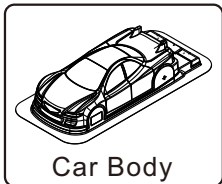

**1**

- 2x4KB** x8
- 2x4KM** x3

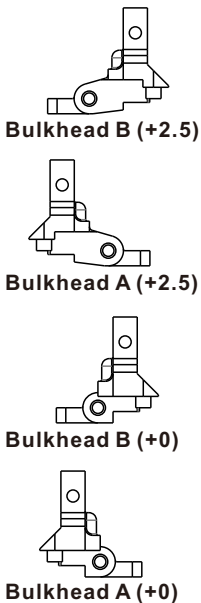

# 1 Attaching bulkheads

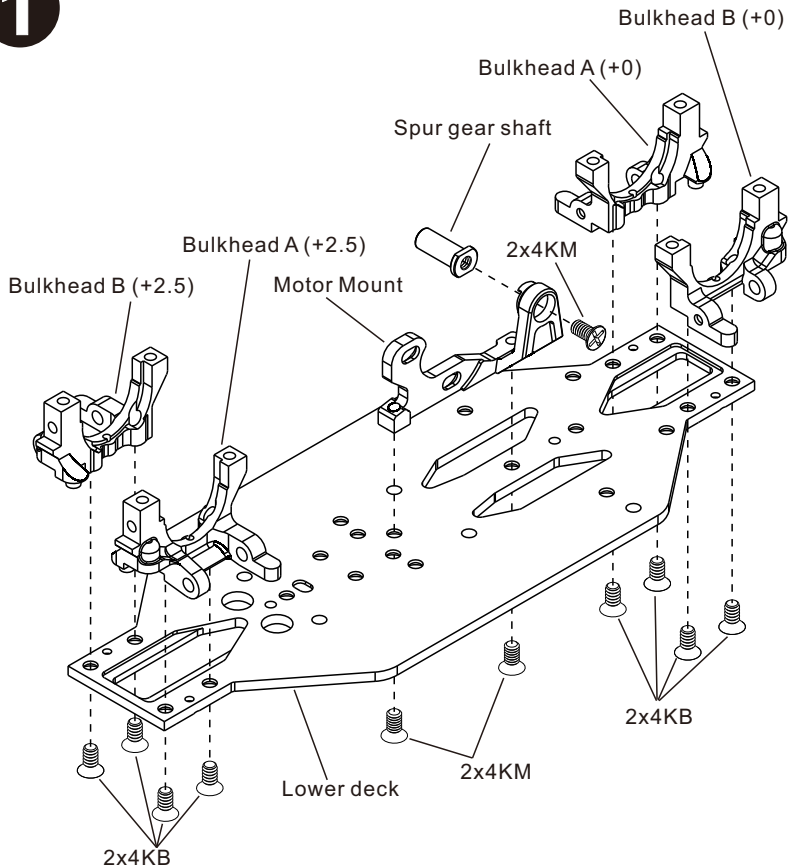

**2**

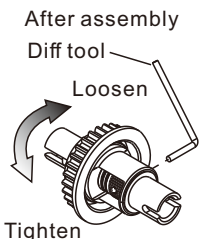

## Build 2 sets

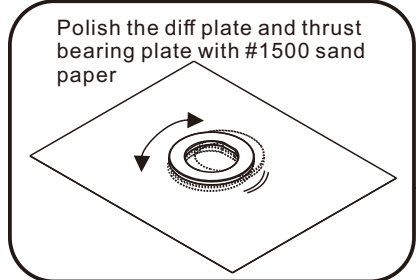
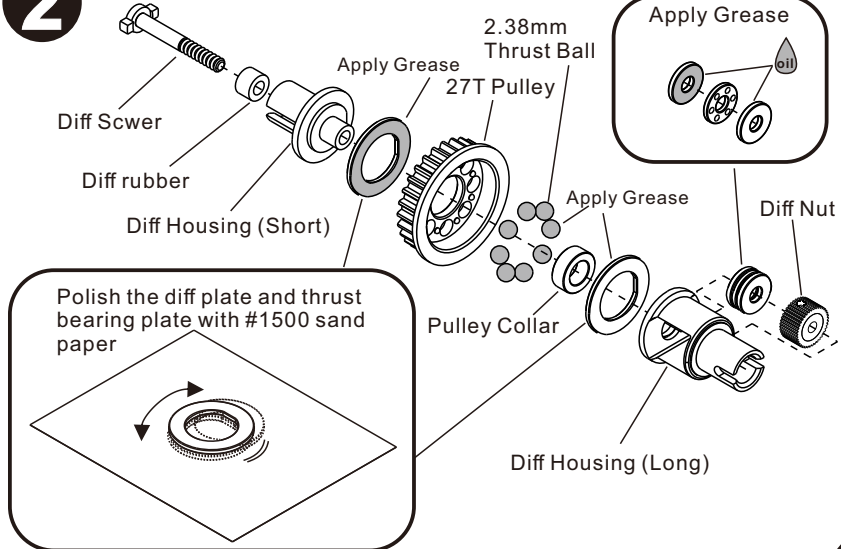

# 2 Ball differential



**3**

-  x4
-  x1



Upper Bulkhead B (+0)

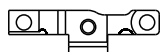

Upper Bulkhead A (+0)

**Attention:**

Add 0.2 mm shims at this side of outdrive cup.

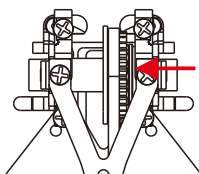
**3**

### Attaching Rear Ball differential & Center Pulley

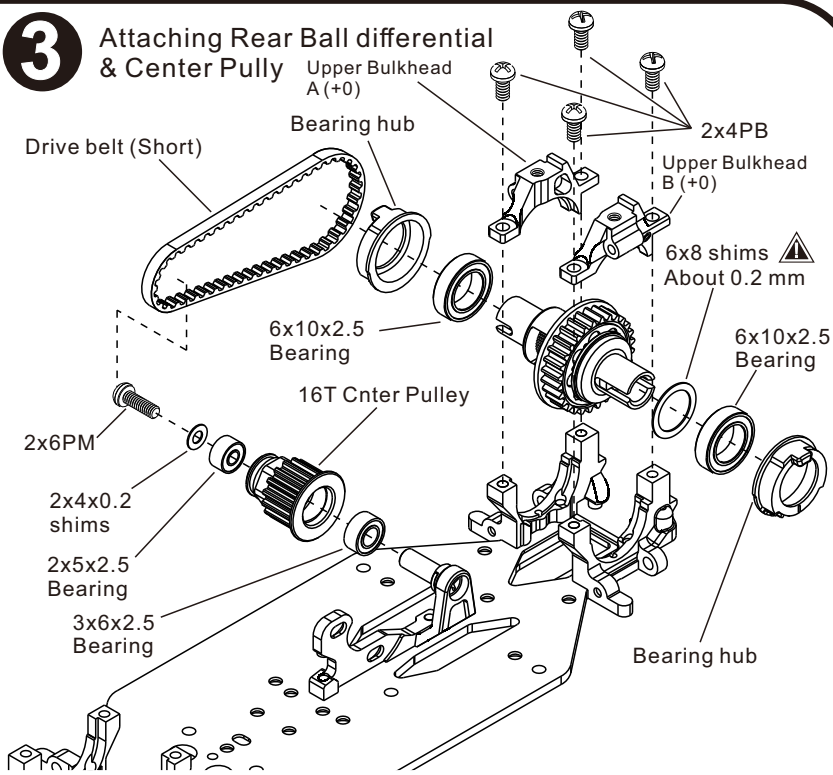
**4**

-  x4



Upper Bulkhead B (+2.5)

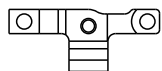

Upper Bulkhead A (+2.5)

**Attention:**

Add 0.2 mm shims at this side of outdrive cup.

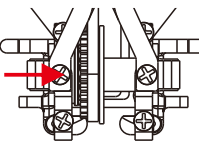
**4**

### Attaching Front Ball differential

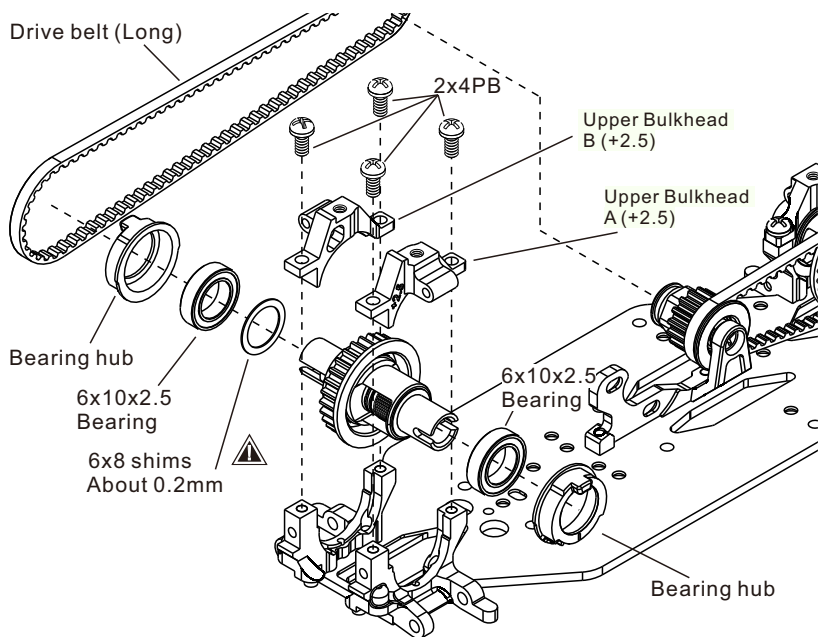

**5**

 x4  
2x4PM

 x4  
1.2x4KM

**Front**

Tighten Loosen

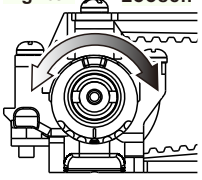

Adjust the bearing hub position to make sure the drive system smooth.

**Rear**

Loosen Tighten

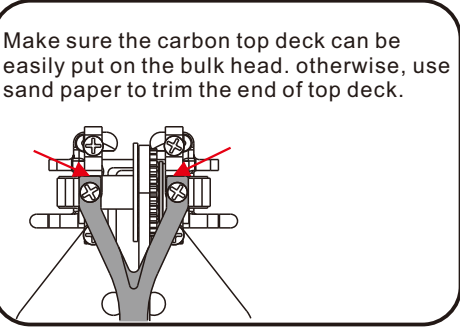
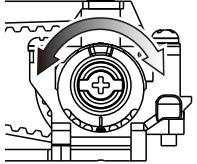
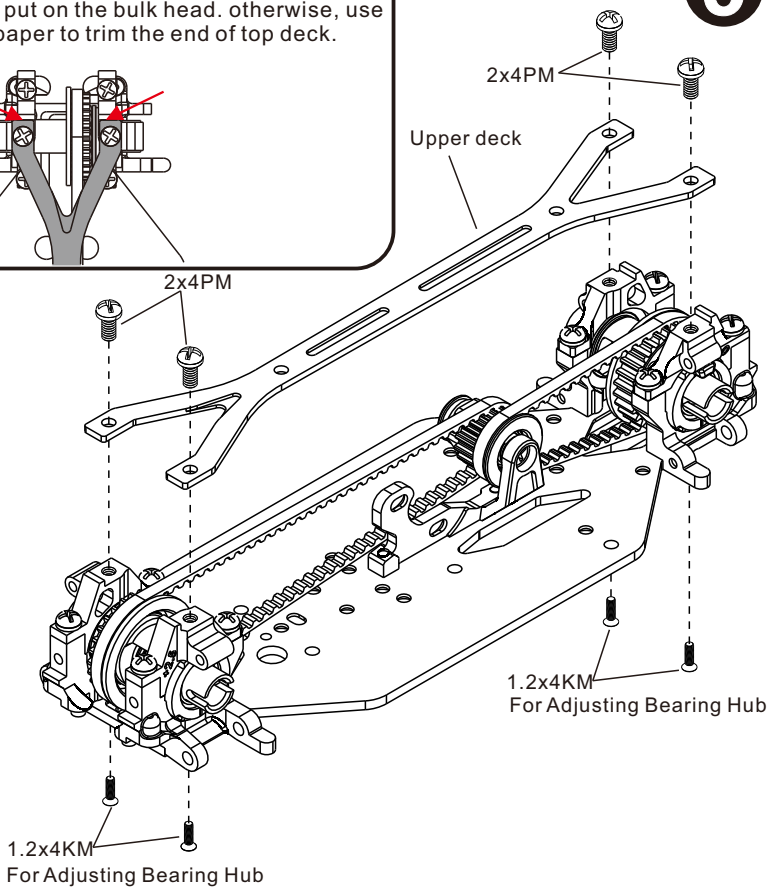
**Attaching Upper deck****5****6**

 x2  
2x10PM



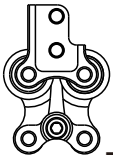
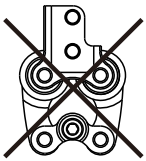

 **Attention:**  
Installation direction

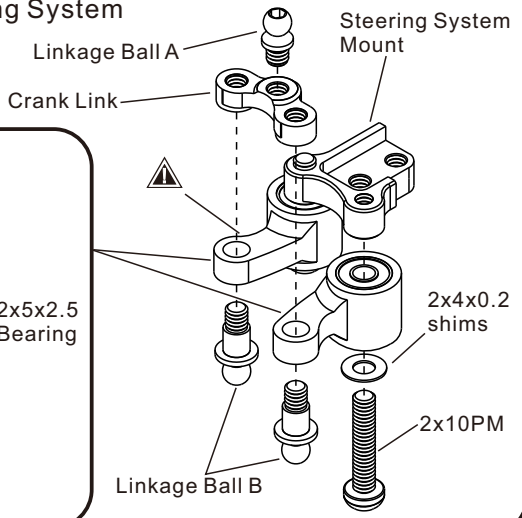
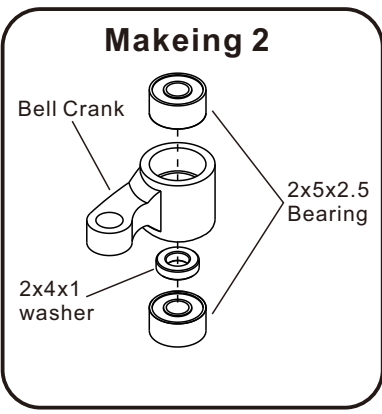

P.3

**6****Attaching Steering System**

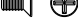
# 7

-  x1
- 1.5x11 Set screw**
-  x1
- 1.5x6PB**
-  x2
- 2x4KM**
-  x5
- 2x4PM**

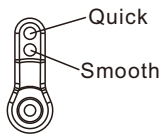

Steering Respond

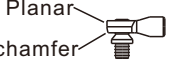

**Attention:**  
Installation direction

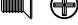

# 8

-  x4
- 2x4KM**
-  x1
- 5x7x1mm O-ring**

**Attention:**

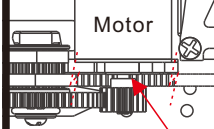

Carefully adjust the position of pinion, make sure it does not touch the front belt.

# 7

## Attaching Servo Mount

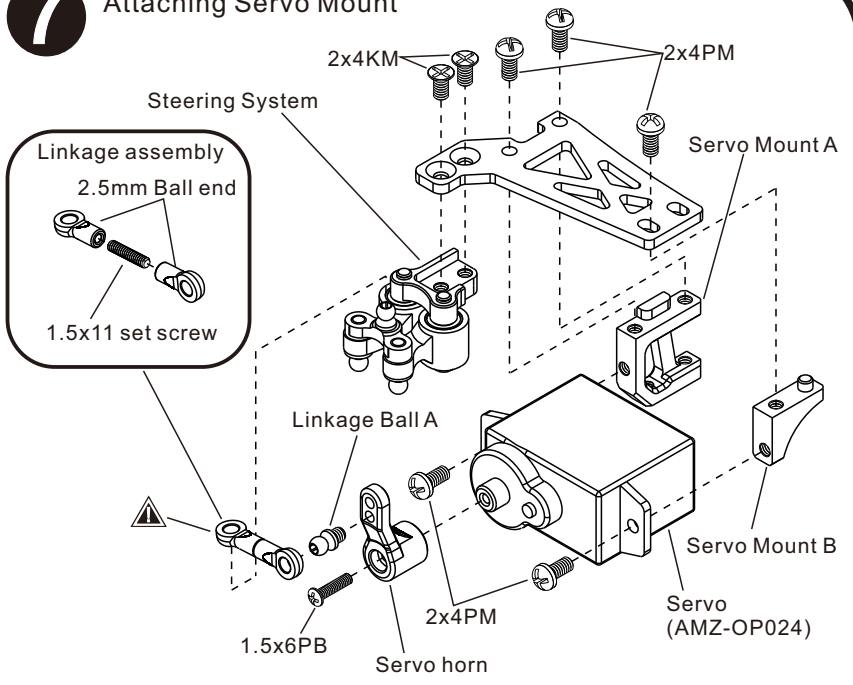

# 8

## Attaching Spur gear & Motor gear

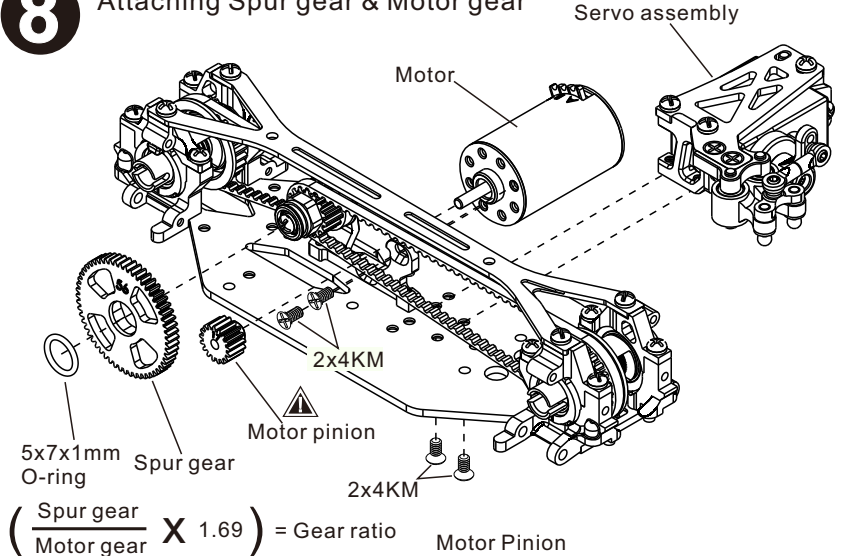

$$\left( \frac{\text{Spur gear}}{\text{Motor gear}} \times 1.69 \right) = \text{Gear ratio} \quad \text{Motor Pinion}$$

		14	15	16	17	18
54				5.70	5.36	5.06
56		6.75	6.30	5.91	5.56	5.25
58	7.53	6.99	6.53	6.12	5.76	5.44

(5.91 is recommended for 5000KV motor)

9

### Build 4 Sets

After assembly  
Installation the wheel  
for testing

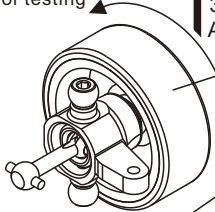

Insert shims to  
adjust the play  
of CVD

9

### Axles assembly

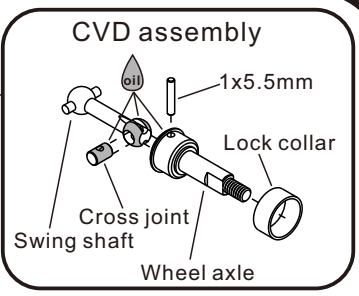
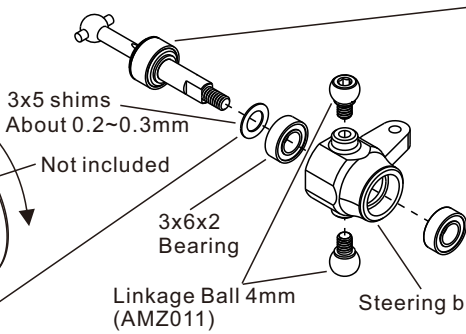

10

### Build 2 Sets

L/R

1.2x3PB x2

10

### Attaching Front arms

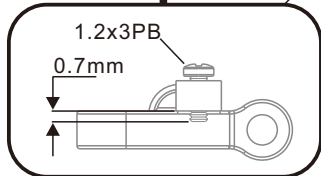
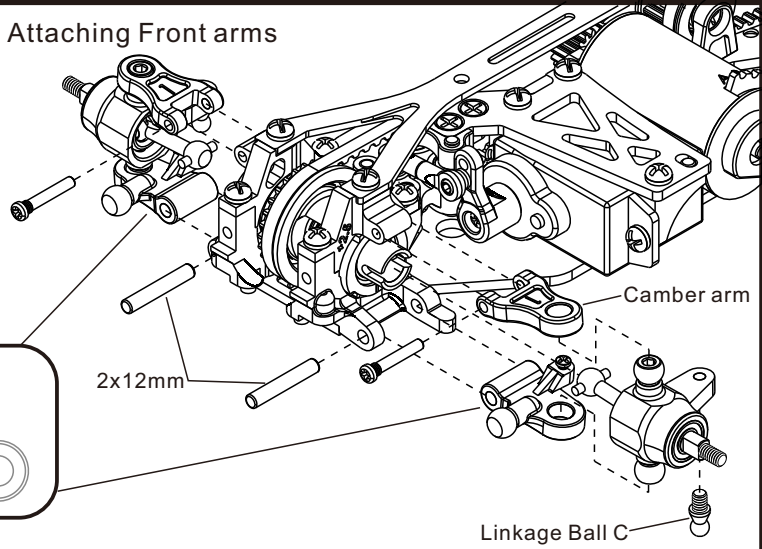

11

### Build 2 Sets

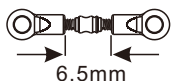

**Attention:**  
Installation direction

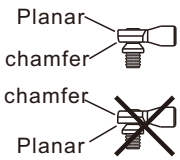

11

### Attaching Tie Rod

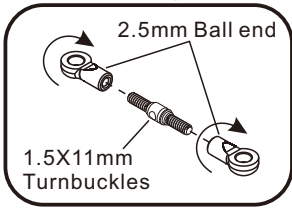
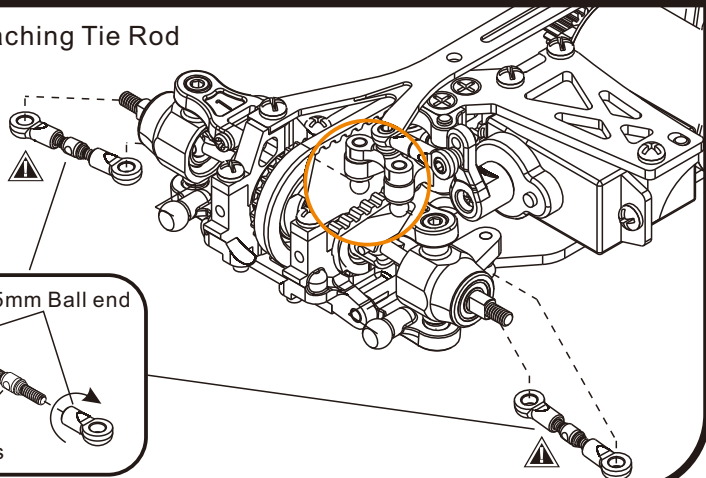



12

L/R

-  x2
-  x2
-  x2

## 12 Attaching Rear arms

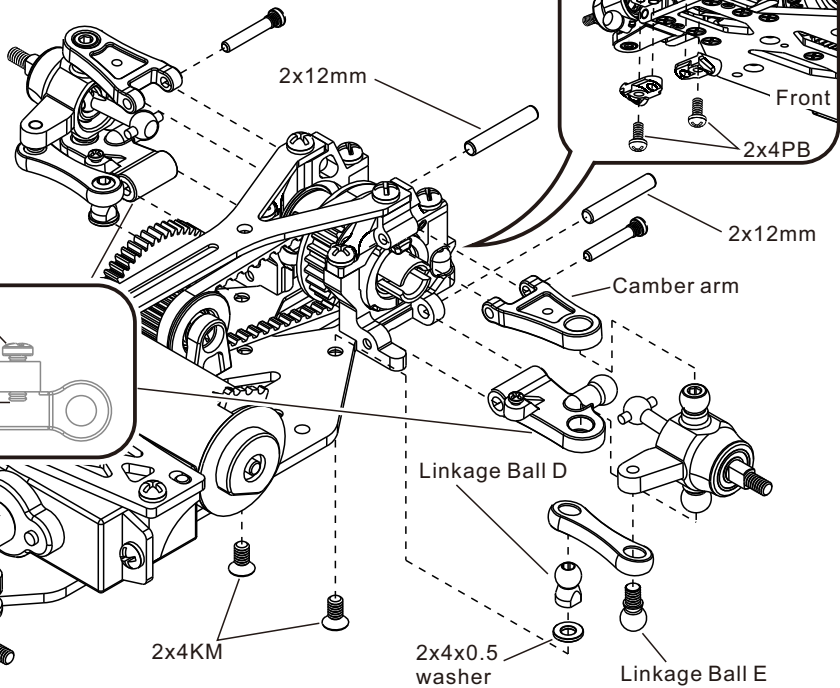



13

L/R

-  x4

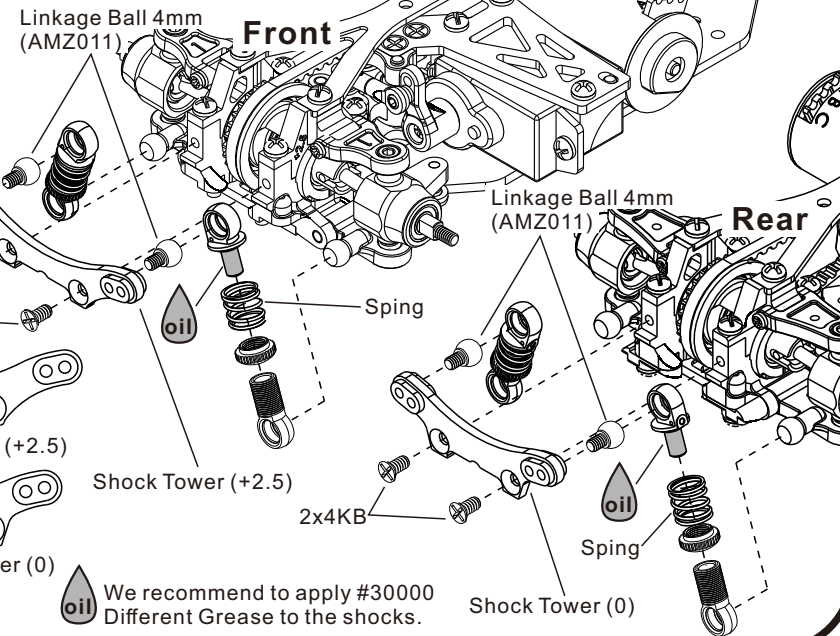
## 13 Attaching Grease shock



 We recommend to apply #30000 Different Grease to the shocks.



14



2x4KB

x3



2x4PB

x2

14

### Attaching other parts

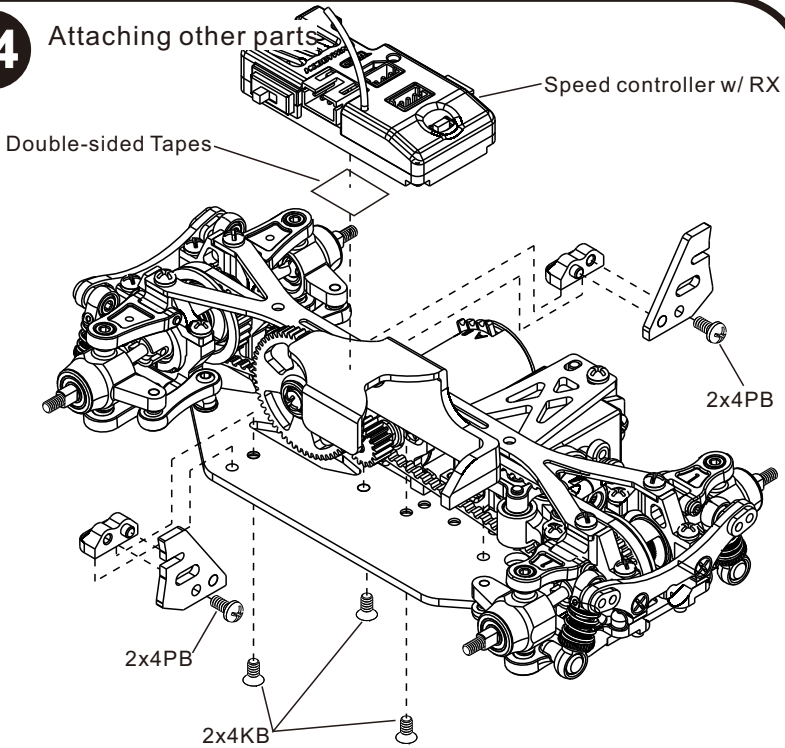

15



2x6KB

x2

15

### Attaching Front Body Mount

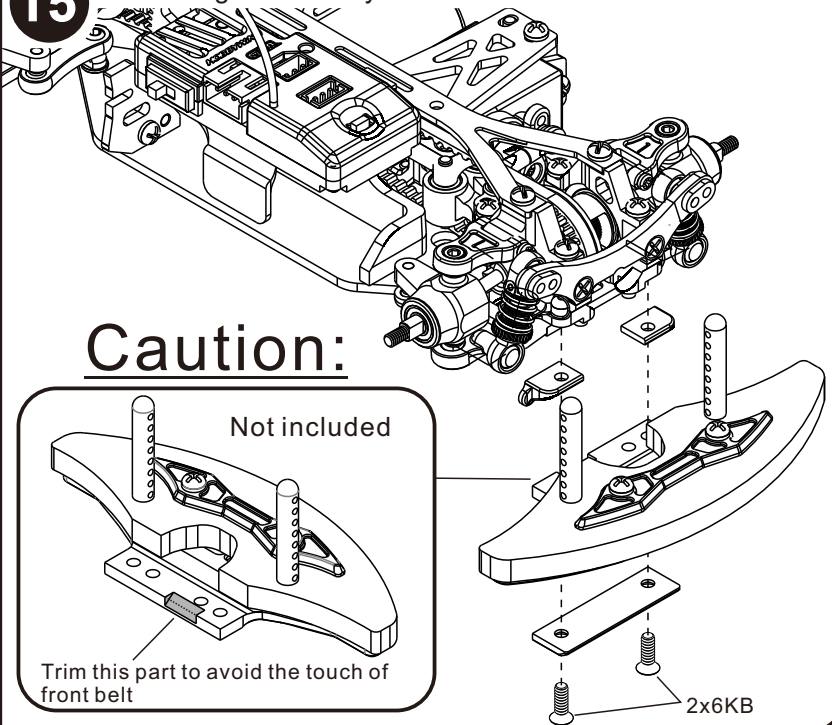

## Caution:

Not included

Trim this part to avoid the touch of front belt

Trim the front body mount a little bit to give space for the front belt.

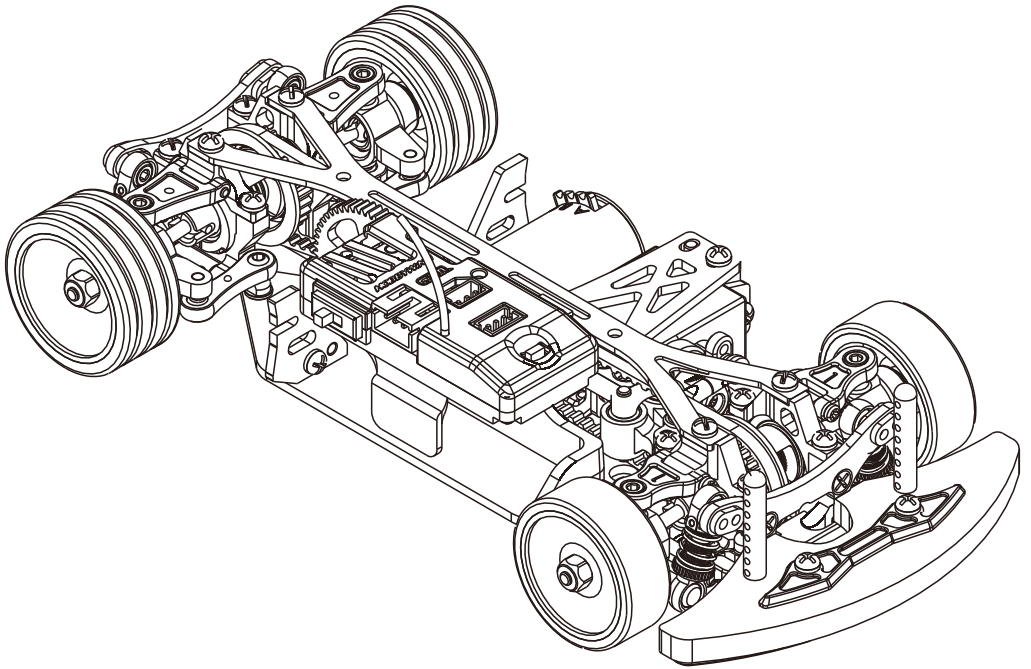

End of Assembly



[www.rcatomic.com](http://www.rcatomic.com)