

Setup Sheet

Conditions: high grip

Rev:1

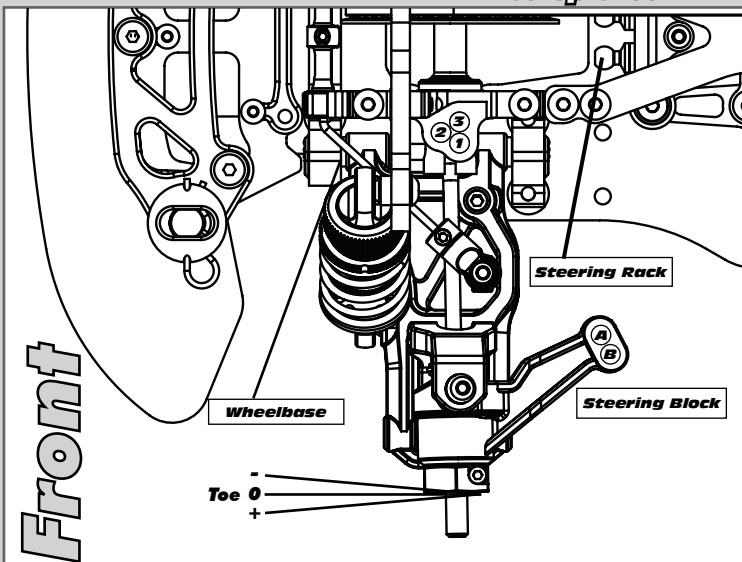

Front	Alignment	Rear
5,2mm	Ride Height	5,4mm
2°	Camber	2°
4°	Caster	N/A
1°	Toe	2,5°
5mm	Hex Width & Shims	5mm
1mm	Wheelbase	1mm
std.+1mm	Steering Rack Ball & Shims	N/A
B	Steering Block Position	N/A
std.+1mm	Steering Block Ball & Shims	N/A

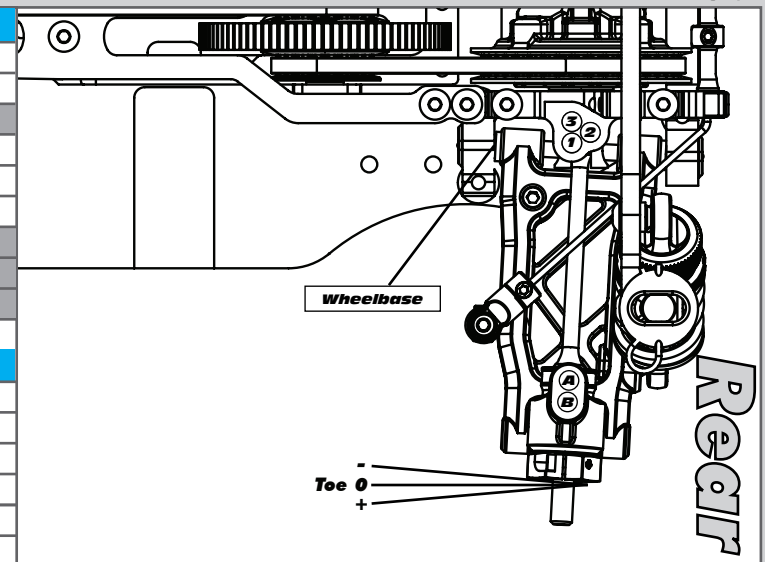

Notes:

Suspension Geometry		
3	Shock Position	3
1	Camber Link Position	1A
std.+2mm	Inner Ball & Shims	std.+1mm
std.+0mm	Outer Ball & Shims	std.+2mm
-2	Outer Arm Mount Insert	+2
1mm	Outer Mount Shims	1mm
-3	Inner Arm Mount Insert	+3
1mm	Inner Mount Shims	1mm
6,2mm	Droop	5,4mm
1,3mm	Anti-Roll Bar	1,2mm

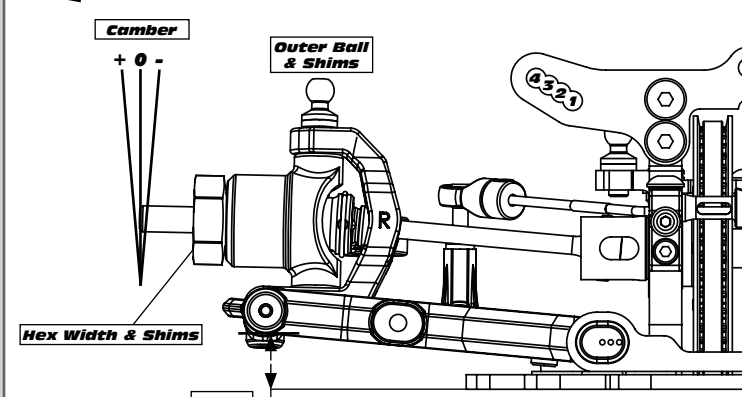

Notes:

Shocks		
37.5WT	Fluid	37.5WT
std.	Piston	std.
0mm	Rebound	0mm
Xray 2.7	Spring	Xray 2.6

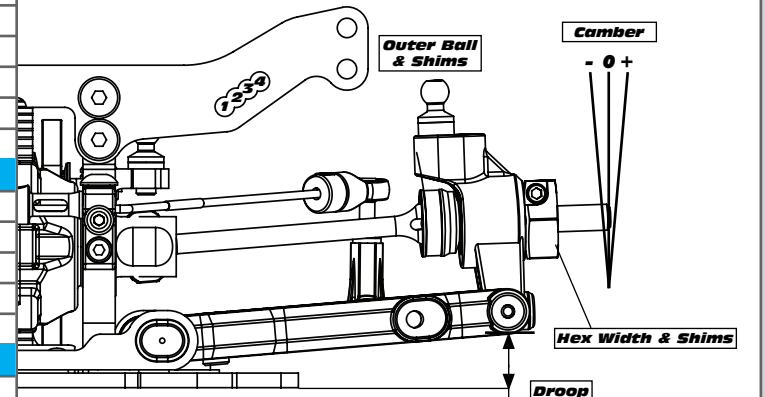

Notes:

Differentials		
Spool	Type	Diff
	Fluid	3K
	Diff Weight with Fluid	2g oil
mid-low	Cam Position	mid-low
	Belt Tension Number	

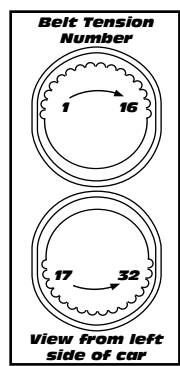
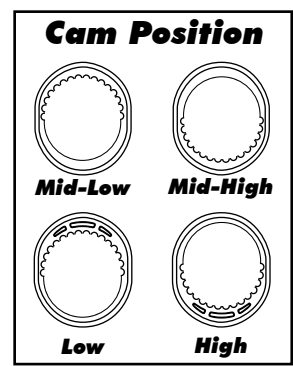
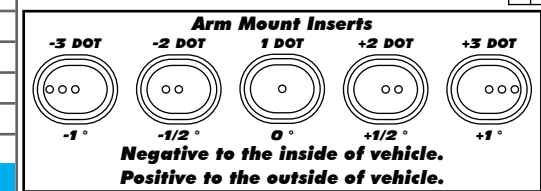

Notes:

Tires		
Vtec CPX V2	Type	Vtec CPX V2
	Tire Diameter	
	Insert & Wheel	
LRP carpet 3	Additive & Amount	LRP carpet 3

Notes: 20/10min, complete

Chassis		
	Type	carbon
	Top Plate:	no motorblock screw

Transmitter	Speed Control
Turning Circle:	E.S.C. Type: LRP Flow X
Steering Expo:	E.S.C. Settings:
Brake E.P. :	Software Version: Stock
Throttle Expo:	Notes:

Motor	Gearing
LRP X20 13.5T	99 / 45

Notes:

Battery		
	Battery Weight:	
	Battery Position:	

Notes: LRP 6400 HV

Body & Wing		
	Battery Weight:	HPI Mazda MPS light
	Battery Position:	