







NOTE :



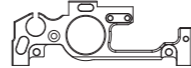

 =Apply Thread lock adhesive

 =Apply CA Glue

 =Apply Grease





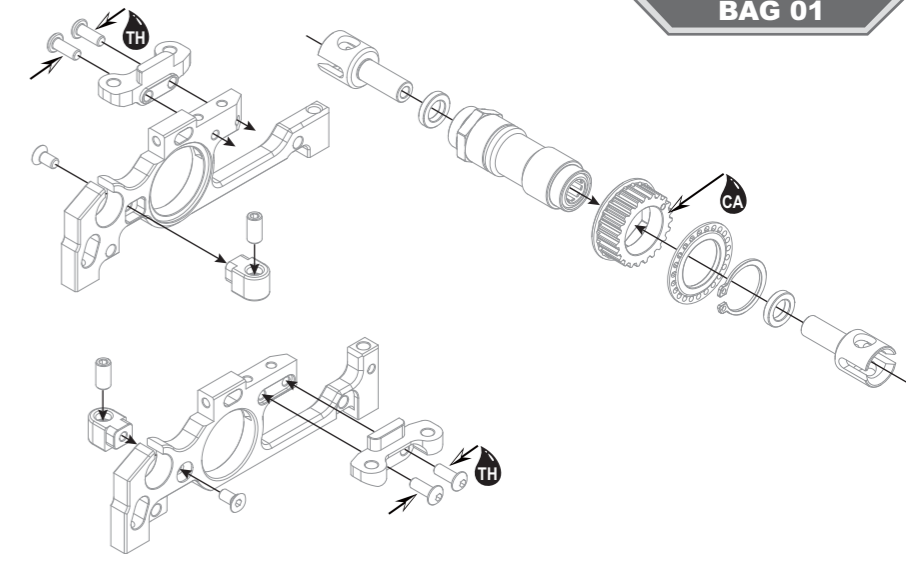

BAG 01

-  **R803059**
Front One Way Cup (2)
-  **R802019**
Front One Way
-  **R801111**
Pulley Set-Front
-  **R802020**
Front Upper Arm
Bracket Base
-  **R801104**
One Way Plastic
Shims (2)
-  **R802004**
Front Alu-Bulkhead-L
-  **R802005**
Front Alu-Bulkhead-R
-  **R801020**
Downstop Nut Holder (2)

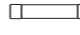
-  **R105105**
3x8 Round Screw
-  **R105203**
3x6mm Flat Screw
-  **R805052**
4x8mm Set
-  **R805041**
14mm Ring Clip (6)







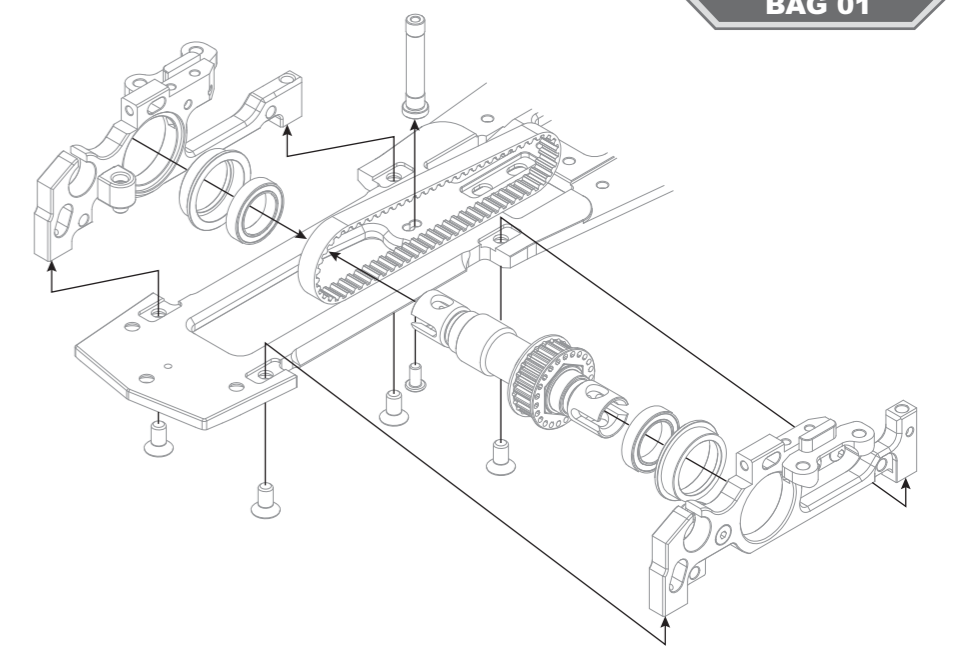

BAG 01

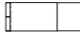
-  **R801042**
Bearing Bushing
-Front One Way (2)
-  **R803040**
Servo Saver Base Post
-  **R804033**
Front Belt 204
-  **R802202**
R8.0E Main Chassis
-  **R806020**
12x18x4mm
Ball Bearing (4)
-  **R105104**
3x6 Round Screw
-  **R805201**
4x8mm Flat Screw



BAG 01

-  **R802110**
Servo Saver Tower
-  **R802008**
Servo Saver Alu
-  **R807010**
Servo Saver Spring
-  **R801108**
Ackermen Adjustment
Shims (2) 0/+1.5
-  **R808010**
Ackermen Plate 8.5mm
Carbon
-  **R105104**
3x6 Round Screw
-  **R106010**
5x8x2.5mm
Ball Bearing (2)

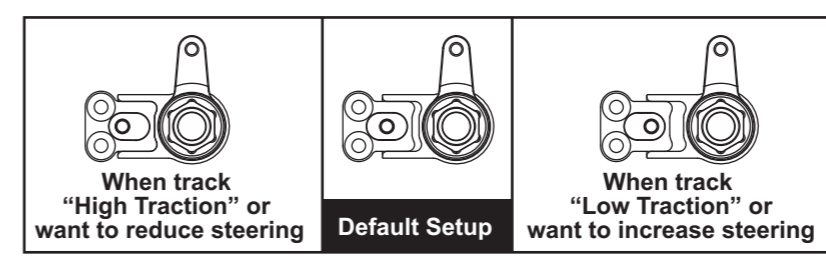
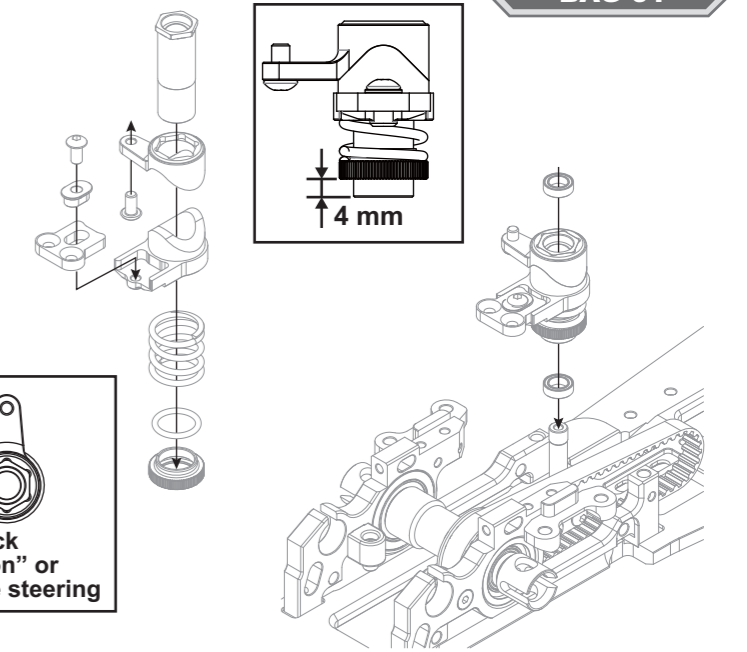

BAG 01

- R801090** Ball End 5.8mm Short (2)
- R803015** Anti Roll Bar Ball Screw (2)
- R803014** Anti Roll Bar Ball Head (2)
- R802041** Front Shock Mount S (2)
- R801015** Front Low Arm Set

- R105104** 3x6 Round Screw
- R105105** 3x8 Round Screw
- R105101** 2x5mm Cap Screw

BAG 02

- R805104** 4x12 Round Screw
- R805102** 4x8 Round Screw
- R801021 (Optional)** Front Low Arm Holder (4)
- R801022** Front Low Arm Holder +2mm (4)
- R802006** Front Upper Arm Bracket
- R803031** Front Low Arm Pin 3x77.8
- R801094** Spacer 1mm/2mm/3mm

Default Setup

- R801022 (Optional)** Front Low Arm Short
- R802041 (Optional)**
- R801021** Front Low Arm Long
- R802042** Front Shock Mount L

Can increase steering best for low traction track.

BAG 02

- R801072** Front Upper Arm (2)
- R803033** Front Upper Arm Pin 3x49 (2)
- R801023** Suspension Bracket Insert-Open (8)
- R801094** Spacer 3mm+2mm+1mm
- R105401** 3x3mm Set

Default

- Front Upper Arm Short**
- Front Upper Arm Medium**
- Front Upper Arm Long**

BAG 02

- R801055** Steering Block
- R802086** 7.9mm Ball End Long-Alu (2)
- R802045** Front Steering Plate (2)
- R803062** Front CVD Shaft (2)
- R803063** Front Wheel Axle (2)
- R802032** Front Tire Hook (2)
- R807004** Tire Hook Spring (4)
- R803064** CVD Insert (2)
- R804003** 7.9mm Ball End Nut (4)

- R105104** 3x6 Round Screw
- R105401** 3x3mm Set
- R806100** Ø2.5x11.8 Pin (6)
- R806101** Ø3x19.8 Pin (6)
- R806020** 12x18x4mm Ball Bearing (4)
- R803051** 12.1x15x0.5mm (10)

BAG 02

- R803016** Ball Head 4.9mm (4)
- R101070** Ball Joint 4.9mm Open (4)
- R803035** 3mmX62mm Rod (2)

BAG 02

- R105202** 3x5mm Flat Screw
- R105104** 3x6 Round Screw

Default Position

49.5 mm

BAG 02

R808002
Front Shock Tower



R105105
3x8 Round Screw

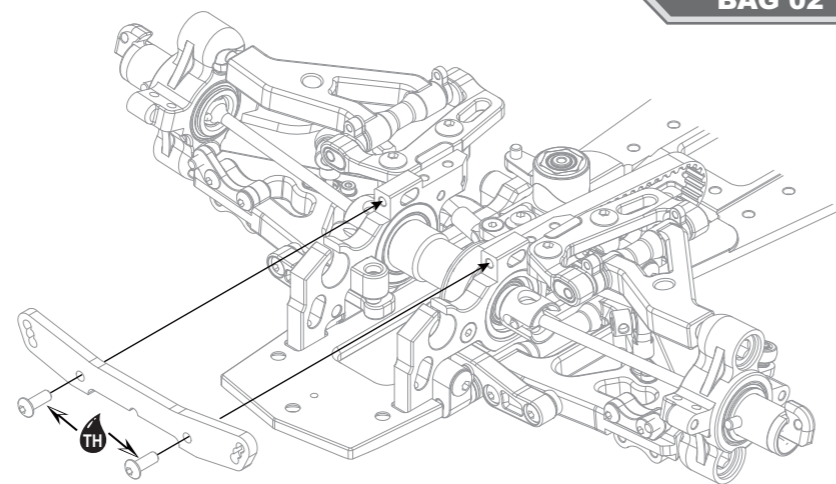

BAG 02

R803013

Anti Roll Bar Stopper (2)



R801046

Anti-Roll Bar Bushing -Front (2)



R807015

Front Anti-Roll Bar 2.2mm



R106010

5x8x2.5mm
Ball Bearing (4)



R105401

3x3mm Set

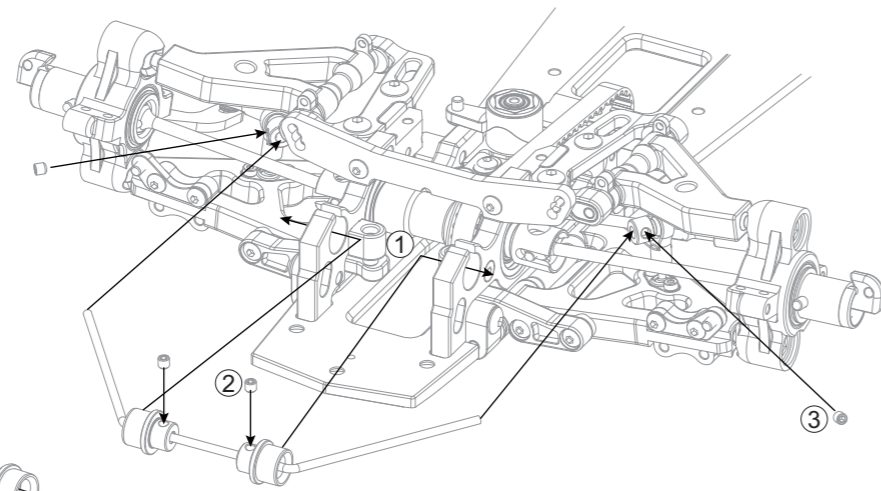

BAG 03



R801113
Pulley Set-Rear

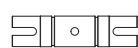

R803010
Rear Solid Axle



R805040
12mm C Clip (6)



R802060
Rear Low Arm Brackets RF



R802021
Rear Bulkhead Low



R801024
Suspension Bracket
Insert-Closed (8)



R805201
4x8mm Flat Screw



R105204
3x8mm Flat Screw

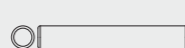

R806101
Ø3x19.8 Pin (6)

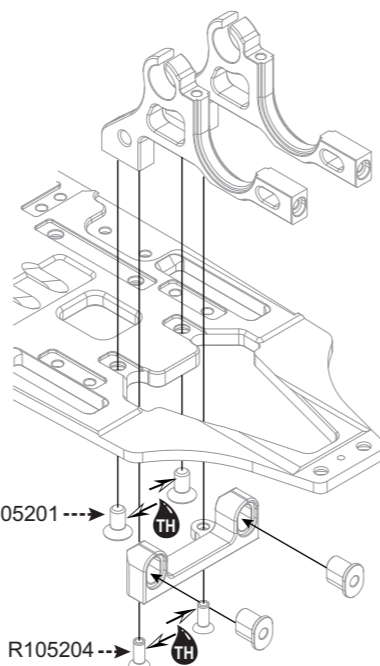
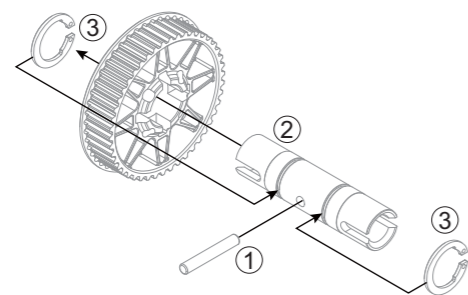

R805201

R105204



HIGH Roll Center

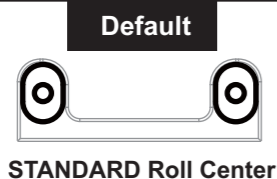

STANDARD Roll Center



LOW Roll Center

BAG 03



R804031
Rear Belt 201-8



R801040
Excenter Bushing Solid Axle (2)



R806020
12x18x4mm
Ball Bearing (4)

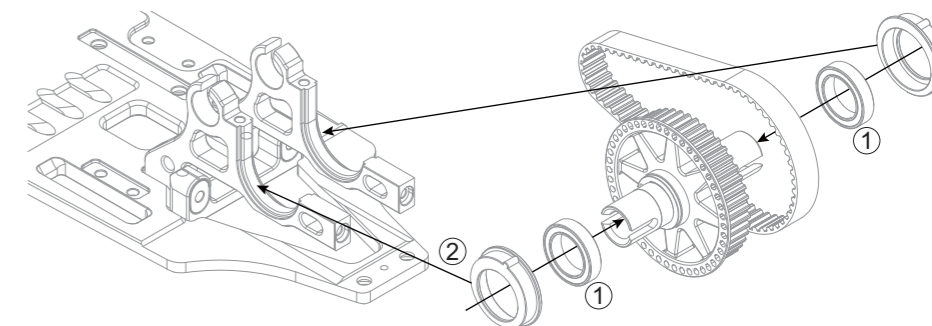

BAG 03



R808006
Rear Upper Link Plate



R808003
Rear Shock Tower



R802022
Rear Bulkhead Upper



R105204
3x8mm Flat Screw



R105106
3x10 Round Screw

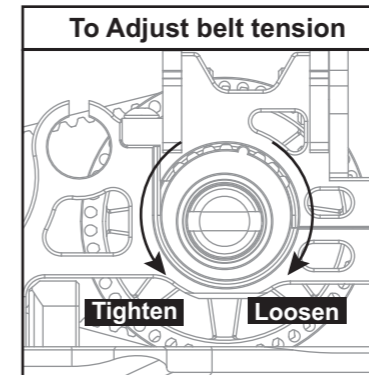

To Adjust belt tension

Tighten

Loosen

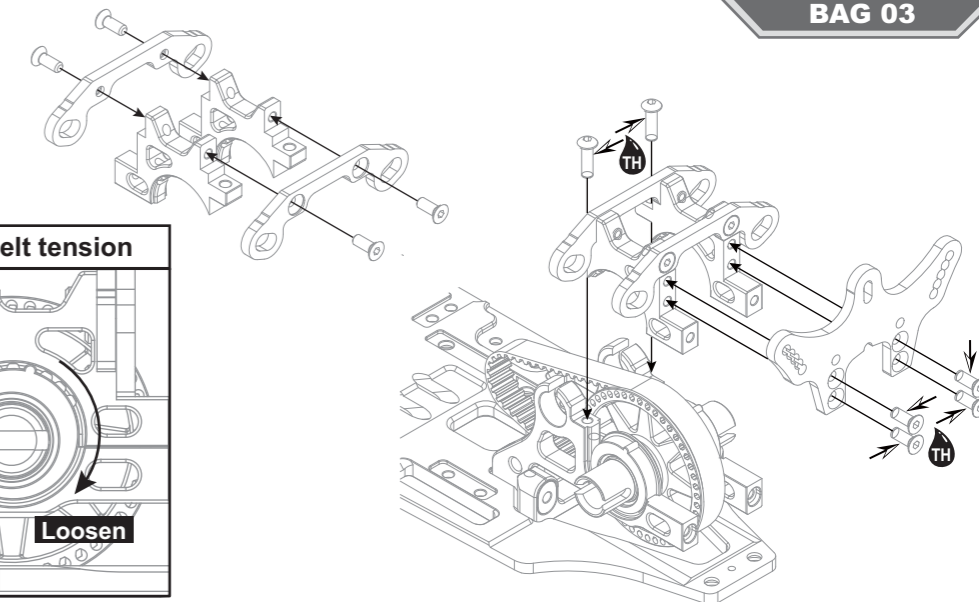

BAG 03



R801010
Rear Low Arm



R802061
Rear Low Arm Brackets RR



R802044
Rear Shock Mount S (2)



R803032
Rear Low Arm Pin (2)



R105104
3x6 Round Screw



R105105
3x8 Round Screw



R805201
4x8mm Flat Screw

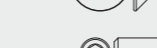

R805053
4x10mm Set

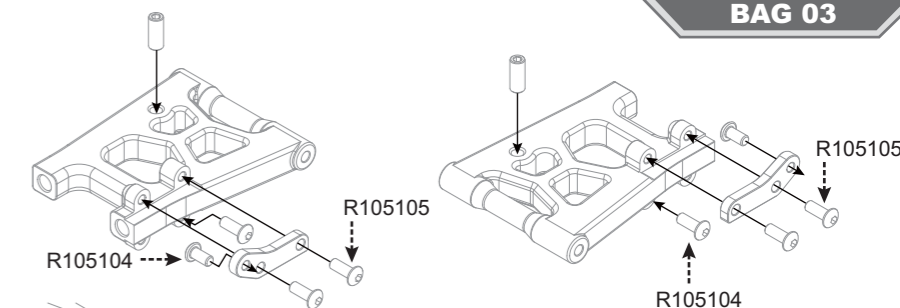

R105104

R105105

R105104

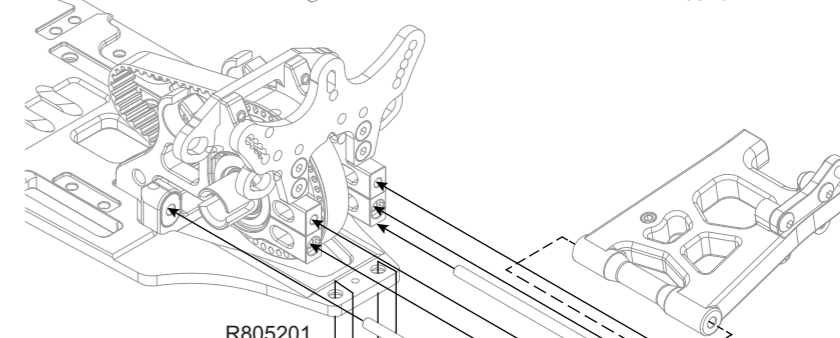

R805201

R105105

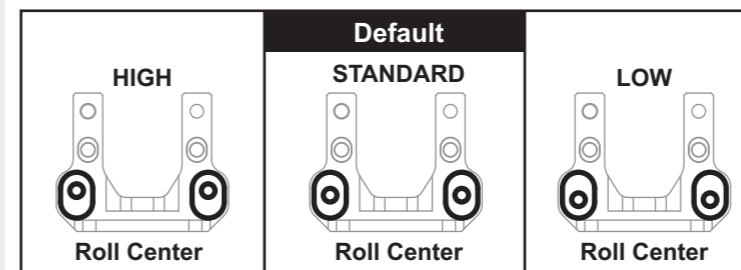

HIGH

Default

LOW



HIGH Roll Center



STANDARD Roll Center



LOW Roll Center

BAG 03

- R807021**
Rear Anti-Roll Bar
2.6mm
- R801047**
Anti-Roll Bar Bushing -Rear (2)
- R803013**
Anti-Roll Bar Stopper (2)
- R803019**
Anti-Roll Bar Adj Screw (2)
- R801092**
Rear Anti-Roll Bar Ball End (2)
- R803016**
Ball Head 4.9mm (4)
- R101070**
Ball Joint 4.9mm Open (4)
- R803102**
Anti-Roll Bar Tool

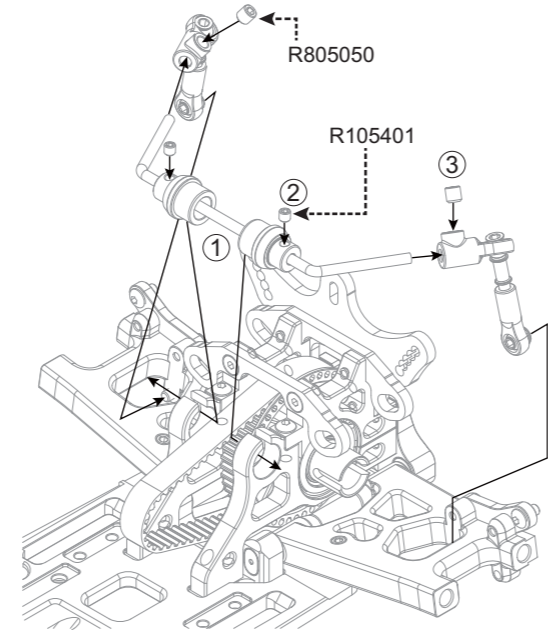
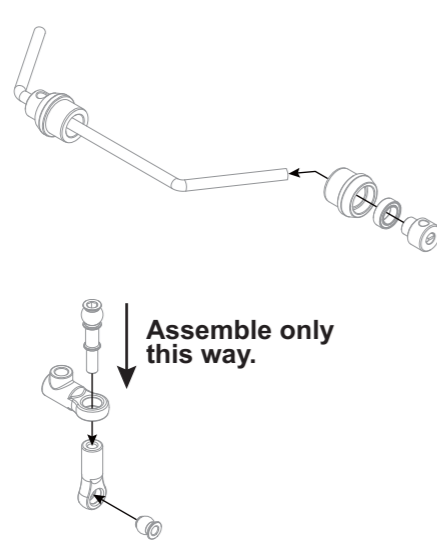

Use R803102 to adjust rear anti roll bar balance.

Set the angle of the roll bar ball end as above.

Centre the anti roll bar so that the spacing is equal on both sides.

- R106010**
5x8x2.5mm
Ball Bearing (2)
- R105401**
3x3mm Set
- R805050**
4x4mm Set

BAG 04

- R801093**
Rear Upper Arm Set
- R803024**
Ball Head 6.8mm (2)
- R803037**
4mmx17mm Turnbuckle (2)
- R801023**
Suspension Bracket Insert-Open (8)
- R803038**
Rear Upper Arm Pin 3x32.5 (2)
- R105401**
3x3mm Set

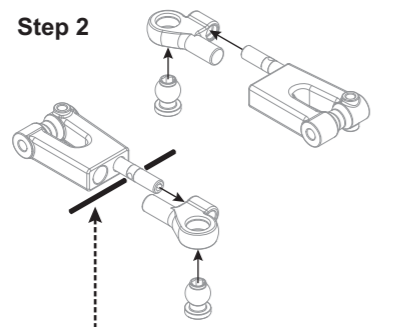
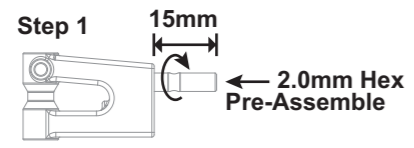

Use 1.5mm Steel bar to turn the turnbuckle
PS:DO NOT OVER TIGHT THE UPPER ARM BY 2.0mm HEX TOOL

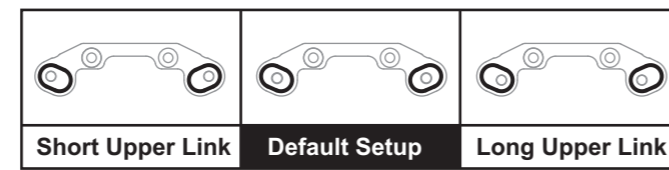
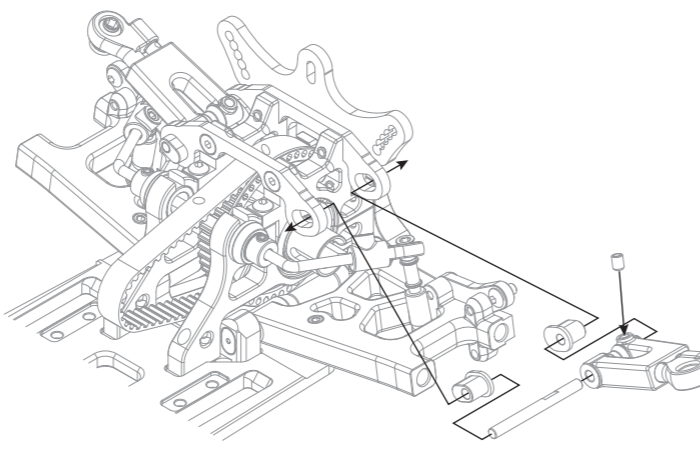

Short Upper Link Default Setup Long Upper Link

BAG 04

- R802033**
Rear Tire Hook (2)
- R807004**
Tire Hook Spring (4)
- R804003**
7.9mm Ball end Nut (4)
- R802085**
7.9mm Ball End Short-Alu (2)
- R801050**
Rear Upright
- R803060**
Rear Wheel Axle (2)
- R801043**
Excenter Rear Upright Bushing +1mm (x4) +0mm (x4)

ECCENTER HUB

Up 1mm	Center (Default Setup)	Low 1mm

- R803050**
12.1x15x0.3mm (10)
- R806020**
12x18x4mm
Ball Bearing (4)
- R803051**
12.1x15x0.5mm (10)
- R105401**
3x3mm Set
- R806101**
Ø3x19.8 Pin (6)
- R805307**
3x16 Set Screw (6)

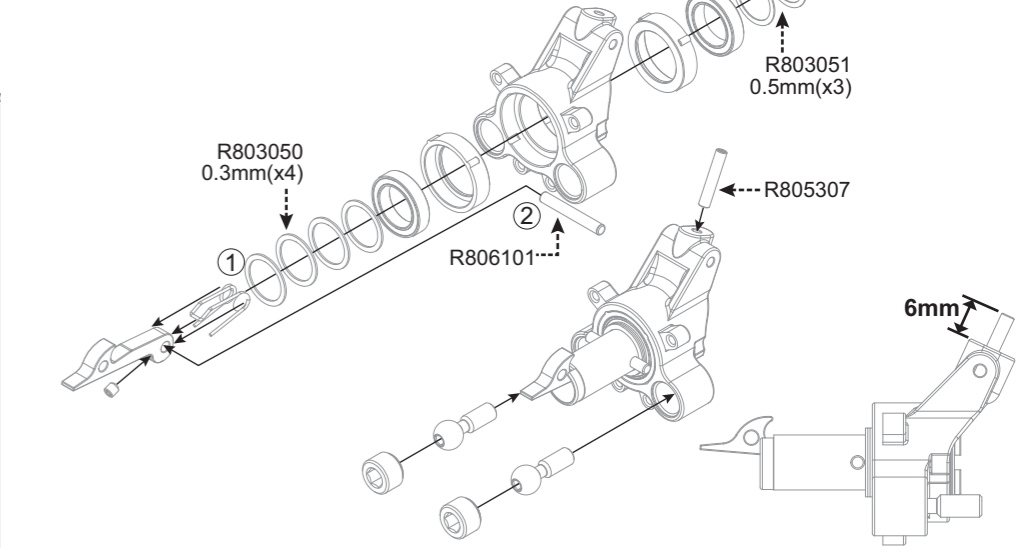

BAG 04

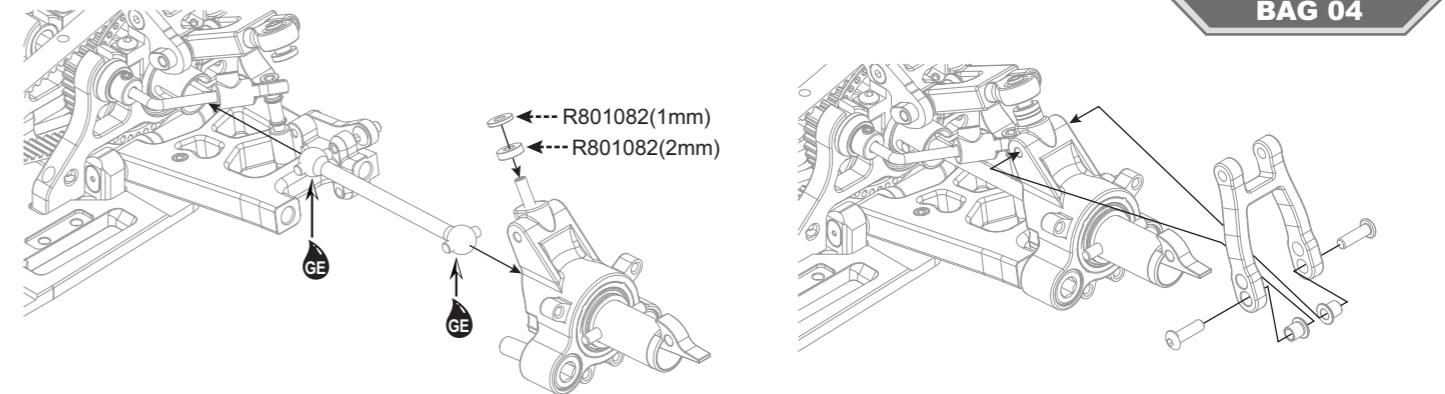

- R801070**
Rear Body Mount Arm (2)
- R802083**
Rear Drive Shaft-Alu (2)
- R103007**
Steering Block Bushing (4)
- R801082**
3x7x1mm Shims (2)
3x7x2mm Shims (2)
- R105106**
3x10 Round Screw

- R801071**
Rear Body Mount
- R808007**
Rear Body Mount Plate
- R803042**
Rear Body Mount Nut
- R803039**
Rear Body Mount Pin 3x19.5 (2)

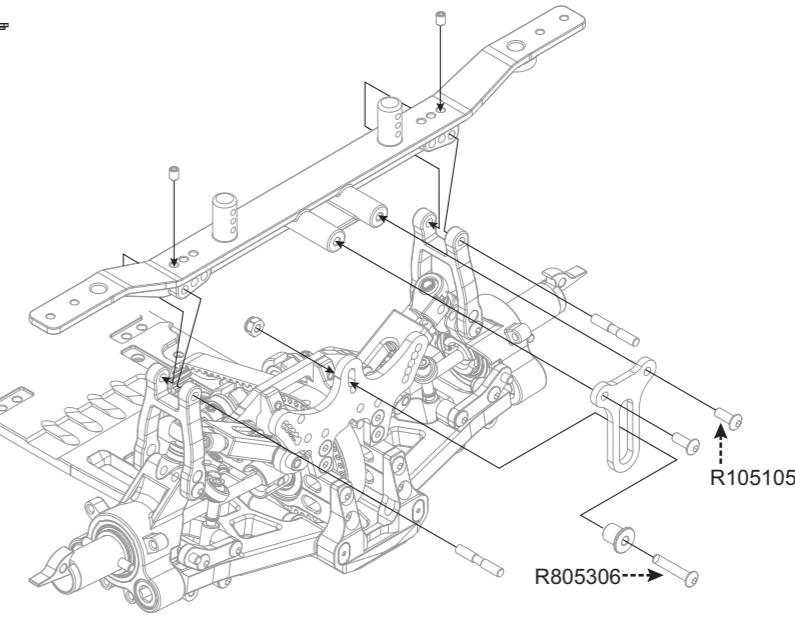

BAG 04

- R105109**
3x16 Round Screw
- R105105**
3x8 Round Screw
- R105150**
3mm Nylon Nut
- R105401**
3x4mm Set

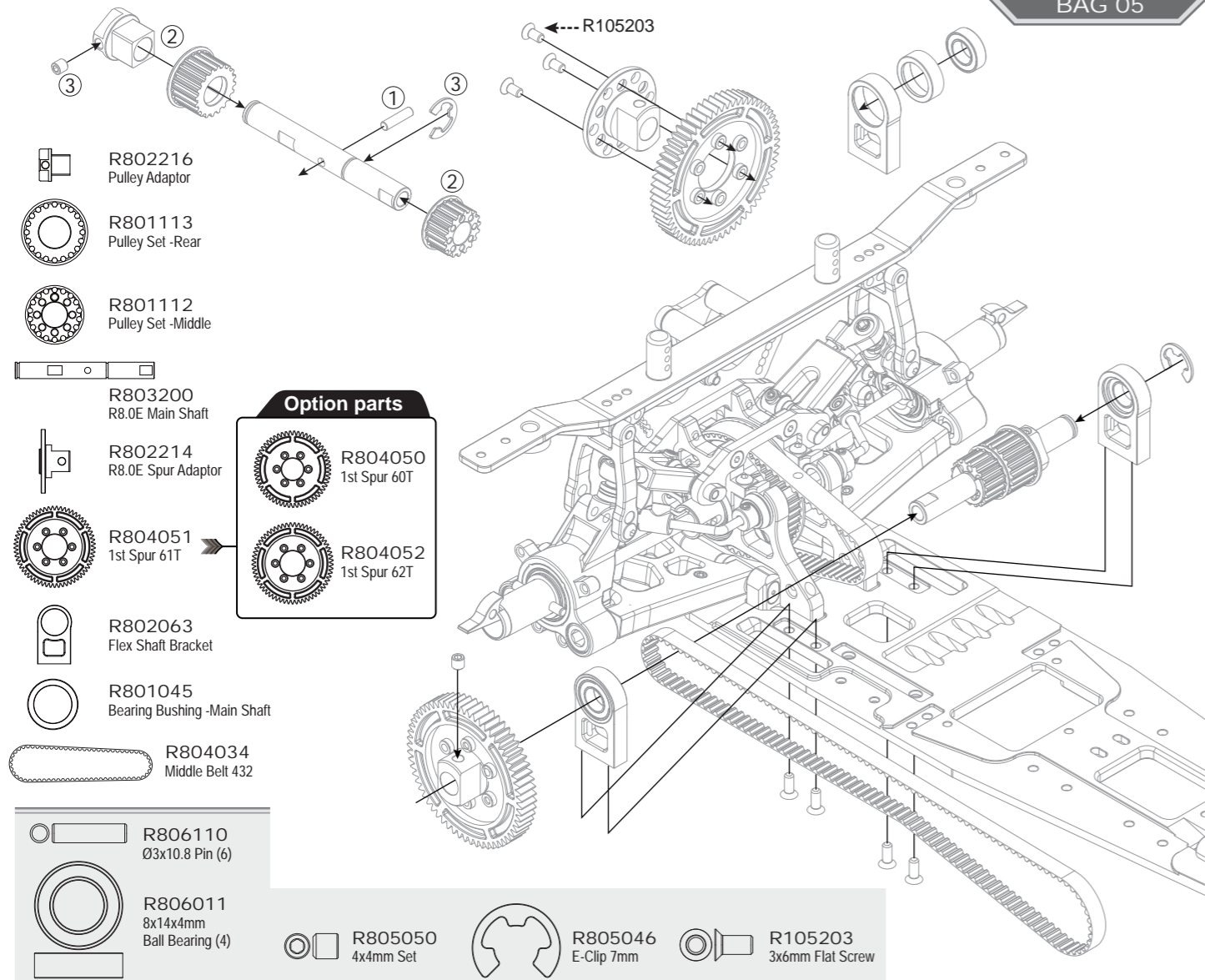

- R802210**
R8.0E Motor Bulkhead
- R802011**
Center Bulkhead

- R105204**
3x8mm Flat Screw
- R805201**
4x8mm Flat Screw

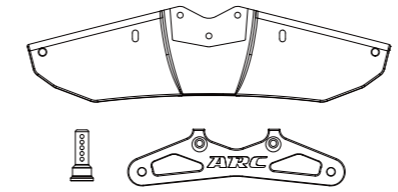
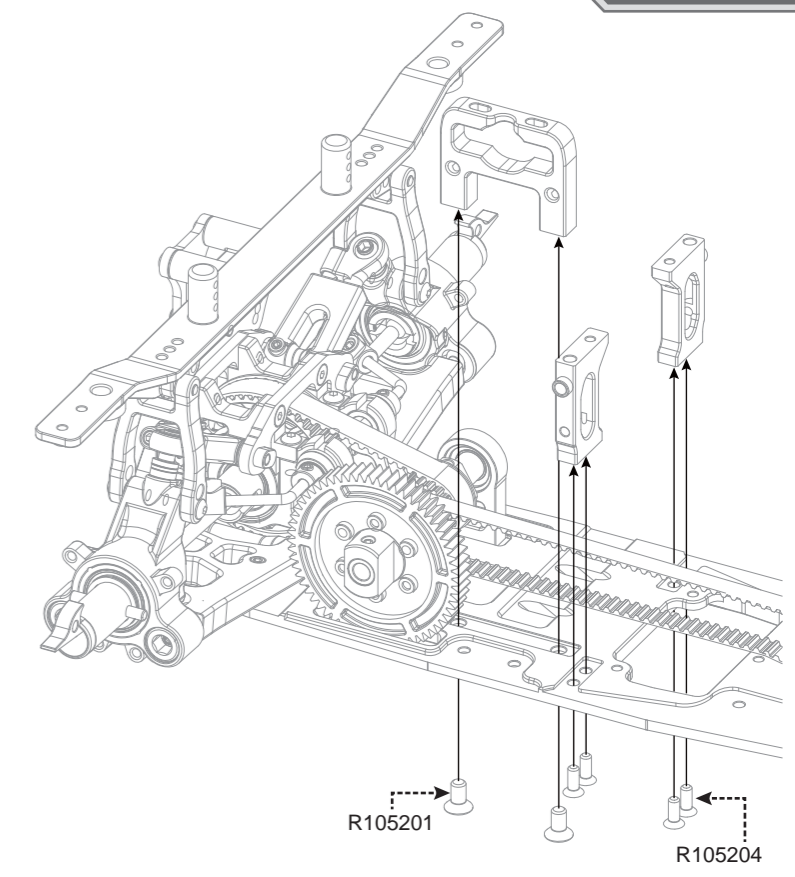

R801060
R 8.0 Bumper/Body Tower Set

- R805302**
4mm
- R805102**
4x8 Round Screw
- R805203**
4x12mm Flat Screw

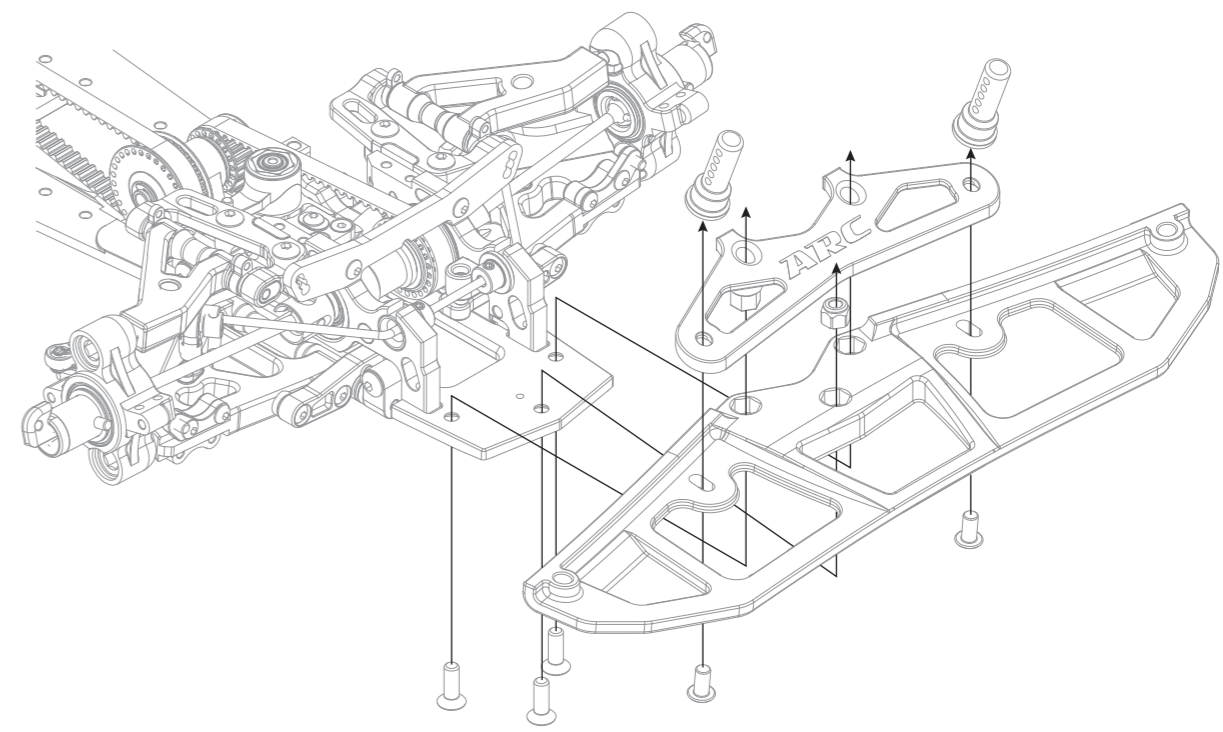

- R801111**
Pulley Set-Front
- R802213**
R8.0E Middle Shaft Block
- R801112**
Pulley Set-Middle
- R803201**
R8.0E Middle Shaft

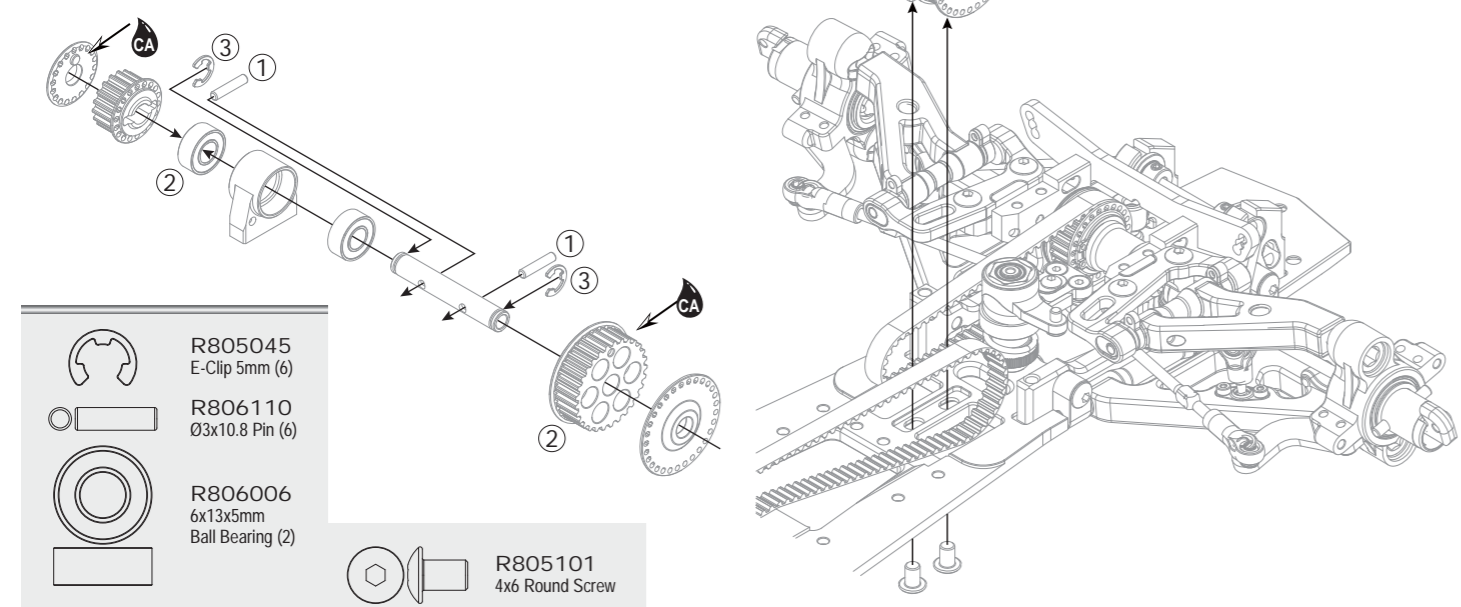

BAG 05

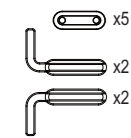

R801210
Battery Mount

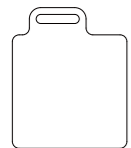

R808104
ESC Holder

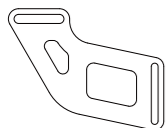

R808103
Battery Holder Carbon (2)



R105106
3x10 Round Screw

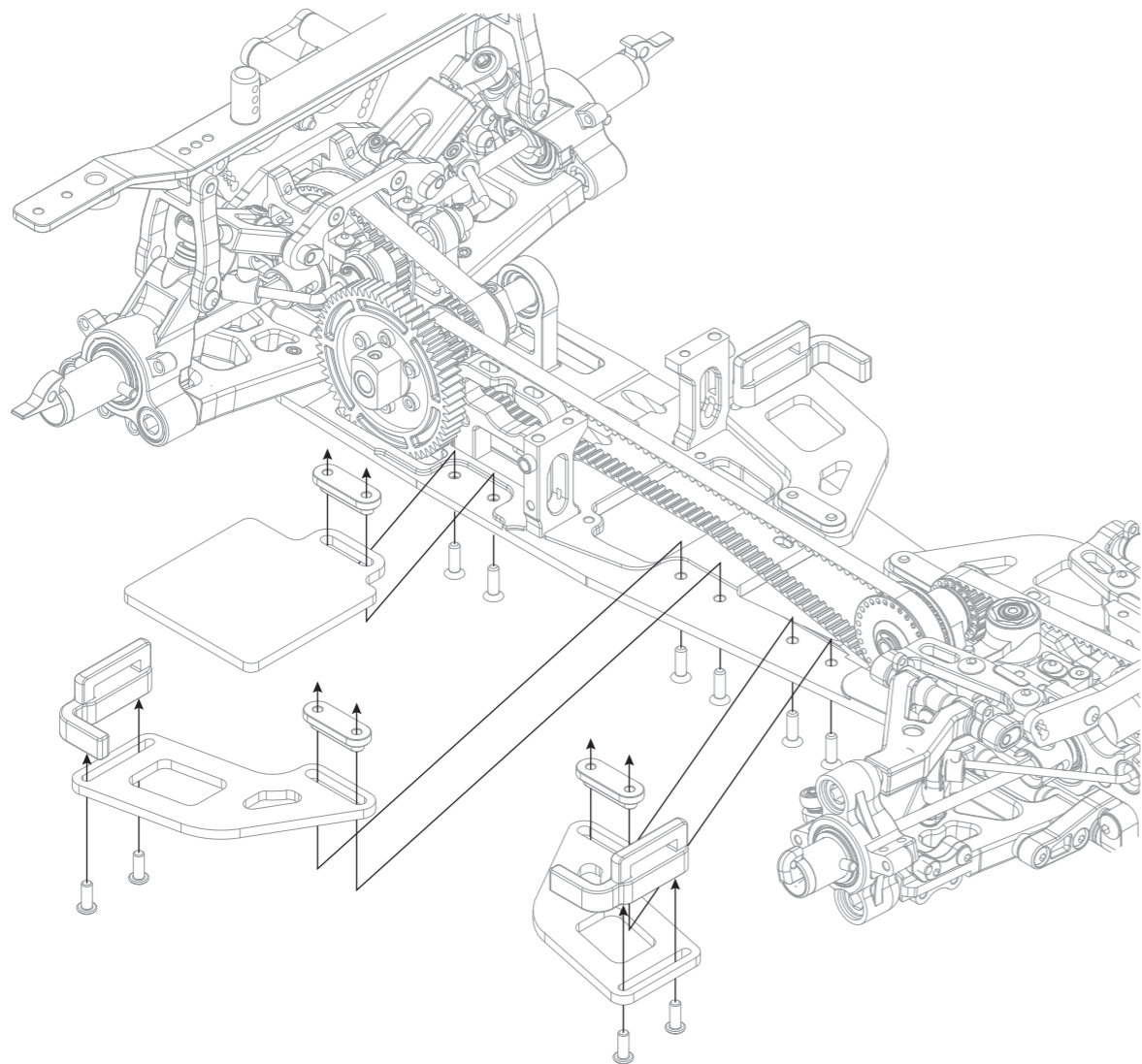

BAG 06

R101040
Shock Ball Joint Set

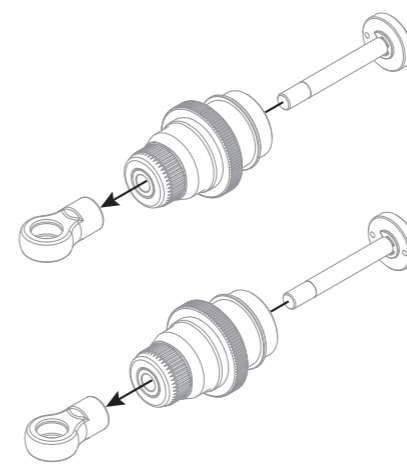

#500

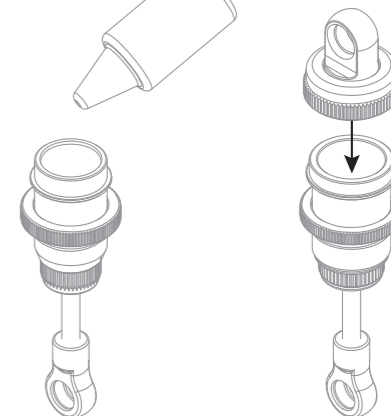

BAG 06



R101040
Shock Ball Joint Set



R103009
5.8mm Ball End (4)



R103027
5.8mm Ball End Short (4)



R807052
Shock Spring Front (Yellow)



R807062
Shock Spring Rear (Blue)

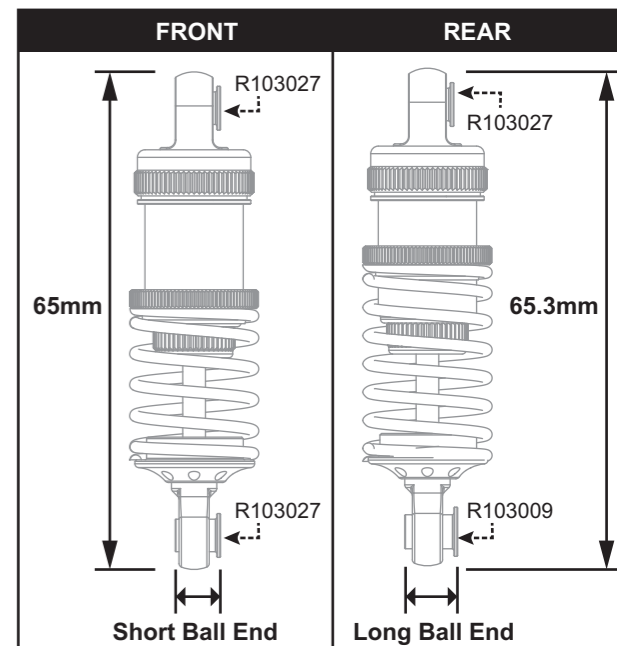
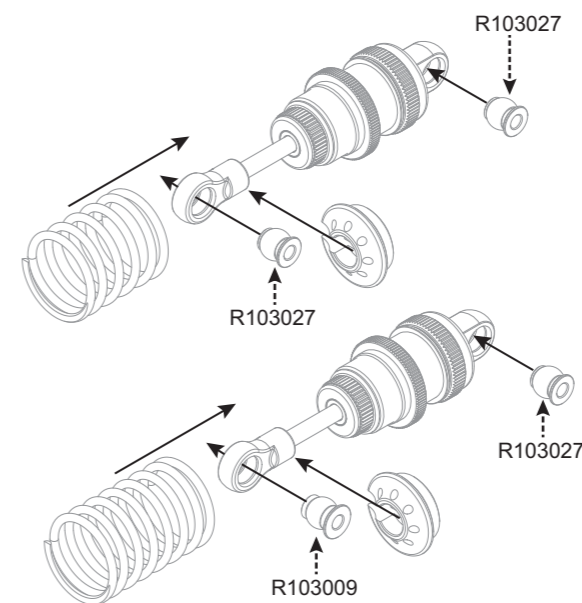

BAG 06

- R104021**
Shock Piston Big Bore Long 1.1mm x2 (4)
- R104022**
Shock Piston Big Bore Long 1.1mm x1 (4)
- R103013**
Shock Shaft (2)
- R102008**
Shock Cap Alu (2)
- R104013**
O-ring 13x1 (4)
- R101040**
Shock Ball Joint Set
- R102009**
Shock Low Cap Alu (2)
- R102010**
Shock ADJ Nut Alu (2)
- R104002**
O-ring 3x2 (4)

- R104007**
Shock Membrane (4)
- R102068**
Shock Body Long (2)
- R104015**
Shock Shaft Shim (4)
- R105501**
E-Clip 2mm (10)

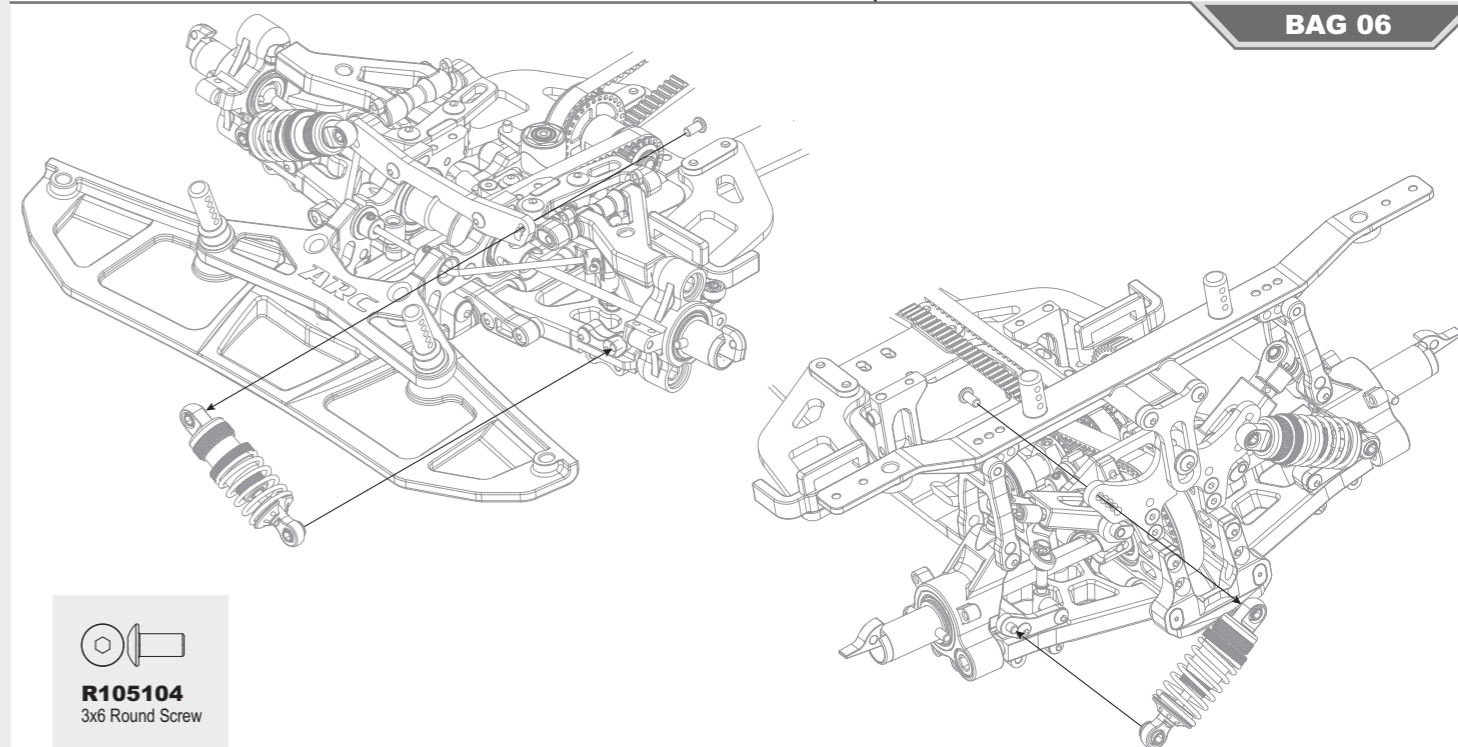
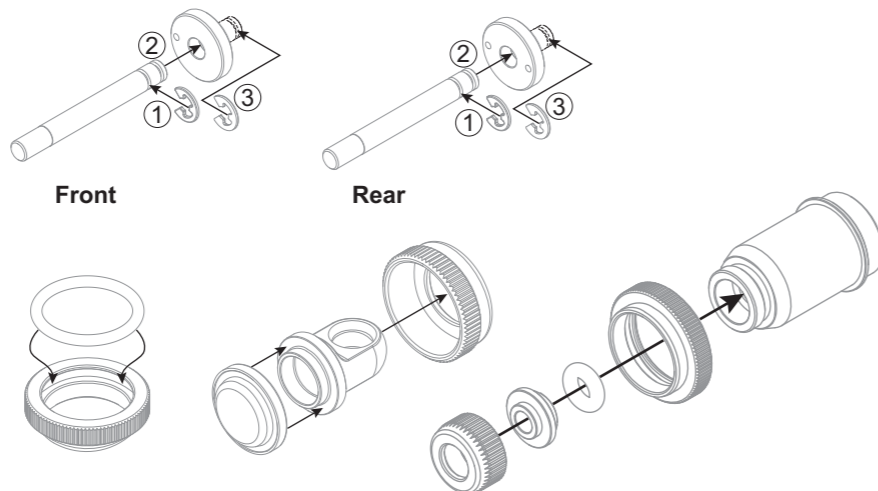

R105104
3x6 Round Screw

BAG 06

R802212
R8.0E Servo Holder-Alu

R808106
R8.0E Belt Tensioner Plate

R802050
Belt Tensioner Shaft (2)

R105104
3x6 Round Screw

R105105
3x8 Round Screw

R805108
3x14 Round Screw



R806005
5x10x4mm

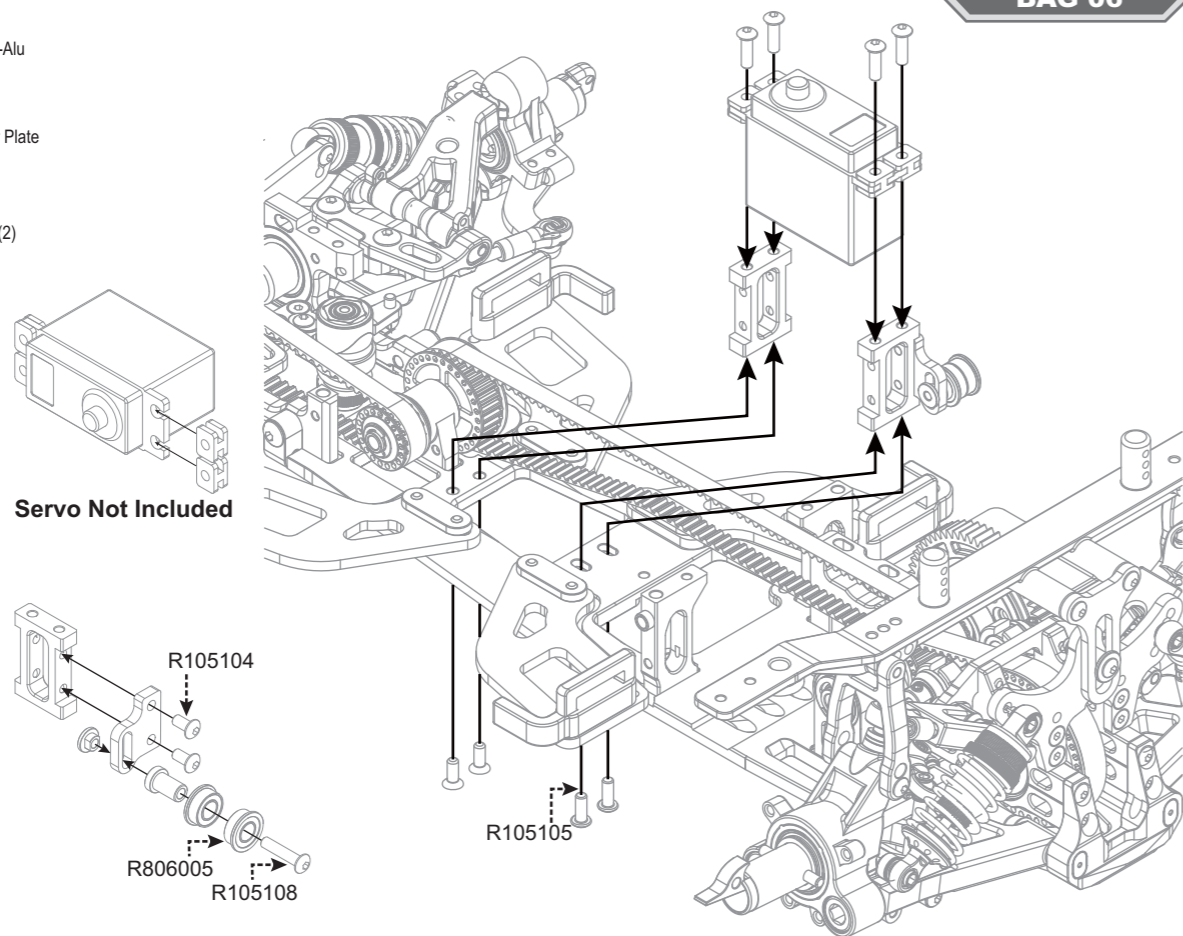

Servo Not Included

R105104

R806005
R105108

R105105

BAG 07

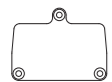

R808105
R8.0E Receiver Holder



R105202
3x5mm Flat Screw

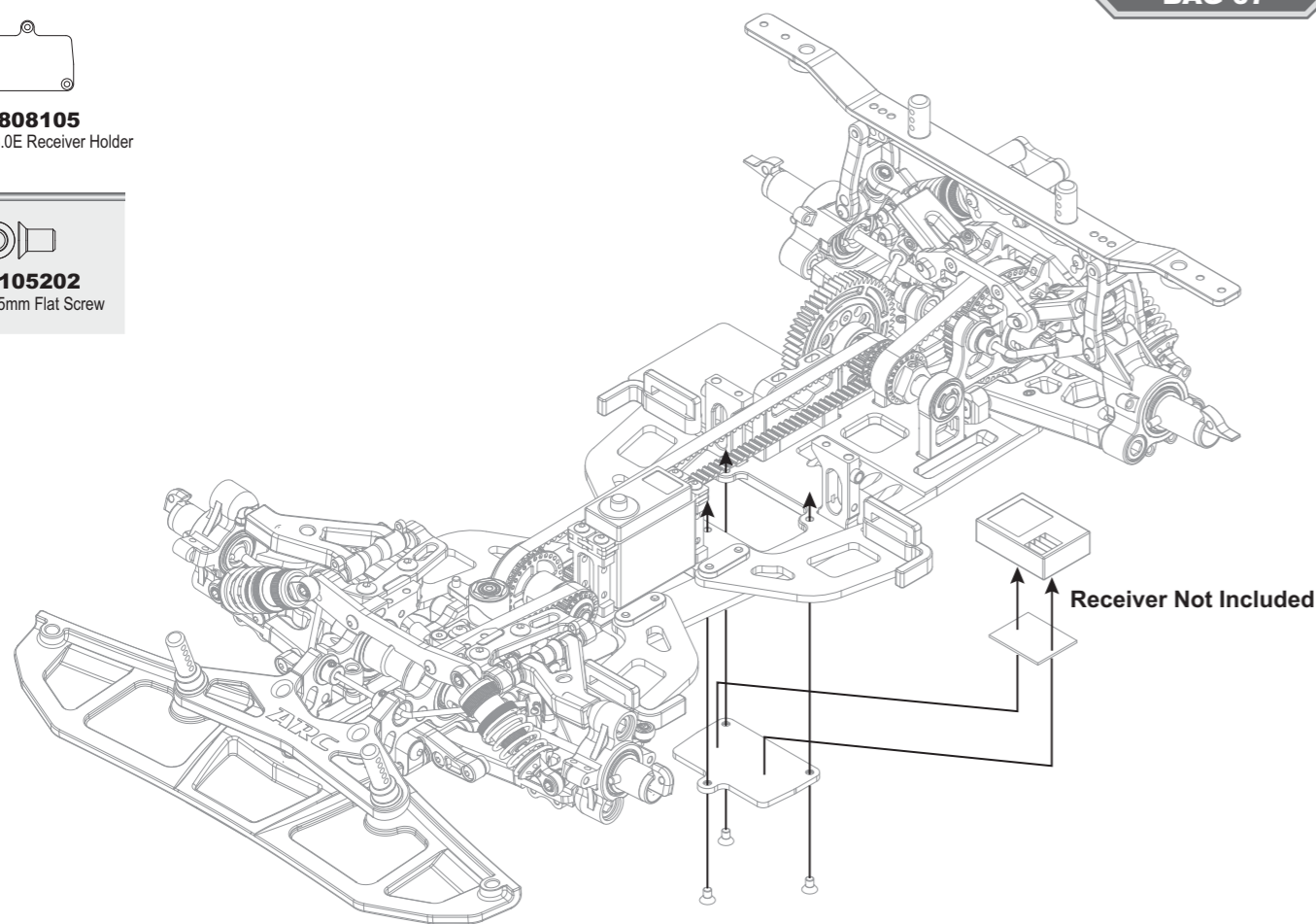

Receiver Not Included

BAG 07

R802211
R8.0E Motor Adaptor

R805050
4x4mm Set



R105302
3x10mm

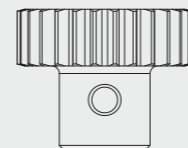

R802221
R8.0E Pinion 27T

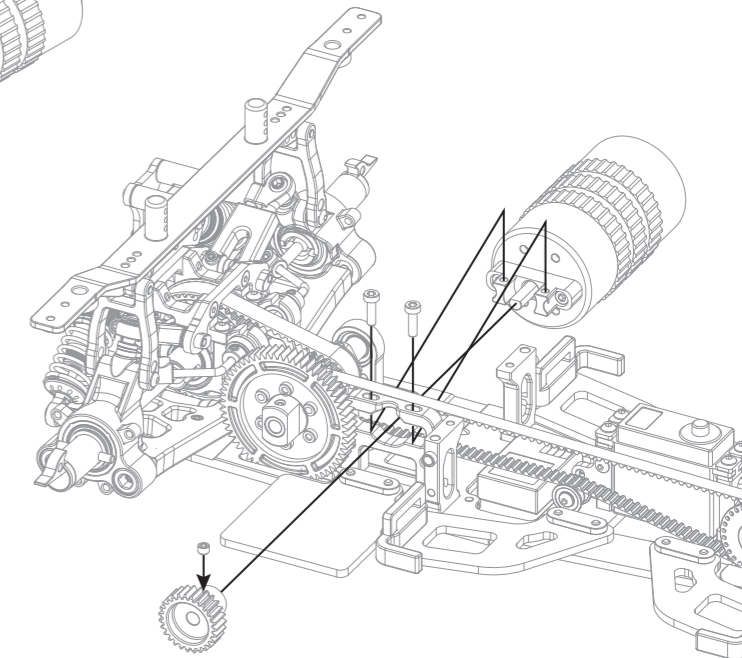
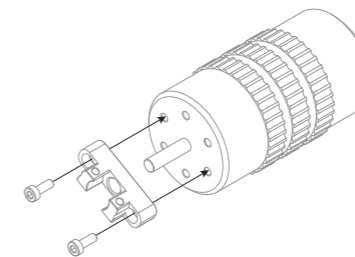

Option parts

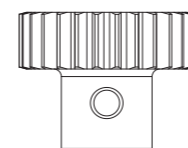

R802220
R8.0E Pinion 26T

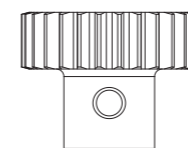

R802222
R8.0E Pinion 28T

BAG 07

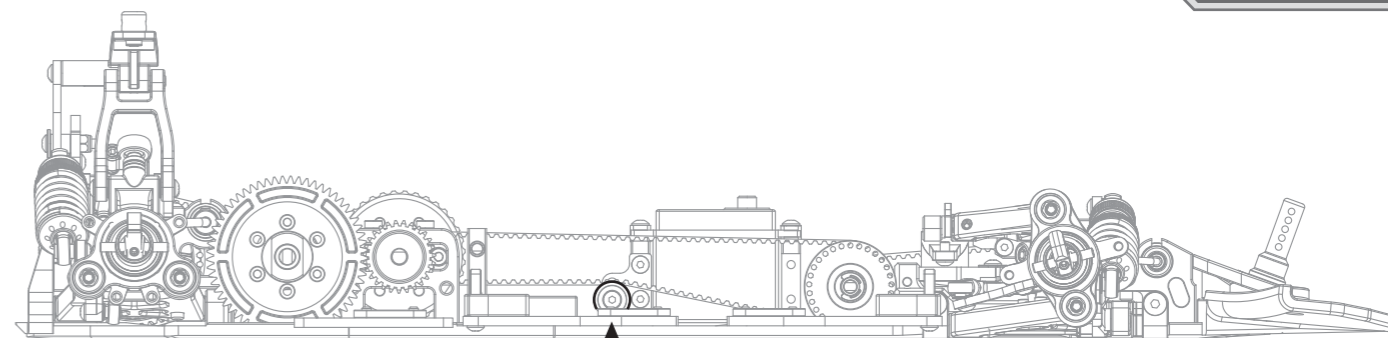

Adjust the middle belt tension here.

BAG 07

R101060
Servo Horn / Bell crank

R101070
Ball Joint 4.9mm Open (4)

R803016
Ball Head 4.9mm (4)

R102817
Turnbuckle 3x43mm

R801082
3x7x1mm Shims

R105104
3x6 Round Screw

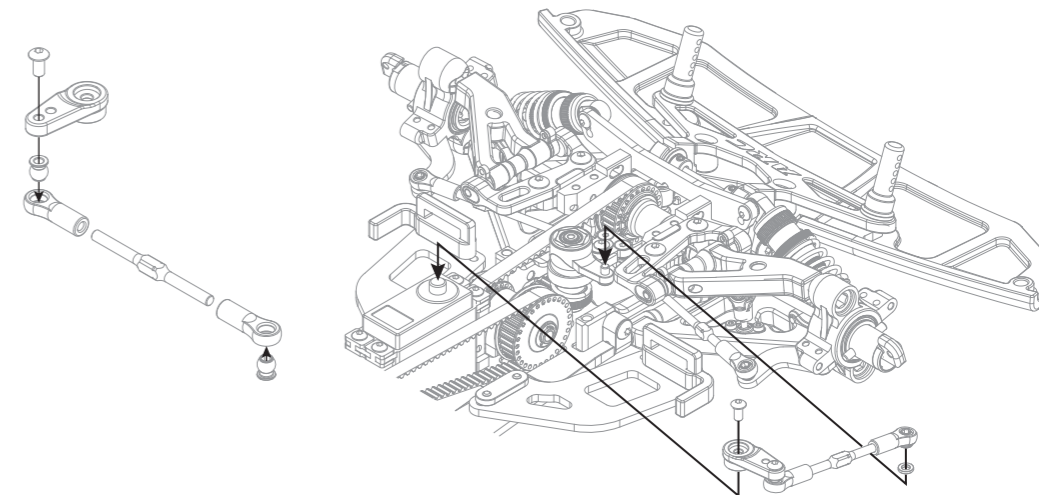

BAG 07

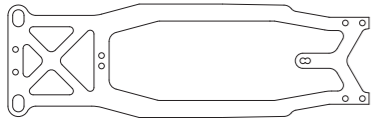

- R808101**
R8.0E Upper Deck
- R80110D**
Antenna Holder
- R102038**
Aluminum Tower (2)
- R808107**
R8.0E Fan Mount
- R801109**
Upper Deck Insert (2)

- R105203**
3x6mm Flat Screw
- R105104**
3x6 Round Screw
- R105105**
3x8 Round Screw
- R105108**
3x14 Round Screw

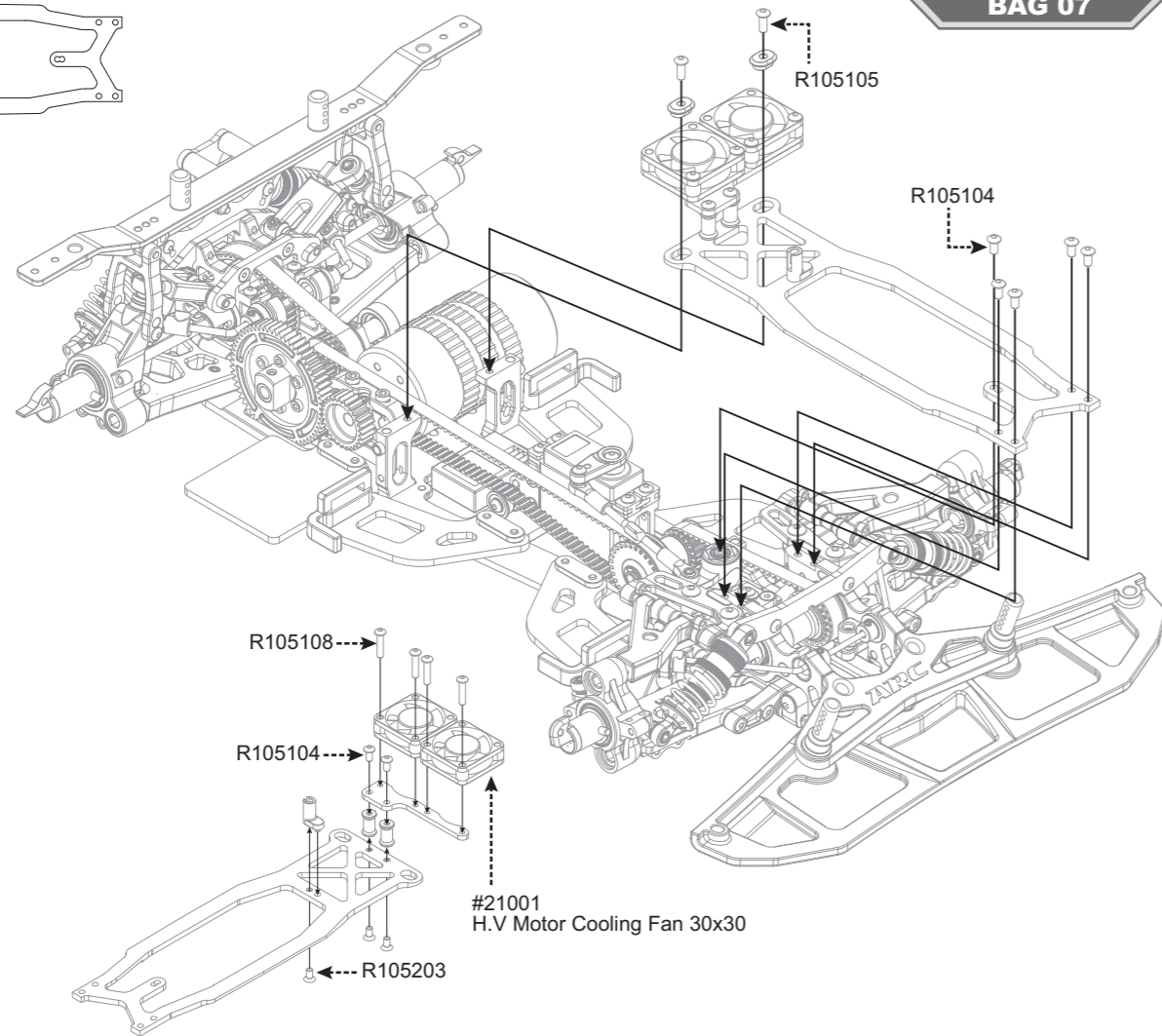

BAG 07

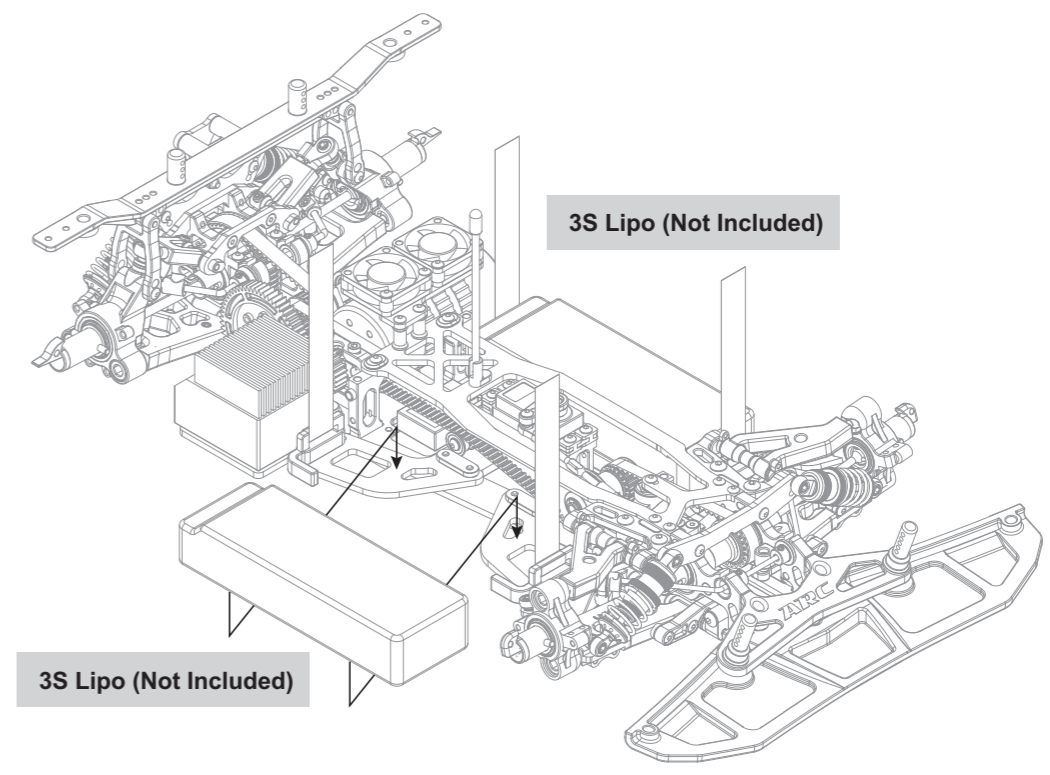

BAG 07

- R104150**
Antenna

**1/8th ESC
Not Included**

**Double Side Tape
(Not Included)**

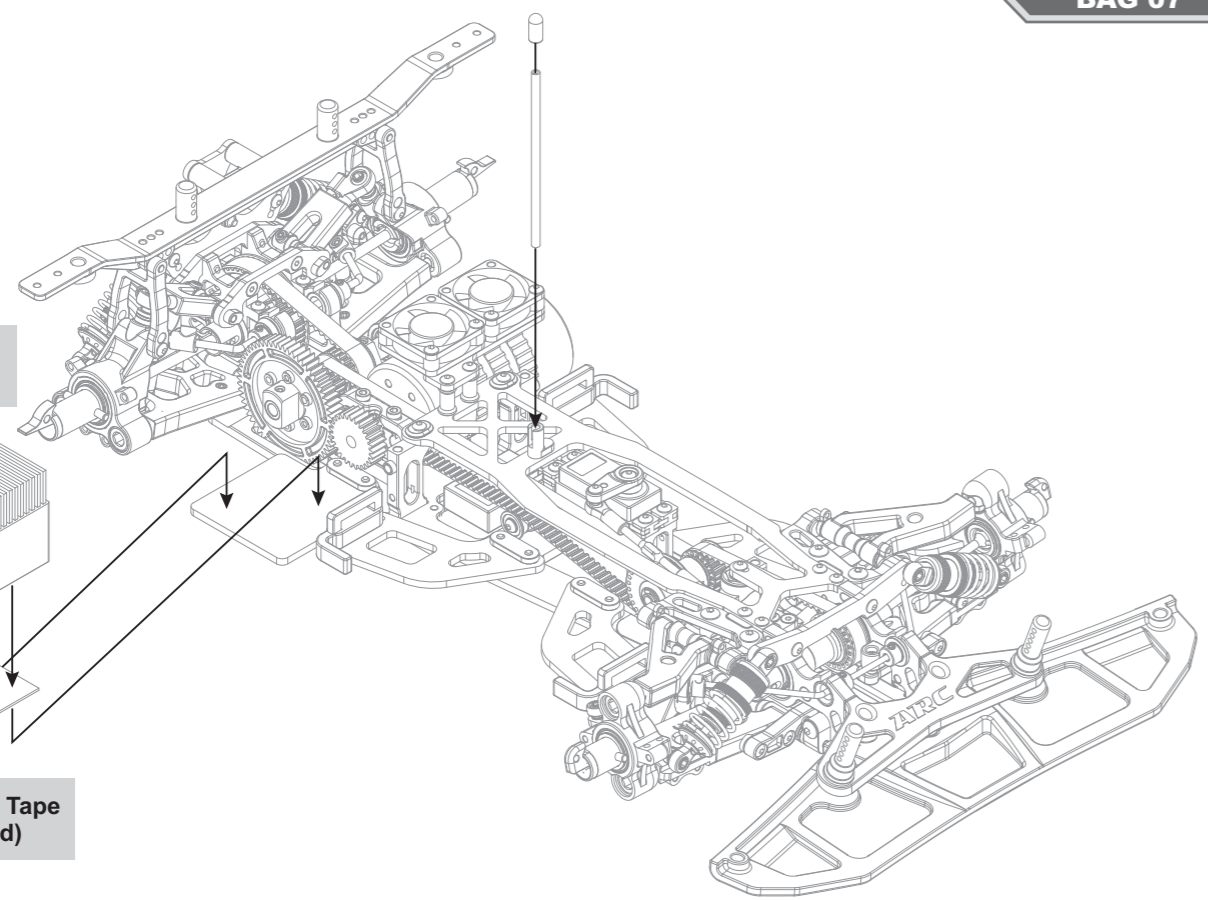

BAG 07

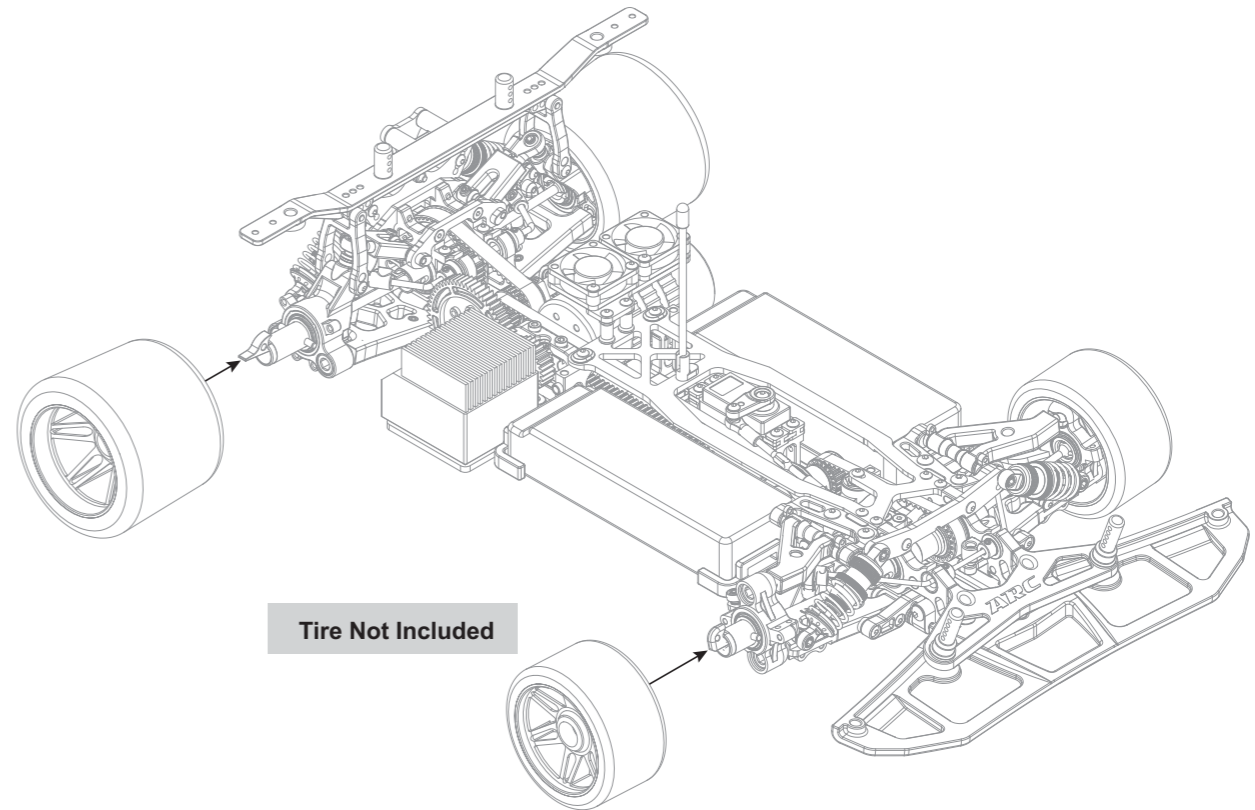

RACE
 TRACK
 NAME
 CITY / COUNTRY
 DATE

TEMPERATURE AIR TRACK
 QUALIFYING POSITION BEST LAPTIME FINAL POSITION RACE LENGTH
 TRACK CONDITION TECHNICAL MIXED FAST
 TRACTION LOW MEDIUM HIGH

GEAR RATIO CHART

Spur / Pinion	60	61	62
26	<input type="checkbox"/> 5.31	<input type="checkbox"/> 5.40	<input type="checkbox"/> 5.48
27	<input type="checkbox"/> 5.11	<input checked="" type="checkbox"/> 5.20	<input type="checkbox"/> 5.28
28	<input type="checkbox"/> 4.93	<input type="checkbox"/> 5.01	<input type="checkbox"/> 5.09

SHOCK Front Rear
 OIL 1 HOLE SHOCK PISTON 1 HOLE OIL
 2 HOLE 2 HOLE
 HOLE SIZE
 SPRING Red Green

TIRE Front Rear
 Front Left Tire Shore Rear Left
 Front Right Tire Ø Rear Right
 Front Left Tire Ø Rear Left
 Front Right Tire Ø Rear Right
 Tire Additive

BODY
 Bumper Standard Cut
 BODY MOUNT DISTANCE mm
 BODY TS040 WING 6 mm

NOTE

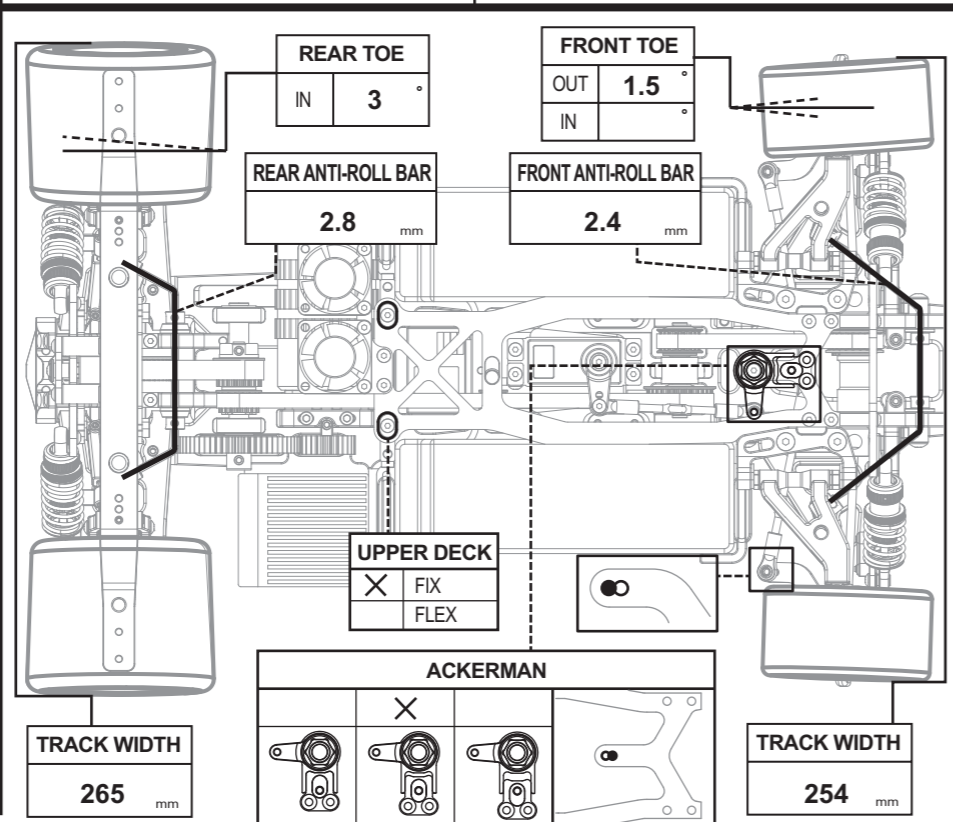
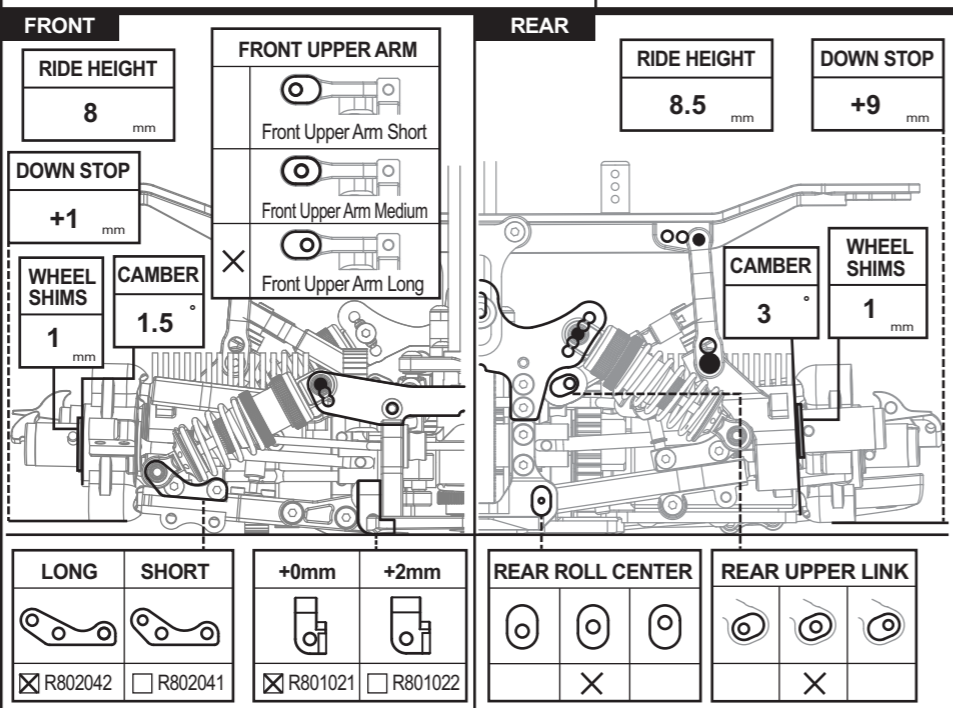
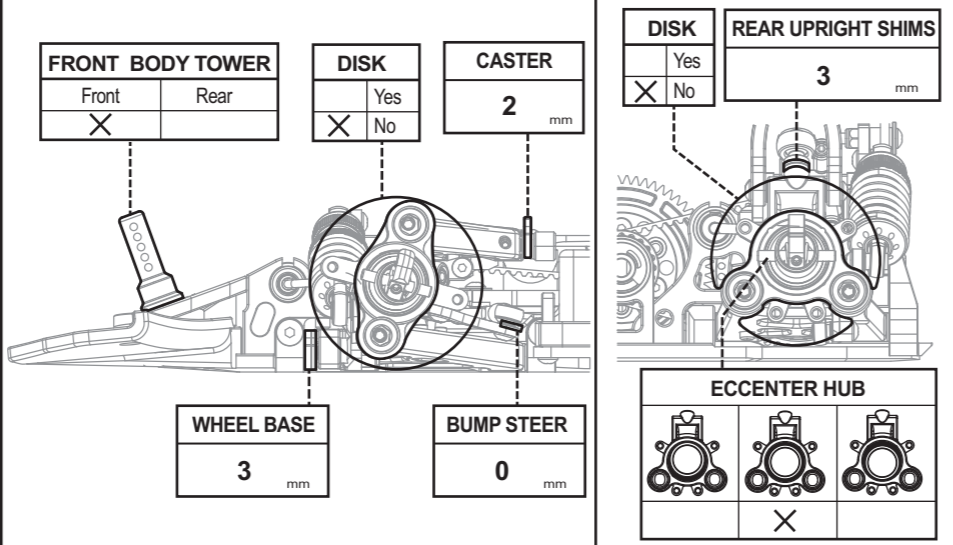

RACE
 TRACK
 NAME
 CITY / COUNTRY
 DATE

TEMPERATURE AIR TRACK
 QUALIFYING POSITION BEST LAPTIME FINAL POSITION RACE LENGTH
 TRACK CONDITION TECHNICAL MIXED FAST
 TRACTION LOW MEDIUM HIGH

GEAR RATIO CHART

Spur / Pinion	60	61	62
26	<input type="checkbox"/> 5.31	<input type="checkbox"/> 5.40	<input type="checkbox"/> 5.48
27	<input type="checkbox"/> 5.11	<input type="checkbox"/> 5.20	<input type="checkbox"/> 5.28
28	<input type="checkbox"/> 4.93	<input type="checkbox"/> 5.01	<input type="checkbox"/> 5.09

SHOCK Front Rear
 OIL 1 HOLE SHOCK PISTON 1 HOLE OIL
 2 HOLE 2 HOLE
 HOLE SIZE
 SPRING Red Green

TIRE Front Rear
 Front Left Tire Shore Rear Left
 Front Right Tire Ø Rear Right
 Front Left Tire Ø Rear Left
 Front Right Tire Ø Rear Right
 Tire Additive

BODY
 Bumper Standard Cut
 BODY MOUNT DISTANCE
 BODY WING mm

NOTE

