

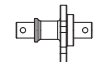

BAG 01

-  **R102003**
Spool Axle Alu
-  **R10102A**
Front Spool Pulley Set 38T
-  **R103001**
Spool Outdrive (2pcs)
-  **R111160**
R11 Eccentric Hub (4)
(1pcs) (4pcs)



-  **R105104**
3x6 Round Screw (10)
-  **R106101**
Ø2x9.8 Pin (10)
-  **R106021**
10x15x4mm
Ball Bearing (4)

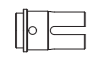
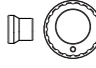
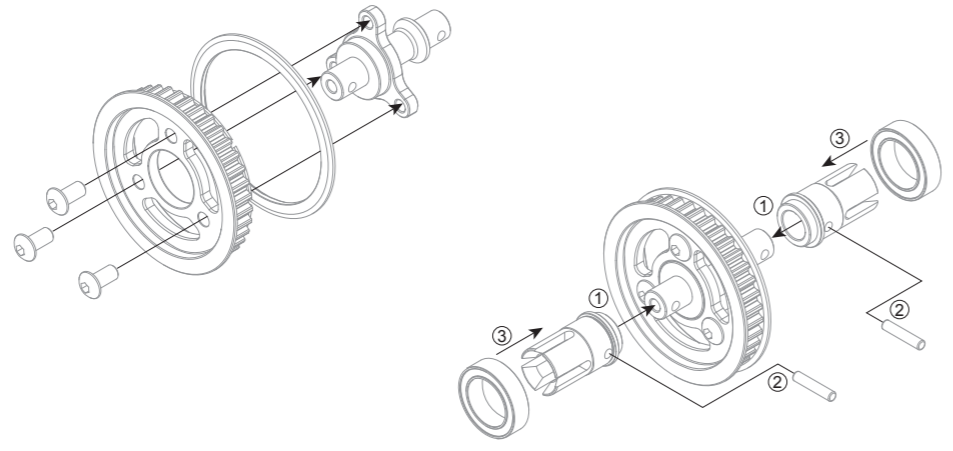
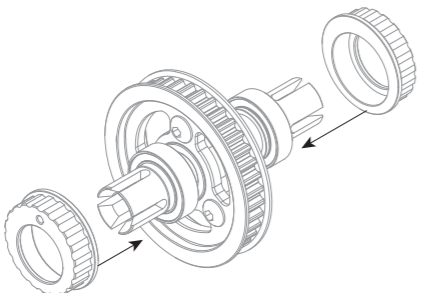

Pulley cover direction

Please make sure the pulley cover is oriented with the bevel side out.

BAG 01

-  (4pcs)
R101110
Diff Gears (with Axle)
-  **R103023**
Gear Diff Shim small (8)
-  **R104005**
O-ring 26x1 (2)

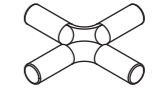
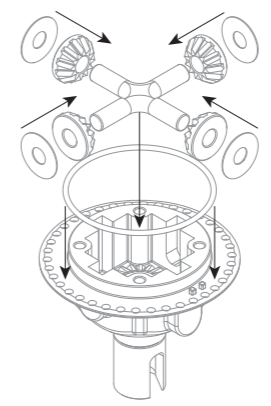

NOTICE

Trim any excess flashing from the diff gear axle at the mold injection point.

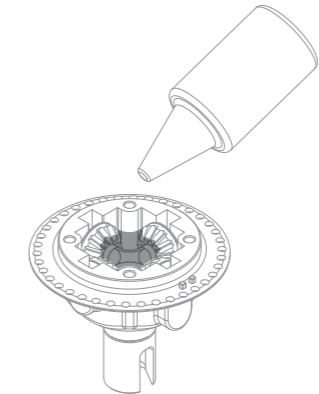

Silicone Oil #1000

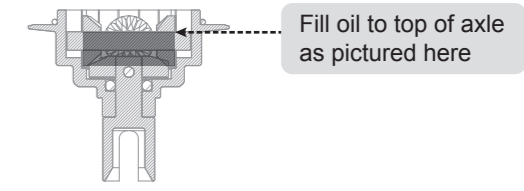

Fill oil to top of axle as pictured here

NOTICE



We recommend using 1.5 grams of silicone diff oil.

BAG 01

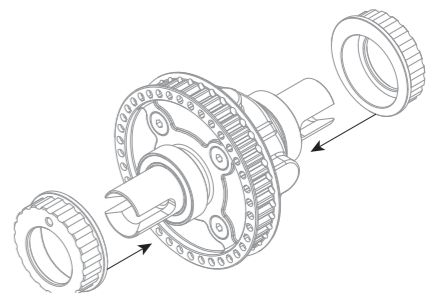
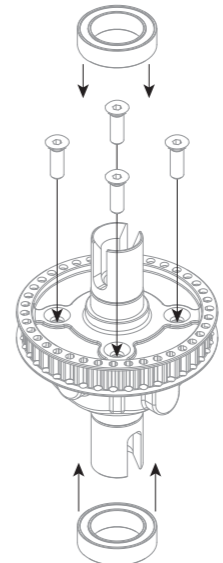
-  (1pcs) (4pcs)
R111160
R11 Eccentric Hub (4)

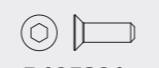
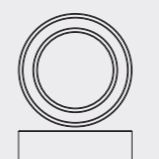

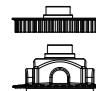
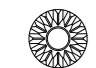
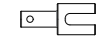
-  **R105201**
2.5x8mm Flat Screw (10)
-  **R106021**
10x15x4mm
Ball Bearing (4)

-  **R10102E**
Rear Diff Case
-  **R101110**
Diff Gears (with Axle)
-  **R102001**
Gear Diff Outdrive Alu
-  **R103024**
Gear Diff Shim Big (4)
-  **R104006**
O-ring 5x2 (4)

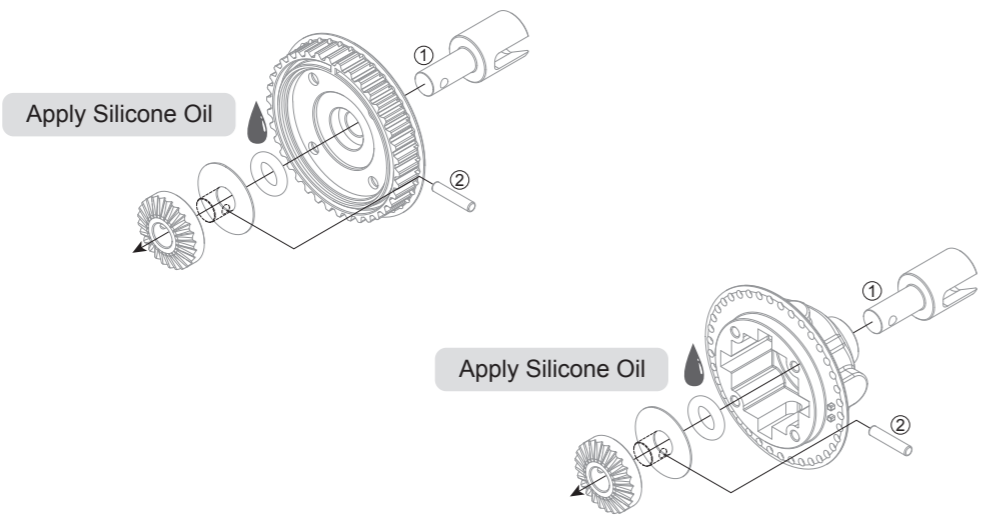

Apply Silicone Oil

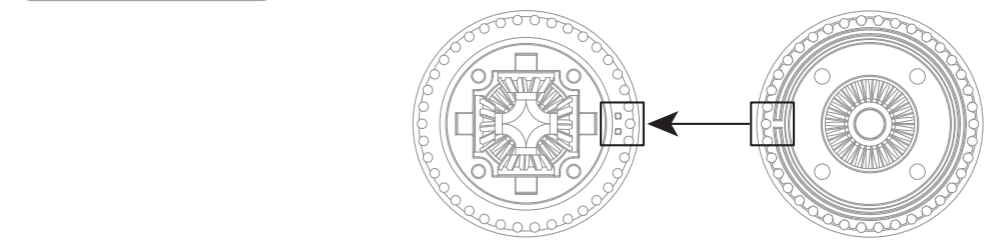

-  **R106101**
Ø2x9.8 Pin (10)



NOTICE

Diff case direction needs to match as below.

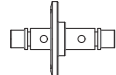
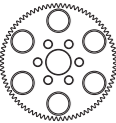
BAG 01

-  **R102004**
Spur Axle Alu
-  **R104101**
CNC Spur 84T(48dp)
-  **R10102C**
19T Belt Pulley Set (2)

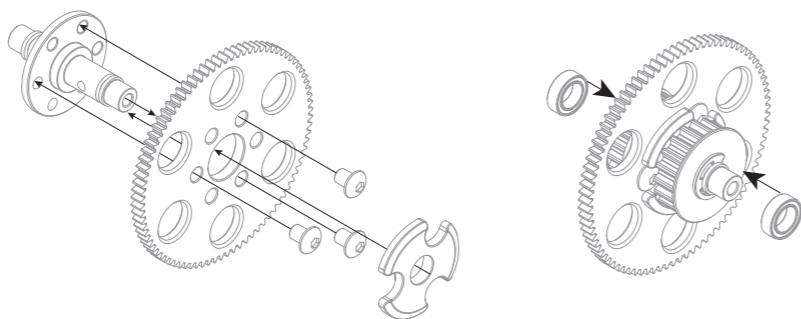

-  **R105103**
3x4 Round Screw (10)
-  **R105504**
E-Clip 4mm (8)
-  **R106104**
Ø2x11.8mm Pin (10)
-  **R106002**
5x8x2.5mm
Ball Bearing (4)

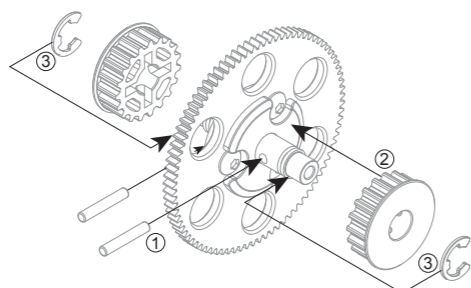

BAG 02

-  **R104013**
O'ring 13x1 (2)
-  **R112032**
R11 Shock Adj Nut-Black (2)
-  **R112030**
R11 Shock Low Cap-Black (2)
-  **R104002**
O'ring 3x2 (4)
-  **R104015**
Shock Shaft Shim (4)
-  **R112033**
Shock Body Short-MC (2)
-  **R103019**
Shock Shaft Short (2)
-  **R104018**
Shock Piston Big Bore 1.1mm x4 (4)

Apply shock oil before assembly

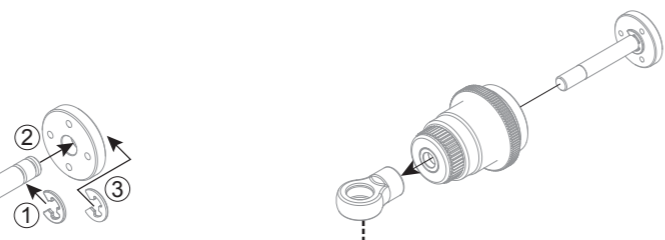

-  **R105501**
E-Clip 2mm (10)

BAG 02

-  **R112031**
R11 Shock Cap-Black (2)
-  **R104016**
Shock Membrane Big Bore (4)

Silicone Oil #500

Fill the shock oil to the top of the shock body

Move the shaft up and down to let the air escape from the oil

To adjust the rebound amount of the shock, push the shock shaft in to the required level to remove excess oil during assembly

↑ PUSH
— 25%
— 50%
— 75%

-  (4pcs) (2pcs) (2pcs) (4pcs)
R101130
Shock Ball Joint Set Big Bore

Drill the shock cap here to help provide zero rebound and softer dampening (optional setting)

-  **R103027**
5.8mm Ball End Short (4)

-  **R107043**
Front Shock Spring short (Green) (2)

-  **R107044**
Rear Shock Spring short (Blue) (2)

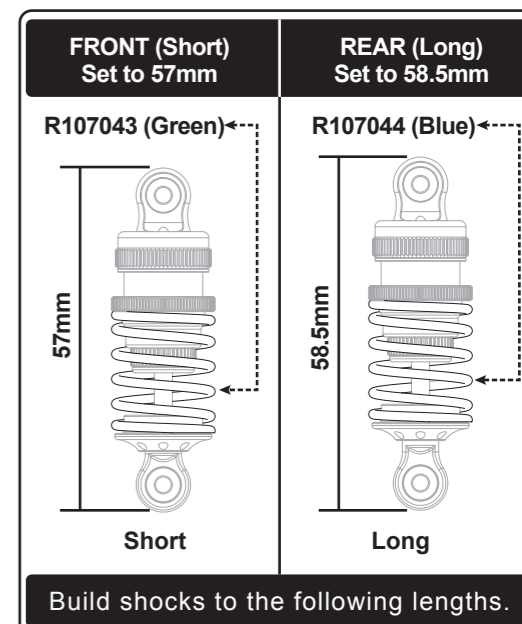
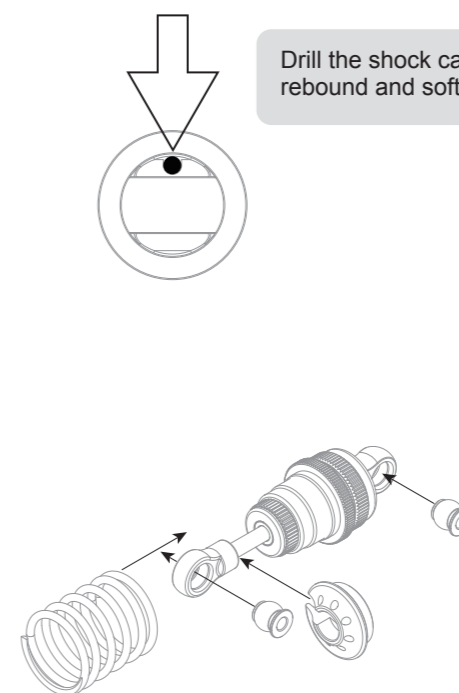

BAG 03

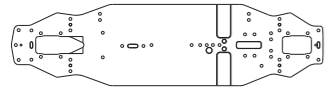

R118035
R11 2017 2.25mm Carbon Chassis

NOTICE

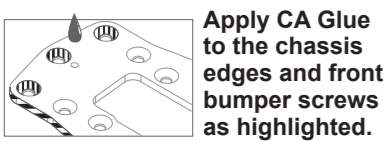

Apply CA Glue to the chassis edges and front bumper screws as highlighted.

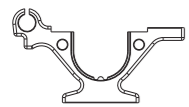

R112100
R11 2017 Low Bulkhead



R105203
3x6mm Flat Screw (10)

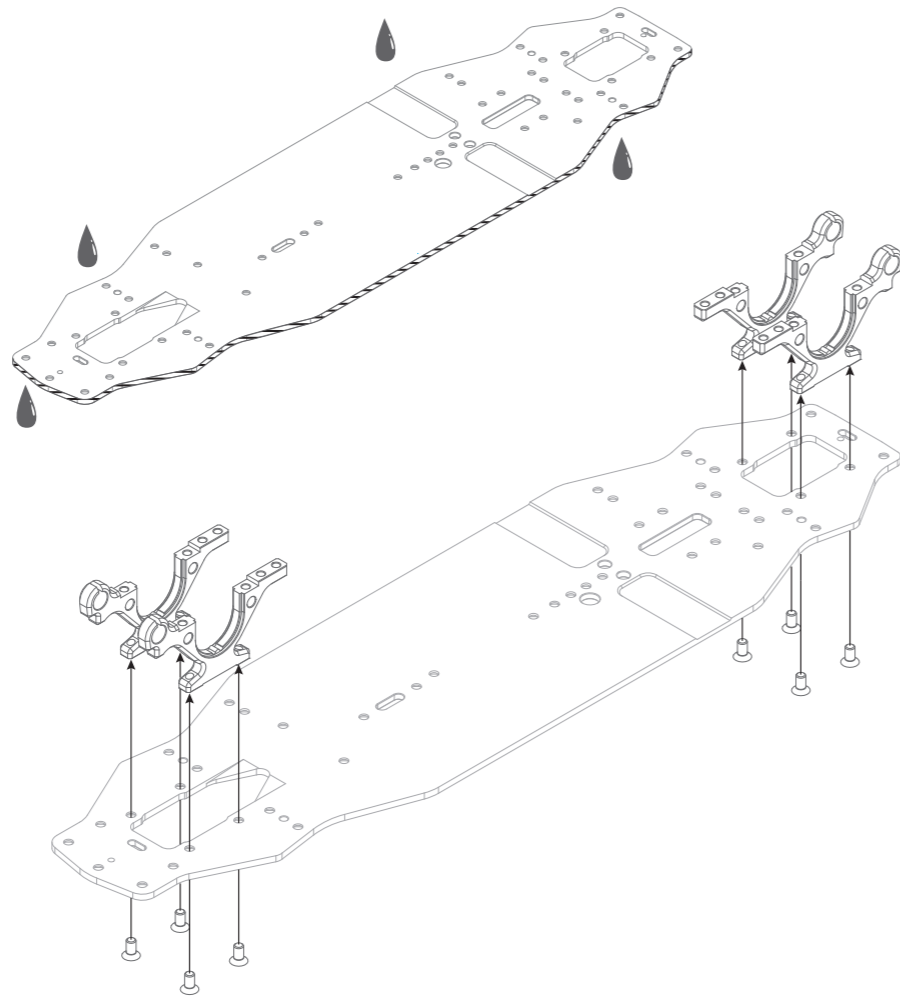

BAG 03

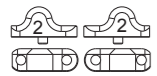

R119001
R11 Separated Suspension Block #2

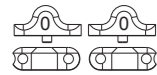

R119002
R11 Separated Suspension Block #0



R113011
R11 Roll Center Shims-Narrow 0.5mm (4)

Option parts



R113010
R11 Roll Center Shims-Narrow 0.3mm (4)



R105203
3x6mm Flat Screw (10)

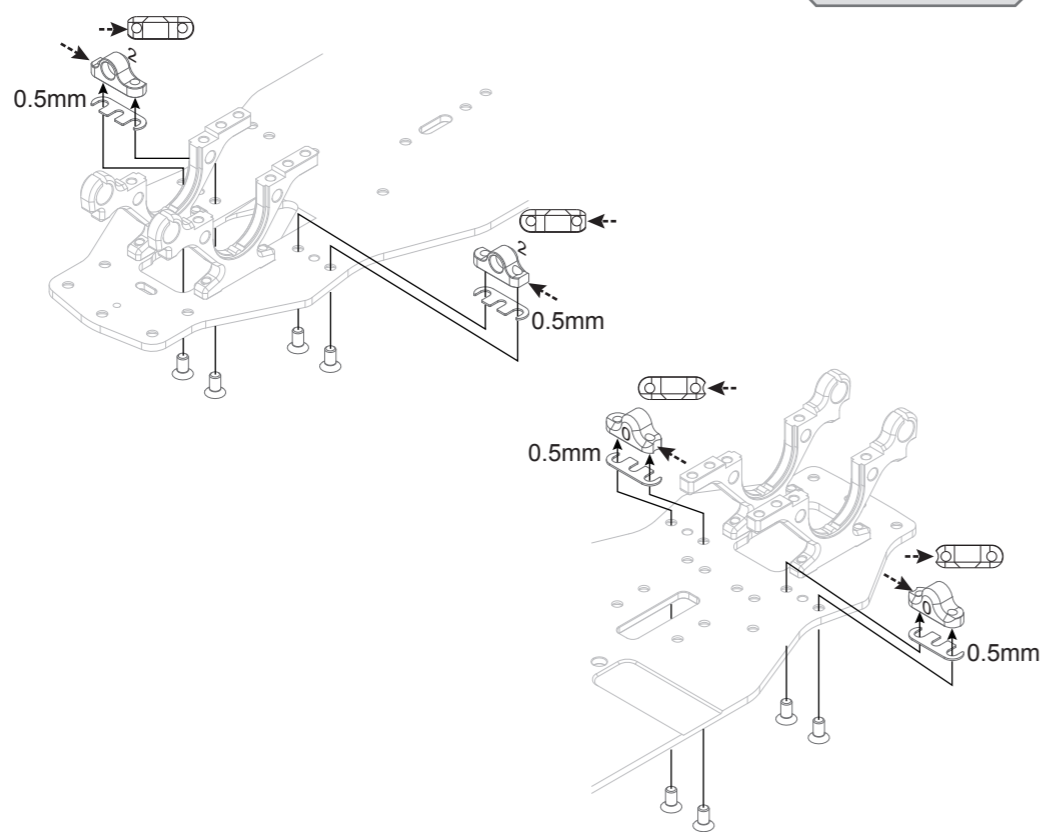

BAG 03

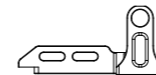

R112057
R11 2017 Motor Bulkhead-Left



R112006
R11 Motor Bulkhead Mount Plate

Option parts

R112007
R11 Center Tower-Alu



R105203
3x6mm Flat Screw (10)



R105104
3x6 Round Screw (10)



R115001
3mm Nylon Nut-Black Alu (4)

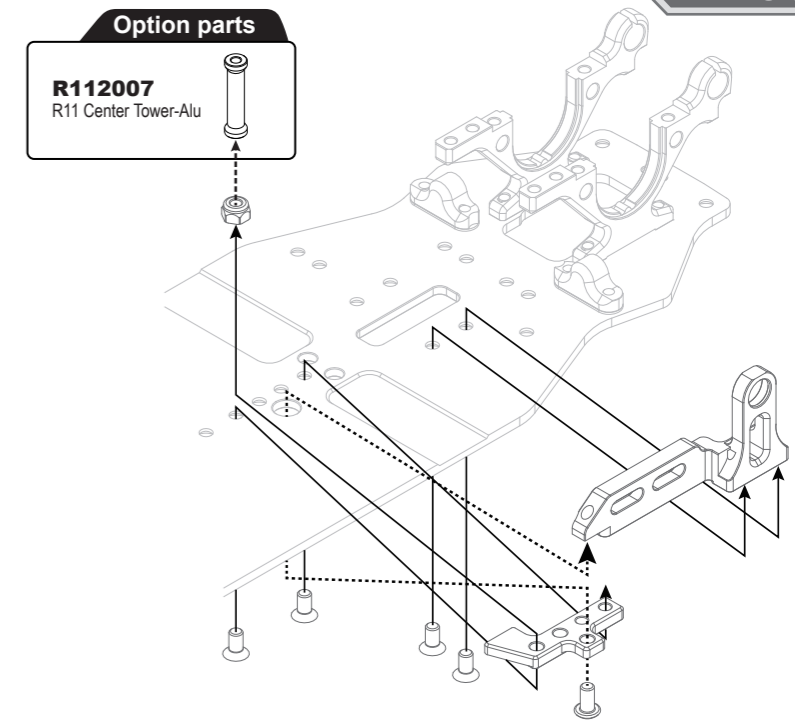

BAG 03



R104051
R10 Rear Belt Rubber 3mm



R114001
R11 Front Belt Rubber 3mm



R112056
R11 2017 Motor Bulkhead-Right



R105203
3x6mm Flat Screw (10)

NOTICE

Initial Position

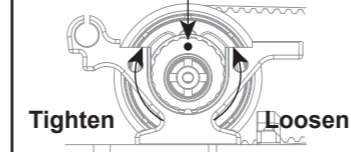

NOTICE

Initial Position

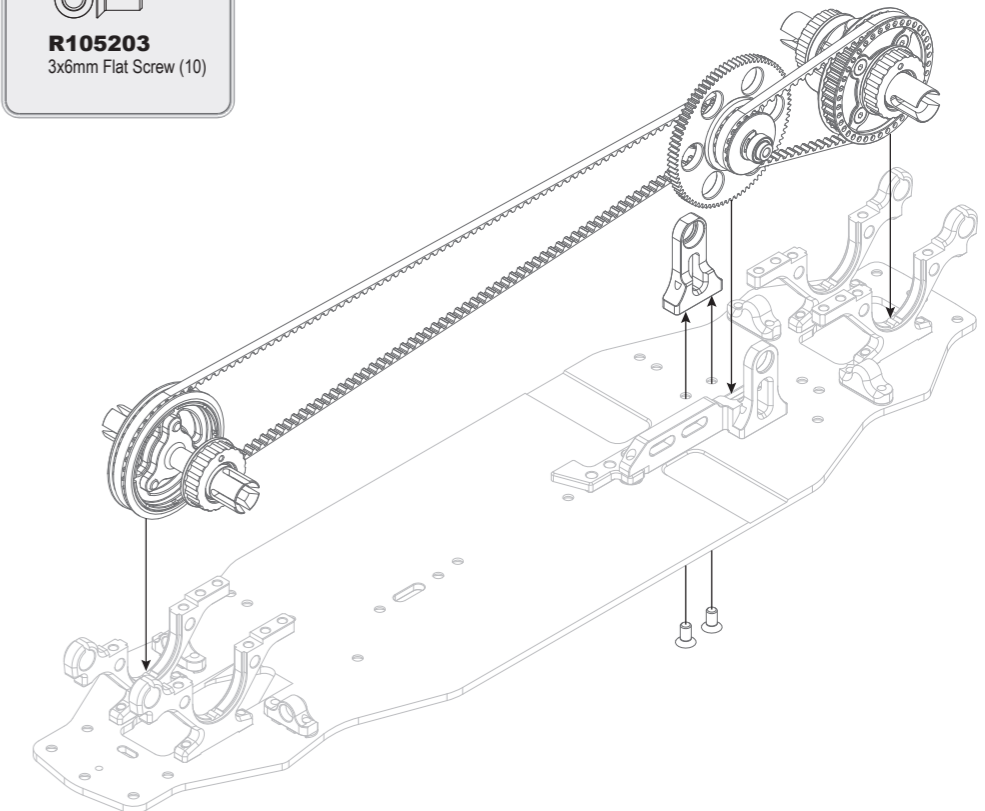
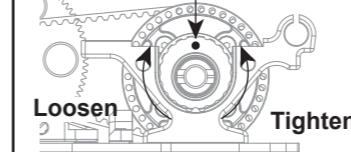

38T

19T

38T

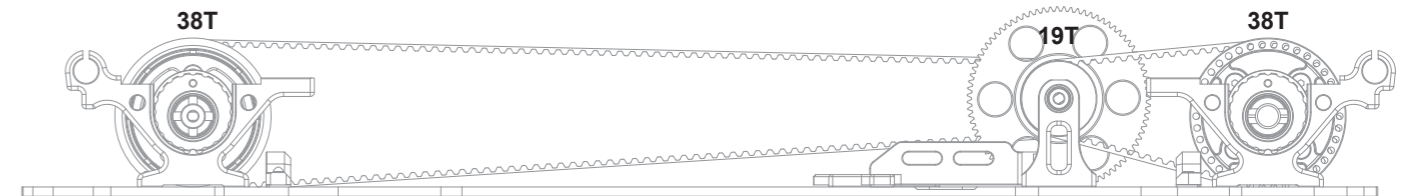

ARC R11 Internal Gear Ratio = 2.0

BAG 03

R112002
R11 Upper Bulkhead (FR/RL)

R112003
R11 Upper Bulkhead (FL/RR)

R118020
R11 Shock Tower-Front (Short)

R118021
R11 Shock Tower-Rear (Short)

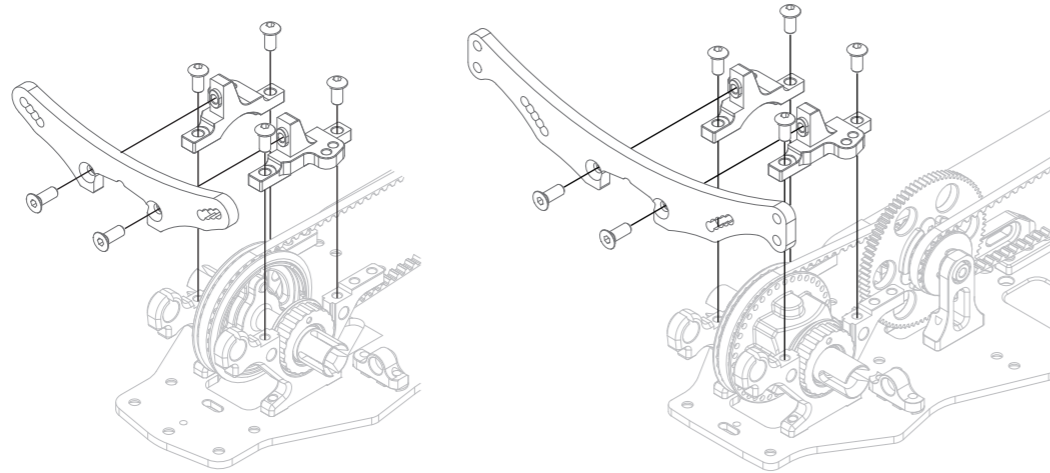

R105204
3x8mm Flat Screw (10)

R105104
3x6 Round Screw (10)

R118013
R11 Floating Servo Mount

R112008
R11 Servo Mount Base

R112009
R11 Servo Mount-Left

R111160
R11 Eccentric Hub (10)
(1pcs) (4pcs)

Not included

NOTICE
It is recommended to use servo mount rubber.

BAG 04

R105205
3x10mm Flat Screw (10)

R105203
3x6mm Flat Screw (10)

R105104
3x6 Round Screw (10)

R105105
3x8 Round Screw (10)

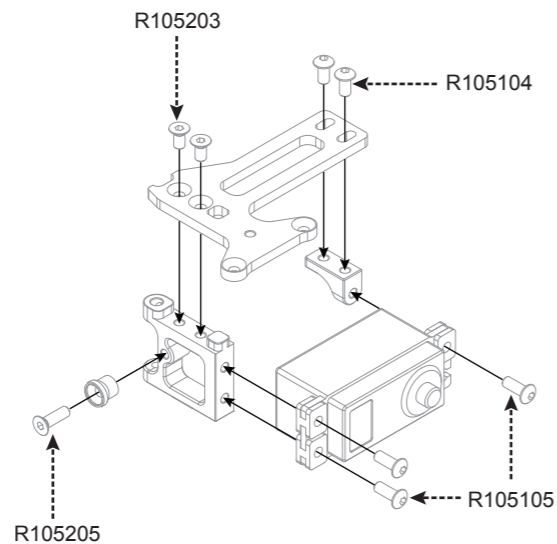

BAG 04

R10107A
Ball Joint 4.9mm open (6)

R103011
4.9mm Ball End Short (4)

R103012
4.9mm Ball End Long (4)

R103032
Turnbuckle 3x35mm (2)

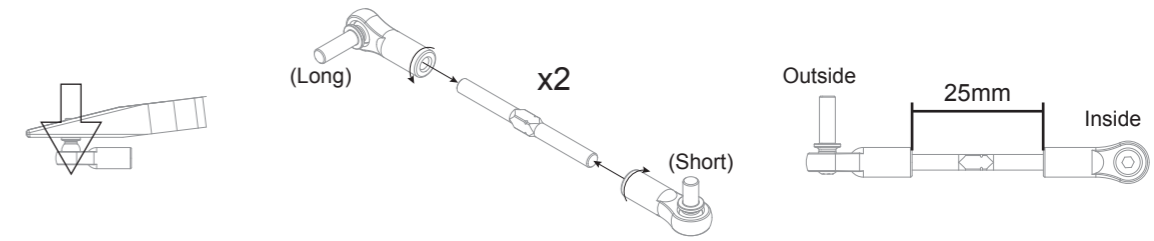

BAG 04

R10107D
Steering Rod Ball Joint

R103011
4.9mm Ball End Short (4)

R103017
4.9mm Ball End Med (4)

R103030
Turnbuckle 3x20mm (2)



BAG 04

R101060
Servo Horn dual steering arm

R112040
Steering Plate 8.5

R103006
Steering Shaft (2)

R105104
3x6mm Round Screw (10)

R102017
3x5.5x3mm Alu Shims (4)

R106010
5x8x2.5mm Ball Bearing (4)

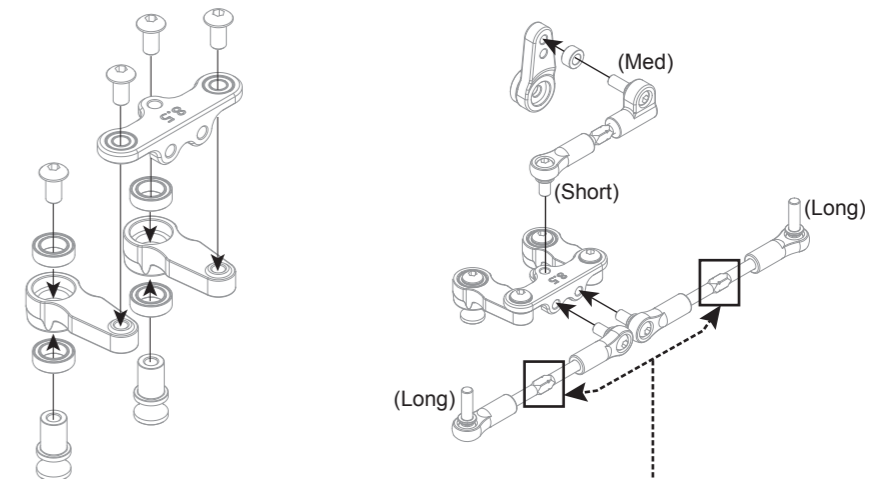

NOTICE
It is recommended to place the notch on each turnbuckle to the right side, which will make it easier to adjust camber and toe in the future.

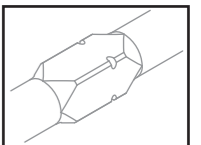

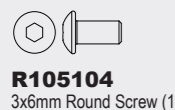

NOTICE
Apply thread locking compound here.

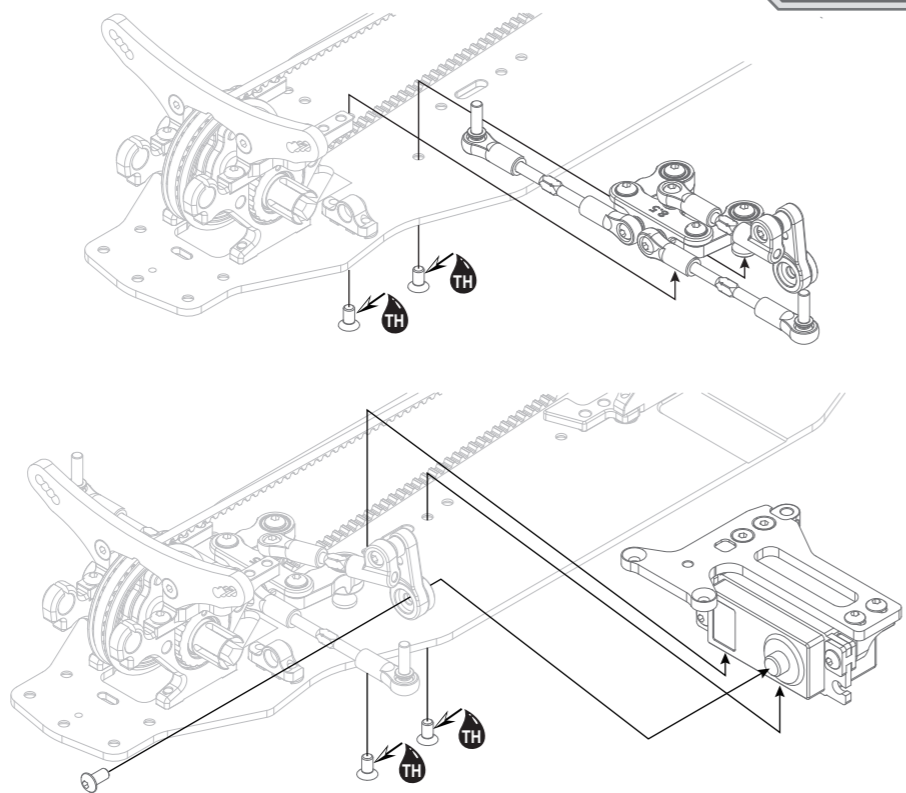

When assembling the front and rear arms, please pay attention to these notches for correct orientation.

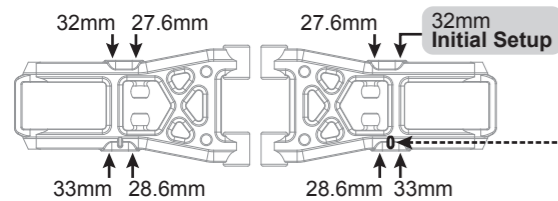

Front lower arms have 4 different shock positions. Make sure left and right sides are both symmetrical during assembly.

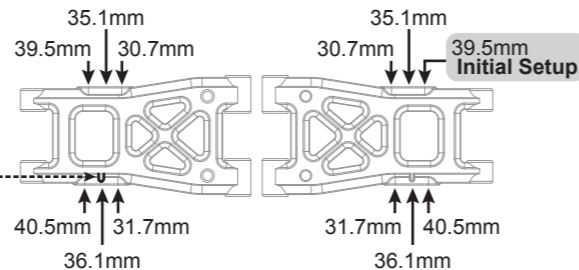

Rear lower arms have 6 different positions for shocks and anti-roll bars. Make sure left and right sides are symmetrical during assembly.

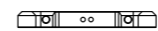
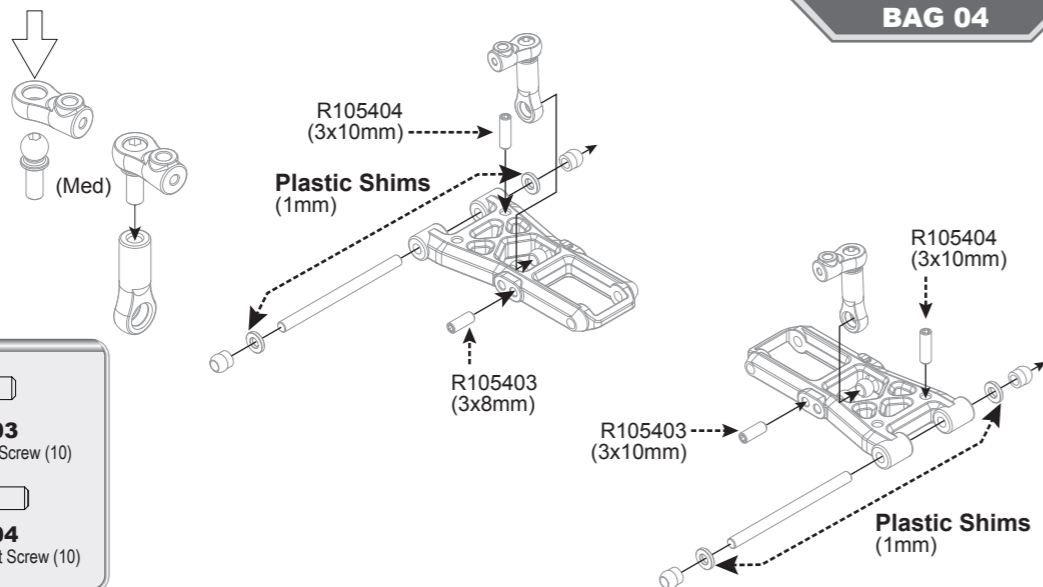
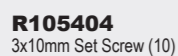
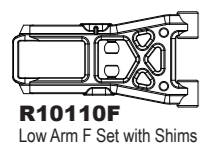

R112020
R11 Suspension Block #2



R113013
R11 Roll Center Shims 0.5mm (4)

Option parts



R113012
R11 Roll Center Shims 0.3mm (4)



R105203
3x6mm Flat Screw (10)

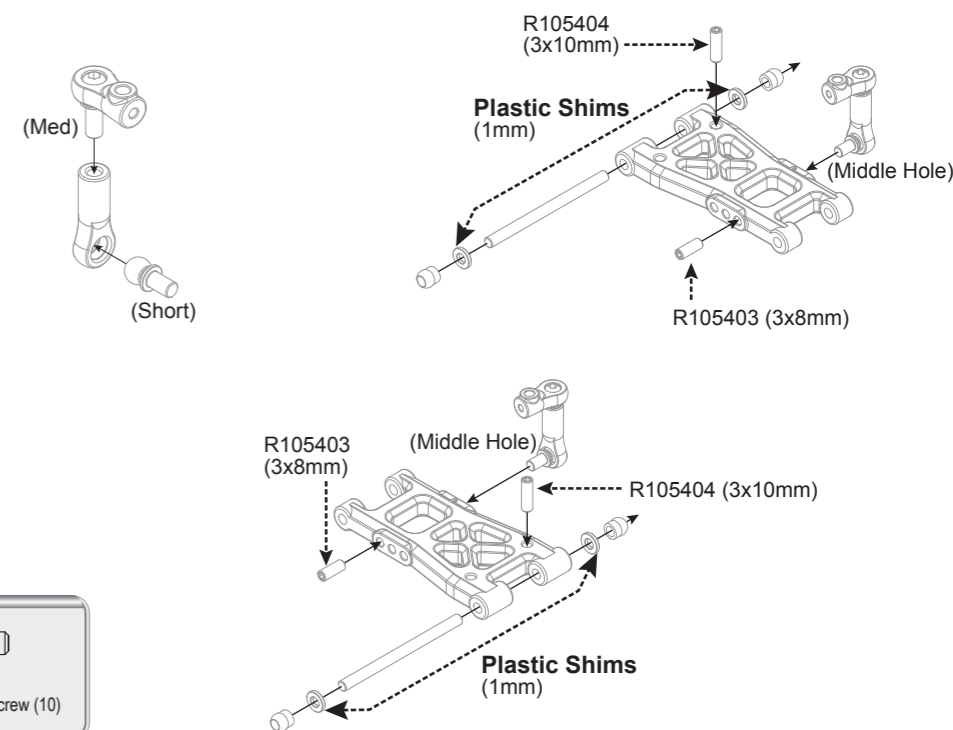
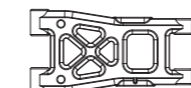
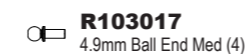
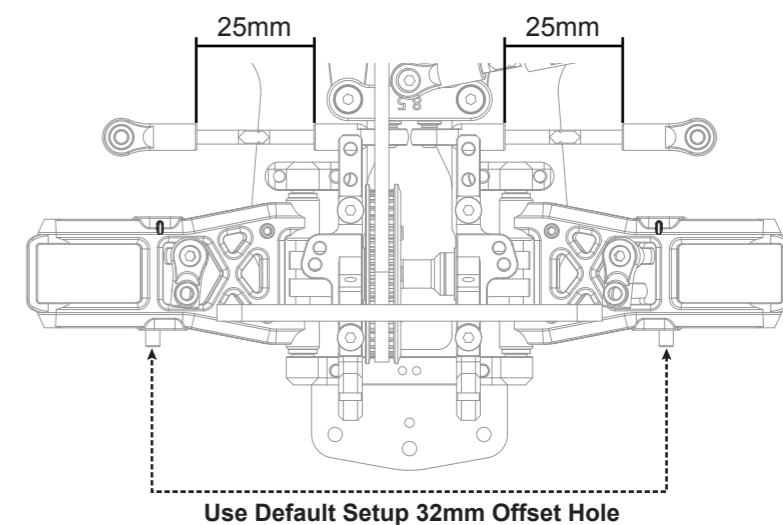
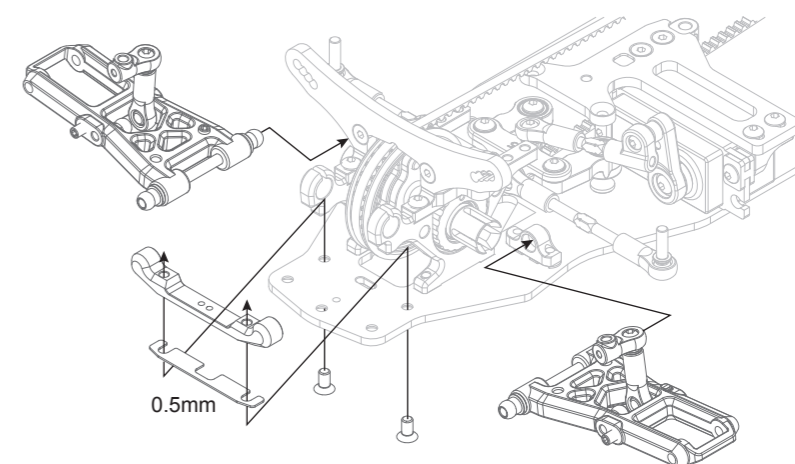

BAG 04

R112022
R11 Suspension Block #3

R113013
R11 Roll Center Shims 0.5mm (4)

R105203
3x6mm Flat Screw (10)

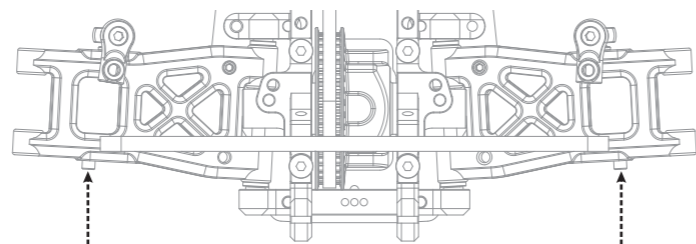
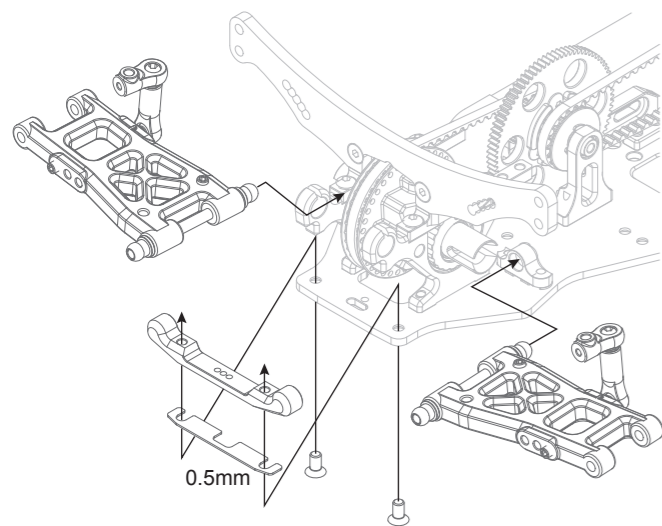

Use Default Setup 39.5mm Offset Hole

BAG 05

R10107A
Ball Joint 4.9mm open (6)

R10107B
Ball Joint 4.9mm closed (4)

R103012
4.9mm Ball End Long (4)

R103031
Turnbuckle 3x25mm (2)

R103017
4.9mm Ball End Med (4)

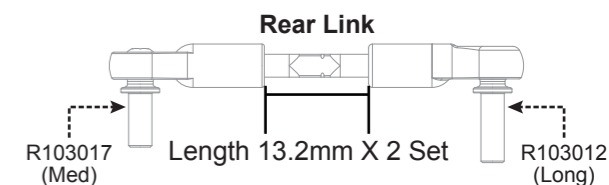
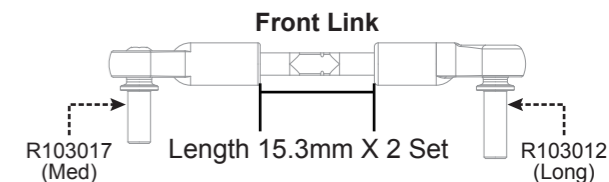
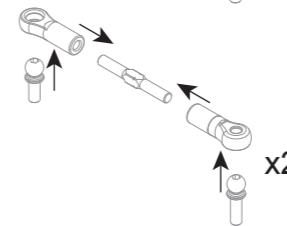
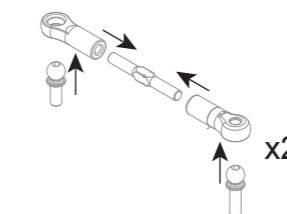

BAG 05

R107001
CDV G-Clip (8)

R103002
Wheel Axle (2)

R103003
CVD Rear 44mm (2)

R109009
D.J CVD Set (Spring Steel) (2set)

R103005
CVD Insert (2)

R101030
C Cap 3.5mm

R102070
Hex Wheel Hub Offset-0.75mm Alu (2)

R102028
Hex Wheel Hub Offset +0.75mm Alu (2)

R101090
Steering Block and Upright

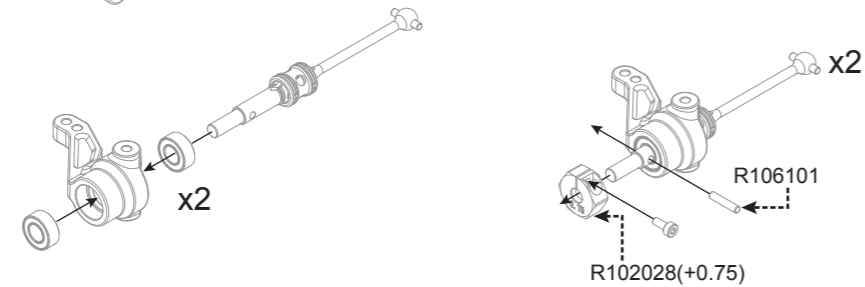
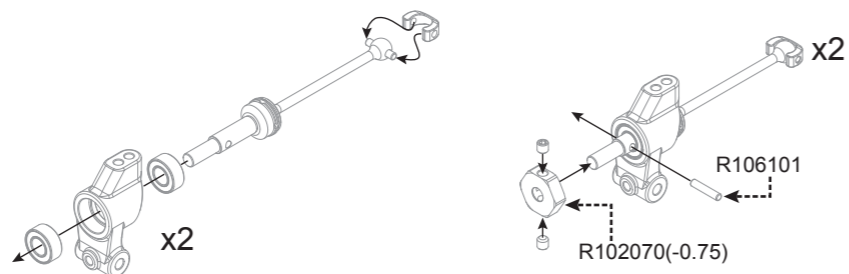
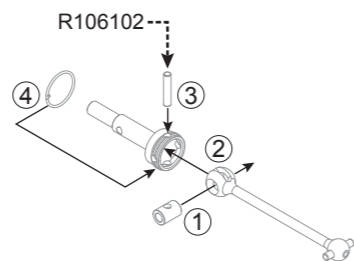

R105401
3x3mm Set Screw (10)

R106101
Ø2x9.8mm Pin (10)

R106102
Ø2x10mm Pin (10)

R106012
5x10x4mm Ball Bearing (4)

R103015
Pivot Pin Front-Out (23mm) (2)

R103016
Pivot Pin Rear-Out (25mm) (2)

R105402
3x4mm Set Screw (10)

R102017
3x5.5x3mm Alu Shims (4)

R102018
3x5.5x4mm Alu Shims (4)

R102014
3x5.5x1mm Alu Shims (4)

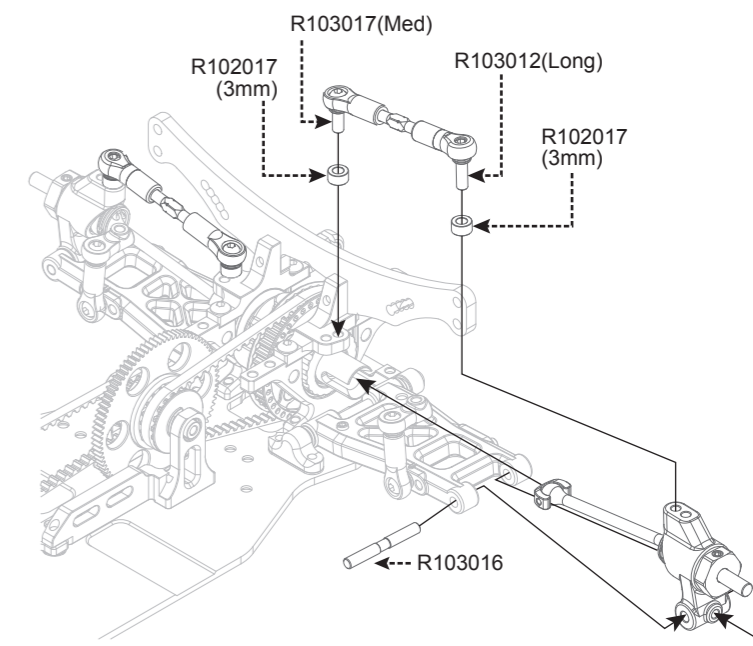
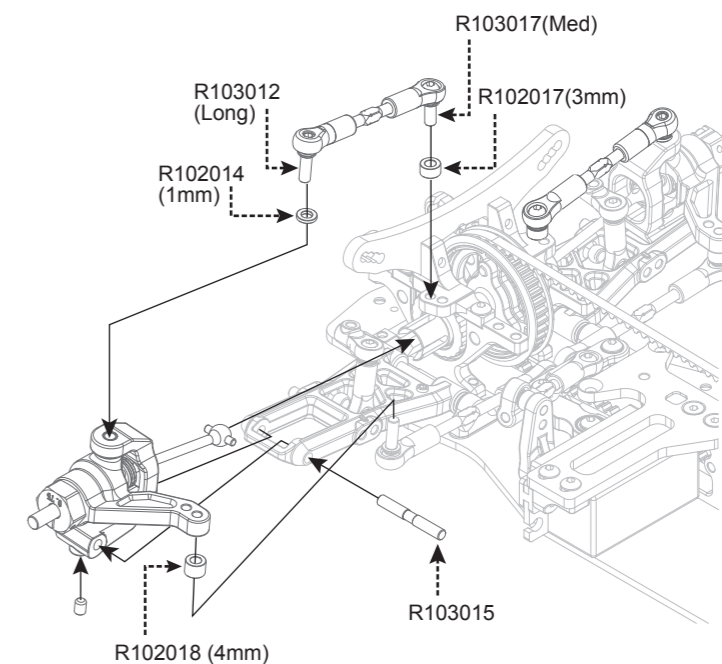

BAG 05

R101080
C-Hub 4 Right + Left

R103007
Steering Block Bushing (4)

R105105
3x8mm Round Screw (10)

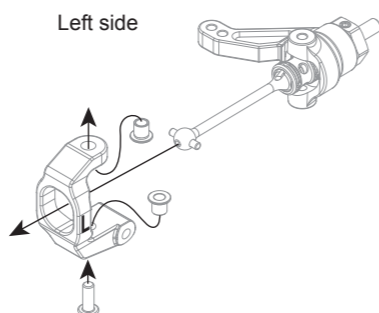
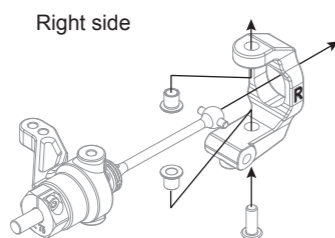

BAG 06

R113001
Anti-Roll Bar Holder (2)

R105401
3x3mm Set Screw (10)

R107014
Rear Anti-Roll Bar 1.3mm

R806001
3x6x2.5mm
Flange Ball Bearing (2)

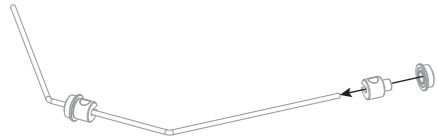
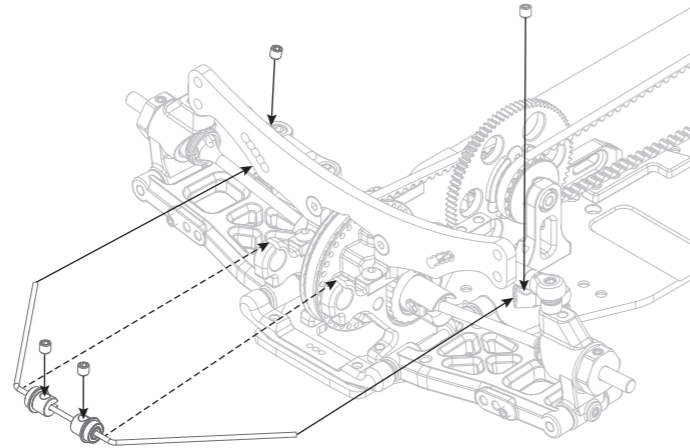

BAG 06

R113001
Anti-Roll Bar Holder (2)

R105401
3x3mm Set Screw (10)

R107011
Front Anti-Roll Bar 1.3mm

R806001
3x6x2.5mm
Flange Ball Bearing (2)

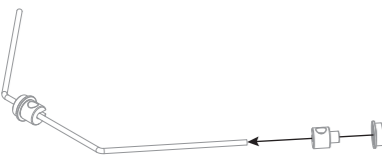
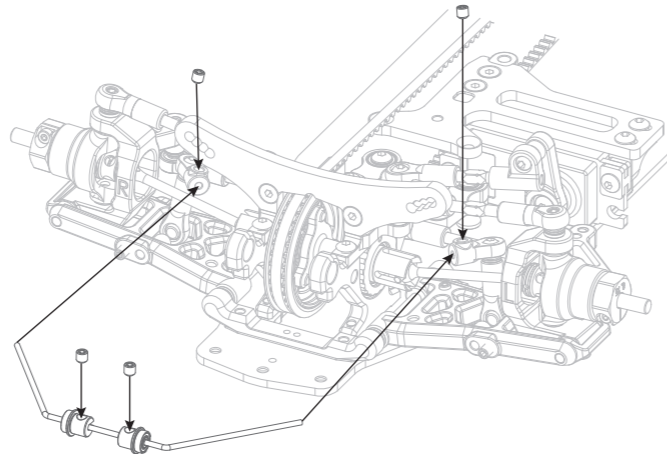

BAG 06

R118003
R11 2017 Upper Deck 2.0mm

R119003
R11 Belt Tensioner

R105104
3x6mm Round Screw (10)

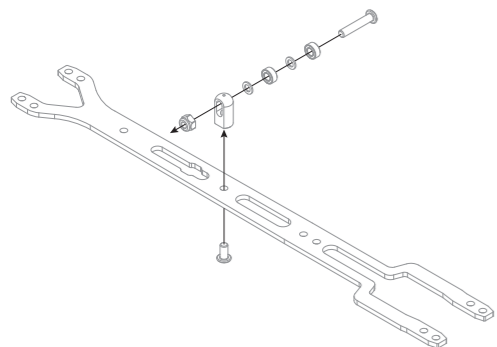
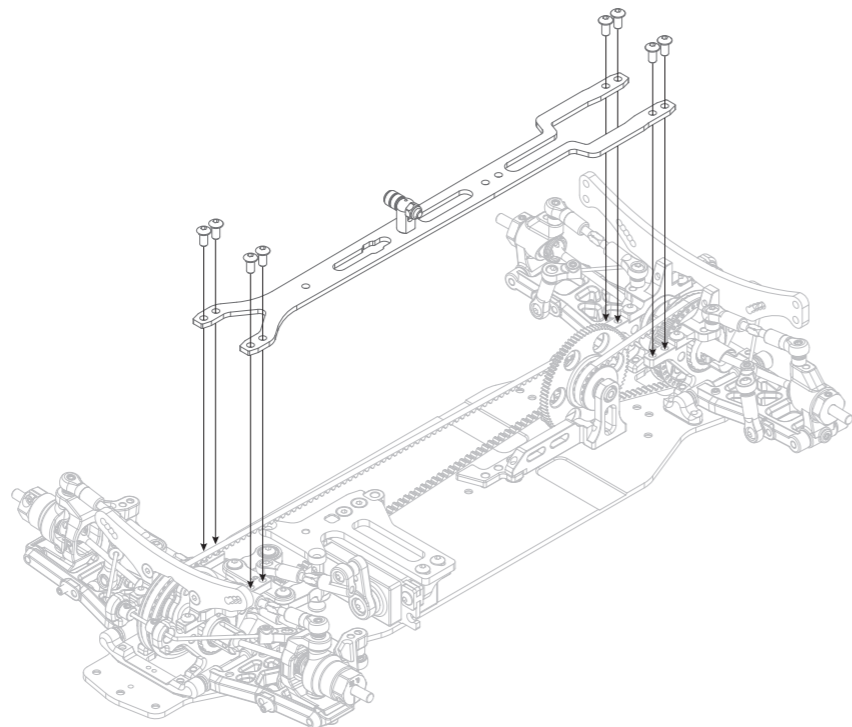

BAG 06

R101050
Bumper / Tower Set

R105150
3mm Nylon Nut (10)

R105205
3x10mm Flat Screw (10)

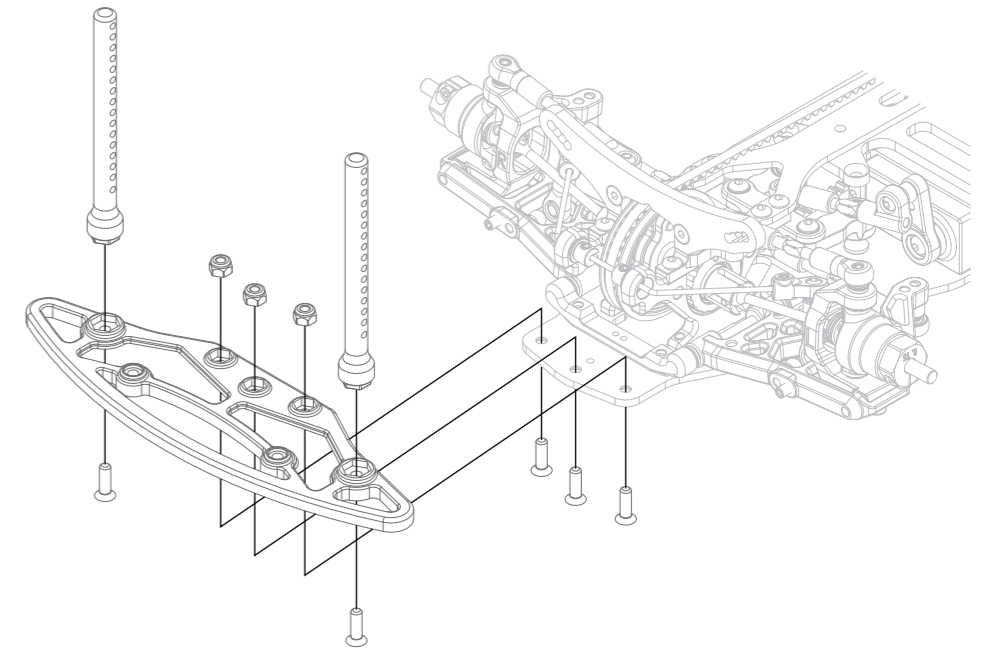

R104010
Foam Bumper

R105105
3x8mm Round Screw (10)

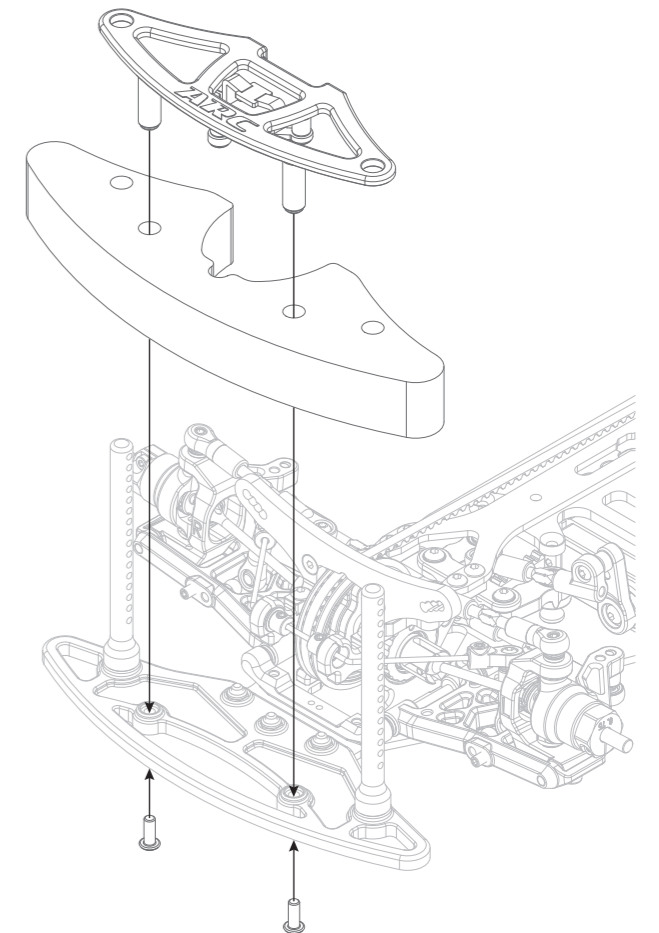



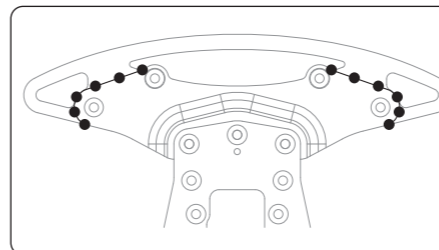

NOTICE

The lower bumper can be cut as marked to make it smaller and less likely to touch the racing surface during cornering, however it will provide less protection.





BAG 06

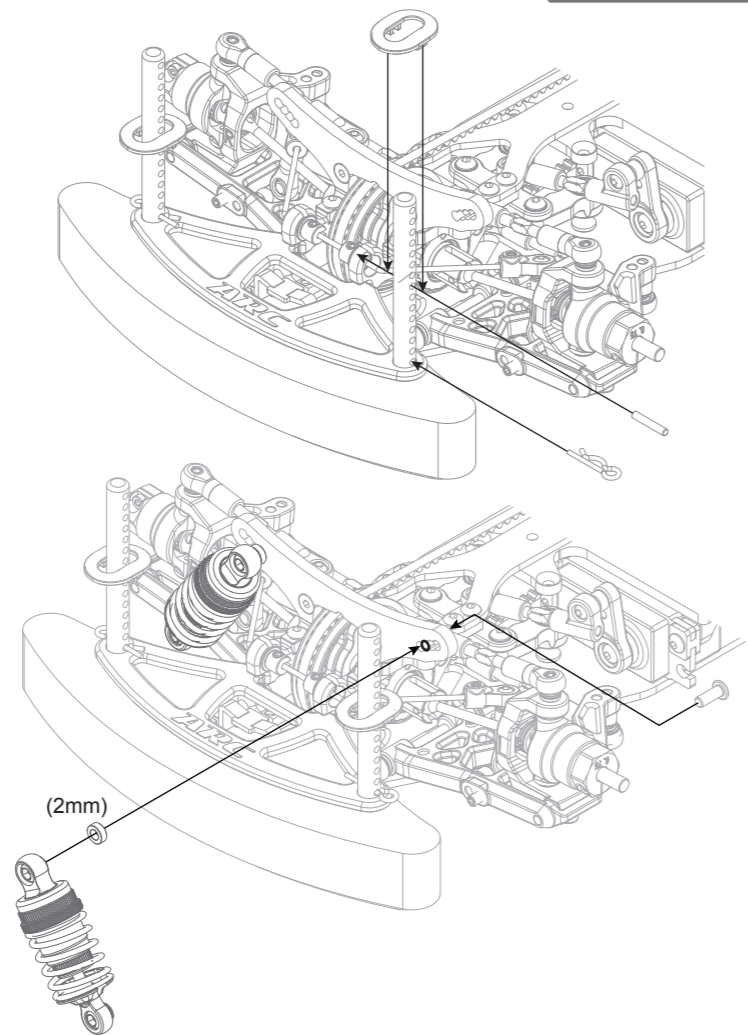

-  **R101050**
Bumper / Tower Set (2pcs)
-  **R107002**
R-Clip (8)
-  **R102015**
3x5.5x2mm Alu Shims (8)

-  **R106104**
Ø2x11.8mm Pin (10)
-  **R105105**
3x8mm Round Screw (10)

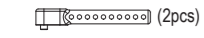

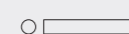

BAG 06

-  (2pcs)
-  (2pcs)
- R101050**
Bumper / Tower Set
-  **R102015**
3x5.5x2mm Alu Shims (8)

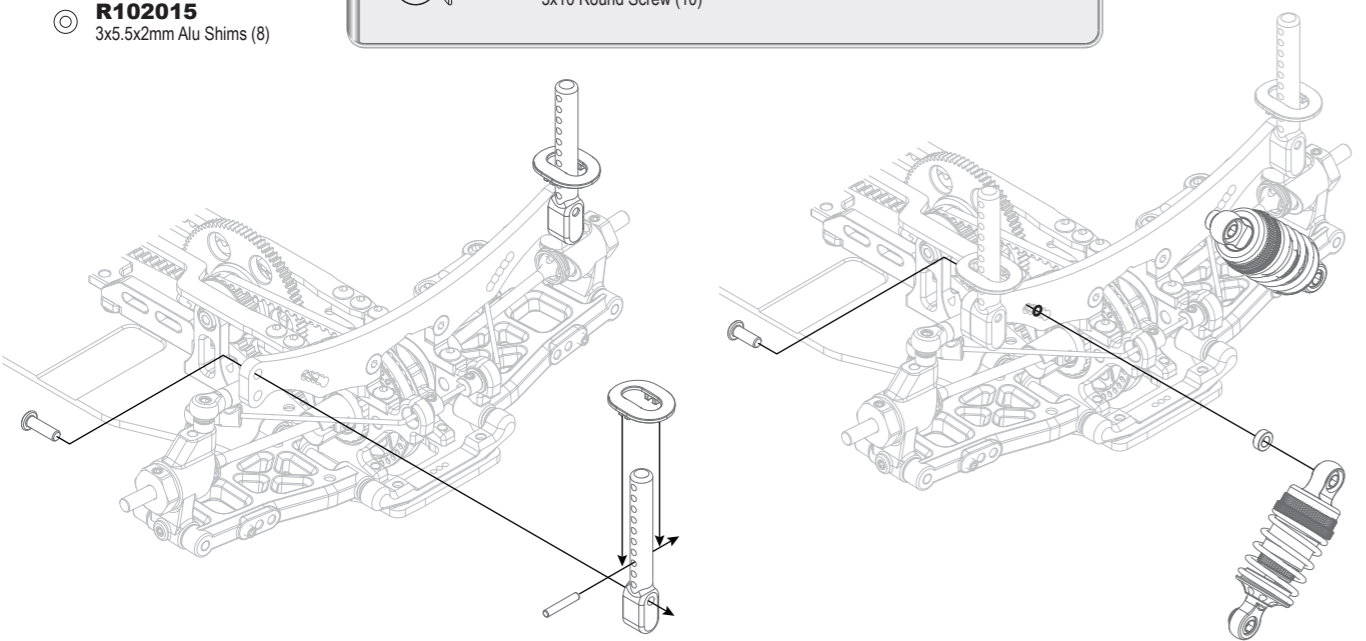
-  **R105105**
3x8mm Round Screw (10)
-  **R106104**
Ø2x11.8mm Pin (10)
-  **R105106**
3x10 Round Screw (10)



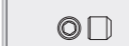

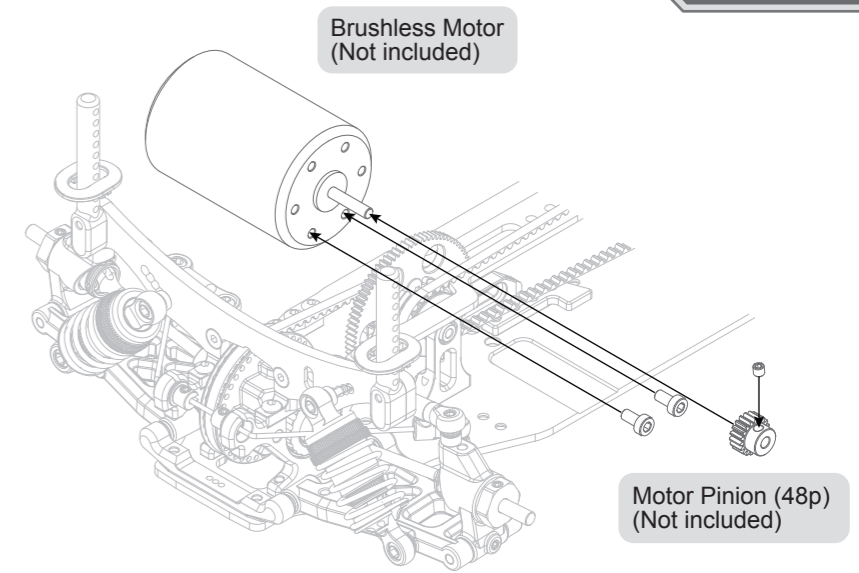

BAG 06

-  **R105401**
3x3mm Set Screw (10)
-  **R105300**
3x6mm Cap Screw (10)

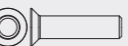

BAG 06

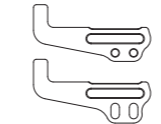
-  **R10110C**
3x6x3mm Plastic Shims
-  **R105204**
3x8mm Flat Screw (10)
-  **R105206**
3x12mm Flat Screw (10)
-  **R115001**
3mm Nylon Nut-Black Alu (4)
-  **R119008**
Battery Guides-Carbon

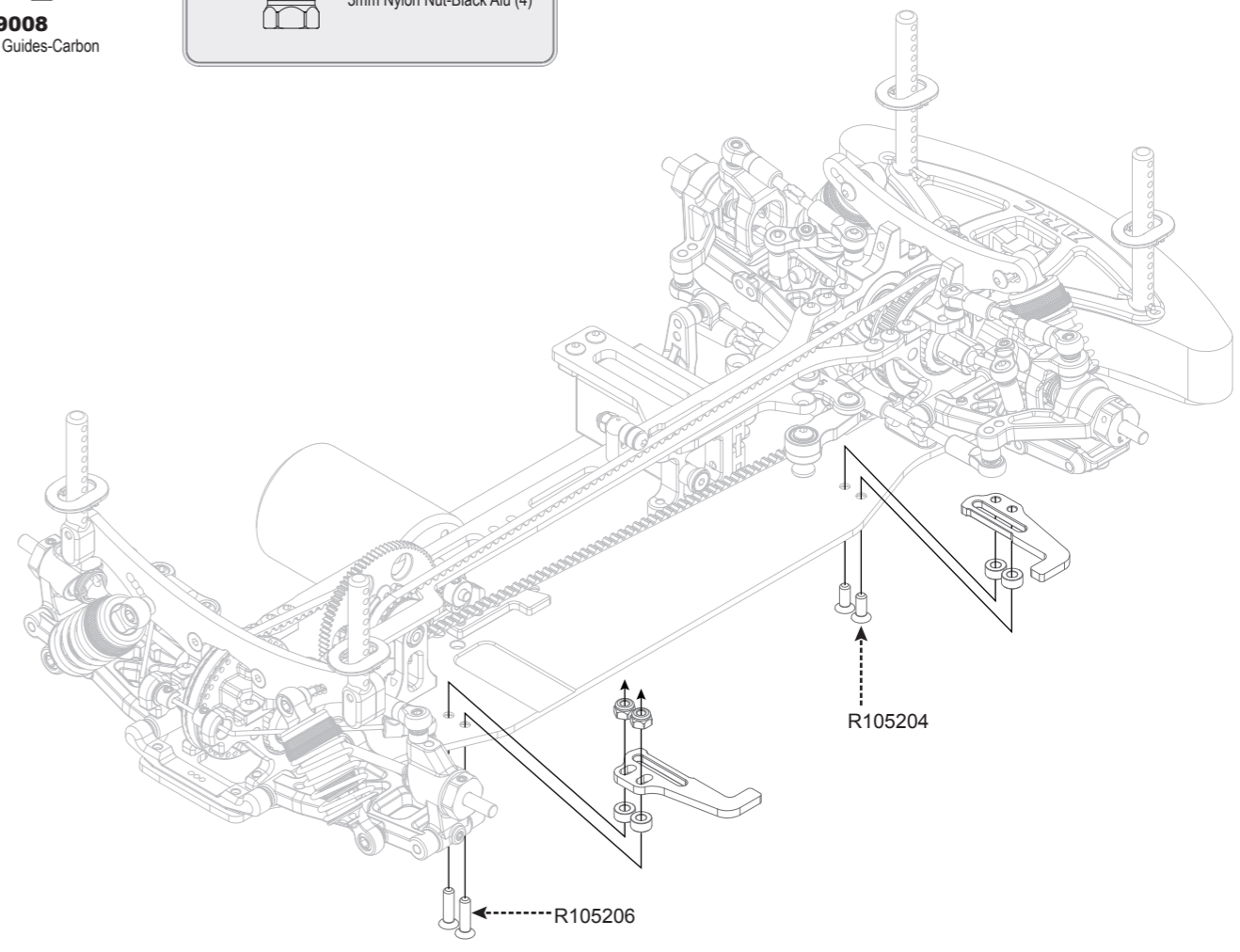

R104150
Antenna

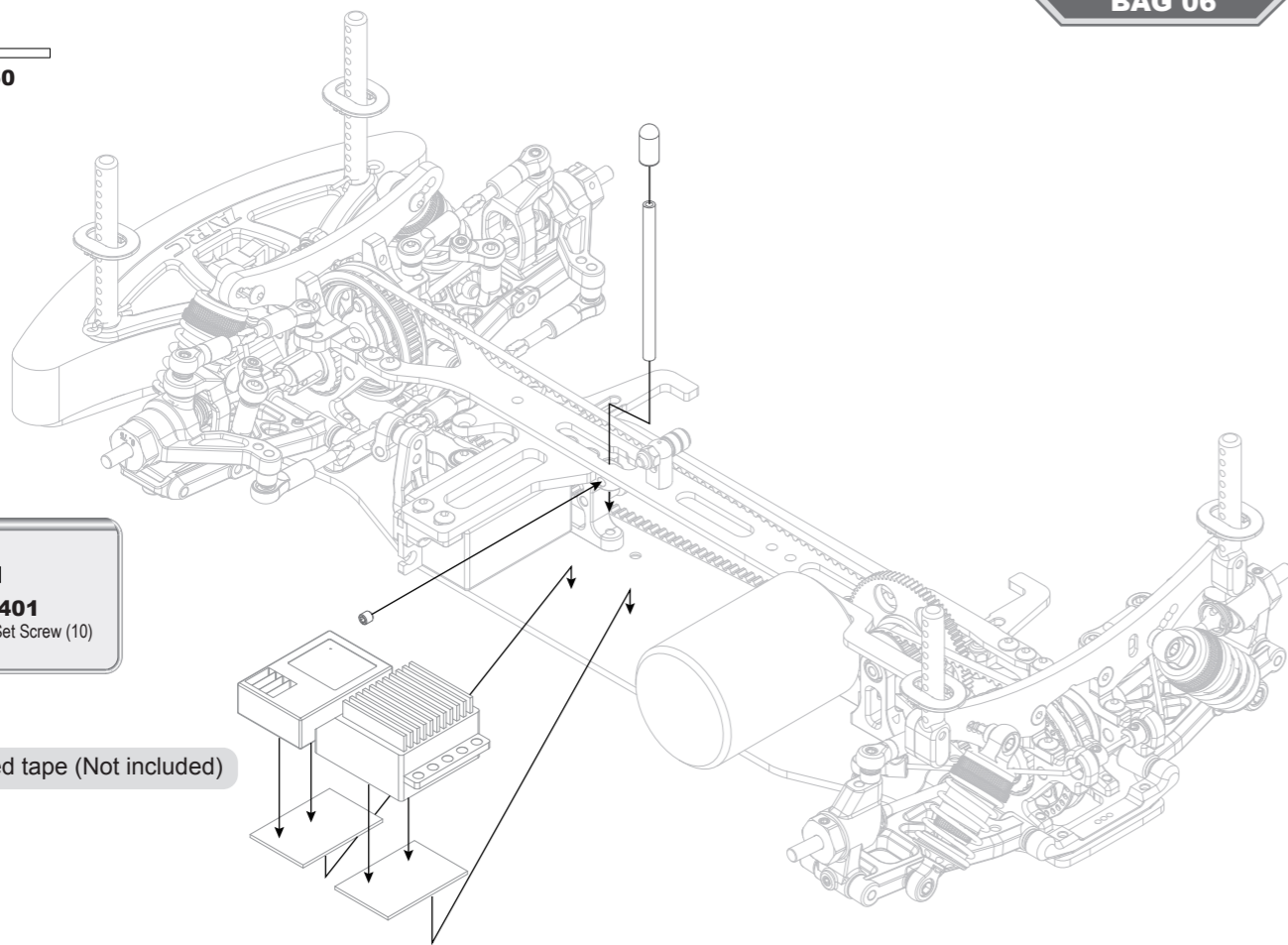

R105401
3x3mm Set Screw (10)

Double sided tape (Not included)

BATTERY MOUNTING METHOD

Use glass fiber tape attached to the battery mount plate to secure the battery.

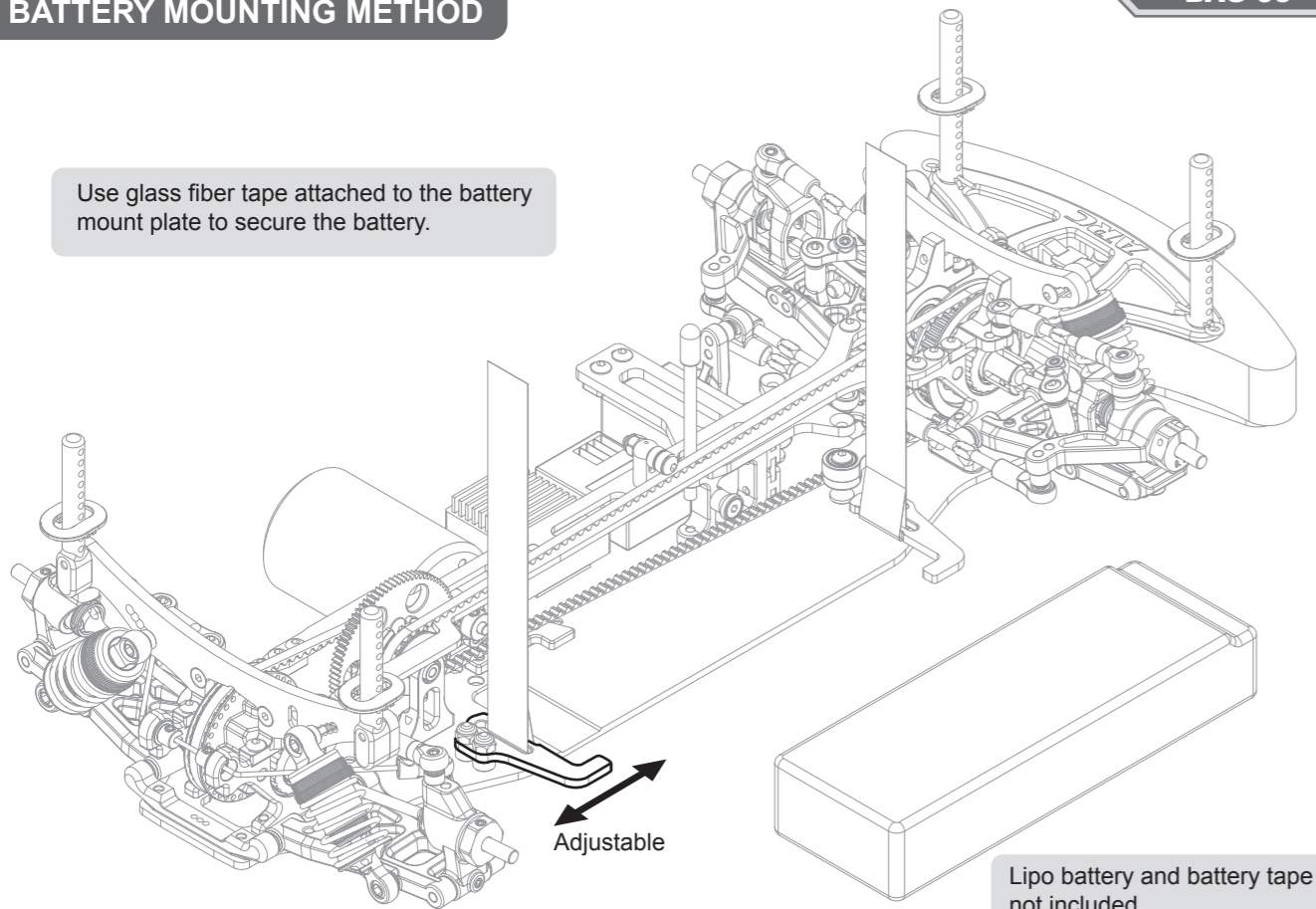

Lipo battery and battery tape not included



R105151
4mm Serrated Wheel Nut (4)

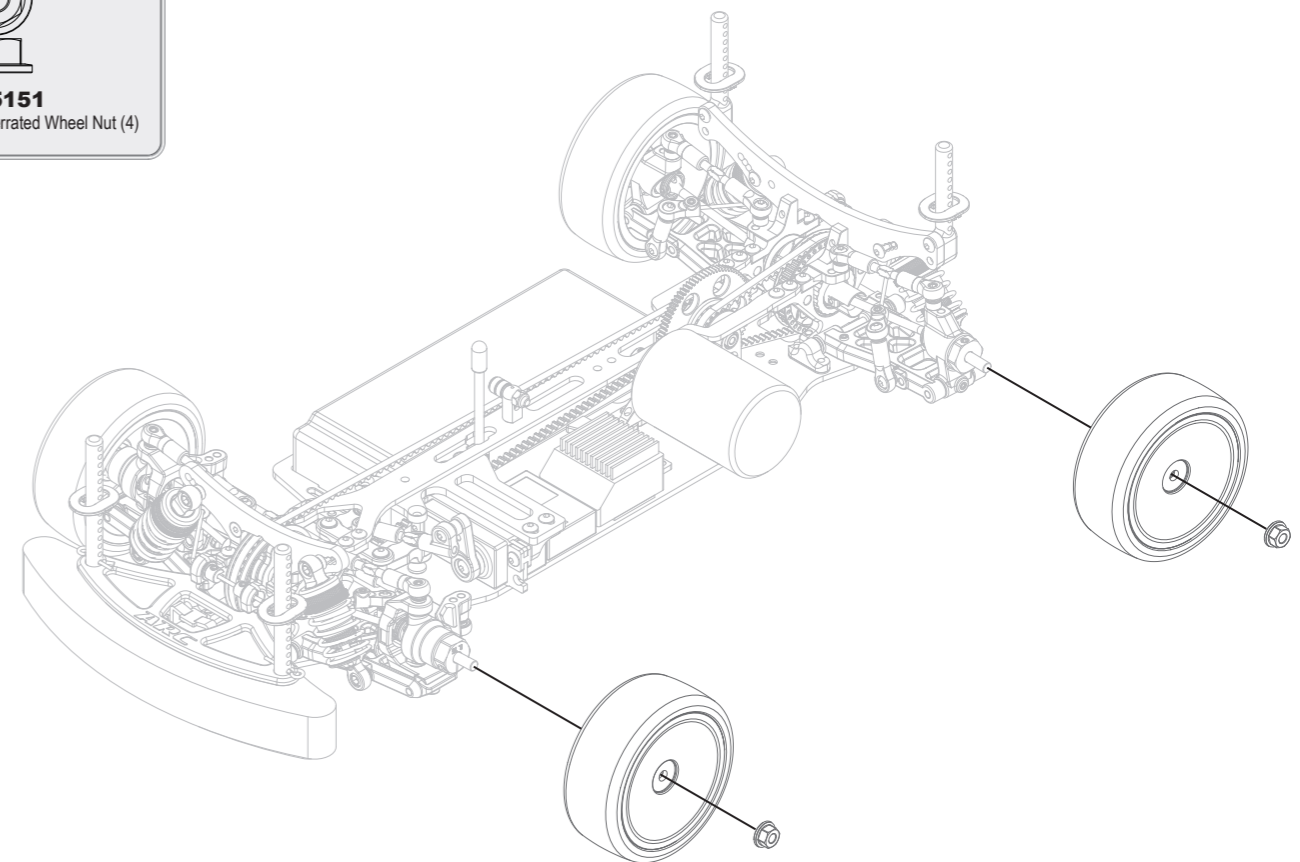

R11 SUSPENSION BLOCK CHART

R119001

R11 Separated Suspension Block #2

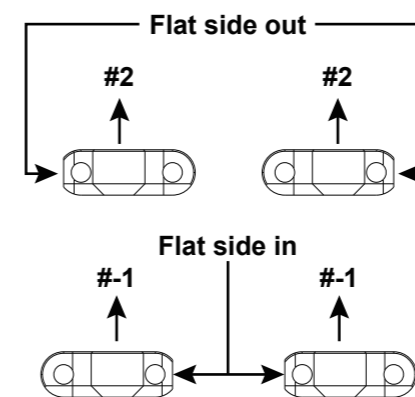

R119002

R11 Separated Suspension Block #0

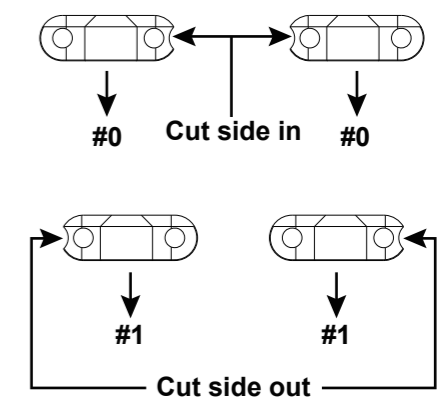

REAR SUSPENSION BLOCK CHART WITH SUSPENSION BLOCK #0&ATS

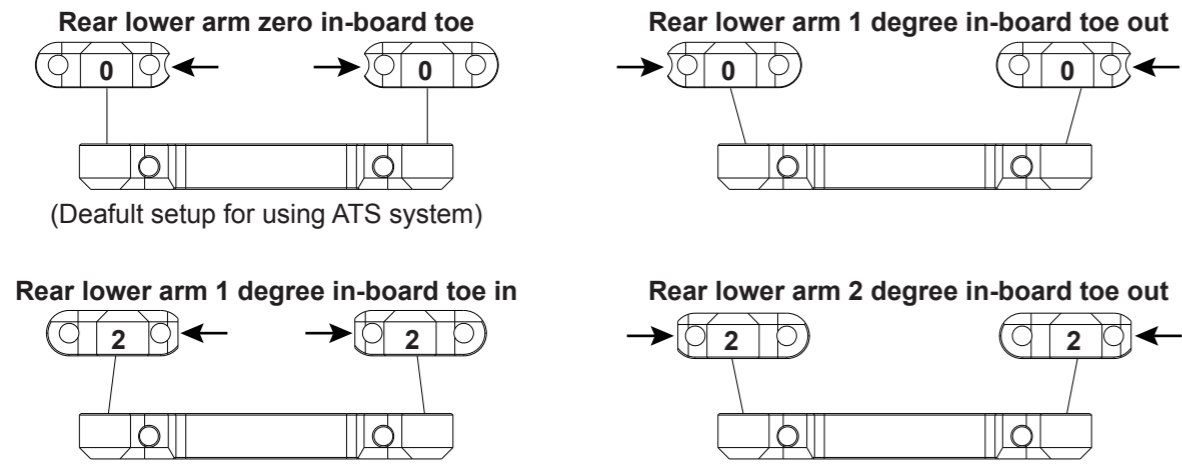

FRONT SUSPENSION BLOCK CHART WITH SUSPENSION BLOCK #1

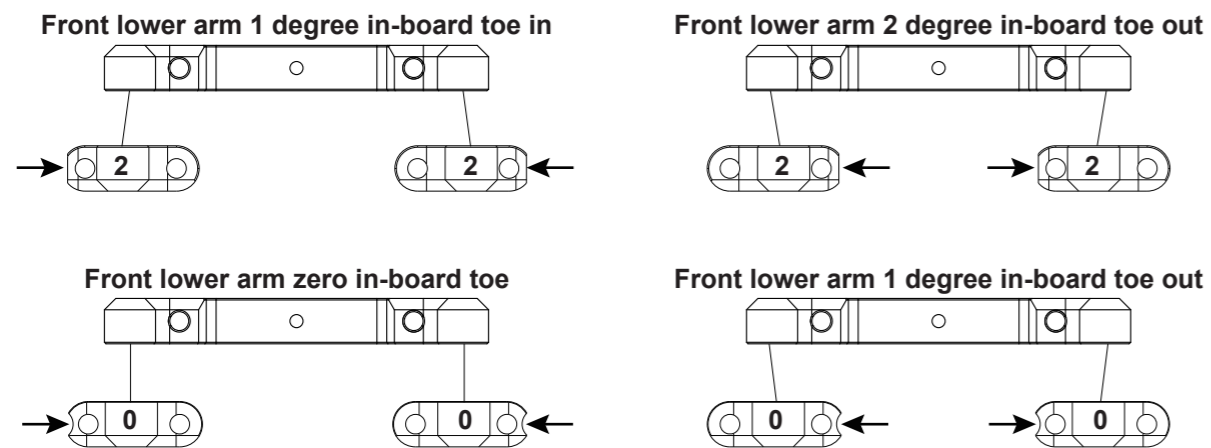

FRONT SUSPENSION BLOCK CHART WITH SUSPENSION BLOCK #2

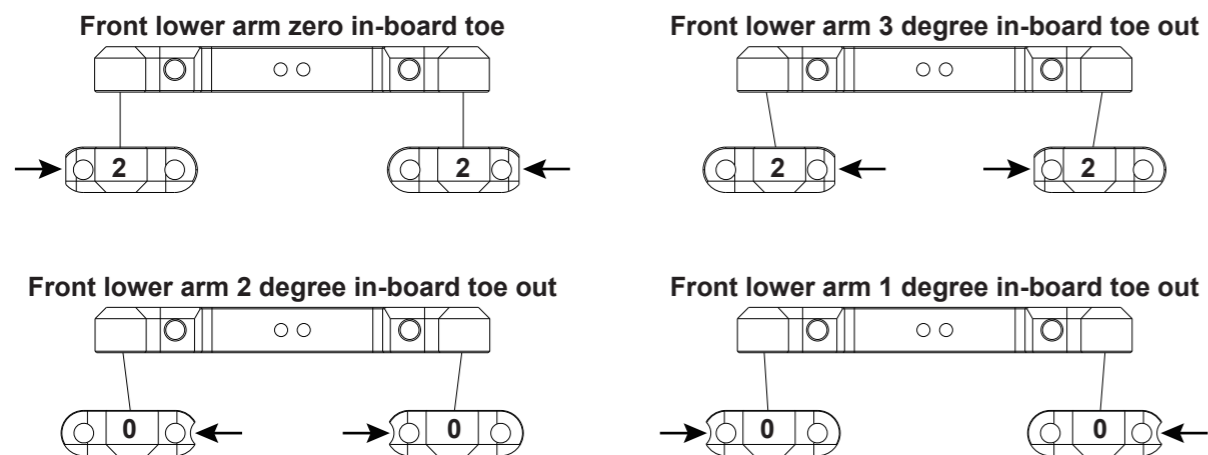

REAR SUSPENSION BLOCK CHART WITH SUSPENSION BLOCK #2.5

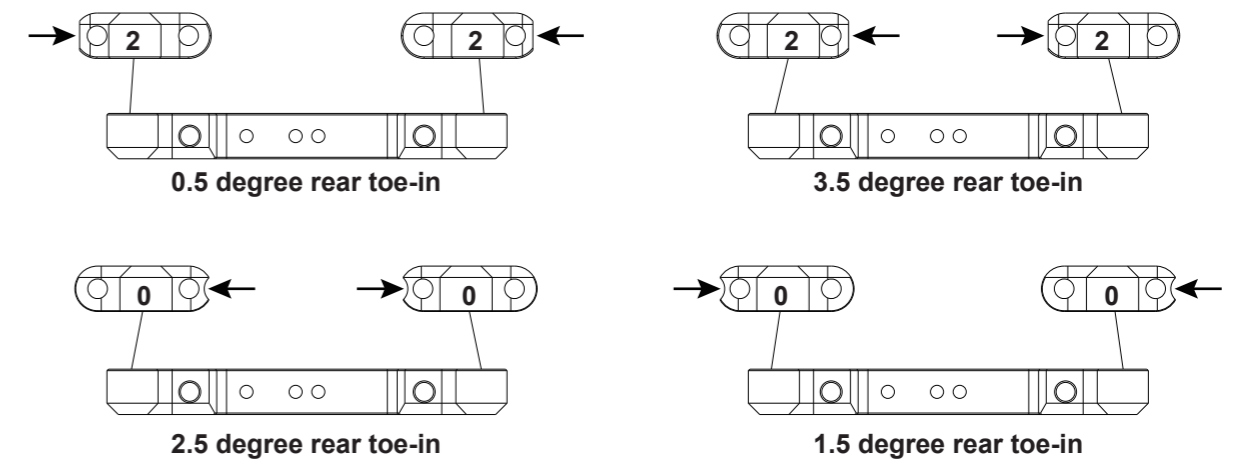

REAR SUSPENSION BLOCK CHART WITH SUSPENSION BLOCK #3

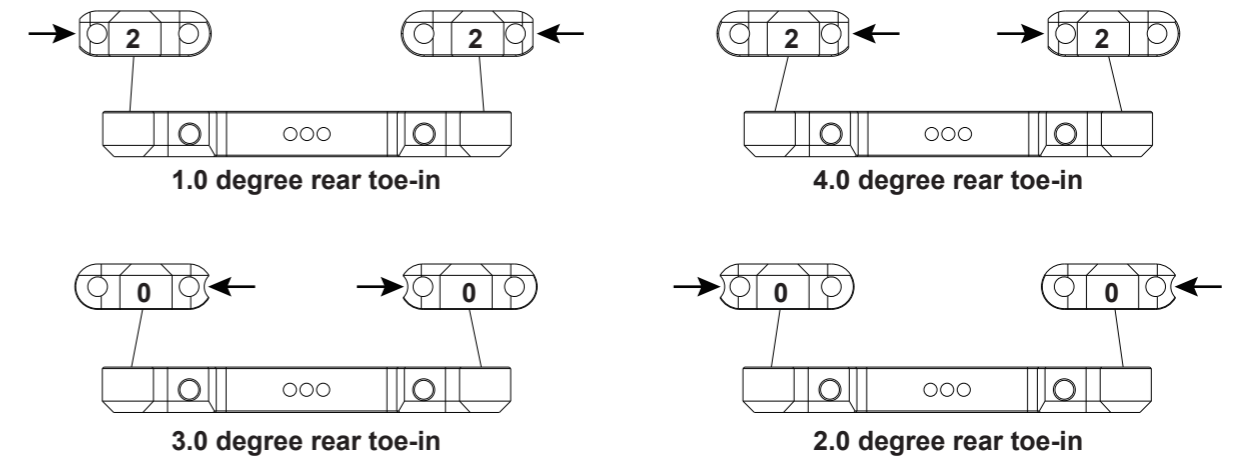

FRONT SUSPENSION BLOCK CHART WITH SUSPENSION BLOCK #3FR

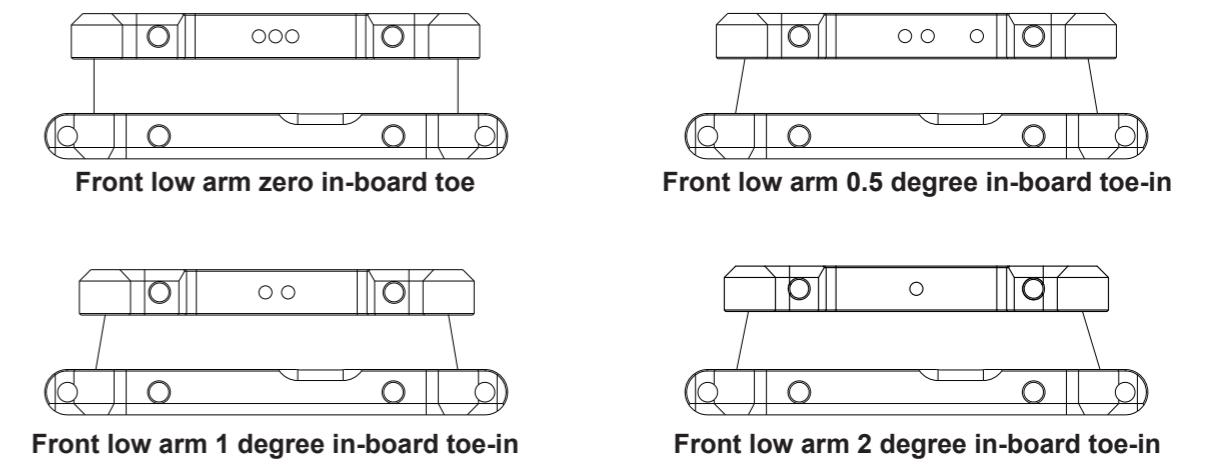

RACE

TRACK

NAME

CITY / COUNTRY

DATE

TEMPERATURE	AIR	TRACK
QUALIFYING POSITION	BEST LAPTIME	FINAL POSITION
	SEC	MIN

TRACK CONDITION CARPET ASPHALT

TECHNICAL MIXED FAST

TRACTION LOW MEDIUM HIGH

FRONT TRANSMISSION REAR

GEAR DIFF CST GEAR DIFF CST

ONE WAY SPOOL

Number of Gears 2 4

PINION T SPUR GEAR T

R10 Internal Ratio 2.0

FINAL DRIVE RATIO

FRONT	REAR
500 CST	500 CST
ARC Green	ARC Blue
4	4
0 %	0 %

TIRES

RIM

INSERTS

ADDITIVE

Bumper Standard Cut

BODY MOUNT DISTANCE 8 mm

BODY BLITZ GSF II WING STANDARD

ATS SETUP

Upright Shims 2 mm

Base Shims 5 mm

NOTE

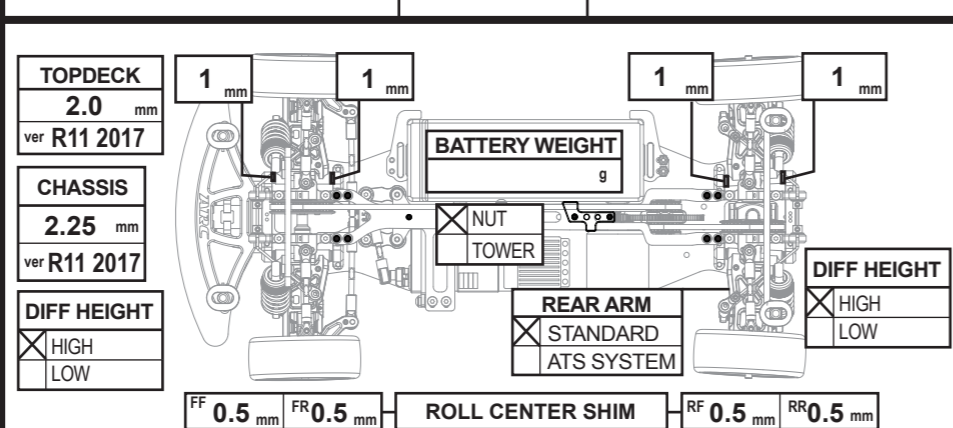
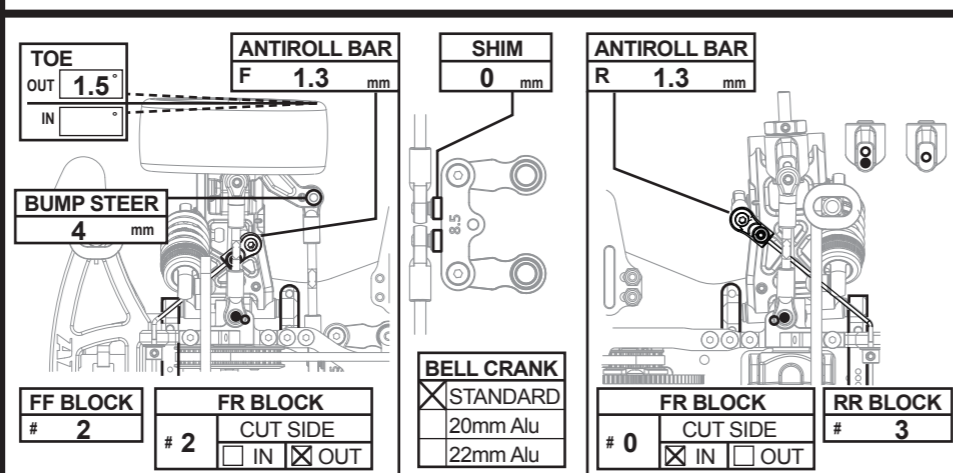
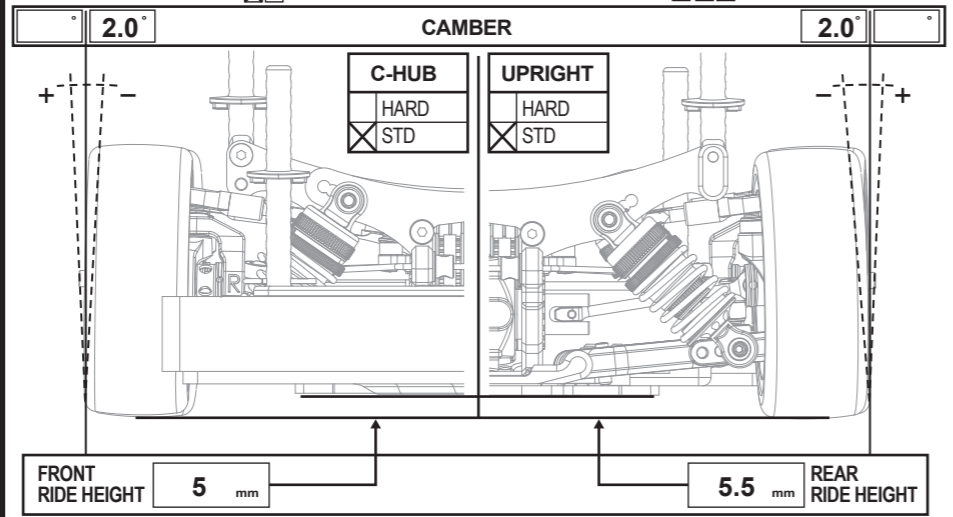
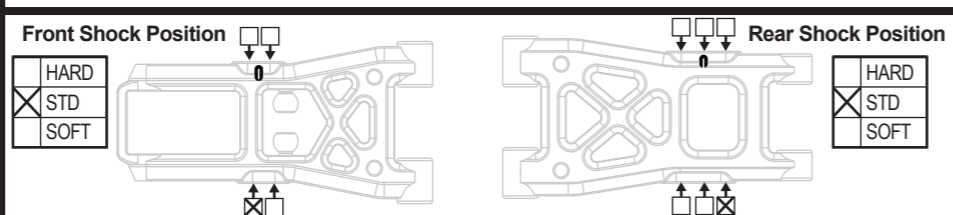
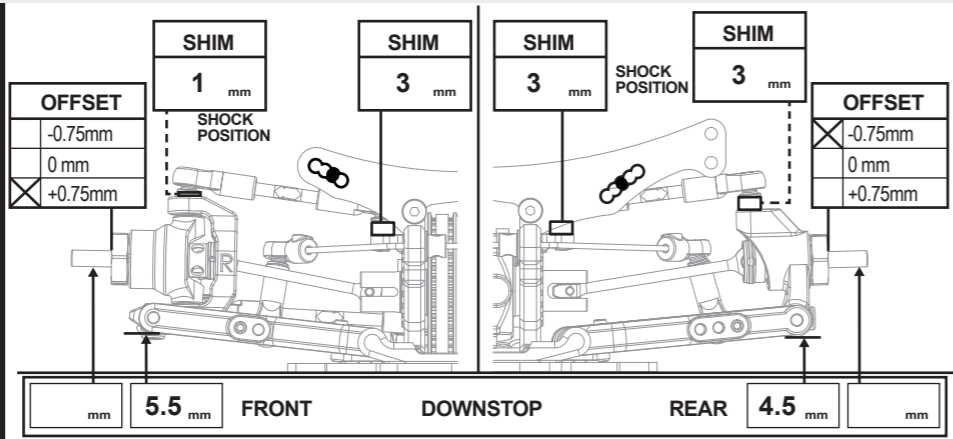

RACE

TRACK

NAME

CITY / COUNTRY

DATE

TEMPERATURE	AIR	TRACK
QUALIFYING POSITION	BEST LAPTIME	FINAL POSITION
	SEC	MIN

TRACK CONDITION CARPET ASPHALT

TECHNICAL MIXED FAST

TRACTION LOW MEDIUM HIGH

FRONT TRANSMISSION REAR

GEAR DIFF CST GEAR DIFF CST

ONE WAY SPOOL

Number of Gears 2 4

PINION T SPUR GEAR T

R10 Internal Ratio

FINAL DRIVE RATIO

FRONT	REAR
CST	CST
OIL	
SPRING	
PISTON	
%	%

TIRES

RIM

INSERTS

ADDITIVE

Bumper Standard Cut

BODY MOUNT DISTANCE mm

BODY WING

ATS SETUP

Upright Shims mm

Base Shims mm

NOTE

